

6605 HARTMAN ST.

L 39 Blk. 7₄ Sub. Jade Park # 4 Zone R-M-h

Gloria Gatewood 7-9-79

CITY OF LAS VEGAS, NEVADA

LOG NO. & AREA 1943 CONST. VAL. \$ 2,400.00

DEPARTMENT OF BUILDING & SAFETY

APPLICATION & BUILDING PERMIT — for: Dwellings, Duplexes, Misc. Residential Const.

ADDRESS OF CONSTRUCTION: 6605 Harbman Street OWNER: Home Savings Association

LOT(s) 39 BLOCK 7 SUBDIVISION Jade Park Unit #1 ZONE: RMH

Existing structure on lot: Dwelling Accessory bldg. Vacant lot Other

PROPOSED CONSTRUCTION: Improve Trailer Estate Lot USE: Residential

MATERIALS OF CONSTRUCTION: Wood Frame Concrete Block Reinforced Concrete Steel Frame

SQ. FEET OF FLOOR AREAS: 1st 20 2nd 20 3rd 20 Other 0 TOTAL SQ. FT. 60

FIRE ZONE: 1 2 3 Occupancy Group: 1 J 1 - 2 CONST. TYPE I II III IV

ARCHITECT: _____ ENGINEER: _____ NO. of UNITS 1 NO. of STORIES 1

Plans Submitted: Yes No Calculations Submitted: Yes No Sewer Fee Req'd: Yes No

CONTRACTOR: Sun Home Builders, Inc. STATE LICENSE # 6660 - 6660A CITY LICENSE # C11-444-2-06059

ADD'L. PERMITS REQ'D: Air Cond. Elec. Plumbing Signs Paving Fence Public Walks Curb-gutters Incinerators Fire Sprinkling System

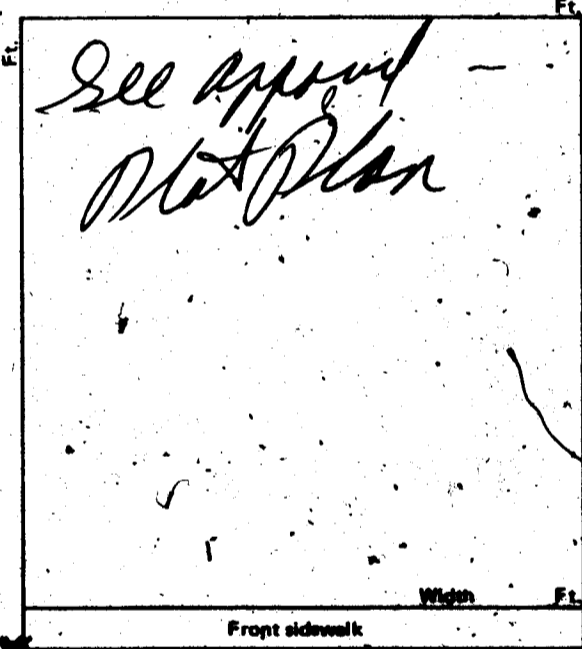

CONDITIONS OF THE PERMIT:

1. I agree to call the City Building Department for inspections before concrete is poured, before rough wiring, electrical, plumbing, framing is covered. Also for air conditioning, sheet-rock and sheathing inspection.
2. I agree that when the job is completed that I will call for final inspection before occupancy.
3. I agree to perform all construction in accordance with City Ordinances and Building Codes.
4. The Contractor's signature below denotes authority from the owner to sign in his behalf and that the owner is aware of all requirements of this application and permit. Separate permits must be taken out for work outlined above this agreement.
5. I have read and understand the contents of this application and permit; I hereby state that the information I have supplied on this application is true and correct.

Approval for the work under this permit will be given only after refuse and debris have been removed from job site and public right of way.

SIGNED: For Sun Home Builders, Inc. Contractor

BY: [Signature] Agent or Owner

CLARK COUNTY HEALTH DEPT. Date _____

LAS VEGAS FIRE DEPARTMENT Date _____

PLANNING DEPT.: [Signature] Date: 6-8-76

PUBLIC WORKS DEPT.: [Signature] Date: 6-9-76

BUILDING DEPT.: [Signature] Date: 6/9/76

12850 PERMIT NO.: 3079 PERMIT FEE \$ 1800

RECEIPT

3211 \$018.00 - 8

CITY OF LAS VEGAS
MUST BE RECORDED

Gloria Gatewood 7-9-79

CITY OF LAS VEGAS, NEVADA

LOG NO. & AREA _____ DEPARTMENT OF BUILDING & SAFETY APPLICATION & BUILDING PERMIT — for: CONST. VAL \$ 810⁰⁰

ADDRESS OF CONSTRUCTION: 7-17 16605 Hartman OWNER: _____

LOT(s) 39 BLOCK 7 SUBDIVISION Jaded Park 4 ZONE R-MH

Materials of Construction: Block Concrete Wire Wood Other PLANS: Yes No

ARCHITECT: _____ ENGINEER: _____ CALCS:

CONTRACTOR: Lynn Conde STATE LICENSE # 12464 CITY LICENSE # 13422

TOTAL SQUARE FEET: 560 TOTAL LINEAL FEET: 90

Remarks: _____

CONDITIONS OF THE PERMIT:

1. Any type of retaining wall must be engineered by a Civil or Structural Engineer.
2. If a home owner takes out the Building Permit and if the owner sublets the work to a Contractor, then the Contractor must take out the permit and pay for it.
3. No fence or wall can be built on City property or rights-of-way, but this is not intended to preclude construction within utility easements if utilities will not be damaged or made inaccessible.
4. The fence or wall shall not enclose any water meter, light standard, or fire alarm box and shall not come closer than 24" from the nearest fire hydrant outlet.
5. Department inspectors must approve footings before concrete is poured and block wall reinforcing before grouting is done.
6. Maximum height of any wall or fence is 6', side and rear yards; 4' maximum in front yard with the vertical surface above the height of 2' — 50% open.
7. I must not obstruct required onsite parking space (2 spaces for each dwelling unit) by the location of this fence or wall.
8. By the signing of this application I herewith agree to the requirements outlined above.

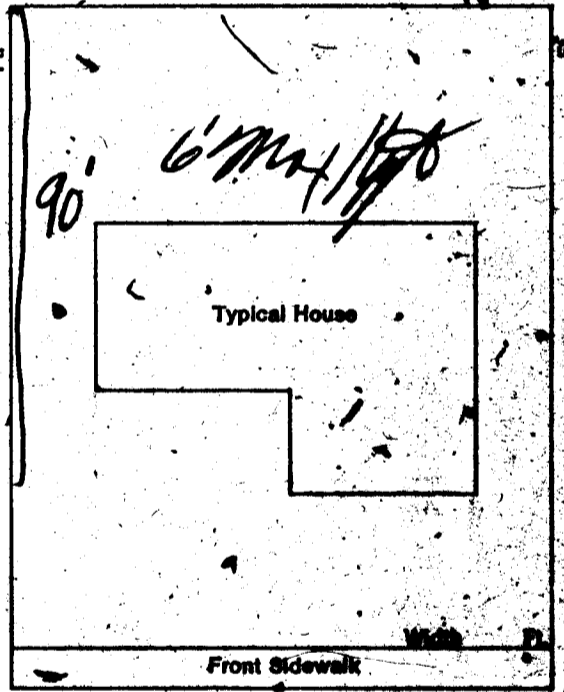

SIGNED: Lynn Conde DATE: 11-14-76
CONTRACTOR AGENT OWNER

PLANNING DEPT: _____ Date: 10-14-76

PUBLIC WORKS DEPT: _____ Date: _____

BUILDING DEPT: _____ Date: 10-14-76

PERMIT NO: 5067 PERMIT FOR: 1102
154-01-280

RECEIPT

9104 \$811.00 - 8

CITY OF LAS VEGAS

MUST BE MACHINE VALIDATED

Gloria Gatewood 7-9-79

CITY OF LAS VEGAS, NEVADA
DEPT. OF PUBLIC SERVICES

LOG NO. & AREA 9-02 DIVISION OF BUILDING & SAFETY PHONE: 386-6251

CONST. VAL. \$ _____ APPLICATION & BUILDING PERMIT - for: Dwellings, Duplexes, Misc. Residential Const.

ADDRESS OF CONSTRUCTION: 6605 Hartman OWNER: John Melancon

LOT(s) 39 BLOCK 7 SUBDIVISION Subd #4 ZONE R-MH

Existing structure on lot: Dwelling Accessory bldgs. Vacant lot Other

PROPOSED CONSTRUCTION: Mobile Home USE: Res.

MATERIALS OF CONSTRUCTION: Wood Frame Concrete Block Reinforced Concrete Steel Frame

SQ. FEET OF FLOOR AREAS: 1st _____ 2nd _____ 3rd _____ Other _____ TOTAL SQ. FT. _____

FIRE ZONE: _____ Occupancy Group _____ CONST. TYPE: _____

ARCHITECT: _____ ENGINEER: _____ NO. of UNITS _____ NO. of STORIES _____

Plans Submitted: Yes No Calculations Submitted: Yes No Sewer Fee Req'd. Yes No

CONTRACTOR: owner STATE LICENSE # _____ CITY LICENSE # _____

ADD'L. PERMITS REQ'D: Air Cond. Elec. Plumbing Signs Paving Fence Public Walks Curb-gutters
Incinerator Fire Sprinkling System

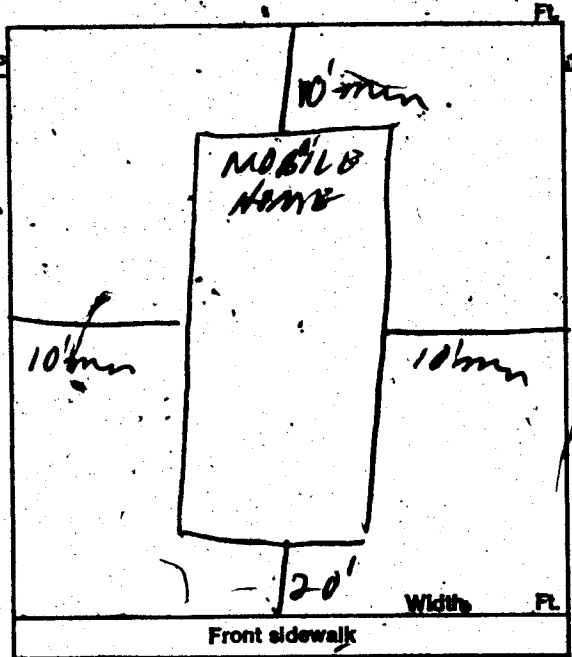

CONDITIONS OF THE PERMIT:

1. I agree to call the City Building Department for inspections before concrete is poured, before rough wiring, electrical, plumbing, framing is covered. Also for air conditioning, sheet-rock and sheathing inspection.
2. I agree that when the job is completed that I will call for final inspection before occupancy.
3. I agree to perform all construction in accordance with City Ordinances and Building Codes.
4. The Contractor's signature below denotes authority from the owner to sign in his behalf and that the owner is aware of all requirements of this application and permit. Separate permits must be taken out for work outlined above this agreement.
5. I have read and understand the contents of this application and permit; I hereby state that the information I have supplied on this application is true and correct.

SIGNED: _____ Contractor

BY: John H. Melancon Agent or Owner

CLARK COUNTY HEALTH DEPT. Date: _____

LAS VEGAS FIRE DEPARTMENT Date: _____

PLANNING DEPT.: JMA Date: 1-17-77

PUBLIC WORKS DEPT.: _____ Date: _____

BUILDING DEPT.: lc Date: 1-17-77

PERMIT NO.: 223 PERMIT FEE \$ 500

154-01-220
76-11-14

3640 RECEIVED - 8

CITY OF LAS VEGAS
BUILDING & SAFETY

MUST BE MACHINE VALIDATED

J. Collins 3-26-82

DEPT. of BLDG. & SAFETY - CITY of LAS VEGAS, NEVADA

OWNER Home Savings ADDRESS 6605 Hartman St. DATE 6-10-76
 GEN. CONT. Sun Home Builders TYPE OF STRUCTURE mobile home insp
 PERMIT NO. 3079 LEGAL DESCRIPTION L 39 B 7 Jade Park Unit # 4

BUILDING	MECHANICAL	ELECTRICAL
Investigation	Plumbing Cont. <u>Longley Const</u>	Temp. pole cont.
Location & Footing	Permit No. <u>1715 1765</u> Date	Permit No. _____ Date
Stem Wall	Heat & Vent. A/C Cont.	Inspection _____ Date
Concrete Slab Floor	Permit No. _____ Date	Electrical Cont. <u>Acme</u> <u>8-22-76</u>
Floor Framing	Sewer Cont. <u>Owner</u>	Permit No. <u>2080</u> Date
Fireplace Footing	Permit No. <u>1715</u> Date	Fixtures Cont.
Chimney Steel	Rough Soil	Permit No. _____ Date
Vert. Steel Reinf.	Rough Water	Slab
Horiz. Steel Reinf.	Top-Out	Rough
Roof Sheathing	Rough Gas	Final Rough
Framing	A/C Rough Duct	Final Fixture
Backing for siding	Ref. Rough Piping	Final Electrical
Ext. Lath	Final Plumbing	Temporary Service
Ext. Scratch	Final Gas	MISCELLANEOUS
Ext. Brown	Final Air Cond.	Grading & Drainage
Int. Lath	Final Refrig.	On-Site Parking Spaces _____ App.
Int. Brown	Final Sewer <u>MEPT-8-76</u>	Eng. Approval of _____
Drywall	Final Septic Tank	Off-Site Improvements
Permit No. _____		
Final Building		
Appr. for Occu.		

INSPECTOR: _____ DATE _____

APPROVED FOR OCCUPANCY & METER *BW1-19-77*

PLEASE NOTE REMARKS ON REVERSE SIDE 6605 Hartman St. LOG # _____ AREA # _____ T19-3

DIVISION of BUILDING & SAFETY - CITY of LAS VEGAS, NEVADA

OWNER John Melancon ADDRESS 6605 Hartman DATE 1-17-77
 GEN. CONT. Owner TYPE OF STRUCTURE Mobile Home
 PERMIT NO. 273 LEGAL DESCRIPTION 39 B. 7 Jade Park # 4

BUILDING	MECHANICAL	ELECTRICAL
Investigation	Plumbing Cont.	Temp. pole cont.
Location & Footing	Permit No. _____ Date	Permit No. _____ Date
Stem Wall	Heat & Vent. A/C Cont.	Inspection _____ Date
Concrete Slab Floor	Permit No. _____ Date	Electrical Cont.
Floor Framing	Sewer Cont.	Permit No. _____ Date
Fireplace Footing	Permit No. _____ Date	Fixtures Cont.
Chimney Steel	Rough Soil	Permit No. _____ Date
Vert. Steel Reinf.	Rough Water	Slab
Horiz. Steel Reinf.	Top-Out	Rough
Roof Sheathing	Rough Gas	Final Rough
Framing	A/C Rough Duct	Final Fixture
Backing for siding	Ref. Rough Piping	Final Electrical
Ext. Lath	Final Plumbing	<u>META for BW1-19-77</u>
Ext. Scratch	Final Gas	Temporary Service
Ext. Brown	Final Air Cond.	MISCELLANEOUS
Int. Lath	Final Refrig.	Grading & Drainage
Int. Brown	Final Sewer	On-Site Parking Spaces _____ App.
Drywall	Final Septic Tank	Eng. Approval of _____
Insulation		Off-Site Improvements
Final Building		
Appr. for Occu.		

INSPECTOR: _____ DATE _____

APPROVED FOR OCCUPANCY & METER *BW1-19-77*

PLEASE NOTE REMARKS ON REVERSE SIDE 6605 Hartman LOG # _____ AREA # _____ 76-114

L. Collins 3-26-82

CITY OF LOS ANGELES
 OWNER Sun [unclear]
 CONTRACTOR [unclear]
 LOT [unclear]
 Date 10-14-76
 5069
 Fence (wire, wood, etc.)
 Location
 Final Inspection
 2d 3d
 10-15-76
 Retaining Wall (masonry)
 Retaining Wall (concrete)
 Location
 Footing
 Wall Steel 1st 2d 3d
 Bond Beam 1st 2d 3d
 Final Inspection

C