

6109 Foxcroft

Debbie Ingman 7-14-86

CITY OF LAS VEGAS, NEVADA

BRUCE UPTON
873-6803
CONST. VAL. \$ 50,000

LOG NO. & AREA R-77 DATE 4/20/86

DEPARTMENT OF BUILDING AND SAFETY PHONE 386-8251
ADDRESS OF CONSTRUCTION 6109 Tokcraft 4-11-2
OWNER Bradyn Upton

BUILDING PERMIT FOR: Single-Family Dwelling, Remodel, Additions, Misc. Residential Construction

LOT(s) 20 BLOCK 1 SUBDIVISION Bishops Woods North ZONE R-E

PROPOSED CONSTRUCTION SFD w/ 1st floor USE

THIS PERMIT FOR BLDG. A/C ELEC. PLBG. OTHER PERMITS RECD: FENCE OFF SITE SWIM POOL

FLOOR AREA BSMT 1ST 1580 2ND GARAGE 616 PORCH 708 TOTAL 2312

CONTRACTOR Owner STATE LICENSE NO. CITY LICENSE NO.

ARCHITECT ENGINEER

MASTER PLUMBER/CONTRACTOR MASTER ELECTRICIAN/CONTRACTOR

OTHER INSPECTIONS AND FEES

- Inspections outside of normal business hours = \$30.00 per hour (minimum charge three hours)
- Plan inspection fee during normal business hours assessed under provisions of TABLE 3-A of the Uniform Building Code = \$30.00 per hour
- Inspections during normal business hours for which no fee is specifically indicated = \$30.00 per hour (minimum charge one half hour)
- Additional plan review required by changes, additions or revisions to approved plans = \$30.00 per hour (minimum charge two hours)

CONDITIONS OF THE PERMIT:

- I agree to call the City Building Department for inspections before concrete is poured, before rough wiring, electrical, plumbing, framing is covered. Also for air conditioning, drywall and sheathing inspection.
- I agree that when the job is completed that I will call for final inspection before occupancy.
- I agree to perform all construction in accordance with City Ordinances and Building Codes. The Contractor's signature below denotes authority from the owner to sign in his behalf and that the owner is aware of all requirements of this application and permit. Separate permits must be taken out for work outlined above this agreement.
- I have read and understand the contents of this application and permit, hereby state that the information I have supplied on this application is true and correct.
- Approval for the work under this permit will be given only after refuse and debris have been removed from job site and public right of way.
- 24 HOUR MINIMUM NOTICE REQUIRED FOR INSPECTIONS

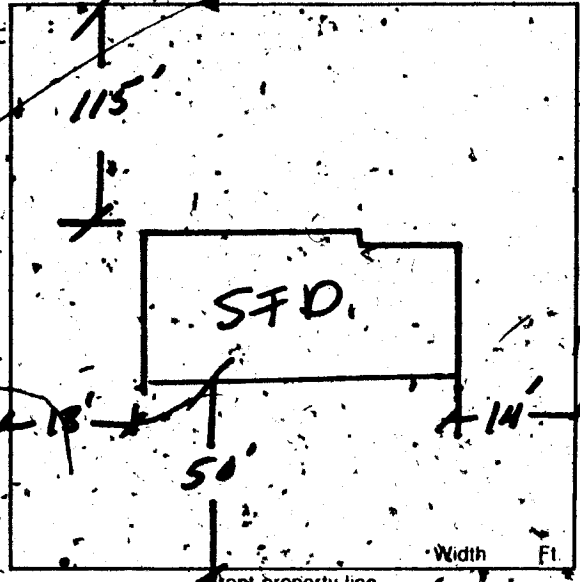

BY: *Bradyn Upton* OWNER

BY: AGENT

I hereby certify that I have reviewed this application and the proposed plans and have found that the proposed development meets the requirements of the City of Las Vegas Flood Hazard Reduction Ordinance, for the issuance of this Development Permit.

LAND DEVELOPMENT AND FLOOD CONTROL ENGINEER 6-26-86 DATE

PLANNING DEPT 6/05/86 DATE

BUILDING DEPT 6/26/86 DATE

FINISH FLOOR TO BE 3" ABOVE TOP OF CURB AT NE PROPERTY COR.

PLUMBING	FEE	ELECTRICAL	FEE
WATER DISTRIBUTION	6.00	RECEPTACLE 40 SWITCH 20	40 24
SEWER SYSTEM - NEW OR MODIFICATION	10.00	EACH LIGHT FIXTURE OR SOCKET	10 .30 5.40
FIXTURES - WATER SOFTENER, H.W. HEATER	2.00	SPECIAL OUTLET, APPLIANCE ETC.	6 .70 4.20
GARBAGE DISPOSAL - WASHER	2.00	SERVICE/PANEL - SUB(3.00) 200A(6.00) 400A(12.50)	6 8 16.50
FUEL PIPING	6.00	A.C. UNIT OR MOTORS	1 3.00 3
IRRIGATION SYSTEM	8.00	2310-2402	TOTAL 44.00
2310-2403	TOTAL	MISC. Temp - power pole	6.00
AIR CONDITIONING	FEE	2310-2401 ISSUANCE FEE	500
NEW UNIT - 3#ON = 9.00 OVER = 16.50		7114-3654 SEWER CONNECTION	184
FURNACE TO 100,000 9.00 OVER/11.00		2310-2401 PLAN REVIEW FEE	2.83
VAPORATIVE COOLER	6.50	2310-2400 BLDG. PERMIT FEE	2.83
VENTILATION FAN	2.35	TOTAL FEES	1,019.00
2310-2405	TOTAL		

RECEIPT **0006**

ELEC	50.00
SEWR	500.00
PLCK	184.00
SFD	283.00
CASH	1017.00
8958A000	15:39

PERMIT EXPIRES 180 DAYS AFTER ABANDONMENT OF WORK

MUST BE MACHINE VALIDATED

Debbie Ingraham 7-16-86

CITY OF LAS VEGAS, NEVADA

LOG NO. & AREA R-17 DATE 7-10-86 CONST. VAL. \$ _____

DEPARTMENT OF BUILDING AND SAFETY
PHONE 386-6251

PLUMBING PERMIT

ADDRESS OF CONSTRUCTION 6109 FOXCROFT OWNER BRENDA BRADY UPTON PHONE 457-3093

CONTRACTOR Owner STATE LICENSE NO. _____ CITY LICENSE NO. _____

LOT(S) 21 BLOCK 1 SUBDIVISION BRETON WOODS NORTH ZONE RF

PROPOSED CONSTRUCTION: SFD W/FP USE: _____
PLUMBING PERMIT NO. 9017

UNITS	DESCRIPTION	FEE	TOTAL
PERMIT ISSUANCE			
	For Issuing Each Permit	10.00	
	For Issuing Each Supplemental Permit #8958	4.50	
FIXTURE CHARGE			
6	Bathtub, Shower, Lavatory, Toilet, Urinal	EA 2.00	12.00
3	Floor Drain, Floor Sink, Wash Tray, Sink	EA 2.00	6.00
	Garbage Disposal, Clothes Washer, Dishwasher (residential)	EA 2.00	6.00
	Garbage Disposal (commercial)	EA 8.00	
	Clothes Washer, Dishwasher (commercial)	EA 2.00	
	Clothes Dryer (gas) (venting)	2.00	2.00
	Dental Unit	8.00	
	Drinking Fountain	2.00	
	Refrigerator, Ice Maker, Water Dispenser	2.00	2.00
	Any other water using equipment, Attached Coffee Makers, Ice Makers	2.00	
	Hot Water Heater (Gas or Electric)	EA 2.00	2.00
SEWER SYSTEM			
	New, Replacement, Modification, or Any Drainage Work	10.00	10.00
	Grease or Sand Trap or Interceptor	2.00	
	Trailer Trap (rental parks)	.500	
WATER SOFTENERS			
	Non Permanent Type (rental)	2.00	
	Permanent Type (connected to drain)	2.00	
WATER DISTRIBUTION SYSTEM			
4	Single Family Dwelling	6.00	24.00
	Multi-Family Dwelling	6.00	
	Plus Each Dwelling Unit	3.00	
	Commercial Building per/floor	3.00	
	Plus Each Unit (leased space or office)	2.00	
	Hotel, Motel	8.00	
	Plus Each Unit	3.00	
	Trailer Park	30.00	
	Plus Each Space	2.00	
	Irrigation Single Family Dwelling	8.00	
	Irrigation Commercial Fee-Based on Building Code Valuation Chart Construction Valuation		

Approval for the work under this permit will be given only after refuse and debris have been removed from job site and public right of way.

UNITS	DESCRIPTION	FEE	TOTAL
FUEL PIPING SYSTEM			
1	Single Family Dwelling	6.00	6.00
	Multi-Family Dwelling	10.00	
	Plus Each Unit,	2.00	
	Commercial Building (per floor)	6.00	
	Plus Each Unit (leased space or office)	6.00	
	Medium Pressure System (Plan Check)	12.00	
	Each Gas Appliance (Any Type)	2.00	
	Steam Boilers	5.00	
SOLAR ENERGY SYSTEMS			
	Collectors (including piping) (per collector)	5.00	
	Storage Tanks (each)	5.00	
PIPELINE CONTRACT			
	For Onsite Sewer, Gas or Water Contract Value. Fee based on Building Code Permit Valuation Chart.		
OTHER INSPECTIONS AND FEES:			
	Inspections outside of normal business hours (minimum charge - three hours)	25.00 per hour	
	Under provisions of Table 3-A of the Uniform Building Code, work which has been inspected once and not approved may be subject to a Reinspection Fee not less than \$30.00 per each inspection during business hours	30.00 each	
	Additional plan review required by changes Additions to or revisions to approved plans (minimum charge two hours)	30.00 per hour	
	Plumbing permit fees may be computed the same as building permit fees by using the cost of installation for valuation amount when such work is not included in the above schedule.		
	Construction Valuation		

I hereby certify that I have carefully examined and read the above application; that the same is true and correct; and that the work herein described is to be done in accordance with all the provisions of the applicable Ordinances of the City of Las Vegas, Nevada and the State Laws, whether herein specified or not.

SIGNED Brenda Upton CONTRACTOR MASTER CARD NO. _____

BY _____ Registered Master Plumber, Spec. Contr. or Owner

BSD 7/10/86 BUILDING DEPT. DATE

3/83 PERMIT EXPIRES 180 DAYS AFTER ABANDONMENT OF WORK

SEWER # 7114-3654 CONNECTION

FIXTURES X 07/10/86

FEE 2310-2403 PERMIT FEE 54.50

TOTAL FEES _____

RECEIPT

0004
FLBB 54.50
CHEK 54.50
9017A000 13:06

PERMIT NO. _____

MUST BE MACHINE VALIDATED

Debbie Ingraham 9-15-86

CITY OF LAS VEGAS, NEVADA

LOG NO. & AREA _____ DATE _____ CONST. VAL. \$ _____

DEPARTMENT OF BUILDING AND SAFETY
PHONE 386-6251

AIR CONDITIONING PERMIT

ADDRESS OF CONSTRUCTION 6109 FOXCROFT OWNER UPSON PHONE 457-3093

CONTRACTOR ALLSTON REF STATE LICENSE NO. 212917 CITY LICENSE NO. _____

LOT(s) _____ BLOCK _____ SUBDIVISION _____ ZONE _____

PROPOSED CONSTRUCTION _____ USE _____

AIR COND. 0872
PERMIT NO. _____

UNITS	DESCRIPTION	FEE	TOTAL
PERMIT ISSUANCE			
1	For the issuance of each permit.	15.00	15
	For issuing each supplemental permit.	4.50	
UNIT FEE SCHEDULE			
	For the installation or relocation of each forced-air or gravity-type furnace or burner, including ducts and vents attached to such appliance, up to and including 100,000 Btu/h.	9.00	
	For the installation or relocation of each forced-air or gravity-type furnace or burner including ducts and vents attached to such appliance over 100,000 Btu/h.	11.00	
	For the installation or relocation of each floor furnace, including vent.	9.00	
	For the installation or relocation of each suspended heater, recessed wall heater or floor-mounted unit heater.	9.00	
	For the installation, relocation or replacement of each appliance vent installed and not included in an appliance permit.	4.50	
	For the repair, alteration of, or addition to each heating appliance, refrigeration unit, cooling unit, absorption unit, or each heating, cooling absorption, or evaporative cooling system, including installation of controls regulated by this code.	9.00	
	For the installation or relocation of each boiler or compressor to and including three horsepower, or each absorption system to and including 100,000 Btu/h.	9.00	
1	For the installation or relocation of each boiler or compressor over three horsepower to and including 15 horsepower, or each absorption system over 100,000 Btu/h and including 500,000 Btu/h.	16.50	16.50
	For the installation or relocation of each boiler or compressor over 15 horsepower to and including 30 horsepower, or each absorption system over 500,000 Btu/h to and including 1,000,000 Btu/h.	22.50	
	For the installation or relocation of each boiler or compressor over 30 horsepower to and including 50 horsepower, or for each absorption system over 1,000,000 Btu/h to and including 1,750,000 Btu/h.	33.50	
	For the installation or relocation of each boiler or refrigeration compressor over 50 horsepower, or each absorption system over 1,750,000 Btu/h.	56.00	

Approval for the work under this permit will be given only after refuse and debris have been removed from job site and public right of way.

UNITS	DESCRIPTION	FEE	TOTAL
	For each air-handling unit to and including 10,000 cubic feet per minute, including ducts attached thereto. <i>Note: This fee shall not apply to an air-handling unit which is a portion of a factory-assembled appliance, cooling unit, evaporative cooler or absorption unit for which a permit is required elsewhere in this code.</i>	6.50	
	For each air-handling unit over 10,000 cfm.	11.00	
	For each evaporative cooler other than portable type.	6.50	
	For each ventilation fan	COMMERCIAL 4.50 RESIDENTIAL 2.35	
	For each ventilation system which is not a portion of any heating or air-conditioning system authorized by a permit.	6.50	
	For the installation of each hood which is served by mechanical exhaust, including the ducts for such hood.	6.50	
	For each appliance or piece of equipment regulated by this code but not classed in other appliance categories, or for which no other fee is listed in this code.	6.50	
OTHER INSPECTIONS AND FEES:			
	Inspections outside of normal business hours (minimum charge — three hours).	25.00 per hour	
	Reinspection fee assessed under provisions of TABLE 3-A of the Uniform Building Code — \$15.00 EACH	15.00 each	
	Inspections for which no fee is specifically indicated (minimum charge — one-half hour).	30.00 per hour	
	Additional plan review required by changes, additions or revisions to approved plans (minimum charge — two hours).	30.00 per hour	
	Mechanical permit fees may be computed the same as building permit fees by using the cost of installation for valuation amount when such work is not included in the above schedule.		
	Gas piping which is directly related and necessary to the repair or replacement of heating, air conditioning, or refrigeration systems not exceeding 500,000 B.T.U.H.	6.00	

I hereby certify that I have carefully examined and read the above application; that the same is true and correct; and that the work herein described is to be done in accordance with all the provisions of the applicable Ordinances of the City of Las Vegas, Nevada and the State Laws, whether herein specified or not.

SIGNATURE *James Stim* CONTRACTOR MASTER CARD NO. _____
BY *R. Alford* Spec Cont. or Owner
BUILDING DEPT. DATE 9-12-86

PERMIT FEE _____
TOTAL FEES 31.50

2310-2405

RECEIVED # _____
A/C 31.50
CASH 31.50
0872A000 15:20
09/12/86

Permit Expires 180 Days After Abandonment of Work

MUST BE MACHINE VALIDATED

Debbie Ingraham 11-21-86

Certificate of Occupancy

City of Las Vegas, Nevada
Department of Building & Safety

This Certificate issued pursuant to the requirements of the Uniform Building Code certifying that at the time of issuance this structure was in compliance with the various ordinances of the City regulating building construction or use. For the following:

Use Classification R-3 Bldg. Permit No. _____
Building Address 6109 Foxcroft Floor, Suite or Room Sfd w/fp
Owner of Building Bradyn & Brenda Linton Address _____
By: Joseph A. Schwartz Date: November 19, 1986

Clay Hymers
Building Official

POST IN CONSPICUOUS PLACE

