

A. 105 FARKAS LN

B. 106 FARKAS LN

C. 107 FARKAS LN.

D. 108 FARKAS LN.

E. 109 FARKAS LN.

Maria Francis 7-1884

CITY OF LAS VEGAS, NEVADA

PHONE # 737-7777

LOG NO. & AREA T53-3 DATE June 29, 1984 CONST. VAL. \$ 39,300.00

DEPARTMENT OF BUILDING AND SAFETY
PHONE 386-6251

45-22-010701100

DEVELOPMENT PERMIT AND BUILDING PERMIT
FOR: Dwellings, Duplexes, Misc. Residential Const.

ADDRESS OF CONSTRUCTION 108 Farkas Lane

OWNER Diversified Development

CONTRACTOR Diversified Development

STATE LICENSE NO. 013872-A

CITY LICENSE NO. 20033

LOT(S) 17 BLOCK 1 SUBDIVISION Redrock Heights

ZONE RE-1

PROPOSED CONSTRUCTION: Single Family Dwelling / W / FP

USE: Residential

BUILDING PERMIT NO. 03841

ELECTRIC PERMIT NO.

PLUMBING PERMIT NO.

AIR COND. PERMIT NO.

ADD'L. PERMITS REQ'D.:

Air Cond. Elec. Plumbing Signs Paving Fence

Incinerators Fire Sprinkling System Off-Site Permit

MATERIALS OF CONSTRUCTION:

Wood Frame Concrete Block Reinforced Concrete Steel Frame

SQUARE FEET OF FLOOR AREAS:

1st 1297 2nd 3rd Other 420 TOTAL SQ. FT. 1717

ARCHITECT:

ENGINEER:

NO. of UNITS 1

NO. of STORIES 1 1/2

OTHER INSPECTIONS AND FEES

1. Inspections outside of normal business hours = \$25.00 per hour (minimum charge three hours).
2. Re-inspection fee during normal business hours assessed under provisions of TABLE 3-A of the Uniform Building Code = \$15.00 each.
3. Inspections during normal business hours for which no fee is specifically indicated = \$15.00 per hour (minimum charge one half hour).
4. Additional plan review required by changes, additions or revisions of approved plans = \$25.00 per hour (minimum charge two hours).

CONDITIONS OF THE PERMIT:

1. I agree to call the City Building Department for inspections before concrete is poured, before rough wiring, electrical, plumbing, framing is covered. Also for air conditioning, drywall and sheathing inspection.
2. I agree that when the job is completed that I will call for final inspection before occupancy.
3. I agree to perform all construction in accordance with City Ordinances and Building Codes.
4. The Contractor's signature below denotes authority from the owner to sign in his behalf and that the owner is aware of all requirements of this application and permit. Separate permits must be taken out for work outlined above this agreement.
5. I have read and understand the contents of this application and permit. I hereby state that the information I have supplied on this application is true and correct.

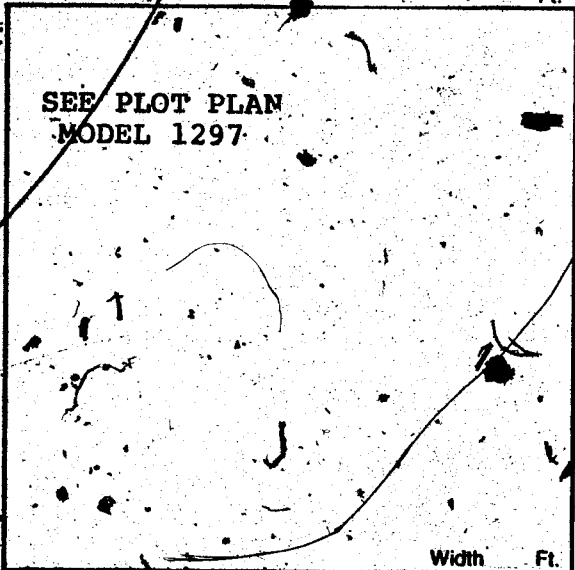

Approval for the work under this permit will be given only after refuse and debris have been removed from job site and public right of way.

SIGNED

[Signature]

CONTRACTOR

BY

[Signature]

AGENT/OWNER

LICENSE DEPT.

DATE

PLANNING DEPT.

DATE

BUILDING DEPT.

DATE

I hereby certify that I have reviewed this application and the proposed plans and have found that the proposed development meets the requirements of the City of Las Vegas Flood Hazard Reduction Ordinance for the issuance of this Development Permit.

LAND DEVELOPMENT AND FLOOD CONTROL ENGINEER

SEWER CONNECTION # 7114-3654

FIXTURES X 07/16/84

FEE 500.00

PLAN REVIEW FEE

PERMIT FEE 238.00

TOTAL FEES 738.00

RECEIPT

***0004**

SEWR 1000.00
SFD 476.00
CHEK 1476.00
0384A000 11:45

383

Permit Expires 180 Days After Abandonment of Work

MUST BE VALIDATED.

Marianne Francis 72484

CITY OF LAS VEGAS, NEVADA

LOG NO. & AREA _____ DATE July 17, 1984 CONST. VAL. \$ _____

DEPARTMENT OF BUILDING AND SAFETY
PHONE 386-6251

PLUMBING PERMIT

ADDRESS OF CONSTRUCTION 108 Farkas Lane OWNER Diversified Development

CONTRACTOR Diversified Development STATE LICENSE NO. 113872-A CITY LICENSE NO. 20033

LOT(s) 17 BLOCK 1 SUBDIVISION Redrock Heights ZONE RE-1

PROPOSED CONSTRUCTION: Single Family Dwelling / W / FP USE: Residential
PLUMBING PERMIT NO. 0477

Approval for the work under this permit will be given only after refuse and debris have been removed from job site and public right of way

UNITS	DESCRIPTION	FEE	TOTAL
PERMIT ISSUANCE			
	For Issuing Each Permit	10.00	10.00
	For Issuing Each Supplemental Permit	4.50	
FIXTURE CHARGE			
	Bathtub Shower Lavatory Toilet Urinal	2.00	8.00
	Floor Drain, Floor Sink, Wash Tray, Sink	2.00	6.00
	Garbage Disposal, Clothes Washer, Dishwasher (residential)	2.00	6.00
	Garbage Disposal (commercial)	2.00	
	Clothes Washer, Dishwasher (commercial)	2.00	
	Clothes Dryer (gas) (venting)	2.00	2.00
	Dental Unit	2.00	
	Drinking Fountain	2.00	
	Refrigerator, Ice Maker, Water Dispenser	2.00	
	Any other water using equipment, Attached Coffee Makers, Ice Makers	2.00	
	Hot Water Heater (Gas or Electric)	2.00	2.00
SEWER SYSTEM			
	New, Replacement, Modification, or Any Drainage Work	10.00	10.00
	Grease or Sand Trap or Interceptor	2.00	
	Trailer Trap (rental parks)	5.00	
WATER SOFTENERS			
	Non-Permanent Type (rental)	2.00	
	Permanent Type (connected to drain)	2.00	
SWIMMING POOLS			
	Private or Wading Pool (including spa)	20.00	
	Public or Semi-Public	30.00	
	Spas - Preformed (private)	10.00	
	Spas - Preformed (commercial)	20.00	
WATER DISTRIBUTION SYSTEM			
	Single Family Dwelling	6.00	6.00
	Multi-Family Dwelling	6.00	
	Plus Each Dwelling Unit	3.00	
	Commercial Building per floor	3.00	
	Plus Each Unit (leased space or office)	2.00	
	Hotel or Motel	8.00	
	Plus Each Unit	3.00	
	Trailer Park	30.00	
	Plus Each Space	2.00	
	Irrigation	8.00	8.00
FUEL PIPING SYSTEM			
	Single Family Dwelling	6.00	6.00
	Multi-Family Dwelling	10.00	
	Plus Each Unit	2.00	
	Commercial Building (per floor)	6.00	
	Plus Each Unit (leased space or office)	6.00	

UNITS	DESCRIPTION	FEE	TOTAL
	Medium Pressure Gas System (plan check)	12.00	
	Each Gas Appliance (any type)	2.00	
	Standby Emergency (generating engines)	5.00	
	Steam Boilers	5.00	
	Service Station Fuel Tank and Piping System	10.00	
	Fuel Tanks (ea)	10.00	
AUTOMATIC FIRE EXTINGUISHING SYSTEM			
	Underground Piping	20.00	
	Distribution Piping (per foot)	.05	
	Sprinkler Head (each)	20	
	In Range Hood and Vent	10.00	
	Dry Standpipe System		
	Piping	75.00	
	Each Outlet	2.00	
	Wet Standpipe System		
	Piping	10.00	
	Fire Hose Cabinet	2.00	
SOLAR ENERGY SYSTEMS			
	Collectors (including piping) (per collector)	5.00	
	Storage Tanks (each)	5.00	
PIPELINE CONTRACT			
	For Onsite Sewer (Gas or Water Contract Value Fee based on Building Code/Permit Valuation Chart)		
OTHER INSPECTIONS AND FEES:			
	Inspections outside of normal business hours (minimum charge— three hours)	25.00 per hour	
	Reinspection fee assessed under provisions of TABLE 3-A of the Uniform Building Code— \$15.00 EACH	15.00 each	
	Inspections for which no fee is specifically indicated (minimum charge— one-half hour)	15.00 per hour	
	Additional plan review required by changes, additions or revisions to approved plans (minimum charge— two hours)	15.00 per hour	

Plumbing permit fees may be computed the same as building permit fees by using the cost of installation for valuation amount when such work is not included in the above schedule

RECEIVED
PLBG 64.00
PLBG 64.00
CHEK 128.00
0477A000 11:11

SEWER # 7114-3654 07/19/84
CONNECTION

FIXTURES X

FEE \$64.00

PERMIT FEE

TOTAL FEES 64.00

I hereby certify that I have carefully examined and read the above application; that the same is true and correct; and that the work herein described is to be done in accordance with all the provisions of the applicable Ordinances of the City of Las Vegas, Nevada and the State laws, whether herein specified or not.
2310-2403

SIGNED [Signature] CONTRACTOR 216 MASTER CARD NO.
BY [Signature] Registered Master Plumber, Spec. Contr. of Nev.
BUILDING DEPT. 7/19/84 DATE

3/83 Permit Expires 180 Days After Abandonment of Work

MUST BE MACHINE VALIDATED

M. Anne Francis 7-24-84

CITY OF LAS VEGAS, NEVADA

LOG NO. & AREA _____ DATE 7-18-84 CONST. VAL. \$ _____

DEPARTMENT OF BUILDING AND SAFETY

ELECTRICAL PERMIT

PHONE 386-6251

ADDRESS OF CONSTRUCTION 1108 FANKAS

OWNER Diversified dev Red Rock Heights

CONTRACTOR Roma El. INC

STATE LICENSE NO. 18187

CITY LICENSE NO. C-11-09152

LOT(S) _____ BLOCK _____ SUBDIVISION _____ ZONE _____

PROPOSED CONSTRUCTION:

USE: _____

ELECTRIC PERMIT NO. 0474-2

Approval for the work under this permit will be given only after refuse and debris have been removed from job site and public right of way

UNITS	DESCRIPTION	FEE	TOTAL
PERMIT ISSUANCE			
	For Issuing Each Permit	10.00	10.00
	Supplemental Fee	4.50	14.50
APPLIANCE CHARGE			
	Receptacle Switch	.40	
	Each Light Fixture or Socket	.30	
	EACH OUTLET FOR: Dishwasher, Garbage Grinder, Trash Compactor, G.F.L., Clothes Washer, Dryer, Electric Range, Ovens, Smoke Detector, Special Purpose, Water Heater, Space Heater, Blast Coil Heater (PER KW), Mercury Lamp, Quartz Lamp, Sodium Lamp	.70	
	X-Ray Unit	10.00	
	Area Lighting (First 3,000 Watts)	8.00	
	Each Additional 1,000 Watts	3.00	
	Motors (1/2 H.P. And Over) Transformers Welders, Generators		
	First H.P. For each Unit	3.00	
	First KVA For Each Unit	3.00	
	Each Additional H.P. or KVA	.30	
	Temporary power or Pole	6.00	6.00
	Electric Service (Incl'd First Meter)	6.00	
	Up to 200 AMP		
	400 AMP And 600 AMP	12.50	
	Over 600 AMP To 1200 AMP	25.00	
	Over 1200 AMP	50.00	
	Each Additional Meter Socket	.50	
	Sub Panel (Each)	3.00	
	Swimming Pool (Residential)	20.00	
	Swimming Pool (Semi-Public)	30.00	
	Spas	8.00	
	Recreational Vehicle Spaces (Each)	3.00	
	Busways-Trolley or Plug-in (# 100 Ft.)	3.00	

UNITS	DESCRIPTION	FEE	TOTAL
	Gasoline Dispenser	2.00	
	All Misc. Electric		
	Permanent AC Unit (Pkg. Units)	3.00	
	Each Air Handler	1.00	
LOW VOLTAGE INSTALLATIONS			
	Speaker Outlets (Each)	.30	
	Signal or Alarm Outlets (Each)	.30	
	Amplifiers	2.00	
	Control Panel	.50	
	TV Master System	.30	
	Telephone or Computer Outlet	.30	
OTHER INSPECTIONS AND FEES:			
	Inspections outside of normal business hours (minimum charge - three hours)	25.00	per hour
	Reinspection fee assessed under provisions of TABLE 3-A of the Uniform Building Code = \$25.00 EACH	25.00	each
	Inspections for which no fee is specifically indicated (minimum charge - one-half hour)	15.00	per hour
	Additional plan review, required by changes, addi- tions or revisions to approved plans (minimum charge - one-half hour) After work hours - \$25.00 per hour - minimum 2 hours.	15.00	per hour
	Starter Permit		
	Contract Price or Cost of Installation		
	Misc.		
	CONDUIT ONLY		

Electrical permit fees may be computed the same as building permit fees by using the cost of installation for valuation amount when such work is not included in the above schedule.

RECEIPT

2310-2402

I hereby certify that I have carefully examined and read the above application; that the same is true and correct; and that the work herein described is to be done in accordance with all the provisions of the applicable Ordinances of the City of Las Vegas, Nevada and the State Laws, whether herein specified or not.

SIGNED *Robert Gorman* CONTRACTOR MASTER CARD NO. 131

PERMIT FEE 16.00

BY *D. Wagner* Spec. Cont'r. or Owner DATE 7-19-84

TOTAL FEES 16.00

3/83

MUST BE MACHINE VALIDATED

Permit Expires 180 Days After Abandonment of Work

Marianne Francis 8-7-84

CITY OF LAS VEGAS, NEVADA

(127)

LOG NO. & AREA _____ DATE _____ CONST. VAL. \$ _____

DEPARTMENT OF BUILDING AND SAFETY
PHONE 386-6251

ELECTRICAL PERMIT

ADDRESS OF CONSTRUCTION 108 - FARKAS

OWNER DIVERSIFIDE DIV.

CONTRACTOR Roma El Inc.

STATE LICENSE NO. 18187

CITY LICENSE NO. C11-09152

LOT(s) _____ BLOCK _____ SUBDIVISION Redrock Heights ZONE _____

PROPOSED CONSTRUCTION: _____ USE: _____

ELECTRIC PERMIT NO. 0803-1

Approval for the work under this permit will be given only after refuse and debris have been removed from job site and public right of way.

UNIT	DESCRIPTION	FEE	TOTAL
PERMIT ISSUANCE			
	For Issuing Each Permit	10.00	10.00
	Supplemental Fee	4.50	
APPLIANCE CHARGE			
43	Receptacle ✓ Switch ✓	.40	17.20
13	Each Light Fixture or Socket	.30	3.90
6	EACH OUTLET FOR: Dishwasher, Garbage Grinder, Trash Compactor, G.F.L., Clothes Washer, Dryer, Electric Range, Ovens, Smoke Detector, Special Purpose, Water Heater /Space Heater, Blast Coil Heater (PER K W), Mercury Lamp, Quartz Lamp, Sodium Lamp	.70	4.20
	X-Ray Unit	10.00	
	Area Lighting (First 3,000 Watts)	8.00	
	Each Additional 1,000 Watts	3.00	
	Motors (1/2 H.P. And Over) Transformers Welders, Generators		
	First H.P. For each Unit	3.00	
	First KVA For Each Unit	3.00	
	Each Additional H.P. or KVA	.30	
	Temporary power or Pole	6.00	
1	Electric Service (Incl'd First Meter) Up to 200 AMP	6.00	6.00
	400 AMP And 600 AMP	12.50	
	Over 600 AMP To 1200 AMP	25.00	
	Over 1200 AMP	50.00	
	Each Additional Meter Socket	.50	
	Sub Panel (Each)	3.00	
	Swimming Pool (Residential)	20.00	
	Swimming Pool (Semi-Public)	30.00	
	Spas	8.00	
	Recreational Vehicle Spaces (Each)	3.00	
	Busways-Trolley or Plug-in (Ea. 100 Ft.)	3.00	

UNITS	DESCRIPTION	FEE	TOTAL
	Gasoline Dispenser	2.00	
	All Misc. Electric		
1	Permanent A/C Unit (Pkg. Units)	3.00	3
	Each Air Handler	1.00	
LOW VOLTAGE INSTALLATIONS			
	Speaker Outlets (Each)	.30	
	Signal or Alarm Outlets (Each)	.30	
	Amplifiers	2.00	
	Control Panel	.50	
	TV Master System	.30	
3	Telephone or Computer Outlet	.30	1.90
OTHER INSPECTIONS AND FEES:			
1	Inspections outside of normal business hours (minimum charge - three hours)	25.00 per hour	
	Reinspection fee assessed under provisions of TABLE 3-A of the Uniform Building Code = \$25.00 EACH	25.00 each	
	Inspections for which no fee is specifically indicated (minimum charge - one-half hour).	15.00 per hour	
	Additional plan review required by changes, addi- tions or revisions to approved plans (minimum charge - one-half hour) After work hours - \$25.00 per hour - minimum 2 hours.	15.00 per hour	
	Start Permit		
	Contract Price or Cost of Installation		
	Misc.		
CONDUIT ONLY			

Electrical permit fees may be computed the same as building permit fees by using the cost of installation for valuation amount when such work is not included in the above schedule.

2310-2402

I hereby certify that I have carefully examined and read the above application, that the same is true and correct, and that the work herein described is to be done in accordance with all the provisions of the applicable Ordinances of the City of Las Vegas, Nevada and the State Laws, whether herein specified or not.

SIGNED Peter Gammire CONTRACTOR MASTER CARD NO. 13

BY [Signature] DATE 8/2/84

BUILDING DEPT. 383

PERMIT FEE 45.20

TOTAL FEES _____

RECEIPT

MUST BE MACHINE VALIDATED

Permit Expires 180 Days After Abandonment of Work

Dona Hooley 8-24-84

CITY OF LAS VEGAS, NEVADA

LOG NO. & AREA _____ DATE _____ CONST. VAL. \$ _____

DEPARTMENT OF BUILDING AND SAFETY
PHONE 386-6251

AIR CONDITIONING PERMIT

ADDRESS OF CONSTRUCTION *(S)* 108 Farkas Lane OWNER *Deversified Development*

CONTRACTOR *Climatic Air* STATE LICENSE NO. 019579 CITY LICENSE NO. C 11-24764

LOT(s) 17 BLOCK 1 SUBDIVISION *Red Rock Heights* ZONE: _____

PROPOSED CONSTRUCTION: *H.V.A.C.* USE: _____
AIR COND. *1298-1*
PERMIT NO. _____

Approval for the work under this permit will be given only after refuse and debris have been removed from job site and public right of way

UNITS	DESCRIPTION	FEE	TOTAL
PERMIT ISSUANCE			
1	For the issuance of each permit.	10.00	10.00
	For issuing each supplemental permit.	3.00	
UNIT FEE SCHEDULE			
	For the installation or relocation of each forced-air or gravity-type furnace or burner, including ducts and vents attached to such appliance, up to and including 100,000 Btu/h.	6.00	
	For the installation or relocation of each forced-air or gravity-type furnace or burner, including ducts and vents attached to such appliance over 100,000 Btu/h.	7.50	
	For the installation or relocation of each floor furnace, including vent.	6.00	
	For the installation or relocation of each suspended heater, recessed wall heater or floor-mounted unit heater.	6.00	
	For the installation, relocation or replacement of each appliance vent installed and not included in an appliance permit.	3.00	
	For the repair of, alteration of, or addition to each heating appliance, refrigeration unit, cooling unit, absorption unit, or each heating, cooling, absorption, or evaporative cooling system, including installation of controls regulated by this code.	6.00	
	For the installation or relocation of each boiler or compressor to and including three horsepower, or each absorption system to and including 100,000 Btu/h.	6.00	6.00
	For the installation or relocation of each boiler or compressor over three horsepower to and including 15 horsepower, or each absorption system over 100,000 Btu/h and including 500,000 Btu/h.	11.00	
	For the installation or relocation of each boiler or compressor over 15 horsepower to and including 30 horsepower, or each absorption system over 500,000 Btu/h to and including 1,000,000 Btu/h.	15.00	
	For the installation or relocation of each boiler or compressor over 30 horsepower to and including 50 horsepower, or for each absorption system over 1,000,000 Btu/h to and including 1,750,000 Btu/h.	22.50	
	For the installation or relocation of each boiler or refrigeration compressor over 50 horsepower, or each absorption system over 1,750,000 Btu/h.	37.50	

UNITS	DESCRIPTION	FEE	TOTAL
	For each air-handling unit to and including 10,000 cubic feet per minute, including ducts attached thereto. <i>Note: This fee shall not apply to an air-handling unit which is a portion of a factory-assembled appliance, cooling unit, evaporative cooler or absorption unit for which a permit is required elsewhere in this code.</i>	4.50	
	For each air-handling unit over 10,000 cfm.	7.50	
	For each evaporative cooler other than portable type.	4.50	
	For each ventilation fan	COMMERCIAL 3.00 RESIDENTIAL 1.50	3.00
	For each ventilation system which is not a portion of any heating or air-conditioning system authorized by a permit.	4.50	
	For the installation of each hood which is served by mechanical exhaust, including the ducts for such hood.	4.50	
	For each appliance or piece of equipment regulated by this code but not classed in other appliance categories, or for which no other fee is listed in this code.	4.50	
	When Chapter 22 is applicable (see Section 103), permit fees for fuel-gas piping shall be as follows: For each gas-piping system of one to four outlets. For each gas-piping system of more than four outlets, per outlet.	2.00 .50	

OTHER INSPECTIONS AND FEES:

Inspections outside of normal business hours (minimum charge — three hours)	25.00 per hour
Reinspection fee assessed under provisions of TABLE 3-A of the Uniform Building Code = \$15.00 EACH	15.00 each
Inspections for which no fee is specifically indicated (minimum charge — one-half hour)	15.00 per hour
Additional plan review required by changes, additions or revisions to approved plans (minimum charge — two hours)	30.00 per hour

Mechanical permit fees may be computed the same as building permit fees by using the cost of installation for valuation amount when such work is not included in the above schedule.

I hereby certify that I have carefully examined and read the above application; that the same is true and correct; and that the work herein described is to be done in accordance with all the provisions of the applicable Ordinances of the City of Las Vegas, Nevada and the State Laws, whether herein specified or not.

SIGNED *Wayne G. Ballard* CONTRACTOR MASTER CARD NO. _____ PERMIT FEE *19.00*

BY *P. Alfano* Spec. Const. or Owner DATE *8-23-84* TOTAL FEES _____

3/83 Permit Expires 180 Days After Abandonment of Work

RECEIPT

MUST BE MACHINE VALIDATED

Quinn Francis 11-584

OWNER Diversified Dev.		ADDRESS 108 Farkas	
DATE 7-17-84		GEN. CONT. owner	
TYPE OF STRUCTURE sfd w/tp		PERMIT No. 0384	
LEGAL DESCRIPTION 17.1; Redrock Hgts		LOG No. 153-3	
APPROVED FOR OCCUPANCY & METER			
BUILDING		MECHANICAL	
Location & Footing	BM 7-16-84	Plumbing Cont.	Diversified Dev.
Concrete Slab Floor	BM 7-18-84	Permit No.	04979 Date 7-19-84
Fireplace Footing		Htg./Vt./A.C. Cont.	Climate Air
Chimney Steel		Permit No.	1298-1 Date 8-23-84
Vent. Steel Roof		Sewer Cont.	owner
Horiz. Steel Roof		Permit No.	0384 Date 7-17-84
Framing	BM 8-31-84	Rough Soil	BM 7-18-84
Ext. Lath	BM 9-18-84	Rough Water	BM 7-16-84
Roof Sheathing	BM 8-17-84	Top-Out	JML 9-11-84
Ext. Brown	BM 8-20-84	Rough Gas	BM 8-31-84
Insulation	JML 9-11-84	A/C Rough Duct	BM 8-24-84
Drywall	BM 9-12-84	Final Plumbing	
Final Building		Final Gas	BM 10-4-84
Appr. for Occu.	BM 10-1-84	Final Air Cond.	BM 10-1-84
		Final Sewer	MM 7-25-84
ELECTRICAL		REMARKS	
Temp. Pole cont.	Roma Elec		
Permit No.	04974-2 Date 7-19-84		
Inspector	Hg 026-7 Date 7-20-84		
Electrical Cont.	Roma Elec		
Permit No.	0803-1 Date 8-2-84		
Rough	BM 8-31-84	PLEASE NOTE ADDITIONAL REMARKS ON REVERSE SIDE	
Final Electrical	BM 10-1-84	DEPT OF BLDG & SAFETY CITY OF LAS VEGAS REV 82-3-29	
Temporary Service			

Approved Francis 10-22-84

FENCE & RETAINING WALLS			
OWNER Diversified Development		DATE 10/9/84	
ADDRESS 108 Farkas			
CONTRACTOR Diversified Dev.		PERMIT NO. 2371-7	FINAL INSPECTION
LOT 17	BLOCK L	SUBDIVISION Redrock Hghts	
LOG #	AREA		
FENCES (wire, wood, block, & retaining walls)			
1	Location		
2	Footing		
3	Wall Steel		
4	1st	2nd	
5	1st	2nd	
6	Final		
Specify Type Of Fence			
2-1-33 DIV. OF BLDG. & SAFETY CITY OF LAS VEGAS REV. 10-78			

Approved Francis 10-11-84

CITY OF LAS VEGAS, NEVADA

LOG NO. & AREA _____ DATE OCTOBER 05, 1984 CONST. VAL. \$ _____

DEPARTMENT OF BUILDING AND SAFETY
PHONE 386-6251

DEVELOPMENT PERMIT AND BUILDING PERMIT
FOR: Fence, Wall, Retaining Wall

ADDRESS OF CONSTRUCTION 108 FARKAS LANE

OWNER DIVERSIFIED DEVELOPMENT

CONTRACTOR DIVERSIFIED DEVELOPMENT

STATE LICENSE NO. 013872-A

CITY LICENSE NO. 20033

LOT(s) 17 BLOCK 1 SUBDIVISION REDROCK HEIGHTS 1-D

ZONE: RE-1

PROPOSED CONSTRUCTION BLOCK WALLS

BUILDING PERMIT NO. 2371-7 ENGINEER _____

Approval for the work under this permit will be given only after refuse and debris have been removed from job site and public right of way

Remarks:

TOTAL SQUARE FEET: _____ TOTAL LINEAL FEET: _____

OTHER INSPECTIONS AND FEES

1. Inspections outside of normal business hours = \$25.00 per hour (minimum charge three hours)
2. Re-inspection fee during normal business hours assessed under provisions of TABLE 3-A of the Uniform Building Code = \$15.00 each.
3. Inspections during normal business hours for which no fee is specifically indicated = \$15.00 per hour (minimum charge one half hour).
4. Additional plan review required by changes, additions or revisions at approved plans = \$25.00 per hour (minimum charge two hours).

CONDITIONS OF THE PERMIT:

1. Any type of retaining wall must be engineered by a Civil or Structural Engineer.
2. If a Home owner takes out the Building Permit and if the owner sublets the work to a Contractor, then the Contractor must take out the permit and pay for it.
3. No fence or wall can be built on City property or rights-of-way, but this is not intended to preclude construction within utility easements if utilities will not be damaged or made inaccessible.
4. The fence or wall shall not enclose any water meter, light standard, or fire-alarm box and shall not come closer than 24" from the nearest fire hydrant outlet.
5. Department inspectors must approve footings before concrete is poured and block wall reinforcing before grouting is done.
6. Maximum height of any wall or fence is 6' side and rear yards; 4' maximum in front yard with the vertical surface above the height of 2' - 50% open.
7. I must not obstruct required onsite parking space (2 spaces for each dwelling unit) by the erection of this fence or wall.
8. By the signing of this application I herewith agree to the requirements outlined above.

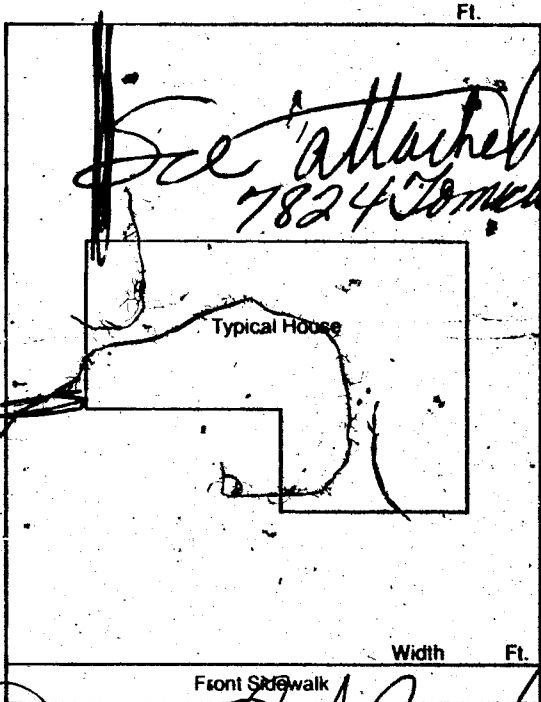

SIGNED *[Signature]* CONTRACTOR - AGENT - OWNER
 PLANNING DEPT _____ DATE 10/9/84
 BUILDING DEPT _____ DATE _____

I hereby certify that I have reviewed this application and the proposed plans and have found that the proposed development meets the requirements of the City of Las Vegas Flood Hazard Reduction Ordinance for the issuance of this Development Permit.

[Signature] 10-9-84
 LAND DEVELOPMENT AND FLOOD CONTROL ENGINEER DATE

PLAN REVIEW FEE _____
 PERMIT FEE _____
 TOTAL FEES _____

RECEIPT

MUST BE MACHINE VALIDATED