

8012 Ducharme Ave

L32 B12 Charleston Rainbow 17-D Zone R-1

Bloua Matewood 9-11-79

CITY OF LAS VEGAS, NEVADA

16-12

21-B-A4

CONST. VAL \$ 40,465.00

DEPARTMENT OF PUBLIC SERVICES
DIVISION OF BUILDING AND SAFETY

APPLICATION & BUILDING PERMIT - for:
Dwellings, Duplexes, Misc. Residential Const.

ADDRESS OF CONSTRUCTION: 8012 Ducharme Avenue OWNER: Sproul Homes of Nevada

LOT: 32 BLOCK: 12 SUBDIVISION: Charleston Rainbow 17-D ZONE: R-1

Existing structure on lot: Dwelling Accessory Bldgs. Vacant Lot Other

PROPOSED CONSTRUCTION: Single Family Dwelling W.F.P. USE: Same

MATERIALS OF CONSTRUCTION: Wood Frame Concrete Block Reinforced Concrete Steel Frame

SQUARE FEET OF FLOOR AREAS: 1st 1394 - 2nd 480 - 3rd 122 - Other 122 TOTAL SQ. FT. 1996

FIRE ZONE: 3 Occupancy Group R-3 CONST. TYPE: V-N

ARCHITECT: ENGINEER: NO. of UNITS: 1 NO. of STORIES: 1

Plans Submitted: Yes No Calculations Submitted: Yes No Sewer Fee Req'd: Yes No

CONTRACTOR: Sproul Homes of Nevada STATE LICENSE # 6011B CITY LICENSE # 6427

ADD'L. PERMITS REQ'D.: Air Cond. Elec. Plumbing Signs Paving Fence Public Walks Curb-gutters
Incinerators Fire Sprinkling System

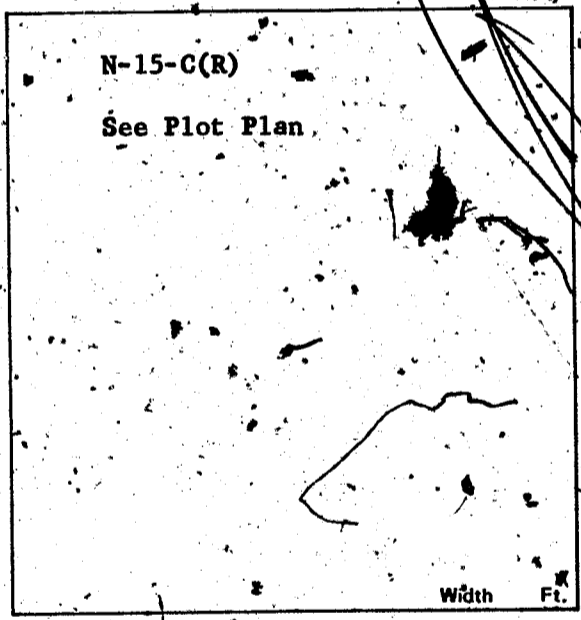

CONDITIONS OF THE PERMIT:

1. I agree to call the City Building Department for inspections before concrete is poured, before rough wiring, electrical, plumbing, framing is covered. Also for Air conditioning, drywall and sheathing inspection.
2. I agree that when the job is completed that I will call for final inspection before occupancy.
3. I agree to perform all construction in accordance with City Ordinances and Building Code.
4. The Contractor's signature below denotes authority from the owner to sign in his behalf and that the owner is aware of all requirements of this application and permit. Separate permits must be taken out for work outlined above this agreement.
5. I have read and understand the contents of this application and permit; hereby state that the information I have supplied on this application is true and correct.

Approval for the work under this permit will be given only after refuse and debris have been removed from job site and public right of way.

SIGNED: Sproul Homes of Nevada Contractor
BY: [Signature] Agent or Owner

PLANNING DEPT.: [Signature] Date: 8-17-79

PUBLIC WORKS DEPT.: Kent North Date: 8-17-79

BUILDING DIVISION: [Signature] Date: 8-24-79

PERMIT NO.: 6697-17 PERMIT FEE \$ 162.00

RECEIPT

MUST BE MACHINE VALIDATED

L. Gatewood 9-12-79

CITY OF LAS VEGAS, NEVADA

32-12

**DEPARTMENT OF PUBLIC SERVICES—APPLICATION AND PERMIT FOR PLUMBING
DIVISION OF BUILDING AND SAFETY**

ADDRESS OF CONSTRUCTION: *8012 DUCHARME AVE* OWNER'S NAME: *(SPROU) HOTMES INC*

CIRCLE: New Bldg. Add'n.; Remodel; TYPE OF BLDG: SFD ART. PUBLIC COMM.

CONTRACTOR'S NAME: *UNITED PLM BGC* STATE LICENSE # *1295* CITY LICENSE # *904*

UNITS	DESCRIPTION	FEE	TOTAL
1	Bathtub	1.00	1.00
	Shower	1.00	1.00
2	Lavatory	1.00	2.00
2	Toilet	1.00	2.00
	Urinal	1.00	
	Floor Drain	1.00	
	Floor Sink	1.00	
	Wash Tray	1.00	
1	Sink	1.00	1.00
	Garbage Disposal	1.00	
	Garbage Disposal (comm.)	3.00	
	Clothes Dryer (gas)	1.00	
1	Clothes Washer	1.00	1.00
	Glothes Washer (comm.)	5.00	
	Dishwasher	1.00	
	Dishwasher (commercial)	5.00	
	Dental Unit	10.00	
	Drinking Fountain	1.00	
	Any Water using Equipment	1.00	
1	Water Heater (gas) (elect.)	1.00	1.00
1	Sewer System—New, Replacement or any Drainage System	4.00	4.00
	Grease or Sand Trap	2.00	
	Trailer Trap	2.00	
	Septic Disposal System	4.00	
WATER SOFTENERS			
	Nonpermanent Type	4.00	
	Permanent Type (connected to Drainage)	5.00	
SWIMMING POOLS			
	Private or Wading Pool	10.00	
	Public or Semi-public	20.00	

UNITS	DESCRIPTION	FEE	TOTAL
WATER DISTRIBUTION SYSTEM			
1	Single Family Dwelling	4.00	4.00
	Multiple Family Dwelling plus each unit	4.00 2.00	
	Commercial Bldg. per floor	6.00	
	Hotel or Motel plus each bath	4.00 1.50	
	Trailer Park plus each space	20.00 1.00	
	Irrigation	4.00	
GAS PIPING SYSTEM			
1	Single Family Dwelling	3.00	3.00
	Multiple Family Dwelling plus each unit	6.00 1.00	
	Commercial Bldg. per floor plus each unit	3.00 3.00	
	Gas Appliance (any type)	1.00	
AUTOMATIC FIRE EXTINGUISHING SYSTEM			
	Underground Piping	10.00	
	Distribution Piping ea. ft.	.01	
	Sprinkler Head each	.10	
	In Range Hood and Vent	5.00	
DRY STANDPIPE SYSTEM			
	Piping	50.00	
	Each Outlet	1.00	
WET STANDPIPE SYSTEM			
	Piping	5.00	
	Fire Hose Cabinet	1.00	
	MINIMUM PERMIT FEE	4.00	
PIPELINE CONTRACTOR SECT. 14-B.P.F. \$			
TOTAL PERMIT FEE \$ 207			

I hereby certify that I have carefully examined and read the above application; that the same is true and correct; and that the work herein described is to be done in accordance with all the provisions of the applicable Ordinances of the City of Las Vegas, Nevada and the State Laws, whether herein specified or not.

Approval for the work under this permit will be given only after refuse and debris have been removed from job site and public right of way.

Signed: *Thomas* Date: *9-14-79*
Registered Master Plumber, Spec. Cont' or Owner

Building Division: *M.S.* Date: *9/14/79*
6933-36

Permit No. *6933-36* Permit Fee \$ *207*

154-01-222

RECEIPT

MUST BE MACHINE VALIDATED

G. Gatewood 9-25-79

CITY OF LAS VEGAS, NEVADA

DEPARTMENT OF PUBLIC SERVICES - ELECTRICAL APPLICATION & PERMIT DIVISION OF BUILDING AND SAFETY

ADDRESS OF CONSTRUCTION: 8012 Ducharme OWNER'S NAME: Sprout Homes

CIRCLE: New Bldg. Add'n.; Remodel; TYPE OF BLDG.: SFD. APT. PUBLIC COMM.

CONTRACTOR'S NAME: Roberts Electric Company STATE LICENSE #: 4528 CITY LICENSE #: 3392

NUMBER	FIXTURE OR INSTALLATION	UNIT PRICE	TOTAL
	Rm addition, carport or garage enclosure	4.00	
	Temporary power	4.00	
67	Light, receptacle or switch outlet	.20	13.40
	Wall or ceiling space heater	.35	
	Garbage grinder outlet	.35	.35
	Dishwasher outlet	.35	
	Clothes dryer outlet	.35	
	Automatic clothes washer	.35	.35
	Electric range outlet	.35	.35
	Electric water heater outlet	.85	
	Special purpose outlet	.35	
	X-ray unit and its appurtenances	5.00	
	Watts of festoon lighting (Watts) First 3,000 watts for each additional thousand watts	4.00 4.50	
	Horsepower each motor first horsepower or less for each additional horsepower	1.75 .35	
	Electric service (including any single meter socket) for each additional socket	3.00 .35	3.00
	Air conditioning service	1.50	1.50
	Each KW(KVA) Generator (Transformer, Welder) First 100 KVA for each additional KW(KVA)	2.00 .01	
	Speaker, signal or alarm outlet	.15	
	Amplifiers	.50	
	Control panels	.25	
	Main control racks	1.00	
	T.V. and radio antennas-master system only	.75	
	Minimum fee for any permit	4.00	
	TOTAL FEE		18.95

Approval for the work under this permit will be given only after refuse and debris have been removed from job site and public right of way.

I hereby certify that I have carefully examined and read the above application; that the same is true and correct; and that the work herein described is to be done in accordance with all the provisions of the applicable Ordinances of the City of Las Vegas, Nevada and State laws whether herein specified or not.

SIGNED: G. D. Waugh DATE: 9-17-79
 MASTER (ELECTRICIAN) (TECHNICIAN) (OWNER)

BUILDING DIVISION: M.S. DATE: 9/20/79

PERMIT NO.: 7110-36 PERMIT FEE: \$ 18.95

RECEIPT

MUST BE MACHINE VALIDATED

OWNER <i>Sproul Homes of Nev</i> ADDRESS <i>8012 Ducharme</i>	
DATE <i>9-4-79</i>	GEN. CONT. <i>Same</i>
<i>SFD W/FP</i>	6697-17
TYPE OF STRUCTURE	PERMIT NO. FINAL INSPECTION
<i>K-32 b-12 Char Rainbow 17-D</i>	
LEGAL DESCRIPTION	LOG # AREA #
APPROVED FOR OCCUPANCY & METER <i>T21-8-A4</i>	
BUILDING	MECHANICAL
Investigation	Plumbing Cont. <i>limited</i>
Location & Footing <i>T.R. 9/2/79</i>	Permit No. <i>6933-36</i> Date <i>9-14-79</i>
Concrete Slab Floor <i>TR 10-4-79</i>	Heat & Vent. A/C Cont. <i>None</i>
Footings <i>TR 10-4-79</i>	Permit No. <i>7286-36</i> Date <i>9-27-79</i>
Chimney Steel.	Sewer Cont. <i>Sproul Homes</i>
Vert. Steel Reinf.	Permit No. <i>6698</i> Date <i>9-4-79</i>
Horiz. Steel Reinf.	Rough Soil <i>M.M.C. 9-28-79</i>
Framing <i>TR 10-30-79</i>	Rough Water <i>M.M.C. 9-28-79</i>
Ext. Lath	Top Out <i>M.M.C. 10-30-79</i>
Ext. Brown	Rough Gas <i>M.M.C. 10-30-79</i>
Drywall	A/C Rough Duct <i>M.M.C. 10-30-79</i>
Final Building <i>BA 12-12-79</i>	Final Plumbing <i>M.M.C. 11-30-79</i>
Appr. for Occu.	Final Gas <i>M.M.C. 11-30-79</i>
ELECTRICAL	Final Air Cond. <i>M.M.C. 11-30-79</i>
Temp. Pole Cont.	Final Sewer
Permit No. Date	REMARKS
Inspection Date	
Electrical Cont. <i>Robert</i>	
Permit No. <i>7112-36</i> Date <i>9-20-79</i>	
Rough	PLEASE NOTE ADDITIONAL REMARKS ON REVERSE SIDE.
Final Rough <i>MCK 10-25-79</i>	DIV. OF BLDG. & SAFETY
Final Electrical <i>MCK 12-5-79</i>	CITY OF LAS VEGAS
Temporary Service	REV. 10-78
	79-3-16

Item wall TR 9-25-79
Roof Shelling TR 10-26-79
Insulation TR 11-2-79