

856 Dusk

LOT 57 BLK 2 LEWIS HOMES LAS VEGAS #12 ZONE R-1

Sharon Perence March 14, 1979

CITY OF LAS VEGAS, NEVADA

LOG NO. & AREA: 14-01 T-32-2

CONST. VAL. \$ 35362

DEPARTMENT OF PUBLIC SERVICES
DIVISION OF BUILDING AND SAFETY

APPLICATION & BUILDING PERMIT - for:
Dwellings, Duplexed, Misc. Residential Const.

ADDRESS OF CONSTRUCTION: 856 Dusk Drive

OWNER: Lewis Homes of Nevada

LOT(S) 57 BLOCK 2 SUBDIVISION Lewis Homes - Las Vegas No. 12 ZONE R-1

Existing structure on lot: Dwelling Accessory Bldgs Vacant Lot Other

PROPOSED CONSTRUCTION: Single-Family Residence USE: Residence

MATERIALS OF CONSTRUCTION: Wood Frame Concrete Block Reinforced Concrete Steel Frame

SQUARE FEET OF FLOOR AREAS: 1st 1579 2nd 477 3rd Other 477 TOTAL SQ. FT. 1990

FIRE ZONE: 3 Occupancy Group R3+M1 CONST. TYPE: VN

ARCHITECT: ENGINEER: VIN NO. OF UNITS 1 NO. OF STORIES 1

Plans Submitted: Yes No Calculations Submitted: Yes No Sewer Fee Req'd: Yes No

CONTRACTOR: Lewis Homes of Nevada STATE LICENSE # 13046A CITY LICENSE # 8707

ADD'L. PERMITS REQ'D: Air Cond. Elec. Plumbing Signs Paving Fence Public Walks Curb gutters
Incinerators Fire Sprinkling System

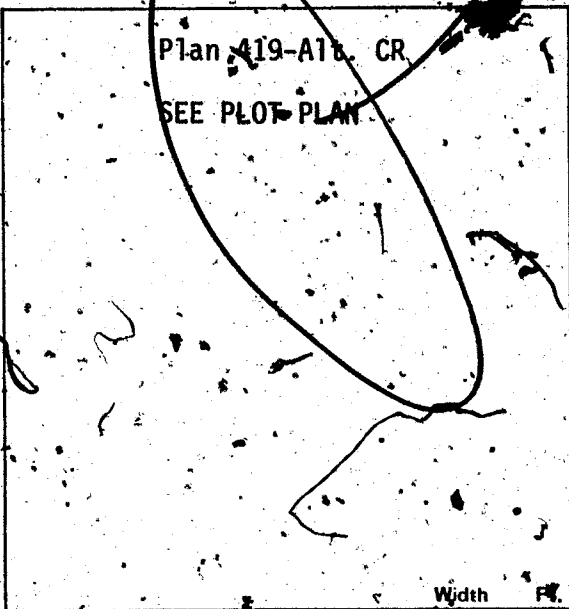

CONDITIONS OF THE PERMIT:

- I agree to call the City Building Department for inspections before concrete is poured, before rough wiring, electrical, plumbing, framing is covered. Also for Air conditioning, drywall and sheathing inspection.
- I agree that when the job is completed that I will call for final inspection before occupancy.
- I agree to perform all construction in accordance with City Ordinances and Building Codes.
- The Contractor's signature below denotes authority from the owner to sign in his behalf and that the owner is aware of all requirements of this application and permit. Separate permits must be taken out for work outlined above this agreement.
- I have read and understand the contents of this application and permit. I hereby state that the information I have supplied on this application is true and correct.

Approval for the work under this permit will be given only after refuse and debris have been removed from job site and public right of way.

SIGNED: Lewis Homes of Nevada Contractor

BY: Carl W. Monson Agent or Owner

PLANNING DEPT: [Signature] Date: 10/11/78

PUBLIC WORKS DEPT: Charles [Signature] Date: 10/11/78

BUILDING DIVISION: WR 7 Date: 10/12/78

PERMIT NO.: 10377-3 PERMIT FEE \$ 151.00

154-01-220

RECEIPT

MUST BE MACHINE VALIDATED

Sharon Perera March 14, 1979

CITY OF LAS VEGAS, NEVADA

DEPARTMENT OF PUBLIC SERVICES - APPLICATION AND PERMIT FOR PLUMBING
DIVISION OF BUILDING AND SAFETY

ADDRESS OF CONSTRUCTION: **856 DUSK DR.**

OWNER'S NAME: **LEWIS HOMES**

CIRCLE: New Bldg.; Add'n.; Remodel; TYPE OF BLDG.: SFD. APT. PUBLIC COMM.

CONTRACTOR'S NAME: **CARDINAL PLBG.**

STATE LICENSE # **10848A** CITY LICENSE # **05575**

UNITS	DESCRIPTION	FEE	TOTAL
1	Bathtub	1.00	
1	Shower	1.00	
2	Lavatory	1.00	
2	Toilet	1.00	
	Urinal	1.00	
	Floor Drain	1.00	
	Floor Sink	1.00	
	Wash Tray	1.00	
	Sink	1.00	
	Garbage Disposal	1.00	
	Garbage Disposal (comm.)	3.00	
	Clothes Dryer (gas)	4.00	
	Clothes Washer	1.00	
	Clothes Washer (comm.)	5.00	
1	Dishwasher	1.00	
	Dishwasher (commercial)	5.00	
	Dental Unit	10.00	
	Drinking Fountain	1.00	
	Any Water-using Equipment	1.00	
1	Water Heater (gas) (elect.)	1.00	
	Sewer System - New, Replacement, or any Drainage System	4.00	
	Grease or Sand Trap	2.00	
	Trailer Trap	2.00	
	Septic Disposal System	4.00	
WATER SOFTENERS			
	Nonpermanent Type	4.00	
	Permanent Type (connected to Drainage)	5.00	
SWIMMING POOLS			
	Private or Wading Pool	10.00	
	Public or Semi-public	20.00	

UNITS	DESCRIPTION	FEE	TOTAL
WATER DISTRIBUTION SYSTEM			
1	Single Family Dwelling	4.00	
	Multiple Family Dwelling plus each unit	4.00	
	Commercial Bldg. per floor	2.00	
	Hotel or Motel plus each bath	6.00	
	4.00	1.50	
	Trailer Park plus each space	20.00	
	Irrigation	1.00	
		4.00	
GAS PIPING SYSTEM			
	Single Family Dwelling	3.00	
	Multiple Family Dwelling plus each unit	6.00	
	Commercial Bldg. per floor plus each unit	1.00	
	3.00	3.00	
	Gas Appliance (any type)	1.00	
AUTOMATIC FIRE EXTINGUISHING SYSTEM			
	Underground Piping	10.00	
	Distribution Piping ea. ft.	.01	
	Sprinkler Head each	.10	
	In Range Hood and Vent	5.00	
DRY STANDPIPE SYSTEM			
	Piping	50.00	
	Each Outlet	1.00	
WET STANDPIPE SYSTEM			
	Piping	5.00	
	Fire Hose Cabinet	1.00	
	MINIMUM PERMIT FEE	4.00	
PIPELINE CONTRACTOR, SECT. 14-B.P.F. S			22.00
TOTAL PERMIT FEE \$			

I hereby certify that I have carefully examined and read the above application; that the same is true and correct; and that the work herein described shall be done in accordance with all the provisions of the applicable Ordinances of the City of Las Vegas, Nevada and the State Laws, whether herein specified or not.

Approval for the work under this permit will be given only after refuse and debris have been removed from job site and public right of way.

Signed: *Thomas P. Elgar* Date: *11-21-78*
Registered Master Plumber, Spec. Contractor/Owner

Building Division: *M.S.* Date: *4/22/78*

Permit No. *11094-14* Permit Fee \$ *22.00*

154-01-222

RECEIPT

MUST BE MACHINE VALIDATED

Sharon Perena March 14, 1979

CITY OF LAS VEGAS, NEVADA

DEPARTMENT OF PUBLIC SERVICES - ELECTRICAL APPLICATION & PERMIT DIVISION OF BUILDING AND SAFETY

ADDRESS OF CONSTRUCTION: 856 Duah Drive, Las Vegas, Nevada. OWNER'S NAME: Lewis Homes of Nevada

CIRCLE: Las Vegas No. 12 TYPE OF BLDG.: SFD. APT. PUBLIC COMM. L - 57 Blk. No. 2.

CONTRACTOR'S NAME: Sparks Electric Co., Inc. STATE LICENSE # 5101 A CITY LICENSE # 04851

NUMBER	FIXTURE OR INSTALLATION	UNIT PRICE	TOTAL
	Rm addition, carport or garage enclosure	4.00	
	Temporary power	4.00	
69	Light, receptacle or switch outlet	.20	13.80
	Wall or ceiling space heater	.35	
1	Garbage grinder outlet	.35	.35
	Dishwasher outlet	.35	.35
1	Clothes dryer outlet	.35	.35
1	Automatic clothes washer	.35	.35
	Electric range outlet	.35	
	Electric water heater outlet	.35	
	Special purpose outlet	.35	
	X-ray unit and its appurtenances	5.00	
	Watts of festoon lighting (Watts) First 3,000 watts for each additional thousand watts	4.00 1.50	
	Horsepower each motor first horsepower or less for each additional horsepower	1.75 .35	
1	Electric service (including any single meter socket) for each additional socket	3.00	3.00
		.35	
1	Air conditioning service	1.50	1.50
	Each KW(KVA) Generator (Transformer, Welder) First 100 KVA for each additional KW(KVA)	2.00 .01	
	Speaker, signal or alarm outlet	.15	
	Amplifiers	.50	
	Control panels	.25	
	Main control racks	1.00	
	T.V. and radio antennas-master system only	.75	
	Minimum fee for any permit	4.00	
	TOTAL FEE		19.70

Approval for the work under this permit will be given only after refuse and debris have been removed from job site and public right of way.

I hereby certify that I have carefully examined and read the above application; that the same is true and correct; and that the work herein described is to be done in accordance with all the provisions of the applicable Ordinances of the City of Las Vegas, Nevada and State laws whether herein specified or not.

SIGNED Don C. Sparks DATE _____
 MASTER (ELECTRICIAN) (TECHNICIAN) (OWNER)

BUILDING DIVISION: M.S. DATE 1/23/79

PERMIT NO.: 0454-14 PERMIT FEE: \$ 17.90

RECEIPT

MUST BE MACHINE VALIDATED

Sharon Pereira March 14, 1979

CITY OF LAS VEGAS, NEVADA

DEPARTMENT OF PUBLIC SERVICES - AIR CONDITIONING APPLICATION & PERMIT
DIVISION OF BUILDING AND SAFETY

ADDRESS OF CONSTRUCTION: **LOT 57** 856 **Dawn Drive** OWNER'S NAME: **Lewis Homes of Nevada**

CIRCLE: Addition; Remodel; New Bldg; TYPE OF BLDG.: **SED. APT. COMM. PUBLIC**

CONTRACTOR'S NAME: **AIRECO** STATE LICENSE # **14196** CITY LICENSE # **C-11-15450**

UNITS	DESCRIPTION	FEE	TOTAL	UNITS	DESCRIPTION	FEE	TOTAL
	Unit heater - floor, wall or suspended	4.00		EVAPORATIVE COOLERS:			
FOR EACH FORCED-AIR OR GRAVITY-TYPE FURNACE OR BURNER INCLUDING DUCTS AND VENT ATTACHED TO SUCH APPLIANCES:					5 outlets or under	3.00	
	Up to and including 100,000 B.t.u.'s	4.00			Over 5 and up to and including 10	5.00	
	Over 100,000 B.t.u.'s	6.00			Each additional outlet over 10	.25	
FOR EACH HEATING APPLICATION, REFRIGERATION UNIT, COMFORT COOLING AND HEATING UNIT, ABSORPTION UNIT, COMPRESSOR OR BOILER:				VENTILATION:			
	Up to and including 3 ton or horsepower, or absorption system up to and including 100,000 B.t.u.'s	4.00			For each fan connected to a single duct	1.00	
4-T	Over 3 ton or 3 horsepower up to and including 10, or absorption system over 100,000 B.t.u.'s up to and including 250,000 B.t.u.'s	7.00	7.00		For each commercial or industrial ventilation system	5.00	
	Over 10 ton or 10 horsepower up to and including 30, or absorption system over 250,000 B.t.u.'s up to and including 1,000,000 B.t.u.'s	12.00			For each commercial kitchen hood	5.00	
	Over 30 ton or 30 horsepower up to and including 50, or absorption system over 1,000,000 B.t.u.'s up to and including 1,700,000 B.t.u.'s	20.00		MISCELLANEOUS:			
	Over 50 ton or 50 horsepower, or absorption system over 1,700,000 B.t.u.'s	30.00			For each water cooling tower	8.00	
FOR EACH AIR HANDLING UNIT INCLUDING DUCTS ATTACHED THERETO:				10	Duct work only - each opening	.25	2.50
	Up to and including 10,000 CFM	2.00			For installation or relocation of each commercial or industrial incinerator	15.00	
	Over 10,000 CFM	4.00			Gas piping related to the air cond. work in single family dwelling only.	3.00	
					For each appliance, piece of equipment, any mechanical work or alteration or replacement not included in this schedule, the permit fee shall be computed the same as building permit fees by using the cost of installation for the valuation amount.		
						FOR THE ISSUANCE OF EACH PERMIT	3.00
						TOTAL PERMIT FEE \$	12.50

I hereby certify that I have carefully examined and read the above application; that the same is true and correct; and that the work herein described is to be done in accordance with all the provisions of the applicable Ordinances of the City of Las Vegas, Nevada and the State Laws, whether herein specified or not.

Approval for the work under this permit will be given only after refuse and debris have been removed from job site and public right of way.

SIGNED *Fran Callaway* Date October 18, 1978
Air Conditioning Contractor - Owner

BUILDING DIVISION *BD* Date 2-1-79

PERMIT NO. 0714-7 PERMIT FEE \$ 12.50

154-01-224

RECEIPT

MUST BE MACHINE VALIDATED

Sharon Terera April 16, 1979

CITY OF LAS VEGAS, NEVADA

LOG NO. & AREA

CONST. VAL. \$ 525-

DEPARTMENT OF PUBLIC SERVICES
DIVISION OF BUILDING & SAFETY

APPLICATION & BUILDING PERMIT for:
Fence, Wall, Retaining Wall.

ADDRESS OF CONSTRUCTION: 856 Dusk Dr

OWNER: Lewis Homes

LOT(s) 57 BLOCK 2 SUBDIVISION Lewis Homes LAS Vegas 12

ZONE R-1

Materials of Construction: Block Concrete Wire Wood Other

PLANS: Yes No

ARCHITECT:

ENGINEER:

CALCS: Yes No

CONTRACTOR: Franklin + McPherson

STATE LICENSE # 6626 B

CITY LICENSE # C11 10129

TOTAL SQUARE FEET:

TOTAL LINEAL FEET: 35

Remarks:
35' x 6' Block

CONDITIONS OF THE PERMIT:

1. Any type of retaining wall must be engineered by a Civil or Structural Engineer.
2. If a home owner takes out the Building Permit and if the owner sublets the work to a Contractor, then the Contractor must take out the permit and pay for it.
3. No fence or wall can be built on City property or rights-of-way, but this is not intended to preclude construction within utility easements if utilities will not be damaged or made inaccessible.
4. The fence or wall shall not enclose any water meter, light stand, or fire alarm box and shall not come closer than 24" from the nearest fire hydrant outlet.
5. Department Inspectors must approve footings before concrete is poured and block wall reinforcing before grouting is done.
6. Maximum height of any wall or fence is 6' side and rear yards; 4' maximum in front yard with the vertical surface above the height of 2' - 50% open.
7. I must not obstruct required onsite parking space (2 spaces for each dwelling unit) by the erection of this fence or wall.
8. By the signing of this application I herewith agree to the requirements outlined above.

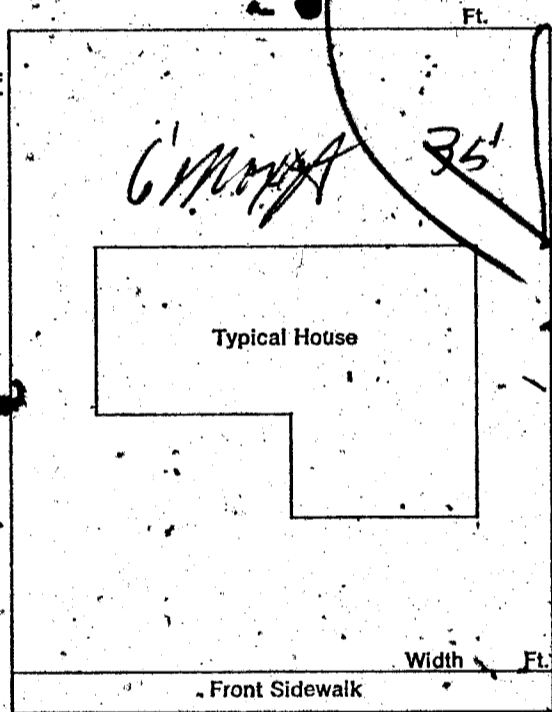

DUSK

SIGNED:

Brian Jones

DATE:

4/10/79

CONTRACTOR

AGENT

OWNER

PLANNING DEPT:

Date:

4-10-79

PUBLIC WORKS DEPT:

Date:

4-10-79

BUILDING DIVISION:

Date:

4-10-79

#12850

PERMIT NO:

2896-7

PERMIT FEE \$

800

RECEIPT

MUST BE MACHINE VALIDATED

W. Gatewood November 26, 1979

CITY OF LAS VEGAS, NEVADA

LOG NO. & AREA _____ CONST. VAL. \$ 2100.00
DEPARTMENT OF PUBLIC SERVICES APPLICATION & BUILDING PERMIT - for:
DIVISION OF BUILDING & SAFETY Fence, Wall, Retaining Wall.

ADDRESS OF CONSTRUCTION: 856 Dusk Dr. OWNER: Robinson

LOT(s): 57 BLOCK 2 SUBDIVISION Lewis Homes Las Vegas Unit # 12 ZONE: R-1

Materials of Construction: Block Concrete Wire Wood Other
ARCHITECT: _____ ENGINEER: _____ PLANS: Yes No
CALCS: Yes No

CONTRACTOR: Quines STATE LICENSE # _____ CITY LICENSE # _____

TOTAL SQUARE FEET: 840 TOTAL LINEAL FEET: 140

Remarks:

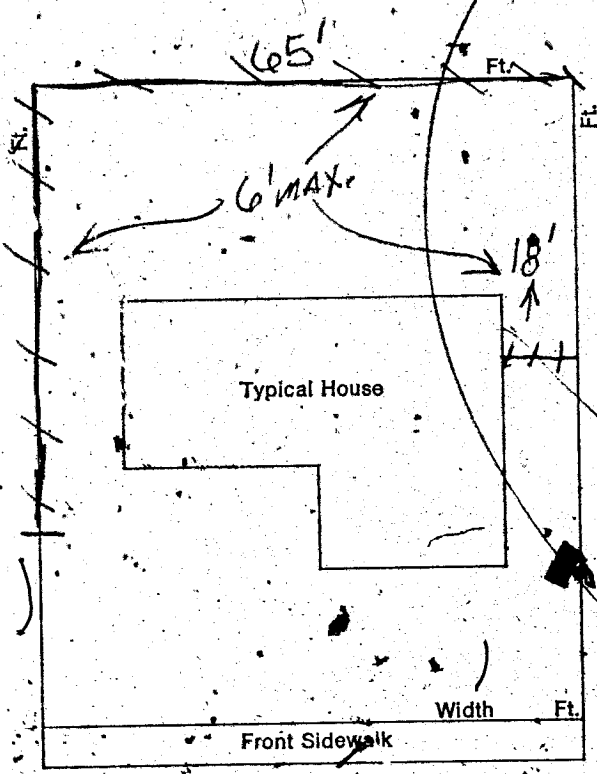

CONDITIONS OF THE PERMIT:

1. Any type of retaining wall must be engineered by a Civil or Structural Engineer.
2. If a home owner takes out the Building Permit and if the owner sublets the work to a Contractor, then the Contractor must take out the permit and pay for it.
3. No fence or wall can be built on City property or rights-of-way, but this is not intended to preclude construction within utility easements if utilities will not be damaged or made inaccessible.
4. The fence or wall shall not enclose any water meter, light standard, or fire alarm box and shall not come closer than 24" from the nearest fire hydrant outlet.
5. Department Inspectors must approve footings before concrete is poured and block wall reinforcing before grouting is done.
6. Maximum height of any wall or fence is 6', side and rear yards; 4' maximum in front yard with the vertical surface above the height of 2' - 50% open.
7. Must not obstruct required onsite parking space (2 spaces for each dwelling unit) by the erection of this fence or wall.
8. By the signing of this application I herewith agree to the requirements outlined above.

PLUMB \$.00
 WALL \$ 18.00
 STL \$ 18.00
 TOTL \$ 18.00
 DATE: _____
 PRIN \$ 18.00

SIGNED: [Signature]
CONTRACTOR AGENT

PLANNING DEPT: _____ Date: 15 Nov 79
 PUBLIC WORKS DEPT: _____ Date: _____
 BUILDING DIVISION: _____ Date: 11/15/79
 #12850 PERMIT NO.: 8336 PERMIT FEE \$ 18.00

#8336 SR#001/01
 RECEIPT
 CITY - LAS VEGAS
 BLDG. & SAFETY
 11/15/79

MUST BE MACHINE VALIDATED

OWNER <u>Lewis Homes of Nev</u> ADDRESS <u>856 Duisk Drive</u>	
DATE <u>10-23-78</u>	GEN. CONT. <u>same</u>
TYPE OF STRUCTURE <u>SFD</u>	PERMIT NO. <u>10377-3</u> FINAL INSPECTION
LEGAL DESCRIPTION <u>L57 B2</u>	LOG # <u>T32-2</u> AREA #
APPROVED FOR OCCUPANCY & METER <u>Lewis Homes Las Vegas No 12</u>	
BUILDING	MECHANICAL
Investigation	Plumbing Cont. <u>Cardinal Rly</u>
Location & Footing <u>DB 11-10-78</u>	Permit No. <u>11014-14</u> Date <u>11-22-78</u>
<u>Site Work EC 12-3-78</u>	Heat & Vent. A/C Cont. <u>Dirco</u>
Concrete Slab Floor <u>EC 12-26-78</u>	Permit No. <u>0714-7</u> Date <u>2-1-79</u>
Fireplace Footing	Sewer Cont. <u>Lewis Homes of Nev</u>
Chimney Steel	Permit No. <u>10377</u> Date
Vert. Steel Reinf.	Rough Soil <u>JL 12-19-78</u>
Horiz. Steel Reinf.	Rough Water
Roof Sheathing <u>EC 2-7-79</u>	Top Out <u>JC 3-23-79</u>
Framing <u>AC 2-22-79</u>	Rough Gas <u>JC 3-23-79</u>
Ext. Lath <u>EC 3-7-79</u>	A/C Rough Duct <u>JC 3-1-79</u>
Ext. Brown <u>EC 4-23-79</u>	Final Plumbing <u>JH 6-25-79</u>
Drywall <u>EC 3-26-79</u>	Final Gas <u>JL 6-27-79</u>
Final Building <u>EC 5-12-79</u>	Final Air Cond. <u>JH 6-25-79</u>
Appr. for Occu.	Final Sewer <u>JL 12-29-78</u>
ELECTRICAL	REMARKS
Temp. Pole Cont.	
Permit No. Date	
Inspection Date	
Electrical Cont. <u>Spehr</u>	
Permit No. <u>04544</u> Date <u>11-23-79</u>	
Rough <u>RP 3-7-79</u>	PLEASE NOTE ADDITIONAL REMARKS ON REVERSE SIDE.
Final Rough	DIV OF BLDG & SAFETY
Final Electrical <u>RPE 13-79</u>	CITY OF LAS VEGAS
Temporary Service	REV 10-78
	79-3-16

CONTRACTOR		
Franklin & McQuinn 3894-7		
PERMITS		
Block #11		
BLOCK		SUBDIVISION
2 Lower Homes E.V. #12		
AREA		
FENCES (wire, wood, block, & retaining walls)		
Erection		
EC 11/30/79		
Posting		
EC 11/22/79		
Wall Sides		
1st		
2nd		
Final		
Final		
Specify Type Of Fence		

FENCE & BRICKWORK		
Rollout	11-16-79	0418
885 East St.		
CONTRACTOR	PERMIT NO.	FINAL INSPECTION
Owner	0336	Brk wall
	BLOCK	SUBDIVISION
	2 Lewis Homes S.V unit #38	
AREA		
FENCES (masonry, wood, block, & retaining walls)		
Division		
Testing	MAY 16-79	
Wall Seal	6-11-79	
1st		
2nd		
3rd		
Final	MAY 31-79	
Specify Type Of Fence		