

2201 Dune Drive

SEE APPLICATION FOR LEGAL

Sharon B... March 14, 1979

CITY OF LAS VEGAS, NEVADA

LOG NO. & AREA

CONST. VAL. \$ 969 609 00

DEPARTMENT OF BUILDING & SAFETY

APPLICATION & BUILDING PERMIT - for: Dwellings, Duplexes, Misc. Residential Const.

ADDRESS OF CONSTRUCTION: 2201 Blue Dr

OWNER: H.G. Black

LOT(s): 10

BLOCK 3

SUBDIVISION: TWIN LAKES VILLAGE UNIT #6

ZONE: R-1

Existing structure on lot: Dwelling Accessory bldgs. Vacant lot Other

PROPOSED CONSTRUCTION: IMPROVING CURB

USE: Dwelling + Family Room

MATERIALS OF CONSTRUCTION: Wood Frame Concrete Block Reinforced Concrete Steel Frame

SQUARE FEET OF FLOOR AREAS: 1st 2nd 3rd Other TOTAL SQ. FT.

FIRE ZONE: 1 2 3 Occupancy Group A B C D E F G H I J-1-2-3-4-5 CONST. TYPE: I II III IV V

ARCHITECT: ENGINEER: NO. of UNITS NO. of STORIES

Plans Submitted: Yes No Calculations Submitted: Yes No Sewer Fee Req'd: Yes No

CONTRACTOR: OWNER STATE LICENSE # CITY LICENSE #

ADD'L. PERMITS REQ'D: Air Cond. Elec. Plumbing Signs Paving Fence Public Walks Curb-gutters Incinerators Fire Sprinkling System

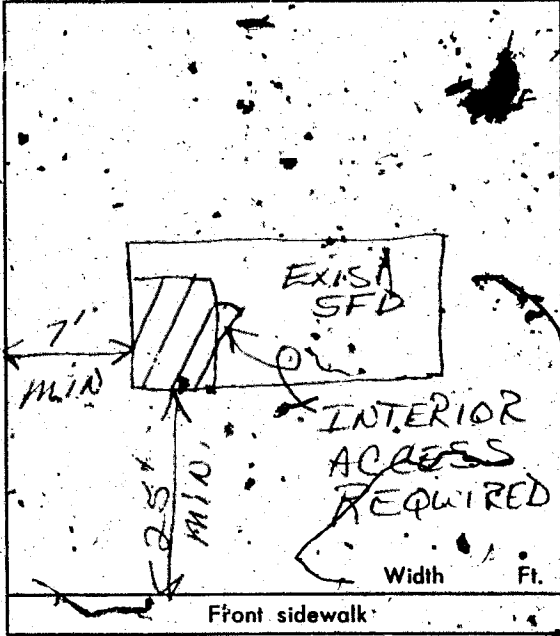

CONDITIONS OF THE PERMIT:

- 1. I agree to call the City Building Department for inspections before concrete is poured, before rough wiring, electrical, plumbing, framing is covered. Also for Air conditioning, sheet-rock and sheathing inspection.
2. I agree that when the job is completed that I will call for final inspection before occupancy.
3. I agree to perform all construction in accordance with City Ordinances and Building Codes.
4. The Contractor's signature below denotes authority from the owner to sign in his behalf and that the owner is aware of all requirements of this application and permit. Separate permits must be taken out for work outlined above this agreement.
5. I have read and understand the contents of this application and permit; I hereby state that the information I have supplied on this application is true and correct.

SIGNED: Contractor

BY: Mr. H.G. Black Agent or Owner

CLARK COUNTY HEALTH DEPT.

LAS VEGAS FIRE DEPARTMENT

PLANNING DEPT. Date: 10-6-69

PUBLIC WORKS DEPT. Date:

BUILDING DEPT. Date: 10-6-69

PERMIT NO: 49576 PERMIT FEE \$ 600

RECEIPT 2996 \$006.00 CITY OF LAS VEGAS DEPT. OF BUILDING & SAFETY MUST BE MACHINE VALIDATED - 6 00 69

Sharon Brown March 14, 1979

CITY OF LAS VEGAS, NEVADA

DEPARTMENT OF BUILDING & SAFETY - ELECTRICAL APPLICATION & PERMIT

ADDRESS OF CONSTRUCTION: 2201 DUNE DR OWNER'S NAME: H. G. BLACK

CIRCLE: New Bldg.; Add'n; Remodel; TYPE OF BLDG. SPD. APT. PUBLIC COMM.

CONTRACTOR'S NAME: _____ STATE LICENSE # _____ CITY LICENSE # _____

NUMBER	FIXTURE OR INSTALLATION	UNIT PRICE
	Fixture or sockets	.15
	Light, receptacle or switch outlet	.20
	Wall or ceiling space heater	.35
	Blast coil heater per kilowatt	.35
	Garbage grinder outlet	.35
	Dishwasher outlet	.35
	Clothes dryer outlet	.35
	Automatic clothes washer	.35
	Electric range outlet	.35
	Electric water heater outlet	.35
	Mercury arc lamp and equipment	.35
	Special purpose outlet	.35
	X-ray unit and its appurtenances	5.00
	Watts of festoon lighting (Watts) First 3,000 watts	4.00
	for each additional thousand watts	1.50
	Horsepower - all motors first horsepower or less	1.75
	for each additional horsepower	.35
	Temporary power and lights (temporary pole)	4.00
	Electric service (including any single meter socket)	3.00
	for each additional socket	.35
	Air conditioning service _____ amps	1.50
	Each KW (KVA) Generator (Transformer) (Welder) KW (KVA)	2.00
	First 100 KVA - For each additional KW (KVA)	.01
	Special inspection per hour	4.00
	Speaker outlets	.15
	Signal or Alarm outlets	.15
	Amplifiers	.50
	Control panels	.25
	T. V. outlets - master system only	.15
	Radio outlets	.15
	Main control racks	1.00
	T. V. and Radio antennas - master system only	.75
	Minimum fee for any permit	4.00
	Total fee	4.00

I hereby certify that I have carefully examined and read the above application; that the same is true and correct; and that the work herein described is to be done in accordance with all the provisions of the applicable Ordinances of the City of Las Vegas, Nevada and State laws whether herein specified or not.

SIGNED Mrs. H. L. Black DATE 10-6-69
MASTER (ELECTRICIAN) (TECHNICIAN) (OWNER)

BUILDING DEPARTMENT J. Wing DATE 10-6-69

PERMIT NO. 28960 PERMIT FEE: \$ 4.00

RECEIPT

2997 \$004.00

CITY OF LAS VEGAS

DEPT. OF BUILDING & SAFETY

MUST BE MACHINE VALIDATED

6 OCT 69

DEPT. OF BLDG & SAFETY - CITY OF LAS VEGAS, NEVADA
 OWNER: H. G. Black ADDRESS: 2201 Dune Drive DATE: 10-6-69
 GEN. CONT. Owner TYPE OF STRUCTURE: enclosed carport
 PERMIT NO. 29516 LEGAL DESCRIPTION: Lot 10/block 2 Twin Lakes Village Unit # 6

BUILDING		MECHANICAL		ELECTRICAL	
LOCATION		PLUMBING CONT.		TEMP. POLE CONT.	
FIREPLACE FTG.		PERMIT NO.	DATE	PERMIT NO.	DATE
FOOTINGS		HEAT & VENT. AC CONT.		INSPECTION	DATE
FOUNDATION WALL		PERMIT NO.	DATE	ELECTRICAL CONT.	DATE
FLOOR FRAMING		SEWER CONT.		PERMIT NO. 28960	DATE 10-6-69
SLAB		PERMIT NO.	DATE	FIXTURES CONT.	
CHIMNEY STEEL (FIREPLACE)		ROUGH SOIL		PERMIT NO.	DATE
WALL STEEL		ROUGH WATER		SLAB	
COLUMN STEEL		TOP-OUT		ROUGH	
BEAM STEEL		ROUGH GAS		FINAL ROUGH	
FRAMING		AC ROUGH DUCT		FINAL FIXTURE	
ROOF SHEATHING		REF. ROUGH PIPING		FINAL ELECTRICAL	
DRYWALL	INTERIOR	FINAL PLUMBING		TEMPORARY SERVICE	
LATHING	EXTERIOR	FINAL GAS			
BACKING (SIDING)		FINAL AIR COND.		MISCELLANEOUS	
PLASTER	SCRATCH	FINAL REFRIG.		GRADING & DRAINAGE	
	BROWN	FINAL SEWER		ON-SITE PARKING SPACES	
URBAN REDEVELOPMENT APPROVAL		FINAL SEPTIC TANK		ENG. APPROVAL OF	
FINAL BLDG.	J. O. B.			OFF-SITE IMPROVEMENTS	
	DATE 10-16-70				

APPROVED FOR OCCUPANCY & METER _____ INSPECTOR _____ DATE _____
 PLEASE NOTE REMARKS ON REVERSE SIDE 2201 Dune Drive LOS # _____ AREA # _____ EX-04

DEPT. OF BLDG & SAFETY - CITY OF LAS VEGAS, NEVADA
 OWNER: THIRD TWIN LAKES MUT. HOMES INC. ADDRESS: 2201 Dune Drive DATE: 7-8-57
 GEN. CONT. TWIN LAKES VILLAGE INC. TYPE OF STRUCTURE: DWELLING
 PERMIT NO. 29210 LEGAL DESCRIPTION: Lot 10, Bl. 3, Twin Lakes Village #6

BUILDING		MECHANICAL		ELECTRICAL	
LOCATION & FLOOR ELEVATION		PLUMBING CONT.		TEMP. POLE CONT.	
FOOTINGS		PERMIT NO. 27287	DATE 8-9-57	PERMIT NO.	DATE
FOUND. & PIERS		HEAT & VENT. CONT.		INSPECTION	DATE
WALL STEEL		PERMIT NO. 27227	DATE 8-30-57	ELECTRICAL CONT.	DATE
BOND BEAM STEEL		SEWER CONT.		PERMIT NO. 27288	DATE 7-10-57
FRAMING & ROOF SHEATHING		PERMIT NO. 27087	DATE 8-9-57	OUTLETS	
STEEL FABRICATION		ROUGH SOIL		MOTORS	M.R.
CONNECTIONS & PAINTING		ROUGH WATER		SLAB	
LATHING	INTERIOR	SEWER OR SEPTIC TANK		ROUGH	
PLASTER	EXTERIOR	TOP-OUT		FINAL ROUGH	
SCRATCH		ROUGH GAS		FIXTURE CONT.	
BROWN		ROUGH DUCT		PERMIT NO. 27288	DATE 7-10-57
FINAL BLDG.		FINAL PLUMBING		FIXTURES	
GRADING & DRAINAGE		FINAL HEATING		FINAL FIXTURE	
ON-SITE PARKING SPACES		FINAL GAS		APPROVED FOR METER	
ENG. APPROVAL OF					
OFF-SITE IMPROVEMENTS					

APPROVED FOR OCCUPANCY: _____ INSPECTOR _____ DATE _____
 * PLEASE NOTE REMARKS ON REVERSE SIDE 2201 Dune Drive DWELLING 7/8/57 EX-04