

5328 Del Rey Ave

L13 B4 CharHills #2 Zone R-1

Sharon Pereira 3/8/79

1968
83

CITY OF LAS VEGAS, NEVADA

LOG NO. & AREA

CONST. VAL. \$ 83

DEPARTMENT OF BUILDING & SAFETY

APPLICATION & BUILDING PERMIT — for:
Fence, Wall, Retaining Wall.

ADDRESS OF CONSTRUCTION:

5328 DEL REY

OWNER: L.H. Westman

LOT(s)

13

BLOCK

4

SUBDIVISION

Ocean Hills #2

ZONE:

R-1

Materials of Construction:

Block

Concrete

Wire

Wood

Other

Yes No

PLANS:

ARCHITECT:

ENGINEER:

CALCS:

CONTRACTOR

Annex Fence

STATE LICENSE #

8581

CITY LICENSE #

7594

TOTAL SQUARE FEET:

TOTAL LINEAL FEET: 83'

Remarks:

Empty table for remarks.

CONDITIONS OF THE PERMIT:

1. Any type of retaining wall must be engineered by a Civil or Structural Engineer.
2. If a home owner takes out the Building Permit and if the owner sublets the work to a Contractor, then the Contractor must take out the permit and pay for it.
3. No fence or wall can be built on City property or rights-of-way, but this is not intended to preclude construction within utility easements if utilities will not be damaged or made inaccessible.
4. The fence or wall shall not enclose any water meter, light standard, or fire alarm box and shall not come closer than 24" from the nearest fire hydrant outlet.
5. Department Inspectors must approve footings before concrete is poured and block wall reinforcing before grouting is done.
6. Maximum height of any wall or fence is 6', side and rear yards; 4' maximum in front yard with the vertical surface above the height of 2' — 50% open and further that fencing within 25' of the intersection of curb faces on corner and through lots is limited to a maximum height of 30".
7. I must not obstruct required onsite parking space (1 space for each dwelling unit) by the erection of this fence or wall.
8. By the signing of this application I herewith agree to the requirements outlined above.

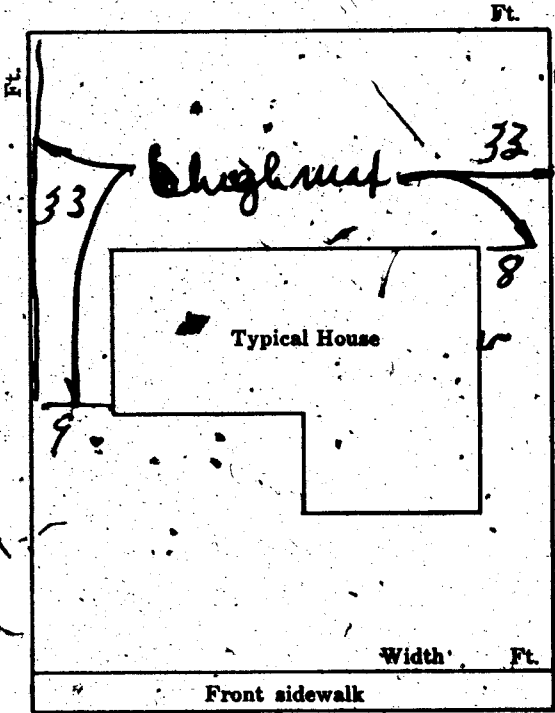

SIGNED:

J. Schuler

DATE:

3-20-68

CONTRACTOR AGENT OWNER

PLANNING DEPT:

ADA

Date:

3-21-68

ENGINEERING DEPT:

Date:

BUILDING DEPT:

P. Wenzel

Date:

3-21-68

#12850

PERMIT NO:

40942

PERMIT FEE \$

3.00

RECEIPT

1968 5000.00 - 8

CITY OF LAS VEGAS
DEPT. OF
BUILDING & SAFETY

MUST BE MACHINE VALIDATED

FF 11-68

Sharon Pereira 3/8/79

CITY OF LAS VEGAS, NEVADA
DEPARTMENT OF BUILDING & SAFETY

PERMIT FEE \$ 4.00
APPLICATION & PERMIT FOR
PLUMBING

JOB ADDRESS: 5328 Del Rey

OWNER'S NAME: FIRST WESTERN SAVINGS AND LOAN ASSN.

LOT BLOCK SUBDIVISION Bldg. type: SFD APT COMM
Circle: New bldg; Old bldg; Add'n; Remodel; Pool; Wtr. Sftner; Lawn Sprkt; Other

CONTRACTOR: ALFRED E. LEE LANDSCAPE AND DESIGN State Lic.# 9433 City Lic.# 4966

QUANTITY	FIXTURE OR INSTALLATION	Unit Price	AMOUNT
	Bathtub	1.00	
	Clothes dryer (gas)	1.00	
	Clothes washer	1.00	
	Dental unit	1.00	
	Dishwasher	1.00	
	Drinking fountain	1.00	
	Fire sprinkling - underground piping	5.00	
	Fire sprinkling - distribution piping per each foot	.01	
	Fire sprinkling heads - per each head	.10	
	Floor drain \$1.00 Floor sink	1.00	
	Gas appliance (any type)	1.00	
	Gas piping system - single family dwelling	3.00	
	Gas piping system - multiple family \$3 per each unit plus	1.00	
	Gas piping system - commercial bldg. per each floor	3.00	
	Grease trap	1.00	
ONE	Irrigation system	4.00	4.00
	Lavatory	4.00	
	Minimum fee for any permit	4.00	
	Piping, Drainage	4.00	
	Sewer replacement	4.00	
	Septic disposal system - Health Dept. approval required	4.00	
	Shower	1.00	
	Sink - kitchen type	1.00	
	Swimming pool - private wading pool	8.00	
	Swimming pool - public - semi-public	12.00	
	Toilet	1.00	
	Urinal	1.00	
	Water distribution system, single family dwelling	4.00	
	Water distribution system multiple dwg. \$4 + each unit	1.00	
	Water distribution system, Group "A" thru "G" per each floor	4.00	
	Water distribution system, Group "H" (hotel) \$4 + per bath*	.50	
	Water heater (gas) (electric)	1.00	
	Water using equipment	1.00	
	Water softener nonpermanent type	4.00	
	Water softener permanent (connected to drainage)	5.00	
	Wash tray	1.00	

TOTAL FEE \$ 4.00

I hereby certify that I have carefully examined & read the above application; that the same is true & correct; and the work herein described is to be done in accordance with the provisions of City of Las Vegas Ordinances & State Laws, whether herein specified or not, * As defined in City Code and Ordinances.

SIGNED: *Alfred E. Lee* Date: 11-4-68
Registered Plumber Spec. Cont'r Owner

Engineering Dept. Date Building Department Date

Sewer Conn. Fee \$ 23.10
Paid in Engr. Dept. PERMIT NO. 25295 PERMIT FEE \$ 4.00

RECEIPT
7584 \$004.00 - 7
CITY OF LAS VEGAS
DEPT. OF BUILDING & SAFETY
Must be machine validated
- 7 NOV 68

DEPARTMENT OF BUILDING & SAFETY
CITY OF LAS VEGAS, NEVADA

FENCE & RETAINING WALLS

DATE 1/22/68

OWNER 1st Western

PERMIT NO. 10019

CONTRACTOR _____

LOT 11

Fence (Wire, Wood, etc.) _____ Walls (masonry, rock, etc.) _____

Location _____
Final Inspection 11-5-68

Location _____
Footing _____
Wall Steel 1st _____ 2d _____ 3d _____
Final Inspection _____

Retaining Wall (masonry)
Location _____
Footing _____
Wall Steel 1st _____ 2d _____ 3d _____
Bond Beam 1st _____ 2d _____ 3d _____
Final Inspection _____

Retaining Wall (concrete)
Location _____
Footing _____
Wall Steel 1st _____ 2d _____ 3d _____
Final Inspection _____

23.14 B

Department of Building & Safety
City of Las Vegas, Nevada

Special Kardex
Elec. only, Plbg. only, A.C. only

Owner First Western Address 5328 Del Rey Date: 11/7/68
Contractor ALFRED E. IER Permit No. 25295
Lot _____ Block _____ Subdivision _____

Electric Only	Plumbing Only	Heat & Vent. A. C. Only
Contractor _____	Contractor _____	Contractor _____
Permit No. _____	Permit No. _____	Permit No. _____
Slab _____	Rough Soil _____	A.C. Rough Duct _____
Rough Elect _____	Rough Water _____	Ref. Ro. Piping _____
Final Rough _____	Top Out _____	Rough Gas _____
Final Fixture _____	Rough Gas _____	Final Refrig _____
Final Elec _____	Final Plbg. <u>11-7-68</u>	Final Air Cond _____
Temp. Service _____	Final Gas _____	Final Gas _____
	Final Sewer _____	
	Final Septic Tank _____	

23.06 D Address 5328 Del Rey

Log No. Irrig Sys. Area _____

