

4209 Essex Green Ct.

L 1 B 5 Sub Char Vill. Green Zone RDP 8 Condo

G. Gatewood 4-10-79

# CITY OF LAS VEGAS, NEVADA

LOG NO. & AREA T-24-2

CONST. VAL \$ 29500<sup>00</sup>

DEPARTMENT OF PUBLIC SERVICES  
DIVISION OF BUILDING AND SAFETY

APPLICATION & BUILDING PERMIT - for:  
Dwellings, Duplexes, Misc. Residential Const.

ADDRESS OF CONSTRUCTION: 4209 Essex Green Court

OWNER: Bonar/DeMichaelis  
A General Partnership

LOT(S) 1 BLOCK 5 SUBDIVISION Charleston Village Green

ZONE: R-3

Existing structure on lot: Dwelling  Accessory Bldgs.  Vacant Lot  Other

PROPOSED CONSTRUCTION: Condominium USE: Residential

MATERIALS OF CONSTRUCTION: Wood Frame  Concrete Block  Reinforced Concrete  Steel Frame

SQUARE FEET OF FLOOR AREAS: 1st 1182 2nd 0 3rd 0 Other 20 TOTAL SQ. FT. 1182 1644

FIRE ZONE: 3 Occupancy Group R-3 CONST. TYPE: V-N

ARCHITECT: RLP Const. Co. Inc. ENGINEER: Bob Mc Nutt NO. OF UNITS 1 NO. OF STORIES 1

Plans Submitted: Yes  No  Calculations Submitted: Yes  No  Sewer Fee Req'd.: Yes  No

CONTRACTOR RLP Const. Co. Inc. STATE LICENSE # 14603 CITY LICENSE # C11814204088

ADD'L. PERMITS REQ'D.: Air Cond.  Elec.  Plumbing  Signs  Paving  Fence  Public Walks  Curb-gutters   
Incinerators  Fire Sprinkling System

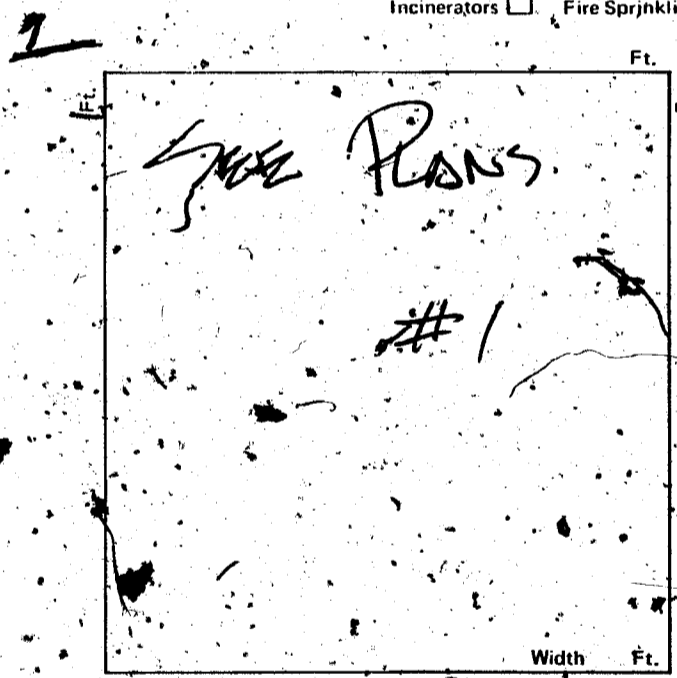

### CONDITIONS OF THE PERMIT:

- I agree to call the City Building Department for inspections before concrete is poured, before rough wiring, electrical, plumbing, framing is covered. Also for Air conditioning, drywall and sheathing inspection.
- I agree that when the job is completed that I will call for final inspection before occupancy.
- I agree to perform all construction in accordance with City Ordinances and Building Codes.
- The Contractor's signature below denotes authority from the owner to sign in his behalf and that the owner is aware of all requirements of this application and permit. Separate permits must be taken out for work outlined above this agreement.
- I have read and understand the contents of this application and permit. I hereby state that the information I have supplied on this application is true and correct.

Approval for the work under this permit will be given only after refuse and debris have been removed from job site and public right of way.

SIGNED: RLP Construction Co., Inc. Contractor  
BY: BH Edwards Agent of Owner

PLANNING DEPT.: [Signature] Date: 7/18/78

PUBLIC WORKS DEPT.: AR Under Date: 7-21-78

BUILDING DIVISION: K Bailey Date: 7-24-78

PERMIT NO.: 8315-1 34 PERMIT FEE \$ 130.50

154-01-220.

RECEIPT

MUST BE MACHINE VALIDATED

G. Gatewood 4-10-79

# CITY OF LAS VEGAS, NEVADA

## DEPARTMENT OF PUBLIC SERVICES—APPLICATION AND PERMIT FOR PLUMBING DIVISION OF BUILDING AND SAFETY

ADDRESS OF CONSTRUCTION: 4209 Essex Green Ct. OWNER'S NAME: BONAR-DE MICHAELIS

CIRCLE: New Bldg. Add'n.; Remodel; TYPE OF BLDG.: SFD. APT. PUBLIC COMM.

CONTRACTOR'S NAME: TASSONE MCEM STATE LICENSE # 12472 B CITY LICENSE # 14636680

UNITS	DESCRIPTION	FEE	TOTAL
1	Bathtub	1.00	
1	Shower	1.00	
2	Lavatory	1.00	
2	Toilet	1.00	
	Urinal	1.00	
	Floor Drain	1.00	
	Floor Sink	1.00	
	Wash Tray	1.00	
1	Sink	1.00	
1	Garbage Disposal	1.00	
1	Garbage Disposal (comm.)	3.00	
1	Clothes Dryer (gas)	1.00	
1	Clothes Washer	1.00	
	Clothes Washer (comm.)	5.00	
	Dishwasher	1.00	
	Dishwasher (commercial)	5.00	
	Dental Unit	10.00	
	Drinking Fountain	1.00	
	Any Water using Equipment	1.00	
1	Water Heater (gas) (elect.)	1.00	
	Sewer System—New, Replacement, or any Drainage System	4.00	
	Grease or Sand Trap	2.00	
	Trailer Trap	2.00	
	Septic Disposal System	4.00	
WATER SOFTENERS			
	Nonpermanent Type	4.00	
	Permanent Type (connected to Drainage)	5.00	
SWIMMING POOLS			
	Private or Wading Pool	10.00	
	Public or Semi public	20.00	

UNITS	DESCRIPTION	FEE	TOTAL
WATER DISTRIBUTION SYSTEM			
1	Single Family Dwelling	4.00	
	Multiple Family Dwelling plus each unit	4.00 2.00	
	Commercial Bldg. per floor	6.00	
	Hotel or Motel plus each bath	4.00 1.50	
	Trailer Park plus each space	20.00 1.00	
	Irrigation	4.00	
GAS PIPING SYSTEM			
1	Single Family Dwelling	3.00	
	Multiple Family Dwelling plus each unit	6.00 1.00	
	Commercial Bldg. per floor plus each unit	3.00 3.00	
	Gas Appliance (any type)	1.00	
AUTOMATIC FIRE EXTINGUISHING SYSTEM			
	Underground Piping	10.00	
	Distribution Piping ea. ft.	.01	
	Sprinkler Head each	10	
	In Range Hood and Vent	5.00	
DRY STANDPIPE SYSTEM			
	Piping	50.00	
	Each Outlet	1.00	
WET STANDPIPE SYSTEM			
	Piping	5.00	
	Fire Hose Cabinet	1.00	
	MINIMUM PERMIT FEE	4.00	
PIPELINE CONTRACTOR, SECT 14 B P F S			
TOTAL PERMIT FEE \$ <u>22.00</u>			

I hereby certify that I have carefully examined and read the above application, that the same is true and correct and that the work herein described is to be done in accordance with all the provisions of the applicable Ordinances of the City of Las Vegas, Nevada and the State Laws, whether herein specified or not.

Approval of the work under this permit will be given only after refuse and debris have been removed from job site and public right of way.

Signed: [Signature] Date: 8/2/78  
Registered Master Plumber, Spec. Cont'r. or Owner

Building Division: F.M.S. Date: 8-4-78

Permit No. 5828-3 Permit Fee \$ 22.00

154-01-222

RECEIPT

MUST BE MACHINE VALIDATED

G. Gatewood 4-10-79

### CITY OF LAS VEGAS, NEVADA

DEPARTMENT OF PUBLIC SERVICES - ELECTRICAL APPLICATION & PERMIT  
DIVISION OF BUILDING AND SAFETY

ADDRESS OF CONSTRUCTION: 4209 Essex Green Court

OWNER'S NAME: RLP Construction Co.

CIRCLE: New Bldg. Add'n. Remodel; TYPE OF BLDG.: SFD. APT. PUBLIC COMM.

CONTRACTOR'S NAME: Sagebrush Electric STATE LICENSE # 14904 CITY LICENSE # C11-09893

NUMBER	FIXTURE OR INSTALLATION	UNIT PRICE	TOTAL
	Rm addition, carport or garage enclosure	4.00	
	Temporary power	4.00	
60	Light, receptacle or switch outlet	.20	12.00
	Wall or ceiling space heater	.35	
1	Garbage grinder outlet	.35	.35
1	Dishwasher outlet	.35	.35
1	Clothes dryer outlet	.35	.35
	Automatic clothes washer	.35	
1	Electric range outlet	.35	.35
	Electric water heater outlet	.35	
	Special purpose outlet	.35	
	X-ray unit and its appurtenances	5.00	
	Watts of festoon lighting (Watts) First 3,000 watts for each additional thousand watts	4.00 1.50	
	Horsepower each motor first horsepower or less for each additional horsepower	1.75 .35	
1	Electric service (including any single meter socket) for each additional socket	3.00 .35	3.00
1	Air conditioning service	1.50	1.50
	Each KW(KVA) Generator (Transformer, Welder) First 100 KVA for each additional KW(KVA)	2.00 .01	
1	Speaker, signal or alarm outlet	.15	.15
	Amplifiers	.50	
	Control panels	.25	
	Main control racks	1.00	
	T.V. and radio antennas-master system only	.75	
	Minimum fee for any permit	4.00	
TOTAL FEE			18.35

Approval for the work under this permit will be given only after refuse and debris have been removed from job site and public right of way.

I hereby certify that I have carefully examined and read the above application, that the same is true and correct, and that the work herein described is to be done in accordance with all the provisions of the applicable Ordinances of the City of Las Vegas, Nevada and State laws whether herein specified or not.

SIGNED Donald H. McHenry DATE 8/16/78  
MASTER (ELECTRICIAN) (TECHNICIAN) (OWNER)

BUILDING DIVISION: M-1 DATE 8-21-78

PERMIT NO. 8891-3 PERMIT FEE \$ 180.50

#### RECEIPT

MUST BE MACHINE VALIDATED

G. Gatewood 4-10-79

### CITY OF LAS VEGAS, NEVADA

DEPARTMENT OF PUBLIC SERVICES—ELECTRICAL APPLICATION & PERMIT  
DIVISION OF BUILDING AND SAFETY

ADDRESS OF CONSTRUCTION: 4209 Essex Green Court

OWNER'S NAME: RLP Construction Co.

CIRCLE: New Bldg. Add'n. Remodel; TYPE OF BLDG.: SFD. APT. PUBLIC COMM.

CONTRACTOR'S NAME: Sagebrush Electric STATE LICENSE # 14904 CITY LICENSE # C11-09893

NUMBER	FIXTURE OR INSTALLATION	UNIT PRICE	TOTAL
	Rm addition, carport or garage enclosure	4.00	
	Temporary power	4.00	
60	Light, receptacle or switch outlet	.20	12.00
	Wall or ceiling space heater	.35	
1	Garbage grinder outlet	.35	.35
1	Dishwasher outlet	.35	.35
1	Clothes dryer outlet	.35	.35
	Automatic clothes washer	.35	
1	Electric range outlet	.35	.35
	Electric water heater outlet	.35	
	Special purpose outlet	.35	
	X-ray unit and its appurtenances	5.00	
	Watts of festoon lighting (Watts) First 3,000 watts for each additional thousand watts	4.00 1.50	
	Horsepower each motor first horsepower or less for each additional horsepower	1.75 .35	
1	Electric service (including any single meter socket) for each additional socket	3.00 .35	3.00
1	Air conditioning service	1.50	1.50
	Each KW(KVA) Generator (Transformer, Welder) First 100 KVA for each additional KW(KVA)	2.00 .01	
1	Speaker, signal or alarm outlet	.15	.15
	Amplifiers	.50	
	Control panels	.25	
	Main control racks	1.00	
	T.V. and radio antennas-master system only	.75	
	Minimum fee for any permit	4.00	
TOTAL FEE			18.35

Approval for the work under this permit will be given only after refuse and debris have been removed from job site and public right of way.

I hereby certify that I have carefully examined and read the above application, that the same is true and correct, and that the work herein described is to be done in accordance with all the provisions of the applicable Ordinances of the City of Las Vegas, Nevada and State laws whether herein specified or not.

SIGNED [Signature] DATE 8/16/78  
MASTER (ELECTRICIAN) (TECHNICIAN) (OWNER)

BUILDING DIVISION: M-1 DATE 8-21-78

PERMIT NO. 8891-3 PERMIT FEE: \$ 180.50

#### RECEIPT

MUST BE MACHINE VALIDATED



G. Gateward 4-10-79

20-16

CITY OF LAS VEGAS, NEVADA

LOG NO. & AREA 1-74-2 CONST. VAL. \$ 4050

DEPARTMENT OF PUBLIC SERVICES

APPLICATION & BUILDING PERMIT for: Fence, Wall, Retaining Wall.

DIVISION OF BUILDING & SAFETY

ADDRESS OF CONSTRUCTION: 4205-4227 Essex Green Ct OWNER: RFP Construction

LOT(s) 142 BLOCK 3-6 SUBDIVISION Charlston Killing Street #2 ZONE RAS

Materials of Construction: Block  Concrete  Wire  Wood  Other  Yes  No

ARCHITECT: \_\_\_\_\_ ENGINEER: \_\_\_\_\_ PLANS:

CONTRACTOR: RFP Construction STATE LICENSE # 14603 CITY LICENSE # 04088

TOTAL SQUARE FEET: 2700 TOTAL LINEAL FEET: 450

Remarks: 86 Ft

CONDITIONS OF THE PERMIT:

1. Any type of retaining wall must be engineered by a Civil or Structural Engineer.
2. If a home owner takes out the Building Permit and if the owner sublets the work to a Contractor, then the Contractor must take out the permit and pay for it.
3. No fence or wall can be built on City property or rights-of-way, but this is not intended to preclude construction within utility easements if utilities will not be damaged or made inaccessible.
4. The fence or wall shall not enclose any water meter, light standard, or fire alarm box and shall not come closer than 24" from the nearest fire hydrant outlet.
5. Department Inspectors must approve footings before concrete is poured and block wall reinforcing before grouting is done.
6. Maximum height of any wall or fence is 6' side and rear yards; 4' maximum in front yard with the vertical surface above the height of 2' - 50% open.
7. I must not obstruct required onsite parking space (2 spaces for each dwelling unit) by the erection of this fence or wall.
8. By the signing of this application I herewith agree to the requirements outlined above.

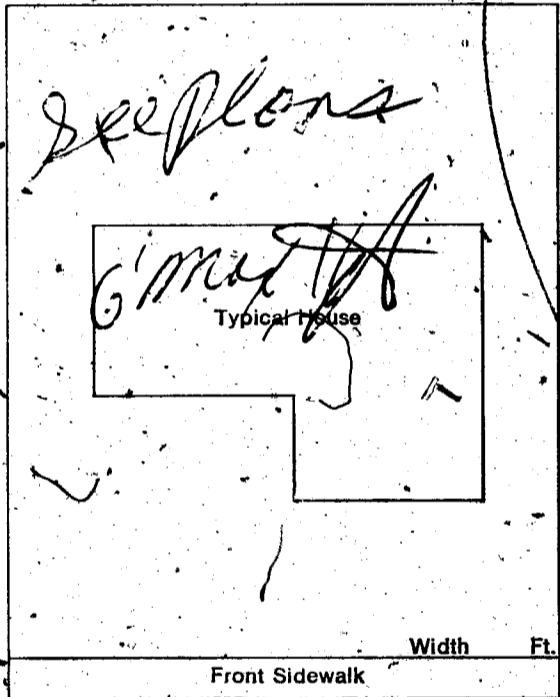

SIGNED: [Signature] DATE: 10/13/78  
CONTRACTOR  AGENT  OWNER

PLANNING DEPT: [Signature] Date: 10-13-78

PUBLIC WORKS DEPT: [Signature] Date: 10-13-78

BUILDING DIVISION: [Signature] Date: 10/13/78

#12850 PERMIT NO: B807-1 PERMIT FEE \$ 33.00

RECEIPT

MUST BE MACHINE VALIDATED

*J. Jones*

DIVISION of BUILDING & SAFETY - CITY of LAS VEGAS, NEVADA

OWNER Bonar DeMichaelis ADDRESS 4209 Essex Green Court DATE 7-27-78  
GEN. CONT. R/L Const TYPE OF STRUCTURE Condominium  
PERMIT NO. 8315-1 LEGAL DESCRIPTION L 1 B 5 Charleston Village Green

BUILDING	MECHANICAL	ELECTRICAL
Investigation	Plumbing Cont. <u>J. Jones</u>	Temp. pole cont.
Location & Footing <u>Mar 7-28-78</u>	Permit No. <u>5828-3</u> Date <u>8-4-78</u>	Permit No. _____ Date _____
Stem Wall	Heat & Vent. A/C Cont. <u>J. Jones</u>	Inspection
Concrete Slab Floor <u>Feb 18-78</u>	Permit No. <u>9112-5</u> Date <u>8-10-78</u>	Electrical Cont. <u>J. Jones</u>
Floor Framing	Sewer Cont. <u>R/L Const</u>	Permit No. <u>828-3</u> Date <u>8-21-78</u>
Fireplace Footing	Permit No. <u>8314</u> Date _____	Fixtures Cont.
Chimney Steel	Rough Soil <u>KW 8-14-78</u>	Permit No. _____ Date _____
Vert. Steel Reinf.	Rough Water <u>KW 8-14-78</u>	Slab
Horiz. Steel Reinf.	Top-Out <u>8-20-78</u> <u>KW 8-22-78</u>	Rough <u>8-21-78</u>
Roof Sheathing <u>Mar 9-12-78</u>	Rough Gas <u>8-20-78</u>	Final Rough
Framing <u>Mar 10-4-78</u>	A/C Rough Duct <u>KW 8-22-78</u>	Final Fixture
Backing for siding	Ref. Rough Piping	Final Electrical <u>Ky 2-16-79</u>
Ext. Lath <u>Mar 11-2-78</u>	Final Plumbing <u>KW 8-22-78</u>	Temporary Service
Ext. Scratch	Final Gas <u>KW 8-23-79</u>	MISCELLANEOUS
Ext. Brown <u>VH 11-5-78</u>	Final Air Cond. <u>KW 1-2-79</u>	Grading & Drainage
Int. Lath	Final Refrig. <u>8-10-78</u>	On Site Parking Spaces _____ App. _____
Int. Brown	Final Sewer	Eng. Approval of _____
Drywall <u>Feb 20-3-78</u>	Final Septic Tank	Off Site Improvements _____
Insulation		
Final Building <u>Mar KW 2-23-79</u>		
Appr. for Occu.		

INSPECTOR: \_\_\_\_\_

DATE \_\_\_\_\_

APPROVED FOR OCCUPANCY & METER \_\_\_\_\_

PLEASE NOTE REMARKS ON REVERSE SIDE

4209 Essex Green Court

LOG # \_\_\_\_\_

AREA # \_\_\_\_\_

76-114

T-24-2