

1110 FREMONT

SEE APPLICATION FOR LEGAL

Glenn Date rec'd 5-9-79

COMMERCIAL  
CITY OF LAS VEGAS, NEVADA

LOG NO. & AREA \_\_\_\_\_ CONST. VAL. \$ 40.00

DEPARTMENT OF BUILDING & SAFETY APPLICATION & BUILDING PERMIT for  
Fence, Wall, Retaining Wall.

ADDRESS OF CONSTRUCTION: 1110 FREMONT REAR OWNER: FRANKLIN BRAS

LOT(s) all BLOCK: 2 SUBDIVISION Ladd Addition ZONE: C-2

Materials of Construction: Block  Concrete  Wire  Wood  Other  PLANS:  Yes  No

ARCHITECT: \_\_\_\_\_ ENGINEER: \_\_\_\_\_ CALCS:

CONTRACTOR: VAN PATTEN CONST. STATE LICENSE # \_\_\_\_\_ CITY LICENSE # \_\_\_\_\_

TOTAL SQUARE FEET: \_\_\_\_\_ TOTAL LINEAL FEET: 20'

Remarks:  
\_\_\_\_\_  
\_\_\_\_\_  
\_\_\_\_\_

CONDITIONS OF THE PERMIT:

1. Any type of retaining wall must be engineered by a Civil or Structural Engineer.
  2. If a home owner takes out the Building Permit and if the owner sublets the work to a Contractor, then the Contractor must take out the permit and pay for it.
  3. No fence or wall can be built on City property or rights-of-way, but this is not intended to preclude construction within utility easements if utilities will not be damaged or made inaccessible.
  4. The fence or wall shall not enclose any water meter, light standard, or fire alarm box and shall not come closer than 24" from the nearest fire hydrant outlet.
  5. Department Inspectors must approve footings before concrete is poured and block wall reinforcing before grouting is done.
  6. Maximum height of any wall or fence is 6' side and rear yards; 4' maximum in front yard with the vertical surface above the height of 2' - 50% open and further that fencing within 25' of the intersection of curb faces on corner and through lots is limited to a maximum height of 30'.
- I must not obstruct required onsite parking space (1 space for each dwelling unit) by the erection of this fence or wall.
- By the signing of this application I herewith agree to the requirements outlined above.

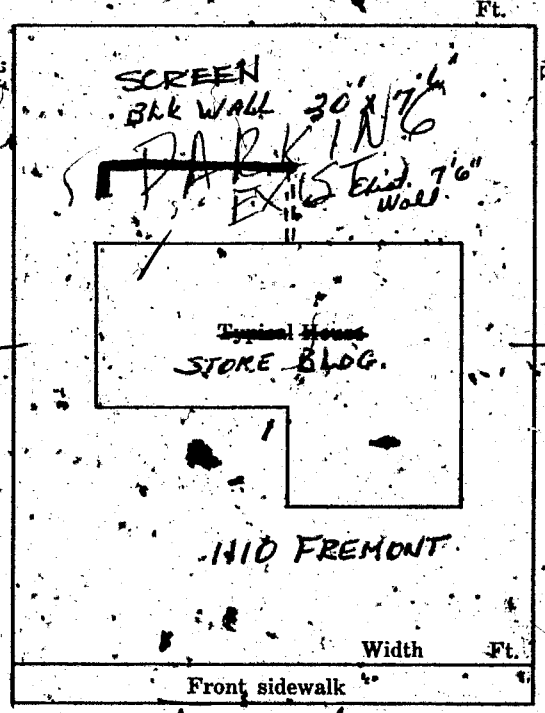

SIGNED: O. W. Rodgers DATE: 8/15/67  
CONTRACTOR  AGENT  OWNER

PLANNING DEPT: [Signature] Date: 8-15-67

ENGINEERING DEPT: \_\_\_\_\_ Date: \_\_\_\_\_

BUILDING DEPT: [Signature] Date: 8-15-67

#1285 PERMIT NO: 38466 PERMIT FEE: 3.00

RECEIPT  
472 \$003.00 - 8  
CITY OF LAS VEGAS  
DEPT. OF BUILDING & SAFETY  
MUST BE MACHINE VALIDATED  
15 AUG 67

Glenn Waterco... -9-79

1969  
CITY OF LAS VEGAS, NEVADA

DEPARTMENT OF BUILDING & SAFETY - APPLICATION AND PERMIT FOR PLUMBING

ADDRESS OF CONSTRUCTION: 1100 E Fremont OWNER'S NAME: Franklin

CIRCLE: New Bldg.; Add'n; Remodel; TYPE OF BLDG.: SFD. APT. PUBLIC COMM.

CONTRACTOR'S NAME: W. A. B. Construction Co STATE LICENSE # 5229A CITY LICENSE # 2-01074

UNITS	DESCRIPTION	FEE	TOTAL
	Bathtub	1.00	
	Shower	1.00	
	Lavatory	1.00	
	Toilet	1.00	
	Urinal	1.00	
	Floor Drain	1.00	
	Floor Sink	1.00	
	Wash Tray	1.00	
	Sink	1.00	
	Garbage Disposal	1.00	
	Garbage Disposal (comm.)	3.00	
	Clothes Dryer (gas)	1.00	
	Clothes Washer	1.00	
	Clothes Washer (comm.)	5.00	
	Dishwasher	1.00	
	Dishwasher (commercial)	5.00	
	Dental Unit	10.00	
	Drinking Fountain	1.00	
	Any Water using Equipment	1.00	
	Water Heater (gas) (elect.)	1.00	
	Sewer System - New, Replacement, or any Drainage System	4.00	
	Grease or Sand Trap	2.00	
	Trailer Trap	2.00	
	Septic Disposal System	4.00	
WATER SOFTENERS			
	Nonpermanent Type	4.00	
	Permanent Type (connected to Drainage)	5.00	
SWIMMING POOLS			
	Private or Wading Pool	10.00	
	Public or Semi-public	20.00	

UNITS	DESCRIPTION	FEE	TOTAL
WATER DISTRIBUTION SYSTEM			
	Single Family Dwelling	4.00	
	Multiple Family Dwelling plus each unit	4.00 2.00	
1	Bldg. Group "A" thru "G" per each floor <u>Water Line</u>	6.00	46.00
	Hotel or Motel plus each bath	4.00 1.50	
	Trailer Park plus each space	20.00 1.00	
	Irrigation	4.00	
GAS PIPING SYSTEM			
	Single Family Dwelling	3.00	
	Multiple Family Dwelling plus each unit	6.00 1.00	
	Commercial Bldg. per floor plus each unit	3.00 3.00	
	Gas Appliance (any type)	1.00	
AUTOMATIC FIRE EXTINGUISHING SYSTEM			
	Underground Piping	10.00	
	Distribution Piping ea. ft.	.01	
	Sprinkler Head each	1.00	
	In Range Hood and Vent	5.00	
DRY STANDPIPE SYSTEM			
	Piping	50.00	
	Each Outlet	1.00	
WET STANDPIPE SYSTEM			
	Piping	5.00	
	Fire Hose Cabinet	1.00	
	MINIMUM PERMIT FEE	4.00	
TOTAL PERMIT FEE \$			<u>60.00</u>

I hereby certify that I have carefully examined and read the above application; that the same is true and correct; and that the work herein described is to be done in accordance with all the provisions of the applicable Ordinances of the City of Las Vegas, Nevada and the State Laws, whether herein specified or not.

Signed: J. J. [Signature] Date: 10-3-69  
 REGISTERED MASTER PLUMBER, SPEC. CONTR., OR OWNER  
 Building Department: J. [Signature] Date: 10-6-69  
 Permit No. 28074 Permit Fee \$ 60.00

#12870

RECEIPT  
 3036 \$006.00  
 CITY OF LAS VEGAS  
 DEPT. OF BUILDING & SAFETY  
 MUST BE MACHINE VALIDATED  
 -7 OCT 69

Glenn Waterwood 5-9-79

1969  
CITY OF LAS VEGAS, NEVADA

DEPARTMENT OF BUILDING & SAFETY - APPLICATION AND PERMIT FOR PLUMBING

ADDRESS OF CONSTRUCTION: 1140 E Fremont OWNER'S NAME: Franklin

CIRCLE: New Bldg; Add'n; Remodel; TYPE OF BLDG.: SFD. APT. PUBLIC COMM.

CONTRACTOR'S NAME: NEVADA IRRIGATION CO STATE LICENSE # 52294 CITY LICENSE # 2-01074

UNITS	DESCRIPTION	FEE	TOTAL
	Bathtub	1.00	
	Shower	1.00	
	Lavatory	1.00	
	Toilet	1.00	
	Urinal	1.00	
	Floor Drain	1.00	
	Floor Sink	1.00	
	Wash Tray	1.00	
	Sink	1.00	
	Garbage Disposal	1.00	
	Garbage Disposal (comm.)	3.00	
	Clothes Dryer (gas)	1.00	
	Clothes Washer	1.00	
	Clothes Washer (comm.)	5.00	
	Dishwasher	1.00	
	Dishwasher (commercial)	5.00	
	Dental Unit	10.00	
	Drinking Fountain	1.00	
	Any Water using Equipment	1.00	
	Water Heater (gas) (elect.)	1.00	
	Sewer System - New, Replacement, or any Drainage System	4.00	
	Grease or Sand Trap	2.00	
	Trailer Trap	2.00	
	Septic Disposal System	4.00	
WATER SOFTENERS			
	Nonpermanent Type	4.00	
	Permanent Type (connected to Drainage)	5.00	
SWIMMING POOLS			
	Private or Wading Pool	10.00	
	Public or Semi-public	20.00	

UNITS	DESCRIPTION	FEE	TOTAL
WATER DISTRIBUTION SYSTEM			
	Single Family Dwelling	4.00	
	Multiple Family Dwelling plus each unit	4.00 2.00	
1	Bldg. Group "A" thru "G" per each floor <u>water line</u>	6.00	6.00
	Hotel or Motel plus each bath	4.00 1.50	
	Trailer Park plus each space	20.00 1.00	
	Irrigation	4.00	
GAS PIPING SYSTEM			
	Single Family Dwelling	3.00	
	Multiple Family Dwelling plus each unit	6.00 1.00	
	Commercial Bldg. per floor plus each unit	3.00 3.00	
	Gas Appliance (any type)	1.00	
AUTOMATIC FIRE EXTINGUISHING SYSTEM			
	Underground Piping	10.00	
	Distribution Piping ea. ft.	.01	
	Sprinkler Head each	.10	
	In Range Hood and Vent	5.00	
DRY STANDPIPE SYSTEM			
	Piping	50.00	
	Each Outlet	1.00	
WET STANDPIPE SYSTEM			
	Piping	5.00	
	Fire Hose Cabinet	1.00	
	MINIMUM PERMIT FEE	4.00	
TOTAL PERMIT FEE \$			<u>6.00</u>

I hereby certify that I have carefully examined and read the above application, that the same is true and correct, and that the work herein described is to be done in accordance with all the provisions of the applicable Ordinances of the City of Las Vegas, Nevada and the State Laws, whether herein specified or not.

Signed: [Signature] Date: 10-3-69  
REGISTERED MASTER PLUMBER, SPEC. CONTR. OR OWNER  
Building Department: [Signature] Date: 10-6-69  
#12870 Permit No. 28074 Permit Fee \$ 6.00

RECEIPT  
3036 \$006.00  
CITY OF LAS VEGAS  
DEPT. OF BUILDING & SAFETY  
MUST BE MACHINE VALIDATED  
-7 OCT 69

Glenn Haterwood 5-9-79

# CITY OF LAS VEGAS, NEVADA

## DEPARTMENT OF BUILDING & SAFETY ELECTRICAL APPLICATION & PERMIT

ADDRESS OF CONSTRUCTION: 1110 E. Fremont OWNER'S NAME: J. J. Franklin

CIRCLE:  New Bldg.;  Add'n.;  Remodel; TYPE OF BLDG.:  SFD.  APT.  PUBLIC COMM.

CONTRACTOR'S NAME: Loyed Tomich Electric STATE LICENSE # 7767 CITY LICENSE # 8713

NUMBER	FIXTURE OR INSTALLATION	UNIT PRICE	TOTAL
	Rm addition, carport or garage enclosure	4.00	
	Temporary power	4.00	
<u>20</u>	Light, receptacle or switch outlet	.20	<u>4.00</u>
	Wall or ceiling space heater	.35	
	Garbage grinder outlet	.35	
	Dishwasher outlet	.35	
	Clothes dryer outlet	.35	
	Automatic clothes washer	.35	
	Electric range outlet	.35	
<u>1</u>	Electric water heater outlet	.35	<u>.35</u>
	Special purpose outlet	.35	
	X-ray unit and its appurtenances	5.00	
	Watts of festoon lighting (Watts) First 3,000 watts for each additional thousand watts	4.00 1.50	
	Horsepower-each motor first horsepower or less for each additional horsepower	1.75 .35	
<u>1</u>	Electric service (including any single meter socket) for each additional socket	3.00 .35	<u>3.00</u>
<u>1</u>	Air conditioning service	1.50	<u>1.50</u>
	Each KW(KVA) Generator (Transformer, Welder) First 100 KVA for each additional KW(KVA)	2.00 .01	
	Speaker, signal or alarm outlet	.15	
	Amplifiers	.50	
	Control panels	.25	
	Main control racks	1.00	
	T.V. and radio antennas-master system only	.75	
	Minimum fee for any permit	4.00	
	<b>TOTAL FEE</b>		<u>8.85</u>

Approval for the work under this permit will be given only after refuse and debris have been removed from job site and public right of way.

I hereby certify that I have carefully examined and read the above application; that the same is true and correct; and that the work herein described is to be done in accordance with all the provisions of the applicable Ordinances of the City of Las Vegas, Nevada and State laws whether herein specified or not.

SIGNED Loyed Tomich DATE 4/4/75  
MASTER (ELECTRICIAN) (TECHNICIAN) (OWNER)

BUILDING DEPARTMENT N. Mills DATE \_\_\_\_\_

#12860 PERMIT NO. 2309 PERMIT FEE: \$ 8.85

RECEIPT

2931 \$008.85 - 6

CITY OF LAS VEGAS  
DEPT. OF BUILDING & SAFETY

MUST BE MACHINE VALIDATED

7 APR 75

*June 18 62*

DEPT. of BLDG & SAFETY - CITY of LAS VEGAS, NEVADA  
 OWNER Peyton Place Cocktail Lounge ADDRESS 1110 E. Fremont DATE May 7, 1962  
 SEN. CONT. Western Neon TYPE OF STRUCTURE Sign  
 PERMIT NO. 576 LEGAL DESCRIPTION \_\_\_\_\_

BUILDING		MECHANICAL		ELECTRICAL	
LOCATION		PLUMBING CONT.		TEMP. POLE CONT.	
REPLACE FTS.		PERMIT NO.	DATE	PERMIT NO.	DATE
FOOTINGS		HEAT & VENT. AC CONT.		INSPECTION	DATE
FOUNDATION WALL		PERMIT NO.	DATE	ELECTRICAL CONT.	
STEM WALL		SEWER CONT.		PERMIT NO.	DATE
FLOOR FRAMING		PERMIT NO.	DATE	FIXTURES CONT.	
SLAB		ROUGH SOIL		PERMIT NO.	DATE
CHIMNEY STEEL (FIREPLACE)		ROUGH WATER		SLAB	
WALL STEEL		TOP-OUT		ROUGH	
COLUMN STEEL		ROUGH GAS		FINAL ROUGH	
BEAM STEEL		AC ROUGH DUCT		FINAL FIXTURE	
STEEL FABRICATION		REF. ROUGH PIPING		TEMPORARY SERVICE	
FRAMING		FINAL PLUMBING		MISCELLANEOUS	
ROOF SHEATHING		FINAL GAS		URBAN REDEVELOPMENT APPROVAL	
DRYWALL	INTERIOR	FINAL AIR COND.		<input type="checkbox"/>	
LATHING	EXTERIOR	FINAL REFRIG.		GRAVING & DRAINAGE	
BACKING (SHIMS)		FINAL SEWER		ON-SITE PARKING SPACES	
PLASTER	SCRATCH	FINAL SEPTIC TANK		ENG. APPROVAL OF	
	BROWN			OFF-SITE IMPROVEMENTS	
FINAL BLDG	DATE			DATE	

APPROVED FOR OCCUPANCY \_\_\_\_\_ INSPECTOR \_\_\_\_\_ DATE \_\_\_\_\_  
 APPROVED FOR METER West 5-8-62 LOG:# \_\_\_\_\_ AREA:# 23.04  
 PLEASE NOTE REMARKS ON REVERSE SIDE  
1110 E. Fremont SIGN May 7, 1962

Department of Building & Safety  
 City of Las Vegas, Nevada  
 Special Kardex  
 Elec. only, Plbg. only, A.C. only  
 Owner J. T. Franklin Address 1110 E. Fremont Date: 11/7/75  
 Contractor \_\_\_\_\_ Permit No. \_\_\_\_\_  
 Lot \_\_\_\_\_ Block \_\_\_\_\_ Subdivision \_\_\_\_\_

Electric Only	Plumbing Only	Heat & Vent. A. C. Only
Contractor <u>Logan &amp; Tomsik</u>	Contractor _____	Contractor _____
Permit No. <u>2309</u>	Permit No. _____	Permit No. _____
Slab _____	Rough Soil _____	A.C. Rough Duct _____
Rough Elect <u>VP11-7-75</u>	Rough Water _____	Ref. Ro. Piping _____
Final Rough _____	Top Out _____	Rough Gas _____
Final Fixture _____	Rough Gas _____	Final Refrig _____
Final Elec <u>VP11-7-75</u>	Final Plbg. _____	Final Air Cond _____
Temp. Service _____	Final Gas _____	Final Gas _____
	Final Sewer _____	
	Final Septic Tank _____	

23.06 D Address 1110 E. Fremont Log No. \_\_\_\_\_ Outlets \_\_\_\_\_ Area \_\_\_\_\_

*Approved 1-18-59*

DEPT. of BLDG. & SAFETY - CITY of LAS VEGAS, NEVADA  
OWNER: FRANKLIN BROS. ADDRESS: 1110 Fremont St. DATE: 7/28/59  
GEN. CONT. FRANKLIN BROS CONSTR. CO. TYPE OF STRUCTURE: INTERIOR REMODELING PARTITIONS ONLY  
PERMIT NO. 31027 LEGAL DESCRIPTION:

LOCATION & FLOOR ELEVATION	PLUMBING CONT. <u>General</u>	TEMP. POLE CONT.
FOOTINGS	PERMIT NO. <u>31194</u> DATE <u>7-22-59</u>	PERMIT NO. _____ DATE _____
FOUND. & PIERS	HEAT. & VENT. CONT.	INSPECTION _____ DATE _____
WALL STEEL	PERMIT NO. _____ DATE _____	ELECTRICAL CONT.
BOND BEAM STEEL	SEWER CONT.	PERMIT NO. _____ DATE _____
FRAMING & ROOF SHEATHING	PERMIT NO. _____ DATE _____	OUTLETS
<u>Mullins 7-22-59</u>	ROUGH SOIL <u>London 7-29-59</u>	MOTORS _____ H.P. _____
STEEL FABRICATION	ROUGH WATER <u>London 7-29-59</u>	SLAB _____
CONNECTIONS & PAINTING	SEWER OR SEPTIC TANK _____	ROUGH _____
INTERIOR _____ EXTERIOR _____	TOP-OUT _____	FINAL ROUGH _____
LATHING	ROUGH GAS _____	FIXTURE CONT. _____ DATE _____
PLASTER	ROUGH DUCT _____	FIXTURES _____
SCRATCH	FINAL PLUMBING <u>Battley 8-6-60</u>	FINAL FIXTURE _____
BROWN	FINAL HEATING _____	APPROVED FOR METER _____
FINAL BLDG. <u>DeVander 6-7-60</u>	FINAL GAS _____	
GRADING & DRAINAGE		
ON-SITE PARKING _____ SPACES _____		
ENG. APPROVAL OF OFF-SITE IMPROVEMENTS		

APPROVED for OCCUPANCY: \_\_\_\_\_ INSPECTOR \_\_\_\_\_ DATE \_\_\_\_\_

\* PLEASE NOTE REMARKS ON REVERSE SIDE  
1110 Fremont St. INTERIOR PARTITIONS ONLY. 7/28/59 23.04

DEPARTMENT OF BUILDING & SAFETY  
CITY OF LAS VEGAS, NEVADA  
OWNER Franklin Bros ADDRESS 1110 Fremont KARDEX CARD  
FENCE & RETAINING WALLS  
DATE 8/15/67

CONTRACTOR Van Patten Const PERMIT NO. 38166  
LOT \_\_\_\_\_ BLOCK 2 SUBDIVISION Iadd Addition  
Repair Block Wall

Fence (wire, wood, etc.)	Walls (masonry, rock, etc.)
Location _____	Location _____
Final Inspection <u>Railley 8-25-67</u>	Footing _____
	Wall Steel 1st _____ 2d _____ 3d _____
	Final Inspection _____
Retaining Wall (masonry)	Retaining Wall (concrete)
Location _____	Location _____
Footing _____	Footing _____
Wall Steel 1st _____ 2d _____ 3d _____	Wall Steel 1st _____ 2d _____ 3d _____
Bond Beam 1st _____ 2d _____ 3d _____	Final Inspection _____
Final Inspection _____	

23.14 B ADDRESS 1110 Fremont LOG NO. \_\_\_\_\_ AREA \_\_\_\_\_

Lula K. ... 4-15-82

ELEC. ONLY PLBG. ONLY, A.C. ONLY		
OWNER		DATE
George Padgett		8/19/82
ADDRESS		
1110 E Fremont		
CONTRACTOR		PERMIT NO.
Alpha Elect		9047
LOT	BLOCK	SUBDIVISION
LOG NO.		AREA
ELECTRIC ONLY		PLUMBING ONLY
Contractor		Contractor
Alpha		
Permit No.		Permit No.
9047		
Rough Elec.		Rough Soil
82723-82		
Final Rough		Rough Water
Final Elec.		Top Out
82727-82		
Temp. Service		Rough Gas
HEAT & VENT. A/C ONLY		Final Plbg.
Contractor		Final Gas
Permit No.		Sewer Final
A/C Rough Duct		
Rough Gas		
Final A/C		
Final Gas		

79-3-15 (811-81) DEPT. OF BLDG. & SAFETY  
CITY OF LAS VEGAS

*Lula Collins 4-15-82*

# CITY OF LAS VEGAS, NEVADA

## DEPARTMENT OF BUILDING AND SAFETY - ELECTRICAL APPLICATION & PERMIT

PHONE NO: \_\_\_\_\_

ADDRESS OF CONSTRUCTION: 1110 E Fremont

OWNER'S NAME: George Padgett

CIRCLE: Addition; Remodel New Bldg. TYPE OF BLDG. SFD APT. COMM. PUBLIC

CONTRACTOR'S NAME: Alpha Elec Inc. STATE LICENSE # 13811 CITY LICENSE # 10248

UNITS	DESCRIPTION	FEE	TOTAL
<b>PERMIT ISSUANCE</b>			
1	For Issuing Each Permit	10.00	10.00
	Supplemental Fee	4.50	
<b>APPLIANCE CHARGE</b>			
4	Receptacle <input checked="" type="checkbox"/> Switch	.40	1.60
	Each Light Fixture or Socket	.30	
	EACH OUTLET FOR: Dishwasher, Garbage Grinder, Trash Compactor, G.F.L., Clothes Washer, Dryer, Electric Range, Oven, Smoke Detector, Special Purpose, Water Heater, Space Heater, Blast Coil Heater (PER K.W.), Mercury Lamp, Quartz Lamp, Sodium Lamp	.70	
	X-Ray Unit	10.00	
	Area Lighting (First 3,000 Watts)	8.00	
	Each Additional 1,000 Watts	3.00	
	Motors (1/2 H.P. and Over) Transformers Welders, Generators		
	First H.P. For each Unit	3.00	
	First KVA For Each Unit	.50	
	Each Additional H.P. or KVA	.30	
	Temporary Power or Pole	6.00	
	Electric Service (Incl'd First Meter)	6.00	
	Up to 200 AMP		
	400 AMP And 600 AMP	12.50	
	Over 600 AMP To 1200 AMP	25.00	
	Over 1200 AMP	50.00	
	Each Additional Meter Socket	.50	

UNITS	DESCRIPTION	FEE	TOTAL
	Sub Panel (Each)	3.00	
	Swimming Pool (Residential)	20.00	
	Swimming Pool (Semi-Public)	30.00	
	Spas	8.00	
	Recreational Vehicle Spaces (Each)	3.00	
	Busways-Trolley or Plug-in (Ea. 100 Ft.)	3.00	
	All Misc. Electric		
	Permanent A/C Unit (Pkg. Units)	3.00	
	Each Air Handler	1.00	
<b>LOW VOLTAGE INSTALLATIONS</b>			
	Speaker Outlets (Each)	.30	
	Signal or Alarm Outlets (Each)	.30	
	Amplifiers	2.00	
	Control Panel	.50	
	TV Master System	.30	
	Telephone or Computer Outlet	.30	
	Starter Permit		
	Contract Price or Cost of Installation		
	Misc.		
<b>TOTAL PERMIT FEE \$</b>		<b>11.60</b>	

Electrical permit fees may be computed the same as building permit fees by using the value of installation for valuation amount when such work is not included in the above schedule.

**FOR BUILDING DEPARTMENT USE ONLY**

Plans submitted:  yes  no      Occupancy type: \_\_\_\_\_      Type of Construction: \_\_\_\_\_

Received by PAC: \_\_\_\_\_      Date: \_\_\_\_\_      Valuation (declared) \$ \_\_\_\_\_

Review by Plans Check: \_\_\_\_\_      Date: \_\_\_\_\_      Fee calculated \$ \_\_\_\_\_

Issued by: \_\_\_\_\_      Date: \_\_\_\_\_      Other Fees (226) \$ \_\_\_\_\_

Check  Cash       Total Fees \$ \_\_\_\_\_

ITONI	\$ .00
SELEC	\$ 11.60
FOOTE	\$ 11.60
<b>TOTL</b>	<b>\$ 11.60</b>
<b>CHEK</b>	<b>\$ 11.60</b>
A#9047 SR#001/01	
CITY - LAS VEGAS	

- Other inspections and fees:
- Inspections outside of normal business hours - \$15.00 per hour (minimum charge two hours).
  - Re-inspection fee assessed under provisions of TABLE 3-A of the Uniform Building Code - \$15.00 per hour.
  - Inspections for which no fee is specifically indicated - \$15.00 per hour (minimum charge one half hour).
  - Additional plan review required by changes, additions or revisions to approved plans - \$15.00 per hour (minimum charge one half hour).

I hereby certify that I have carefully examined and read the above application; that the same is true and correct; and that the work herein described is to be done in accordance with all the provisions of the applicable Ordinances of the City of Las Vegas, Nevada and the State Laws, whether herein specified or not. City Master Card No. \_\_\_\_\_

SIGNED Edward E. Gunn 3/19/82  
Master (Electrician) (Technician) (Owner)

BUILDING DIVISION 9047  
PERMIT NO. 9047

#1721-2402

Approved for the work under this permit will be done only after all related debris have been removed from job site and public right of way.

**RECEIPT**

*Debbie Ingram 6-9-88*

# CITY OF LAS VEGAS, NEVADA

LOG NO. & AREA \_\_\_\_\_ DATE 6-2-88 CONST. VAL. \$ 4,100.00

DEPARTMENT OF BUILDING AND SAFETY PHONE 386-6251 DEVELOPMENT PERMIT AND BUILDING PERMIT FOR: Commercial and Public Structures

ADDRESS OF CONSTRUCTION 1110 FREMONT ST. E OWNER GEORGE COX

CONTRACTOR RANERI - LONG ROOFING STATE LICENSE NO. 19951 CITY LICENSE NO. 22043

LOT(S) Plat 2 SUBDIVISION Sadd Gidd ZONE C-7

PROPOSED CONSTRUCTION: RE-ROOF EXISTING BUILDING USE: \_\_\_\_\_

BUILDING PERMIT NO. 1059 ELECTRIC PERMIT NO. \_\_\_\_\_ PLUMBING PERMIT NO. \_\_\_\_\_ AIR COND. PERMIT NO. \_\_\_\_\_

ADD'L. PERMITS REQ'D.: Air Cond.  Elec.  Plumbing  Signs  Paving  Fences  Fire S.S.  Off-Site P.

OCCUPANCY GROUP \_\_\_\_\_ CONSTRUCTION TYPE \_\_\_\_\_

MATERIALS OF CONSTRUCTION: Wood Frame  Concrete Block  Reinforced Concrete  Steel Frame

SQUARE FEET OF FLOOR AREAS: 1st \_\_\_\_\_ 2nd \_\_\_\_\_ 3rd \_\_\_\_\_ Other \_\_\_\_\_ TOTAL SQ. FT. \_\_\_\_\_

ARCHITECT: \_\_\_\_\_ ENGINEER: \_\_\_\_\_ NO. of UNITS \_\_\_\_\_ NO. of STORIES 1

### OTHER INSPECTIONS AND FEES

1. Inspections outside of normal business hours = \$30.00 per hour (minimum charge three hours).
2. Re-inspection fee during normal business hours assessed under provisions of TABLE 3-A of the Uniform Building Code = \$30.00 each.
3. Inspections during normal business hours for which no fee is specifically indicated = \$30.00 per hour (minimum charge one half hour).
4. Additional plan review required by changes, additions or revisions to approved plans = \$30.00 per hour (minimum charge two hours).

### CONDITIONS OF THE PERMIT:

1. I agree to call the City Building Department for inspections before concrete is poured, before rough wiring, electrical, plumbing, framing is covered. Also for air conditioning, drywall and sheathing inspection.
2. I agree that when the job is completed that I will call for final inspection before occupancy.
3. I agree to perform all construction in accordance with City Ordinances and Building Codes.
4. The Contractor's signature below denotes authority from the owner to sign in his behalf and that the owner is aware of all requirements of this application and permit. Separate permits must be taken out for work outlined above this agreement.
5. I have read and understand the contents of this application and permit; I hereby state that the information I have supplied on this application is true and correct.

Approval for the work under this permit will be given only after refuse and debris have been removed from job site and public right of way.

*re-roof only \$900 profit Built-up CLASS "B"*

Width Ft.

Front property line

SIGNED Raneri & Long CONTRACTOR

BY Buddy Powell AGENT/OWNER

LICENSE DEPT. \_\_\_\_\_ DATE 6/2/88

PLANNING DEPT. \_\_\_\_\_ DATE \_\_\_\_\_  
I hereby certify that I have reviewed this application and the proposed plans and have found that the proposed development meets the requirements of the City of Las Vegas Flood Hazard Reduction Ordinance for the issuance of this Development Permit.

LAND DEVELOPMENT AND FLOOD CONTROL ENGINEER \_\_\_\_\_ DATE \_\_\_\_\_

DATE DEPARTMENT \_\_\_\_\_ DATE \_\_\_\_\_  
BUILDING DEPT. 6-2-88 DATE \_\_\_\_\_

SEWER CONNECTION 7-14-3654

FIXTURES X 06/02/88

FEE \_\_\_\_\_

PLAN REVIEW FEE \_\_\_\_\_

2310-2403 PERMIT FEE 60.60

TOTAL FEES \_\_\_\_\_

RECEIPT  
\*\*0803\*\*  
COMM 60.60  
CHEK 60.60  
1059A000 09:56

PERMIT NO. \_\_\_\_\_ MUST BE MACHINE VALIDATED

Permit Expires 180 Days After Abandonment of Work

Debbie Ingram 6-10-89

OWNER	George Cox	ADDRESS	1110 Fremont
DATE	6-6-88	GEN. CONT.	Raneri & Long
TYPE OF STRUCTURE	RE-roof	PERMIT No.	1059
LEGAL DESCRIPTION		LOG No.	AREA No.
APPROVED FOR OCCUPANCY & METER			
BUILDING		MECHANICAL	
Location & Footing		Plumbing Cont.	
Concrete Slab Floor		Permit No.      Date	
Fireplace Footing		Htg./Vt./A.C. Cont.	
Chimney Steel		Permit No.      Date	
Vert. Steel Reinf.		Sewer Cont.	
Horiz. Steel Reinf.		Permit No.      Date	
Framing		Rough Soil	
Ext. Lath		Rough Water	
Roof Sheathing		Top-Out	
Ext. Brown		Rough Gas	
Insulation		A/C Rough Duct	
Drywall		Final Plumbing	
Final Building <i>exp 3/1/89</i>		Final Gas	
Appr. for Occu.		Final Air Cond.	
ELECTRICAL		Final Sewer	
Temp. Pole cont.		REMARKS	
Permit No.      Date			
Inspection      Date			
Electrical Cont.			
Permit No.      Date			
Rough		PLEASE NOTE ADDITIONAL REMARKS ON REVERSE SIDE	
Final Electrical		DEPT. OF BLDG. & SAFETY CITY OF LAS VEGAS REV 82-3-29	
Temporary Service			