

6249 Espinosa

L 5 B12 Sub Char Hgts. 51-H Zone R-1

B. Gatewood 4-9-79

CITY OF LAS VEGAS, NEVADA

15-19 T-11-3

CONST. VAL. \$ 22,400

DEPARTMENT OF PUBLIC SERVICES  
DIVISION OF BUILDING AND SAFETY

APPLICATION & BUILDING PERMIT - for  
Dwellings, Duplexes, Misc. Residential Const.

ADDRESS OF CONSTRUCTION: 6249 Espinosa Ave.

OWNER: Nevada Young American Homes, Inc.

LOT(s) 5 BLOCK 12 SUBDIVISION Charleston Heights 51-H ZONE R-1

Existing structure on lot: Dwelling  Accessory Bldgs.  Vacant Lot  Other

PROPOSED CONSTRUCTION: SFD USE: Res.

MATERIALS OF CONSTRUCTION: Wood Frame  Concrete Block  Reinforced Concrete  Steel Frame

SQUARE FEET OF FLOOR AREAS: 1st 1,054 2nd 3rd Other 320 TOTAL SQ. FT. 1,376

FIRE ZONE: 3 Occupancy Group: R-3 CONST. TYPE: 5-N

ARCHITECT: ENGINEER: NO. of UNITS 1 NO. of STORIES 1

Plans Submitted: Yes  No  Calculations Submitted: Yes  No  Sewer Fee Req'd.: Yes  No

CONTRACTOR: Nevada Young American Homes STATE LICENSE # 10390A CITY LICENSE # C 11-448

ADD'L. PERMITS REQ'D.: Air Cond.  Elec.  Plumbing  Signs  Paving  Fence  Public Walks  Curb/gutters   
Incinerators  Fire Sprinkling System

"See Attached Plot Plan"  
#1056 Rev.  
Width Ft.  
Front property line

CONDITIONS OF THE PERMIT:

- I agree to call the City Building Department for inspections before concrete is poured, before rough wiring, electrical, plumbing, framing is covered, Also for Air conditioning, drywall and heating inspection.
- I agree that when the job is completed that I will call for final inspection before occupancy.
- I agree to perform all construction in accordance with City Ordinances and Building Codes.
- The Contractor's signature below denotes authority from the owner to sign in his behalf and that the owner is aware of all requirements of this application and permit. Separate permits must be taken out for work outlined above this agreement.
- I have read and understand the contents of this application and permit; I hereby state that the information I have supplied on this application is true and correct.

Approval for the work under this permit will be given only after refuse and debris have been removed from job site and public right of way.

SIGNED: Nevada Young American Homes, Inc. Contractor

BY: Norman P. Peterson Agent or Owner

PLANNING DEPT. Date: 7-25-78

PUBLIC WORKS DEPT. Charles J. Junk Date: 7/26/78

BUILDING DIVISION: Date: 8-1-78

PERMIT NO.: 8462-173A PERMIT FEE \$ 103.00

154-01-220

RECEIPT  
MUST BE MACHINE VALIDATED

B. Gatewood 4-9-79

# CITY OF LAS VEGAS, NEVADA

15-19 T-11-3  
LOG NO. & AREA

CONST. VAL. \$ 22,400

DEPARTMENT OF PUBLIC SERVICES  
DIVISION OF BUILDING AND SAFETY

APPLICATION & BUILDING PERMIT - for  
Dwellings, Duplexes, Misc. Residential Const.

ADDRESS OF CONSTRUCTION: 6249 Espinosa Ave.

OWNER: Nevada Young American Homes, Inc.

LOT(s) 5 BLOCK 12 SUBDIVISION Charleston Heights 51-H ZONE R-1

Existing structure on lot: Dwelling  Accessory Bldgs.  Vacant Lot  Other

PROPOSED CONSTRUCTION: SFD USE: Res.

MATERIALS OF CONSTRUCTION: Wood Frame  Concrete Block  Reinforced Concrete  Steel Frame

SQUARE FEET OF FLOOR AREAS: 1st 1,054 2nd 3rd Other 320 TOTAL SQ. FT. 1,376

FIRE ZONE: 3 Occupancy Group: R-3 CONST. TYPE: 5-N

ARCHITECT: ENGINEER: NO. of UNITS 1 NO. of STORIES 1

Plans Submitted: Yes  No  Calculations Submitted: Yes  No  Sewer Fee Req'd: Yes  No

CONTRACTOR: Nevada Young American Homes STATE LICENSE # 10390A CITY LICENSE # C 11-448

ADD'L. PERMITS REQ'D.: Air Cond.  Elec.  Plumbing  Signs  Paving  Fence  Public Walks  Curbs/gutters   
Incinerators  Fire Sprinkling System

### CONDITIONS OF THE PERMIT:

"See Attached Plot Plan"  
#1056 Rev.  
Width Ft.  
Front property line

- I agree to call the City Building Department for inspections before concrete is poured, before rough wiring, electrical, plumbing, framing is covered. Also for Air conditioning, drywall and heating inspection.
- I agree that when the job is completed that I will call for final inspection before occupancy.
- I agree to perform all construction in accordance with City Ordinances and Building Codes.
- The Contractor's signature below denotes authority from the owner to sign in his behalf and that the owner is aware of all requirements of this application and permit. Separate permits must be taken out for work outlined above this agreement.
- I have read and understand the contents of this application and permit. I hereby state that the information I have supplied on this application is true and correct.

Approval for the work under this permit will be given only after refuse and debris have been removed from job site and public right of way.

SIGNED: Nevada Young American Homes, Inc. Contractor

BY: Norman Peterson Agent or Owner

PLANNING DEPT. *[Signature]* Date: 7-25-78

PUBLIC WORKS DEPT. *Charles J. [Signature]* Date: 7-26-78

BUILDING DIVISION: *[Signature]* Date: 8-1-78

PERMIT NO.: 8462-173A PERMIT FEE \$ 103.00

154-01-220

RECEIPT

MUST BE MACHINE VALIDATED

H. Gatewood 4-9-79

# CITY OF LAS VEGAS, NEVADA

## DEPARTMENT OF PUBLIC SERVICES—ELECTRICAL APPLICATION & PERMIT DIVISION OF BUILDING AND SAFETY

ADDRESS OF CONSTRUCTION: 6249 Espinosa Ave. OWNER'S NAME: Young American Homes

CIRCLE: New Bldg; Add'n.; Remodel; TYPE OF BLDG.: SFD. APT. PUBLIC COMM.

CONTRACTOR'S NAME: Roberts Electric Company STATE LICENSE # 4528 CITY LICENSE # 3392

NUMBER	FIXTURE OR INSTALLATION	UNIT PRICE	TOTAL
	Rm addition, carport or garage enclosure	4.00	
	Temporary power	4.00	
41	Light, receptacle or switch outlet	.20	8.20
	Wall or ceiling space heater	.35	
1	Garbage grinder outlet	.35	.35
1	Dishwasher outlet	.35	.35
	Clothes dryer outlet	.35	
	Automatic clothes washer	.35	
	Electric range outlet	.35	
	Electric water heater outlet	.35	
	Special purpose outlet	.35	
	X-ray unit and its appurtenances	5.00	
	Watts of festoon lighting (Watts) First 3,000 watts for each additional thousand watts	4.00 1.50	
	Horsepower each motor first horsepower or less for each additional horsepower	1.75 .35	
1	Electric service (including any single meter socket) for each additional socket	3.00 .35	3.00
1	Air conditioning service	1.50	1.50
	Each KW(KVA) Generator (Transformer, Welder) First 100 KVA for each additional KW(KVA)	2.00 .01	
	Speaker, signal or alarm outlet	.15	
	Amplifiers	.50	
	Control panels	.25	
	Main control racks	1.00	
	T.V. and radio antennas-master system only	.75	
	Minimum fee for any permit	4.00	
	<b>TOTAL FEE</b>		<b>13.40</b>

Approval for the work under this permit will be given only after refuse and debris have been removed from job site and public right of way.

I hereby certify that I have carefully examined and read the above application; that the same is true and correct; and that the work herein described is to be done in accordance with all the provisions of the applicable Ordinances of the City of Las Vegas, Nevada and State laws whether herein specified or not.

SIGNED: R. D. Waugh DATE July 28, 1978  
MASTER (ELECTRICIAN) (TECHNICIAN) (OWNER)

BUILDING DIVISION: M12 DATE 8-1-78

PERMIT NO.: 8376-28 PERMIT FEE: \$ 13.40

### RECEIPT

MUST BE MACHINE VALIDATED

M. Batewood 4-9-79

# CITY OF LAS VEGAS, NEVADA

## DEPARTMENT OF PUBLIC SERVICES - ELECTRICAL APPLICATION & PERMIT DIVISION OF BUILDING AND SAFETY

ADDRESS OF CONSTRUCTION: 6249 Espinosa Ave. OWNER'S NAME: Young American Homes

CIRCLE: New Bldg; Add'n.; Remodel; TYPE OF BLDG.: SFD. APT. PUBLIC COMM.

CONTRACTOR'S NAME: Roberts Electric Company STATE LICENSE #: 4528 CITY LICENSE #: 3392

NUMBER	FIXTURE OR INSTALLATION	UNIT PRICE	TOTAL
	Rm addition, carport or garage enclosure	4.00	
	Temporary power	4.00	
41	Light, receptacle or switch outlet	.20	8.20
	Wall or ceiling space heater	.35	
1	Garbage grinder outlet	.35	.35
1	Dishwasher outlet	.35	.35
	Clothes dryer outlet	.35	
	Automatic clothes washer	.35	
	Electric range outlet	.35	
	Electric water heater outlet	.35	
	Special purpose outlet	.35	
	X-ray unit and its appurtenances	5.00	
	Watts of festoon lighting (Watts) First 3,000 watts for each additional thousand watts	4.00 1.50	
	Horsepower each motor first horsepower or less for each additional horsepower	1.75 .35	
1	Electric service (including any single meter socket) for each additional socket	3.00 .35	3.00
1	Air conditioning service	1.50	1.50
	Each KW(KVA) Generator (Transformer, Welder) First 100 KVA for each additional KW(KVA)	2.00 .01	
	Speaker, signal or alarm outlet	.15	
	Amplifiers	.50	
	Control panels	.25	
	Main control racks	1.00	
	T.V. and radio antennas-master system only	.75	
	Minimum fee for any permit	4.00	
	<b>TOTAL FEE</b>		<b>13.40</b>

Approval for the work under this permit will be given only after refuse and debris have been removed from job site and public right of way.

I hereby certify that I have carefully examined and read the above application; that the same is true and correct; and that the work herein described is to be done in accordance with all the provisions of the applicable Ordinances of the City of Las Vegas, Nevada and State laws whether herein specified or not.

SIGNED: ORL Waugh DATE July 28, 1978  
 MASTER (ELECTRICIAN) (TECHNICIAN) (OWNER)

BUILDING DIVISION: M12 DATE 8-1-78

PERMIT NO.: 8376-28 PERMIT FEE: \$ 13.40

RECEIPT

MUST BE MACHINE VALIDATED

M. Gatewood 4-9-79

CITY OF LAS VEGAS, NEVADA

15-12

DEPARTMENT OF PUBLIC SERVICES - APPLICATION AND PERMIT FOR PLUMBING  
DIVISION OF BUILDING AND SAFETY

ADDRESS OF CONSTRUCTION: 6249 ESPINOSA AVE OWNER'S NAME: YOUTH AMERICAN HOMES

CIRCLE: New Bldg. Add'n.; Remodel; TYPE OF BLDG. SFD APT. PUBLIC COMM.

CONTRACTOR'S NAME: UNITED PLUMBING STATE LICENSE # 1295 CITY LICENSE # 904

UNITS	DESCRIPTION	FEE	TOTAL
2	Bathtub	1.00	2-
	Shower	1.00	
2	Lavatory	1.00	2-
2	Toilet	1.00	2-
	Urinal	1.00	
	Floor Drain	1.00	
	Floor Sink	1.00	
	Wash Tray	1.00	
1	Sink	1.00	1-
	Garbage Disposal	1.00	
	Garbage Disposal (comm.)	3.00	
	Clothes Dryer (gas)	1.00	
1	Clothes Washer	1.00	1-
	Clothes Washer (comm.)	5.00	
	Dishwasher	1.00	
	Dishwasher (commercial)	5.00	
	Dental Unit	10.00	
	Drinking Fountain	1.00	
	Any Water using Equipment	1.00	
1	Water Heater (gas) (elect.)	1.00	1-
1	Sewer System - New, Replacement, or any Drainage System	4.00	4-
	Grease or Sand Trap	2.00	
	Trailer Trap	2.00	
	Septic Disposal System	4.00	
WATER SOFTENERS			
	Nonpermanent Type	4.00	
	Permanent Type, connected to Drainage	5.00	
SWIMMING POOLS			
	Private or Wading Pool	10.00	
	Public or Semi-public	20.00	

UNITS	DESCRIPTION	FEE	TOTAL
WATER DISTRIBUTION SYSTEM			
1	Single Family Dwelling	4.00	4-
	Multiple Family Dwelling plus each unit	4.00 2.00	
	Commercial Bldg. per floor	6.00	
	Hotel or Motel plus each bath	4.00 1.50	
	Trailer Park plus each space	20.00 1.00	
	Irrigation	4.00	
GAS PIPING SYSTEM			
1	Single Family Dwelling	3.00	3-
	Multiple Family Dwelling plus each unit	6.00 1.00	
	Commercial Bldg. per floor plus each unit	3.00 3.00	
	Gas Appliance (any type)	1.00	
AUTOMATIC FIRE EXTINGUISHING SYSTEM			
	Underground Piping	10.00	
	Distribution Piping ea. ft.	.01	
	Sprinkler Head each	10	
	In Range Hood and Vent	5.00	
DRY STANDPIPE SYSTEM			
	Piping	50.00	
	Each Outlet	1.00	
WET STANDPIPE SYSTEM			
	Piping	5.00	
	Fire Hose Cabinet	1.00	
	MINIMUM PERMIT FEE	4.00	
PIPELINE CONTRACTOR, SECT. 14 B.P.F. S.			
TOTAL PERMIT FEES			20-

I hereby certify that I have carefully examined and read the above application, that the same is true and correct, and that the work herein described is to be done in accordance with all the provisions of the applicable Ordinances of the City of Las Vegas, Nevada and the State Laws, whether herein specified or not.

Approval for the work under this permit will be given only after refuse and debris have been removed from job site and public right of way.

Signed: J. Paris Date: 8-2-78  
Registered Master Plumber, Spec. Contr. or Owner

Building Division: SM Date: 8-8-78

Permit No. 8602-18 Permit Fee \$ 20.00

154-01-222

RECEIPT

MUST BE MACHINE VALIDATED

M. Gatewood 4-9-79

### CITY OF LAS VEGAS, NEVADA

#### DEPARTMENT OF PUBLIC SERVICES - AIR CONDITIONING APPLICATION & PERMIT DIVISION OF BUILDING AND SAFETY

ADDRESS OF CONSTRUCTION: Lot 5 Blk 12 OWNER'S NAME: Nevada Young American Homes  
6249 Espinosa Ave.

CIRCLE: Addition; Remodel; New Bldg; TYPE OF BLDG.: SFD APT. COMM. PUBLIC

CONTRACTOR'S NAME: Nicosia Air Conditioning Co. STATE LICENSE # 7605 CITY LICENSE # 8351

UNITS	DESCRIPTION	FEE	TOTAL	UNITS	DESCRIPTION	FEE	TOTAL
	Unit heater - floor, wall or suspended	4.00		EVAPORATIVE COOLERS:			
	FOR EACH FORCED-AIR OR GRAVITY-TYPE FURNACE OR BURNER, INCLUDING DUCTS AND VENT ATTACHED TO SUCH APPLIANCES:				5 outlets or under	3.00	
	Up to and including 100,000 B.t.u.'s	4.00			Over 5 and up to and including 10	5.00	
	Over 100,000 B.t.u.'s	6.00			Each additional outlet over 10	.25	
	FOR EACH HEATING APPLICATION, REFRIGERATION UNIT, COMFORT COOLING AND HEATING UNIT, ABSORPTION UNIT, COMPRESSOR OR BOILER:			VENTILATION:			
1	Up to and including 3 ton or horsepower, or absorption system up to and including 100,000 B.t.u.'s	4.00	4.00		For each fan connected to a single duct	1.00	
	Over 3 ton or 3 horsepower up to and including 10, or absorption system over 100,000 B.t.u.'s up to and including 250,000 B.t.u.'s	7.00			For each commercial or industrial ventilation system	5.00	
	Over 10 ton or 10 horsepower up to and including 30, or absorption system over 250,000 B.t.u.'s up to and including 1,000,000 B.t.u.'s	12.00			For each commercial kitchen hood	5.00	
	Over 30 ton or 30 horsepower up to and including 50, or absorption system over 1,000,000 B.t.u.'s up to and including 1,700,000 B.t.u.'s	20.00		MISCELLANEOUS:			
	Over 50 ton or 50 horsepower, or absorption system over 1,700,000 B.t.u.'s	30.00			For each water cooling tower	8.00	
	FOR EACH AIR HANDLING UNIT INCLUDING DUCTS ATTACHED THERETO:				Duct work only - each opening	.25	
	Up to and including 10,000 CFM	2.00			For installation or relocation of each commercial or industrial incinerator	15.00	
	Over 10,000 CFM	4.00			Gas piping related to the air cond. work in single family dwelling only	3.00	
					For each appliance, piece of equipment, any mechanical work or alteration or replacement not included in this schedule, the permit fee shall be computed the same as building permit fees by using the cost of installation for the valuation amount.		
				FOR THE ISSUANCE OF EACH PERMIT			3.00
TOTAL PERMIT FEE \$							7.00

I hereby certify that I have carefully examined and read the above application; that the same is true and correct; and that the work herein described is to be done in accordance with all the provisions of the applicable Ordinances of the City of Las Vegas, Nevada and the State Laws whether herein specified or not.

Approval for the work under this permit will be given only after refuse and debris have been removed from job site and public right of way.

SIGNED M. Gatewood Date 8-15-78  
Air Conditioning Contractor - Owner

BUILDING DIVISION M.S. Date 8-16-78

PERMIT NO. 8778-10 PERMIT FEE \$ 7.00

RECEIPT  
  
  
  
  
  
  
  
  
  
MUST BE MACHINE VALIDATED

#12890

J. Jones 10/12/11

DIVISION of BUILDING & SAFETY - CITY of LAS VEGAS, NEVADA

OWNER Ne. Am Young Homes ADDRESS 6249 Espinosa Ave. DATE 8-2-78  
GEN. CONT. Same TYPE OF STRUCTURE SFD  
PERMIT NO. 8462-17 LEGAL DESCRIPTION L-5 B-12 Charleston Heights 51-H

BUILDING	MECHANICAL	ELECTRICAL
Investigation	Plumbing Cont. <u>United</u>	Temp. pole cont.
Location & Footing <u>K.P. 11-78</u>	Permit No. <u>8602-18</u> Date <u>8-8-78</u>	Permit No. _____ Date _____
Stem Wall <u>K.P. 22-28</u>	Heat & Vent. A/C Cont. <u>Misc</u>	Inspection _____ Date _____
Concrete Slab Floor <u>K.P. 9-11-78</u>	Permit No. <u>8728-19</u> Date <u>8-16-78</u>	Electrical Cont. <u>Roberts</u>
Floor Framing	Sewer Cont. <u>Young Am. Homes</u>	Permit No. <u>8526-28</u> Date <u>8-1-78</u>
Fireplace Footing	Permit No. <u>8462</u> Date _____	Fixtures Cont. _____
Chimney Steel	Rough Soil <u>J.P. 25-78</u>	Permit No. _____ Date _____
Vert. Steel Reinf.	Rough Water _____	Slab _____
Horiz. Steel Reinf.	Top Out <u>MC 10-26-78</u>	Rough <u>J.P. 11-78</u>
Roof Sheathing <u>R.P. 16-12-78</u>	Rough Gas <u>MC 11-26-78</u>	Final Rough _____
Framing <u>K.P. 30-78</u>	A/C Rough Duct <u>MC 10-26-78</u>	Final Fixture _____
Backing for siding	Ref. Rough Piping _____	Final Electrical <u>CW 79-79 L.P. 79</u>
Ext. Lath <u>R.P. 15-78 R.P. 11-78</u>	Final Plumbing <u>J.P. 1-8-79</u>	Temporary Service _____
Ext. Scratch	Final Gas <u>J.P. 1-9-79</u>	MISCELLANEOUS
Ext. Brown <u>B.P. 12-20-78</u>	Final Air Cond. <u>J.P. 1-9-79</u>	Grading & Drainage _____
Int. Lath	Final Refrig. _____	On Site Parking Spaces _____ App. _____
Int. Brown	Final Sewer <u>J.P. 8-2-78</u>	Eng. Approval of _____
Drywall <u>R.P. 15-78 R.P. 11-78</u>	Final Septic Tank _____	Off Site Improvements _____
Insulation <u>R.P. 1-3-78</u>		
Final Building <u>J.P. 1-2-78</u>		
Appr. for Occu. _____		

INSPECTOR: \_\_\_\_\_ DATE \_\_\_\_\_

APPROVED FOR OCCUPANCY & METER J.K. 1-8-79

PLEASE NOTE REMARKS ON REVERSE SIDE 6249 Espinosa Ave, 1-11-3 LOG # \_\_\_\_\_ AREA # \_\_\_\_\_ 76-11-4

Nesli Ingham 3-28-85

# CITY OF LAS VEGAS, NEVADA

LOG NO. & AREA 1092  
277  
1365 DATE 01A-332-039 CONST. VAL. \$ 1,365

DEPARTMENT OF BUILDING AND SAFETY PHONE 386-6251  
FOR: Fence, Wall, Retaining Wall

ADDRESS OF CONSTRUCTION 6249 Espinosa OWNER Steven Scott

CONTRACTOR Danner STATE LICENSE NO. Charly's 5116 CITY LICENSE NO. \_\_\_\_\_

LOT(s) 5 BLOCK 1 SUBDIVISION Charly's 5116 ZONE R-1

PROPOSED CONSTRUCTION: Blk  
BUILDING PERMIT NO. 6638 ENGINEER \_\_\_\_\_

Approval for the work under this permit will be given only after refuse and debris have been removed from job site and public right of way.

TOTAL SQUARE FEET: 546 TOTAL LINEAL FEET: 91

Remarks:  
\_\_\_\_\_  
\_\_\_\_\_  
\_\_\_\_\_

### OTHER INSPECTIONS AND FEES

1. Inspections outside of normal business hours = \$25.00 per hour (minimum charge 1/2 hour)
2. Re-inspection fee during normal business hours assessed under provisions of TABLE 3-A of the Uniform Building Code = \$15.00 each
3. Inspections during normal business hours for which no fee is specifically indicated = \$15.00 per hour (minimum charge one half hour)
4. Additional plan review required by changes, additions or revisions at approved plans = \$25.00 per hour (minimum charge two hours)

DL - OK

### CONDITIONS OF THE PERMIT:

1. Any type of retaining wall must be engineered by a Civil or Structural Engineer.
2. If a home owner takes out the Building Permit and if the owner sublets the work to a Contractor, then the Contractor must take out the permit and pay for it.
3. No fence or wall can be built on City property or rights-of-way, but this is not intended to preclude construction within utility easements if utilities will not be damaged or made inaccessible.
4. The fence or wall shall not enclose any water meter, light standard, or fire alarm box and shall not come closer than 24" from the nearest fire hydrant outlet.
5. Department Inspectors must approve footings before concrete is poured and block wall reinforcing before grouting is done.
6. Maximum height of any wall or fence is 6' side and rear yards; 4' maximum in front yard with the vertical surface above the height of 2' - 50% open.
7. Must not obstruct required onsite parking space (2 spaces for each dwelling unit) by the erection of this fence or wall.
8. By the signing of this application I herewith agree to the requirements outlined above.

Wall must conform to CUL Specs.

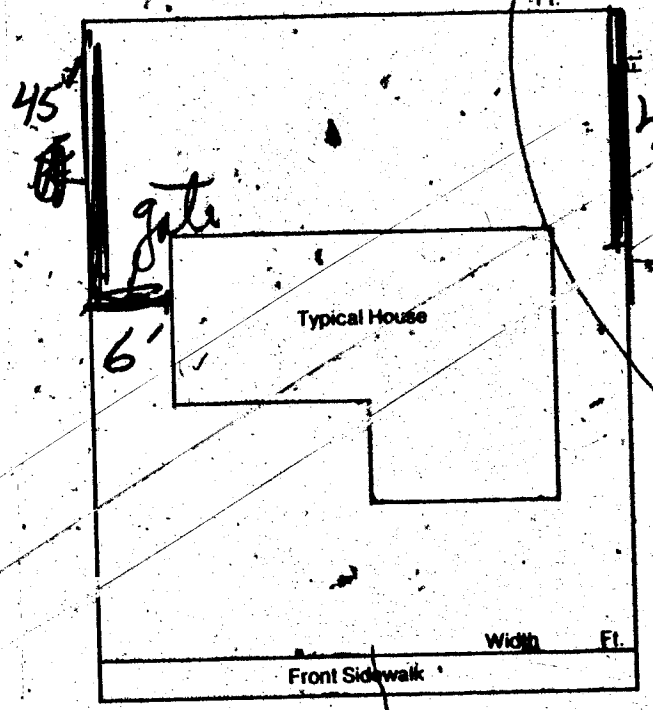

RECEIPT  
\*\*0004\*\*  
WALL 32.50  
CASH 32.50  
6638A000 15:51

03/27/85

SIGNED Steven Scott CONTRACTOR - AGENT - ENGINEER

PLANNING DEPT. J. K. Bloom DATE 3/27/85

BUILDING DEPT. Craig Moore DATE 3/27/85

I hereby certify that I have reviewed this application and the proposed plans and have found that the proposed development meets the requirements of the City of Las Vegas Flood Hazard Reduction Ordinance for the issuance of this Development Permit. 2310-2401

SA 3-27-85  
LAND DEVELOPMENT AND FLOOD CONTROL ENGINEER DATE

PLAN REVIEW FEE \_\_\_\_\_  
PERMIT FEE 32.50  
TOTAL FEES 32.50

MUST BE MACHINE VALIDATED

Permit Expires 180 Days After Abandonment of Work

*Steven Scott* *6-20-85*

[Empty box]

**FENCES & RETAINING WALLS**

Contractor <b>Steven Scott</b>		DATE <b>3-27-85</b>
Address <b>6299 Espinosa</b>		
Inspector <b>[unclear]</b>	Sheet No. <b>0000</b>	Lot No.
Project Name <b>[unclear]</b>		
Notes (add, amend, delete & quantity with)		
Location <b>DB4-48</b>	Qty	Unit
Item <b>1st</b>	Qty	Unit
Item <b>2nd</b>	Qty	Unit
Item <b>3rd</b>	Qty	Unit
Item <b>4th</b>	Qty	Unit
Item <b>5th</b>	Qty	Unit
Item <b>6th</b>	Qty	Unit
Item <b>7th</b>	Qty	Unit
Item <b>8th</b>	Qty	Unit
Item <b>9th</b>	Qty	Unit
Item <b>10th</b>	Qty	Unit
<p style="text-align: center;"><b>DD-6-20-85</b></p>		
<p style="text-align: center;"><b>[Signature]</b></p>		