

4203 EL CONLON

LOT 19 BK 10 LAS VERDES HGTS #6 ZONE R-1

M. Gatewood 3-28-79

CITY OF LAS VEGAS, NEVADA

LOG NO. & AREA 9 DEPARTMENT OF BUILDING & SAFETY CONST. VAL. \$ 900

APPLICATION & BUILDING PERMIT - for: Dwellings, Duplexes, Misc. Residential Const.

ADDRESS OF CONSTRUCTION: 4203 El Condon OWNER: Wm Hallinger

LOT(s) 19 BLOCK 10 SUBDIVISION 4th HTS 6th Unit 1 ZONE: R-1

Existing structure on lot: Dwelling Accessory bldgs Vacant lot Other

PROPOSED CONSTRUCTION: Wood Patio Cover 10x40 USE: Patio

MATERIALS OF CONSTRUCTION: Wood Frame Concrete Block Reinforced Concrete Steel Frame

SQ. FEET OF FLOOR AREAS: 1st 400 2nd 0 3rd 0 Other 0 TOTAL SQ. FT. 400

FIRE ZONE: 1 2 3 Occupancy Group 1 J 1-2 CONST. TYPE I II III IV V

ARCHITECT: Quiner ENGINEER: _____ NO. of UNITS _____ NO. of STORIES _____

Plans Submitted: Yes No Calculations Submitted: Yes No Sewer Fee Req'd: Yes No

CONTRACTOR: _____ STATE LICENSE # _____ CITY LICENSE # _____

ADD'L. PERMITS REQ'D: Air Cond. Elec. Plumbing Signs Paving Fence Public Walks Curb-gutters Incinerators Fire Sprinkling System

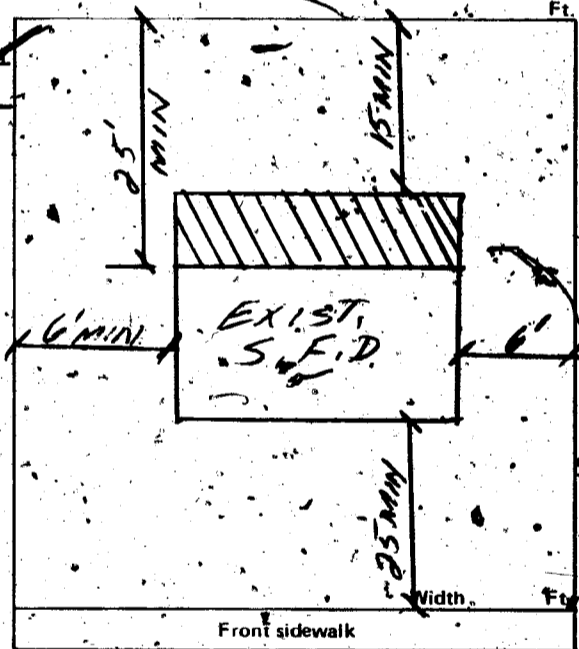

CONDITIONS OF THE PERMIT:

- 1. I agree to call the City Building Department for inspections before concrete is poured, before rough wiring, electrical, plumbing, framing is covered. Also for air conditioning, sheet-rock and sheathing inspection.
2. I agree that when the job is completed that I will call for final inspection before occupancy.
3. I agree to perform all construction in accordance with City Ordinances and Building Codes.
4. The Contractor's signature below denotes authority from the owner to sign in his behalf, and that the owner is aware of all requirements of this application and permit. Separate permits must be taken out for work outlined above this agreement.
5. I have read and understand the contents of this application and permit; I hereby state that the information I have supplied on this application is true and correct.

Approval for the work under this permit will be given only after refuse and debris have been removed from job site and public right of way.

SIGNED: _____ Contractor

BY: Wm Hallinger Agent or Owner

CLARK COUNTY HEALTH DEPT. Date _____

LAS VEGAS FIRE DEPARTMENT Date _____

PLANNING DEPT.: _____ Date: 4/8/75

PUBLIC WORKS DEPT.: _____ Date: _____

BUILDING DEPT.: WRP Date: 4/8/75

12850 PERMIT NO.: 1302 PERMIT FEE \$ 1100.

RECEIPT 3384 \$011.00 - 8 CITY OF LAS VEGAS DEPT. OF BUILDING & SAFETY MUST BE MACHINE VALIDATED - 8 APR 75

DEPT. of BLDG. & SAFETY - CITY of LAS VEGAS, NEVADA

OWNER: Wm Gallinger ADDRESS: 4203 El Conlon DATE: 4-8-75
 GEN. CONT. Owner TYPE OF STRUCTURE wood patio cover
 PERMIT NO. XX 1302 LEGAL DESCRIPTION L 19 B 10 LIV. Hts 6 Unit # 1

BUILDING	MECHANICAL	ELECTRICAL
Investigation	Plumbing Cont.	Temp. pole cont.
Location Footing	Permit No. _____ Date _____	Permit No. _____ Date _____
Stem Wall	Heat & Vent. A/C Cont.	Inspection _____ Date _____
Concrete Slab Floor	Permit No. _____ Date _____	Electrical Cont.
Floor Framing	Sewer Cont.	Permit No. _____ Date _____
Fireplace Footing	Permit No. _____ Date _____	Fixtures Cont.
Chimney Steel	Rough Soil	Permit No. _____ Date _____
Vent. Steel Reinf.	Rough Water	Slab
Horiz. Steel Reinf.	Top-Out	Rough
Roof Sheathing	Rough Gas	Final Rough
Framing	A/C Rough Duct	Final Fixture
Backing for Lathing	Ref. Rough Piping	Final Electrical
Ext. Lath	Final Plumbing	
Ext. Scratch	Final Gas	Temporary Service
Ext. Brown	Final Air Cond.	
Int. Lath	Final Refrig.	MISCELLANEOUS
Int. Brown	Final Sewer	
Drywall	Final Septic Tank	Grading & Drainage
Permit No.		On-Site Parking Spaces _____ APP. _____
Final Building		Eng. Approval of _____
Appr. for Occy.		Off Site Improvements _____

INSPECTOR: _____

DATE _____

APPROVED FOR OCCUPANCY & METER _____

PLEASE NOTE REMARKS ON REVERSE SIDE

4203 El Conlon

LOG # _____

AREA # _____

DEPT. of BLDG. & SAFETY - CITY of LAS VEGAS, NEVADA

OWNER: MIRANTI INVESTMENT CO. ADDRESS: 4203 El Conlon Ave. DATE: 6-21-62
 GEN. CONT. Miranti Const. Co. TYPE OF STRUCTURE S.F. DWL.
 PERMIT NO. 10858 LEGAL DESCRIPTION Lot 19 Block 10 Las Verdias #6 Unit #1

BUILDING	MECHANICAL	ELECTRICAL
LOCATION	PLUMBING CONT.	TEMP POLE CONT.
FIREPLACE ETC.	PERMIT NO. <u>8529</u> DATE <u>12-28-62</u>	PERMIT NO. _____ DATE _____
FOOTINGS	HEAT & VENT. AC CONT.	INSPECTION _____ DATE _____
FOUNDATION WALL	PERMIT NO. <u>4313</u> DATE <u>9-26-62</u>	ELECTRICAL CONT.
STEM WALL	SEWER CONT.	PERMIT NO. <u>1337</u> DATE <u>1-21-62</u>
FLOOR FRAMING	PERMIT NO. _____ DATE _____	FIXTURES CONT.
SLAB	ROUGH SOIL	PERMIT NO. <u>1337</u> DATE <u>1-21-62</u>
CHIMNEY STEEL (FIREPLACE)	ROUGH WATER	SLAB
WALL STEEL	TOP-OUT	ROUGH
COLUMN STEEL	ROUGH GAS	FINAL ROUGH
BEAM STEEL	AC ROUGH DUCT	FINAL FIXTURE
STEEL FABRICATION	REF. ROUGH PIPING	TEMPORARY SERVICE
FRAMING	FINAL PLUMBING	
ROOF SHEATHING	FINAL GAS	MISCELLANEOUS
	FINAL AIR COND.	URBAN REDEVELOPMENT APPROVAL
DRYWALL	FINAL REFRIG.	<input type="checkbox"/>
LATHING	FINAL SEWER	
BACKING (SIDING)	FINAL SEPTIC TANK	GRADING & DRAINAGE
PLASTER		ON-SITE PARKING SPACES _____ APP. _____
SCRATCH		ENG. APPROVAL OF _____
BROWN		OFF-SITE IMPROVEMENTS _____
FINAL BLDG		

APPROVED FOR OCCUPANCY _____

INSPECTOR _____

DATE _____

APPROVED FOR METER _____

PLEASE NOTE REMARKS ON REVERSE SIDE

LOG # _____

AREA # _____

23.04

4203 El Conlon Ave.

T-32

4