

8216 BUCCANEER LANE

LOT 30 BK 5 CHARLESOTN RAINBOW 18 C ZONE R-1

7 Maria Coley August 8, 1980

### CITY OF LAS VEGAS, NEVADA

LOG NO. & AREA T21 4/80 CONST. VAL. \$ 40,465.00

DEPARTMENT OF PUBLIC SERVICES  
DIVISION OF BUILDING AND SAFETY

APPLICATION & BUILDING PERMIT - for:  
Dwellings, Duplexes, Misc. Residential Const.

ADDRESS OF CONSTRUCTION: 8216 Buccaneer Lane OWNER: Sproul Homes of Nevada

LOT(S) 30 BLOCK 4 SUBDIVISION Charleston Rainbow 18C ZONE: R-1

Existing structure on lot: Dwelling  Accessory Bldgs.  Vacant Lot  Other

PROPOSED CONSTRUCTION: Single Family Dwelling w/F.P. USE: Same

MATERIALS OF CONSTRUCTION: Wood Frame  Concrete Block  Reinforced Concrete  Steel Frame

SQUARE FEET OF FLOOR AREAS: 1st 1394 2nd 480 Other 122 TOTAL SQ. FT. 1996

FIRE ZONE: R-3 Occupancy Group R-3 CONST. TYPE: V-N

ARCHITECT: \_\_\_\_\_ ENGINEER: \_\_\_\_\_ NO. of UNITS 1 NO. of STORIES 1

Plans Submitted: Yes  No  Calculations Submitted: Yes  No  Sewer Fee Req'd.: Yes  No

CONTRACTOR: Sproul Homes of Nevada STATE LICENSE # 6011B CITY LICENSE # 6427

ADD'L. PERMITS REQ'D.: Air Cond.  Elec.  Plumbing  Signs  Paving  Fence  Public Walks  Curb-gutters   
Incinerators  Fire Sprinkling System

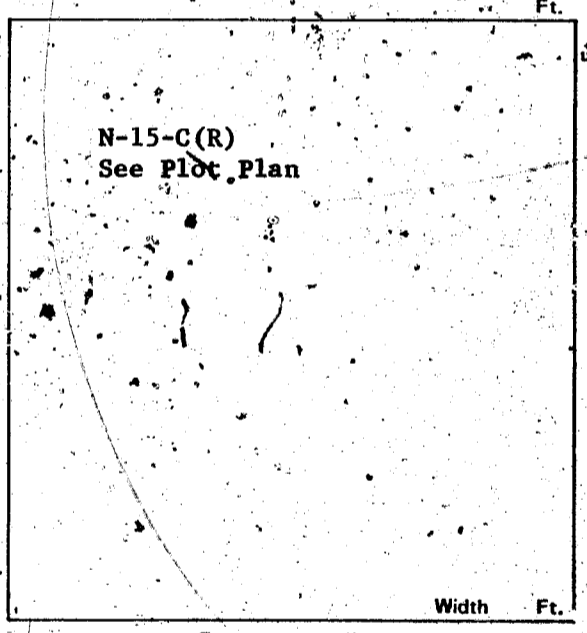

#### CONDITIONS OF THE PERMIT:

- I agree to call the City Building Department for inspections before concrete is poured, before rough wiring, electrical, plumbing, framing is covered. Also for Air conditioning drywall and sheathing inspection.
- I agree that when the job is completed that I will call for final inspection before occupancy.
- I agree to perform all construction in accordance with City Ordinances and Building Codes.
- The Contractor's signature below denotes authority from the owner to sign in his behalf and that the owner is aware of all requirements of this application and permit. Separate permits must be taken out for work outlined above this agreement.
- I have read and understand the contents of this application and permit. I hereby state that the information I have supplied on this application is true and correct.

Approval for the work under this permit will be given only after refuse and debris have been removed from job site and public right of way.

SIGNED: Sproul Homes of Nevada Contractor  
 BY: John E. [Signature] Agent or Owner

PLANNING DEPT.: J. Brown Date: 7/29/80

PUBLIC WORKS DEPT.: WRK Date: 7/29/80

BUILDING DIVISION: M.J. Date: 7-30-80

PERMIT NO.: 4188-5 PERMIT FEE \$: 172.00

RECEIPT

MUS: BE MACHINE VALIDATED

1721-2407

30-5  
 2 Units Only August 8, 1980

# CITY OF LAS VEGAS, NEVADA

DEPARTMENT OF PUBLIC SERVICES—PLUMBING APPLICATION & PERMIT  
 DIVISION OF BUILDING AND SAFETY

ADDRESS OF CONSTRUCTION: 8216 BUCCANEER LANE OWNER'S NAME: SPROUL HOMES, INC

CIRCLE: Addition; Remodel; New Bldg TYPE OF BLDG.: SFD APT. COMM. PUBLIC

CONTRACTOR'S NAME: UNITED PLMBC STATE LICENSE # 1295 CITY LICENSE # 904

| UNITS                            | DESCRIPTION                                                         | FEE   | TOTAL |
|----------------------------------|---------------------------------------------------------------------|-------|-------|
| <b>PERMIT ISSUANCE</b>           |                                                                     |       |       |
| 1                                | For Issuing Each Permit                                             | 7.00  | 7.00  |
|                                  | For Issuing Each Supplemental Permit                                | 4.25  |       |
| <b>FIXTURE CHARGE</b>            |                                                                     |       |       |
| 1                                | Bathub                                                              | 1.50  | 1.50  |
|                                  | Shower                                                              | 1.50  | 1.50  |
| 2                                | Lavatory                                                            | 1.50  | 3.00  |
| 2                                | Toilet                                                              | 1.50  | 3.00  |
|                                  | Urinal                                                              | 1.50  |       |
|                                  | Floor Drain                                                         | 1.50  |       |
|                                  | Floor Sink                                                          | 1.50  |       |
|                                  | Wash Tray                                                           | 1.50  |       |
| 1                                | Sink                                                                | 1.50  | 1.50  |
|                                  | Garbage Disposal (residential)                                      | 1.50  |       |
|                                  | Garbage Disposal (commercial)                                       | 5.50  |       |
|                                  | Clothes Dryer (gas) (venting)                                       | 1.50  |       |
| 1                                | Clothes Washer (residential)                                        | 1.50  | 1.50  |
|                                  | Clothes Washer (commercial)                                         | 1.50  |       |
|                                  | Dishwasher (residential)                                            | 1.50  |       |
|                                  | Dishwasher (commercial)                                             | 1.50  |       |
|                                  | Dental Unit                                                         | 1.50  |       |
|                                  | Drinking Fountain                                                   | 1.50  |       |
|                                  | Refrigerator - Ice Maker, Water Dispenser                           | 1.50  |       |
|                                  | Any other water using equipment, Attached coffee Makers, Ice Makers | 1.50  |       |
| 1                                | Water Heaters (gas) (electric)                                      | 1.50  | 1.50  |
| <b>SEWER SYSTEM</b>              |                                                                     |       |       |
| 1                                | New, Replacement, Modification, or Any Drainage Work                | 7.50  | 7.50  |
|                                  | Grease or Sand Trap or Interceptor                                  | 2.00  |       |
|                                  | Trailer Trap (rental parks)                                         | 3.50  |       |
| <b>WATER SOFTENERS</b>           |                                                                     |       |       |
|                                  | Non Permanent Type (rental)                                         | 2.00  |       |
|                                  | Permanent Type (connected to drain)                                 | 2.00  |       |
| <b>SWIMMING POOLS</b>            |                                                                     |       |       |
|                                  | Private or Wading Pool (including spa)                              | 15.00 |       |
|                                  | Public or Semi-Public                                               | 25.00 |       |
|                                  | Spas - Preformed (private)                                          | 10.00 |       |
|                                  | Spas - Preformed (commercial)                                       | 15.00 |       |
| <b>WATER DISTRIBUTION SYSTEM</b> |                                                                     |       |       |
| 1                                | Single Family Dwelling                                              | 5.00  | 5.00  |
|                                  | Multi-Family Dwelling                                               | 5.00  |       |
|                                  | Plus Each Dwelling Unit                                             | 2.50  |       |
|                                  | Commercial Building per floor                                       | 3.00  |       |
|                                  | Plus Each Unit (leased space or office)                             | 6.00  |       |

| UNITS                                      | DESCRIPTION                                                                                                           | FEE           | TOTAL |
|--------------------------------------------|-----------------------------------------------------------------------------------------------------------------------|---------------|-------|
|                                            | Hotel or Motel                                                                                                        | 6.00          |       |
|                                            | Plus Each Unit                                                                                                        | 2.50          |       |
|                                            | Trailer Park                                                                                                          | 25.00         |       |
|                                            | Plus Each Space                                                                                                       | 1.50          |       |
|                                            | Irrigation                                                                                                            | 6.00          |       |
| <b>FUEL PIPING SYSTEM</b>                  |                                                                                                                       |               |       |
| 1                                          | Single Family Dwelling                                                                                                | 4.50          | 4.50  |
|                                            | Multi-Family Dwelling                                                                                                 | 8.00          |       |
|                                            | Plus Each Unit                                                                                                        | 1.50          |       |
|                                            | Commercial Building (per floor)                                                                                       | 4.50          |       |
|                                            | Plus Each Unit (leased space or office)                                                                               | 4.50          |       |
|                                            | Medium Pressure Gas System (plan check)                                                                               | 6.00          |       |
|                                            | Each Gas Appliance (any type)                                                                                         | 1.50          |       |
|                                            | Standby-Emergency (generating engines)                                                                                | 2.50          |       |
|                                            | Steam Boilers                                                                                                         | 2.50          |       |
|                                            | Service Station Fuel Tank and Piping System                                                                           | 5.00          |       |
|                                            |                                                                                                                       | 5.00          |       |
| <b>AUTOMATIC FIRE EXTINGUISHING SYSTEM</b> |                                                                                                                       |               |       |
|                                            | Underground Piping                                                                                                    | 15.00         |       |
|                                            | Distribution Piping (per foot)                                                                                        | 03            |       |
|                                            | Sprinkler Head (each)                                                                                                 | .45           |       |
|                                            | In Range Hoqd and Vent                                                                                                | 7.50          |       |
|                                            | Dry Standpipe System                                                                                                  | 62.50         |       |
|                                            | Piping                                                                                                                | 1.50          |       |
|                                            | Each Outlet                                                                                                           | 7.50          |       |
|                                            | Wet Standpipe System                                                                                                  | 1.50          |       |
|                                            | Piping                                                                                                                | 2.50          |       |
|                                            | Fire Hose Cabinet                                                                                                     | 2.50          |       |
| <b>SOLAR ENERGY SYSTEMS</b>                |                                                                                                                       |               |       |
|                                            | Collectors (including piping) (per collector)                                                                         | 2.50          |       |
|                                            | Storage Tanks (each)                                                                                                  | 2.50          |       |
| <b>PIPELINE CONTRACT</b>                   |                                                                                                                       |               |       |
|                                            | For Onsite Sewer, Gas or Water Contract Value. Fee based on Building Code Permit Valuation Chart.                     |               |       |
|                                            | Inspections for which no fee is specifically indicated (minimum charge - one half hour)                               | 7.50 per hour |       |
|                                            | Additional plan review required by changes, additions or revisions to approved plans (minimum charge - one half hour) | 7.50 per hour |       |

Plumbing permit fees may be computed the same as building permit fees by using the cost of installation for valuation amount when such work is not included in the above schedule.

I hereby certify that I have carefully examined and read the above application; that the same is true and correct; and that the work herein described is to be done in accordance with all the provisions of the applicable Ordinances of the City of Las Vegas, Nevada and the State Laws, whether herein specified or not.

Approval for the work under this permit will be given only after refuse and debris have been removed from job site and public right of way.

SIGNED: J. Davis Date: 8-4-80  
 Registered Master Plumber, Spec. Cont'r. or Owner  
 BUILDING DIVISION: Toile Date: 8/7/80  
 PERMIT NO.: 4364-30 PERMIT FEE \$: 37.50

RECEIPT

MUST BE MACHINE VALIDATED

Shaw KYRIAKOS 9-2-80

# CITY OF LAS VEGAS, NEVADA

DEPARTMENT OF PUBLIC SERVICES — ELECTRICAL APPLICATION & PERMIT  
DIVISION OF BUILDING AND SAFETY

ADDRESS OF CONSTRUCTION: 8216 Buccaneer Lane OWNER'S NAME: Sprout Homes  
 CIRCLE: Addition; Remodel; New Bldg. TYPE OF BLDG.: SFD APT. COMM. PUBLIC  
 CONTRACTOR'S NAME: Roberts Electric Company STATE LICENSE # 4528 CITY LICENSE # 3392

| UNITS | DESCRIPTION                                                                     | FEE   | TOTAL |
|-------|---------------------------------------------------------------------------------|-------|-------|
| 67    | Receptacles <u>41</u> Outlets <u>14</u> Switches <u>12</u>                      | .80   | 20.10 |
|       | Wall or Ceiling Space Heaters                                                   | .50   |       |
|       | Blast Coil Heaters (per kilowatt)                                               | .35   |       |
|       | Garbage Grinder Outlet                                                          | .50   | .50   |
|       | Trash Compactor                                                                 | .35   |       |
|       | Dishwasher Outlet                                                               | .50   | .50   |
|       | Clothes Dryer Outlet                                                            | .50   | .50   |
|       | Automatic Clothes Washer Outlet                                                 | .50   | .50   |
|       | Electric Range                                                                  | .50   | .50   |
|       | Electric Water Heater                                                           | .50   |       |
| 14    | Each Fixture or Socket                                                          | .15   | 2.10  |
|       | Each Mercury Arc Lamp and Equipment (sodium)                                    | .50   |       |
|       | Each Special Purpose Outlet                                                     | .50   |       |
|       | Each X-ray Unit and its Appurtenances                                           | 7.50  |       |
|       | Area Lighting—First 8000 Watts                                                  | 6.00  |       |
|       | For Each Additional 1000 Watts                                                  | 2.25  |       |
|       | Total Horsepower Each Motor—Generator, Transformer, Welder                      | 2.50  |       |
|       | First Horsepower or KVA                                                         | .40   |       |
|       | For Each Additional Horsepower up to 50                                         | .15   |       |
|       | For Each Horsepower over 50                                                     | .15   |       |
|       | Temporary Power and Lights — Temporary Pole                                     | 5.00  |       |
|       | Electric Service, Including First Meter Socket                                  | 4.50  | 4.50  |
|       | For Each Additional Meter Socket                                                | .40   |       |
|       | Services over 200 to 600 Amperes                                                | 6.25  |       |
|       | 600 to 1200 Amperes                                                             | 12.50 |       |
|       | over 1200 Amperes                                                               | 25.00 |       |
|       | Sub Panel                                                                       | 1.50  |       |
|       | Permanently Connected Air Conditioning Service (Heating/Cooling)                | 2.25  | 2.25  |
|       | Speaker Outlets                                                                 | .20   |       |
|       | Signal or Alarm Outlets                                                         | .25   |       |
|       | Amplifiers                                                                      | 1.25  |       |
|       | Control Panels                                                                  | .35   |       |
|       | T.V. Outlets — Master System Only                                               | .30   |       |
|       | Swimming Pool (residential)                                                     | 10.00 |       |
|       | Swimming Pool (commercial)                                                      | 15.00 |       |
|       | Spas                                                                            | 4.00  |       |
|       | Recreational Vehicles (per space)                                               | 1.50  |       |
|       | Busways—for Trolley and Plug-in Type Busways, Each 100 Feet or Fraction Thereof | 1.50  |       |
|       | Fee for issuing Each Permit                                                     | 7.00  | 7.00  |

**Other inspections and fees:**

1. Inspections outside of normal business hours = \$7.50 per hour (minimum charge two hours).
2. Re-inspection fee assessed under provisions of Section 305(f) of the Uniform Building Code = \$7.50 per hour.
3. Inspections for which no fee is specifically indicated = \$7.50 per hour (minimum charge one half hour).
4. Additional plan review required by changes, additions or revisions to approved plans = \$7.50 per hour (minimum charge one half hour).

Approval for the work under this permit will be given only after refuse and debris have been removed from job site and public right of way.

I hereby certify that I have carefully examined and read the above application; that the same is true and correct; and that the work herein described is to be done in accordance with all the provisions of the applicable Ordinances of the City of Las Vegas, Nevada and the State Laws, whether herein specified or not.

SIGNED: *[Signature]* Date: 8-22-80  
 Master (Electrician) (Technician) (Owner)  
 BUILDING DIVISION: *[Signature]* Date: 8/26/80  
 PERMIT NO. 4771-20 PERMIT FEE \$ 38.45

**RECEIPT**

MUST BE MACHINE VALIDATED

Gloria Ealy 9-4-80

## CITY OF LAS VEGAS, NEVADA

DEPARTMENT OF PUBLIC SERVICES — AIR CONDITIONING APPLICATION & PERMIT  
DIVISION OF BUILDING AND SAFETY

ADDRESS OF CONSTRUCTION: 8216 Buccanner Lane OWNER'S NAME: Sproul Homes of Nevada  
 CIRCLE: Addition; Remodel; New Bldg. TYPE OF BLDG.: SFD APT. COMM. PUBLIC  
 STATE LICENSE # 6058 CITY LICENSE # 7618  
 CONTRACTOR'S NAME: Gearing Air Conditioning

| UNITS | DESCRIPTION                                                                                                                                                                                                                                           | FEE   | TOTAL |
|-------|-------------------------------------------------------------------------------------------------------------------------------------------------------------------------------------------------------------------------------------------------------|-------|-------|
|       | <b>PERMIT ISSUANCE</b>                                                                                                                                                                                                                                |       |       |
|       | For the issuance of each permit.                                                                                                                                                                                                                      | 6.50  | 6.50  |
|       | For issuing each supplemental permit.                                                                                                                                                                                                                 | 3.00  |       |
|       | <b>UNIT FEE SCHEDULE</b>                                                                                                                                                                                                                              |       |       |
|       | For the installation or relocation of each forced-air or gravity-type furnace or burner, including ducts and vents attached to such appliance, up to and including 100,000 Btu/h.                                                                     | 5.00  |       |
|       | For the installation or relocation of each forced-air or gravity-type furnace or burner, including ducts and vents attached to such appliance over 100,000 Btu/h.                                                                                     | 5.75  |       |
|       | For the installation or relocation of each floor furnace, including vent.                                                                                                                                                                             | 5.00  |       |
|       | For the installation or relocation of each suspended heater, recessed wall heater or floor-mounted unit heater.                                                                                                                                       | 5.00  |       |
|       | For the installation, relocation or replacement of each appliance vent installed and not included in an appliance permit.                                                                                                                             | 2.00  |       |
|       | For the repair, alteration of, or addition to each heating appliance, refrigeration unit, cooling unit, absorption unit, each heating, cooling, absorption, or evaporative cooling system, including installation of controls regulated by this code. | 5.00  |       |
|       | For the installation or relocation of each boiler or compressor to and including three horsepower, or each absorption system to and including 100,000 Btu/h.                                                                                          | 5.00  |       |
|       | For the installation or relocation of each boiler or compressor over three horsepower to and including 15 horsepower, or each absorption system over 100,000 Btu/h and including 500,000 Btu/h.                                                       | 9.00  | 9.00  |
|       | For the installation or relocation of each boiler or compressor over 15 horsepower to and including 30 horsepower, or each absorption system over 500,000 Btu/h to and including 1,000,000 Btu/h.                                                     | 11.00 |       |
|       | For the installation or relocation of each boiler or compressor over 30 horsepower to and including 50 horsepower, or for each absorption system over 1,000,000 Btu/h to and including 1,750,000 Btu/h.                                               | 21.25 |       |
|       | For the installation or relocation of each boiler or refrigeration compressor over 50 horsepower, or each absorption system over 1,750,000 Btu/h.                                                                                                     | 33.75 |       |

| UNITS | DESCRIPTION                                                                                                                                                                                                                                                                                                                                  | FEE           | TOTAL |
|-------|----------------------------------------------------------------------------------------------------------------------------------------------------------------------------------------------------------------------------------------------------------------------------------------------------------------------------------------------|---------------|-------|
|       | For each air-handling unit to and including 10,000 cubic feet per minute, including ducts attached thereto.<br><i>Note: This fee shall not apply to an air-handling unit which is a portion of a factory-assembled appliance, cooling unit, evaporative cooler or absorption unit for which a permit is required elsewhere in this code.</i> | 3.25          |       |
|       | For each air-handling unit over 10,000 cfm.                                                                                                                                                                                                                                                                                                  | 5.75          |       |
|       | For each evaporative cooler other than portable type.                                                                                                                                                                                                                                                                                        | 3.75          |       |
|       | For each ventilation fan connected to a duct.                                                                                                                                                                                                                                                                                                | 3.00          |       |
|       | For each ventilation system which is not a portion of any heating or air-conditioning system authorized by a permit.                                                                                                                                                                                                                         | 2.75          |       |
|       | For the installation of each hood which is served by mechanical exhaust, including the ducts for such hood.                                                                                                                                                                                                                                  | 4.25          |       |
|       | For the installation or relocation of each domestic-type incinerator.                                                                                                                                                                                                                                                                        | 5.25          |       |
|       | For the installation or relocation of each commercial or industrial-type incinerator.                                                                                                                                                                                                                                                        | 22.50         |       |
|       | For each appliance or piece of equipment regulated by this code but not classed in other applicable categories, or for which no other fee is listed in this code.                                                                                                                                                                            | 3.75          |       |
|       | When Chapter 22 is applicable (see Section 103), permit fees for fuel-gas piping shall be as follows:<br>For each gas-piping system of one to four outlets.<br>For each gas-piping system of more than four outlets, per outlet.                                                                                                             | 2.00<br>.50   |       |
|       | <b>OTHER INSPECTIONS AND FEES:</b>                                                                                                                                                                                                                                                                                                           |               |       |
|       | Inspections outside of normal business hours (minimum charge — two hours)                                                                                                                                                                                                                                                                    | 7.50 per hour |       |
|       | Reinspection fee assessed under provisions of Section 305 (1).                                                                                                                                                                                                                                                                               | 7.50 each     |       |
|       | Inspections for which no fee is specifically indicated (minimum charge — one-half hour).                                                                                                                                                                                                                                                     | 7.50 per hour |       |
|       | Additional plan review required by changes, additions or revisions to approved plans (minimum charge — one-half hour).                                                                                                                                                                                                                       | 7.50 per hour |       |
|       | <b>TOTAL PERMIT FEE \$</b>                                                                                                                                                                                                                                                                                                                   | <b>15.50</b>  |       |

I hereby certify that I have carefully examined and read the above application; that the same is true and correct; and that the work herein described is to be done in accordance with all the provisions of the applicable Ordinances of the City of Las Vegas, Nevada and the State Laws, whether herein specified or not.

Approval for the work under this permit will be given only after refuse and debris have been removed from job site and public right of way.

SIGNED E.E. Gearing (i.k.) Date 8/26/80  
 Air Conditioning Contractor - Owner  
E.E. Gearing Touie Date 8/28/80  
 BUILDING DIVISION  
 PERMIT NO. H-769-30 PERMIT FEE \$ 15.50

RECEIPT

MUST BE MACHINE VALIDATED

#1721-2405 (REV. 3/80)

*Carrie Jackson*

|                                                          |                                                          |                                   |  |
|----------------------------------------------------------|----------------------------------------------------------|-----------------------------------|--|
| OWNER <b>Sprout Homes</b>                                |                                                          | ADDRESS <b>8216. Buccaneer</b>    |  |
| DATE <b>7-29-80</b>                                      | GEN. CONT. <b>Owner</b>                                  |                                   |  |
| SED W/TP <b>4188-5 1</b>                                 |                                                          |                                   |  |
| TYPE OF STRUCTURE                                        | PERMIT NO.                                               | FINAL INSPECTION                  |  |
| LEGAL DESCRIPTION <b>L-30 B-5 Charleston Rainbow 100</b> |                                                          |                                   |  |
| APPROVED FOR OCCUPANCY & METER                           |                                                          | <b>T21</b>                        |  |
| <b>BUILDING</b>                                          |                                                          | <b>MECHANICAL</b>                 |  |
| Investigation                                            | Plumbing Cont <i>Unk</i>                                 |                                   |  |
| Location & Footing <i>BM 8-15-80</i>                     | Permit No <i>4364-3</i> Date <i>8-2-80</i>               |                                   |  |
| Concrete Slab Floor <i>BM 8-29-80</i>                    | Heat & Vent. A/C Cont. <i>Unk</i>                        |                                   |  |
| Fireplace Footing <i>BM 8-15-80</i>                      | Permit No <i>4761-50</i> Date <i>8-2-80</i>              |                                   |  |
| Chimney Steel <i>BM 9-4-80</i>                           | Sewer Cont <b>Sprout</b>                                 |                                   |  |
| Vert Steel Reinf                                         | Permit No <b>4188</b> Date <b>7-29-80</b>                |                                   |  |
| Horiz Steel Reinf                                        | Rough Soil <i>MMC 8-27-80</i>                            |                                   |  |
| Framing <i>BM 9-26-80</i>                                | Rough Water <i>MMC 8-27-80</i>                           |                                   |  |
| Ext Lath                                                 | Top Out <i>JL 9-23-80</i>                                |                                   |  |
| Ext Brown                                                | Rough Gas <i>JL 9-23-80</i>                              |                                   |  |
| Drywall <i>BM 10-3-80</i>                                | A/C Rough Duct <i>JL 9-23-80</i>                         |                                   |  |
| Final Building <i>BM 10-28-80</i>                        | Final Plumbing <i>JL 10-23-80</i>                        |                                   |  |
| Appr. for Occu.                                          | Final Gas <i>JL 10-23-80</i>                             |                                   |  |
| <b>ELECTRICAL</b>                                        |                                                          | Final Air Cond <i>JL 10-23-80</i> |  |
| Temp. Pole Cont                                          | Final Sewer <i>JL 9-12-80</i>                            |                                   |  |
| Permit No                                                | Date                                                     | <b>REMARKS</b>                    |  |
| Inspection                                               | Date                                                     |                                   |  |
| Electrical Cont <i>Roberts &amp; Co</i>                  |                                                          |                                   |  |
| Permit No <i>4771-20</i>                                 | Date <i>8-21-80</i>                                      |                                   |  |
| Rough <i>MMTGT 10-20-80</i>                              | PLEASE NOTE ADDITIONAL REMARKS ON REVERSE SIDE.          |                                   |  |
| Final Rough                                              | DIV. OF BLDG & SAFETY<br>CITY OF LAS VEGAS<br>REV. 10-78 |                                   |  |
| Final Electrical <i>BM 10-28-80</i>                      | 79 3 16                                                  |                                   |  |
| Temporary Service                                        |                                                          |                                   |  |

*Lyell Jackson*

Stem wall B.M. 8-22-80  
Rough cutting B.M. 24-80  
Insulation B.M. 30-80

Permit No. 4188-5

CITY OF LAS VEGAS, NEVADA

CONST. VAL. \$ 2235<sup>00</sup>

LOG NO. & AREA \_\_\_\_\_

DEPARTMENT OF BUILDING AND SAFETY

APPLICATION & BUILDING PERMIT - for:  
Fence, Wall, Retaining Wall.

ADDRESS OF CONSTRUCTION:

8216 Buacanas  
Ruccaner

OWNER:

Midley Credler

LOT(s)

30

BLOCK

5

SUBDIVISION

Charleston 18C

ZONE

R-1

Materials of Construction:

Block

Concrete

Wire

Wood

Other

45-19-7-025

Yes

No

PLANS:

CALCS:

ARCHITECT:

ENGINEER:

CONTRACTOR:

C E Davis

STATE LICENSE #

12281

CITY LICENSE #

12927

TOTAL SQUARE FEET:

894

TOTAL LINEAL FEET:

149

Remarks:

Remarks section with three empty lines.

CONDITIONS OF THE PERMIT:

1. Any type of retaining wall must be engineered by a Civil or Structural Engineer.
2. If a home owner takes out the Building Permit and if the owner sublets the work to a Contractor, then the Contractor must take out the permit and pay for it.
3. No fence or wall can be built on City property or rights-of-way, but this is not intended to preclude construction within utility easements if utilities will not be damaged or made inaccessible.
4. The fence or wall shall not enclose any water meter, light standard, or fire alarm box and shall not come closer than 24" from the nearest fire hydrant outlet.
5. Department inspectors must approve footings before concrete is poured and block wall reinforcing before grouting is done.
6. Maximum height of any wall or fence is 6', side and rear yards; 4' maximum in front yard with the vertical surface above the height of 2' - 50% open.
7. I must not obstruct required onsite parking space (2 spaces for each dwelling unit) by the erection of this fence or wall.
8. By the signing of this application I herewith agree to the requirements outlined above.

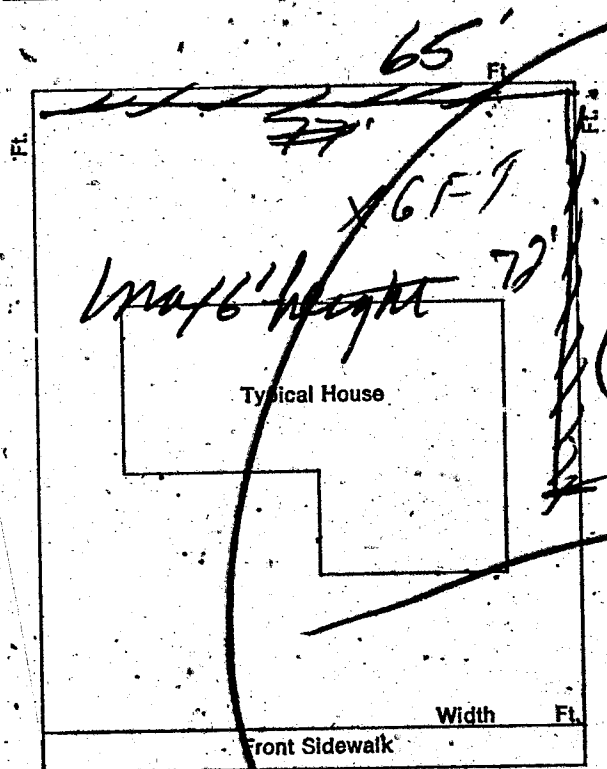

1TONI \$ .00  
 WALL \$ 38.50  
 STL \$ 38.50  
 TOTL \$ 77.00  
 CHEK \$ 38.50

#5597 SR#01/01  
 CITY OF LAS VEGAS  
 BLDG. & SAFETY  
 11/17/81

SIGNED:

CONTRACTOR  AGENT

PLANNING DEPT:

[Signature]

Date:

12/17/81

PUBLIC WORKS DEPT:

NA

Date:

11/17/81

BUILDING DIVISION:

Tom

Date:

11/17/81

PERMIT NO:

5597

PERMIT FEE \$

38.50

RECEIPT

MUST BE MACHINE VALIDATED

82

1

| FENCE & RETAINING WALLS |       |              |                  |
|-------------------------|-------|--------------|------------------|
| OWNER                   |       | 11-17-81     | DATE             |
| Mickey Giebler          |       |              |                  |
| ADDRESS                 |       |              |                  |
| 8216 Buccaneer          |       |              |                  |
| CONTRACTOR              |       | PERMIT NO.   | FINAL INSPECTION |
| C.E. Davis              |       | 5597         | Blk wall         |
| LOT                     | BLOCK | SUBDIVISION  |                  |
| 30                      | 5Char | Rainbow 18-C |                  |
| LOG #                   |       | AREA         |                  |

FENCES (wire, wood, block, & retaining walls)

|   |            |                |  |
|---|------------|----------------|--|
| 1 | Location   | B M 11-18-81 ✓ |  |
| 2 | Footing    |                |  |
| 3 | Wall Steel | B M 11-19-81   |  |
|   | 1st        | 2nd            |  |
| 4 | Bond Beam  |                |  |
|   | 1st        | 2nd            |  |
| 5 | Final      | B M 11-20-81   |  |

Specify Type Of Fence

2-1-33 DIV OF BLDG & SAFETY CITY OF LAS VEGAS REV 10-78

E-Z-WAY SYSTEMS NEWARK OH 43055 LITHO IN U.S.A.