

808 Coulthard

L3 B1 Char Hgts #27 D-2 Zone R-1

Sharon Parra 2-26-79

CITY OF LAS VEGAS, NEVADA
 DEPARTMENT OF BUILDING & SAFETY
 808 Couthard
 JOB ADDRESS: COUTHARD DRIVE

PERMIT FEE \$ 20.00
 APPLICATION & PERMIT FOR
 PLUMBING
 OWNER'S NAME: SPREAD HOMES, INC.

LOT 9 BLOCK 1 SUBDIVISION CH 27 D 1 Bldg. type: SFD APT COMM
 Circle: New bldg. Old bldg; Add'n; Remodel; Pool; Wtr. Sftner; Lawn Sprkr; Other
 CONTRACTOR: UNITED PLUMBING State Lic. # 1295 City Lic. # 904

QUANTITY	FIXTURE OR INSTALLATION	Unit Price	AMOUNT
1	Bathtub	1.00	1.00
	Clothes dryer (gas)	1.00	
1	Clothes washer	1.00	1.00
	Dental unit	1.00	
	Dishwasher	1.00	
	Drinking fountain	1.00	
	Fire sprinkling - underground piping	5.00	
	Fire sprinkling - distribution piping per each foot	.01	
	Fire sprinkling heads - per each head	.10	
	Floor drain \$1.00 Floor sink	1.00	
	Gas appliance (any type)	1.00	
1	Gas piping system - single family dwelling	3.00	3.00
	Gas piping system - multiple family \$3 per each unit plus	1.00	
1	Gas piping system - commercial bldg. per each floor	3.00	
	Grease trap	1.00	
	Irrigation system	4.00	
2	Lavatory	1.00	2.00
	Minimum fee for any permit	4.00	
1	Piping, Drainage	4.00	4.00
1	Sewer replacement	4.00	
	Septic disposal system - Health Dept. approval required	4.00	
1	Shower	1.00	1.00
1	Sink - kitchen type	1.00	1.00
	Swimming pool - private - wading pool	8.00	
	Swimming pool - public - semi-public	12.00	
2	Toilet	1.00	2.00
	Urinal	1.00	
1	Water distribution system, single family dwelling	4.00	4.00
	Water distribution system multiple dwg. \$4 + each unit	1.00	
	Water distribution system, Group "A" thru "G" per each floor	4.00	
	Water distribution system, Group "H" (hotel) \$4 + per bath*	.50	
1	Water heater (gas) (electric)	1.00	1.00
	Water using equipment	1.00	
	Water softener nonpermanent type	4.00	
	Water softener permanent (connected to drainage)	5.00	
	Wash tray	1.00	

I hereby certify that I have carefully examined & read the above application; that the same is true & correct; and the work herein described is to be done in accordance with the provisions of City of Las Vegas Ordinances & State Laws, whether herein specified or not. * As defined in City Code and Ordinances.

TOTAL FEE \$ 20.00

SIGNED: [Signature] Date: 10-13-67
 Registered Plumber Spec. Cont'r, Owner

Engineering Dept. Date 12/13/67 Building Department Date
 Sewer Conn. Fee \$ 23.10
 Paid in Engr. Dept. PERMIT NO. 22473 PERMIT FEE \$ 20.00
 #1287

RECEIPT
DM 1967 \$20.00 - 1
 CITY OF LAS VEGAS
 DEPT. OF BUILDING & SAFETY
 Must be machine validated

Sharon Lewis 2-26-79

CITY OF LAS VEGAS, NEVADA
DEPARTMENT OF BUILDING & SAFETY

PERMIT FEE \$ 20.00
APPLICATION & PERMIT FOR
PLUMBING

808 Couthard

JOB ADDRESS: COUTHARD DRIVE

OWNER'S NAME: SPRAW HOTELS, INC.

LOT 9 BLOCK 1 SUBDIVISION CH 27 D 1 Bldg. type: SFD APT COMM
Circle: New bldg; Old bldg; Add'n; Remodel; Pool; Wtr. Sftner; Lawn Sprkr; Other

CONTRACTOR: UNITED PLUMBING State Lic. # 1295 City Lic. # 904

QUANTITY	FIXTURE OR INSTALLATION	Unit Price	AMOUNT
1	Bathtub	1.00	1.00
	Clothes dryer (gas)	1.00	
1	Clothes washer	1.00	1.00
	Dental unit	1.00	
	Dishwasher	1.00	
	Drinking fountain	1.00	
	Fire sprinkling - underground piping	5.00	
	Fire sprinkling - distribution piping per each foot	.01	
	Fire sprinkling heads - per each head	.10	
	Floor drain \$1.00 Floor sink	1.00	
	Gas appliance (any type)	1.00	
1	Gas piping system - single family dwelling	3.00	3.00
	Gas piping system - multiple family \$3 per each unit plus	1.00	
1	Gas piping system - commercial bldg. per each floor	3.00	
	Grease trap	1.00	
	Irrigation system	4.00	
2	Lavatory	1.00	2.00
	Minimum fee for any permit	4.00	
1	Piping, Drainage	4.00	4.00
	Sewer replacement	4.00	
	Septic disposal system - Health Dept. approval required	4.00	
1	Shower	1.00	1.00
1	Sink - kitchen type	1.00	1.00
	Swimming pool - private - wading pool	8.00	
	Swimming pool - public - semi-public	12.00	
2	Toilet	1.00	2.00
	Urinal	1.00	
1	Water distribution system, single family dwelling	4.00	4.00
	Water distribution system multiple dwg. \$4 + each unit	1.00	
	Water distribution system, Group "A" thru "G" per each floor	4.00	
	Water distribution system, Group "H" (hotel) \$4 + per bath*	.50	
1	Water heater (gas) (electric)	1.00	1.00
	Water using equipment	1.00	
	Water softener nonpermanent type	4.00	
	Water softener permanent (connected to drainage)	5.00	
	Wash tray	1.00	

TOTAL FEE \$ 20.00

I hereby certify that I have carefully examined & read the above application; that the same is true & correct; and the work herein described is to be done in accordance with the provisions of City of Las Vegas Ordinances & State Laws, whether herein specified or not. * As defined in City Code and Ordinances.

SIGNED: [Signature] Date: 10-13-67
Registered Plumber Spec. Cont'r, Owner

Engineering Dept. Date Building Department Date
Sewer Conn. Fees
Paid in Engr. Dept. PERMIT NO. 22473 PERMIT FEE \$ 20.00
23.10 #1287

RECEIPT
\$20.00 - 1
CITY OF LAS VEGAS
DEPT. OF BUILDING & SAFETY
Must be machine validated

Sharon Lorenz 2-26-79

CITY OF LAS VEGAS, NEVADA

LOG NO. & AREA _____

CONST. VAL. \$ 11,650.00

DEPARTMENT OF BUILDING & SAFETY

APPLICATION & BUILDING PERMIT — for:
Dwellings, Duplexes, Misc. Residential Const.

ADDRESS OF CONSTRUCTION: 808 Coulthard Drive

OWNER: Sproul Homes, Inc.

LOT(s) 3

BLOCK 1

SUBDIVISION Charleston Heights Unit # 27-D-2

ZONE: R-1

Existing structure on lot: Dwelling Accessory bldg. Vacant lot Other

PROPOSED CONSTRUCTION: Single Family Dwelling

USE: Same

MATERIALS OF CONSTRUCTION: Wood Frame Concrete Block Reinforced Concrete Steel Frame

SQUARE FEET OF FLOOR AREAS: 1st XX 2nd _____ 3rd _____ Other _____ TOTAL SQ. FT. 978

FIRE ZONE: 1 2 3 Occupancy Group A B C D E F G H I J 1-2-3-4-5

CONST. TYPE: I II III IV V

ARCHITECT: _____

ENGINEER: _____

NO. of UNITS _____

NO. of STORIES _____

Plans Submitted: Yes No

Calculations Submitted Yes No

Sewer Fee Req'd. Yes No

CONTRACTOR: Sproul Homes, Inc.

STATE LICENSE # 6011B

CITY LICENSE # 6427

ADD'L. PERMITS REQ'D: Air Cond. Elec. Plumbing Signs Paving Fence Public Walks Curb-gutters Incinerators Fire Sprinkling System

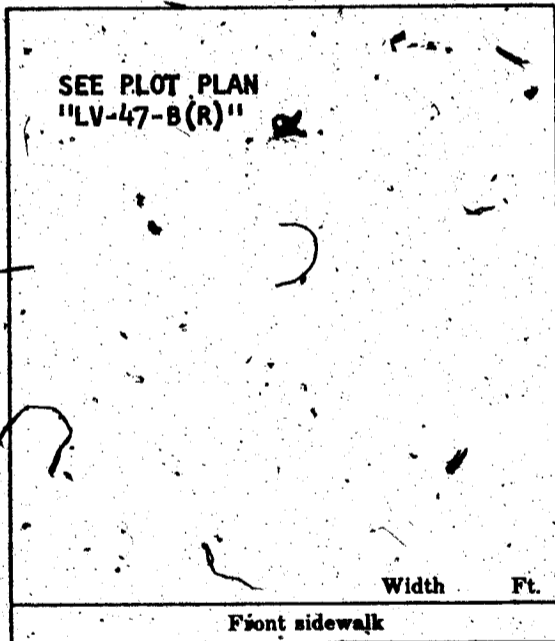

CONDITIONS OF THE PERMIT:

1. I agree to call the City Building Department for inspections before concrete is poured, before rough wiring, electrical, plumbing, framing is covered. Also for Air conditioning, sheet-rock and sheathing inspection.
2. I agree that when the job is completed that I will call for final inspection before occupancy.
3. I agree to perform all construction in accordance with City Ordinances and Building Codes.
4. The Contractor's signature below denotes authority from the owner to sign in his behalf and that the owner is aware of all requirements of this application and permit. Separate permits must be taken out for work outlined above this agreement.
5. I have read and understand the contents of this application and permit; I hereby state that the information I have supplied on this application is true and correct.

SIGNED: SPROUL HOMES, INC. Contractor

BY: [Signature] Agent or Owner

CLARK COUNTY HEALTH DEPT. _____ Date _____

LAS VEGAS FIRE DEPARTMENT _____ Date _____

PLANNING DEPT: [Signature]

Date: 12-13-67

ENGINEERING DEPT: [Signature]

Date: 12-13

BUILDING DEPT: [Signature]

Date: 12-13-67

#1285p

PERMIT NO: 39604

PERMIT FEE \$ 42.00

RECEIPT
 7779 3042.00 - 8
 CITY OF LAS VEGAS
 DEPT. OF BUILDING & SAFETY
 MUST BE MACHINE VALIDATED
 15 DEC 67

Sharon Perera 2-26-79

CITY OF LAS VEGAS, NEVADA
DEPARTMENT OF BUILDING & SAFETY

SEWER CONNECTION FEE: \$ 150.00

RECEIPT
for
SEWER CONNECTION FEE

JOB ADDRESS: 808 Coulthard Drive OWNER'S NAME: Sproul Homes, Inc.

LOT 3 BLOCK 1 SUBDIVISION Charleston Heights Unit # 27-B-2

QUANTITY	OCCUPANCY	UNIT FEE	AMOUNT
1	Sewer Connection for S. E. D.		\$150.00

TOTAL _____

Less Credit* _____

TOTAL FEE \$ 150.00

*Credit for existing sewer is applied to the new sewer connection fee based on previous type of occupancy and only when the new occupancy requires an additional fee.

This receipt does not authorize the owner or his representative to start any work without obtaining a plumbing permit.

J. Wenzel 12-14-67
DEPARTMENT OF BUILDING & SAFETY DATE

#1267 RECEIPT NO. 22496 SEWER FEE \$ 150.00
73102

23.30

Receipt.

~~204 20000~~ - 3

CITY OF LAS VEGAS
DEPT OF
BUILDING & SAFETY

Must be machine validated

Sharon Lewis 2-26-79

1968

CITY OF LAS VEGAS, NEVADA

DEPARTMENT OF BUILDING & SAFETY - AIR CONDITIONING APPLICATION & PERMIT

ADDRESS OF CONSTRUCTION: 808 COULT HALL DR OWNER'S NAME: SPROUL

CIRCLE: New bldg. Old bldg.; Add'n; Remodel; TYPE OF BLDG. SFB APT. COMM.

CONTRACTOR'S NAME: BUSICK - GRARING STATE LICENSE # 6033 CITY LICENSE #

UNITS	HEATERS	PRICE	FEE	UNITS	GAS	PRICE	FEE
	Unit Heaters (floor, suspended & wall)	\$2.00			Gas piping system 1 to 5 outlets	\$3.00	
	Floor Furnace	\$3.00			Gas piping system over 5 outlets (per outlet)	.20	
	Forced Air or Gravity Type under 100,000 BTU's	\$7.00			Swimming pool heater	\$4.00	
	Steam or hot water heating system under 15 outlets (Boiler Excluded)	\$8.00		VENTS			
	Steam or hot water heating system 15 to 30 outlets (Boiler Excluded)	\$10.00			Combustion products vent other than a chimney	\$1.00	
	Each outlet over 30	.50			Residential kitchen or bathroom vent each	.25	<u>50</u>
	Radiant type heating system under 1000 sq. ft. to be heated	\$8.00			Commercial Hood	\$4.00	
	Radiant type heating system 1000 to 2000 sq. ft. to be heated	\$10.00			Ventilation system not a portion of any heating or air conditioning system up to \$1,000 valuation	\$5.00	
	Each additional 500 sq. ft. over 2000 sq. ft.	.50		BOILER			
AIR CONDITIONING					Boiler installation 15 H.P. and under	\$5.00	
	Heat pump or refrigerant 3 tons or less.	\$4.00	<u>400</u>		Boiler installation over 15 H.P.	\$10.00	
	Heat pump or refrigerant 3 tons to 10 tons	\$6.00		REPAIR			
	Each addn. ton over 10 ton	.50			Inspection of alteration or replacement of any mechanical cooling equipment which is a portion of any air conditioning system	\$3.00	
	Refrigeration system 3 ton or less	\$5.00			DUCT WORK ONLY (each opening)	.25	
	Refrigeration system 3 to 10 ton	\$7.00			WATER TOWER	\$4.00	
	Each addn. ton over 10 ton	.50			MINIMUM PERMIT FEE	\$4.00	
	Evaporative cooler 5 outlets and under	\$3.00		TOTAL PERMIT FEE			
	Evaporative cooler 5 to 10 outlets	\$5.00					<u>450</u>
	Each addn. outlet over 10	.25					

I hereby certify that I have carefully examined and read the above application; that the same is true and correct; and that the work herein described is to be done in accordance with all the provisions of the applicable Ordinances of the City of Las Vegas, Nevada and the State laws, whether herein specified or not.

SIGNED: [Signature] Date 1-3-68
 AIR CONDITIONING CONTRACTOR - OWNER

BUILDING DEPARTMENT [Signature] Date 1-11-68

#12890 PERMIT NO. 15582 PERMIT FEE \$ 450

RECEIPT

5833 2004.50 - 4

CITY OF LAS VEGAS
 DEPT. OF BUILDING & SAFETY

MULTI-MACHINE VALIDATED

1-11-68

Sharon Brown 2-26-79

CITY OF LAS VEGAS, NEVADA

DEPARTMENT OF BUILDING & SAFETY - ELECTRICAL APPLICATION & PERMIT

ADDRESS OF CONSTRUCTION: 808 Crestfield Drive OWNER'S NAME: Sharon Brown

LOT(S) 3 BLOCK 1 SUBDIVISION Ch 2702 Type of bldg. SFD Apt. Com.

Check Proper Construction: New Bldg. Addn. Remodel Temporary Pole Old Bldg.

CONTRACTOR'S NAME: Robert E. Lutz STATE LICENSE # 5144 CITY LICENSE # 2392

NUMBER	FIXTURE OR INSTALLATION	UNIT PRICE	
<u>14</u>	Fixture or sockets	.15	<u>210</u>
<u>64</u>	Light, receptacle or switch outlet	.20	<u>1140</u>
	Wall or ceiling space heater	.35	
	Blast coil heater per kilowatt	.35	
<u>1</u>	Garbage grinder outlet	.35	<u>35</u>
	Dishwasher outlet	.35	
	Clothes dryer outlet	.35	
	Automatic clothes washer	.35	
	Electric range outlet	.35	
	Electric water heater outlet	.35	
	Mercury arc lamp and equipment	.35	
	Special purpose outlet	.35	
	X-ray unit and its appurtenances	5.00	
	Watts of festoon lighting (Watts) First 3,000 watts	4.00	
	for each additional thousand watts	1.50	
	Horsepower - all motors first horsepower or less	1.75	
	for each additional horsepower	.35	
	Temporary power and lights (temporary pole)	4.00	
<u>1</u>	Electric service (including any single meter socket)	3.00	
	for each additional socket	.35	<u>300</u>
<u>1</u>	Air conditioning service	1.50	<u>150</u>
	amps		
	Each KW (KVA) Generator (Transformer) (Welder) KW (KVA)	2.00	
	First 100 KVA - For each additional KW (KVA)	.01	
	Special inspection per hour	4.00	
	Speaker outlets	.15	
	Signal or Alarm outlets	.15	
	Amplifiers	.50	
	Control panels	.25	
	T. V. outlets - master system only	.15	
	Radio outlets	.15	
	Main control racks	1.00	
	T. V. and Radio antennas - master system only	.75	
	Minimum fee for any permit	4.00	
	Total fee		<u>1835</u>

I hereby certify that I have carefully examined and read the above application; that the same is true and correct; and that the work herein described is to be done in accordance with all the provisions of the applicable Ordinances of the City of Las Vegas, Nevada and State laws whether herein specified or not.

SIGNED [Signature] Date 2/2/68
MASTER (ELECTRICIAN) (TECHNICIAN) (OWNER)

BUILDING DEPARTMENT [Signature] Date 2-5-68

#12860 PERMIT NO. 24682 PERMIT FEE: \$ 18³⁵

RECEIPT
 4025 5018.35 - 6
 CITY OF LAS VEGAS
 DEPT. OF BUILDING & SAFETY
 MUST BE MACHINE VALIDATED

Sharon Medina 2-26-79

CITY OF LAS VEGAS, NEVADA

LOG NO. & AREA

CONST. VAL. \$ 550.00

DEPARTMENT OF BUILDING & SAFETY

APPLICATION & BUILDING PERMIT for: Fence, Wall, Retaining Wall.

ADDRESS OF CONSTRUCTION:

808 Coulthard Drive

OWNER:

Lynn Medina

LOT(s)

3

BLOCK

11

SUBDIVISION

Charleston Hts 27-0

ZONE R-1

Materials of Construction:

Block

Concrete

Wire

Wood

Other

Yes No

PLANS:

ARCHITECT:

ENGINEER:

CALCS:

CONTRACTOR:

owner

STATE LICENSE #

CITY LICENSE #

TOTAL SQUARE FEET:

TOTAL LINEAL FEET: 100'

Remarks:

CONDITIONS OF THE PERMIT:

1. Any type of retaining wall must be engineered by a Civil or Structural Engineer.
2. If a home owner takes out the Building Permit and if the owner sublets the work to a Contractor, then the Contractor must take out the permit and pay for it.
3. No fence or wall can be built on City property or rights-of-way, but this is not intended to preclude construction within utility easements if utilities will not be damaged or made inaccessible.
4. The fence or wall shall not enclose any water meter, light standard, or fire alarm box and shall not come closer than 24" from the nearest fire hydrant outlet.
5. Department Inspectors must approve footings before concrete is poured and block wall reinforcing before grouting is done.
6. Maximum height of any wall or fence is 6', side and rear yards; 4' maximum in front yard with the vertical surface above the height of 2' - 50% open.
7. It must not obstruct required onsite parking space. (2 spaces for each dwelling unit) by the erection of this fence or wall.
8. By the signing of this application I herewith agree to the requirements outlined above.

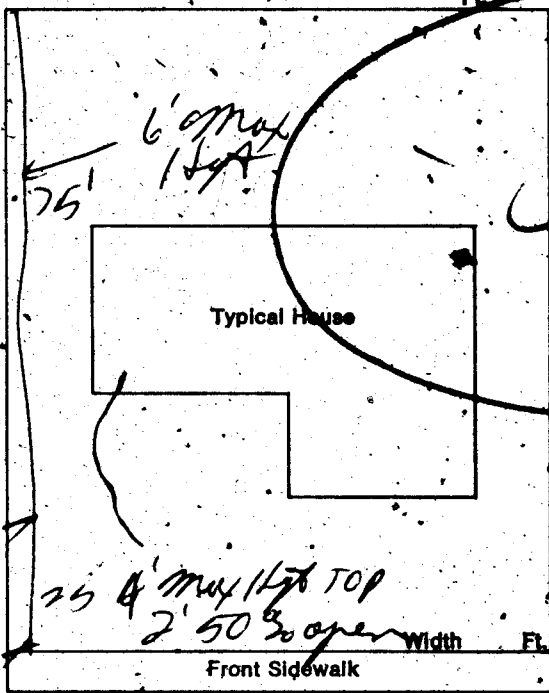

SIGNED:

Lynn Medina

DATE: 6-27-74

CONTRACTOR AGENT OWNER

PLANNING DEPT:

PA

Date: 6-27-74

PUBLIC WORKS DEPT:

George Dammer

Date: 6-27-74

BUILDING DEPT:

Jane Dreyer

Date: 6-28-74

#12850

PERMIT NO:

17400

PERMIT FEE \$

8.00

RECEIPT

4054 \$008.00 - 8

CITY OF LAS VEGAS DEPT. OF BUILDING & SAFETY

MUST BE MACHINE VALIDATED

2-8-74

Theresa Kyrnakos 4-17-81

DEPT. of BLDG & SAFETY - CITY of LAS VEGAS, NEVADA

OWNER Sproul Homes ADDRESS 808 Coulthard Drive DATE 12/11/67
 GEN CONT. Same TYPE OF STRUCTURE SEB
 PERMIT NO. 39604 LEGAL DESCRIPTION L 3 B 1 Charleston Heights #27, d-2

BUILDING	MECHANICAL	ELECTRICAL
LOCATION <u>CH 12-28-67</u>	PLUMBING CONT. <u>11-20-67</u>	TEMP. POLE CONT. _____
FIREPLACE PTS _____	PERMIT NO. <u>22473</u> DATE <u>12-13-67</u>	PERMIT NO. _____ DATE _____
FOOTINGS <u>CH 12-28-67</u>	HEAT & VENT. AC CONT. <u>13533</u> DATE <u>1-11-68</u>	INSPECTION _____ DATE _____
FOUNDATION WALLS <u>CH 12-28-67</u>	SEWER CONT. <u>Sproul</u>	ELECTRICAL CONT. <u>24652</u> DATE <u>2-5-68</u>
FLOOR FRAMING _____	PERMIT NO. <u>22106</u> DATE <u>12/11/67</u>	PERMIT NO. _____ DATE _____
SLAB <u>CH 12-28-67</u>	ROUGH SOIL <u>1-9-68</u>	FIXTURES CONT. <u>24652</u> DATE <u>2-5-68</u>
CHIMNEY STEEL (FIREPLACE) _____	ROUGH WATER <u>1-9-68</u>	PERMIT NO. _____ DATE _____
WALL STEEL _____	TOP-OUT <u>1-9-68</u>	SLAB _____
COLUMN STEEL _____	ROUGH GAS <u>1-9-68</u>	ROUGH _____
BEAM STEEL _____	AC ROUGH DUCT <u>1-9-68</u>	FINAL ROUGH _____
FRAMING <u>CH 12-28-67</u>	REF. ROUGH PIPING _____	FINAL FIXTURE _____
ROOF SHEATHING <u>CH 12-28-67</u>	FINAL PLUMBING <u>1-9-68</u>	FINAL ELECTRICAL <u>1-9-68</u>
DRYWALL _____	FINAL GAS <u>1-9-68</u>	TEMPORARY SERVICE _____
LATHING _____	FINAL AIR COND. <u>1-9-68</u>	MISCELLANEOUS _____
BACKING (SIDING) _____	FINAL REFRIG _____	GRADING & DRAINAGE _____
PLASTER <u>CH 12-28-67</u>	FINAL SEWER <u>1-9-68</u>	ON-SITE PARKING SPACES _____ APP. _____
SCRATCH _____	FINAL SEPTIC TANK _____	ENG APPROVAL OF _____
URBAN REDEVELOPMENT APPROVAL _____		OFF-SITE IMPROVEMENTS _____
FINAL BLDG _____ DATE _____		

APPROVED FOR OCCUPANCY & METER Inspector 3-26-68 DATE _____
 PLEASE NOTE REMARKS ON REVERSE SIDE 808 Coulthard Drive LOG # T-11 AREA # 4 23.04

DEPARTMENT OF BUILDING & SAFETY
 CITY OF LAS VEGAS, NEVADA

OWNER Lynn Medina ADDRESS 808 Coulthard Drive DATE 6/27/74
 KARDEX CARD
 FENCE & RETAINING WALLS

CONTRACTOR Owner PERMIT NO. 17400

LOT 3 BLOCK 1 SUBDIVISION V Chas Hgts 22 D-2
 Block fence

Fence (wire, wood, etc.)	Walls (masonry, rock, etc.)
Location _____	Location <u>12-7-11-74</u>
Final Inspection _____	Footing <u>12-7-11-74</u>
	Wall Steel 1st _____ 2d _____ 3d _____
	Final Inspection _____
Retaining Wall (masonry)	Retaining Wall (concrete)
Location _____	Location _____
Footing _____	Footing _____
Wall Steel 1st _____ 2d _____ 3d _____	Wall Steel 1st _____ 2d _____ 3d _____
Bond Beam 1st _____ 2d _____ 3d _____	Final Inspection _____
Final Inspection _____	

Pulled 3-10-75

23.14 B ADDRESS _____ AREA _____

Order Number 9-17-86

CITY OF LAS VEGAS, NEVADA

LOG NO. & AREA _____ DATE 9-15-87 CONST. VAL. \$ _____

DEPARTMENT OF BUILDING AND SAFETY
PHONE 386-6251 FOR INSPECTIONS, CALL 798-2071

AIR CONDITIONING PERMIT

ADDRESS OF CONSTRUCTION 808 Coulthard OWNER Lynn Medina PHONE 870-8387

CONTRACTOR Quality A/C Service, Inc. STATE LICENSE NO. 21544 CITY LICENSE NO. U67-2-26325

LOT(s) _____ BLOCK _____ SUBDIVISION _____ ZONE _____

PROPOSED CONSTRUCTION: replace existing unit USE: _____
AIR COND. 2167-A
PERMIT NO. _____

Approval for the work under this permit will be given only after refuse and debris have been removed from job site and public right of way.

UNITS	DESCRIPTION	FEE	TOTAL
PERMIT ISSUANCE			
1	For the issuance of each permit.	15.00	15.00
	For issuing each supplemental permit.	4.50	
UNIT FEE SCHEDULE			
	For the installation or relocation of each forced-air or gravity-type furnace or burner, including ducts and vents attached to such appliance, up to and including 100,000 Btu/h.	9.00	
	For the installation or relocation of each forced-air or gravity-type furnace or burner, including ducts and vents attached to such appliance over 100,000 Btu/h.	11.00	
	For the installation or relocation of each floor furnace, including vent.	9.00	
	For the installation or relocation of each suspended heater, recessed wall heater or floor-mounted unit heater.	9.00	
	For the installation, relocation or replacement of each appliance vent installed and not included in an appliance permit.	4.50	
	For the repair of, alteration of, or addition to each heating appliance, refrigeration unit, cooling unit, absorption unit, or each heating, cooling, absorption, or evaporative cooling system, including installation of controls regulated by this code.	9.00	
	For the installation or relocation of each boiler or compressor to and including three horsepower, or each absorption system to and including 100,000 Btu/h.	9.00	9.00
	For the installation or relocation of each boiler or compressor over three horsepower to and including 15 horsepower, or each absorption system over 100,000 Btu/h and including 500,000 Btu/h.	16.50	
	For the installation or relocation of each boiler or compressor over 15 horsepower to and including 30 horsepower, or each absorption system over 500,000 Btu/h to and including 1,000,000 Btu/h.	22.50	
	For the installation or relocation of each boiler or compressor over 30 horsepower to and including 50 horsepower, or for each absorption system over 1,000,000 Btu/h to and including 1,750,000 Btu/h.	33.50	
	For the installation or relocation of each boiler or refrigeration compressor over 50 horsepower, or each absorption system over 1,750,000 Btu/h.	56.00	

UNITS	DESCRIPTION	FEE	TOTAL
	For each air-handling unit to and including 10,000 cubic feet per minute, including ducts attached thereto. <i>Note: This fee shall not apply to an air-handling unit which is a portion of a factory-assembled appliance, cooling unit, evaporative cooler or absorption unit for which a permit is required elsewhere in this code.</i>	6.50	
	For each air-handling unit over 10,000 cfm.	11.00	
	For each evaporative cooler other than portable type.	6.50	
	For each ventilation fan	COMMERCIAL 1.50 RESIDENTIAL 2.35	
	For each ventilation system which is not a portion of any heating or air-conditioning system authorized by a permit.	6.50	
	For the installation of each hood which is served by mechanical exhaust, including the ducts for such hood.	6.50	
	For each appliance or piece of equipment regulated by this code but not classed in other appliance categories or for which no other fee is listed in this code.	6.50	

OTHER INSPECTIONS AND FEES:			
	Inspections outside of normal business hours (minimum charge — three hours.)	25.00	per hour
	Reinspection fee assessed under provisions of TABLE 3-A of the Uniform Building Code = \$15.00 EACH	15.00	each
	Inspections for which no fee is specifically indicated (minimum charge — one-half hour).	30.00	per hour
	Additional plan review required by changes, additions or revisions to approved plans (minimum charge — two hours).	30.00	per hour
	Mechanical permit fees may be computed the same as building permit fees by using the cost of installation for valuation amount when such work is not included in the above schedule.		
	Gas piping which is directly related and necessary to the repair or replacement of heating, air conditioning, or refrigeration systems not exceeding 500,000 B.T.U.H.	6.00	

I hereby certify that I have carefully examined and read the above application; that the same is true and correct; and that the work herein described is to be done in accordance with all the provisions of the applicable Ordinances of the City of Las Vegas, Nevada and the State Laws, whether hereinafter specified or not.

SIGNED Jodi Thore CONTRACTOR MASTER CARD NO. _____
BY P. Alfano Spec. Contr. or Owner DATE 9-16-87
BUILDING DEPT.

PERMIT FEE: \$24.00
TOTAL FEES: _____

RECEIPT
7
MUST BE MACHINE VALIDATED

Permit Expires 180 Days After Abandonment of Work

Abbe Inglish 9-17-86

CITY OF LAS VEGAS, NEVADA

LOG NO. & AREA _____

DATE: 9-15-87

CONST. VAL. \$ _____

DEPARTMENT OF BUILDING AND SAFETY
PHONE 386-0251 FOR INSPECTIONS, CALL 799-2071

AIR CONDITIONING PERMIT

ADDRESS OF CONSTRUCTION: 808 Coulthard

OWNER: Lynn Medina

PHONE: 870-8387

CONTRACTOR: Quality A/C Service, Inc.

STATE LICENSE NO. 21544

CITY LICENSE NO. U67-2-26325

LOT(S) _____ BLOCK _____ SUBDIVISION _____ ZONE _____

PROPOSED CONSTRUCTION: replace existing unit

USE: _____

AIR COND. PERMIT NO. 2167-1

Approval for the work under this permit will be given only after refuse and debris have been removed from job site and public right of way.

UNITS	DESCRIPTION	FEE	TOTAL
PERMIT ISSUANCE			
1	For the issuance of each permit.	15.00	15.00
	For issuing each supplemental permit.	4.50	
UNIT FEE SCHEDULE			
	For the installation or relocation of each forced-air or gravity-type furnace or burner, including ducts and vents attached to such appliance, up to and including 100,000 Btu/h.	9.00	
	For the installation or relocation of each forced-air or gravity-type furnace or burner, including ducts and vents attached to such appliance over 100,000 Btu/h.	11.00	
	For the installation or relocation of each floor furnace, including vent.	9.00	
	For the installation or relocation of each suspended heater, recessed wall heater or floor-mounted unit heater.	9.00	
	For the installation, relocation or replacement of each appliance vent installed and not included in an appliance permit.	4.50	
	For the repair, or alteration of, or addition to each heating appliance, refrigeration unit, cooling unit, absorption unit, or each heating, cooling absorption, or evaporative cooling system, including installation of controls regulated by this code.	9.00	
1	For the installation or relocation of each boiler or compressor to and including three horsepower, or each absorption system to and including 100,000 Btu/h.	9.00	9.00
	For the installation or relocation of each boiler or compressor over three horsepower to and including 15 horsepower, or each absorption system over 100,000 Btu/h and including 500,000 Btu/h.	16.50	
	For the installation or relocation of each boiler or compressor over 15 horsepower to and including 30 horsepower, or each absorption system over 500,000 Btu/h to and including 1,000,000 Btu/h.	22.50	
	For the installation or relocation of each boiler or compressor over 30 horsepower to and including 50 horsepower, or for each absorption system over 1,000,000 Btu/h to and including 1,750,000 Btu/h.	33.50	
	For the installation or relocation of each boiler or refrigeration compressor over 50 horsepower, or each absorption system over 1,750,000 Btu/h.	56.00	

UNITS	DESCRIPTION	FEE	TOTAL
	For each air-handling unit to and including 10,000 cubic feet per minute, including ducts attached thereto. <i>Note: This fee shall not apply to an air-handling unit which is a portion of a factory-assembled appliance, cooling unit, evaporative cooler or absorption unit for which a permit is required elsewhere in this code.</i>	6.50	
	For each air-handling unit over 10,000 cfm.	11.00	
	For each evaporative cooler other than portable type.	6.50	
	For each circulation fan	COMMERCIAL 4.50 RESIDENTIAL 2.35	
	For each ventilation system which is not a portion of any heating or air-conditioning system authorized by a permit.	6.50	
	For the installation of each hood which is served by mechanical exhaust, including the ducts for such hood.	6.50	
	For each appliance or piece of equipment regulated by this code but not classed in other appliance categories or for which no other fee is listed in this code.	6.50	
OTHER INSPECTIONS AND FEES:			
	Inspections outside of normal business hours (minimum charge — three hours.)	25.00 per hour	
	Reinspection fee assessed under provisions of TABLE 3-A of the Uniform Building Code = \$15.00 EACH	15.00 each	
	Inspections for which no fee is specifically indicated (minimum charge — one-half hour).	30.00 per hour	
	Additional plan review required by changes, additions or revisions to approved plans (minimum charge — two hours).	30.00 per hour	
	Mechanical permit fees may be computed the same as building permit fees by using the cost of installation for valuation amount when such work is not included in the above schedule.		
	Gas piping which is directly related and necessary to the repair or replacement of heating, air conditioning, or refrigeration systems not exceeding 500,000 B.T.U.H.	6.00	

I hereby certify that I have carefully examined and read the above application; that the same is true and correct; and that the work herein described is to be done in accordance with all the provisions of the applicable Ordinances of the City of Las Vegas, Nevada and the State Laws, whether hereinafter specified or not.

Jodi Moore
SIGNED _____

CONTRACTOR

MASTER CARD NO. _____

PERMIT FEE: \$24.00

BY *P. Alfano*
BUILDING DEPT. _____

Spec. Off. or Owner

9-16-87
DATE

TOTAL FEES _____

2340-2405

RECEIPT

MUST BE MACHINE VALIDATED

Permit Expires 180 Days After Abandonment of Work

Debbie Ingram 4-13-89

ELEC. ONLY PLBG. ONLY, A.C. ONLY

OWNER <i>Lynn Medina</i>		DATE <i>9-16-87</i>
ADDRESS <i>808 Cantabria</i>		
CONTRACTOR	PERMIT NO.	FINAL INSPECTION
LOT	BLOCK	SUBDIVISION
LOG NO.	AREA <i>Replace unit</i>	
ELECTRIC ONLY		PLUMBING ONLY
Contractor		Contractor
Permit No.		Permit No.
Rough Elec.		Rough Soil
Final Rough		Rough Water
Final Elec.		Top Out
Temp. Service		Rough Gas
HEAT & VENT. A/C ONLY		Final Plbg.
Contractor <i>Quality A/C</i>		Final Gas
Permit No. <i>2167-1</i>		Sewer Final
Rough Duct		
Rough Gas		
Final A/C <i>IX 9/16/87</i>		
Final		

79-3-15 (11-81) DEPT. OF BLDG. & SAFETY
CITY OF LAS VEGAS