

. 725 Carpenter St .

. L 78 B 3 Char Hgts 20- A Zone R-1 .

Sham Pereira - Feb 8, 1979

Blue

CITY OF LAS VEGAS, NEVADA

LOG NO. & AREA: 1-19 DEPARTMENT OF BUILDING & SAFETY: APPLICATION & BUILDING PERMIT - for: CONST. VAL. \$ 174⁰⁰

ADDRESS OF CONSTRUCTION: 725 Carpenter St. OWNER: D. Goncalves

LOT(s): 78 BLOCK: 3 SUBDIVISION: Charleston 1st 70-A ZONE: R1

Materials of Construction: Block Concrete Wire Wood Other PLANS: Yes No

ARCHITECT: ENGINEER: CALC:

CONTRACTOR: Raring Inc. STATE LICENSE #: 42019 CITY LICENSE #: 102-9

TOTAL SQUARE FEET: TOTAL LINEAL FEET: 58'

Remarks:

CONDITIONS OF THE PERMIT:

1. Any type of retaining wall must be engineered by a Civil or Structural Engineer.
2. If a home owner takes out the Building Permit and if the owner sublets the work to a Contractor, then the Contractor must take out the permit and pay for it.
3. No fence or wall can be built on City property or rights-of-way, but this is not intended to preclude construction within utility easements if utilities will not be damaged or made inaccessible.
4. The fence or wall shall not enclose any water meter, light standard, or fire alarm box and shall not come closer than 24" from the nearest fire hydrant outlet.
5. Department Inspectors must approve footings before concrete is poured and block wall reinforcing before grouting is done.
6. Maximum height of any wall or fence is 6' side and rear yards; 4' maximum in front yard with the vertical surface above the height of 2' - 50% open.
7. It must not obstruct required onsite parking space (2 spaces for each dwelling unit) by the erection of this fence or wall.
8. By the signing of this application I herewith agree to the requirements outlined above.

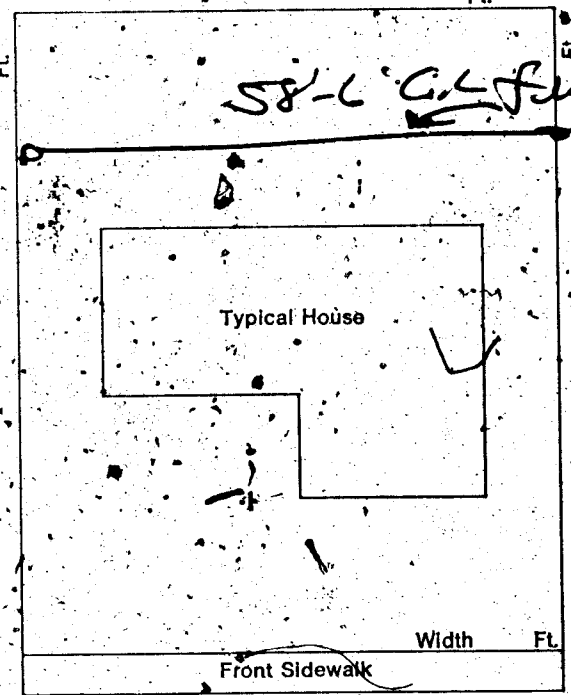

SIGNED: [Signature] DATE: 8-30-76 CONTRACTOR AGENT OWNER

PLANNING DEPT: [Signature] Date: 9-17-76

PUBLIC WORKS DEPT: [Signature] Date: 9-17-76

BUILDING DEPT: [Signature] Date: 9-17-76

#12850 PERMIT NO: 4422 PERMIT FEE \$ 5⁰⁰

RECEIPT

7114 \$005.00 - 8

CITY OF LAS VEGAS

DEPT. OF BUILDING & SAFETY

MUST BE MACHINE VALIDATED

2-27-76

Angela Jackson

DEPARTMENT OF BUILDING & SAFETY
CITY OF LAS VEGAS, NEVADA

OWNER D. Gonzalez ADDRESS 725 Carpenter KARDEX CARD
FENCE & RETAINING WALLS
DATE 0-1-75

CONTRACTOR Fencing Inc. PERMIT NO. 4422

LOT _____ BLOCK _____ SUBDIVISION Chas Hrs 20A Wood Fence

Fence (wire, wood, etc.)	Walls (masonry, rock, etc.)
Location _____	Location _____
Final Inspection _____	Footing _____
	Wall Steel 1st _____ 2d _____ 3d _____
	Final Inspection _____
Retaining Wall (masonry)	Retaining Wall (concrete)
Location _____	Location _____
Footing _____	Footing _____
Wall Steel 1st _____ 2d _____ 3d _____	Wall Steel 1st _____ 2d _____ 3d _____
Bond Beam 1st _____ 2d _____ 3d _____	Final Inspection _____
Final Inspection _____	

23.14 B ADDRESS 725 Carpenter AREA _____

DEPARTMENT OF BUILDING & SAFETY
CITY OF LAS VEGAS, NEVADA

OWNER Arthur Craig ADDRESS 725 Carpenter KARDEX CARD
FENCE & RETAINING WALLS
DATE 1-20-75

CONTRACTOR Fortune Traders PERMIT NO. 28800

LOT 78 BLOCK 3 SUBDIVISION Chas Hrs 20A Wood Fence

Fence (wire, wood, etc.)	Walls (masonry, rock, etc.)
Location _____	Location _____
Final Inspection <u>WCS 1-27-75</u>	Footing _____
	Wall Steel 1st _____ 2d _____ 3d _____
	Final Inspection _____
Retaining Wall (masonry)	Retaining Wall (concrete)
Location _____	Location _____
Footing _____	Footing _____
Wall Steel 1st _____ 2d _____ 3d _____	Wall Steel 1st _____ 2d _____ 3d _____
Bond Beam 1st _____ 2d _____ 3d _____	Final Inspection _____
Final Inspection _____	

23.14 B ADDRESS 725 Carpenter AREA _____

ANGELA JACKSON

DEPT. of BLDG & SAFETY—CITY of LAS VEGAS, NEVADA

OWNER SPROUL HOMES, INC. ADDRESS 725 CARPENTER DRIVE DATE 11-19-62

GEN CONT. Same TYPE OF STRUCTURE SFD

PERMIT NO. 13798 LEGAL DESCRIPTION Int 7A block 3 Tract 20 A

BUILDING		MECHANICAL		ELECTRICAL	
LOCATION	18 11-15-62	PLUMBING CONT.	Winters	TEMP POLE CONT.	
FIREPLACE FTS		PERMIT NO.	8240	PERMIT NO.	
FOOTINGS	11-15-62	DATE	1-16-62	DATE	
FOUNDATION WALL		HEAT & VENT. AC CONT.	Haidorn	INSPECTION	
STEM WALL		PERMIT NO.	1264	DATE	2-13-63
FLOOR FRAMING		SEWER CONT.		ELECTRICAL CONT.	12-15-62
SLAB		PERMIT NO.		PERMIT NO.	1253
CHIMNEY STEEL (FIREPLACE)		ROUGH SOIL	Lundin 12-10-62	DATE	12-15-62
WALL STEEL		ROUGH WATER	Lundin 12-10-62	FIXTURES CONT.	
COLUMN STEEL		TOP-OUT	Jacobson 1-30-63	PERMIT NO.	
BEAM STEEL		ROUGH GAS		DATE	
STEEL FABRICATION		AC ROUGH DUCT	Robert 1-30-62	SLAB	
FRAMING		REF. ROUGH PIPING		ROUGH	12-1-63
ROOF SHEATHING	12-1-63	FINAL PLUMBING	W.J. 5-63	FINAL ROUGH	
DRYWALL	INTERIOR	FINAL GAS		FINAL FIXTURE	
LATHING	EXTERIOR	FINAL AIR COND.	W.J. 5-63	TEMPORARY SERVICE	
BACKING (SIDING)		FINAL REFRIG.	Lundin 1-2-63		
PLASTER	SCRATCH	FINAL SEWER			
FINAL BLDG	DATE 3-7-63	FINAL SEPTIC TANK			

7337 APPROVED FOR OCCUPANCY Miller 3-7-63 INSPECTOR DATE

APPROVED FOR METER Miller 3-7-63

PLEASE NOTE REMARKS ON REVERSE SIDE

LOG # T 64 AREA # 4 23.04

725 CARPENTER DRIVE