

4044 Broadriver

CITY OF LAS VEGAS, NEVADA

LOG NO. & AREA T10 3/81

CONST. VAL. \$ 37,841.00

DEPARTMENT OF PUBLIC SERVICES
DIVISION OF BUILDING AND SAFETY

APPLICATION & BUILDING PERMIT - for:
Dwellings, Duplexes, Misc. Residential Const.

ADDRESS OF CONSTRUCTION: 4044 Broadriver Dr.

OWNER: Plaster Becker Company

LOT(s) 30 BLOCK 3 SUBDIVISION Charleston Heights 62B ZONE RPD 9

Existing structure on lot: Dwelling Accessory Bldgs Vacant Lot Other

PROPOSED CONSTRUCTION: Single Family Residence w/ Fireplace USE: Residence

MATERIALS OF CONSTRUCTION: Wood Frame Concrete Block Reinforced Concrete Steel Frame

SQUARE FEET OF FLOOR AREAS: 1st 1341 2nd 454 Other 24 TOTAL SQ. FT. 1819

FIRE ZONE: 3 Occupancy Group R-3 CONST. TYPE: Y-N

ARCHITECT: Charles Delk ENGINEER: G.C. Wallace NO. of UNITS 1 NO. of STORIES 1

Plans Submitted Yes No Calculations Submitted Yes No Sewer Fee Req'd. Yes No

CONTRACTOR: Plaster Becker Company STATE LICENSE # 015601 CITY LICENSE # C11-E60-219388

ADD'L. PERMITS REQ'D. Air Cond. Elec. Plumbing Signs Paving Fence Public Walks Curb-gutters
Incinerators Fire Sprinkling System

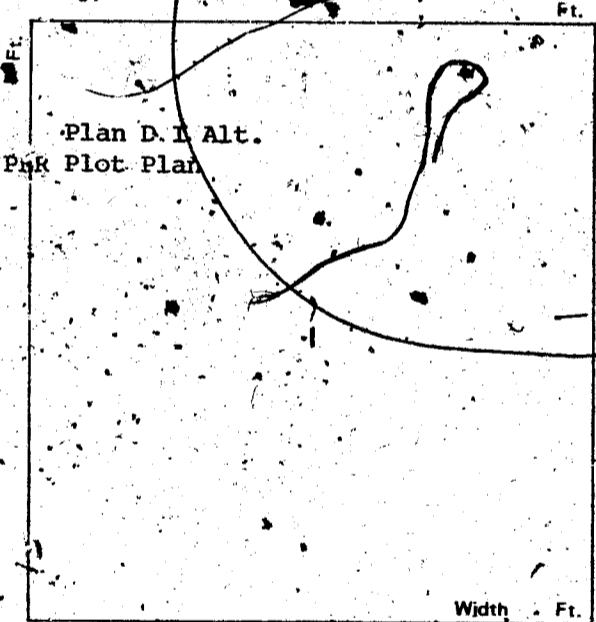

CONDITIONS OF THE PERMIT:

1. I agree to call the City Building Department for inspections before concrete is poured, before rough wiring, electrical, plumbing, framing is covered. Also for Air conditioning, drywall and sheathing inspection.
2. I agree that when the job is completed that I will call for final inspection before occupancy.
3. I agree to perform all construction in accordance with City Ordinances and Building Codes.
4. The Contractor's signature below denotes authority from the owner to sign in his behalf and that the owner is aware of all requirements of this application and permit. Separate permits must be taken out for work outlined above this agreement.
5. I have read and understand the contents of this application and permit; I hereby state that the information I have supplied on this application is true and correct.

Approval for the work under this permit will be given only after refuse and debris have been removed from job site and public right of way.

SIGNED: Plaster Becker Company Contractor

BY: [Signature] Agent or Owner

PLANNING DEPT. [Signature] Date: 5/8/81

PUBLIC WORKS DEPT. [Signature] Date: 5/11/81

BUILDING DIVISION: [Signature] Date: 5-13-81

PERMIT NO.: 1412-20 PERMIT FEE \$ 172.00

154-01-220

RECEIPT

MUST BE MACHINE VALIDATED

Lot 30 BK 3

CITY OF LAS VEGAS, NEVADA

DEPARTMENT OF BUILDING AND SAFETY - PLUMBING APPLICATION & PERMIT

ADDRESS OF CONSTRUCTION:

4044 Bradner Dr.

OWNER'S NAME:

Plaster Becker Company

PHONE NO. 672-0174

CIRCLE: Addition; Remodel; New Bldg.

TYPE OF BLDG.: SFD ART. COMM. PUBLIC

CONTRACTOR'S NAME:

Town Plumbing Plc

STATE LICENSE #

1567

CITY LICENSE #

14013

UNITS	DESCRIPTION	FEE	TOTAL
PERMIT ISSUANCE			
1	For Issuing Each Permit	10.00	10
	For Issuing Each Supplemental Permit	4.50	
FIXTURE CHARGE			
6	Bathub, Shower, Lavatory, Toilet, Urinal	EA. 2.00	12
1	Floor Drain, Floor Sink, Wash Tray, Sink	EA. 2.00	2
3	Garbage Disposal, Clothes Washer, Dishwasher (residential)	EA. 2.00	6
	Garbage Disposal (commercial)	EA. 8.00	
	Clothes Washer, Dishwasher (commercial)	EA. 2.00	
	Clothes Dryer (gas/venting)	2.00	
	Dental Unit	2.00	
	Drinking Fountain	8.00	
	Refrigerator - Ice Maker, Water Dispenser	2.00	
	Any other water using equipment, Attached Coffee Makers, Ice Makers	2.00	
1	Hot Water Heater (Gas or Electric)	EA. 2.00	2
SEWER SYSTEM			
1	New, Replacement, Modification, or Any Drainage Work	10.00	10
	Grease or Sand Trap or Interceptor	2.00	
	Trailer Trap (rental parks)	5.00	
WATER SOFTENERS			
	Non Permanent Type (rental)	2.00	
	Permanent Type (connected to drain)	2.00	
SWIMMING POOLS			
	Private or Wading Pool (including spa)	20.00	
	Public or Semi-Public	30.00	
	Spas - Preformed (private)	10.00	
	Spas - Preformed (commercial)	20.00	
WATER DISTRIBUTION SYSTEM			
1	Single Family Dwelling	6.00	6
	Multi Family Dwelling	6.00	
	Plus Each Dwelling Unit	3.00	
	Commercial Building per floor	3.00	
	Plus Each Unit (leased space or office)	2.00	
	Hotel or Motel	8.00	
	Plus Each Unit	3.00	
	Trailer Park	30.00	
	Plus Each Space	2.00	
	Irrigation	8.00	
FUEL PIPING SYSTEM			
1	Single Family Dwelling	6.00	6
	Multi-Family Dwelling	10.00	

UNITS	DESCRIPTION	FEE	TOTAL
	Plus Each Unit	2.00	
	Commercial Building (per floor)	6.00	
	Plus Each Unit (leased space or office)	6.00	
1	Medium Pressure Gas System (plan check)	12.00	12
1	Each Gas Appliance (any type)	2.00	2
	Standby Emergency (generating engines)	5.00	
	Steam Boilers	5.00	
	Service Station Fuel Tank and Piping System	10.00	
		10.00	
AUTOMATIC FIRE EXTINGUISHING SYSTEM			
	Underground Piping	20.00	
	Distribution Piping (per foot)	.05	
	Sprinkler Head (each)	.20	
	In-Range Hood and Vent	10.00	
	Dry Standpipe System		
	Piping	75.00	
	Each Outlet	2.00	
	Wet Standpipe System		
	Piping	10.00	
	Fire Hose Cabinet	2.00	
SOLAR ENERGY SYSTEMS			
	Collectors (including piping) (per collector)	5.00	
	Storage Tanks (each)	5.00	
PIPELINE CONTRACT			
	For Onsite Sewer, Gas or Water Contract Value. Fee based on Building Code Permit Valuation Chart.		
	Inspections for which no fee is specifically indicated (minimum charge - one half hour)	15.00 per hour	
	Additional plan review required by changes, additions or revisions to approved plans (minimum charge - one half hour)	15.00 per hour	
	Misc.		
	TOTAL PERMIT FEE \$	62.00	

Permit fees may be computed the same as building permit fees by using the cost of installation for valuation amount when such work is not included in the above schedule

I hereby certify that I have carefully examined and read the above application; that the same is true and correct; and that the work herein described is to be done in accordance with all the provisions of the applicable Ordinances of the City of Las Vegas, Nevada and the State Laws, whether herein specified or not.

Approval for the work under this permit will be given only after refuse and debris have been removed from job site and public right of way.

CITY MASTER CARD NO. 26

SIGNED

Roger E. Haef
Registered Master Plumber, Spec. Contractor Owner

Date

BUILDING DIVISION

T. Qui

Date 6/11/61

PERMIT NO. 2001-11

PERMIT FEE \$ 62.00

-1721-2403

RECEIPT

CITY OF LAS VEGAS, NEVADA

DEPARTMENT OF PUBLIC SERVICES - AIR CONDITIONING APPLICATION & PERMIT DIVISION OF BUILDING AND SAFETY

ADDRESS OF CONSTRUCTION: 4044 Broadview OWNER'S NAME: Plaster Becker
 CIRCLE: Addition; Remodel; New Bldg. TYPE OF BLDG.: SFD APT. COMM. PUBLIC
 CONTRACTOR'S NAME: Arco STATE LICENSE # 14196 CITY LICENSE # C-1195450

UNITS	DESCRIPTION	FEE	TOTAL
	PERMIT ISSUANCE		
✓	For the issuance of each permit.	10.00	10.00
	For issuing each supplemental permit.	3.00	
	UNIT FEE SCHEDULE		
	For the installation or relocation of each forced air or gravity-type furnace or burner, including ducts and vents attached to such appliance, up to and including 100,000 Btu/h.	6.00	
	For the installation or relocation of each forced air or gravity-type furnace or burner, including ducts and vents attached to such appliance over 100,000 Btu/h.	7.50	
	For the installation or relocation of each floor furnace, including vent.	6.00	
	For the installation or relocation of each suspended heater, recessed wall heater or floor-mounted unit heater.	6.00	
✓	For the installation, relocation or replacement of each appliance vent installed and not included in an appliance permit.	3.00	
	For the repair of, alteration of, or addition to each heating appliance, refrigeration unit, cooling unit, absorption unit, or each heating, cooling, absorption, or evaporative cooling system, including installation of controls regulated by this code.	6.00	
	For the installation or relocation of each boiler or compressor to and including three horsepower, or each absorption system to and including 100,000 Btu/h.	6.00	
✓	For the installation or relocation of each boiler or compressor over three horsepower to and including 15 horsepower, or each absorption system over 100,000 Btu/h and including 500,000 Btu/h.	11.00	11.00
	For the installation or relocation of each boiler or compressor over 15 horsepower to and including 30 horsepower, or each absorption system over 500,000 Btu/h to and including 1,000,000 Btu/h.	15.00	
	For the installation or relocation of each boiler or compressor over 30 horsepower to and including 50 horsepower, or for each absorption system over 1,000,000 Btu/h to and including 1,750,000 Btu/h.	22.50	
	For the installation or relocation of each boiler or refrigeration compressor over 50 horsepower, or each absorption system over 1,750,000 Btu/h.	37.50	

UNITS	DESCRIPTION	FEE	TOTAL
	For each air-handling unit to and including 10,000 cubic feet per minute, including ducts attached thereto. <i>Note: This fee shall not apply to an air-handling unit which is a portion of a factory-assembled appliance, cooling unit, evaporative cooler or absorption unit for which a permit is required elsewhere in this code.</i>	4.50	
	For each air-handling unit over 10,000 cfm.	7.50	
	For each evaporative cooler other than portable type.	4.50	
✓	For each ventilation fan connected to a single duct.	1.00	3.00
	For each ventilation system which is not a portion of any heating or air-conditioning system authorized by a permit.	4.50	
✓	For the installation of each hood which is served by mechanical exhaust, including the ducts for such hood.	4.50	4.50
	For the installation or relocation of each domestic-type incinerator.	7.50	
	For the installation or relocation of each commercial or industrial-type incinerator.	30.00	
	For each appliance, or piece of equipment regulated by this code but not classed in other appliance categories, or for which no other fee is listed in this code.	4.50	
	When Chapter 22 is applicable (see Section 103), permit fees for fuel-gas piping shall be as follows: For each gas-piping system of one to four outlets. For each gas-piping system of more than four outlets, per outlet.	2.00 50	
	OTHER INSPECTIONS AND FEES:		
	Inspections outside of normal business hours (minimum charge - two hours)	15.00 per hour	
	Reinspection fee assessed under provisions of Section 305 (1).	15.00 per hour	
	Inspections for which no fee is specifically indicated (minimum charge - one-half hour).	15.00 per hour	
	Additional plan review required by changes, additions or revisions to approved plans (minimum charge - one-half hour).	15.00 per hour	
	TOTAL PERMIT FEE \$ <u>26.50</u>		

I hereby certify that I have carefully examined and read the above application; that the same is true and correct; and that the work herein described is to be done in accordance with all the provisions of the applicable Ordinances of the City of Las Vegas, Nevada and the State Laws, whether herein specified or not.

Approval for the work under this permit will be given only after refuse and debris have been removed from job site and public right of way.

SIGNED: Fran Callaway Date: 6-16-81
 Air Conditioning Contractor - Owner
 BUILDING DIVISION: Toni Date: 6/19/81
 PERMIT NO.: 2198-8 PERMIT FEE: 26.50

RECEIPT

CITY OF LAS VEGAS, NEVADA

DEPARTMENT OF BUILDING AND SAFETY—ELECTRICAL APPLICATION & PERMIT

ADDRESS OF: L30 B 3 PHONE NO. 642-0923
 CONSTRUCTION: 4044 Broadview Drive OWNER'S NAME: Charleston Heights 62B (1) Plaster-Becker Company
 CIRCLE: Addition; Remodel; New Bldg. TYPE OF BLDG.: 9FD APT. COMM. PUBLIC
 CONTRACTOR'S NAME: ERIC ELECTRIC CO., INC. STATE LICENSE # 13175 CITY LICENSE # C11-10628

UNITS	DESCRIPTION	FEE	TOTAL
PERMIT ISSUANCE			
1	For Issuing Each Permit	10.00	10.00
	Supplemental Fee	4.50	
APPLIANCE CHARGE			
38	Receptacle 27 Switch 11	.40	15.20
12	Each Light Fixture or Socket	.30	3.60
6	EACH OUTLET FOR: Dishwasher, Garbage Grinder, Trash Compactor, G.F.L., Clothes Washer, Dryer, Electric Range, Ovens, Smoke Detector, Special Purpose, Water Heater, Space Heater, Blast Coil Heater (PER K.W.), Mercury Lamp, Quartz Lamp, Sodium Lamp.	.70	4.20
	X-Ray Ur.	10.00	
	Area Lighting (First 3,000 Watts)	8.00	
	Each Additional 1,000 Watts	3.00	
	Motors (1/2 H.P. And Over) Transformers Welders, Generators		
	First H.P. For each Unit	3.00	
	First KVA For Each Unit	.50	
	Each Additional H.P. or KVA	.30	
	Temporary Power or Pole	6.00	
1	Electric Service (Incl'd First Meter)	6.00	6.00
	Up to 200 AMP		
	400 AMP And 600 AMP	12.50	
	Over 600 AMP To 1200 AMP	25.00	
	Over 1200 AMP	50.00	
	Each Additional Meter Socket	.50	

UNITS	DESCRIPTION	FEE	TOTAL
	Sub Panel (Each)	3.00	
	Swimming Pool (Residential)	20.00	
	Swimming Pool (Semi-Public)	30.00	
	Spas	8.00	
	Recreational Vehicle Spaces (Each)	3.00	
	Busways-Trolley or Plug-in (Ea. 100 Ft.)	3.00	
	All Misc. Electric		
1	Permanent A/C Unit (Pkg. Units)	3.00	3.00
	Each Air Handler	1.00	
LOW VOLTAGE INSTALLATIONS			
	Speaker Outlets (Each)	.30	
	Signal or Alarm Outlets (Each)	.30	
	Amplifiers	2.00	
	Control Panel	.50	
	TV Master System	.30	
	Telephone or Computer Outlet	.30	
	Starter Permit		
	Contract Price or Cost of Installation		
	Misc.		
TOTAL PERMIT FEE \$		42.00	

Electrical permit fees may be computed the same as building permit fees by using the cost of installation for valuation amount when such work is not included in the above schedule.

FOR BUILDING DEPARTMENT USE ONLY

Plans submitted: yes no
 Received by PAC: _____ Date: _____
 Review by Plans Check: _____ Date: _____
 Issued by: _____ Date: _____
 Check Cash

Occupancy type: _____ Type of Construction _____ Square Footage _____
 Valuation (declared) \$ _____
 Fee calculated \$ _____
 Other Fees (226) \$ _____
 Total Fees \$ _____

- Other inspections and fees:
- Inspections outside of normal business hours—\$15.00 per hour (minimum charge two hours).
 - Re-inspection fee assessed under provisions of TABLE 3-A of the Uniform Building Code—\$15.00 per hour.
 - Inspections for which no fee is specifically indicated—\$15.00 per hour (minimum charge one half hour).
 - Additional plan review required by changes, additions or revisions to approved plans—\$15.00 per hour (minimum charge one half hour).

Approval for the work under this permit will be given only after refuse and debris have been removed from job site and public right of way.

I hereby certify that I have carefully examined and read the above application; that the same is true and correct; and that the work herein described is to be done in accordance with all the provisions of the applicable Ordinances of the City of Las Vegas, Nevada and the State Laws, whether herein specified or not. City Master Card No. 44

SIGNED: [Signature] Date: _____
 Master (Electrician) (Technician) (Owner)
 BUILDING DIVISION: [Signature] Date: 7-20-64
 PERMIT NO. 3055-5 PERMIT FEE \$ _____

#1721-2402

RECEIPT

OWNER **Plaster Becker** ADDRESS **4044 Broadriver**

DATE **5-20-81** GEN. CONT. **Owner**

SFD W/F/P **1412-30**

TYPE OF STRUCTURE PERMIT NO. FINAL INSPECTION

LEGAL DESCRIPTION **Lot 3 Chas. Heights 62B T10 AREA 3/81**

APPROVED FOR OCCUPANCY & METER

BUILDING	MECHANICAL
Investigation	Plumbing Cont. <i>Town & Country Pkg</i>
Location & Footing <i>VH 5-22-81</i>	Permit No. <i>2001-11</i> Date <i>4-1-81</i>
Concrete Slab Floor <i>VH 6-10-81</i>	Heat & Vent. A/C Cont. <i>Adrian</i>
Fireplace Footing	Permit No. <i>2118-9</i> Date <i>6-19-81</i>
Chimney Steel	Sewer Cont. <i>Plaster Becker</i>
Vert. Steel Reinf.	Permit No. <i>1411</i> Date <i>5/20/81</i>
Horiz. Steel Reinf.	Rough Soil <i>Pa 6-5-81</i>
Framing <i>VH 8-3-81</i>	Rough Water <i>Pa 6-9-81</i>
Ext. Lath	Top-Out <i>Pa 7-8-81</i>
Ext. Brown	Rough Gas <i>Pa 8-3-81</i>
Drywall <i>VH 8-17-81</i>	A/C Rough Duct <i>Pa 2-7-81</i>
Final Building <i>VH 10-22-81</i>	Final Plumbing <i>Pa 7-21-81</i>
Appr. for Occu.	Final Gas <i>Pa 7-21-81</i>
ELECTRICAL	Final Air Cond. <i>Pa 7-21-81</i>
Temp. Pole Cont.	Final Sewer <i>Pa 6-11-81</i>
Permit No. _____ Date _____	REMARKS
Inspection _____ Date _____	
Electrical Cont. <i>Ric Pka</i>	
Permit No. <i>3015-5</i> Date <i>7-21-81</i>	
Rough <i>Pa 7-30-81</i>	PLEASE NOTE ADDITIONAL REMARKS ON REVERSE SIDE.
Final Rough	DIV OF BLDG & SAFETY
Final Electrical <i>Pa 7-30-81</i>	CITY OF LAS VEGAS
Temporary Service	REV. 10-78
	79-3-16

Roof sheathing 207-7-8
Insulation 204-8-6-81

ELECTRIC

Project - 82

OWNER Plaster Becker ADDRESS 4044 Broadriver

DATE 5-20-81 GEN. CONT. owner

SFD W/FP 1412-30

TYPE OF STRUCTURE PERMIT NO. FINAL INSPECTION

LEGAL DESCRIPTION 30 R 3 Chas. Heights 62B T10 AREA 3/81

APPROVED FOR OCCUPANCY & METER

BUILDING	MECHANICAL
Investigation	Plumbing Cont. <u>Town & Country Pkwy</u>
Location & Footing <u>VH 5-25-81</u>	Permit No. <u>2001-11</u> Date <u>6-11-81</u>
Concrete Slab Floor <u>VH 6-10-81</u>	Heat & Vent. A/C Cont. <u>owner</u>
Fireplace Footing	Permit No. <u>2091-9</u> Date <u>6-19-81</u>
Chimney Steel	Sewer Cont. <u>Plaster Becker</u>
Vert. Steel Reinf.	Permit No. <u>1411</u> Date <u>5/20/81</u>
Horiz. Steel Reinf.	Rough Soil <u>Pa 6-5-81</u>
Framing <u>VH 8-3-81</u>	Rough Water <u>Pa 6-9-81</u>
Ext. Lath	Top-Out <u>Pa 7-5-81</u>
Ext. Brown	Rough Gas <u>Pa 8-3-81</u>
Drywall <u>VH 8-12-81</u>	A/C Rough Duct <u>Pa 7-7-81</u>
Final Building <u>VH 10-22-81</u>	Final Plumbing <u>JR 9-21-81</u>
Appr. for Occu.	Final Gas <u>JL 9-21-81</u>
ELECTRICAL	Final Air Cond. <u>JL 9-21-81</u>
Temp. Pole Cont.	Final Sewer <u>Pa 6-11-81</u>

REMARKS

Permit No.	Date	REMARKS
Inspection	Date	
Electrical Cont. <u>Ric Ellis</u>		
Permit No. <u>3055-5</u> Date <u>7-28-81</u>		
Rough <u>Da 7-30-81</u>		PLEASE NOTE ADDITIONAL REMARKS ON REVERSE SIDE.
Final Rough		DIV OF BLDG. & SAFETY CITY OF LAS VEGAS REV. 10-78
Final Electrical <u>Da 9-30-81</u>		79-3-16
Temporary Service		

Sheet 82

Roof sheathing 2-7-81
Insulation 8-6-81