

4525 ALAMEDA AVE.

LOT 54 B5 METROPOLITAN PARK UNIT 18 P-1 ZONE SFD

CITY OF LAS VEGAS, NEVADA

DEPARTMENT OF PUBLIC SERVICES—APPLICATION AND PERMIT FOR PLUMBING DIVISION OF BUILDING AND SAFETY

ADDRESS OF CONSTRUCTION: 4525 Alameda St OWNER'S NAME: METRO-NEW Corp
 CIRCLE: New Bldg. Add'n.; Remodel; TYPE OF BLDG: SFD APT. PUBLIC COMM.
 CONTRACTOR'S NAME: Sterling Plmb STATE LICENSE # 7119A CITY LICENSE # 910

UNITS	DESCRIPTION	FEE	TOTAL
1	Bathtub	1.00	1-
1	Shower	1.00	1-
2	Lavatory	1.00	2-
2	Toilet	1.00	2-
	Urinal	1.00	
	Floor Drain	1.00	
	Floor Sink	1.00	
	Wash Tray	1.00	
1	Sink	1.00	1-
	Garbage Disposal	1.00	
	Garbage Disposal (comm.)	3.00	
	Clothes Dryer (gas)	1.00	
	Clothes Washer	1.00	1-
	Clothes Washer (comm.)	5.00	
	Dishwasher	1.00	
	Dishwasher (commercial)	5.00	
	Dental Unit	10.00	
	Drinking Fountain	1.00	
	Any Water-using Equipment	1.00	
1	Water Heater (gas) (elect.)	1.00	1-
	Sewer System—New, Replacement, or any Drainage System	4.00	4-
	Grease or Sand Trap	2.00	
	Trailer Trap	2.00	
	Septic Disposal System	4.00	
WATER SOFTENERS			
	Nonpermanent Type	4.00	
	Permanent Type (connected to Drainage)	5.00	
SWIMMING POOLS			
	Private or Wading Pool	10.00	
	Public or Semi-public	20.00	

UNITS	DESCRIPTION	FEE	TOTAL
WATER DISTRIBUTION SYSTEM			
1	Single Family Dwelling	4.00	4-
	Multiple Family Dwelling plus each unit	4.00	
		2.00	
	Commercial Bldg. per floor	6.00	
	Hotel or Motel plus each bath	4.00	
		-1.50	
	Trailer Park plus each space	20.00	
		1.00	
	Regation	4.00	
GAS PIPING SYSTEM			
1	Single Family Dwelling	3.00	3-
	Multiple Family Dwelling plus each unit	6.00	
		1.00	
	Commercial Bldg. per floor plus each unit	3.00	
		3.00	
	Gas Appliance (any type)	1.00	
AUTOMATIC FIRE EXTINGUISHING SYSTEM			
	Underground Piping	10.00	
	Distribution Piping ea. ft.	.01	
	Sprinkler Head each	.10	
	In Range Hood and Vent	5.00	
DRY STANDPIPE SYSTEM			
	Piping	50.00	
	Each Outlet	1.00	
WET STANDPIPE SYSTEM			
	Piping	5.00	
	Fire Hose Cabinet	1.00	
	MINIMUM PERMIT FEE	4.00	
PIPELINE CONTRACTOR; SECT. 14-B.P.F. \$			
TOTAL PERMIT FEE \$ <u>200</u>			

I hereby certify that I have carefully examined and read the above application; that the same is true and correct; and that the work herein described is to be done in accordance with all the provisions of the applicable Ordinances of the City of Las Vegas, Nevada and the State Laws, whether herein specified, or not.

Approval for the work under this permit will be given only after refuse and debris have been removed from job site and public right of way.

Signed: [Signature] Date: 6/6/78
Registered Master Plumber, Spec. Cont'r. or Owner

Building Division: MP Date: 6-6-78

Permit No. 6900-2 Permit Fee \$ 200

154-01-222

RECEIPT

MUST BE MACHINE VALIDATED

CITY OF LAS VEGAS, NEVADA

DEPARTMENT OF PUBLIC SERVICES - AIR CONDITIONING APPLICATION & PERMIT
 DIVISION OF BUILDING AND SAFETY

ADDRESS OF CONSTRUCTION: 4525 Alameda Avenue OWNER'S NAME: METROPOLITAN PARK CONSTRUCTION

CIRCLE: Addition; Remodel; New Bldg; TYPE OF BLDG.: SFD APT. COMM. PUBLIC

CONTRACTOR'S NAME: CENTRAL AIR CONDITIONING INC. STATE LICENSE # 11997 CITY LICENSE # 00057

UNITS	DESCRIPTION	FEE	TOTAL	UNITS	DESCRIPTION	FEE	TOTAL
	Unit heater - floor, wall or suspended	4.00			EVAPORATIVE COOLERS:		
	FOR EACH FORCED-AIR OR GRAVITY-TYPE FURNACE OR BURNER INCLUDING DUCTS AND VENT ATTACHED TO SUCH APPLIANCES:				5 outlets or under	3.00	
	Up to and including 100,000 B.t.u.'s	4.00			Over 5 and up to and including 10	5.00	
	Over 100,000 B.t.u.'s	6.00			Each additional outlet over 10	.25	
	FOR EACH HEATING APPLICATION, REFRIGERATION UNIT, COMFORT COOLING AND HEATING UNIT, ABSORPTION UNIT, COMPRESSOR OR BOILER:				VENTILATION:		
	Up to and including 3 ton or horsepower, or absorption system, up to and including 100,000 B.t.u.'s	4.00			For each fan connected to a single duct	1.00	
<u>1-3 1/2</u>	Over 3 ton or 3 horsepower up to and including 10, or absorption, system over 100,000 B.t.u.'s up to and including 250,000 B.t.u.'s	7.00	<u>\$7.00</u>		For each commercial or industrial ventilation system	5.00	
	Over 10 ton or 10 horsepower up to and including 30, or absorption system over 250,000 B.t.u.'s up to and including 1,000,000 B.t.u.'s	12.00			For each commercial kitchen hood	5.00	
	Over 30 ton or 30 horsepower up to and including 50, or absorption system over 1,000,000 B.t.u.'s up to and including 1,700,000 B.t.u.'s	20.00			MISCELLANEOUS:		
	Over 50 ton or 50 horsepower, or absorption system over 1,700,000 B.t.u.'s	30.00			For each water cooling tower	8.00	
	FOR EACH AIR HANDLING UNIT INCLUDING DUCTS ATTACHED THERETO:				Duct work only - each opening	.25	
	Up to and including 10,000 CFM	2.00			For installation or relocation of each commercial or industrial incinerator	15.00	
	Over 10,000 CFM	4.00			Gas piping related to the air cond. work in single family dwelling only.	3.00	
					For each appliance, piece of equipment, any mechanical work or alteration or replacement not included in this schedule, the permit fee shall be computed the same as building permit fees by using the cost of installation for the valuation amount.		
					FOR THE ISSUANCE OF EACH PERMIT	3.00	
					TOTAL PERMIT FEE \$		\$10.00

I hereby certify that I have carefully examined and read the above application; that the same is true and correct; and that the work herein described is to be done in accordance with all the provisions of the applicable Ordinances of the City of Las Vegas, Nevada and the State Laws, whether herein specified or not.

Approval for the work under this permit will be given only after refuse and debris have been removed from job site and public right of way.

SIGNED L. L. Spradell Date 07/13/78
 Air Conditioning Contractor - Owner

BUILDING DIVISION M.S. Date 7-31-78

PERMIT NO. 2385-31 PERMIT FEE \$ 10.00

RECEIPT

MUST BE MACHINE VALIDATED

J. Q. Davis 12-4-78

CITY OF LAS VEGAS, NEVADA

DEPARTMENT OF PUBLIC SERVICES—ELECTRICAL APPLICATION & PERMIT

DIVISION OF BUILDING AND SAFETY

ADDRESS OF CONSTRUCTION: 4525 Alameda Ave. OWNER'S NAME: Metropolitan-Nevada Corp.

CIRCLE: New Bldg; Add'n.; Remodel; TYPE OF BLDG.: SFD. APT. PUBLIC COMM.

CONTRACTOR'S NAME: Urban Electric Corp. STATE LICENSE # 8016A CITY LICENSE # 9013

NUMBER	FIXTURE OR INSTALLATION	UNIT PRICE	TOTAL
	Rm addition, carport or garage enclosure	4.00	
	Temporary power	4.00	
57	Light, receptacle or switch outlet	.20	11.40
	Wall or ceiling space heater	.35	
1	Garbage grinder outlet	.35	.35
1	Dishwasher outlet	.38	.35
1	Clothes dryer outlet	.35	.35
1	Automatic clothes washer	.35	.35
	Electric range outlet	.35	
	Electric water heater outlet	.35	
1	Special purpose outlet	.35	.35
	X-ray unit and its appurtenances	5.00	
	Watts of festoon lighting (Watts) First 3,000 watts for each additional thousand watts	4.00 1.50	
	Horsepower each motor first horsepower or less for each additional horsepower	1.75 .35	
1	Electric service (including any single meter socket) for each additional socket	3.00 .35	3.00
	Air conditioning service	1.50	
	Each KW(KVA) Generator (Transformer, Welder) First 100 KVA for each additional KW(KVA)	2.00 .01	
	Speaker, signal or alarm outlet	.15	
	Amplifiers	.50	
	Control panels	.25	
	Main control racks	1.00	
	T.V. and radio antennas-master system only	.75	
	Minimum fee for any permit	4.00	
	TOTAL FEE		16.50

Approval for the work under this permit will be given only after refuse and debris have been removed from job site and public right of way.

I hereby certify that I have carefully examined and read the above application; that the same is true and correct; and that the work herein described is to be done in accordance with all the provisions of the applicable Ordinances of the City of Las Vegas, Nevada and State laws whether herein specified or not.

SIGNED Urban DATE 8/25/78
 MASTER ELECTRICIAN (TECHNICIAN/TOWNER)
 BUILDING DIVISION: WRJ DATE 8/25/78
 PERMIT NO. 9016-13 PERMIT FEE: 16.50

RECEIPT

MUST BE MACHINE DATED

CITY OF LAS VEGAS, NEVADA

33-07

LOG NO. & AREA T-3r2 CONST. VAL. \$ 29,410

DEPARTMENT OF PUBLIC SERVICES
DIVISION OF BUILDING AND SAFETY

APPLICATION & BUILDING PERMIT - for:
Dwellings, Duplexes, Misc. Residential Const.

ADDRESS OF CONSTRUCTION: 4575 Alameda Ave. OWNER: METROPOLITAN-NEVADA CORPORATION

LOT(s) 54 BLOCK 5 SUBDIVISION METROPOLITAN PARK Unit #18 ZONE: R-1

Existing structure on lot: Dwelling Accessory Bldgs. Vacant Lot Other

PROPOSED CONSTRUCTION: Single Family Dwelling USE: Residence

MATERIALS OF CONSTRUCTION: Wood Frame Concrete Block Reinforced Concrete Steel Frame

SQUARE FEET OF FLOOR AREAS: 1st 1252 2nd _____ 3rd _____ Other 137 TOTAL SQ. FT. 1689

FIRE ZONE: 3 Occupancy Group R-3 & R-1 CONST. TYPE: 5N

ARCHITECT: _____ ENGINEER: David Weiss NO. of UNITS 1 NO. of STORIES 1

Plans Submitted: Yes No Calculations Submitted: Yes No Sewer Fee Req'd. Yes No

CONTRACTOR: METROPOLITAN-NEVADA STATE LICENSE # 11199 CITY LICENSE # 16382

ADD'L. PERMITS REQ'D.: Air Cond. Elec. Plumbing Signs Paving Fence Public Walks Curb gutters
Incinerators Fire Sprinkling System

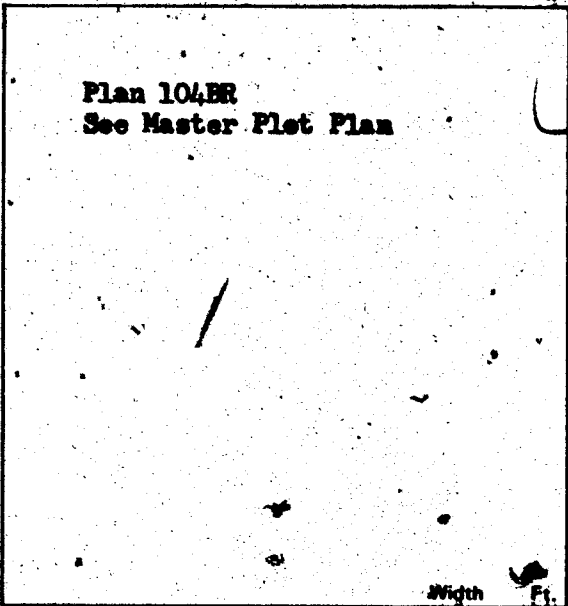

CONDITIONS OF THE PERMIT:

1. I agree to call the City Building Department for inspections before concrete is poured, before rough wiring, electrical, plumbing, framing is covered. Also for Air-conditioning, drywell and sheathing inspection.
2. I agree that when the job is completed that I will call for final inspection before occupancy.
3. I agree to perform all construction in accordance with City Ordinances and Building Codes.
4. The Contractor's signature below denotes authority from the owner to sign in his behalf and that the owner is aware of all requirements of this application and permit. Separate permits must be taken out for work outlined above this agreement.
5. I have read and understand the contents of this application and permit; I hereby state that the information I have supplied on this application is true and correct.

Approval for the work under this permit will be given only after refuse and debris have been removed from job site and public right of way.

SIGNED: METROPOLITAN-NEVADA CORPORATION Contractor

BY: Wesley Lester, Vice President Agent or Owner

Front property line

PLANNING DEPT.: _____ Date: 5-25-78

PUBLIC WORKS DEPT.: Cheryl Jule Date: 5/26/78

BUILDING DIVISION: WR7 Date: 5/26/78

PERMIT NO.: 6679-2 PERMIT FEE \$ 131.00

154-01-220

RECEIPT

MUST BE MACHINE VALIDATED

Gloria Ealy 10-22-80

DIVISION of BUILDING & SAFETY - CITY of LAS VEGAS, NEVADA

OWNER Metropolitan Nev ADDRESS 4525 Alameda Ave. DATE 5/26/78
 GEN. CONT. Same TYPE OF STRUCTURE SFD
 PERMIT NO. 6679-2 LEGAL DESCRIPTION Metropolitan Park #.18

BUILDING	MECHANICAL	ELECTRICAL
Investigation	Plumbing Cont. <i>Merling</i>	Temp. pole cont.
Location & Footing <i>M 2-6-78</i>	Permit No. <i>6700-2</i> Date <i>6-6-78</i>	Permit No. _____ Date _____
Stem Wall	Heat & Vent. A/C Cont. <i>Central a/c</i>	Inspection _____ Date _____
Concrete Slab Floor <i>M 2-6-78</i>	Permit No. <i>2385-31</i> Date <i>2-3-78</i>	Electrical Cont. <i>Urban</i>
Floor Framing	Sewer Cont. Metropolitan Nev	Permit No. <i>9026-43</i> Date <i>8-25-78</i>
Fireplace Footing	Permit No. 6678 Date _____	Fixtures Cont. _____
Chimney Steel <i>VH 8-22-78</i>	Rough Soil <i>KW 6-8-78</i>	Permit No. _____ Date _____
Veri. Steel Reinf.	Rough Water <i>KW 6-8-78</i>	Slab _____
Horiz. Steel Reinf.	Top Out <i>KW 8-2-78</i>	Rough _____
Roof Sheathing <i>VH 8-4-78</i>	Rough Gas <i>KW 8-2-78</i>	Final Rough <i>KW 8-2-78</i>
Framing <i>VH 8-28-78</i>	A/C Rough Duct <i>KW 8-2-78</i>	Final Fixture _____
Backing for siding	Ref. Rough Piping	Final Electrical <i>Rp 11-15-78</i>
Ext. Lath	Final Plumbing <i>JC 11-1-78</i>	Temporary Service _____
Ext. Scratch <i>VH 7-12-78</i>	Final Gas <i>JC 11-1-78</i>	MISCELLANEOUS
Ext. Brown <i>VH 9-15-78</i>	Final Air Cond. <i>JC 10-23-78</i>	Grading & Drainage _____
Int. Lath	Final Refrig. _____	On Site Parking Spaces _____ App. _____
Int. Brown	Final Sewer <i>KW 8-12-78</i>	Eng. Approval of _____
Dry _____	Final Septic Tank _____	Off Site Improvements _____
Insulation <i>VH 8-28-78</i>		
Final Building <i>VH 11-22-78</i>		
Appr. for Occu.		

INSPECTOR: _____ DATE: _____

APPROVED FOR OCCUPANCY & METER _____

PLEASE NOTE REMARKS ON REVERSE SIDE 4525 Alameda Av.e LOG # _____ AREA # *T-3-2* 76-114

Debra Ingram 8-27-87

CITY OF LAS VEGAS, NEVADA

LOG NO. & AREA N/A DATE 8/25/87 CONST. VAL. \$ 3415.00

DEPARTMENT OF BUILDING AND SAFETY 060-313-013 DEVELOPMENT PERMIT AND BUILDING PERMIT
PHONE 386-6251 FOR: Fence, Wall, Retaining Wall

ADDRESS OF CONSTRUCTION 4525 Alameda Ave. OWNER Scott Corbett

CONTRACTOR owner STATE LICENSE NO. CITY LICENSE NO.

LOT(S) 54 BLOCK 5 SUBDIVISION Met Park #18 ZONE R-1

CONSTRUCTION PLANS SUBMITTED BY OWNER/CONTRACTOR CONSTRUCTION DESIGN BY CITY DESIGN SHEET.
BUILDING PERMIT NO. 15-24 ENGINEER

Approval for the work under this permit will be given only after refuse and debris have been removed from job site and public right of way.

DESCRIPTION	TOTAL LIN. FT.	TOTAL SQ. FT.
CHAIN LINK OR WIRE MESH		
ORNAMENTAL IRON		
WOOD		
<input checked="" type="checkbox"/> MASONRY	<u>237</u>	<u>1366</u>
RETAINING		

OTHER INSPECTIONS AND FEES

- Inspections outside of normal business hours - \$30.00 per hour (minimum charge three hours).
- Re-inspection fee during normal business hours assessed under provisions of TABLE 3-A of the Uniform Building Code - \$30.00 each.
- Inspections during normal business hours for which no fee is specifically indicated - \$30.00 per hour (minimum charge one half hour).
- Additional plan review required by changes, additions or revisions at approved plans - \$30.00 per hour (minimum charge two hours).

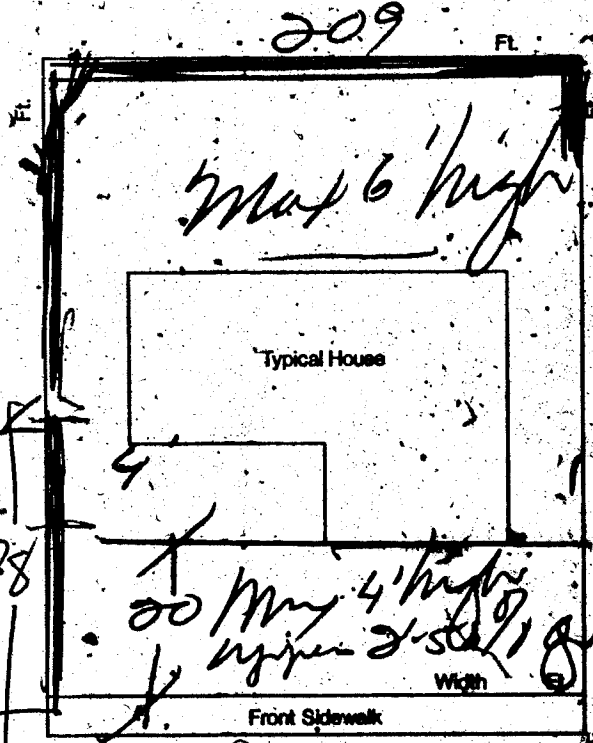

CONDITIONS OF THE PERMIT:

- Any type of retaining wall must be engineered by a Civil or Structural Engineer.
- If a home owner takes out the Building Permit and if the owner sublets the work to a Contractor, then the Contractor must take out the permit and pay for it.
- No fence or wall can be built on City property or rights-of-way, but this is not intended to preclude construction within utility easements if utilities will not be damaged or made inaccessible.
- The fence or wall shall not enclose any water meter, light standard, or fire alarm box and shall not come closer than 24" from the nearest fire hydrant outlet.
- Department inspections must approve footings before concrete is poured and block wall reinforcing before grouting is done.
- Maximum height of any wall or fence is 6' side and rear yards; 4' maximum in front yard with the vertical surface above the height of 2' - 50% open.
- It must not obstruct required on-site parking space (2 spaces for each dwelling unit) by the erection of this fence or wall.
- By the signing of this application I herewith agree to the requirements outlined above.

SIGNED Scott Corbett CONTRACTOR - AGENT - OWNER

08/25/87

PLANNING DEPT. I hereby certify that I have reviewed this application and the proposed plans and have found that the proposed development meets the requirements of the City of Las Vegas Flood Hazard Reduction Ordinance for the issuance of this Development Permit.

[Signature] LAND DEVELOPMENT AND FLOOD CONTROL ENGINEER DATE 8/24/87

MA BUILDING DEPT. DATE 8/25/87

PLAN REVIEW FEE
PERMIT FEE 53.40
2310-2401
TOTAL FEES

RECEIPT
0003
WALL 53.40
CHEK 53.40
1524A000 10:57

MUST BE MACHINE VALIDATED

PERMIT EXPIRES 180 DAYS AFTER ABANDONMENT OF WORK

Debbie Ingdram 10-29-87

FENCE & RETAINING WALLS

OWNER Scott Corbett		DATE 8-26-87
ADDRESS 4525 Alameda Ave.		
CONTRACTOR owner	PERMIT NO. 1524	LOG NO.
LEGAL		
FENCES (wire, wood, block, & retaining walls)		
Location & Footing		
1st	2nd	3rd
Horiz. & Vert. Steel		
1st	2nd	3rd
Grid		
1st	2nd	3rd
Bond Beam		
1st	2nd	3rd
Footing		
TS 10-12-87		
Specify Type Of Fence		
2-1-88	DIV. OF ENG. & SAFETY CITY OF LAS VEGAS REV. 11-81	