

. 7101 Alamosa Way .

LOT 14 BLK 5 RAINBOW WEST #1 ZONE R-1 SFD

L. Collins 12-5-78

18-09

F-26-3

# CITY OF LAS VEGAS, NEVADA

LOG NO. & AREA

CONST. VAL. \$

34670<sup>00</sup>

DEPARTMENT OF PUBLIC SERVICES  
DIVISION OF BUILDING AND SAFETY

APPLICATION & BUILDING PERMIT - for:  
Dwellings, Duplexes, Minor Residential Const.

ADDRESS OF CONSTRUCTION:

7101 Alamosa Way

OWNER:

U.S. Home Corporation

LOT(s)

14

BLOCK

5

SUBDIVISION

Rainbow West # 1

ZONE:

R-1

Existing structure on lot:

Dwelling

Accessory Bldgs.

Vacant Lot

Other

PROPOSED CONSTRUCTION:

SFD

USE:

Res

MATERIALS OF CONSTRUCTION:

Wood Frame

Concrete Block

Reinforced Concrete

Steel Frame

SQUARE FEET OF FLOOR AREAS:

1st 1502

2nd

3rd

Other 463

TOTAL SQ. FT.

1965

FIRE ZONE:

3

Occupancy Group

R-3 + M1

CONST. TYPE:

Frame & stucco V-N

ARCHITECT:

John Sherman

ENGINEER:

NO. of UNITS

NO. of STORIES

1

Plans Submitted:

Yes

No

Calculations Submitted

Yes

No

Sewer Fee Req'd.

Yes

No

CONTRACTOR:

U.S. Home Corporation

STATE LICENSE #

14506

CITY LICENSE #

C11 17512

ADD'L. PERMITS REQ'D.:

Air Cond.

Elec.

Plumbing

Signs

Paving

Fence

Public Walks

Curb-gutters

Incinerators

Fire Sprinkling System

### CONDITIONS OF THE PERMIT:

1. I agree to call the City Building Department for inspections before concrete is poured, before rough wiring, electrical, plumbing, framing is covered. Also for Air conditioning, drywall and sheathing inspection.
2. I agree that when the job is completed that I will call for final inspection before occupancy.
3. I agree to perform all construction in accordance with City Ordinances and Building Codes.
4. The Contractor's signature below denotes authority from the owner to sign in his behalf and that the owner is aware of all requirements of this application and permit. Separate permits must be taken out for work outlined above this agreement.
5. I have read and understand the contents of this application and permit; I hereby state that the information I have supplied on this application is true and correct.

Approval for the work under this permit will be given only after refuse and debris have been removed from job site and public right of way.

SIGNED:

U.S. HOME CORPORATION

Contractor

*George E. Holmbeck, U.S.*

Agent or Owner

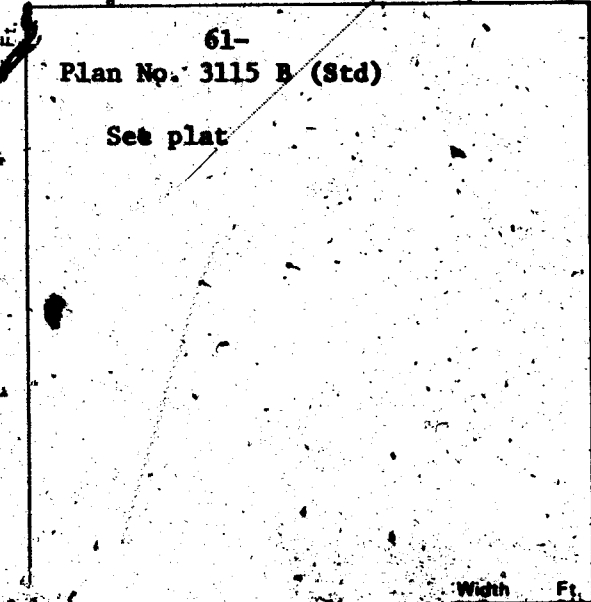

PLANNING DEPT.:

*AAA*

Date:

7-25-78

PUBLIC WORKS DEPT.:

*Charles Suh*

Date:

7/26/78

BUILDING DIVISION:

*RET*

Date:

8-1-78

PERMIT NO.:

8841-7-3/4

PERMIT FEE \$

147.<sup>00</sup>

154-01-220

RECEIPT

MUST BE MACHINE VALIDATED

L. Collins 12-5-78

# CITY OF LAS VEGAS, NEVADA

## DEPARTMENT OF PUBLIC SERVICES - AIR CONDITIONING APPLICATION & PERMIT DIVISION OF BUILDING AND SAFETY

ADDRESS OF CONSTRUCTION: 7101 Alamosa Way OWNER'S NAME: U S Homes

CIRCLE: Addition, Remodel, New Bldg. TYPE OF BLDG.: SFD APT. COMM. PUBLIC

CONTRACTOR'S NAME: Valley Aire, Inc. STATE LICENSE # 74018 CITY LICENSE # 2-11-18140

UNITS	DESCRIPTION	FEE	TOTAL	UNITS	DESCRIPTION	FEE	TOTAL
	Unit heater - floor, wall or suspended	4.00			EVAPORATIVE COOLERS:		
	FOR EACH FORCED-AIR OR GRAVITY-TYPE FURNACE OR BURNER INCLUDING DUCTS AND VENT ATTACHED TO SUCH APPLIANCES:				5 outlets or under	3.00	
	Up to and including 100,000 B.t.u.'s	4.00			Over 5 and up to and including 10	5.00	
	Over 100,000 B.t.u.'s	6.00			Each additional outlet over 10	.25	
	FOR EACH HEATING APPLICATION, REFRIGERATION UNIT, COMFORT COOLING AND HEATING UNIT, ABSORPTION UNIT, COMPRESSOR OR BOILER:				VENTILATION:		
1	Up to and including 3 ton or horsepower, or absorption system up to and including 100,000 B.t.u.'s	4.00	4.00		For each fan connected to a single duct	1.00	
	Over 3 ton or 3 horsepower up to and including 10, or absorption system over 100,000 B.t.u.'s up to and including 250,000 B.t.u.'s	7.00			For each commercial or industrial ventilation system	5.00	
	Over 10 ton or 10 horsepower up to and including 30, or absorption system over 250,000 B.t.u.'s up to and including 1,000,000 B.t.u.'s	12.00			For each commercial kitchen hood	5.00	
	Over 30 ton or 30 horsepower up to and including 50, or absorption system over 1,000,000 B.t.u.'s up to and including 1,700,000 B.t.u.'s	20.00			MISCELLANEOUS:		
	Over 50 ton or 50 horsepower, or absorption system over 1,700,000 B.t.u.'s	30.00		8	For each water cooling tower	8.00	
	FOR EACH AIR HANDLING UNIT INCLUDING DUCTS ATTACHED THERETO:				Duct work only - each opening	.25	2.00
	Up to and including 10,000 CFM	2.00			For installation or relocation of each commercial or industrial incinerator	15.00	
	Over 10,000 CFM	4.00			Gas piping related to the air cond. work in single family dwelling only	3.00	
					For each appliance, piece of equipment, any mechanical work or alteration or replacement not included in this schedule, the permit fee shall be computed the same as building permit fees by using the cost of installation for the valuation amount.		
					FOR THE ISSUANCE OF EACH PERMIT		3.00
					TOTAL PERMIT FEE \$	9.00	

I hereby certify that I have carefully examined and read the above application; that the same is true and correct; and that the work herein described is to be done in accordance with all the provisions of the applicable Ordinances of the City of Las Vegas, Nevada and the State Laws, whether herein specified or not.

Approval for the work under this permit will be given only after refuse and debris have been removed from job site and public right of way.

SIGNED [Signature] Date 10/28/78  
Air Conditioning Contractor/Owner

BUILDING DIVISION B.D. Date 10-30-78

PERMIT NO. 10560-2 PERMIT FEE \$ 9.00

RECEIPT  
  
  
  
  
  
  
  
  
  
  
MUST BE MACHINE VALIDATED

#12890

**CITY OF LAS VEGAS, NEVADA**

**DEPARTMENT OF PUBLIC SERVICES—ELECTRICAL APPLICATION & PERMIT**  
DIVISION OF BUILDING AND SAFETY

ADDRESS OF CONSTRUCTION: 7101 Alamosa Way

OWNER'S NAME: U.S. HOMES, INC.

CIRCLE: New Bldg. Add'n.; Remodel; TYPE OF BLDG.: SFD. APT. PUBLIC COMM.

CONTRACTOR'S NAME: ANDERSON ELECTRIC

STATE LICENSE # 10997

CITY LICENSE # 090-2-00350

NUMBER	FIXTURE OR INSTALLATION	UNIT PRICE	TOTAL
	Rm addition, carport or garage enclosure	4.00	
	Temporary power	4.00	
66	Light, receptacle or switch outlet	.20	13.20
	Wall or ceiling space heater	.35	
1	Garbage grinder outlet	.35	.35
1	Dishwasher outlet	.35	.35
1	Clothes dryer outlet	.35	.35
1	Automatic clothes washer	.35	.35
	Electric range outlet	.35	.35
1	Electric water heater outlet	.35	.35
	Special purpose outlet	.35	
	X-ray unit and its appurtenances	5.00	
	Watts of festoon lighting (Watts) First 3,000 watts for each additional thousand watts	4.00 1.50	
	Horsepower—each motor first horsepower or less for each additional horsepower	1.75 .35	
1	Electric service (including any single meter socket) for each additional socket	3.00 .35	3.00
1	Air conditioning service	1.50	1.50
	Each KW(KVA) Generator (Transformer, Welder) First 100 KVA for each additional KW(KVA)	2.00 .91	
	Speaker, signal or alarm outlet	.15	.15
	Amplifiers	.50	
	Control panels	.25	
	Main control racks	1.00	
	T.V. and radio antennas—master system only	.75	
	Minimum fee for any permit	4.00	
	<b>TOTAL FEE</b>		<b>19.60</b>

Approval for the work under this permit will be given only after refuse and debris have been removed from job site and public right of way.

I hereby certify that I have carefully examined and read the above application; that the same is true and correct, and that the work herein described is to be done in accordance with all the provisions of the applicable Ordinances of the City of Las Vegas, Nevada and State laws whether herein specified or not.

SIGNED Anderson DATE 12-7-28  
 MASTER (ELECTRICIAN) (TECHNICIAN) (OWNER) # 65  
 BUILDING DIVISION: RU DATE 12/7/28  
 PERMIT NO. 11550-17 PERMIT FEE: \$ 19.60

**RECEIPT**  
 MUST BE MACHINE VALIDATED

Sharon Pereira March 2, 1979

# CITY OF LAS VEGAS, NEVADA

## DEPARTMENT OF PUBLIC SERVICES—APPLICATION AND PERMIT FOR PLUMBING DIVISION OF BUILDING AND SAFETY

ADDRESS OF CONSTRUCTION: 7101 Alamo Ave. WY OWNER'S NAME: US Homes  
 CIRCLE: New Bldg. Add'n. Remodel. TYPE OF BLDG.: SFD. APT. PUBLIC COMM.  
 CONTRACTOR'S NAME: Ron Scarlett Plumb STATE LICENSE # 1431-9 CITY LICENSE # CL-16914

UNITS	DESCRIPTION	FEE	TOTAL
1	Bathtub	1.00	1-
1	Shower	1.00	1-
3	Lavatory	1.00	3-
2	Toilet	1.00	2-
	Urinal	1.00	
	Floor Drain	1.00	
	Floor Sink	1.00	
	Wash Tray	1.00	
1	Sink	1.00	1-
1	Garbage Disposal	1.00	1-
	Garbage Disposal (comm.)	3.00	
	Clothes Dryer (gas)	1.00	
1	Clothes Washer	1.00	1-
	Clothes Washer (comm.)	5.00	
1	Dishwasher	1.00	1-
	Dishwasher (commercial)	5.00	
	Dental Unit	10.00	
	Drinking Fountain	1.00	
	Any Water using Equipment	1.00	
1	Water Heater (gas) (elect.)	1.00	1-
1	Sewer System—New, Replacement, or any Drainage System	4.00	4-
	Grease or Sand Trap	2.00	
	Trailer Trap	2.00	
	Septic Disposal System	4.00	
WATER SOFTENERS			
	Nonpermanent Type	4.00	
	Permanent Type (connected to Drainage)	5.00	
SWIMMING POOLS			
	Private or Wading Pool	10.00	
	Public or Semi-public	20.00	

UNITS	DESCRIPTION	FEE	TOTAL
WATER DISTRIBUTION SYSTEM			
1	Single Family Dwelling	4.00	4-
	Multiple Family Dwelling plus each unit	4.00	
		2.00	
	Commercial Bldg. per floor	6.00	
	Hotel or Motel plus each bath	4.00	
		1.50	
	Trailer Park plus each space	20.00	
		1.00	
	Irrigation	4.00	
GAS PIPING SYSTEM			
1	Single Family Dwelling	3.00	3-
	Multiple Family Dwelling plus each unit	6.00	
		1.00	
	Commercial Bldg. per floor plus each unit	3.00	
		3.00	
	Gas Appliance (any type)	1.00	
AUTOMATIC FIRE EXTINGUISHING SYSTEM			
	Underground Piping	10.00	
	Distribution Piping ea. ft.	.01	
	Sprinkler Head each	.10	
	In Range Hood and Vent	5.00	
DRY STANDPIPE SYSTEM			
	Piping	50.00	
	Each Outlet	1.00	
WET STANDPIPE SYSTEM			
	Piping	5.00	
	Fire Hose Cabinet	1.00	
		1.00	
MINIMUM PERMIT FEE 4.00			
PIPELINE CONTRACTOR, SECT. 14-B.P.F. S			
TOTAL PERMIT FEE \$ <u>23-</u>			

I hereby certify that I have carefully examined and read the above application; that the same is true and correct; and that the work herein described is to be done in accordance with all the provisions of the applicable Ordinances of the City of Las Vegas, Nevada, and the State Laws, whether herein specified or not.

Approval for the work under this permit will be given only after refuse and debris have been removed from job site and public right of way.

Signed: Ron Scarlett Date: 2-28-79  
Registered Master Plumber, Spec. Contr. or Owner  
 Building Division: BD Date: 2-28-79  
 Permit No. 1534-6 Permit Fee \$ 23.00

154-01-222

RECEIPT

MUST BE MACHINE VALIDATED

Theresa Kyriakos 10-30-80

CITY OF LAS VEGAS, NEVADA

LOG NO. & AREA

CONST. VAL. \$

309.00

DEPARTMENT OF PUBLIC SERVICES  
DIVISION OF BUILDING & SAFETY

APPLICATION & BUILDING PERMIT - for  
Fence, Wall, Retaining Wall.

ADDRESS OF CONSTRUCTION:

7101 Alamosa

OWNER:

David Sheehan

LOT(S)

14

BLOCK

5

SUBDIVISION

Rainbow Court #1

ZONE

F-1

Materials of Construction:

Block

Concrete

Wire

Wood

Other

Yes No

PLANS:

ARCHITECT:

ENGINEER:

CALCS:

CONTRACTOR:

Owner

STATE LICENSE #

CITY LICENSE #

TOTAL SQUARE FEET:

TOTAL LINEAL FEET:

77

Remarks:

CONDITIONS OF THE PERMIT:

1. Any type of retaining wall must be engineered by a Civil or Structural Engineer.
2. If a home owner takes out the Building Permit and if the owner sublets the work to a Contractor, then the Contractor must take out the permit and pay for it.
3. No fence or wall can be built on City property or rights-of-way, but this is not intended to preclude construction within utility easements if utilities will not be damaged or made inaccessible.
4. The fence or wall shall not enclose any water meter, light standard, or fire alarm box and shall not come closer than 24" from the nearest fire hydrant outlet.
5. Department inspectors must approve footings before concrete is poured and block wall reinforcing before grouting is done.
6. Maximum height of any wall or fence is 6', side and rear yards; 4' maximum in front yard with the vertical surface above the height of 2' - 50% open.
7. I must not obstruct required onsite parking space (2 spaces for each dwelling unit) by the erection of this fence or wall.
8. By the signing of this application I herewith agree to the requirements outlined above.

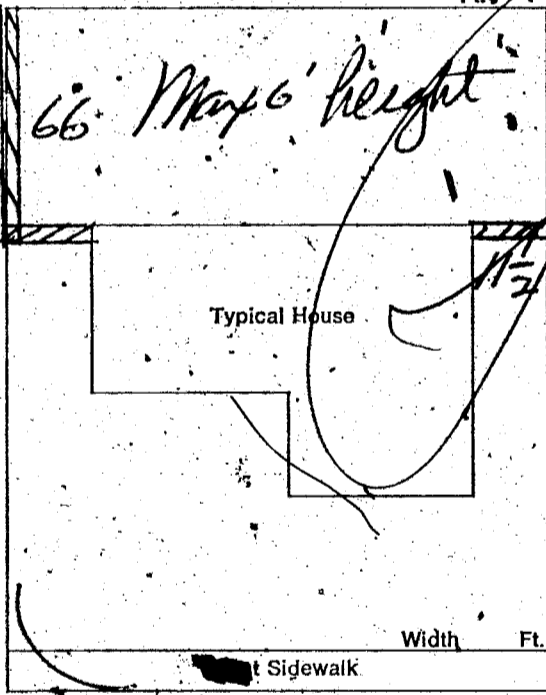

Alamosa

SIGNED:

Barbara A. [Signature]

CONTRACTOR  AGENT

STAMP \$ .00  
 SEAL \$ 7.50  
 DATE: 10/28/80  
 OWNER  \$ 7.50  
 CHECK \$ 7.50

PLANNING DEPT:

J. Brown

Date:

10/28/80

PUBLIC WORKS DEPT:

Date:

10/28/80

BUILDING DIVISION:

Tonie

Date:

10/28/80

PERMIT NO:

6117

PERMIT FEE \$

7.50

RECEIVED  
 CITY - LAS VEGAS  
 BLDG. & SAFETY  
 10/28/80

MUST BE MACHINE VALIDATED

Thomas KIRIAKOS 11-7-80

DIVISION OF BUILDING & SAFETY  
CITY OF LAS VEGAS

OK Permit # 6117 Issued 10/28/80  
Telephone 386-6251  
11/4/80

# PERMIT REQUIRED

Permits Required: No person, firm, or corporation shall erect, construct, enlarge, alter, repair, move, improve, remove, convert, or demolish any building or structure in the City, or cause same to be done, without first obtaining a separate permit.

Where work for which a permit is required by this Code is started or proceeded with prior to obtaining said permit, the fees shall be DOUBLED.

Date 10/27/80

Type of work WOOD FENCE

Address of work 7101 ALAMOSA

Remarks:

RE-INSPECTION ON 10/3/80

Signed: [Signature]  
Inspector

Theresa KYRIAKOS 2-2-81

OWNER U S Homes Corp		ADDRESS 7101 Alamosa Way	
DATE 8-2-78	GEN. CONT. SAME		
TYPE OF STRUCTURE SFD	PERMIT NO. 8441-7	FINAL INSPECTION	
LEGAL DESCRIPTION L 14 B5		LOG # T26-3 AREA #	
APPROVED FOR OCCUPANCY & METER Rainbow West #1			
BUILDING		MECHANICAL	
Investigation	Plumbing Cont. Ron Scarlett		
Location & Footing JK 8-17-78	Permit No. 1-34-6 Date 2-28-79		
Concrete Slab Floor JS 8-20-78	Heat & Vent. A/C Cont. Valley Air		
Fireplace Footing	Permit No. 1056-24 Date 11-30-78		
Chimney Steel	Sewer Cont. U S Home		
Vert. Steel Reinf.	Permit No. 9440 Date		
Horiz. Steel Reinf.	Rough Soil MC 9-13-78		
Roof Sheathing JS 12-2-78	Rough Water		
Framing JS 1-18-79	Top-Out MC 1-15-79		
Ext. Lath	Rough Gas MC 1-15-79		
Ext. Brown	A/C Rough Duct 1-15-79 MC		
Drywall JK 1-12-79	Final Plumbing MC 3-15-79		
Final Building JS 3-15-79	Final Gas MC 3-15-79		
Appr. for Occu. EC 3-15-79	Final Air Cond. MC 3-15-79		
ELECTRICAL		Final Sewer JL 9-26-78	
Temp. Pole Cont.	REMARKS		
Permit No. ✓	Date		
Inspection	Date		
Electrical Cont. Anderson			
Permit No. 10-17	Date 12-12-78		
Rough JS 8-15-79	PLEASE NOTE ADDITIONAL REMARKS ON REVERSE SIDE.		
Final Rough	DIV OF BLDG. & SAFETY CITY OF LAS VEGAS REV. 10-78		
Final Electrical MCL 1-12-80	2-1-81		
Temporary Service	E-Z-WAY SYSTEMS NEWARK OH 43055 LITHO IN U.S.A.		

FENCE & RETAINING WALLS			
OWNER David Shehan			DATE 10/28/78
ADDRESS 7101 Alamosa			
CONTRACTOR Owner		PERMIT NO. 6117	FINAL INSPECTION
LOT 14	BLOCK 5	SUBDIVISION Rainbow Tract #1	
LOG #	AREA		
FENCES (wire, wood, block, & retaining walls)			
Location	Wood		
Footing			
Wall Steel			
1st	2nd		
Bond Beam			
1st	2nd		
Final	FC 11-12-80		
Specify Type Of Fence			
E-Z-WAY SYSTEMS DIV OF BLDG. & SAFETY CITY OF LAS VEGAS REV. 10-78			