

24 Bon Rea Cir

Desert Mobile Homes Park Zone R-T

Glouia Gatewood 9-11-79

CITY OF LAS VEGAS, NEVADA

LOG NO. & AREA: Permit CONST. VAL. \$ 132-

DEPARTMENT OF PUBLIC SERVICES
DIVISION OF BUILDING AND SAFETY

APPLICATION & BUILDING PERMIT - for:
Dwellings, Duplexes, Misc. Residential Const.

ADDRESS OF CONSTRUCTION: 24 Bon Road OWNER: H.S. Gartin

LOT(s) _____ BLOCK _____ SUBDIVISION: Desert White Home Park ZONE: R-T

Existing structure on lot: Dwelling Accessory Bldgs. Vacant Lot Other

PROPOSED CONSTRUCTION: SHED - Set up (Existing) USE: Storage

MATERIALS OF CONSTRUCTION: Wood Frame Concrete Block Reinforced Concrete Steel Frame

SQUARE FEET OF FLOOR AREAS: 1st _____ 2nd _____ 3rd _____ Other _____ TOTAL SQ. FT. 144

FIRE ZONE: _____ Occupancy Group _____ CONST. TYPE: _____

ARCHITECT: _____ ENGINEER: _____ NO. of UNITS _____ NO. of STORIES _____

Plans Submitted: Yes No Calculations Submitted: Yes No Sewer Fee Req'd.: Yes No

CONTRACTOR: owner STATE LICENSE # _____ CITY LICENSE # _____

ADD'L. PERMITS REQ'D.: Air Cond. Elec. Plumbing Signs Paving Fence Public Walks Curb-gutters
Incinerators Fire Sprinkling System

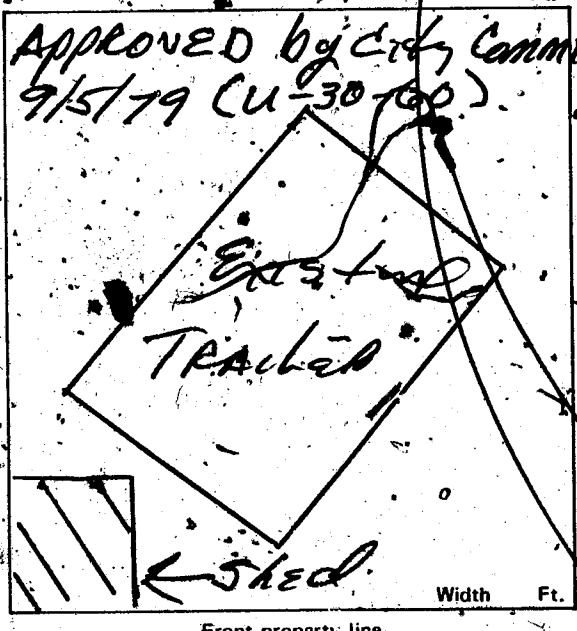

CONDITIONS OF THIS PERMIT:

1. LULA \$.00
2. SET \$ 7.00
3. STL \$ 7.00
4. CHET \$ 2.00
5. AIR COND. \$ 001/01
6. CITY - LAS VEGAS
7. BLDG. & SAFETY
8. 09/06/79

- I agree to call the City Building Department for inspections before concrete is poured, before rough wiring, electrical plumbing, and framing is covered. Also for Air conditioning, drywall and final inspection.
 - I agree that when the job is completed I will request a final inspection before occupancy.
 - I agree to perform all construction in accordance with City Ordinances and Building Codes.
 - The Contractor's signature below denotes authority from the owner to sign in his behalf and that the owner is aware of all requirements of this application and permit. Separate permits must be taken out for work outlined above this agreement.
 - I have read and understand the contents of this application and permit; I hereby state that the information I have supplied on this application is true and correct.
- Approval for the work under this permit will be given only after refuse and debris have been removed from job site and public right of way.

SIGNED: _____ Contractor

BY: H.S. Gartin Agent or Owner

PLANNING DEPT.: [Signature] Date: 9/6/79

PUBLIC WORKS DEPT.: [Signature] Date: 9-6-79

BUILDING DIVISION: M.S. Date: 9/6/79

PERMIT NO.: 6747 PERMIT FEE \$ 7.00

154-01-220

RECEIPT

MUST BE MACHINE VALIDATED

These Remarks 2-4-81.

OWNER <i>H.S. Garvin</i>		ADDRESS <i>24 Bon Rea Cr.</i>	
DATE <i>9-6-79</i>	GEN. CONT. <i>Owner</i>		
TYPE OF STRUCTURE <i>shed set up (existing)</i>	PERMIT NO. <i>6747</i>	FINAL INSPECTION	
LEGAL DESCRIPTION <i>Desert Mobile Home Park</i>	LOG #	AREA #	
APPROVED FOR OCUPANCY & METER,			
BUILDING		MECHANICAL	
Investigation		Plumbing Cont.	
Location & Footing		Permit No.	Date
Concrete Slab Floor		Heat & Vent. A/C Cont.	
Fireplace Footing		Permit No.	Date
Chimney Steel		Sewer Cont.	
Vert. Steel Reinf.		Permit No.	Date
Horiz. Steel Reinf.		Rough Soil	
Framing		Rough Water	
Ext. Lath		Top-Out	
Ext. Brown		Rough Gas	
Drywall		A/C Rough Duct	
Final Building <i>MNV-1780</i>		Final Plumbing	
Appr. for Occu.		Final Gas	
ELECTRICAL		Final Air Cond.	
Temp. Pole Cont.		Final Sewer	
Permit No.	Date	REMARKS	
Inspection	Date		
Electrical Cont.			
Permit No.	Date		
Rough		PLEASE NOTE ADDITIONAL REMARKS ON REVERSE SIDE.	
Final Rough		DIV OF BLDG & SAFETY CITY OF LAS VEGAS REV 10-78	
Final Electrical		79 3-16	
Temporary Service			