

6200 Arlington

Lot 5 Blk 14 Charleston Hgts 41-B

Storia Caly 11-18-80

Debbi Ingram 6-5-85

### CITY OF LAS VEGAS, NEVADA

LOG NO. & AREA \_\_\_\_\_ DATE 5-31-85 CONST. VAL. \$ 750

DEPARTMENT OF BUILDING AND SAFETY **BUILDING PERMIT**  
PHONE 386-6251 FOR: Remodel, Additions, Misc. Residential Const.

ADDRESS OF CONSTRUCTION 6200 Arlington OWNER James Enlow

CONTRACTOR M + J Const STATE LICENSE NO. 22926 CITY LICENSE NO. 27134

LOT(s) 5 BLOCK 14 SUBDIVISION Charlotta HHS ZONE R-1

PROPOSED CONSTRUCTION: Patio Cover USE \_\_\_\_\_  
BUILDING PERMIT NO. 8202 ELECTRIC PERMIT NO. \_\_\_\_\_ PLUMBING PERMIT NO. \_\_\_\_\_ AIR COND. PERMIT NO. \_\_\_\_\_

ADD'L. PERMITS-REQ'D.: Air Cond.  Elec.  Plumbing  Signs  Paving  Fence   
Incinerators  Fire Sprinkling System  Off-Site Permit

MATERIALS OF CONSTRUCTION: Wood Frame  Concrete Block  Reinforced Concrete  Steel Frame   
VIKING ALUM. LERO

SQUARE FEET OF FLOOR AREAS: 1st \_\_\_\_\_ 2nd \_\_\_\_\_ 3rd \_\_\_\_\_ Other \_\_\_\_\_ TOTAL SQ. FT. \_\_\_\_\_

ARCHITECT: \_\_\_\_\_ ENGINEER: \_\_\_\_\_ NO. of UNITS \_\_\_\_\_ NO. of STORIES \_\_\_\_\_

- OTHER INSPECTIONS AND FEES**
- Inspections outside of normal business hours = \$25.00 per hour (minimum charge three hours)
  - Re-inspection fee during normal business hours assessed under provisions of TABLE 3-A of the Uniform Building Code = \$15.00 per hour
  - Inspections during normal business hours for which no fee is specifically indicated = \$15.00 per hour (minimum charge one half hour)
  - Additional plan review required by changes, additions or revisions to approved plans = \$25.00 per hour (minimum charge two hours)

- CONDITIONS OF THE PERMIT:**
- I agree to call the City Building Department for inspections before concrete is poured, before rough wiring, electrical, plumbing, framing is covered. Also for air conditioning, drywall and sheathing inspection.
  - I agree that when the job is completed that I will call for final inspection before occupancy.
  - I agree to perform all construction in accordance with City Ordinances and Building Codes.
  - The Contractor's signature below denotes authority from the owner to sign in his behalf and that the owner is aware of all requirements of this application and permit. Separate permits must be taken out for work outlined above this agreement.
  - I have read and understand the contents of this application and permit. I hereby state that the information I have supplied on this application is true and correct.

Approval for the work under this permit will be given only after refuse and debris have been removed from job site and public right of way.

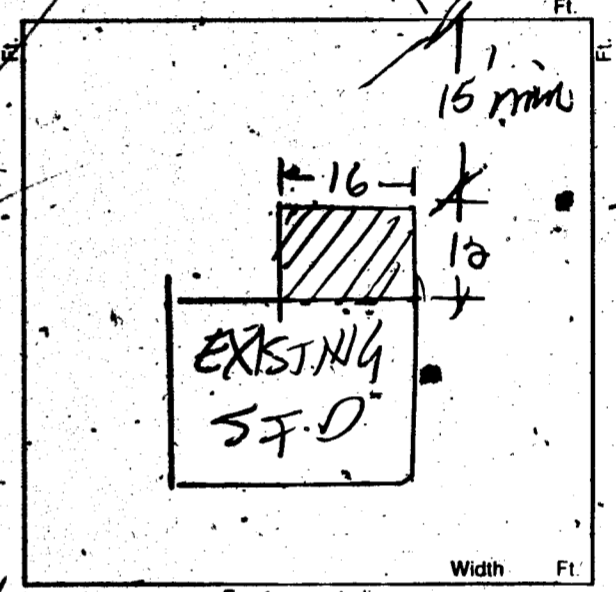

BY: Erud Madigan AGENT/OWNER 5/31/85

PLANNING DEPT. Jan 5-31-85 DATE

PLUMBING	FEE	ELECTRICAL	FEE
WATER DISTRIBUTION		RECEPTACLE SWITCH	
SEWER SYSTEM - NEW OR MODIFICATION		EACH LIGHT FIXTURE OR SOCKET	
FIXTURES - WATER SOFTENER, H.W. HEATER		SPECIAL OUTLET, APPLIANCE ETC.	
GARBAGE DISPOSAL - WASHER, (DISH OR CLOTHES)		ELECTRICAL SERVICE OR PANEL	
FUEL PIPING		A.C. UNIT OR MOTORS	
GAS APPLIANCE OR A.C. UNIT		<u>2310-2402</u> TOTAL	
IRRIGATION SYSTEM		*MISC	
<u>2310-2403</u> TOTAL			
AIR CONDITIONING	.FEE		
NEW UNIT			
HEATERS - WALL, CEILING OR FLOOR			
EVAPORATIVE COOLER			
<u>2310-2405</u> TOTAL			

PLAN REVIEW FEE  
BLDG. PERMIT FEE 13  
TOTAL FEES

RECEIPT  
\*\*0007\*\*  
SFD 13.00  
CHK 13.00  
8202A000 14:10

383 Permit Expires 180 Days After Abandonment of Work

MUST BE MACHINE VALIDATED.

### DEPT. of BLDG. & SAFETY - CITY of LAS VEGAS, NEVADA

OWNER SPROUL HOMES INC ADDRESS 6200 Arlington Ave. DATE 10-2-62  
GEN CONT Same 13071 LEGAL DESCRIPTION Lot 5, Blk 14, Chas Hts 41-B TYPE OF STRUCTURE SFD

BUILDING	MECHANICAL	ELECTRICAL
LOCATION	PLUMBING CONT. <u>10-2-62</u>	TEMP. POLE CONT. _____
FIREPLACE FTG.	PERMIT NO. _____ DATE _____	PERMIT NO. _____ DATE _____
FOOTINGS	HEAT & VENT. AC CONT. _____	INSPECTION _____ DATE _____
FOUNDATION WALL	PERMIT NO. _____ DATE <u>12-6-62</u>	ELECTRICAL CONT. _____
STEM WALL	SEWER CONT. _____	PERMIT NO. <u>230</u> DATE <u>10-2-62</u>
FLOOR FRAMING	PERMIT NO. _____ DATE _____	FIXTURES CONT. _____
SLAB	ROUGH SOIL _____	PERMIT NO. _____ DATE _____
CHIMNEY STEEL (FIREPLACE)	ROUGH WATER _____	SLAB _____
WALL STEEL	TOP-OUT <u>London 11-24-62</u>	ROUGH <u>11-8-62</u>
COLUMN STEEL	ROUGH GAS _____	FINAL ROUGH _____
BEAM STEEL	AC ROUGH DUCT <u>London 11-24-62</u>	FINAL FIXTURE _____
STEEL FABRICATION	REF. ROUGH PIPING _____	TEMPORARY SERVICE _____
FRAMING	FINAL PLUMBING <u>London 1-18-63</u>	
ROOF SHEATHING	FINAL GAS _____	<b>MISCELLANEOUS</b>
DRYWALL	FINAL AIR COND. <u>London 11-8-62</u>	URBAN REDEVELOPMENT APPROVAL _____
LATHING	FINAL REFRIG. _____	GRADING & DRAINAGE _____
BACKING (SIDING)	FINAL SEWER <u>London 11-24-62</u>	ON-SITE PARKING SPACES _____ APP. _____
PLASTER	FINAL SEPTIC TANK _____	ENG APPROVAL OF _____
SCRATCH BROWN		OFF-SITE IMPROVEMENTS _____
FINAL BLDG. _____		DATE _____

APPROVED FOR OCCUPANCY Heppner 11-14-63 INSPECTOR \_\_\_\_\_ DATE \_\_\_\_\_  
APPROVED FOR METER \_\_\_\_\_  
PLEASE NOTE REMARKS ON REVERSE SIDE LOG# \_\_\_\_\_ AREA# \_\_\_\_\_ 23.04

6200 Arlington Ave.

### DEPT. of BLDG. & SAFETY - CITY of LAS VEGAS, NEVADA

OWNER R. A. Mason ADDRESS 6200 Arlington DATE 5/29/63  
GEN CONT Rainbolt Enterprises Inc. TYPE OF STRUCTURE wood fence

BUILDING	MECHANICAL	ELECTRICAL
LOCATION	PLUMBING CONT. _____	TEMP. POLE CONT. _____
FIREPLACE FTG.	PERMIT NO. _____ DATE _____	PERMIT NO. _____ DATE _____
FOOTINGS	HEAT & VENT. AC CONT. _____	INSPECTION _____ DATE _____
FOUNDATION WALL	PERMIT NO. _____ DATE _____	ELECTRICAL CONT. _____
FLOOR FRAMING	SEWER CONT. _____	PERMIT NO. _____ DATE _____
SLAB	PERMIT NO. _____ DATE _____	FIXTURES CONT. _____
CHIMNEY STEEL (FIREPLACE)	ROUGH SOIL _____	PERMIT NO. _____ DATE _____
WALL STEEL	ROUGH WATER _____	SLAB _____
COLUMN STEEL	TOP-OUT _____	ROUGH _____
BEAM STEEL	ROUGH GAS _____	FINAL ROUGH _____
FRAMING	AC ROUGH DUCT _____	FINAL FIXTURE _____
ROOF SHEATHING	REF. ROUGH PIPING _____	FINAL ELECTRICAL _____
DRYWALL	FINAL PLUMBING _____	TEMPORARY SERVICE _____
LATHING	FINAL GAS _____	
BACKING (SIDING)	FINAL AIR COND. _____	<b>MISCELLANEOUS</b>
PLASTER	FINAL REFRIG. _____	GRADING & DRAINAGE _____
SCRATCH BROWN	FINAL SEWER _____	ON-SITE PARKING SPACES _____ APP. _____
URBAN REDEVELOPMENT APPROVAL _____	FINAL SEPTIC TANK _____	ENG APPROVAL OF _____
FINAL BLDG. <u>11</u>		OFF-SITE IMPROVEMENTS _____
DATE <u>6-2-64</u>		DATE _____

APPROVED FOR OCCUPANCY & METER \_\_\_\_\_ INSPECTOR \_\_\_\_\_ DATE \_\_\_\_\_  
PLEASE NOTE REMARKS ON REVERSE SIDE LOG# \_\_\_\_\_ AREA# \_\_\_\_\_ 23.04

6200 Arlington

only 11-18-80

Debbi Ingram 6-5-85

CITY OF LAS VEGAS, NEVADA

LOG NO. & AREA \_\_\_\_\_ DATE 5-31-85 CONST. VAL. \$ 750

DEPARTMENT OF BUILDING AND SAFETY PHONE 386-6251 BUILDING PERMIT FOR: Remodel, Additions, Misc. Residential Const.

ADDRESS OF CONSTRUCTION 6200 Arlington OWNER James Enlow

CONTRACTOR M & J Const. STATE LICENSE NO. 22726 CITY LICENSE NO. 27134

LOT(S) 5 BLOCK 14 SUBDIVISION Charlotta 41B ZONE R-1

PROPOSED CONSTRUCTION: Pat's Cover USE \_\_\_\_\_

ADD'L. PERMITS-REQ'D.: Air Cond.  Elec.  Plumbing  Signs  Paving  Fence  Incinerators  Fire Sprinkling System  Off-Site Permit

MATERIALS OF CONSTRUCTION: Wood Frame  Concrete Block  Reinforced Concrete  Steel Frame  VIKING ACUM. LCR0

SQUARE FEET OF FLOOR AREAS: 1st \_\_\_\_\_ 2nd \_\_\_\_\_ 3rd \_\_\_\_\_ Other \_\_\_\_\_ TOTAL SQ. FT. \_\_\_\_\_

ARCHITECT: \_\_\_\_\_ ENGINEER: \_\_\_\_\_ NO. of UNITS \_\_\_\_\_ NO. of STORIES \_\_\_\_\_

- OTHER INSPECTIONS AND FEES**
- Inspections outside of normal business hours = \$25.00 per hour (minimum charge three hours).
  - Re-inspection fee during normal business hours assessed under provisions of TABLE 3-A of the Uniform Building Code = \$15.00 per hour.
  - Inspections during normal business hours for which no fee is specifically indicated = \$15.00 per hour (minimum charge one half hour).
  - Additional plan review required by changes, additions or revisions to approved plans = \$25.00 per hour (minimum charge two hours).

- CONDITIONS OF THE PERMIT:**
- I agree to call the City Building Department for inspections before concrete is poured, before rough wiring, electrical, plumbing, framing is covered. Also for air conditioning, drywall and sheathing inspection.
  - I agree that when the job is completed that I will call for final inspection before occupancy.
  - I agree to perform all construction in accordance with City Ordinances and Building Codes.
  - The Contractor's signature below denotes authority from the owner to sign in his behalf and that the owner is aware of all requirements of this application and permit. Separate permits must be taken out for work outlined above this agreement.
  - I have read and understand the contents of this application and permit. I hereby state that the information I have supplied on this application is true and correct.

Approval for the work under this permit will be given only after refuse and debris have been removed from job site and public right of way.

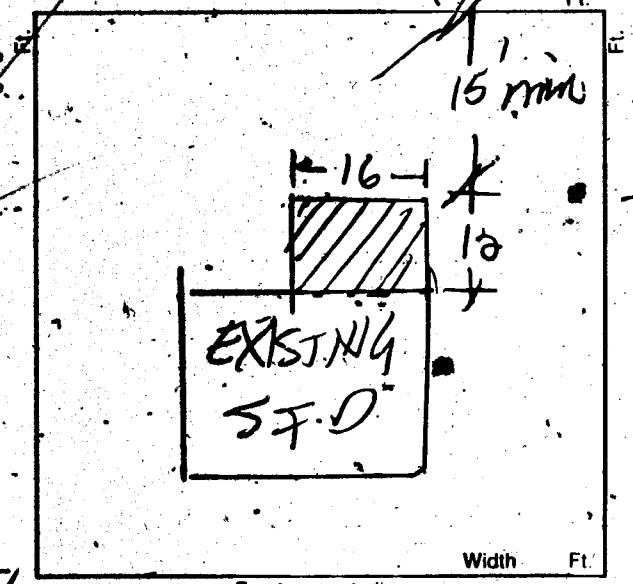

BY: [Signature] AGENT/TOWNER DATE 5/31/85

PLANNING DEPT. [Signature] BUILDING DEPT. [Signature] DATE 5-31-85

PLUMBING	FEE	ELECTRICAL	FEE
WATER DISTRIBUTION		RECEPTACLE SWITCH	85/21/85
SEWER SYSTEM - NEW OR MODIFICATION		EACH LIGHT FIXTURE OR SOCKET	
FIXTURES - WATER SOFTENER, H.W. HEATER		SPECIAL OUTLET, APPLIANCE ETC.	
GARBAGE DISPOSAL - WASHER. (DISH OR CLOTHES)		ELECTRICAL SERVICE OR PANEL	
FUEL PIPING		A.C. UNIT OR MOTORS	
GAS APPLIANCE OR A.C. UNIT		2310-2402 TOTAL	
IRRIGATION SYSTEM		MISC.	
2310-2403 TOTAL			
AIR CONDITIONING	.FEE		
NEW UNIT			
HEATERS - WALL, CEILING OR FLOOR			
EVAPORATIVE COOLER			
2310-2405 TOTAL			

PLAN REVIEW FEE BLDG. PERMIT FEE 13 TOTAL FEES

RECEIPT #0007\*\* SFD 13.00 CHEK 13.00 8202A000 14:10

383 Permit Expires 180 Days After Abandonment of Work MUST BE MACHINE VALIDATED

DEPT. of BLDG. & SAFETY - CITY of LAS VEGAS, NEVADA  
SPROUT HOMES INC ADDRESS 6200 Arlington Ave. DATE 10-2-62  
Same 13071 LEGAL DESCRIPTION Lot 5, Bk 14, Chas Hts 41-B TYPE OF STRUCTURE SFD

BUILDING	MECHANICAL	ELECTRICAL
PLUMBING CONT. [Signature] DATE [Signature]	TEMP. POLE CONT. _____	PERMIT NO. _____ DATE _____
PERMIT NO. [Signature] DATE [Signature]	INSPECTION _____	INSPECTION _____ DATE _____
HEAT & VENT. AC CONT. [Signature] DATE [Signature]	ELECTRICAL CONT. [Signature]	PERMIT NO. [Signature] DATE [Signature]
SEWER CONT. [Signature] DATE [Signature]	FIXTURES CONT. [Signature]	PERMIT NO. _____ DATE _____
ROUGH SOIL [Signature] DATE [Signature]	SLAB [Signature]	ROUGH _____
ROUGH WATER [Signature] DATE [Signature]	ROUGH _____	FINAL ROUGH _____
ROUGH GAS [Signature] DATE [Signature]	FINAL ROUGH _____	FINAL FIXTURE _____
AC ROUGH DUCT [Signature] DATE [Signature]	FINAL FIXTURE _____	TEMPORARY SERVICE _____
REF. ROUGH PIPING [Signature] DATE [Signature]	MISCELLANEOUS _____	URBAN REDEVELOPMENT APPROVAL _____
FINAL PLUMBING [Signature] DATE [Signature]	GRADING & DRAINAGE _____	ON-SITE PARKING SPACES _____ APP. _____
FINAL GAS [Signature] DATE [Signature]	ENG APPROVAL OF _____	OFF-SITE IMPROVEMENTS _____
FINAL AIR COND. [Signature] DATE [Signature]	INSPECTOR _____	DATE _____
FINAL REFRIG. [Signature] DATE [Signature]	APPROVED FOR OCCUPANCY [Signature] DATE [Signature]	LOG# _____ AREA# _____ 23.04
FINAL SEWER [Signature] DATE [Signature]	APPROVED FOR METER _____	NOTE REMARKS ON REVERSE SIDE
FINAL SEPTIC TANK [Signature] DATE [Signature]		

6200 Arlington Ave.

DEPT. of BLDG. & SAFETY - CITY of LAS VEGAS, NEVADA  
R. A. Mason ADDRESS 6200 Arlington DATE 5/29/63  
Rainbolt Enterprises Inc. LEGAL DESCRIPTION 20263 TYPE OF STRUCTURE wood fence

BUILDING	MECHANICAL	ELECTRICAL
PLUMBING CONT. _____	TEMP. POLE CONT. _____	PERMIT NO. _____ DATE _____
PERMIT NO. _____ DATE _____	INSPECTION _____	INSPECTION _____ DATE _____
HEAT & VENT. AC CONT. _____	ELECTRICAL CONT. _____	PERMIT NO. _____ DATE _____
SEWER CONT. _____	FIXTURES CONT. _____	PERMIT NO. _____ DATE _____
ROUGH SOIL _____	SLAB _____	ROUGH _____
ROUGH WATER _____	ROUGH _____	FINAL ROUGH _____
ROUGH GAS _____	FINAL ROUGH _____	FINAL FIXTURE _____
AC ROUGH DUCT _____	FINAL FIXTURE _____	TEMPORARY SERVICE _____
REF. ROUGH PIPING _____	MISCELLANEOUS _____	URBAN REDEVELOPMENT APPROVAL _____
FINAL PLUMBING _____	GRADING & DRAINAGE _____	ON-SITE PARKING SPACES _____ APP. _____
FINAL GAS _____	ENG APPROVAL OF _____	OFF-SITE IMPROVEMENTS _____
FINAL AIR COND. _____	INSPECTOR _____	DATE _____
FINAL REFRIG. _____	APPROVED FOR OCCUPANCY & METER _____	LOG# _____ AREA# _____ 23.04
FINAL SEWER _____	APPROVED FOR METER _____	NOTE REMARKS ON REVERSE SIDE
FINAL SEPTIC TANK _____		

6200 Arlington

Debra Ingram 6-26-85

OWNER James Enlow		ADDRESS 6200 Arlington	
DATE 6-4-85		GEN. CONT. M & J Const.	
BUILD. TYPE patio cover		PERMIT No. 8202	
LEGAL SEE APPLICATION		LOG No.	
<b>BUILDING</b>		<b>MECHANICAL</b>	
Pt. Loc. & Ft. <input type="checkbox"/>		Plumbing Cont.	
Location & Footing <input type="checkbox"/>		Permit No.	Date
Stemwall <input type="checkbox"/>		A/C Cont.	
Concrete Slab Floor <input type="checkbox"/>		Permit No.	Date
Chimney Steel <input type="checkbox"/>		Sewer Fee	
Fireplace Footing <input type="checkbox"/>		Irrig. Cont.	
Vert. Steel Reinf. <input type="checkbox"/>		Permit No.	Date
Horiz. Steel Reinf. <input type="checkbox"/>		Hood Cont.	
Roof Sheathing		Permit No.	Date
Insulation		Rough Soil <input type="checkbox"/>	
Framing		Rough Water <input type="checkbox"/>	
Ext. Lath		Top-Out	
Ext. Scratch		Rough Gas	
Ext. Brown		A/C Rough Duct.	
Drywall		Final Plumbing	
Final Building <i>6-6-85</i>		Final Gas	
Appr. for Occu. Final Building		Final Air Cond.	
		Final Sewer	
		Rough Hold <input type="checkbox"/>	
<b>ELECTRICAL</b>		Final Hood <input type="checkbox"/>	
Electrical Cont.		Final Irrig.	
Permit No.	Date		
PT Rough			
Ground Electrode		<b>ELECTRICAL</b>	
Temporary Power		Temp. Pole Cont.	
Meter Tag		Permit No.	Date
Final Electrical		Inspection	Date