

: 2913 Austin Ave

LOT 53 BLK 4 TIWN LAKES VILLAGE #7 ZONE R-1

*S. Seibert 1-78-19*

CITY OF LAS VEGAS, NEVADA

LOG NO. & AREA \_\_\_\_\_

DEPARTMENT OF BUILDING & SAFETY

CONST. VAL. ~~\_\_\_\_\_~~

APPLICATION & BUILDING PERMIT - for: *3600*  
Fence, Wall, Retaining Wall.

ADDRESS OF CONSTRUCTION: *2913 Austin*

OWNER: *MR Goodwin*

LOT(s) *53*

BLOCK *4*

SUBDIVISION *Tumble Valley #7*

ZONE *R-1*

Materials of Construction:

Block

Concrete

Wire

Wood

Other

Yes

No

ARCHITECT: \_\_\_\_\_

ENGINEER: \_\_\_\_\_

PLANS:

CALCS:

CONTRACTOR: *Stansberry Const Co.*

STATE LICENSE # *10519*

CITY LICENSE # *18007*

Remarks:

Remarks section with three horizontal lines for notes.

TOTAL SQUARE FEET: \_\_\_\_\_

TOTAL LINEAL FEET: *18*

CONDITIONS OF THE PERMIT:

1. Any type of retaining wall must be engineered by a Civil or Structural Engineer.
2. If a home owner takes out the Building Permit and if the owner sublets the work to a Contractor, then the Contractor must take out the permit and pay for it.
3. No fence or wall can be built on City property or rights-of-way, but this is not intended to preclude construction within utility easements if utilities will not be damaged or made inaccessible.
4. The fence or wall shall not enclose any water meter, light standard, or fire alarm box and shall not come closer than 24" from the nearest fire hydrant outlet.
5. Department inspectors must approve footings before concrete is poured and block wall reinforcing before grouting is done.
6. Maximum height of any wall or fence is 6' side and rear yards; 4' maximum in front yard with the vertical surface above the height of 2' - 50% open.
7. I must not obstruct required onsite parking space (1 space for each dwelling unit) by the erection of this fence or wall.
8. By the signing of this application I herewith agree to the requirements outlined above.

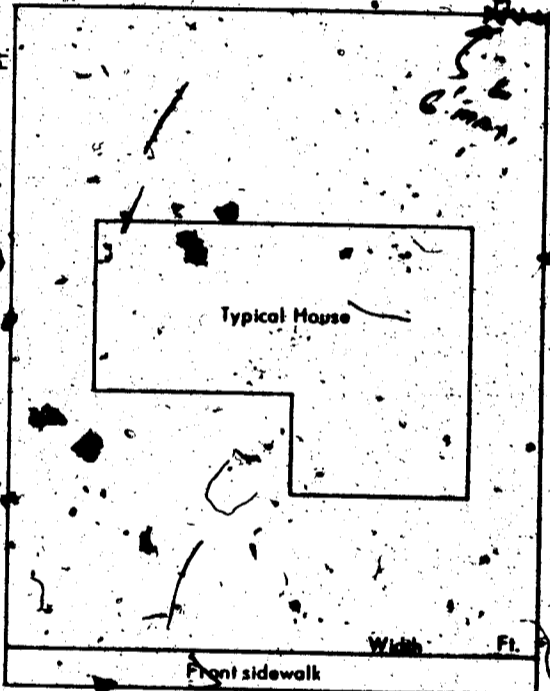

SIGNED: *Red Raul*

DATE: *11-23-71*

CONTRACTOR

AGENT

OWNER

PLANNING DEPT. \_\_\_\_\_

Date: *11/23/71*

PUBLIC WORKS DEPT. \_\_\_\_\_

Date: \_\_\_\_\_

BUILDING DEPT. \_\_\_\_\_

Date: *11-24-71*

#12850

PERMIT NO. *1644*

PERMIT FEE \$ *5.00*

RECEIPT

*7311*

\$ *005.00*

*-18*

CITY OF LAS VEGAS

DEPT. OF BUILDING & SAFETY

MUST BE MACHINE VALIDATED

23 NOV 71

Maria Caly: 12-1-80

DEPARTMENT OF BUILDING & SAFETY  
CITY OF LAS VEGAS, NEVADA

KARDEX CARD  
FENCE & RETAINING  
WALLS

OWNER Goodwin ADDRESS 2913 Austin DATE 11/24/71  
 CONTRACTOR STANSBERRY CONST PERMIT NO. 1644  
 LOT 53 BLOCK 4 SUBDIVISION Twin Lakes Village #7

Fence (wire, wood, etc.)		Walls (masonry, rock, etc.)	
Location _____		Location _____	
Final Inspection <u>H.B. 2-3-72</u>		Footings _____	
		Wall Steel 1st _____ 2d _____ 3d _____	
		Final Inspection _____	
Retaining Wall (masonry)		Retaining Wall (concrete)	
Location _____		Location _____	
Footings _____		Footings _____	
Wall Steel 1st _____ 2d _____ 3d _____		Wall Steel 1st _____ 2d _____ 3d _____	
Bond Beam 1st _____ 2d _____ 3d _____		Final Inspection _____	
Final Inspection _____			

23.14 B ADDRESS 2913 Austin LOG NO. \_\_\_\_\_ AREA \_\_\_\_\_

DEPT. of BLDG & SAFETY—CITY of LAS VEGAS, NEVADA

OWNER R. L. HAÜPT ADDRESS 2913 Austin DATE 10-3-62  
 GEN CONT OWNER TYPE OF STRUCTURE wood fence  
 PERMIT NO 12976 LEGAL DESCRIPTION \_\_\_\_\_

BUILDING		MECHANICAL	ELECTRICAL
LOCATION _____		PLUMBING CONT. _____	TEMP POLE CONT. _____
FIREPLACE FTG. _____		PERMIT NO. _____ DATE _____	PERMIT NO. _____ DATE _____
FOOTINGS _____		HEAT & VENT. AC CONT. _____	INSPECTION _____ DATE _____
FOUNDATION WALL _____		PERMIT NO. _____ DATE _____	ELECTRICAL CONT. _____
STEM WALL _____		SEWER CONT. _____	PERMIT NO. _____ DATE _____
FLOOR FRAMING _____		PERMIT NO. _____ DATE _____	FIXTURES CONT. _____
SLAB _____		ROUGH SOIL _____	PERMIT NO. _____ DATE _____
CHIMNEY STEEL (FIREPLACE) _____		ROUGH WATER _____	SLAB _____
WALL STEEL _____		TOP-OUT _____	ROUGH _____
COLUMN STEEL _____		ROUGH GAS _____	FINAL ROUGH _____
BEAM STEEL _____		AC ROUGH DUCT _____	FINAL FIXTURE _____
STEEL FABRICATION _____		REF ROUGH PIPING _____	TEMPORARY SERVICE _____
FRAMING _____		FINAL PLUMBING _____	
ROOF SHEATHING _____		FINAL GAS _____	MISCELLANEOUS
INTERIOR _____	EXTERIOR _____	FINAL AIR COND. _____	URBAN REDEVELOPMENT APPROVAL _____
DRYWALL _____		FINAL REFRIG. _____	<input type="checkbox"/>
LATHING _____		FINAL SEWER _____	
BACKING SIDING _____		FINAL SEPTIC TANK _____	
PLASTER SCRATCH _____			GRADING & DRAINAGE _____
PLASTER FINISH _____			ON-SITE PARKING SPACES _____ APP. _____
DATE _____			ENG APPROVAL OF _____
			OFF-SITE IMPROVEMENTS _____

APPROVED FOR OCCUPANCY \_\_\_\_\_ INSPECTOR \_\_\_\_\_ DATE \_\_\_\_\_  
 APPROVED FOR METER 12-1-80 \_\_\_\_\_  
 PLEASE NOTE REMARKS ON REVERSE SIDE LOG # \_\_\_\_\_ AREA # \_\_\_\_\_ 23.04

2913 Austin

Alma Ealy 12-1-80

DEPT. of BLDG. & SAFETY - CITY of LAS VEGAS, NEVADA  
OWNER, ANCHORAGE DEV. CO. ADDRESS 2913 Austin Ave. DATE 4/17/61  
GEN. CONT. VIKING CONSTR. CO. TYPE OF STRUCTURE S. F. DWELLING  
PERMIT NO. 4103 LEGAL DESCRIPTION Lot 53, Bl. 4, Twin Lakes V. #7

LOCATION	FIREPLACE FTG. 1	PLUMBING CONT. <u>W.C. Bly</u>	TEMP. POLE CONT.
FOOTINGS	PILES	PERMIT NO. <u>2592</u> DATE <u>05-3-61</u>	PERMIT NO. _____ DATE _____
FOUND.	PIERS	HEAT. & VENT. CONT. <u>W.C. Bly</u>	INSPECTION _____ DATE _____
FLOOR	SLAB	PERMIT NO. <u>467</u> DATE <u>3-16-61</u>	ELECTRICAL CONT. <u>W.C. Bly</u>
ANCHOR BOLTS	BASE PLATES	SEWER CONT. <u>W.C. Bly</u>	PERMIT NO. <u>2827</u> DATE <u>6-18-61</u>
WALL STEEL		PERMIT NO. <u>2892</u> DATE <u>5-3-61</u>	OUTLETS <u>54</u>
COLUMN STEEL		ROUGH SOIL <u>Anderson 5-5-61</u>	MOTORS _____ H.P. _____
BEAM STEEL		ROUGH WATER <u>Anderson 5-2-61</u>	SLAB _____
FRAMING		TOP-OUT _____	ROUGH _____
ROOF SHEATHING		ROUGH GAS _____	FINAL ROUGH _____
STEEL FABRICATION		AC ROUGH DUCT <u>W.C. Bly</u>	FIXTURES CONT. <u>W.C. Bly</u>
STEEL CONNECTION		REF. ROUGH PIPING _____	PERMIT NO. <u>2827</u> DATE <u>6-18-61</u>
	INTERIOR	SEWER <u>Rummen 12-13-61</u>	FIXTURES <u>14</u>
LATHING	EXTERIOR	SEPIC TANK _____	FINAL FIXTURE <u>W.C. Bly 11-22-61</u>
BACKING		FINAL PLUMBING <u>Battery 3-14-61</u>	URBAN REDEVELOPMENT APPROVAL _____
PLASTER	SCRATCH	FINAL GAS _____	
FINAL BLDG.	BROWN	FINAL HEATING _____	
GRADING & DRAINAGE		FINAL AIR COND <u>W.C. Bly 10-2-61</u>	
ON-SITE PARKING	SPACES	FINAL REFRIG. _____	
ENG APPROVAL OF _____			
OFF-SITE IMPROVEMENTS _____			

APPROVED FOR OCCUPANCY W.C. Bly 4-17-61  
APPROVED FOR MEIER W.C. Bly 11-24-61

PLEASE NOTE REMARKS ON REVERSE SIDE 2913 Austin Ave. LOG# T-13 AREA# 3 25-04