

3113 BRADY DR.

LOT 23 BLK 3 COLLEGE PARK #23 ZONE R-1

D. Gatewood 1-29-79

CITY OF LAS VEGAS, NEVADA

1967 187.00

LOG NO. & AREA \_\_\_\_\_

CONST. VAL. \$ ~~185.00~~

DEPARTMENT OF BUILDING & SAFETY

APPLICATION & BUILDING PERMIT — for:  
Fence, Wall, Retaining Wall.

ADDRESS OF CONSTRUCTION: 3113 E. BRADY

OWNER: JAMES C. TAYLOR

LOT(s) 23 BLOCK 3 SUBDIVISION College Park # 23 ZONE: R-1

Materials of Construction: Block  Concrete  Wire  Wood  Other  Yes No

ARCHITECT: \_\_\_\_\_ ENGINEER: \_\_\_\_\_ PLANS:    
CALCS:

CONTRACTOR: \_\_\_\_\_ STATE LICENSE # \_\_\_\_\_ CITY LICENSE # \_\_\_\_\_

TOTAL SQUARE FEET: \_\_\_\_\_ TOTAL LINEAL FEET: 107

Remarks:  
\_\_\_\_\_  
\_\_\_\_\_  
\_\_\_\_\_

CONDITIONS OF THE PERMIT:

1. Any type of retaining wall must be engineered by a Civil or Structural Engineer.
2. If a home owner takes out the Building Permit and if the owner sublets the work to a Contractor, then the Contractor must take out the permit and pay for it.
3. No fence or wall can be built on City property or rights-of-way, but this is not intended to preclude construction within utility easements if utilities will not be damaged or made inaccessible.
4. The fence or wall shall not enclose any water meter, light standard, or fire alarm box and shall not come closer than 24" from the nearest fire hydrant outlet.
5. Department Inspectors must approve footings before concrete is poured and block wall reinforcing before grouting is done.
6. Maximum height of any wall or fence is 6', side and rear yards; 4' maximum in front yard with the vertical surface above the height of 2' — 50% open and further that fencing within 25' of the intersection of curb faces on corner and through lots is limited to a maximum height of 30".
7. I must not obstruct required onsite parking space (1 space for each dwelling unit) by the erection of this fence or wall.
8. By the signing of this application I herewith agree to the requirements outlined above.

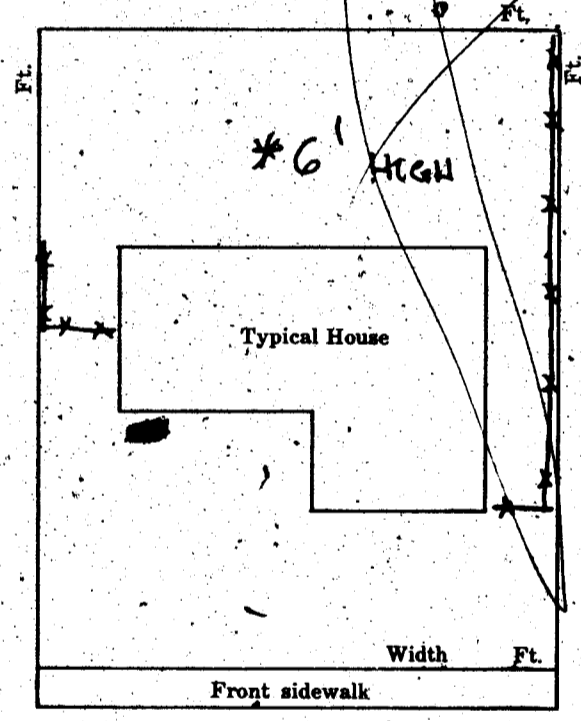

SIGNED: James C. Taylor DATE: 5-1-67  
CONTRACTOR  AGENT  OWNER

PLANNING DEPT: [Signature] Date: 5/1/67  
 ENGINEERING DEPT: \_\_\_\_\_ Date: \_\_\_\_\_  
 BUILDING DEPT: [Signature] Date: 5-1-67  
 #1285 PERMIT NO: 37138 PERMIT FEE \$ 40.00

RECEIPT  
 2877 \$004.00 - 8  
 CITY OF LAS VEGAS  
 DEPT. OF BUILDING & SAFETY  
 MUST BE MACHINE VALIDATED  
 - 1 MAY 67.

*Angela S. Jackson 2/20/80*

F

DEPT. of BLDG & SAFETY - CITY of LAS VEGAS, NEVADA  
 OWNER Norsac Building Co. ADDRESS 3113 Brady Dr. DATE 4/4/63  
 GEN. CONT. owner TYPE OF STRUCTURE SFD  
 PERMIT NO. 16910 LEGAL DESCRIPTION lot 23, block 3, College Park #23

BUILDING	MECHANICAL	ELECTRICAL
LOCATION _____	PLUMBING CONT. <u>W. Willard</u>	TEMP. POLE CONT. _____
FIREPLACE FTS. _____	PERMIT NO. <u>11230</u> DATE <u>4-11-63</u>	PERMIT NO. _____ DATE _____
FOOTINGS <u>2nd 4-19-63</u>	HEAT & VENT. AC CONT. <u>Gardner</u>	INSPECTION _____ DATE _____
FOUNDATION WALL <u>2nd 4-19-63</u>	PERMIT NO. <u>7813</u> DATE <u>4-1-63</u>	ELECTRICAL CONT. <u>M. ...</u>
FLOOR FRAMING _____	SEWER CONT. <u>Willard</u>	PERMIT NO. <u>12693</u> DATE <u>5-2-63</u>
SLAB <u>1st 4-29-63</u>	PERMIT NO. <u>11230</u> DATE <u>4-11-63</u>	FIXTURES CONT. <u>...</u>
CHIMNEY STEEL (FIREPLACE) _____	ROUGH SOIL <u>4-18-63</u>	PERMIT NO. <u>12693</u> DATE _____
WALL STEEL _____	ROUGH WATER <u>4-18-63</u>	SLAB _____
COLUMN STEEL _____	TOP-OUT <u>3-15 3-16-63</u>	ROUGH <u>...</u> 5-22-63
BEAM STEEL _____	ROUGH GAS <u>3-15 3-16-63</u>	FINAL ROUGH _____
FRAMING <u>CC 5-31-63</u>	AC ROUGH DUCT <u>BB 3-16-63</u>	FINAL FIXTURE _____
ROOF SHEATHING <u>CC 5-31-63</u>	REP. ROUGH PIPING _____	FINAL ELECTRICAL _____
DRYWALL <u>CC 6-20-63</u>	FINAL PLUMBING <u>BB 4-23-63</u>	TEMPORARY SERVICE <u>...</u> 7-24-63
LATHING _____	FINAL GAS <u>BB 4-23-63</u>	MISCELLANEOUS _____
BACKING (SIGNS) _____	FINAL AIR COND. <u>BB 4-23-63</u>	GRADING & DRAINAGE _____
PLASTER SCRATCH _____	FINAL REFRIG. _____	ON-SITE PARKING SPACES _____ APP. _____
PLASTER BROWN _____	FINAL SEWER <u>BB 5-14-63</u>	ENG. APPROVAL OF _____
URBAN REDEVELOPMENT APPROVAL _____	FINAL SEPTIC TANK _____	OFF-SITE IMPROVEMENTS _____
FINAL BLDG <u>...</u> DATE <u>8-26-63</u>		

APPROVED FOR OCCUPANCY & METER \_\_\_\_\_  
 PLEASE NOTE REMARKS ON REVERSE SIDE  
 INSPECTOR ... DATE \_\_\_\_\_  
 3113 Brady Dr. LOG # \_\_\_\_\_ AREA # \_\_\_\_\_ 23.04  
 UT-11 2

DEPARTMENT OF BUILDING & SAFETY  
 CITY OF LAS VEGAS, NEVADA

KARDEX CARD  
 FENCE & RETAINING  
 WALLS

OWNER James C. Taylor ADDRESS 3113 E. Brady DATE 5/7/67  
 CONTRACTOR ... PERMIT NO. 37158  
 LOT 23 BLOCK 3 SUBDIVISION College Park #23  
Wood Fence

Fence (wire, wood, etc.)	Walls (masonry, rock, etc.)
Location <u>D.B. 5-1-67</u>	Location _____
Final Inspection <u>D.B. 5-2-67</u>	Footings _____
	Wall Steel 1st _____ 2d _____ 3d _____
	Final Inspection _____
Retaining Wall (masonry)	Retaining Wall (concrete)
Location _____	Location _____
Footings _____	Footings _____
Wall Steel 1st _____ 2d _____ 3d _____	Wall Steel 1st _____ 2d _____ 3d _____
Bond Beam 1st _____ 2d _____ 3d _____	Final Inspection _____
Final Inspection _____	

23.14 B ADDRESS \_\_\_\_\_ AREA \_\_\_\_\_