

317 Agora Court

LOT 3 BLK 9 METROPOLITAN PARK # 19 ZONED R-1

CITY OF LAS VEGAS, NEVADA

LOG NO. & AREA T-3-2

CONST. VAL. \$ 18,930

DEPARTMENT OF PUBLIC SERVICES
DIVISION OF BUILDING AND SAFETY

APPLICATION & BUILDING PERMIT - for:
Dwellings, Duplexes, Misc. Residential Const.

ADDRESS OF CONSTRUCTION:

317. Agora Way

OWNER: METROPOLITAN-NEVADA CORPORATION

LOT(s) 3 BLOCK 9 SUBDIVISION METROPOLITAN PARK #19 ZONE: R-1

Existing structure on lot: Dwelling Accessory Bldgs. Vacant Lot Other

PROPOSED CONSTRUCTION: Single Family Dwelling USE: Residence

MATERIALS OF CONSTRUCTION: Wood Frame Concrete Block Reinforced Concrete Steel Frame

SQUARE FEET OF FLOOR AREAS: 1st 802 2nd 3rd Other 289 TOTAL SQ. FT. 1091

FIRE ZONE: 3 Occupancy Group R-1 & M-1 CONST. TYPE: 5-N

ARCHITECT: ENGINEER: David Weiss NO. of UNITS 1 NO. of STORIES 1

Plans Submitted: Yes No Calculations Submitted: Yes No Sewer Fee Req'd: Yes No

CONTRACTOR: METROPOLITAN-NEVADA STATE LICENSE # 11199 CITY LICENSE # 16382

ADD'L. PERMITS REQ'D.: Air Cond. Elec. Plumbing Signs Paving Fence Public Walks Curb-gutters
Incinerators Fire Sprinkling System

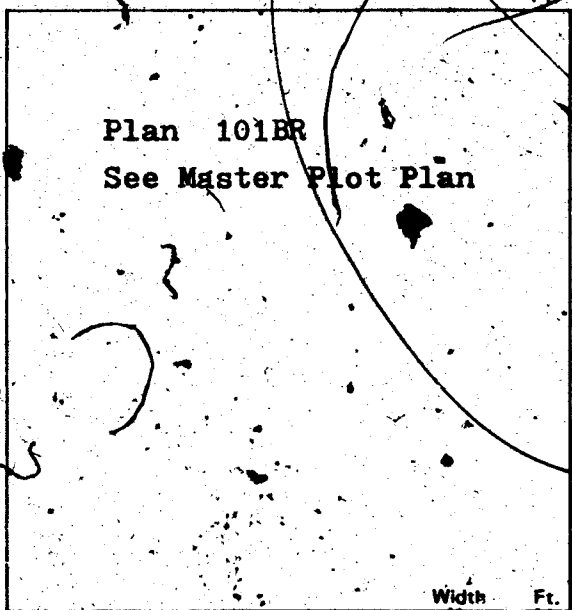

CONDITIONS OF THE PERMIT:

1. I agree to call the City Building Department for inspections before concrete is poured, before rough wiring, electrical, plumbing, framing is covered. Also for Air conditioning, drywall and sheathing inspection.
2. I agree that when the job is completed that I will call for final inspection before occupancy.
3. I agree to perform all construction in accordance with City Ordinances and Building Codes.
4. The Contractor's signature below denotes authority from the owner to sign in his behalf and that the owner is aware of all requirements of this application and permit. Separate permits must be taken out for work outlined above this agreement.
5. I have read and understand the contents of this application and permit; I hereby state that the information I have supplied on this application is true and correct.

Approval for the work under this permit will be given only after refuse and debris have been removed from job site and public right of way.

SIGNED: METROPOLITAN-NEVADA CORPORATION Contractor

BY: Agent or Owner

Wesley Lester, Vice President

PLANNING DEPT.: Date: 8-21-78

PUBLIC WORKS DEPT.: Date: 8-9-78

BUILDING DIVISION: Date: 8-6-78

PERMIT NO.: 9228-3 PERMIT FEE \$ 88.00

154-01-220

RECEIPT

MUST BE MACHINE VALIDATED

CITY OF LAS VEGAS, NEVADA

DEPARTMENT OF PUBLIC SERVICES - AIR CONDITIONING APPLICATION & PERMIT DIVISION OF BUILDING AND SAFETY

ADDRESS OF CONSTRUCTION: 317 Agora Way OWNER'S NAME: Metropolitan Nevada Corporation

CIRCLE: Addition; Remodel; New Bldg; TYPE OF BLDG. (SFD) APT. COMM. PUBLIC

CONTRACTOR'S NAME: Central Air Conditioning STATE LICENSE # 11997 CITY LICENSE # 00057

UNITS	DESCRIPTION	FEE	TOTAL	UNITS	DESCRIPTION	FEE	TOTAL
	Unit heater - floor, wall or suspended	4.00			EVAPORATIVE COOLERS:		
	FOR EACH FORCED-AIR OR GRAVITY-TYPE FURNACE OR BURNER INCLUDING DUCTS AND VENT ATTACHED TO SUCH APPLIANCES:				5 outlets or under	3.00	
	Up to and including 100,000 B.t.u.'s	4.00			Over 5 and up to and including 10	5.00	
	Over 100,000 B.t.u.'s	6.00			Each additional outlet over 10	.25	
	FOR EACH HEATING APPLICATION, REFRIGERATION UNIT, SPLIT COOLING AND HEATING UNIT, ABSORPTION UNIT, COMPRESSOR OR BOILER:				VENTILATION:		
1-3	Up to and including 3 ton or horsepower, or absorption system up to and including 100,000 B.t.u.'s	4.00	4.00		For each fan connected to a single duct	1.00	
	Over 3 ton or 3 horsepower up to and including 10, or absorption system over 100,000 B.t.u.'s up to and including 250,000 B.t.u.'s	7.00			For each commercial or industrial ventilation system	5.00	
	Over 10 ton or 10 horsepower up to and including 30, or absorption system over 250,000 B.t.u.'s up to and including 1,000,000 B.t.u.'s	12.00			For each commercial kitchen hood	5.00	
	Over 30 ton or 30 horsepower up to and including 50, or absorption system over 1,000,000 B.t.u.'s up to and including 1,700,000 B.t.u.'s	20.00			MISCELLANEOUS:		
	Over 50 ton or 50 horsepower, or absorption system over 1,700,000 B.t.u.'s	30.00			For each water cooling tower	8.00	
	FOR EACH AIR HANDLING UNIT INCLUDING DUCTS ATTACHED THERETO:				Duct work only, each opening	.25	
	Up to and including 10,000 CFM	2.00			For installation or relocation of each commercial or industrial incinerator	15.00	
	Over 10,000 CFM	4.00			Gas piping related to the air cond. work in single family dwelling only	3.00	
					For each appliance, piece of equipment, any mechanical work or alteration or replacement not included in this schedule, the permit fee shall be computed the same as building permit fees by using the cost of installation for the valuation amount.		
					FOR THE ISSUANCE OF EACH PERMIT		3.00
					TOTAL PERMIT FEE \$		7.00

I hereby certify that I have carefully examined and read the above application; that the same is true and correct; and that the work herein described is to be done in accordance with all the provisions of the applicable Ordinances of the City of Las Vegas, Nevada and the State Laws, whether herein specified or not.

Approval for the work under this permit will be given only after refuse and debris have been removed from job site and public right of way.

SIGNED A. McDonald Date 12/31/78
Air Conditioning Contractor - Owner

BUILDING DIVISION M.S. Date 1/3/79

PERMIT NO. 10649-41 PERMIT FEE \$ 7.00

RECEIPT

PAID BY MACHINE VALIDATED

Sharon Perena April 17, 1979

Water Graphics Corporation

PRESS HARD -- YOU ARE MAKING 5 COPIES

CITY OF LAS VEGAS, NEVADA

LOG NO. & AREA H-227
DEPARTMENT OF PUBLIC SERVICES
DIVISION OF BUILDING & SAFETY

CONST. VAL. \$ 22,815.00

APPLICATION & BUILDING PERMIT - for:
Fence, Wall, Retaining Wall.

ADDRESS OF CONSTRUCTION: 317 AGORA WY

OWNER: THE PARK

LOT(S) _____ BLOCK _____ SUBDIVISION METROPOLITAN BLVD UNIT 19 ZONE R-1

Materials of Construction: Block Concrete Wire Wood Other PLANS: Yes No

ARCHITECT: _____ ENGINEER: _____ CALCS: Yes No

CONTRACTOR: WINDMILL CONTRACTORS STATE LICENSE # _____ CITY LICENSE # _____

TOTAL SQUARE FEET: 9124 TOTAL LINEAL FEET: 1521

Remarks: See plan sheet INTERIOR
WALLS
14, 15, 16, 17

CONDITIONS OF THE PERMIT:

- Any type of retaining wall must be engineered by a Civil or Structural Engineer.
- If a home owner takes out the Building Permit and if the owner sublets the work to a Contractor, then the Contractor must take out the permit and pay for it.
- No fence or wall can be built on City property or rights-of-way, but this is not intended to preclude construction within utility easements if utilities will not be damaged or made inaccessible.
- The fence or wall shall not enclose any water meter, light standard, or fire alarm box and shall not come closer than 24" from the nearest fire hydrant outlet.
- Department Inspectors must approve footings before concrete is poured and block wall reinforcing before grouting is done.
- Maximum height of any wall or fence is 6' side and rear yards; 4' maximum in front yard with the vertical surface, above the height of 2' - 50% open.
- I must not obstruct required onsite parking space (2 spaces for each dwelling unit) by the erection of this fence or wall.
- By the signing of this application I herewith agree to the requirements outlined above.

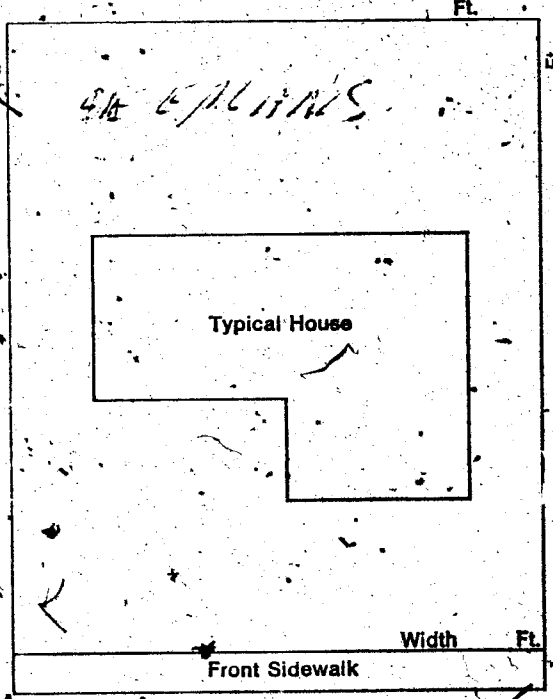

SIGNED: [Signature] DATE: _____
CONTRACTOR AGENT OWNER

PLANNING DEPT: [Signature] Date: 3-30-79
 PUBLIC WORKS DEPT: A.K. Weeder Date: 3-30-79
 BUILDING DIVISION: U.S. Date: 3/30/79
 #12850 PERMIT NO: 2559 PERMIT FEE \$ 138.00

RECEIPT
 [Stamp]
 MUST BE MACHINE VALIDATED

Gloria Caly 10-21-80

DIVISION of BUILDING & SAFETY - CITY of LAS VEGAS, NEVADA

OWNER Metropolitan Nev. Corp. ADDRESS 317 Agora Way DATE 9-7-78
 GEN. CONT. Same TYPE OF STRUCTURE SFD
 PERMIT NO. 9228-3 LEGAL DESCRIPTION L-3 B-9 Metropolitan Park #19

BUILDING	MECHANICAL	ELECTRICAL
Investigation	Plumbing Cont. <i>Steeling</i>	Temp. pole cont.
Location & Footing <i>M 2-9-28-78</i>	Permit No. <i>9818-3</i> Date <i>9-27-78</i>	Permit No. _____ Date _____
Stem Wall	Heat & Vent. A/C Cont. <i>Central ac</i>	Inspection _____ Date _____
Concrete Slab Floor <i>VH 10-13-78</i>	Permit No. <i>12422-41</i> Date <i>1-2-79</i>	Electrical Cont. <i>Uiba</i>
Floor Framing	Sewer Cont. <i>Metropolitan Nev.</i>	Permit No. <i>00-21-0</i> Date <i>1-7-79</i>
Fireplace Footing	Permit No. <i>9227</i> Date _____	Fixtures Cont. _____
Chimney, Steel	Rough Soil <i>Jc 10-13-78</i>	Permit No. _____ Date _____
Vert. Steel Reinf.	Rough Water	Slab _____
Horiz. Steel Reinf.	Tap Out	Rough <i>RP 12-29-78</i>
Roof Sheathing <i>VH 12-26-78</i>	Rough Gas	Final Rough _____
Framing <i>VH 1-4-79</i>	A/C Rough Duct <i>Jc 1-8-79</i>	Final Fixture _____
Backing for siding	Ref. Rough Piping	Final Electrical <i>RP 3-26-79</i>
Ext. Lath <i>VH 1-8-79</i>	Final Plumbing <i>SC 3-30-79</i>	Temporary Service _____
Ext. Scratch	Final Gas <i>Jc 3-30-79</i>	
Ext. Brown <i>VH 1-22-79</i>	Final A/C Cond. <i>Jc 4-2-79</i>	
Int. Lath	Final Refrig. _____	
Int. Brown	Final Sewer _____	
Drywall <i>VH 1-17-79</i>	Final Septic Tank _____	
Insulation <i>VH 1-15-79</i>		
Final Building <i>VH 4-2-79</i>		
Appr. for Occu.		

INSPECTOR:

DATE:

APPROVED FOR OCCUPANCY & METER

PLEASE NOTE REMARKS ON REVERSE SIDE 317 Agora Way

LOG #

AREA #

T-3-2

76-114