

6325 BRANDYWINE

D. Gatewood 1-30-79

Cherry

CITY OF LAS VEGAS, NEVADA

DEPARTMENT OF BUILDING & SAFETY - AIR CONDITIONING APPLICATION & PERMIT

ADDRESS OF CONSTRUCTION: 6325 BRANDYVINE OWNER'S NAME: BOB WEINSTEIN

CIRCLE: Addition Remodel: New Bldg: TYPE OF BLDG.: SFD APT. COMM. PUBLIC
 CONTRACTOR'S NAME: OTTON'S A/C STATE LICENSE 9223 CITY LICENSE 09536

UNITS	DESCRIPTION	FEE	TOTAL	UNITS	DESCRIPTION	FEE	TOTAL
	Unit heater - floor, wall or suspended	4.00			EVAPORATIVE COOLERS:		
	FOR EACH FORCED-AIR OR GRAVITY-TYPE FURNACE OR BURNER INCLUDING DUCTS AND VENT ATTACHED TO SUCH APPLIANCES:				5 outlets or under	3.00	
	Up to and including 100,000 B.t.u.'s	4.00			Over 5 apt up to and including 10	5.00	
	Over 100,000 B.t.u.'s	6.00			Each additional outlet over 10	.25	
	FOR EACH HEATING APPLICATION, REFRIGERATION UNIT, COMFORT COOLING AND HEATING UNIT, ABSORPTION UNIT, COMPRESSOR OR BOILER:				VENTILATION:		
	Up to and including 3 ton or horsepower, or absorption system up to and including 100,000 B.t.u.'s	4.00			For each fan connected to a single duct	.00	
	Over 3 ton or 3 horsepower up to and including 10, or absorption system over 100,000 B.t.u.'s up to and including 250,000 B.t.u.'s	7.00	7.00		For each commercial or industrial ventilation system	5.00	
	Over 10 ton or 10 horsepower up to and including 30, or absorption system over 250,000 B.t.u.'s up to and including 1,000,000 B.t.u.'s	12.00			For each commercial kitchen hood	5.00	
	Over 30 ton or 30 horsepower up to and including 50, or absorption system over 1,000,000 B.t.u.'s up to and including 1,700,000 B.t.u.'s	20.00			MISCELLANEOUS:		
	Over 50 ton or 50 horsepower, or absorption system over 1,700,000 B.t.u.'s	30.00			For each water cooling tower	8.00	
	FOR EACH AIR HANDLING UNIT INCLUDING DUCTS ATTACHED THERETO:				Duct work only - each opening	.25	
	Up to and including 10,000 CFM	2.00			For installation or relocation of each commercial or industrial incinerator	15.00	
	Over 10,000 CFM	4.00			Gas piping related to the air cond. work in single family dwelling only	3.00	
					For each appliance, piece of equipment, any mechanical work or alteration or replacement not included in this schedule, the permit fee shall be computed the same as building permit fees by using the cost of installation for the valuation amount.		
					FOR THE ISSUANCE OF EACH PERMIT	3.00	
					TOTAL PERMIT FEE \$	<u>10.00</u>	

I hereby certify that I have carefully examined and read the above application; that the same is true and correct; and that the work herein described is to be done in accordance with all the provisions of the applicable Ordinances of the City of Las Vegas, Nevada and the State Laws, whether herein specified or not.

SIGNED: [Signature] Date: 7/1/75
 Air Conditioning Contractor - Owner

BUILDING DEPARTMENT: [Signature] Date: _____

PERMIT NO. 488 PERMIT FEE \$ 10.00

RECEIPT
 7383 \$010.00 - 4
 CITY OF LAS VEGAS
 DEPT. OF BUILDING & SAFETY
 MUST BE MACHINE VALIDATED
 - 2 JUL 75

G. Gatewood 1-30-79

CITY OF LAS VEGAS, NEVADA

Job #5183

DEPARTMENT OF BUILDING & SAFETY - ELECTRICAL APPLICATION & PERMIT

ADDRESS OF CONSTRUCTION: 6325 Brandywine Way OWNER'S NAME: Bob Wellnitz

CIRCLE: New Bldg.; Add'n.; Remodel; TYPE OF BLDG.: SFD. APT. PUBLIC COMM.

CONTRACTOR'S NAME: ELECTRIC CONSTRUCTION CO. STATE LICENSE # 9383 CITY LICENSE # 2193

NUMBER	FIXTURE OR INSTALLATION	UNIT PRICE	TOTAL
	Rm addition, carport or garage enclosure	4.00	
	Temporary power	4.00	
	Light, receptacle or switch outlet	.20	
	Wall or ceiling space heater	.35	
	Garbage grinder outlet	.35	
	Dishwasher outlet	.35	
	Clothes dryer outlet	.35	
	Automatic clothes washer	.35	
	Electric range outlet	.35	
	Electric water heater outlet	.35	
	Special purpose outlet	.35	
	X-ray unit and its appurtenances	5.00	
	Watts of festoon lighting (Watts) First 3,000 watts for each additional thousand watts	4.00 1.50	
	Horsepower each motor first horsepower or less for each additional horsepower	1.75 .35	
	Electric service (including any single meter socket) for each additional socket	3.00 .35	
1	Air conditioning service <u>70A</u>	1.50	1.50
	Each KW(KVA) Generator (Transformer, Welder) First 100 KVA for each additional KW(KVA)	2.00 .01	
	Speaker, signal or alarm outlet	.15	
	Amplifiers	.50	
	Control panels	.25	
	Main control racks	1.00	
	T.V. and radio antennas-master system only	.75	
	Minimum fee for any permit	4.00	4.00
	TOTAL FEE		4.00

Approval for the work under this permit will be given only after refuse and debris have been removed from job site and public right of way.

I hereby certify that I have carefully examined and read the above application; that the same is true and correct; and that the work herein described is to be done in accordance with all the provisions of the applicable Ordinances of the City of Las Vegas, Nevada and State laws whether herein specified or not.

SIGNED [Signature] #69 DATE 7-1-75
 MASTER (ELECTRICIAN) [Signature]
 BUILDING DEPARTMENT [Signature] DATE 7-3-75
 #12860 PERMIT NO. 1392 PERMIT FEE \$ 4.00

RECEIPT
 7583 { \$004.00 - .6
 CITY OF LAS VEGAS
 DEPT. OF BUILDING & SAFETY
 MUST BE MACHINE VALIDATED
 3 JUL 75

Department of Building & Safety
City of Las Vegas, Nevada

Special Kardex
Elec. only, Plbg. only, A.C. only

Owner Bob Wellnitz Address 6325 Brandywine Date: 7/2/75
Contractor _____ Permit No. _____
Lot _____ Block _____ Subdivision _____

Electric Only	Plumbing Only	Heat & Vent. A. C. Only
Contractor <u>Elec Const</u>	Contractor _____	Contractor <u>Cottons</u>
Permit No. <u>1394</u>	Permit No. _____	Permit No. <u>488</u>
Lab _____	Rough Soil _____	A.C. Rough Duct _____
Rough Elect _____	Rough Water _____	Ref. Ro. Piping _____
Final Rough _____	Top Out _____	Rough Gas _____
Final Fixture _____	Rough Gas _____	Final Refrig _____
Final Elec _____	Final Plbg. _____	Final Air Cond <u>7-2-75</u>
Temp. Service _____	Final Gas _____	Final Gas _____
	Final Sewer _____	
	Final Septic Tank _____	

23.06 D Address 6325 Brandywine Log No. AC Area

DEPT of BLDG. & SAFETY - CITY of LAS VEGAS, NEVADA
OWNER E. KEITH WHITNEY ADDRESS 6325 Brandywine DATE 3/31/61
GEN. CONT. OWNER TYPE OF STRUCTURE STORAGE SHED
PERMIT NO. 3929 LEGAL DESCRIPTION Lot 7, Bl. 5, Chs. Hts. 22

LOCATION _____	FIREPLACE FTG. <u>8-75-61</u>	PLUMBING CONT. _____	TEMP. POLE CONT. _____
FOOTINGS _____	PILES _____	PERMIT NO. _____ DATE _____	PERMIT NO. _____ DATE _____
FOUND _____	PIERS <u>8-15-61</u>	HEAT & VENT. CONT. _____	INSPECTION _____ DATE _____
FLOOR _____	SLAB _____	PERMIT NO. _____ DATE _____	ELECTRICAL CONT. _____
ANCHOR BOLTS _____	BASE PLATES _____	SEWER CONT. _____	PERMIT NO. _____ DATE _____
WALL STEEL _____		SEWER NO. _____ DATE _____	OUTLETS _____
COLUMN STEEL _____		ROUGH SOIL _____	MOTORS _____ H.P. _____
BEAM STEEL _____		ROUGH WATER _____	
FRAMING _____		TOP-OUT _____	SLAB _____
ROOF SHEATHING _____		ROUGH GAS _____	ROUGH _____
STEEL FABRICATION _____		AC ROUGH DUCT _____	FINAL ROUGH _____
STEEL CONNECTION _____		REF. ROUGH PIPING _____	
LATHING _____	INTERIOR _____ EXTERIOR _____	SEWER _____	FIXTURES CONT. _____
BACKING _____		SEPTIC TANK _____	PERMIT NO. _____ DATE _____
PLASTER <u>SCRATCH</u> _____			FIXTURES _____
FINAL BLDG. _____ DATE _____			FINAL FIXTURE _____
GRADING & DRAINAGE _____		FINAL PLUMBING _____	URBAN REDEVELOPMENT APPROVAL _____
ON-SITE PARKING _____ SPACES _____		FINAL GAS _____	
ENG APPROVAL OF _____		FINAL HEATING _____	
OFF-SITE IMPROVEMENTS _____		FINAL AIR COND. _____	
		FINAL REFRIG. _____	

APPROVED FOR OCCUPANCY Bushong 1-31-62 INSPECTOR _____ DATE _____
APPROVED FOR METER _____
PLEASE NOTE REMARKS ON REVERSE SIDE. 6325 Brandywine Log # _____ AREA # _____ 23.04

DEPT. OF BLDG. & SAFETY - CITY OF LAS VEGAS, NEVADA

OWNER: SPROHL HOMES, INC. ADDRESS: 6325 Brandywine Way DATE: 9/6/60

SER. CONT. SAME PERMIT NO. 1482 LEGAL DESCRIPTION: Lot 7, Bl. 5, Chas. Hts. #22 TYPE OF STRUCTURE: S. F. DWELLING

LOCATION & FLOOR ELEVATION _____ FOOTINGS <u>Anderson 9-15-60</u> FOUND. & PIERS _____ WALL STEEL _____ BOND BEAM STEEL _____ FRAMING & ROOF SHEATHING <u>Palmer 10-1-60</u> STEEL FABRICATION _____ CONNECTIONS & PAINTING _____ INTERIOR _____ EXTERIOR _____ LATHING _____ PLASTER _____ SCRATCH BROWN _____ FINAL BLDG. <u>Palmer 11-29-60</u> GRADING & DRAINAGE _____ ON-SITE PARKING _____ SPACES _____ ENG. APPROVAL OF OFF-SITE IMPROVEMENTS _____	PLUMBING CONT. <u>Winters</u> PERMIT NO. <u>1325</u> DATE <u>9-21-60</u> HEAT & VENT. CONT. <u>Winters</u> PERMIT NO. <u>1361</u> DATE <u>10-6-60</u> SEWER CONT. <u>Winters</u> PERMIT NO. <u>1322</u> DATE <u>9-21-60</u> ROUGH SOIL <u>London 9-27-60</u> ROUGH WATER <u>London 9-27-60</u> SEWER OR SEPTIC TANK <u>London 10-27-60</u> TOP-OUT <u>London 10-24-60</u> ROUGH GAS <u>London 10-24-60</u> ROUGH DUCT <u>Moore 10-24-60</u> FINAL PLUMBING <u>London 11-29-60</u> FINAL HEATING <u>DT-RPM</u> FINAL GAS <u>London 11-29-60</u>	TEMP. POLE CONT. _____ PERMIT NO. _____ DATE _____ INSPECTION _____ DATE _____ ELECTRICAL CONT. <u>Proctor</u> PERMIT NO. <u>1272</u> DATE <u>9-22-60</u> OUTLETS <u>43</u> MOTORS _____ H.P. _____ SLAB <u>Stibel 8-30-60</u> ROUGH _____ FINAL ROUGH _____ FIXTURE CONT. <u>Proctor</u> PERMIT NO. <u>1275</u> DATE <u>9-24-60</u> FIXTURES <u>9</u> FINAL FIXTURE _____ APPROVED FOR METER: <u>Stibel 11-29-60</u>
--	--	---

APPROVED FOR OCCUPANCY: _____
 INSPECTOR _____ DATE _____

PLEASE NOTE REMARKS ON REVERSE SIDE

6325 Brandywine Way DWELLING 9/6/60

LOG: # T-36 Area: # 4 23.04

Jones 10 19-81

CITY OF LAS VEGAS, NEVADA

CONST. VAL \$ *1000*

LOG NO. & AREA _____
DEPARTMENT OF BUILDING AND SAFETY

APPLICATION FOR BUILDING PERMIT - for:
Fence, Wall, Retaining Wall.

ADDRESS OF CONSTRUCTION: *6325 Brentwood Way* OWNER: *Gene Adler*

LOT(s) *7* BLOCK *5* SUBDIVISION *Chaparral 1122* ZONE *R-1*

Materials of Construction: Block Concrete Wire Wood Other *Block*
PLANS: Yes No
CALCS: Yes No

ARCHITECT: _____ ENGINEER: _____

CONTRACTOR: *Owner* STATE LICENSE # _____ CITY LICENSE # *05*

TOTAL SQUARE FEET: *150* TOTAL LINEAL FEET: *96*

Remarks:

CONDITIONS OF THE PERMIT:

1. Any type of retaining wall must be engineered by a Civil or Structural Engineer.
2. If a home owner takes out the Building Permit and if the owner sublets the work to a Contractor, then the Contractor must take out the permit and pay for it.
3. No fence or wall can be built on City property or rights-of-way, but this is not intended to preclude construction within utility easements if utilities will not be damaged or made inaccessible.
4. The fence or wall shall not enclose any water meter, light standard, or fire alarm box and shall not come closer than 24" from the nearest fire hydrant outlet.
5. Department inspectors must approve footings before concrete is poured and block wall reinforcing before grouting is done.
6. Maximum height of any wall or fence is 6', side and rear yards; 4' maximum in front yard with the vertical surface above the height of 2'-50% open.
7. I must not obstruct required onsite parking space (2 spaces for each dwelling unit) by the erection of this fence or wall.
8. By the signing of this application herewith agree to the requirements outlined above.

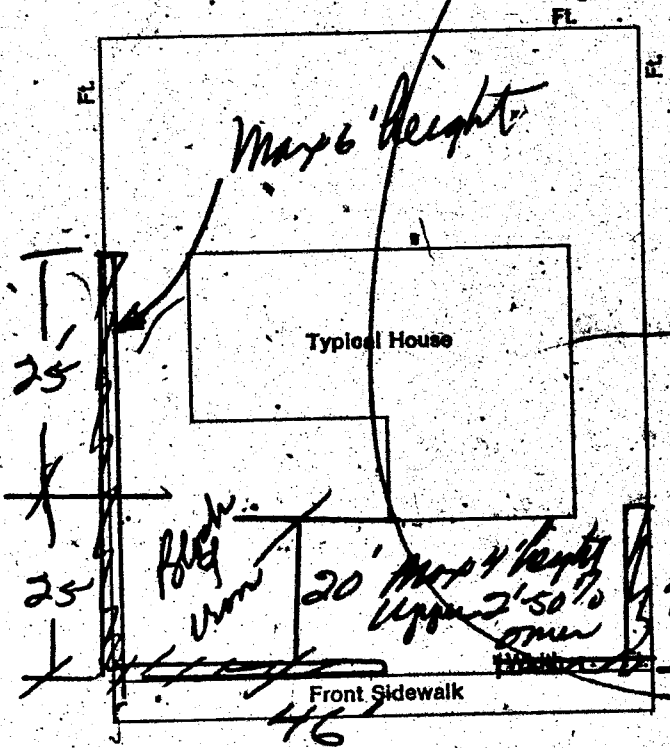

1TONI \$.00
WALL \$ 17.50
STL \$ 17.50

TOTL \$ *100*
CHECK DATE: *10/12/81*
AMOUNT \$R#001701

SIGNED: _____
CONTRACTOR AGENT

PLANNING DEPT: *[Signature]* Date: *10/12/81*
PUBLIC WORKS DEPT: *[Signature]* Date: *10/12/81*
BUILDING DIVISION: *[Signature]* Date: *10/12/81*
PERMIT NO: *4752* PERMIT FEE \$ *17.50*

CITY OF LAS VEGAS
BLDG. & SAFETY
10/12/81

MUST BE MACHINE VALIDATED

J. Jones 10-19-81

DEPARTMENT OF BUILDING & SAFETY
CITY OF LAS VEGAS

*Corrected 10-12-81
DM # 4752*

Telephone
386-6251

PERMIT REQUIRED

Permits Required: No person, firm, or corporation shall erect, construct, enlarge, alter, repair, move, improve, remove, convert, or demolish any building or structure in the City, or cause same to be done, without first obtaining a separate permit.

Where work for which a permit is required by this Code is started or proceeded with prior to obtaining said permit, the fees may be DOUBLED.

Date *10-9-81*

Type of work *Block wall*

Address of work *6325 BRANDYwine*

Remarks: *PERMIT REQUIRED
within 72 HOURS - by
14 Oct 81*

Signed *Bill Miskaluk*
Blky INSPECTOR

June Adler 82

FENCE & RETAINING WALL		
OWNER <i>June Adler</i>		DATE <i>10-12-81</i>
ADDRESS <i>6325 Brandwine Way</i>		
CONTRACTOR <i>Owner</i>	PERMIT NO. <i>4752</i>	FINAL INSPECTION <i>Blk & Iron</i>
LOT <i>7</i>	BLOCK <i>5 Char Hgts #22</i>	SUBDIVISION
LOG #	AREA	
FENCES (wire, wood, block, & retaining walls)		
1	Location	
2	Footing <i>BM 10-13-81</i>	
3	Wall Steel	
	1st	2nd
4	Bond Beam	
	1st	2nd
5	Final <i>BM 11-16-81</i>	
Specify Type Of Fence		
2-1-33	DIV. OF BLDG. & SAFETY CITY OF LOS ANGELES REV. 10-78	E-Z-WAY SYSTEM NEWARK, OH LITHO IN U.S.A.

Don [unclear] 11-30-82

CITY OF LAS VEGAS, NEVADA

070-103-819

LOG NO. & AREA

CONST. VAL. \$ 4490.00

DEPARTMENT OF PUBLIC SERVICES
DIVISION OF BUILDING AND SAFETY

APPLICATION & BUILDING PERMIT - for:
Dwellings, Duplexes, Misc. Residential Const.

ADDRESS OF CONSTRUCTION: 6325 Brandywine Way

OWNER: June Adler

LOT(s) 7 BLOCK 5 SUBDIVISION

Chin Hgts #22 ZONE R1

Existing structure on lot: Dwelling Accessory Bldgs. Vacant Lot Other

PROPOSED CONSTRUCTION: Alcoa Siding

USE:

MATERIALS OF CONSTRUCTION: Wood Frame Concrete Block Reinforced Concrete Steel Frame

SQUARE FEET OF FLOOR AREAS: 1st _____ 2nd _____ 3rd _____ Other _____ TOTAL SQ. FT. _____

FIRE ZONE: _____ Occupancy Group _____ CONST. TYPE: _____

ARCHITECT _____ ENGINEER _____ NO. of UNITS _____ NO. of STORIES _____

Plans Submitted: Yes No Calculations Submitted Yes No Sewer Fee Req'd. Yes No

CONTRACTOR: D.C. Builders STATE LICENSE # 007831 CITY LICENSE # 000083240s

ADD'L. PERMITS REQ'D: Air Cond. Elec. Plumbing Signs Paving Fence Public Walks Curb-gutters
Incinerators Fire Sprinkling System

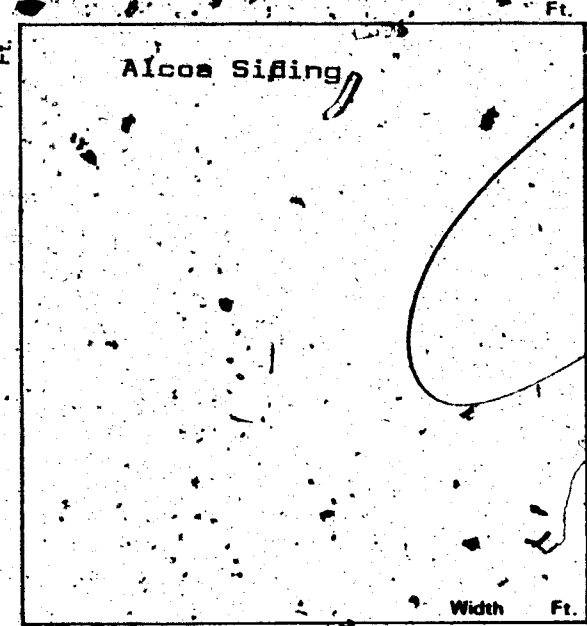

CONDITIONS OF THE PERMIT

- I agree to call the City Building Department for inspections before concrete is poured, before rough wiring, electrical, plumbing, framing is covered. Also for Air conditioning, drywall and sheathing inspection.
- I agree that when the job is completed that I will call for final inspection before occupancy.
- I agree to perform all construction in accordance with City Ordinances and Building Codes.
- The Contractor's signature below denotes authority from the owner to sign in his behalf and that the owner is aware of all requirements of this application and permit. Separate permits must be taken out for work outlined above this agreement.
- I have read and understand the contents of this application and permit. I hereby state that the information I have supplied on this application is true and correct.

Approval for the work under this permit will be given only after refuse and debris have been removed from job site and public right of way. Separate permits are required for work within the public right of way.

SIGNED: D.C. Builders Contractor
BY: Jim B... Agent or Owner

LLULA \$.00
SFD \$ 50.50
STL \$ 50.50
TOTL \$ 50.50

CHEK RECEIPT \$ 50.50
AN#5101 SR#001/01
CITY - LAS VEGAS
BLDG. & SAFETY
11/29/82

PLANNING DEPT. [Signature] Date: 11/29/82

PUBLIC WORKS DEPT. [Signature] Date: 11-29-82

BUILDING DIVISION: [Signature] Date: [Signature]

PERMIT NO: 5101 PERMIT FEE \$ 50.50

2300-2401

MUST BE MACHINE VALIDATED

Lula Collins 12-19-84.

OWNER <u>June Adler</u>		ADDRESS <u>6325 Brandywine</u>	
DATE <u>11/29/82</u>		GEN. CONT. <u>D.C. Builders</u>	
TYPE OF STRUCTURE <u>Siding</u>		PERMIT NO. <u>5102</u>	FINAL INSPECTION
LEGAL DESCRIPTION <u>Lot 7 Blk 5 Charleston hqts #22 zone R-1</u>		LOG NO.	AREA NO.
APPROVED FOR OCCUPANCY & METER			
BUILDING		MECHANICAL	
Investigation		Plumbing Cont.	
Location & Footing		Permit No.	Date
Concrete Slab Floor		Heat & Vent/A/C Cont.	
Fireplace Footing		Permit No.	Date
Chimney Steel		Sewer Cont.	
Vert. Steel Reinf.		Permit No.	Date
Horiz. Steel Reinf.		Rough Soil	
Framing		Rough Water	
Ext. Lath		Tap Out	
Ext. Brown		Rough Gas	
Drywall		A/C Rough Duct	
Final Building		Final Plumbing	
Appr. for Occu	<u>12-19-84</u>	Final Gas	
ELECTRICAL		Final Air Cond.	
Temp. Pipe Coat		Final Sewer	
Permit No.	Date	REMARKS	
Inspection	Date		
Electrical Cont.			
Permit No.	Date	PLEASE NOTE ADDITIONAL REMARKS ON REVERSE SIDE	
Rough			
Final Rough		DEPT. OF BLDG. & SAFETY	
Final Electrical		CITY OF LAS VEGAS	
Temporary Service		REV: 82-3-29	

Lula Collins 12-19-84

Siding B-M 12-10-82