

1353 ARVILLE ST.

S. Seybert 1/17/79

CITY OF LAS VEGAS, NEVADA
DEPARTMENT OF BUILDING & SAFETY - AIR CONDITIONING APPLICATION & PERMIT

ADDRESS OF CONSTRUCTION: 1353 Arville OWNER'S NAME: TOM MORRIS

CIRCLE: Addition: Remodel: New Bldg: TYPE OF BLDG.: SFD APT. COMM. PUBLIC

CONTRACTOR'S NAME: Supreme Ref STATE LICENSE 10344 CITY LICENSE 871-2-11139

| UNITS | DESCRIPTION | FEE | TOTAL | UNITS | DESCRIPTION | FEE | TOTAL |
|-------|--|-------|-------|-------|---|-------|-------|
| | Unit heater-floor, wall or suspended | 4.00 | | | EVAPORATIVE COOLERS: | | |
| | FOR EACH FORCED-AIR OR GRAVITY-TYPE FURNACE OR BURNER INCLUDING DUCTS AND VENT ATTACHED TO SUCH APPLIANCES: | | | | 5 outlets or under | 3.00 | |
| | Up to and including 100,000 B.t.u.'s | 4.00 | | | Over 5 and up to and including 10 | 5.00 | |
| | Over 100,000 B.t.u.'s | 6.00 | | | Each additional outlet over 10 | .25 | |
| | FOR EACH HEATING APPLICATION, REFRIGERATION UNIT, COMFORT COOLING AND HEATING UNIT, ABSORPTION UNIT, COMPRESSOR OR BOILER: | | | | VENTILATION: | | |
| | Up to and including 3 ton or horsepower, or absorption system up to and including 100,000 B.t.u.'s | 4.00 | 4.00 | | For each fan connected to a single duct | 1.00 | |
| | Over 3 ton or 3 horsepower up to and including 10, or absorption system over 100,000 B.t.u.'s up to and including 250,000 B.t.u.'s | 7.00 | | | For each commercial or industrial ventilation system | 5.00 | |
| | Over 10 ton or 10 horsepower up to and including 30, or absorption system over 250,000 B.t.u.'s up to and including 1,000,000 B.t.u.'s | 12.00 | | | For each commercial kitchen hood | 5.00 | |
| | Over 30 ton or 30 horsepower up to and including 50, or absorption system over 1,000,000 B.t.u.'s up to and including 1,700,000 B.t.u.'s | 20.00 | | | MISCELLANEOUS: | | |
| | Over 50 ton or 50 horsepower, or absorption system over 1,700,000 B.t.u.'s | 30.00 | | | For each water cooling tower | 8.00 | |
| | FOR EACH AIR HANDLING UNIT INCLUDING DUCTS ATTACHED THERETO: | | | 7 | Duct work only - each opening | .25 | 1.75 |
| | Up to and including 10,000 CFM | 2.00 | | | For installation or relocation of each commercial or industrial incinerator | 15.00 | |
| | Over 10,000 CFM | 4.00 | | | Gas piping related to the air cond. work in single family dwelling only | 3.00 | |
| | | | | | FOR THE ISSUANCE OF EACH PERMIT | | 3.00 |
| | | | | | TOTAL PERMIT FEE \$ | | 8.75 |

I hereby certify that I have carefully examined and read the above application; that the same is true and correct; and that the work herein described is to be done in accordance with all the provisions of the applicable Ordinances of the City of Las Vegas, Nevada and the State Laws, whether herein specified or not.

SIGNED: Mont Bennett Date: 5/29/70
 Air Conditioning Contractor - Owner

BUILDING DEPARTMENT: James Meyer Date: 6-3-70

PERMIT NO. 29161 PERMIT FEE \$ 8.75

RECEIPT

\$136.0008.75 - 1

CITY OF LAS VEGAS
 DEPT. OF BUILDING & SAFETY

MUST BE MACHINE VALIDATED

3 JUN 70

S. Seybert 1/17/79

CITY OF LAS VEGAS, NEVADA

LOG NO. & AREA

1970

CONST. VAL. \$

500.⁰⁰/₂₂

DEPARTMENT OF BUILDING & SAFETY

APPLICATION & BUILDING PERMIT - for:

Dwellings, Duplexes, Misc. Residential Const.

ADDRESS OF CONSTRUCTION:

1353 ARVILLE

OWNER:

TOM MORRIS

LOT(s)

BLOCK

SUBDIVISION

ZONE:

Existing structure on lot:

Dwelling

Accessory bldg.

Vacant lot

Other

PROPOSED CONSTRUCTION:

REROOF

USE:

MATERIALS OF CONSTRUCTION:

Wood Frame

Concrete Block

Reinforced Concrete

Steel Frame

SQUARE FEET OF FLOOR AREAS:

1st

2nd

3rd

Other

TOTAL SQ. FT.

FIRE ZONE:

1 2 3

Occupancy Group

A

B

C

D

E

F

G

H

I

J-1-2-3-4-5

CONST. TYPE:

I

II

III

IV

V

ARCHITECT:

ENGINEER:

NO. of UNITS

NO. of STORIES

Plans Submitted:

Yes

No

Calculations Submitted

Yes

No

Sewer Fee Req'd.

Yes

No

CONTRACTOR:

Howard's Inc.

STATE LICENSE #

6406

CITY LICENSE #

211794200604

ADD'L. PERMITS REQ'D:

Air Cond.

Elec.

Plumbing

Signs

Paving

Fence

Public Walks

Curb-gutters

Incinerators

Fire Sprinkling System

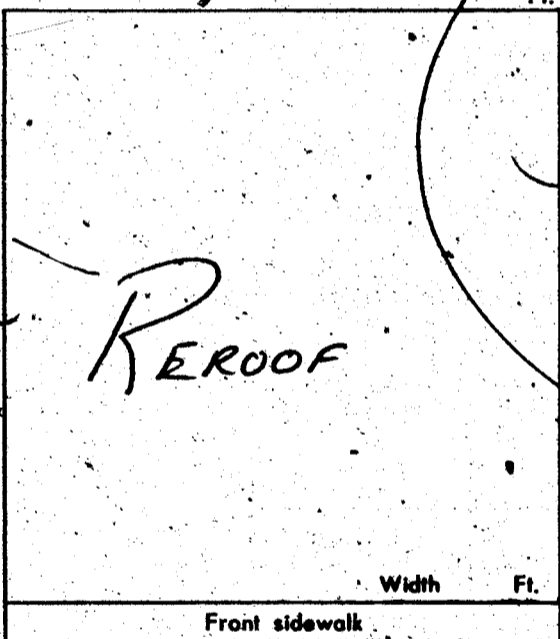

CONDITIONS OF THE PERMIT:

1. I agree to call the City Building Department for inspections before concrete is poured, before rough wiring, electrical, plumbing, framing is covered. Also for Air conditioning, sheet-rock and sheathing inspection.
2. I agree that when the job is completed that I will call for final inspection before occupancy.
3. I agree to perform all construction in accordance with City Ordinances and Building Codes.
4. The Contractor's signature below denotes authority from the owner to sign in his behalf and that the owner is aware of all requirements of this application and permit. Separate permits must be taken out for work outlined above this agreement.
5. I have read and understand the contents of this application and permit; I hereby state that the information I have supplied on this application is true and correct.

SIGNED:

Howard's Inc.

Contractor

BY:

David Schmidt

Agent or Owner

CLARK COUNTY HEALTH DEPT.

Date

LAS VEGAS FIRE DEPARTMENT

Date

PLANNING DEPT:

Date:

PUBLIC WORKS DEPT:

Date:

BUILDING DEPT:

David Meyer

Date:

6-5-70

*12850

PERMIT NO:

53661

PERMIT FEE \$

7.⁰⁰/₂₂

RECEIPT
9205 \$5007.00 - 8
CITY OF LAS VEGAS
DEPT. OF BUILDING & SAFETY
MUST BE MACHINE DATED
5 JAN 70

S. Seybert 1/17/79

CITY OF LAS VEGAS, NEVADA

DEPARTMENT OF BUILDING & SAFETY - ELECTRICAL APPLICATION & PERMIT

ADDRESS OF CONSTRUCTION: 1353 ARVILLE

OWNER'S NAME: C. I. MORRIS

CIRCLE: New Bldg.; Add'n; Remodel; TYPE OF BLDG.: SFD. APT. PUBLIC COMM.

CONTRACTOR'S NAME: SIMPSON & BOZARTH ELECT. INC. STATE LICENSE # 6424A

CITY LICENSE # 7564

| NUMBER | FIXTURE OR INSTALLATION | UNIT PRICE | |
|--------|---|------------|------|
| | Fixture or sockets | .15 | |
| | Light, receptacle or switch outlet | .20 | |
| | Wall or ceiling space heater | .35 | |
| | Blast coil heater per kilowatt | .35 | |
| | Garbage grinder outlet | .35 | |
| | Dishwasher outlet | .35 | |
| | Clothes dryer outlet | .35 | |
| | Automatic clothes washer | .35 | |
| | Electric range outlet | .35 | |
| | Electric water heater outlet | .35 | |
| | Mercury arc lamp and equipment | .35 | |
| | Special purpose outlet | .35 | |
| | X-ray unit and its appurtenances | 5.00 | |
| | Watts of festoon lighting (Watts) First 3,000 watts | 4.00 | |
| | for each additional thousand watts | 1.50 | |
| | Horsepower - all motors first horsepower or less | 1.75 | |
| | for each additional horsepower | .35 | |
| | Temporary power and lights (temporary pole) | 4.00 | |
| | Electric service (including any single meter socket) | 3.00 | |
| | for each additional socket | .35 | |
| 1 | Air conditioning service -amps | 1.50 | |
| | Each KW (KVA) Generator (Transformer) (Welder) KW (KVA) | 2.00 | |
| | First 100 KVA - For each additional KW (KVA) | .91 | |
| | Special inspection per hour | 4.00 | |
| | Speaker outlets | .15 | |
| | Signal or Alarm outlets | .15 | |
| | Amplifiers | .50 | |
| | Control panels | .25 | |
| | T. V. outlets - master system only | .15 | |
| | Radio outlets | .15 | |
| | Main control racks | 1.00 | |
| | T. V. and Radio antennas - master system only | .75 | |
| 1 | Minimum fee for any permit | 4.00 | 4.00 |
| | Total fee | | 4.00 |

I hereby certify that I have carefully examined and read the above application, that the same is true and correct; and that the work herein described is to be done in accordance with all the provisions of the applicable Ordinances of the City of Las Vegas, Nevada and State laws whether herein specified or not.

SIGNED William B. Simpson
MASTER (ELECTRICIAN)

DATE JUNE 9, 1970

BUILDING DEPARTMENT J. Wenzel

DATE 6-11-70

PERMIT NO. 30899

PERMIT FEE: \$ 4.00

RECEIPT

5549 \$004.00 - 6

CITY OF LAS VEGAS
DEPT. OF BUILDING & SAFETY

Melvia E. Ellis 11-25-80

Department of Building & Safety
City of Las Vegas, Nevada

Special Kardex
Elec. only, Plbg. only, A.C. only

Owner Tom Morris Address 1353 Arville Date: 6/3/70
Contractor _____ Permit No. _____
Lot _____ Block _____ Subdivision _____

| Electric Only | Plumbing Only | Heat & Vent. A. C. Only |
|-----------------------------------|-------------------------|----------------------------------|
| Contractor <u>Impson B. Smith</u> | Contractor _____ | Contractor <u>Supreme Refrig</u> |
| Permit No. <u>30899</u> | Permit No. _____ | Permit No. <u>29161</u> |
| Slab _____ | Rough Soil _____ | A.C. Rough Duct _____ |
| Rough Elect _____ | Rough Water _____ | Ref. Ro. Piping _____ |
| Final Rough _____ | Top Out _____ | Rough Gas _____ |
| Final Fixture _____ | Rough Gas _____ | Final Refrig _____ |
| Final Elec <u>6/10/70</u> | Final Plbg. _____ | Final Air Cond <u>6/10/70</u> |
| Temp. Service _____ | Final Gas _____ | Final Gas <u>1-21-71</u> |
| | Final Sewer _____ | |
| | Final Septic Tank _____ | |

23.06 D Address 1353 Arville Log No. H.P. Area _____

DEPT. of BLDG. & SAFETY - CITY of LAS VEGAS, NEVADA

OWNER Morris ADDRESS 1353 Arville DATE Dec. 22, 1964
GEN CONT Wells Cargo, Inc. TYPE OF STRUCTURE Asphalt Paved Driveway
PERMIT NO 28616 LEGAL DESCRIPTION Lot 11 Block 2, Hinson Tr.

| BUILDING | MECHANICAL | ELECTRICAL |
|---|----------------------------|--|
| LOCATION _____ | PLUMBING CONT _____ | TEMP POLE CONT _____ |
| FIREPLACE FTG _____ | PERMIT NO _____ DATE _____ | PERMIT NO _____ DATE _____ |
| FOOTINGS _____ | HEAT & VENT AC CONT _____ | INSPECTION _____ DATE _____ |
| FOUNDATION WALL _____ | PERMIT NO _____ DATE _____ | ELECTRICAL CONT _____ |
| FLOOR FRAMING _____ | SEWER CONT _____ | PERMIT NO _____ DATE _____ |
| SLAB _____ | PERMIT NO _____ DATE _____ | FIXTURES CONT _____ |
| CHIMNEY STEEL (FIREPLACE) _____ | ROUGH SOIL _____ | PERMIT NO _____ DATE _____ |
| WALL STEEL _____ | ROUGH WATER _____ | SLAB _____ |
| COLUMN STEEL _____ | TOP-OUT _____ | ROUGH _____ |
| BEAM STEEL _____ | ROUGH GAS _____ | FINAL ROUGH _____ |
| FRAMING _____ | AC ROUGH DUCT _____ | FINAL FIXTURE _____ |
| ROOF SHEATHING _____ | REF ROUGH PIPING _____ | FINAL ELECTRICAL _____ |
| DRYWALL _____ | FINAL PLUMBING _____ | TEMPORARY SERVICE _____ |
| LATHING _____ | FINAL GAS _____ | |
| BACKING (SIDING) _____ | FINAL AIR COND _____ | MISCELLANEOUS |
| PLASTER SCRATCH _____ | FINAL REFRIG _____ | GRADING & DRAINAGE _____ |
| PLASTER BROWN _____ | FINAL SEWER _____ | ON-SITE PARKING SPACES _____ APP _____ |
| URBAN REDEVELOPMENT APPROVAL _____ | FINAL SEPTIC TANK _____ | ENG APPROVAL OF _____ |
| FINAL BLDG <u>W.C.D.</u> DATE <u>6-7-65</u> | | OFF-SITE IMPROVEMENTS _____ |

APPROVED FOR OCCUPANCY & METER _____ INSPECTOR _____ DATE _____
PLEASE NOTE REMARKS ON REVERSE SIDE LOG: # _____ AREA: # 4 23.04
1353 Arville

Maria Caly 11-25-80

DEPT. of BLDG & SAFETY - CITY of LAS VEGAS, NEVADA
 OWNER Tom Morris ADDRESS 1353 Arville DATE 6/5/70
 GEN. CONT. HOWARD'S INC. TYPE OF STRUCTURE reroof
 PERMIT NO. 53661 LEGAL DESCRIPTION

| BUILDING | MECHANICAL | ELECTRICAL |
|------------------------------|-----------------------|-----------------------------|
| LOCATION | PLUMBING CONT. | TEMP. POLE CONT. |
| FIREPLACE FTO. | PERMIT NO. DATE | PERMIT NO. DATE |
| FOOTINGS | HEAT & VENT. AC CONT. | INSPECTION DATE |
| FOUNDATION WALL | PERMIT NO. DATE | ELECTRICAL CONT. |
| FLOOR FRAMING | SEWER CONT. | PERMIT NO. DATE |
| SLAB | ROUGH SOIL | FIXTURES CONT. |
| CHIMNEY STEEL (FIREPLACE) | ROUGH WATER | PERMIT NO. DATE |
| WALL STEEL | TOP-OUT | SLAB |
| COLUMN STEEL | ROUGH GAS | ROUGH |
| BEAM STEEL | AC ROUGH DUCT | FINAL ROUGH |
| FRAMING | REF. ROUGH PIPING | FINAL FIXTURE |
| ROOF SHEATHING | FINAL PLUMBING | FINAL ELECTRICAL |
| INTERIOR | FINAL GAS | TEMPORARY SERVICE |
| EXTERIOR | FINAL AIR COND. | MISCELLANEOUS |
| DRYWALL | FINAL REFRIG. | GRADING & DRAINAGE |
| LATHING | FINAL SEWER | ON-SITE PARKING SPACES APP. |
| BACKING (SIDING) | FINAL SEPTIC TANK | ENG APPROVAL OF |
| SCRATCH | | OFF-SITE IMPROVEMENTS |
| PLASTER BROWN | | |
| URBAN REDEVELOPMENT APPROVAL | | |
| FINAL BLDG DATE 6-8-70 | | |

APPROVED FOR OCCUPANCY & METER _____ INSPECTOR _____ DATE _____
 PLEASE NOTE REMARKS ON REVERSE SIDE 1353 Arville LOG # _____ AREA # _____ 23-04

Department of Building & Safety City of Las Vegas, Nevada
 Special Kardex Elect. only-Plbg. only-A.C. only
 Owner Tom Morris Address 1353 Arville Date 8/17/65
 Contractor _____ Bermit No. _____
 Lot _____ Block _____ Subdivision _____

| Electric Only | Plumbing Only | Heat & Vent. A.C. Only |
|---------------------|-------------------------|------------------------|
| Contractor _____ | Contractor General | Contractor _____ |
| Permit No. _____ | Permit No. 18346 | Permit No. _____ |
| Slab _____ | Rough Soil _____ | A.C. Rough Duct _____ |
| Rough Elect. _____ | Rough Water _____ | Ref. Ro. Piping _____ |
| Final Rough _____ | Top Out _____ | Rough Gas _____ |
| Final Fixture _____ | Rough Gas _____ | Final Refrig. _____ |
| Final Elect. _____ | Final Plbg. 8/26/65 | Final Air Cond. _____ |
| Temp. Service _____ | Final Gas 8/26/65 | Final Gas _____ |
| | Final Sewer _____ | |
| | Final Septic Tank _____ | |

23.06 D Address 1353 Arville Log No. _____ Area Plbg. only _____

Debbie Ingraham 2-25-85

66

MAYOR BILL BRIARE
COUNCILMEN
RON LURIE
AL LEVY
BOB NOLEN
W. WAYNE BUNKER
CITY ATTORNEY
GEORGE F. OGILVIE
CITY MANAGER
ASHLEY HALL



CITY of LAS VEGAS

February 15, 1985

Mr. Clarence T. Morris
5424 Hibbetts
Las Vegas, Nevada 89103

RE: RECLASSIFICATION OF PROPERTY
Z-98-84

Dear Mr. Morris:

The City Council at a regular meeting held February 6, 1985, DENIED the Reclassification of Property generally located at 1353 Arville Street, From: R-E (Residence Estates) To: C-1 (Limited Commercial), Proposed Use: Child Care Center.

Sincerely,

Carol Ann Hawley
CAROL ANN HAWLEY
City Clerk

CAH:jp

cc: Dept. of Community Planning and Development
Dept. of Fire Services
Dept. of Design and Development
Dept. of Building and Safety
Land Development and Flood Control
Ms. Sandy McFarland

*2-20-85 - 1353 Arville
Home apparently vacant
No vehicles.
Pest control service notice
on door dated 2-5-85.
Jim Lawson*

