

2212 BRADY ST.

LOT 14 BK 1 GREATER LAS VEGAS ADDN #3 UNIT 5-A ZONE R-1

D. Gatewood 1-29-79

1968  
CITY OF LAS VEGAS, NEVADA

LOG NO. & AREA T-15/2 CONST. VAL. \$ 15,238.00  
 DEPARTMENT OF BUILDING & SAFETY APPLICATION & BUILDING PERMIT — for:  
 Dwellings, Duplexes, Misc. Residential Const.  
 ADDRESS OF CONSTRUCTION: 2212 Brady Street OWNER: Nevada Western Development Corp.,  
 Formerly Mortgage Services, Inc.  
 LOT(s) 14 BLOCK 1 SUBDIVISION Greater Las Vegas Addn. 3, Unit 5-A ZONE: R-1  
 Existing structure on lot: Dwelling  Accessory bldgs.  Vacant lot  Other   
 PROPOSED CONSTRUCTION: Single family dwelling with garage USE: Residence  
 MATERIALS OF CONSTRUCTION: Wood Frame  Concrete Block  Reinforced Concrete  Steel Frame   
 SQUARE FEET OF FLOOR AREAS: 1st \_\_\_\_\_ 2nd \_\_\_\_\_ 3rd \_\_\_\_\_ Other \_\_\_\_\_ TOTAL SQ. FT. 1362 + 306  
 FIRE ZONE: 1 2 3  Occupancy Group A B C D E F G H I J 1-2-3-4-5 CONST. TYPE: I II III IV V  
 ARCHITECT: None ENGINEER: Voorheis-Trindle NO. of UNITS \_\_\_\_\_ NO. of STORIES \_\_\_\_\_  
 Plans Submitted: Yes  No  Calculations Submitted Yes  No  Sewer Fee Req'd. Yes  No   
 CONTRACTOR: Robert Shaw STATE LICENSE # B 9440 CITY LICENSE # C11-916-2-12446  
 ADD'L. PERMITS REQ'D: Air Cond.  Elec.  Plumbing  Signs  Paving  Fence  Public Walks  Curb-gutters   
 Incinerators  Fire Sprinkling System

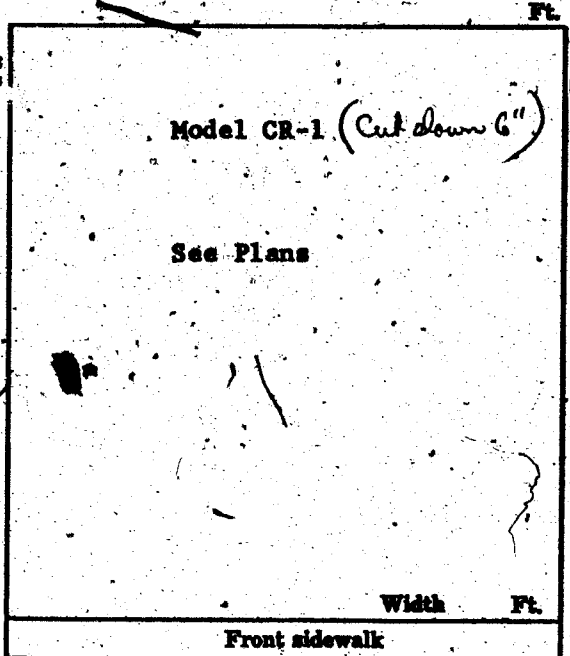

- CONDITIONS OF THE PERMIT:**
1. I agree to call the City Building Department for inspections before concrete is poured, before rough wiring, electrical, plumbing, framing is covered. Also for Air conditioning, sheet-rock and sheathing inspection.
  2. I agree that when the job is completed that I will call for final inspection before occupancy.
  3. I agree to perform all construction in accordance with City Ordinances and Building Codes.
  4. The Contractor's signature below denotes authority from the owner to sign in his behalf and that the owner is aware of all requirements of this application and permit. Separate permits must be taken out for work outlined above this agreement.
  5. I have read and understand the contents of this application and permit; I hereby state that the information I have supplied on this application is true and correct.

SIGNED: Robert Shaw Contractor  
 BY: R. Shaw Agent or Owner  
 \_\_\_\_\_ Date \_\_\_\_\_  
 CLARK COUNTY HEALTH DEPT.  
 \_\_\_\_\_ Date \_\_\_\_\_  
 LAS VEGAS FIRE DEPARTMENT

PLANNING DEPT: [Signature] Date: 5-24-68  
 ENGINEERING DEPT: J.D. Decker Date: 5-24-68  
 BUILDING DEPT: [Signature] Date: 5-24-68  
 #12850 PERMIT NO: 42019 PERMIT FEE \$ 48.00

RECEIPT  
 075 \$048.00 - 8  
 CITY OF LAS VEGAS  
 DEPT. OF BUILDING & SAFETY  
 MUST BE MACHINE VALIDATED  
 24 MAY 68

D. Gatewood 1-29-79

CITY OF LAS VEGAS, NEVADA  
DEPARTMENT OF BUILDING & SAFETY

SEWER CONNECTION FEE: \$ \_\_\_\_\_

RECEIPT  
for  
SEWER CONNECTION FEE

JOB ADDRESS: 2212 Brady Street OWNER'S NAME: Nevada Western Development Corp.

LOT 14 BLOCK 1 SUBDIVISION Greater Las Vegas Addn. 3, Unit 5-A

| QUANTITY | OCCUPANCY              | UNIT FEE | AMOUNT |
|----------|------------------------|----------|--------|
| 1        | Sewer Conn. - S. F. D. | 150.00   | 150.00 |
|          |                        |          |        |
|          |                        |          |        |
|          |                        |          |        |
|          |                        |          |        |
|          |                        |          |        |
|          |                        |          |        |
|          |                        |          |        |

|              |               |
|--------------|---------------|
| TOTAL        | 150.00        |
| Less Credit* | ---           |
| TOTAL FEE \$ | <u>150.00</u> |

\*Credit for existing sewer is applied to the new sewer connection fee based on previous type of occupancy and only when the new occupancy requires an additional fee.  
This receipt does not authorize the owner or his representative to start any work without obtaining a plumbing permit.

[Signature]  
DEPARTMENT OF BUILDING & SAFETY DATE 5-24-67

Receipt  
\$150.00 - 3  
CITY OF LAS VEGAS  
DEPT. OF  
BUILDING & SAFETY  
Must be revalidated

#1297 RECEIPT NO. 23102 SEWER FEE \$ 150.00

23.30

D. McIntire 1-29-79

CITY OF LAS VEGAS, NEVADA  
DEPARTMENT OF BUILDING & SAFETY

PERMIT FEE \$ \_\_\_\_\_  
APPLICATION & PERMIT FOR \_\_\_\_\_

JOB ADDRESS: 2212 Brady OWNER'S NAME: Robert Shaw PLUMBING

LOT 4 BLOCK 1 SUBDIVISION \_\_\_\_\_ Bldg. type: SFD  APT  COMM

Circle: New Bldg. Old bldg; Add'n; Remodel; Pool; Wtr. Sftner; Lawn Sprkr; Other,

CONTRACTOR: Col Plumbing State Lic. # 7596 City Lic. # 10100

| QUANTITY | FIXTURE OR INSTALLATION                                      | Unit Price | AMOUNT |
|----------|--|------------|--------|
| 1        | Bathtub  | 1.00       | 1.00   |
|          | Clothes dryer (gas)  | 1.00       |        |
| 1        | Clothes washer   | 1.00       | 1.00   |
|          | Dental unit  | 1.00       |        |
|          | Dishwasher   | 1.00       |        |
|          | Drinking fountain  | 1.00       |        |
|          | Fire sprinkling - underground piping                         | 5.00       |        |
|          | Fire sprinkling - distribution piping per each foot          | .01        |        |
| 1        | Fire sprinkling heads - per each head                        | .10        |        |
|          | Floor drain \$1.00 Floor sink                                | 1.00       |        |
|          | Gas appliance (any type)                                     | 1.00       |        |
| 1        | Gas piping system - single family dwelling                   | 3.00       | 3.00   |
|          | Gas piping system - multiple family \$3 per each unit plus   | 1.00       |        |
|          | Gas piping system - commercial bldg. per each floor          | 3.00       |        |
|          | Grease trap  | 1.00       |        |
|          | Irrigation system  | 4.00       |        |
| 2        | Lavatory   | 1.00       | 2.00   |
|          | Minimum fee for any permit                                   | 4.00       |        |
| 1        | Piping, Drainage   | 4.00       | 4.00   |
|          | Sewer replacement  | 4.00       |        |
|          | Septic disposal system - Health Dept. approval required      | 4.00       |        |
| 1        | Shower   | 1.00       | 1.00   |
| 1        | Sink - kitchen type  | 1.00       | 1.00   |
|          | Swimming pool - private - wading pool                        | 8.00       |        |
|          | Swimming pool - public - semi-public                         | 12.00      |        |
| 2        | Toilet   | 1.00       | 2.00   |
|          | Urinal   | 1.00       |        |
| 1        | Water distribution system, single family dwelling            | 4.00       | 4.00   |
|          | Water distribution system multiple dwg. \$4 + each unit      | 1.00       |        |
|          | Water distribution system, Group "A" thru "G" per each floor | 4.00       |        |
|          | Water distribution system, Group "H" (hotel) \$4 + per bath* | .50        |        |
| 1        | Water heater (gas) (electric)                                | 1.00       | 1.00   |
|          | Water using equipment  | 1.00       |        |
|          | Water softener nonpermanent type                             | 4.00       |        |
|          | Water softener permanent (connected to drainage)             | 5.00       |        |
|          | Wash tray  | 1.00       |        |

TOTAL FEE \$ 20.00

I hereby certify that I have carefully examined & read the above application; that the same is true & correct; and the work herein described is to be done in accordance with the provisions of City of Las Vegas Ordinances & State Laws, whether herein specified or not. \* As defined in City Code and Ordinances.

SIGNED: Col Date: \_\_\_\_\_  
Registered Plumber Spec. Cont'r. Owner

Engineering Dept. Date \_\_\_\_\_ Building Department Date 6-25-68  
Sewer Conn. Fee \$ \_\_\_\_\_  
Paid in Engr. Dept. PERMIT NO 24223 PERMIT FEE \$ 20.00  
23-10 #12870

RECEIPT  
1352 \$020.00 - 7  
CITY OF LAS VEGAS  
DEPT. OF BUILDING & SAFETY  
Must be machine validated  
24 JUN 68

D. Gatewood 1-29-79

**CITY OF LAS VEGAS, NEVADA**

**DEPARTMENT OF BUILDING & SAFETY - ELECTRICAL APPLICATION & PERMIT**

ADDRESS OF CONSTRUCTION: 2212 Brady OWNER'S NAME: Nevada Western

LOT(S) \_\_\_\_\_ BLOCK \_\_\_\_\_ SUBDIVISION \_\_\_\_\_ Type of bldg., SED  Apt.  Comm.

Check Proper Construction: New Bldg.  Addn.  Remodel  Temporary Pole  Old Bldg.

CONTRACTOR'S NAME: Cadenbach Electric STATE LICENSE # 8016 CITY LICENSE # 09013

| NUMBER | FIXTURE OR INSTALLATION                                 | UNIT PRICE |       |
|--------|---|------------|-------|
| 10     | Fixture or sockets                                      | .15        | 1.50  |
| 47     | Light, receptacle or switch outlet                      | .20        | 9.40  |
|        | Wall of ceiling space heater                            | .35        |       |
|        | Blast coil heater per kilowatt                          | .35        |       |
| 1      | Garbage grinder outlet                                  | .35        | .35   |
| 1      | Dishwasher outlet                                       | .35        | .35   |
|        | Clothes dryer outlet                                    | .35        |       |
| 1      | Automatic clothes washer                                | .35        | .35   |
|        | Electric range outlet                                   | .35        |       |
|        | Electric water heater outlet                            | .35        |       |
|        | Mercury arc lamp and equipment                          | .35        |       |
| 2      | Special purpose outlet                                  | .35        | .70   |
|        | X-ray unit and its apputenances                         | 5.00       |       |
|        | Watts of festoon lighting (Watts) First 3,000 watts     | 4.00       |       |
|        | for each additional thousand watts                      | 1.50       |       |
|        | Horsepower - all motors first horsepower or less        | 1.75       |       |
|        | for each additional horsepower                          | .35        |       |
|        | Temporary power and lights (temporary pole)             | 4.00       |       |
| 1      | Electric service (including any single meter socket)    | 3.00       | 3.00  |
|        | for each additional socket                              | .35        |       |
| 1      | Air conditioning service                                | 1.50       | 1.50  |
|        | amps  |            |       |
|        | Each KW (KVA) Generator (Transformer) (Welder) KW (KVA) | 2.00       |       |
|        | First 100 KVA - For each additional KW (KVA)            | .01        |       |
|        | Special inspection per hour                             | 4.00       |       |
|        | Speaker outlets   | .15        |       |
|        | Signal or Alarm outlets                                 | .15        |       |
|        | Amplifiers  | .50        |       |
|        | Control panels  | .25        |       |
| 1      | T. V. outlets - master system only                      | .15        |       |
|        | Radio outlets   | .15        |       |
|        | Main control racks                                      | 1.00       |       |
|        | T. V. and Radio antennas - master system only           | .75        |       |
|        | Minimum fee for any permit                              | 4.00       |       |
|        | Total fee   |            | 17.15 |

I hereby certify that I have carefully examined and read the above application; that the same is true and correct; and that the work herein described is to be done in accordance with all the provisions of the applicable Ordinances of the City of Las Vegas, Nevada and State laws whether herein specified or not.

SIGNED [Signature] Date \_\_\_\_\_  
MASTER (ELECTRICIAN) (TECHNICIAN) (OWNER)  
 BUILDING DEPARTMENT [Signature] Date 7-17-68  
 #1286 PERMIT NO. 25941 PERMIT FEE: \$ 17.15

RECEIPT  
 7435 \$017.15 - 6  
 CITY OF LAS VEGAS  
 DEPT. OF BUILDING & SAFETY  
 MUST BE MAILED TO LAS VEGAS

M. Gatewood 1-29-79

**CITY OF LAS VEGAS, NEVADA**  
**DEPARTMENT OF BUILDING & SAFETY - AIR CONDITIONING APPLICATION & PERMIT**

ADDRESS OF CONSTRUCTION: 2212 Brady, Las Vegas, Nevada OWNER'S NAME: Mortgage Services, Inc.  
 CIRCLE: New bldg. Old bldg.; Add'n; Remodel; TYPE OF BLDG. SFD APT. COMM.  
 CONTRACTOR'S NAME: Clark County Air Conditioning STATE LICENSE # 8133A CITY LICENSE # 1655

| UNITS            | HEATERS  | PRICE   | FEE  | UNITS                   | GAS   | PRICE   | FEE  |
|------------------|--|---------|------|-------------------------|---|---------|------|
|                  | Unit Heaters (floor, suspended & wall)                               | \$2.00  |      |                         | Gas piping system 1 to 5 outlets  | \$3.00  |      |
|                  | Floor Furnace  | \$3.00  |      |                         | Gas piping system over 5 outlets (per outlet)   | .20     |      |
|                  | Forced Air or Gravity Type under 100,000 BTU's                       | \$7.00  |      |                         | Swimming pool heater  | \$4.00  |      |
|                  | Steam or hot water heating system under 15 outlets (Boiler Excluded) | \$8.00  |      | VENTS                   |   |         |      |
|                  | Steam or hot water heating system 15 to 30 outlets (Boiler Excluded) | \$10.00 |      |                         | Combustion products vent other than chimney   | \$1.00  |      |
|                  | Each outlet over 30  | .50     |      |                         | Residential kitchen or bathroom vent each   | .25     |      |
|                  | Radiant type heating system under 1000 sq. ft. to be heated          | \$8.00  |      |                         | Commercial Hood   | \$4.00  |      |
|                  | Radiant type heating system 1000 to 2000 sq. ft. to be heated        | \$10.00 |      |                         | Ventilation system not a portion of any heating or air conditioning system up to \$1,000 valuation                            | \$5.00  |      |
|                  | Each additional 500 sq. ft. over 2000 sq. ft.                        | .50     |      | BOILER                  |   |         |      |
| AIR CONDITIONING |  |         |      |                         | Boiler installation 15 H.P. and under   | \$5.00  |      |
|                  | Heat pump or refrigerant 3 tons or less.                             | \$4.00  |      |                         | Boiler installation over 15 H.P.  | \$10.00 |      |
|                  | Heat pump or refrigerant 3 tons to 10 tons                           | \$6.00  |      | REPAIR                  |   |         |      |
|                  | Each addn. ton over 10 ton   | .50     |      |                         | Inspection of alteration or replacement of any mechanical cooling equipment which is a portion of any air conditioning system | \$3.00  |      |
| 1                | Refrigeration system 3 ton or less.                                  | \$5.00  | 5.00 | 8                       | DUCT WORK ONLY (each opening)   | .25     | 2.00 |
|                  | Refrigeration system 3 to 10 ton                                     | \$7.00  |      |                         | WATER TOWER   | \$4.00  |      |
|                  | Each addn. ton over 10 ton   | .50     |      |                         | MINIMUM PERMIT FEE  | \$4.00  |      |
|                  | Evaporative cooler 5 outlets and under                               | \$3.00  |      | TOTAL PERMIT FEE \$7.00 |   |         |      |
|                  | Evaporative cooler 5 to 10 outlets                                   | \$5.00  |      |                         |   |         |      |
|                  | Each addn. outlet over 10  | .25     |      |                         |   |         |      |

I hereby certify that I have carefully examined and read the above application; that the same is true and correct, and that the work herein described is to be done in accordance with all the provisions of the applicable Ordinances of the City of Las Vegas, Nevada and the State laws, whether herein specified or not.

SIGNED: A. J. Lawton Date: 7-12-68  
 AIR CONDITIONING CONTRACTOR - OWNER  
 BUILDING DEPARTMENT: G. W. ... Date: 7-17-68  
 #1289 PERMIT NO. 1629

RECEIPT  
 2481 \$007.00 - 4  
 CITY OF LAS VEGAS  
 DEPT. OF BUILDING & SAFETY  
 MUST BE MACHINE VALIDATED  
 17-18-68

D. Gatewood 1-29-79

CITY OF LAS VEGAS, NEVADA

LOG NO. & AREA

CONST. VAL. \$ 200.00

DEPARTMENT OF BUILDING & SAFETY

APPLICATION & BUILDING PERMIT — for:  
Fence, Wall, Retaining Wall.

ADDRESS OF CONSTRUCTION: 2212 Brady OWNER: Robt Shaw Const.

LOT(s) 1A BLOCK 1 SUBDIVISION Co. L. V. Ad. 3 Ua. 5A ZONE: R-1

Materials of Construction: Block  Concrete  Wire  Wood  Other  PLANS:   Yes No

ARCHITECT: ENGINEER: CALCS:

CONTRACTOR: Fortuna Fencing STATE LICENSE # 5906 A CITY LICENSE # 8489

TOTAL SQUARE FEET: 100 TOTAL LINEAL FEET: 100

Remarks:

CONDITIONS OF THE PERMIT:

1. Any type of retaining wall must be engineered by a Civil or Structural Engineer.
2. If a home owner takes out the Building Permit and if the owner sublets the work to a Contractor, then the Contractor must take out the permit and pay for it.
3. No fence or wall can be built on City property or rights-of-way, but this is not intended to preclude construction within utility easements if utilities will not be damaged or made inaccessible.
4. The fence or wall shall not enclose any water meter, light standard, or fire alarm box and shall not come closer than 24" from the nearest fire hydrant outlet.
5. Department Inspectors must approve footings before concrete is poured and block wall reinforcing before grouting is done.
6. Maximum height of any wall or fence is 6', side and rear yards; 4' maximum in front yard with the vertical surface above the height of 2' — 50% open and further that fencing within 25' of the intersection of curb faces on corner and through lots is limited to a maximum height of 30".
7. I must not obstruct required onsite parking space (1 space for each dwelling unit) by the erection of this fence or wall.
8. By the signing of this application I herewith agree to the requirements outlined above.

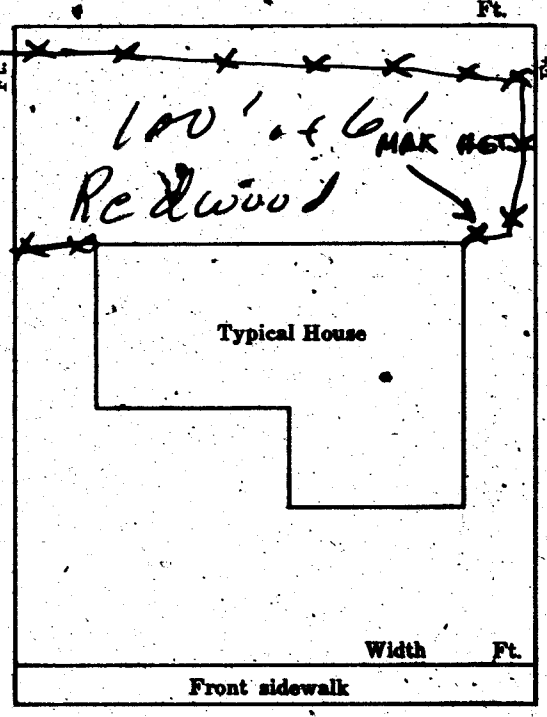

SIGNED: R. M. Gordon DATE: 8/6/68  
CONTRACTOR  AGENT  OWNER

PLANNING DEPT: [Signature] Date: 9-5-68

ENGINEERING DEPT: \_\_\_\_\_ Date: \_\_\_\_\_

BUILDING DEPT: G. W. [Signature] Date: 9-5-68

#12850 PERMIT NO: 44184 PERMIT FEE \$ 4.00

RECEIPT  
4598 \$004.00 - 8

CITY OF LAS VEGAS  
DEPT. OF BUILDING & SAFETY

MUST BE MACHINE VALIDATED  
- 5 SEP 68

*W. Gatewood P-29-779*

**CITY OF LAS VEGAS, NEVADA**

**DEPARTMENT OF BUILDING & SAFETY - APPLICATION AND PERMIT FOR PLUMBING**

ADDRESS OF CONSTRUCTION: 2012 Brady OWNER'S NAME: Odin Williams  
 CIRCLE: New Bldg.; Add'n.; Remodel; TYPE OF BLDG.: SFD. APT. PUBLIC COMM.  
 CONTRACTOR'S NAME: Tropicana Pools Inc. STATE LICENSE # 9444 CITY LICENSE # C11 171 2 07454

| UNITS                 | DESCRIPTION  | FEE   | TOTAL |
|-----------------------|--|-------|-------|
|                       | Bathtub  | 1.00  |       |
|                       | Shower   | 1.00  |       |
|                       | Lavatory   | 1.00  |       |
|                       | Toilet   | 1.00  |       |
|                       | Urinal   | 1.00  |       |
|                       | Floor Drain  | 1.00  |       |
|                       | Floor Sink   | 1.00  |       |
|                       | Wash Tray  | 1.00  |       |
|                       | Sink   | 1.00  |       |
|                       | Garbage Disposal                                       | 1.00  |       |
|                       | Garbage Disposal (comm.)                               | 3.00  |       |
|                       | Clothes Dryer (gas)                                    | 1.00  |       |
|                       | Clothes Washer   | 1.00  |       |
|                       | Clothes Washer (comm.)                                 | 5.00  |       |
|                       | Dishwasher   | 1.00  |       |
|                       | Dishwasher (commercial)                                | 5.00  |       |
|                       | Dental Unit  | 10.00 |       |
|                       | Drinking Fountain                                      |       |       |
|                       | Any Water using Equipment                              | 1.00  |       |
|                       | Water Heater (gas) (elect.)                            | 1.00  |       |
|                       | Sewer System - New, Replacement or any Drainage System |       |       |
|                       | Grease or Sand Trap                                    |       |       |
|                       | Trailer Trap   | 2.00  |       |
|                       | Septic Disposal System                                 | 4.00  |       |
| <b>WATER RETENERS</b> |  |       |       |
|                       | Nonpermanent   | 4.00  |       |
|                       | Permanent Type (connected to drainage)                 | 5.00  |       |
|                       | Private or Wading                                      | 10.00 |       |
|                       | Public or Semi-public                                  | 20.00 |       |

| UNITS  | DESCRIPTION                               | FEE   | TOTAL |
|--|---|-------|-------|
| <b>WATER DISTRIBUTION SYSTEM</b>               |   |       |       |
|  | Single Family Dwelling                    | 4.00  |       |
|  | Multiple Family Dwelling plus each unit   | 4.00  |       |
|  | Bldg. Group "A" thru "G" per each floor   | 2.00  |       |
|  | Hotel or Motel plus each bath             | 6.00  |       |
|  | Trailer Park                              | 4.00  |       |
|  | Trailer Park per each space               | 20.00 |       |
|  | Trailer Park per each space               | 1.00  |       |
|  | Trailer Park per each space               | 4.00  |       |
| <b>GAS PIPING SYSTEM</b>                       |   |       |       |
|  | Single Family Dwelling                    | 3.00  |       |
|  | Multiple Family Dwelling plus each unit   | 8.00  |       |
|  | Commercial Bldg. per floor plus each unit | 1.00  |       |
|  | Commercial Bldg. per floor plus each unit | 3.00  |       |
|  | Commercial Bldg. per floor plus each unit | 3.00  |       |
|  | Gas Appliance (any type)                  | 1.00  |       |
| <b>AUTOMATIC FIRE EXTINGUISHING SYSTEM</b>     |   |       |       |
|  | Underground Piping                        | 10.00 |       |
|  | Distribution Piping ea. ft.               | .01   |       |
|  | Sprinkler Head each                       | .10   |       |
|  | In Range Hood and Vent                    | 5.00  |       |
| <b>DRY STANDPIPE SYSTEM</b>                    |   |       |       |
|  | Piping                                    | 50.00 |       |
|  | Each Outlet                               | 1.00  |       |
| <b>WET STANDPIPE SYSTEM</b>                    |   |       |       |
|  | Piping                                    | 5.00  |       |
|  | Fire Hose Cabinet                         | 1.00  |       |
|  | MINIMUM PERMIT FEE                        | 4.00  |       |
| <b>PIPELINE CONTRACTOR; SECT. 14-B.P.F. \$</b> |   |       |       |
| <b>TOTAL PERMIT FEE \$</b>                     |   |       |       |

I hereby certify that I have carefully examined and read the above application; that the same is true and correct; and that the work herein described is to be done in accordance with all the provisions of the applicable Ordinances of the City of Las Vegas, Nevada and the State Laws, whether herein specified or not.

Approval for the work under this permit will be given only after refuse and debris have been removed from job site and public right of way.

Signed: [Signature] Date: 4/10/74  
 Registered Master Plumber, Spec. Cont'r. or Owner  
 Building Department: [Signature] Date: 4-10-74  
 Permit No. 13014 Permit Fee \$ 10.00

#12870

RECEIPT  
 433 504004 - 7  
 CITY OF LAS VEGAS  
 DEPARTMENT OF BUILDING & SAFETY  
 MUST BE MACHINE RECORDED

*M. Gatewood P-29-779*

**CITY OF LAS VEGAS, NEVADA**  
**DEPARTMENT OF BUILDING & SAFETY**  
**RECEIPT**  
**FOR**  
**SEWER CONNECTION**

JOB ADDRESS: 2012 Brady OWNER'S NAME: 1111

LOT \_\_\_\_\_ BLOCK \_\_\_\_\_ SUBDIVISION \_\_\_\_\_

| QUANTITY | OCCUPANCY        | UNIT FEE | AMOUNT       |
|----------|------------------|----------|--------------|
| <i>1</i> | <i>Swim Pool</i> |          | <i>37.50</i> |
|          |                  |          |              |
|          |                  |          |              |
|          |                  |          |              |
|          |                  |          |              |
|          |                  |          |              |
|          |                  |          |              |
|          |                  |          |              |
|          |                  |          |              |
|          |                  |          |              |

PAID BY: \_\_\_\_\_

TOTAL \_\_\_\_\_

Less Credit \_\_\_\_\_

TOTAL FEE \$ *37.50*

\*Credit for existing sewer is applied to the new sewer connection fee based on previous type of occupancy and only when the new occupancy requires an additional fee.

This receipt does not authorize the owner or his representative to start any work without obtaining a plumbing permit.

*Heri Brady*  
DEPARTMENT OF BUILDING & SAFETY

RECEIPT

NO. 100250

CITY OF LAS VEGAS  
DEPT. OF BUILDING & SAFETY

MAY BE MACHINE VALIDATED

672102

G. Gatewood B-29-779

**CITY OF LAS VEGAS, NEVADA**

**BUILDING AND SAFETY DEPARTMENT - APPLICATION AND PERMIT FOR SWIMMING POOL**

LOG No. M-133 Const. valuation \$ 3700<sup>00</sup>

ADDRESS OF CONSTRUCTION: 2012 Street OWNER'S NAME: W. W. Williams

LOT 178 BLOCK 8 SUBDIVISION Greater Las Vegas ZONE R-1

CIRCLE TYPE OF POOL THAT APPLIES: Private  Semi-public  Public

MATERIALS OF CONSTRUCTION: Reinforced granite  Reinforced concrete  Other

SQUARE FEET OF SURFACE AREA: 450 VOLUME IN GALLONS 1

ARCHITECT'S NAME: \_\_\_\_\_ OWNER NAME: \_\_\_\_\_

PLANS SUBMITTED: Yes  No  CALIBRATION SUBMITTED: Yes  No

CONTRACTOR'S NAME: Tropicana Pools Inc. License # 9656 City License # C11 171 2

ADDITIONAL PERMITS REQUIRED: Electrical  Plumbing  Other  Sewer fee req'd: Yes  No

I state that I am familiar with effective Ordinances of the City of Las Vegas, Nevada, and effective Statutes of the State of Nevada covering construction of the above type; I agree to perform said construction in conformity therewith. I further agree that issuance of a permit on above application will not excuse me from conforming with said Ordinances and Statutes despite any errors on the part of the Building Inspector or Engineer in checking plans and application herewith submitted.

All swimming pools must be fenced before the pool is filled with water. No electric lines shall go over a pool. I have read and understand the contents of above application; I hereby state that same are true and correct. I also agree to repair any utility line if damaged during excavating work.  
Signed: [Signature] 4/10/74  
(Contractor)  
By: Tropicana Pools Inc.  
(Agent or Owner)

**CITY SWIMMING POOL ORDINANCE**  
Applicant must have separate plot plan showing location of proposed or existing pool fencing and location of swimming pool.

The Contractor's signature above denotes authority from the owner to sign on his behalf and that the owner is aware of all requirements of this application. Separate permits must be obtained for electrical and plumbing work.

APPROVED BY:  
PLANNING DEPT. [Signature] DATE 4-10-74  
PUBLIC WORKS DEPT. [Signature] DATE 4-11-74  
BUILDING DEPT. [Signature] DATE 4-11-74  
PERMIT No. 1000

RECEIPT  
CITY OF LAS VEGAS  
BUILDING & SAFETY  
MAY BE MACHINE VALIDATED

*Angela L. Jackson 2/20/80*

DEPARTMENT OF BUILDING & SAFETY  
CITY OF LAS VEGAS, NEVADA

KARDEX CARD  
FENCE & RETAINING  
WALLS

OWNER Robert Shaw ADDRESS 2212 Brady DATE 9/5/68

CONTRACTOR Fortune Fencing PERMIT NO. 44188

LOT 14 BLOCK 1 SUBDIVISION Greater L. V. #3  
Wood

|  |  |  |  |
|--|--|--|--|
| Fence (wire, wood, etc.)               |  | Walls (masonry, rock, etc.)            |  |
| Location _____                         |  | Location _____                         |  |
| Final Inspection <u>9/10/68</u>        |  | Footing _____                          |  |
|  |  | Wall Steel 1st _____ 2d _____ 3d _____ |  |
|  |  | Final Inspection _____                 |  |
| Retaining Wall (masonry)               |  | Retaining Wall (concrete)              |  |
| Location _____                         |  | Location _____                         |  |
| Footing _____                          |  | Footing _____                          |  |
| Wall Steel 1st _____ 2d _____ 3d _____ |  | Wall Steel 1st _____ 2d _____ 3d _____ |  |
| Bond Beam 1st _____ 2d _____ 3d _____  |  | Final Inspection _____                 |  |
| Final Inspection _____                 |  |  |  |

23.14 B ADDRESS 2212 Brady LOG NO. \_\_\_\_\_ AREA \_\_\_\_\_

DEPT. of BLDG & SAFETY—CITY of LAS VEGAS, NEVADA  
OWNER NEV. WESTERN DEV. CORP. ADDRESS 2212 BRADY ST. DATE 5-24-68  
GEN CONT. ROBERT SHAW TYPE OF STRUCTURE S.F.D. WITH  
PERMIT NO. 12019 LEGAL DESCRIPTION Lot 14, Blk. 1, GIV. ADD. 3, UNITS A CAR

| BUILDING                                       | MECHANICAL                                  | ELECTRICAL                                  |
|--|---|---|
| LOCATION <u>2212 Brady</u>                     | PLUMBING CONT. <u>Clark Co.</u>             | TEMP. POLE CONT. _____                      |
| FIREPLACE FTS. _____                           | PERMIT NO. <u>24223</u> DATE <u>6-24-68</u> | PERMIT NO. _____ DATE _____                 |
| FOOTINGS <u>2-6-68</u>                         | HEAT & AC CONT. <u>Clark Co.</u>            | INSPECTION _____ DATE _____                 |
| FOUNDATION WALL _____                          | PERMIT NO. <u>16351</u> DATE <u>1-7-68</u>  | ELECTRICAL CONT. <u>Cadman</u>              |
| FLOOR FRAMING <u>2-6-68</u>                    | SEWER CONT. <u>NEV. WESTERN DEV. CORP.</u>  | PERMIT NO. <u>25741</u> DATE <u>7-12-68</u> |
| SLAB <u>2-6-68</u>                             | PERMIT NO. <u>23920</u> DATE <u>5-24-68</u> | FIXTURES CONT. _____                        |
| CHIMNEY STEEL (FIREPLACE) _____                | ROUGH SOIL <u>2-6-68</u>                    | PERMIT NO. _____ DATE _____                 |
| WALL STEEL _____                               | ROUGH WATER <u>2-6-68</u>                   | SLAB _____                                  |
| COLUMN STEEL _____                             | TOP-OUT <u>2-24-68</u>                      | ROUGH <u>2-23-68</u>                        |
| BEAM STEEL _____                               | ROUGH GAS <u>2-24-68</u>                    | FINAL ROUGH <u>2-24-68</u>                  |
| FRAMING <u>2-9-68</u>                          | AC ROUGH DUCT <u>2-24-68</u>                | FINAL FIXTURE <u>2-24-68</u>                |
| ROOF SHEATHING <u>2-24-68</u>                  | REF. ROUGH PIPING <u>2-24-68</u>            | FINAL ELECTRICAL <u>2-24-68</u>             |
| INTERIOR _____                                 | FINAL PLUMBING <u>2-24-68</u>               | TEMPORARY SERVICE _____                     |
| DRYWALL <u>2-24-68</u>                         | FINAL GAS <u>2-24-68</u>                    | MISCELLANEOUS _____                         |
| LATHING <u>2-24-68</u>                         | FINAL AIR COND. <u>2-24-68</u>              | GRADING & DRAINAGE _____                    |
| BACKING (SINGS) _____                          | FINAL REFRIG. <u>2-24-68</u>                | ON-SITE PARKING SPACES _____ APP. _____     |
| PLASTER <u>2-24-68</u>                         | FINAL SEWER <u>2-24-68</u>                  | ENG. APPROVAL OF _____                      |
| BROWN _____                                    | FINAL SEPTIC TANK _____                     | OFF-SITE IMPROVEMENTS _____                 |
| URBAN REDEVELOPMENT APPROVAL _____             |   |   |
| FINAL BLDG. <u>2-24-68</u> DATE <u>2-24-68</u> |   |   |

APPROVED FOR OCCUPANCY & METER 2-24-68 INSPECTOR \_\_\_\_\_ DATE \_\_\_\_\_

PLEASE NOTE REMARKS ON REVERSE SIDE 2212 BRADY ST. LOG # T-15/2 AREA # \_\_\_\_\_ 23.04

Angela L. Jackson 2/20/80

|  |                    |   |                  |
|--|--------------------|---|------------------|
| DEPARTMENT OF BUILDING & SAFETY<br>CITY OF LAS VEGAS, NEVADA |                    | KARDEX CARD<br>FENCE & RETAINING<br>WALLS |                  |
| OWNER  | Robert Shaw Const. | ADDRESS                                   | 2213 Brady       |
|  |                    | DATE                                      | 1/6/69           |
| CONTRACTOR   | FORTUNE FENCING    |   | PERMIT NO. 45555 |
| LOT  | 49                 | BLOCK                                     | 2                |
| SUBDIVISION  | Gr. Las Vegas #3   |   |                  |
| Fence (wire, wood, etc.)                                     |                    | WOOD FENCE                                |                  |
| Location   |                    | Walls (masonry, rock, etc.)               |                  |
| Final Inspection <i>R.H. 1-13-69</i>                         |                    | Location                                  |                  |
|  |                    | Footing                                   |                  |
|  |                    | Wall Steel 1st 2d 3d                      |                  |
|  |                    | Final Inspection                          |                  |
| Retaining Wall (masonry)                                     |                    | Retaining Wall (concrete)                 |                  |
| Location   |                    | Location                                  |                  |
| Footing  |                    | Footing                                   |                  |
| Wall Steel 1st 2d 3d   |                    | Wall Steel 1st 2d 3d                      |                  |
| Bond Beam 1st 2d 3d  |                    | Final Inspection                          |                  |
| Final Inspection   |                    |   |                  |
| 23.14 B  | ADDRESS            | LOG NO.                                   | AREA             |
|  | 2213 Brady         |   |                  |

?