

2416 BAY MEADOWS CR

LOT 49 BLK B NEW WEST #1 OF NEW ZONE R-1

Thomas Rankin 3-26-81

CITY OF LAS VEGAS, NEVADA

Permit

LOG NO. & AREA T23-3/00

CONST. VAL. \$ 40,363.00

DEPARTMENT OF PUBLIC SERVICES  
DIVISION OF BUILDING AND SAFETY

APPLICATION & BUILDING PERMIT for:  
Dwellings, Duplexes, Misc. Residential, Const.

ADDRESS OF CONSTRUCTION: 2416 BAY MEADOWS CIRCLE OWNER: NEW WEST LAND CORP

LOT(S): 49 BLOCK B SUBDIVISION NEW WEST #1 OF NEW ZONE: R-1

Existing structure on lot: Dwelling  Accessory Bldgs.  Vacant Lot  Other

PROPOSED CONSTRUCTION: S.F.D. MODEL # 1434 w/F.P. USE:

MATERIALS OF CONSTRUCTION: Wood Frame  Concrete Block  Reinforced Concrete  Steel Frame

LIVING AREA SQUARE FEET OF FLOOR AREAS: 1st 1434 SQ. FT. 2nd 486 SQ. FT. 3rd (Other) 27 TOTAL SQ. FT. 1945

FIRE ZONE: Occupancy Group R-3 CONST. TYPE: 5N

ARCHITECT: RAY BATES ENGINEER: ALCA ENG. NO. of UNITS NO. of STORIES 1

Plans Submitted: Yes  No  Calculations Submitted: Yes  No  Sewer Fee Req'd. Yes  No

CONTRACTOR: GATEWOOD CORP STATE LICENSE # 017399 CITY LICENSE #

ADD'L. PERMITS REQ'D.: Air Cond.  Elec.  Plumbing  Signs  Paving  Fence  Public Walks  Curb gutters   
Incinerator:  Fire Sprinkling System

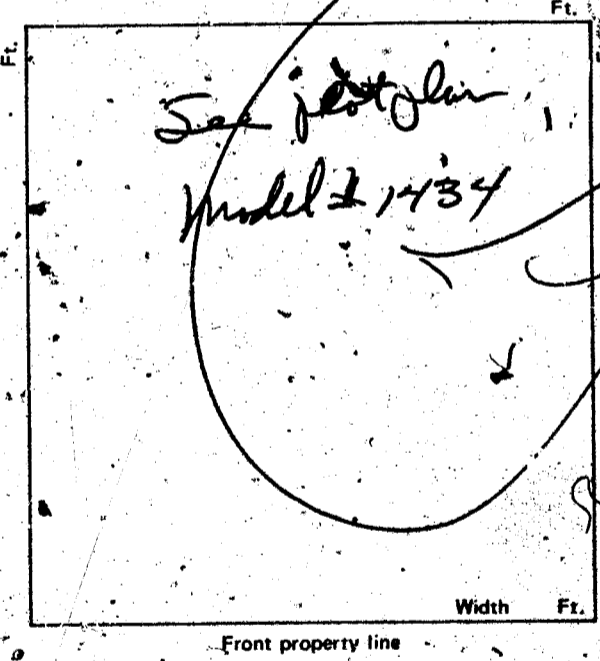

CONDITIONS OF THE PERMIT:

- I agree to call the City Building Department for inspections before concrete is poured, before rough wiring, electrical, plumbing, framing is covered. Also for Air conditioning, drywall and sheathing inspection.
- I agree that when the job is completed that I will call for final inspection before occupancy.
- I agree to perform all construction in accordance with City Ordinances and Building Codes.
- The Contractor's signature below denotes authority from the owner to sign in his behalf and that the owner is aware of all requirements of this application and permit. Separate permits must be taken out for work outlined above this agreement.
- I have read and understand the contents of this application and permit. I hereby state that the information I have supplied on this application is true and correct.

Approval for the work under this permit will be given only after refuse and debris have been removed from job site and public right of way.

SIGNED: GATEWOOD CORP Contractor  
BY: James C. Rankin - SECRETARY Agent or Owner

PLANNING DEPT.: [Signature] Date: 12/2/80  
PUBLIC WORKS DEPT.: [Signature] Date: 12/26/80  
BUILDING DIVISION: [Signature] Date: 12-26-80  
PERMIT NO.: 9702-28 PERMIT FEE \$ 182.00

1721-2401

RECEIPT

MUST BE MACHINE VALIDATED





# CITY OF LAS VEGAS, NEVADA

**DEPARTMENT OF PUBLIC SERVICES — AIR CONDITIONING APPLICATION & PERMIT**  
**DIVISION OF BUILDING AND SAFETY**

ADDRESS OF CONSTRUCTION: 2416 Bay Meadows Ct

OWNER'S NAME: Gatewood

CIRCLE: Addition; Remodel; New Bldg TYPE OF BLDG.: SFD APT. COMM. PUBLIC

CONTRACTOR'S NAME: Assured A/c

STATE LICENSE # 13980

CITY LICENSE # 19534

UNITS	DESCRIPTION	FEE	TOTAL
	<b>PERMIT ISSUANCE</b>		
1	For the issuance of each permit.	10.00	10.00
	For issuing each supplemental permit.	3.00	
	<b>UNIT FEE SCHEDULE</b>		
	For the installation or relocation of each forced-air or gravity-type furnace or burner, including ducts and vents attached to such appliance, up to and including 100,000 Btu/h.	6.00	
	For the installation or relocation of each forced-air or gravity-type furnace or burner, including ducts and vents attached to such appliance over 100,000 Btu/h.	7.50	
	For the installation or relocation of each floor furnace including vent.	6.00	
	For the installation or relocation of each suspended heater, recessed wall heater or floor-mounted unit heater.	6.00	
	For the installation, relocation or replacement of each appliance vent installed and not included in an appliance permit.	3.00	
	For the repair of, alteration of, or addition to each heating appliance, refrigeration unit, cooling unit, absorption unit, or each heating, cooling, absorption, or evaporative cooling system, including installation of controls regulated by this code.	6.00	
1	For the installation or relocation of each boiler or compressor to and including three horsepower, or each absorption system to and including 100,000 Btu/h.	6.00	6.00
	For the installation or relocation of each boiler or compressor over three horsepower to and including 15 horsepower, or each absorption system over 100,000 Btu/h and including 500,000 Btu/h.	11.00	
	For the installation or relocation of each boiler or compressor over 15 horsepower to and including 30 horsepower, or each absorption system over 500,000 Btu/h to and including 1,000,000 Btu/h.	15.00	
	For the installation or relocation of each boiler or compressor over 30 horsepower to and including 50 horsepower, or for each absorption system over 1,000,000 Btu/h to and including 1,750,000 Btu/h.	22.50	
	For the installation or relocation of each boiler or refrigeration compressor over 50 horsepower, or each absorption system over 1,750,000 Btu/h.	37.50	

UNITS	DESCRIPTION	FEE	TOTAL
	For each air-handling unit to and including 10,000 cubic feet per minute, including ducts attached thereto. Note: This fee shall not apply to an air-handling unit which is a portion of a factory assembled appliance, cooling unit, evaporative cooler or absorption unit for which a permit is required elsewhere in this code.	4.50	
	For each air-handling unit over 10,000 cfm.	7.50	
	For each evaporative cooler other than portable type.	4.50	
	For each ventilation fan connected to a single duct.	3.00	
	For each ventilation system which is not a portion of any heating or air-conditioning system authorized by a permit.	4.50	
	For the installation of each hood which is served by mechanical exhaust, including the ducts for such hood.	4.50	
	For the installation or relocation of each domestic-type incinerator.	7.50	
	For the installation or relocation of each commercial or industrial-type incinerator.	30.00	
	For each appliance or piece of equipment regulated by this code but not classed in other appliance categories, or for which no other fee is listed in this code.	4.50	
	When Chapter 22 is applicable (see Section 103), permit fees for fuel-gas piping shall be as follows: For each gas-piping system of one to four outlets.	2.00	
	For each gas-piping system of more than four outlets, per outlet.	.50	
	<b>OTHER INSPECTIONS AND FEES:</b>		
	Inspections outside of normal business hours (minimum charge — two hours).	15.00 per hour	
	Reinspection fee assessed under provisions of Section 305 (1).	15.00 each	
	Inspections for which no fee is specifically indicated (minimum charge — one-half hour).	15.00 per hour	
	Additional plan review required by changes, additions or revisions to approved plans (minimum charge — one-half hour).	15.00 per hour	
	<b>TOTAL PERMIT FEE \$</b> <u>16.00</u>		

I hereby certify that I have carefully examined and read the above application; that the same is true and correct; and that the work herein described is to be done in accordance with all the provisions of the applicable Ordinances of the City of Las Vegas, Nevada and the State Laws, whether herein specified or not.

Approval for the work under this permit will be given only after refuse and debris have been removed from job site and public right of way.

SIGNED: Kim A. Raymond Date: 7/2/81  
 Air Conditioning Contractor Owner

BUILDING DIVISION: lc Date: 7-7-81

PERMIT NO. 2539-23 PERMIT FEE \$ 16.00

**RECEIPT**

OWNER New West Land Corp ADDRESS 2416 Bay Meadows

DATE 3-24-81 GEN. CONT. Gatewood Corp

SFD w/fireplace 9752-28

TYPE OF STRUCTURE PERMIT NO. FINAL INSPECTION

L 49 B B New West #1 LOG # T23 AREA # 3/80

LEGAL DESCRIPTION

APPROVED FOR OCCUPANCY & METER

BUILDING	MECHANICAL
Investigation	Plumbing Cont. <u>Hynds pl</u>
Location & Footing <u>FC 5-26-81</u>	Permit No. <u>1765</u> Date <u>6-4-81</u>
Concrete Slab Floor <u>FC 6-12-81</u>	Heat & Vent. A/C Cont. <u>Commed</u>
Fireplace Footing <u>FC 6-17-81</u>	Permit No. <u>2534-23</u> Date <u>7-2-81</u>
Chimney Steel	Sewer Cont. <u>Gatewood Corp</u>
Vert. Steel Reinf.	Permit No. <u>9752</u> Date <u>12/24/80</u>
Horiz. Steel Reinf.	Rough Soil <u>2-6-81</u>
Framing <u>FC 7-24-81</u>	Rough Water
Ext. Lath <u>FC 7-27-81</u>	Top-Out <u>8-27-22-81</u>
Ext. Brown <u>FC 9-31-81</u>	Rough Gas <u>8-27-22-81</u>
Drywall <u>FC 9-30-81</u>	A/C Rough Duct <u>8-27-22-81</u>
Final Building <u>FC 11-9-81</u>	Final Plumbing <u>8-29-26-81</u>
Appr. for Occu.	Final Gas <u>8-29-26-81</u>
<b>ELECTRICAL</b>	Final Air Cond <u>8-29-26-81</u>
Temp. Pole Cont.	Final Sewer <u>8-27-20-81</u>
Permit No. _____ Date _____	<b>REMARKS</b>
Inspection _____ Date _____	
Electrical Cont. <u>Stutten plw</u>	
Permit No. <u>24514</u> Date <u>7-1-81</u>	
Rough <u>2-5-7-81</u>	PLEASE NOTE ADDITIONAL REMARKS ON REVERSE SIDE.
Final Rough	DIV OF BLDG & SAFETY
Final Electrical <u>08-10-81</u>	CITY OF LAS VEGAS
Temporary Service	REV. 10-78
	79-3-16

Roof sheeting v H 7-1-57

Manhattan 7c 7-27-57

Sheet 82

OWNER New West Land Corp ADDRESS 2416 Bay Meadows

DATE 3-24-81 GEN. CONT. Gatewood Corp

TYPE OF STRUCTURE SFD w/Fireplace PERMIT NO. 9752-28

LEGAL DESCRIPTION L 49 B B New West #1 LOG # T23 AREA # 3/80

APPROVED FOR OCCUPANCY & METER

BUILDING	MECHANICAL
Investigation	Plumbing Cont. <u>Hyneda p/h</u>
Location & Footing <u>FC 5-26-81</u>	Permit No. <u>1765</u> Date <u>6-4-81</u>
Concrete Slab Floor <u>FC 6-12-81</u>	Heat & Vent. A/C Cont. <u>Assured</u>
Fireplace Footing <u>FC 6-19-81</u>	Permit No. <u>2539-23</u> Date <u>7-22-81</u>
Chimney Steel	Sewer Cont. <u>Gatewood Corp</u>
Vert. Steel Reinf.	Permit No. <u>9752</u> Date <u>12/24/80</u>
Horiz. Steel Reinf.	Rough Soil <u>2-6-5-81</u>
Framing <u>FC 7-24-81</u>	Rough Water
Ext. Lath <u>FC 7-27-81</u>	Top-Out <u>9-7-22-81</u>
Ext. Brown <u>FC 9-31-81</u>	Rough Gas <u>9-22-81</u>
Drywell <u>FC 9-30-81</u>	A/C Rough Duct <u>9-22-81</u>
Final Building <u>FC 11-9-81</u>	Final Plumbing <u>9-16-81</u>
Appr. for Occu.	Final Gas <u>9-16-81</u>
ELECTRICAL	Final Air Cond. <u>9-16-81</u>
Temp. Pole Cont.	Final Sewer <u>9-22-81</u>
Permit No. _____ Date _____	REMARKS
Inspection _____ Date _____	
Electrical Cont. <u>Stratton p/h</u>	
Permit No. <u>2451-1</u> Date <u>7-1-81</u>	
Rough <u>JRS 7-20-81</u>	PLEASE NOTE ADDITIONAL REMARKS ON REVERSE SIDE.
Final Rough	DIV. OF BLDG. & SAFETY
Final Electrical <u>9-10-5-81</u>	CITY OF LAS VEGAS
Temporary Service	REV. 10-78
	79-3-16

Roof sheathing v H 9-187  
Insulation 7c 7-27-87

Yolanda B. Williams 8/4/89

Chilton



DEPARTMENT OF PUBLIC WORKS  
FLOOD CONTROL DIVISION  
400 Stewart Avenue  
Las Vegas, Nv 89101

Gentlemen:

Please issue a statement to us as to whether or not the following property is located in a flood hazard area.

The address of the subject property is: ~~1414 S. Maryland Circle~~  
Las Vegas, Nevada 89108

The legal description is: NEW WEST #1  
Lot 49, Block B

COMPLETE THE FOLLOWING

The above described property is \_\_\_\_\_ is not  located in a "A" flood hazard area.

Per Map # 325276-00200 (ZONE C)

Map Effective Date OCT. 18, 1983

Seymour Novak  
SIGNATURE

ENGR. DESIGNER  
TITLE

2-27-86  
DATE

VL

Fleet Mortgage Corp. 1100 East Sahara Avenue, Almond Tree, Suite 204, Las Vegas, Nevada 89104-3226 702-735-8135  
A Member of Fleet Financial Group

Seymour Novak