

4332 W Bonanza

Tot 4 BLK 7 CHARLESTON ESTATES #2-D ZONE R-1

1967
CITY OF LAS VEGAS, NEVADA

LOG NO. & AREA _____

CONST. VAL. \$ 57⁰⁰

DEPARTMENT OF BUILDING & SAFETY

APPLICATION & BUILDING PERMIT — for:
Fence, Wall, Retaining Wall.

ADDRESS OF CONSTRUCTION: 4332 W. BONANZA ROAD

OWNER: CHARLES E. GRIGSBY

LOT(S) 4 BLOCK 7 SUBDIVISION CHARLES JON ESTATES # 2 D

ZONE: R-1

Materials of Construction: Block Concrete Wire Wood Other

Yes No
PLANS:
CALCS:

ARCHITECT: _____

ENGINEER: _____

CONTRACTOR: ~~_____~~

STATE LICENSE # _____

CITY LICENSE # _____

Owner

TOTAL SQUARE FEET: _____

TOTAL LINEAL FEET: _____

Remarks:

CONDITIONS OF THE PERMIT:

- Any type of retaining wall must be engineered by a Civil or Structural Engineer.
- If a home owner takes out the Building Permit and if the owner sublets the work to a Contractor, then the Contractor must take out the permit and pay for it.
- No fence or wall can be built on City property or rights-of-way, but this is not intended to preclude construction within utility easements if utilities will not be damaged or made inaccessible.
- The fence or wall shall not enclose any water meter, light standard, or fire alarm box and shall not come closer than 24" from the nearest fire hydrant outlet.
- Department Inspectors must approve footings before concrete is poured and block wall reinforcing before grouting is done.
- Maximum height of any wall or fence is 6', side and rear yards; 4' maximum in front yard with the vertical surface above the height of 2' — 50% open and further that fencing within 25' of the intersection of curb faces on corner and through lots is limited to a maximum height of 30".
- I must not obstruct required onsite parking space (1 space for each dwelling unit) by the erection of this fence or wall.
- By the signing of this application I herewith agree to the requirements outlined above.

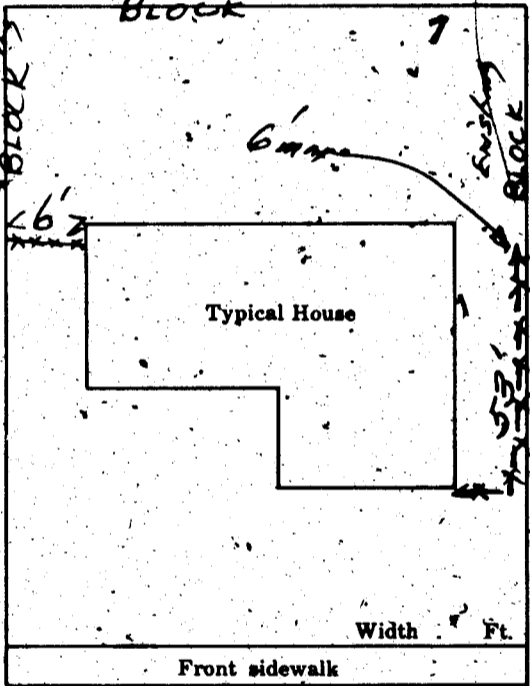

SIGNED: Mr. Charles E. Grigsby DATE: _____

CONTRACTOR AGENT OWNER

PLANNING DEPT: _____

Date: 2/21/67

ENGINEERING DEPT: _____

Date: _____

BUILDING DEPT: Janet Meyer

Date: 3-21-67

#1285

PERMIT NO: 36532

PERMIT FEE \$ 3⁰⁰

RECEIPT

JPM \$003.00 - 8

CITY OF LAS VEGAS
DEPT. OF BUILDING & SAFETY

MUST BE MACHINE VALIDATED

21 MAR 67

CITY OF LAS VEGAS, NEVADA
DEPARTMENT OF BUILDING & SAFETY

1968

PERMIT FEE \$ 4.00

APPLICATION & PERMIT FOR
PLUMBING

JOB ADDRESS: 4332 West Bonanza Road NAME: Charles Grigsby

LOT BLOCK SUBDIVISION Bldg. type: SFD APT COMM
Circle: New bldg; Old bldg; Add'n; Remodel; Pool; Wtr. Sftner; (Lawn Sprkr); Other

CONTRACTOR: Owner State Lic.# City Lic.#

QUANTITY	FIXTURE OR INSTALLATION	Unit Price	AMOUNT
	Bathtub	1.00	
	Clothes dryer (gas)	1.00	
	Clothes washer	1.00	
	Dental unit	1.00	
	Dishwasher	1.00	
	Drinking fountain	1.00	
	Fire sprinkling - underground piping	5.00	
	Fire sprinkling - distribution piping per each foot	.01	
	Fire sprinkling heads - per each head	.10	
	Floor drain \$1.00 Floor sink	1.00	
	Gas appliance (any type)	1.00	
	Gas piping system - single family dwelling	3.00	
	Gas piping system - multiple family \$3 per each unit plus	1.00	
	Gas piping system - commercial bldg. per each floor	3.00	
	Grease trap	1.00	
X	Irrigation system	4.00	4.00
	Lavatory	1.00	
	Minimum fee for any permit	4.00	
	Piping, Drainage	4.00	
	Sewer replacement	4.00	
	Septic disposal system - Health Dept. approval required	4.00	
	Shower	1.00	
	Sink - kitchen type	1.00	
	Swimming pool - private - wading pool	8.00	
	Swimming pool - public - semi-public	12.00	
	Toilet	1.00	
	Urinal	1.00	
	Water distribution system, single family dwelling	4.00	
	Water distribution system multiple dwg. \$4 + each unit	1.00	
	Water distribution system, Group "A" thru "G" per each floor	4.00	
	Water distribution system, Group "H" (hotel) \$4 + per bath*	.50	
	Water heater (gas) (electric)	1.00	
	Water using equipment	1.00	
	Water softener nonpermanent type	4.00	
	Water softener permanent (connected to drainage)	5.00	
	Wash tray	1.00	

I hereby certify that I have carefully examined & read the above application; that the same is true & correct; and the work herein described is to be done in accordance with the provisions of City of Las Vegas Ordinances & State Laws, whether herein specified or not. * As defined in City Code and Ordinances.

TOTAL FEE \$ 4.00

SIGNED: *Charles Grigsby* 1/25/68
Registered Plumber Spec Contr Owner

James W. Meyer 1/25/68
Building Department Date

Engineering Dept. Date Sewer Conn. Fees 22760 PERMIT NO. 4.00
Paid in Engr. Dept. #12870 PERMIT FEE \$ 4.00

RECEIPT 3004.00 - 7
CITY OF LAS VEGAS
DEPT OF BUILDING & SAFETY

Must be machine validated

Angela Jackson

DEPT. of BLDG & SAFETY—CITY of LAS VEGAS, NEVADA

OWNER Executive Associates ADDRESS 4332 Bonanza Road DATE 6/12/63
 GEN. CONT. John Bangle TYPE OF STRUCTURE block fence
 PERMIT NO. 20428 LEGAL DESCRIPTION _____

BUILDING		MECHANICAL	ELECTRICAL
LOCATION _____		PLUMBING CONT. _____	TEMP. POLE CONT. _____
FIREPLACE FTS. _____		PERMIT NO. _____ DATE _____	PERMIT NO. _____ DATE _____
FOOTINGS _____		HEAT & VENT. AC CONT. _____	INSPECTION _____ DATE _____
FOUNDATION, WALL _____		PERMIT NO. _____ DATE _____	ELECTRICAL CONT. _____
FLOOR FRAMING _____		SEWER CONT. _____	PERMIT NO. _____ DATE _____
SLAB _____		PERMIT NO. _____ DATE _____	FIXTURES CONT. _____
CHIMNEY STEEL (FIREPLACE) _____		ROUGH SOIL _____	PERMIT NO. _____ DATE _____
WALL STEEL _____		ROUGH WATER _____	SLAB _____
COLUMN STEEL _____		TAP-OUT _____	ROUGH _____
BEAM STEEL _____		ROUGH GAS _____	FINAL ROUGH _____
FRAMING _____		AC ROUGH DUCT _____	FINAL FIXTURE _____
ROOF SHEATHING _____		REF. ROUGH PIPING _____	FINAL ELECTRICAL _____
INTERIOR _____ EXTERIOR _____		FINAL PLUMBING _____	TEMPORARY SERVICE _____
DRYWALL _____		FINAL GAS _____	MISCELLANEOUS
LATHING _____		FINAL AIR COND. _____	
BACKING (SPONGE) _____		FINAL REFR. _____	
PLASTER SCRATCH _____		FINAL SEWER _____	
PLASTER BROWN _____		FINAL SEPTIC TANK _____	
URBAN REDEVELOPMENT APPROVAL _____			GRADING & DRAINAGE _____
FINAL BLDG. <u>INSPECTED</u> DATE <u>4-3-63</u>			ON-SITE PARKING SPACES _____ APP. _____
			ENS. APPROVAL OF _____
			OFF-SITE IMPROVEMENTS _____

APPROVED FOR OCCUPANCY & METER _____ INSPECTOR _____ DATE _____

PLEASE NOTE REMARKS ON REVERSE SIDE

LOG # _____ AREA # _____ 23.04

4332 Bonanza Road

**DEPARTMENT OF BUILDING & SAFETY
CITY OF LAS VEGAS, NEVADA**

**KARDEX CARD
FENCE & RETAINING
WALLS**

OWNER Chas. E. Grigsby ADDRESS 4332 West Bonanza DATE 3/21/67
 CONTRACTOR Owner PERMIT NO. 36532
 LOT 4 BLOCK 7 SUBDIVISION Chas Est # 20

Fence (wire, wood, etc.)	Walls (masonry, rock, etc.)
Location _____	Location _____
Final Inspection <u>Walt Subject 3-28-67</u>	Footings _____
	Wall Steel 1st _____ 2d _____ 3d _____
	Final Inspection _____
Retaining Wall (masonry)	Retaining Wall (concrete)
Location _____	Location _____
Footings _____	Footings _____
Wall Steel 1st _____ 2d _____ 3d _____	Wall Steel 1st _____ 2d _____ 3d _____
Bond Beam 1st _____ 2d _____ 3d _____	Final Inspection _____
Final Inspection _____	

23.14 B

ADDRESS 4332 AREA _____

Wayne Jackson

DEPT. of BLDG & SAFETY - CITY of LAS VEGAS, NEVADA
 OWNER: Executive Associate ADDRESS 4332 Bonanza Rd. West DATE 10-22-62
 GEN. CONT. John Bangle TYPE OF STRUCTURE SED
 PERMIT NO. 13526 LEGAL DESCRIPTION Lot 4 block 7 Charleston Estates #2-D

BUILDING	MECHANICAL	ELECTRICAL
LOCATION <u>WS 10-20-62</u>	PLUMBING CONT. <u>WJ 8721</u>	TEMP. POLE CONT. _____
FIREPLACE FTS. _____	PERMIT NO. <u>8721</u> DATE <u>12-12-62</u>	PERMIT NO. _____ DATE _____
FOOTINGS <u>WS 10-26-62</u>	HEAT & VENT. AC CONT. <u>Wilson</u>	INSPECTION _____ DATE _____
FOUNDATION WALL <u>WS 12-27-62</u>	PERMIT NO. <u>2341</u> DATE <u>1-16-63</u>	ELECTRICAL CONT. <u>Nutida</u>
STEM WALL _____	SEWER CONT. _____	PERMIT NO. <u>9106</u> DATE <u>11-15-62</u>
FLOOR FRAMING _____	PERMIT NO. _____ DATE _____	FIXTURES CONT. <u>Nutida</u>
SLAB _____	ROUGH SOIL <u>Laudon 12-5-62</u>	PERMIT NO. <u>9106</u> DATE <u>11-15-62</u>
CHIMNEY STEEL (FIREPLACE) <u>WS 12-5-62</u>	ROUGH WATER <u>Laudon 12-5-62</u>	SLAB _____
WALL STEEL _____	TOP-OUT <u>Laudon 1-15-63</u>	ROUGH <u>West 1-8-63</u>
COLUMN STEEL _____	ROUGH GAS _____	FINAL ROUGH _____
BEAM STEEL _____	AC ROUGH DUCT <u>Laudon 1-16-63</u>	FINAL FIXTURE _____
STEEL FABRICATION _____	REF. ROUGH PIPING _____	TEMPORARY SERVICE _____
FRAMING _____	FINAL PLUMBING <u>WJ 33-28-63</u>	
ROOF SHEATHING _____	FINAL GAS _____	MISCELLANEOUS
DRYWALL _____	FINAL AIR COND. <u>WJ 33-28-63</u>	URBAN REDEVELOPMENT APPROVAL _____
LATHING _____	FINAL REFRIG _____	<input type="checkbox"/>
BACKING (SCREWS) _____	FINAL SEWER <u>WJ 2-14-63</u>	GRADING & DRAINAGE _____
PLASTER, SCRATCH _____	FINAL SEPTIC TANK _____	ON-SITE PARKING SPACES _____ APP. _____
PLASTER, BROWN _____		ENG APPROVAL OF _____
FINAL BLDG _____ DATE <u>1-17-63</u>		OFF-SITE IMPROVEMENTS _____

APPROVED FOR OCCUPANCY 1-17-63 INSPECTOR Sweetbert DATE _____
 APPROVED FOR METER 10-15-63
 PLEASE NOTE REMARKS ON REVERSE SIDE

4332 Bonanza Rd. LDG # T 58 AREA # 3 23.06
 4332 (Owner)

Department of Building & Safety City of Las Vegas, Nevada Special Kardex Elec. only, Plbg. only, A.C. only

Owner Charles Girgsby Address 4332 West Bonanza Road Date: 1-25-68
 Contractor _____ Permit No. _____
 Lot _____ Block _____ Subdivision _____

Electric Only	Plumbing Only	Heat & Vent. A. C. Only
Contractor _____	Contractor <u>Owner</u>	Contractor _____
Permit No. _____	Permit No. <u>22760</u>	Permit No. _____
Slab _____	Rough Soil _____	A.C. Rough Duct _____
Rough Elect _____	Rough Water _____	Ref. Ro. Piping _____
Final Rough _____	Top Out _____	Rough Gas _____
Final Fixture _____	Rough Gas _____	Final Refrig _____
Final Elec _____	Final Plbg. <u>WJ 2-15-68</u>	Final Air Cond _____
Temp. Service _____	Final Gas _____	Final Gas _____
	Final Sewer _____	
	Final Septic Tank _____	

23.06 D Address 4332 West Bonanza Log No. _____ Area irrigation system