

404 BONANZA WAY

Lot 1 B1 Biltmore Add #2 Zone R-1

G. Gatewood 7-24-71

CITY OF LAS VEGAS, NEVADA

LOG NO. & AREA

CONST. VAL. \$ 300.00

DEPARTMENT OF BUILDING & SAFETY

APPLICATION & BUILDING PERMIT - Fence, Wall, Retaining Wall

ADDRESS OF CONSTRUCTION: 404 Bonanza Alley

OWNER: Jack Underwood

LOT(s): 1

BLOCK: 1

SUBDIVISION: BILTINGRE ADDITION #2

ZONE: R1

Materials of Construction:

Block

Concrete

Wire

Wood

Other

Yes

No

PLANS:

ARCHITECT:

ENGINEER:

CALCS:

CONTRACTOR: Ac. Masonry, Inc.

STATE LICENSE #

CITY LICENSE #

TOTAL SQUARE FEET: 300

TOTAL LINEAL FEET: 50

Remarks table with 4 rows and 1 column.

CONDITIONS OF THE PERMIT:

- 1. Any type of retaining wall must be engineered by a Civil or Structural Engineer.
2. If a home owner takes out the Building Permit and if the owner submits the work to a Contractor, then the Contractor must take out the permit and pay for it.
3. No fence or wall can be built on City property or rights of way, but this is not intended to preclude construction within utility easements if utilities will not be damaged or made inaccessible.
4. The fence or wall shall not enclose any water meter, light standard, or fire alarm box and shall not come closer than 24" from the nearest fire hydrant outlet.
5. Department inspectors must approve footings before concrete is poured and block wall/reinforcing before grouting is done.
6. Maximum height of any wall or fence is 6', side and rear yards; 4' maximum in front yard with the vertical surface above the height of 2' - 50% open.
7. I must not obstruct required onsite parking space (1 space for each dwelling unit) by the erection of this fence or wall.
8. By the signing of this application I herewith agree to the requirements outlined above.

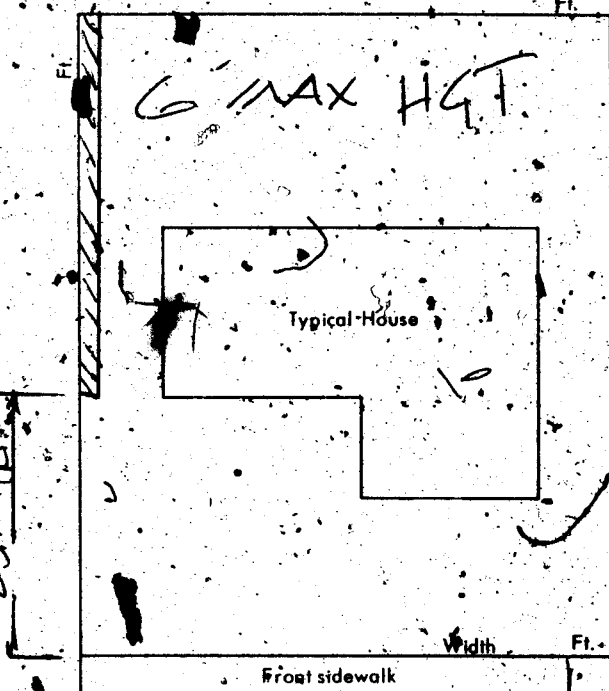

SIGNED: [Signature]

DATE: 5-14-71

CONTRACTOR AGENT OWNER

PLANNING DEPT. [Signature]

Date: 5-14-71

PUBLIC WORKS DEPT. [Signature]

Date: 5-14-71

BUILDING DEPT. [Signature]

Date: 5-14-71

#12850

PERMIT NO.: 60314

PERMIT FEE \$ 500

RECEIPT form with fields for amount (\$500.00) and date (MAY 71).

Russell Jackson 1/26/71

DEPARTMENT OF BUILDING & SAFETY
CITY OF LAS VEGAS, NEVADA

KARDEX CARD
FENCE & RETAINING
WALLS

OWNER Jack Underwood

ADDRESS 404 Bonanza Way

DATE 5/14/71

CONTRACTOR Ace Masonry

PERMIT NO. 60314

LOT 1 BLOCK 1 SUBDIVISION Biltmore Add

Block fence	
Fence (wire, wood, etc.)	Walls (masonry, rock, etc.)
Location _____	Location _____
Final Inspection _____	Footing _____
	Wall Steel 1st _____ 2d _____ 3d _____
	Final Inspection _____
Retaining Wall (masonry)	Retaining Wall (concrete)
Location _____	Location _____
Footing _____	Footing _____
Wall Steel 1st _____ 2d _____ 3d _____	Wall Steel 1st _____ 2d _____ 3d _____
Bond Beam 1st _____ 2d _____ 3d _____	Final Inspection _____
Final Inspection _____	

Pulled 6-14-71

23.14 B

ADDRESS 404 Bonanza Way

LOG NO. _____

AREA _____

404 BONANZA WAY

Lot 1 B1 Biltmore Add #2 Zone R-1

CITY OF LAS VEGAS, NEVADA

LOG NO. & AREA

DEPARTMENT OF BUILDING & SAFETY

CONST. VAL: \$ 300

APPLICATION & BUILDING PERMIT - for: Fence, Well, Retaining Wall.

ADDRESS OF CONSTRUCTION:

404 Bonanza Way

OWNER:

Jack Underwood

LOT(s)

BLOCK

SUBDIVISION

BILTMORE ADDITION #2

ZONE: R1

Materials of Construction:

Block

Concrete

Wire

Wood

Other

Yes No

PLANS:

ARCHITECT:

ENGINEER:

CALCS:

CONTRACTOR:

Ac. Masonry Sew

STATE LICENSE #

CITY LICENSE #

TOTAL SQUARE FEET: 300

TOTAL LINEAL FEET: 50

Remarks:

CONDITIONS OF THE PERMIT:

- Any type of retaining wall must be engineered by a Civil or Structural Engineer.
- If a home owner takes out the Building Permit and if the owner sublets the work to a Contractor, then the Contractor must take out the permit and pay for it.
- No fence or wall can be built on City property or rights of way, but this is not intended to preclude construction within utility easements if utilities will not be damaged or made inaccessible.
- The fence or wall shall not enclose any water meter, light standard, or fire alarm box and shall not come closer than 24" from the nearest fire hydrant outlet.
- Department Inspectors must approve footings before concrete is poured and block wall reinforcing before grouting is done.
- Maximum height of any wall or fence is 6' side and rear yards; 4' maximum in front yard with the vertical surface above the height of 2' - 50% open.
- I must not obstruct required onsite parking space (1 space for each dwelling unit) by the erection of this fence or wall.
- By the signing of this application herewith agree to the requirements outlined above.

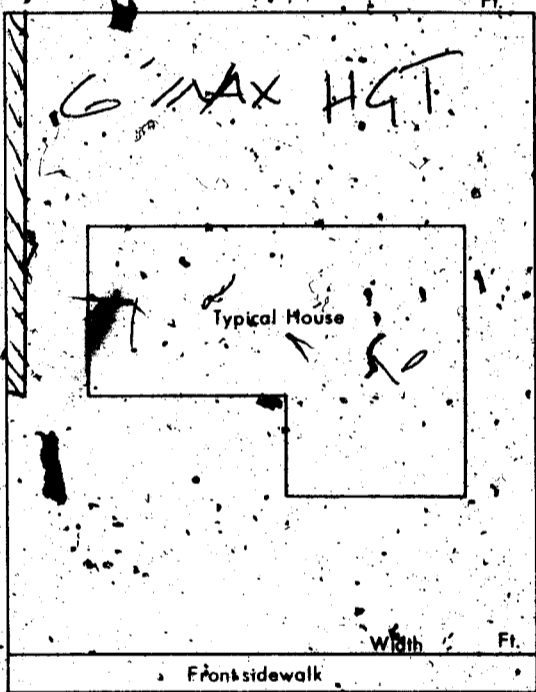

SIGNED:

Alan Bell

DATE: 5-14-71

CONTRACTOR AGENT OWNER

PLANNING DEPT. *[Signature]*

Date: 5-14-71

PUBLIC WORKS DEPT. *[Signature]*

Date: 5-14-71

BUILDING DEPT. *[Signature]*

Date: 5-14-71

#12850

PERMIT NO.:

60314

PERMIT FEE \$

500

RECEIPT

36 \$005.00 - 8

CITY OF LAS VEGAS DEPT. OF BUILDING & SAFETY

MUST BE MACHINE VALIDATED

14 MAY 71

Boyle Jackson 1/26/81

DEPARTMENT OF BUILDING & SAFETY
CITY OF LAS VEGAS, NEVADA

KARDEX CARD
FENCE & RETAINING

OWNER Jack Underwood

ADDRESS 404 Bonanza Way

WALLS DATE 5/14/71

CONTRACTOR Ace Masonry

PERMIT NO. 60314

LOT 1 BLOCK 1 SUBDIVISION Baltimore Add

Block fence

Fence (wire, wood, etc.)

Walls (masonry, rock, etc.)

Location _____
Final Inspection _____

Location _____
Footing _____
Wall Steel 1st _____ 2d _____ 3d _____
Final Inspection _____

Retaining Wall (masonry)

Retaining Wall (concrete)

Location _____
Footing _____
Wall Steel 1st _____ 2d _____ 3d _____
Bond Beam 1st _____ 2d _____ 3d _____
Final Inspection _____

Location _____
Footing _____
Wall Steel 1st _____ 2d _____ 3d _____
Final Inspection _____

Revised 6-14-72

23.14 B

ADDRESS 404 Bonanza Way

LOG NO.

AREA