

A. *6229 Blossomwood
B. **6233 Blossomwood

*Perimeter wall/see
6012 Heather Mist
** ~~3016~~ Fern Hollow

CONTRACTOR R/S Development STATE LICENSE NO. 18769 GARAGE 100 PORCH 210 TOTAL 2220
 ARCHITECT Kevin Thistle ENGINEER EST CITY LICENSE NO. 011-02373-2-
 MASTER PLUMBER/CONTRACTOR MASTER ELECTRICIAN/CONTRACTOR 033804

OTHER INSPECTIONS AND FEES

1. Inspections outside of normal business hours = \$30.00 per hour (minimum charge three hours)
2. Re-inspection fee during normal business hours assessed under provisions of TABLE 3-A of the Uniform Building Code = \$30.00 per hour
3. Inspections during normal business hours for which no fee is specifically indicated = \$30.00 per hour (minimum charge one half hour)
4. Additional Plan review required by changes, additions or revisions to approved plans = \$30.00 per hour (minimum charge two hours)

CONDITIONS OF THE PERMIT:

1. I agree to call the City Building Department for inspections before concrete is poured, before rough wiring, electrical, plumbing, framing is covered. Also for air conditioning, drywall and sheathing inspection.
2. I agree that when the job is completed that I will call for final inspection before occupancy.
3. I agree to perform all construction in accordance with City Ordinances and Building Codes.
4. The Contractor's signature below denotes authority from the owner to sign in his behalf and that the owner is aware of all requirements of this application and permit. Separate permits must be taken out for work outlined above this agreement.
5. I have read and understand the contents of this application and permit. I hereby state that the information I have supplied on this application is true and correct.
6. Approval for the work under this permit will be given only after refuse and debris have been removed from job site and public right-of-way.
7. 24 HOUR MINIMUM NOTICE REQUIRED FOR INSPECTIONS.

BY: [Signature] OWNER
 I HEREBY DECLARE THAT I AM THE LEGAL OWNER OF THE ABOVE PROPERTY.
 BY: [Signature] AGENT

I hereby certify that I have reviewed this application and the proposed plans and have found that the proposed development meets the requirements of the City of Las Vegas Flood Hazard Reduction Ordinance for the issuance of this Development Permit.

LAND DEVELOPMENT AND FLOOD CONTROL ENGINEER [Signature] DATE 10-2-87
 PLANNING DEPT [Signature] DATE 10/2/87
 BUILDING DEPT [Signature] DATE 10/15/87

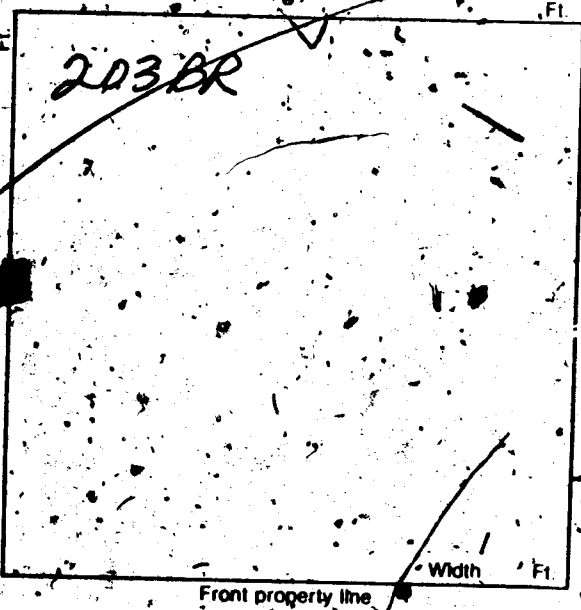

FOR INSPECTIONS CALL 799-2071

PLUMBING		FEE	ELECTRICAL		FEE
WATER DISTRIBUTION	6.00		RECEPTACLE	SWITCH	.40
SEWER SYSTEM - NEW OR MODIFICATION	10.00		EACH LIGHT FIXTURE OR SOCKET		.30
FIXTURES - WATER SOFTENER, H.W., HEATER	2.00		SPECIAL OUTLET, APPLIANCE, ETC.		.70
GARBAGE DISPOSAL - WASHER	2.00		SERVICE PANEL - SUB/3.00 - 200A/6.00 - 400A/12.50		3.00
FUEL PIPING	6.00		A.C. UNIT OR MOTORS		3.00
IRRIGATION SYSTEM	8.00		2310 - 2402	TOTAL	
MISC			MISC.		
2310 - 2403			2310 - 2401 ISSUANCE FEE		
TOTAL			7114 - 3854 SEWER CONNECTION		500.00
AIR CONDITIONING		FEE	2310 - 2401 PLAN REVIEW FEE		
NEW UNIT - 3 TON = 9.00 OVER = 16.50			2310 - 2401 BLDG. PERMIT FEE		355.00
FURNACE TO 100,000 BTU OVER/11.00			TOTAL FEES		855.00
EVAPORATIVE COOLER	6.50				
VENTILATION FAN	2.35				
2310 - 2405					
TOTAL					

RECEIPT
 PERMIT NO. _____
 MUST BE MACHINE VALIDATED

Permit Expires 180 Days After Abandonment of Work

[Signature] 10-15-87

CITY OF LAS VEGAS, NEVADA

LOG NO. & AREA T-87 DATE 09/21/87 CONST. VAL. \$ 51,125
 DEPARTMENT OF BUILDING AND SAFETY 390-1520-005 PHONE 386-6251
 ADDRESS OF CONSTRUCTION 6233 Blossomwood Ave. OWNER R/S Development PHONE NO. 458-6820
 LOT(S) 203 BLOCK 1 SUBDIVISION (Emerald West) Willow #3 ZONE R-1
 PROPOSED CONSTRUCTION SFD W/FP. USE _____
 THIS PERMIT FOR 5 BLDG. A/C ELEC. PLBG. OTHER PERMITS REQ.: FENCE OFF SITE SWIM POOL
 FLOOR AREA BSMT _____ 1ST 1758 2ND _____ GARAGE 410 PORCH _____ TOTAL 2207
 CONTRACTOR R/S Development STATE LICENSE NO. 18769 CITY LICENSE NO. 011-02363-2-
 ARCHITECT Kevin Thistle

PROPOSED CONSTRUCTION: NEW S.F.R.

PLUMBING PERMIT NO. 2912-3

USE:

UNITS	DESCRIPTION	FEE	TOTAL
PERMIT ISSUANCE			
	For Issuing Each Permit	10.00	10.00
	For Issuing Each Supplemental Permit	4.50	
FIXTURE CHARGE			
8	Bath, Shower, Lavatory, Toilet, Urinal	EA 2.00	16.00
1	Floor Drain, Floor Sink, Wash Tray, Sink	EA 2.00	2.00
2	Garbage Disposal, Clothes Washer, Dishwasher (residential)	EA 2.00	4.00
	Garbage Disposal (commercial)	EA 8.00	
	Clothes Washer, Dishwasher (commercial)	EA 2.00	
	Clothes Dryer (gas) (venting)	2.00	
	Dental Unit	8.00	
	Drinking Fountain	2.00	
	Refrigerator - Ice Maker, Water Dispenser	2.00	
	Any other water using equipment Attached	2.00	
1	Coffee Makers, Ice Makers	2.00	
	Hot Water Heater (Gas or Electric)	EA 2.00	2.00
SEWER SYSTEM			
	New, Replacement, Modification, or Any Drainage Work	10.00	10.00
	Grease or Sand Trap or Interceptor	2.00	
	Trailer Trap (regal parks)	5.00	
WATER SOFTENERS			
	Non Permanent Type (rental)	2.00	
	Permanent Type (connected to drain)	2.00	
WATER DISTRIBUTION SYSTEM			
	Single Family Dwelling	6.00	6.00
	Multi-Family Dwelling	6.00	
	Plus Each Dwelling Unit	3.00	
	Commercial Building per floor	3.00	
	Plus Each Unit (leased space or office)	2.00	
	Hotel or Motel	8.00	
	Plus Each Unit	3.00	
	Trailer Park	30.00	
	Plus Each Space	2.00	
	Irrigation Single Family Dwelling	8.00	
	Irrigation Commercial Fee Based on Building Code Valuation Chart		
	Construction Valuation		

Approval for the work under this permit will be given only after refuse and debris have been removed from job site and public right of way.

UNITS	DESCRIPTION	FEE	TOTAL
FUEL PIPING SYSTEM			
	Single Family Dwelling	6.00	6.00
	Multi-Family Dwelling	10.00	
	Plus Each Unit	2.00	
	Commercial Building (per floor)	6.00	
	Plus Each Unit (leased space or office)	6.00	
	Medium Pressure System (Plan Check)	12.00	
4	Each Gas Appliance (Any Type)	2.00	8.00
	Steam Boilers	5.00	
SOLAR ENERGY SYSTEMS			
	Collectors (including piping) (per collector)	5.00	
	Storage Tanks (each)	5.00	
PIPELINE CONTRACT			
	For Onsite Sewer, Gas or Water Contract Value Fee based on Building Code Permit Valuation Chart		
OTHER INSPECTIONS AND FEES:			
	Inspections outside of normal business hours (minimum charge—three hours)	25.00 per hour	
	Under provisions of Table 3-A of the Uniform Building Code, work which has been inspected once and not approved may be subject to a Reinspection Fee not less than \$30.00 per each inspection during business hours	30.00 each	
	Additional plan review required by changes, Additions to or revisions to approved plans (minimum charge two hours)	30.00 per hour	
	Plumbing permit fees may be computed the same as building permit fees by using the cost of installation for valuation amount when such work is not included in the above schedule.		
	Construction Valuation		

I hereby certify that I have carefully examined and read the above application, that the same is true and correct, and that the work herein described is to be done in accordance with all the provisions of the applicable Ordinances of the City of Las Vegas, Nevada and the State Laws, whether herein specified or not.

[Signature]
 SIGNED _____ CONTRACTOR _____ MASTER CARD NO. _____

BY _____ Registered Master Plumber, Spec. Plumber, or Owner
 BUILDING DEPT. *[Signature]* DATE 10-8-87

3/83 PERMIT EXPIRES 180 DAYS AFTER ABANDONMENT OF WORK

SEWER # 7114-3854 CONNECTION

FIXTURES

FEE _____

2310-2403 PERMIT FEE _____

TOTAL FEES 64.00

PERMIT NO. _____

MUST BE MACHINE VALIDATED

[Signature] 70-13-87

CITY OF LAS VEGAS, NEVADA 202AR

LOG NO. & AREA _____ DATE _____ CONST. VAL. \$ _____

DEPARTMENT OF BUILDING AND SAFETY PHONE 386-6251 PLUMBING PERMIT

ADDRESS OF CONSTRUCTION 6233 BLOSSOMWOOD AVE. OWNER R/S DEVELOPMENT PHONE 458-6820

CONTRACTOR STERLING PLUMBING STATE LICENSE NO. 719A CITY LICENSE NO. 910

LOT(S) 203 BLOCK 1 SUBDIVISION EMERALD WEST ZONE _____

PROPOSED CONSTRUCTION: NEW S.F.R. PLUMBING PERMIT NO. 2912-5 USE: _____

PROPOSED CONSTRUCTION: wiring for ~~any~~ new SFD

ELECTRIC PERMIT NO. 4197-17

Approval for the work under this permit will be given only after refuse and debris have been removed from job site and public right of way.

UNITS	DESCRIPTION	FEE	TOTAL
PERMIT ISSUANCE			
	For Issuing Each Permit	10.00	10.00
	Supplemental Fee	4.50	
APPLIANCE CHARGE			
Residential or General Commercial			
61	Receptacle 38 Switch 23	.40	24.40
20	Each Light Fixture, Socket, or Exit Light	.30	6.00
8	EACH OUTLET FOR Special Purpose: Dishwasher, Garbage Grinder, Trash Compactor, G.F.I., Clothes Washer, Dryer, Electric Range, Ovens, Smoke Detector, Water Heater, Space Heater, Blast Coil Heater (PER.M.V.), Mercury Lamp, Quartz Lamp, Sodium Lamp, Exhaust Fans, 20 AMP Single Circuit Sign.	.70	5.60
	X-Ray Unit	10.00	
	Area Lighting (First 3,000 Watts)	8.00	
	Each Additional 1,000 Watts	3.00	
MOTORS (1/2 H.P. AND OVER) TRANSFORMERS, ELEVATORS, WELDERS, GENERATORS, CHILLERS, AND SIGNS			
	First H.P. For Each Unit	3.00	
	First KVA For Each Unit	3.00	
	Each Additional H.P. or KVA up to 50	.50	
	Each Additional H.P. or KVA over 50	.35	
	Temporary power or Pole	6.00	
ELECTRIC SERVICE OR MAIN DISCONNECT			
1	Up to 200 AMP	6.00	6.00
	400 AMP And 600 AMP	12.50	
	Over 600 AMP To 1200 AMP	25.00	
	Over 1200 AMP	50.00	
	Each Additional Meter Socket	.50	
	Sub Panel or Motor Control Center (Ea.)	3.00	
	Swimming Pool (Residential)	20.00	
	Swimming Pool (Semi Public)	30.00	
	Spas	8.00	
	Recreational Vehicle Spaces (Each)	3.00	

UNITS	DESCRIPTION	FEE	TOTAL
	Busways-Trolley or Plug-in (Ea. 100 Ft.)	3.00	
	Gas Pumps (Ea.)	3.00	
1	Permanent A/C Unit (Pkg. Units)	3.00	3.00
	Each Air Handler	.00	
RESIDENTIAL LOW VOLTAGE INSTALLATIONS			
	Speaker Outlets (Each)		
	Signal or Alarm Outlets (Each)		
	Amplifiers	2.00	
	Control Panels	.50	
	TV Master System	.30	
3	Telephone or Computer Outlet	.30	90
OTHER INSPECTIONS AND FEES: INCLUDES ISSUANCE FEES WHEN APPLICABLE			
	Inspections outside of normal business hours (minimum charge - three hours)	25.00	per hour
	Reinspection fee assessed under provisions of TABLE 3-A of the Uniform Building Code = \$30.00 EACH	30.00	each
	Inspections for which no fee is specifically indicated (minimum charge - one-half hour)	30.00	per hour
	Additional plan review required by changes, additions or revisions to approved plans (minimum charge - one-half hour). After work hours - \$30.00 per hour - minimum 1 hour.	30.00	per hour
	Starter Permit	50.00	
CONTRACT PRICE OR COST OF INSTALLATION			
	Commercial - Burglar Alarms		
	- Music Systems		
	- Data Processing		
	- Communication		
	Conduit Only - Contract Price		
	All Misc. Electric		

I hereby certify that I have carefully examined and read the above application; that the same is true and correct; and that the work herein described is to be done in accordance with all the provisions of the applicable Ordinances of the City of Las Vegas, Nevada and the State Laws, whether herein specified or not.

Daniel Z. Anderson
SIGNED HOMEOWNER, CONTRACTOR, OR OWNER

D.S.
BUILDING DEPT.

11/17/87
DATE

PERMIT EXPIRES 180 DAYS AFTER ABANDONMENT OF WORK

Electrical permit fees may be computed the same as building permit fees by using the cost of installation for valuation amount when such work is not included in the above schedule.

2310-2402

RECEIPT

PERMIT NO. _____
MUST BE MACHINE VALIDATED

Debbie Anderson 11-25-87

CITY OF LAS VEGAS, NEVADA

LOG NO. & AREA _____ DATE 10/21/87 CONST. VAL. \$ _____

DEPARTMENT OF BUILDING AND SAFETY
PHONE 386-6254

ADDRESS OF CONSTRUCTION 633 Blossomwood Ave. OWNER R/S Development PHONE 458-6820

CONTRACTOR Anderson Electric STATE LICENSE NO. 10997 CITY LICENSE NO. 090-2-00350

LOT(s) 203 BLOCK 1 SUBDIVISION Emerald West ZONE _____

PROPOSED CONSTRUCTION: wiring for new SFD

LOT(s) 202 BLOCK 1 SUBDIVISION EMERALD WEST ZONE

PROPOSED CONSTRUCTION: SFD
 AIR COND. 440
 PERMIT NO. 73

UNITS	DESCRIPTION	FEE	TOTAL
PERMIT ISSUANCE			
1	For the issuance of each permit.	15.00	15.00
	For issuing each supplemental permit.	4.50	
UNIT FEE SCHEDULE			
	For the installation or relocation of each forced-air or gravity-type furnace or burner, including ducts and vents attached to such appliance, up to and including 100,000 Btu/h.	9.00	
	For the installation or relocation of each forced-air or gravity-type furnace or burner, including ducts and vents attached to such appliance over 100,000 Btu/h.	11.00	
	For the installation or relocation of each floor furnace, including vent.	9.00	
	For the installation or relocation of each suspended heater, recessed wall heater or floor-mounted unit heater.	9.00	
	For the installation, relocation or replacement of each appliance vent installed and not included in an appliance permit.	4.50	
	For the repair of, alteration of, or addition to each heating appliance, refrigeration unit, cooling unit, absorption unit, or each heating, cooling absorption, or evaporative cooling system, including installation of controls regulated by this code.	9.00	
	For the installation or relocation of each boiler or compressor to and including three horsepower, or each absorption system to and including 100,000 Btu/h.	9.00	
1	For the installation or relocation of each boiler or compressor over three horsepower to and including 15 horsepower, or each absorption system over 100,000 Btu/h and including 500,000 Btu/h.	16.50	16.50
	For the installation or relocation of each boiler or compressor over 15 horsepower to and including 30 horsepower, or each absorption system over 500,000 Btu/h to and including 1,000,000 Btu/h.	22.50	
	For the installation or relocation of each boiler or compressor over 30 horsepower to and including 50 horsepower, or for each absorption system over 1,000,000 Btu/h to and including 1,750,000 Btu/h.	33.00	
	For the installation or relocation of each boiler or refrigeration compressor over 50 horsepower, or each absorption system over 1,750,000 Btu/h.	58.00	

Approval for the work under this permit will be given only after refuse and debris have been removed from job site and public right of way.

UNITS	DESCRIPTION	FEE	TOTAL
	For each air-handling unit to and including 10,000 cubic feet per minute including ducts attached thereto. Note: This fee shall not apply to an air-handling unit which is a portion of a factory-assembled appliance, cooling unit, evaporative cooler or absorption unit for which a permit is required elsewhere in this code.	6.50	
	For each air-handling unit over 10,000 cfm.	11.00	
	For each evaporative cooler other than portable type.	6.50	
	For each ventilation fan	COMMERCIAL 4.50 RESIDENTIAL 2.35	4.70
	For each ventilation system which is not a portion of any heating or air-conditioning system, authorized by a permit.	6.50	
	For the installation of each hood which is served by mechanical exhaust, including the ducts for such hood.	6.50	
	For each appliance or piece of equipment regulated by this code but not classed in other appliance categories, or for which no other fee is listed in this code.	6.50	
OTHER INSPECTIONS AND FEES:			
	Inspections outside of normal business hours (minimum charge — three hours)	25.00 per hour	
	Reinspection fee assessed under provisions of TABLE 3-A of the Uniform Building Code — \$15.00 EACH	15.00 each	
	Inspections for which no fee is specifically indicated (minimum charge — one-half hour).	30.00 per hour	
	Additional plan review required by changes, additions or revisions to approved plans (minimum charge — two hours).	30.00 per hour	
	Mechanical permit fees may be computed the same as building permit fees by using the cost of installation for valuation amount when such work is not included in the above schedule.		
	Gas piping which is directly related and necessary to the repair or replacement of heating, air conditioning, or refrigeration systems not exceeding 500,000 B.T.U.H.	6.00	

I hereby certify that I have carefully examined and read the above application; that the same is true and correct; and that the work herein described is to be done in accordance with all the provisions of the applicable Ordinances of the City of Las Vegas, Nevada and the State Laws, whether herein specified or not.

TROPIC AIR COND., INC.
 SIGNED: *[Signature]* CONTRACTOR
 BY: *[Signature]* Spec. Contr. or Other
 BUILDING DEPT. DATE: 11-23-87

2310-2405
 RECEIPT
 PERMIT FEE \$15.00
 TOTAL FEES \$36.20

Permit Expires 180 Days After Abandonment of Work

MUST BE MACHINE VALIDATED

Debbie Ingram 12-2-87

CITY OF LAS VEGAS, NEVADA

LOG NO. & AREA _____ DATE _____ CONST. VAL. \$ _____

DEPARTMENT OF BUILDING AND SAFETY
 PHONE 386-6251 FOR INSPECTIONS, CALL 799-2071

AIR CONDITIONING PERMIT

ADDRESS OF CONSTRUCTION 6233 BLOSSOMWOOD AVENUE OWNER R. S. DEVELOPMENT PHONE: 458-6820

CONTRACTOR TROPIC AIR COND., INC. STATE LICENSE NO. 10426D CITY LICENSE NO. 03382

FOR: Fence, Wall, Retaining Wall
 ADDRESS OF CONSTRUCTION: 6229 Blossomwood OWNER: James McDonald PHONE: 658-2101

CONTRACTOR: owner STATE LICENSE NO. CITY LICENSE NO.

LOT(s): 202 BLOCK: 1 SUBDIVISION: Hollman A 2 ZONE: R-1

CONSTRUCTION PLANS SUBMITTED BY OWNER/CONTRACTOR
 BUILDING PERMIT NO: 5359 ENGINEER: CONSTRUCTION DESIGN BY CITY DESIGN SHEET.

Approval for the work under this permit will be given only after refuse and debris have been removed from job site and public right of way.

DESCRIPTION	TOTAL LIN. FT.	TOTAL SQ. FT.
CHAIN LINK OR WIRE MESH		
ORNAIMENTAL IRON 5' HIGH	13	65
WOOD		
MASONRY 6' HIGH	35	210
RETAINING		

OTHER INSPECTIONS AND FEES

- Inspections outside of normal business hours - \$30.00 per hour (minimum charge three hours).
- Re-inspection fee during normal business hours assessed under provisions of Table 3-A of the Uniform Building Code - \$30.00 each.
- Inspections during normal business hours for which no fee is specifically indicated - \$30.00 per hour (minimum charge one half hour).

Additional plan review required by changes, additions or revisions at approved plans - \$30.00 per hour (minimum charge two hours).

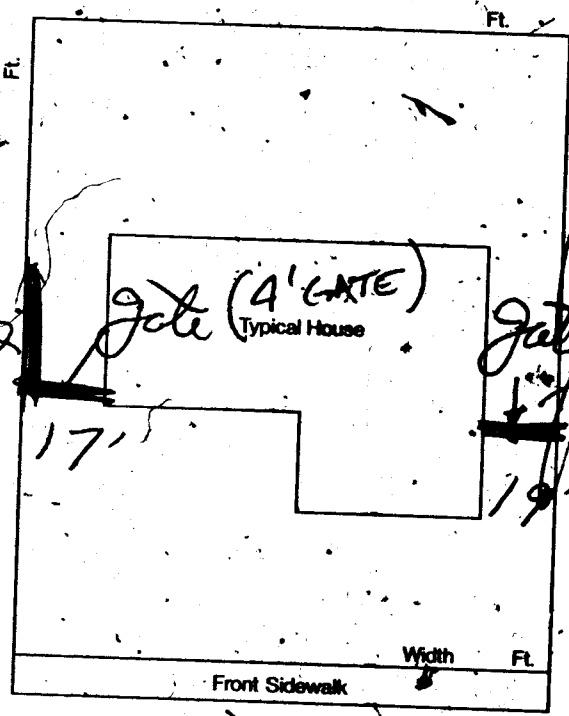

- CONDITIONS OF THE PERMIT:**
- Any type of retaining wall must be engineered by a Civil or Structural Engineer.
 - If a home owner takes out the Building Permit and if the owner sublets the work to a Contractor, then the Contractor must take out the permit and pay for it.
 - No fence or wall can be built on City property or rights-of-way, but this is not intended to preclude construction within utility easements if utilities will not be damaged or made inaccessible.
 - The fence or wall shall not enclose any water meter, light standard, or fire alarm box and shall not come closer than 24" from the nearest fire hydrant outlet.
 - Department inspectors must approve footings before concrete is poured and block wall reinforcing before grouting is done.
 - Maximum height of any wall or fence is 6', side and rear yards; 4' maximum in front yard with the vertical surface above the height of 2' - 50% open.
 - I must not obstruct required onsite parking space (2 spaces for each dwelling unit) by the erection of this fence or wall.
 - By the signing of this application I herewith agree to the requirements outlined above.

FOR INSPECTIONS, CALL 799-2071
 AS PER CITY DESIGN SHEET

SIGNED: James McDonald
 CONTRACTOR - AGENT - OWNER
 DATE: 9/19/88

PLANNING DEPT.
 I hereby certify that I have reviewed this application and the proposed plans and have found that the proposed development meets the requirements of the City of Las Vegas Flood Hazard Reduction Ordinance for the issuance of this Development Permit.

LAND DEVELOPMENT AND FLOOD CONTROL ENGINEER
N. K. [Signature]
 DATE: 9/19/88
 BUILDING DEPT.

PLAN REVIEW FEE
 PERMIT FEE 15.60
 2310-2401
 TOTAL FEES

RECEIPT
 0004
 WALL 15.60
 CHEK 15.60
 5359A000 09:05
 09/19/88

3/83
 PERMIT EXPIRES 180 DAYS AFTER ABANDONMENT OF WORK

MUST BE MACHINE VALIDATED

Abbi Ingram 3-14-88

OWNER: R/S Dev. ADDRESS: 6233 Blossomwood
 DATE: 10-8-87 GEN. CONT. owner

CONTRACTOR: R/S Development

STATE LICENSE NO. 18769

CITY LICENSE NO. 011-02363-2-033804

ARCHITECT: Kevin Thistle

ENGINEER: ESI

MASTER PLUMBER/
CONTRACTOR

MASTER ELECTRICIAN/
CONTRACTOR

OTHER INSPECTIONS AND FEES

1. Inspections outside of normal business hours = \$30.00 per hour (minimum charge three hours).
2. Re-inspection fee during normal business hours assessed under provisions of TABLE 3-A of the Uniform Building Code = \$30.00 per hour.
3. Inspections during normal business hours for which no fee is specifically indicated = \$30.00 per hour (minimum charge one half hour).
4. Additional plan review required by changes, additions or revisions to approved plans = \$30.00 per hour (minimum charge two hours).

CONDITIONS OF THE PERMIT:

1. I agree to call the City Building Department for inspections before concrete is poured, before rough wiring, electrical, plumbing, framing is covered. Also for air conditioning, drywall and sheathing inspection.
2. I agree that when the job is completed that I will call for final inspection before occupancy.
3. I agree to perform all construction in accordance with City Ordinances and Building Codes.
4. The Contractor's signature below denotes authority from the owner to sign in his behalf and that the owner is aware of all requirements of this application and permit. Separate permits must be taken out for work outlined above this agreement.
5. I have read and understand the contents of this application and permit. I hereby state that the information I have supplied on this application is true and correct.
6. Approval for the work under this permit will be given only after refuse and debris have been removed from job site and public right of way.
7. 24 HOUR MINIMUM NOTICE REQUIRED FOR INSPECTIONS.

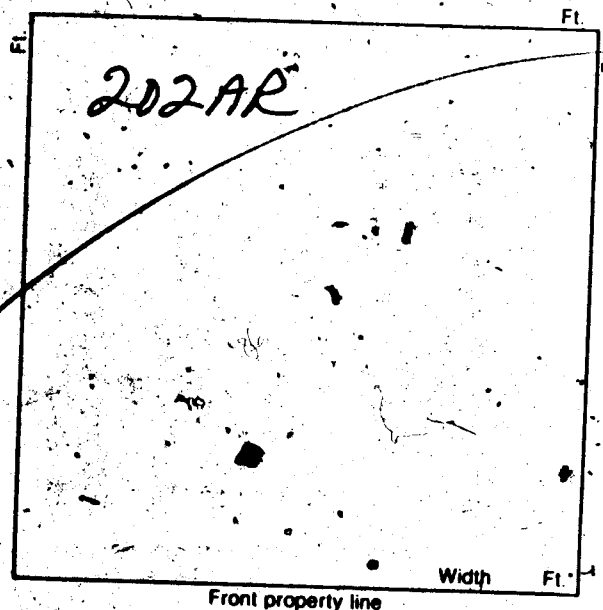

BY: [Signature] OWNER
 I HEREBY DECLARE THAT I AM THE LEGAL OWNER OF THE ABOVE PROPERTY.
 BY: [Signature] AGENT

I hereby certify that I have reviewed this application and the proposed plans and have found that the proposed development meets the requirements of the City of Las Vegas Flood Hazard Reduction Ordinance for the issuance of this Development Permit.

LAND DEVELOPMENT AND FLOOD CONTROL ENGINEER: [Signature] DATE: 10-2-87
 PLANNING DEPT: [Signature] DATE: 10/2/87
 BUILDING DEPT: [Signature] DATE: 10/5/87

FOR INSPECTIONS
CALL 799-2071

PLUMBING		FEE	ELECTRICAL		FEE
WATER DISTRIBUTION	6.00		RECEPTACLE SWITCH	.40	
SEWER SYSTEM - NEW OR MODIFICATION	10.00		EACH LIGHT FIXTURE OR SOCKET	.30	
FIXTURES - WATER SOFTENER, H.W. HEATER	2.00		SPECIAL OUTLET, APPLIANCE ETC.	.70	
GARBAGE DISPOSAL - WASHER	2.00		SERVICE/PANEL - SUB/3.00 - 200A/6.00 - 400A/12.50		
FUEL PIPING	6.00		A.C. UNIT OR MOTORS	3.00	
IRRIGATION SYSTEM	8.00		2310 - 2402	TOTAL	
MISC.			MISC.		
2310 - 2403			2310 - 2401 ISSUANCE FEE		
TOTAL			7114 - 3654 SEWER CONNECTION	500.00	
AIR CONDITIONING		FEE	2310 - 2401 PLAN REVIEW FEE		
NEW UNIT - 3 TON = 9.00 OVER = 16.50			2310 - 2401 BLDG. PERMIT FEE	347.00	
FURNACE TO 100,000/9.00 OVER/11.00			TOTAL FEES	847.00	
VAPORATIVE COOLER	6.50				
VENTILATION FAN	2.35				
2310 - 2405					
TOTAL					

RECEIPT

PERMIT NO. _____

MUST BE MACHINE VALIDATED

Permit Expires 180 Days After Abandonment of Work

UNITS	DESCRIPTION	FEE	TOTAL
PERMIT ISSUANCE			
	For Issuing Each Permit	10.00	10.00
	For Issuing Each Supplemental Permit	4.50	
FIXTURE CHARGE			
8	Bathub, Shower, Lavatory, Toilet, Urinal	EA. 2.00	16.00
1	Floor Drain, Floor Sink, Wash Tray, Sink	EA. 2.00	2.00
2	Garbage Disposal, Clothes Washer, Dishwasher (residential)	EA. 2.00	4.00
	Garbage Disposal (commercial)	EA. 8.00	
	Clothes Washer, Dishwasher (commercial)	EA. 2.00	
	Clothes Dryer (gas) (venting)	2.00	
	Dental Unit	8.00	
	Drinking Fountain	2.00	
	Refrigerator - Ice Maker, Water Dispenser	2.00	
	Any other water using equipment, Attached Coffee Makers, Ice Makers	2.00	
1	Hot Water Heater (Gas or Electric)	EA. 2.00	2.00
SEWER SYSTEM			
	New, Replacement, Modification, or Any Drainage Work	10.00	10.00
	Grease or Sand Trap or Interceptor	2.00	
	Trailer Trap (rental parks)	5.00	
WATER SOFTENERS			
	Non Permanent Type (rental)	2.00	
	Permanent Type (connected to drain)	2.00	
WATER DISTRIBUTION SYSTEM			
	Single Family Dwelling	6.00	6.00
	Multi-Family Dwelling	6.00	
	Plus Each Dwelling Unit	3.00	
	Commercial Building per floor	3.00	
	Plus Each Unit (leased space or office)	2.00	
	Hotel or Motel	8.00	
	Plus Each Unit	3.00	
	Trailer Park	30.00	
	Plus Each Space	2.00	
	Irrigation Single Family Dwelling	8.00	
	Irrigation Commercial Fee Based on Building Code Valuation Chart Construction Valuation		

UNITS	DESCRIPTION	FEE	TOTAL
FUEL PIPING SYSTEM			
	Single Family Dwelling	6.00	6.00
	Multi-Family Dwelling	10.00	
	Plus Each Unit	2.00	
	Commercial Building (per floor)	6.00	
	Plus Each Unit (leased space or office)	6.00	
	Medium Pressure System (Plan Check)	12.00	
4	Each Gas Appliance (Any Type)	2.00	8.00
	Steam Boilers	5.00	
SOLAR ENERGY SYSTEMS			
	Collectors (including piping) (per collector)	5.00	
	Storage Tanks (each)	5.00	
PIPELINE CONTRACT			
	For Onsite Sewer, Gas or Water Contract Value. Fee based on Building Code Permit Valuation Chart.		
OTHER INSPECTIONS AND FEES:			
	Inspections outside of normal business hours (minimum charge—three hours)	25.00	per hour
	Under provisions of Table 3-A of the Uniform Building Code, work which has been inspected once and not approved may be subject to a Reinspection Fee not less than \$30.00 per each inspection during business hours.	30.00	each
	Additional plan review required by changes. Additions to or revisions to approved plans (minimum charge two hours).	30.00	per hour
	Plumbing permit fees may be computed the same as building permit fees by using the cost of installation for valuation amount when such work is not included in the above schedule.		
	Construction Valuation		

SEWER # 7114-3854 CONNECTION

I hereby certify that I have carefully examined and read the above application; that the same is true and correct; and that the work herein described is to be done in accordance with all the provisions of the applicable Ordinances of the City of Las Vegas, Nevada and the State Laws, whether herein specified or not.

SIGNED: [Signature] CONTRACTOR MASTER CARD NO. _____

BY: [Signature] Registered Master Plumber, Spec. Contr. or Owner
 BUILDING DEPT. DATE: 10-8-87

383 PERMIT EXPIRES, 180 DAYS AFTER ABANDONMENT OF WORK

FIXTURES: _____
 FEE: _____
 2310-2403 PERMIT FEE: _____
 TOTAL FEES: 64.00

RECEIPT

PERMIT NO. _____

MUST BE MACHINE VALIDATED

PROPOSED CONSTRUCTION: wiring for new SFD

USE:

ELECTRIC PERMIT NO. 4197 -19

Approval for the work under this permit will be given only after refuse and debris have been removed from job site and public right of way.

UNITS	DESCRIPTION	FEE	TOTAL
PERMIT ISSUANCE			
1	For Each Permit	10.00	10.00
	Supplemental Fee	4.50	
APPLIANCE CHARGE			
Residential or General Commercial			
624	Receptacle 42 Switch 22	.40	25.60
18	Each Light Fixture, Socket or Exit Light	.30	5.40
10	EACH OUTLET FOR Special Purpose: Dishwasher, Garbage Grinder, Trash Compactor, G.F.I., Clothes Washer, Dryer, Electric Range, Ovens, Smoke Detector, Water Heater, Space Heater, Blast Coil Heater (PER K.W.), Mercury Lamp, Quartz Lamp, Sodium Lamp, Exhaust Fans, 20 AMP Single Circuit Sign.	.70	7.00
	X-Ray Unit	10.00	
	Area Lighting (First 3,000 Watts)	8.00	
	Each Additional 1,000 Watts	3.00	
MOTORS (1/2 H.P. AND OVER) TRANSFORMERS, ELEVATORS, WELDERS, GENERATORS, CHILLERS, AND SIGNS			
	First H.P. For each Unit	3.00	
	First KVA For Each Unit	3.00	
	Each Additional H.P. or KVA up to 50	.50	
	Each Additional H.P. or KVA over 50	.35	
	Temporary power or Pole	6.00	
ELECTRIC SERVICE OR MAIN DISCONNECT			
1	Up to 200 AMP	6.00	6.00
	400 AMP And 600 AMP	12.50	
	Over 600 AMP To 1200 AMP	25.00	
	Over 1200 AMP	50.00	
	Each Additional Meter Socket	.50	
	Sub Panel or Motor Control Center (Ea.)	3.00	
	Swimming Pool (Residential)	20.00	
	Swimming Pool (Semi-Public)	30.00	
	Spas	8.00	
	Recreational Vehicle Spaces (Each)	3.00	

UNITS	DESCRIPTION	FEE	TOTAL
	Busways-Trolley or Plug-in (Ea. 100 Ft.)	3.00	
	Gas Pumps (Ea.)	3.00	
1	Permanent A/C Unit (Pkg. Units)	3.00	32.00 3.00
	Each Air Handler	1.00	
RESIDENTIAL LOW VOLTAGE INSTALLATIONS			
	Speaker Outlets (Each)	.30	
	Signal or Alarm Outlets (Each)	.30	
	Amplifiers	2.00	
	Control Panel	.50	
	TV Master System	.30	
3	Telephone or Computer Outlet	.30	.90

OTHER INSPECTIONS AND FEES: INCLUDES ISSUANCE FEES WHEN APPLICABLE

	Inspections outside of normal business hours (minimum charge - three hours)	25.00 per hour
	Reinspection fee assessed under provisions of TABLE 3-A of the Uniform Building Code = \$30.00 EACH.	30.00 each
	Inspections for which no fee is specifically indicated (minimum charge - one-half hour).	30.00 per hour
	Additional plan review required by changes, additions or revisions to approved plans (minimum charge - one-half hour). After work hours - \$30.00 per hour - minimum 1 hour.	30.00 per hour
	Starter Permit	50.00

CONTRACT PRICE OR COST OF INSTALLATION

Commercial	Burglar Alarms	
	Music Systems	
	Data Processing	
	Communication	
	Conduit Only-Contract Price	
	All Misc. Electric	

Electrical permit fees may be computed the same as building permit fees by using the cost of installation for valuation amount when such work is not included in the above schedule.

231Q-2402

RECEIPT

I hereby certify that I have carefully examined and read the above application; that the same is true and correct, and that the work herein described is to be done in accordance with all the provisions of the applicable Ordinances of the City of Las Vegas, Nevada and the State Laws, whether herein specified or not.

Daniel K. Anderson
SIGNED HOMEOWNER, CONTRACTOR, OR O.I.

CARD NO.

D.S.
BUILDING DEPT.

11/17/87
DATE

PERMIT EXPIRES 180 DAYS AFTER ABANDONMENT OF WORK

PERMIT FEE 57.90

LESS STARTER PERMIT

TOTAL FEES

PERMIT NO.

MUST BE MACHINE VALIDATED

LOT(s) **203**

BLOCK **1**

SUBDIVISION **EMERALD WEST**

ZONE:

PROPOSED CONSTRUCTION **SFD**
 AIR COND. **448**
 PERMIT NO. **75**

USE:

UNITS	DESCRIPTION	FEE	TOTAL
PERMIT ISSUANCE			
1	For the issuance of each permit.	15.00	15.00
	For issuing each supplemental permit.	4.50	
UNIT FEE SCHEDULE			
1	For the installation or relocation of each forced-air or gravity-type furnace or burner, including ducts and vents attached to such appliance, up to and including 100,000 Btu/h.	9.00	
	For the installation or relocation of each forced-air or gravity-type furnace or burner, including ducts and vents attached to such appliance over 100,000 Btu/h.	11.00	
	For the installation or relocation of each floor furnace, including vent.	9.00	
	For the installation or relocation of each suspended heater, recessed wall heater or floor-mounted unit heater.	9.00	
	For the installation, relocation or replacement of each appliance vent installed and not included in an appliance permit.	4.50	
	For the repair, alteration of, or addition to each heating appliance, refrigeration unit, cooling unit, absorption unit, or each heating, cooling, absorption, or evaporative cooling system, including installation of controls regulated by this code.	9.00	
	For the installation or relocation of each boiler or compressor to and including three horsepower, or each absorption system to and including 100,000 Btu/h.	9.00	
1	For the installation or relocation of each boiler or compressor over three horsepower to and including 15 horsepower, or each absorption system over 100,000 Btu/h and including 500,000 Btu/h.	16.50	16.50
	For the installation or relocation of each boiler or compressor over 15 horsepower to and including 30 horsepower, or each absorption system over 500,000 Btu/h to and including 1,000,000 Btu/h.	22.50	
	For the installation or relocation of each boiler or compressor over 30 horsepower to and including 50 horsepower, or each absorption system over 1,000,000 Btu/h to and including 1,750,000 Btu/h.	33.50	
	For the installation or relocation of each boiler or refrigeration compressor over 50 horsepower, or each absorption system over 1,750,000 Btu/h.	56.00	

Approval for the work under this permit will be given only after refuse and debris have been removed from job site and public right of way.

UNITS	DESCRIPTION	FEE	TOTAL
	For each air-handling unit to and including 10,000 cubic feet per minute, including ducts attached thereto. <i>Note: This fee shall not apply to an air-handling unit which is a portion of a factory-assembled appliance, cooling unit, evaporative cooler or absorption unit for which a permit is required elsewhere in this code.</i>	6.50	
	For each air-handling unit over 10,000 cfm.	11.00	
	For each evaporative cooler other than portable type.	6.50	
	For each ventilation fan	COMMERCIAL 4.50 RESIDENTIAL 2.35	7.05
	For each ventilation system which is not a portion of any heating or air-conditioning system authorized by a permit.	6.50	
	For the installation of each hood which is served by mechanical exhaust, including the ducts for such hood.	6.50	
	For each appliance or piece of equipment regulated by this code but not classed in other appliance categories for which no other fee is listed in this code.	6.50	
OTHER INSPECTIONS AND FEES:			
	Inspections outside of normal business hours (minimum charge — three hours)	25.00 per hour	
	Reinspection fee assessed under provisions of TABLE 3-A of the Uniform Building Code, = \$15.00 EACH	15.00 each	
	Inspections for which no fee is specifically indicated (minimum charge — one-half hour)	30.00 per hour	
	Additional plan review required by changes, additions or revisions to approved plans (minimum charge — two hours)	30.00 per hour	
	Mechanical permit fees may be computed the same as building permit fees by using the cost of installation for valuation amount when such work is not included in the above schedule.		
	Gas piping which is directly related and necessary to the repair or replacement of heating, air conditioning, or refrigeration systems not exceeding 500,000 B.T.U.H.	6.00	

2310-2405

RECEIPT

I hereby certify that I have carefully examined and read the above application; that the same is true and correct, and that the work herein described is to be done in accordance with all the provisions of the applicable Ordinances of the City of Las Vegas, Nevada and the State Laws, whether herein specified or not.

TROPIC AIR COND., INC.

SIGNED *[Signature]* CONTRACTOR MASTER CARD NO. PERMIT FEE **\$15.00**

BY *[Signature]* Spec. Contr. or Owner TOTAL FEES **\$38.55**

BUILDING DEPT. DATE **11-23-82**

Permit Expires 180 Days After Abandonment of Work

MUST BE MACHINE VALIDATED

OWNER	R/S Dev.	ADDRESS	6233 B ...	OMWOOD
DATE	10-8-87	GEN. CONT.	Owner	
BULD. TYPE	sf/tp	PERMIT No.	2820-5	
LEGAL	LOT 03	LOG No.	187	
BUILDINGS		MECHANICAL		
Pt. Loc. & Ft. <input type="checkbox"/>		Plumbing Cont.	Sterling	
Location & Footing <input type="checkbox"/>	5410-47	Permit No.	2912-5	Date 11-4-87
Stemwall <input type="checkbox"/>		A/C Cont.	None	
Concrete Slab Floor <input type="checkbox"/>	15410-4	Permit No.	4422-15	Date 11-25-87
Chimney Steel <input type="checkbox"/>		Sewer Fee	owner	
Fireplace Footing <input type="checkbox"/>		Irrig. Cont.		
Vert. Steel Reinf. <input type="checkbox"/>		Permit No.	Date	
Horiz. Steel Reinf. <input type="checkbox"/>		Hood Cont.		
Roof Sheathing	BM 12-10-87	Permit No.	Date	
Insulation	BM 1-11-88	Rough Soil <input type="checkbox"/>	11-10-87	
Framing	BM 1-5-88	Rough Water <input type="checkbox"/>		
Ext. Lath	BM 1-7-88	Tap-Out		
Ext. Scratch		Rough Gas	TT 12-30-87	
Ext. Brown		A/C Rough/Duct		
Drywall	BM 1-21-88	Final Plumbing	TT 3/11/88	
Final Building	BM 3/18/88	Final Gas	TT 3/11/88	
Appr. for Occu. Final Building		Final Air Cond.	TT 3/11/88	
		Final Sewer	TT 12-10-87	
ELECTRICAL		ELECTRICAL		
Electrical Cont.	Industrial	Rough Hood <input type="checkbox"/>		
Permit No.	4497-19	Final Hood <input type="checkbox"/>		
PT Rough	KB 1-4-88	Final Irrig.		
Ground Electrode		ELECTRICAL		
Temporary Power		Temp. Pole Cont.		
Meter Tag		Permit No.	Date	
Final Electrical	KB 3/1/88	Inspection	Date	