

# CITY OF LAS VEGAS, NEVADA

DEPARTMENT OF BUILDING AND SAFETY  
PHONE 386 6251 *060-323-010*



MIT NO *89-030177*

**DEVELOPMENT PERMIT**  
FOR Fence Wall Retaining Wall

LOG NO & AREA \_\_\_\_\_ DATE *7/7/89* CONST VAL \$ *330.00*

ADDRESS OF CONSTRUCTION *517 Greasewood Dr* OWNER *David Benedict* PHONE *459-3138*

CONTRACTOR \_\_\_\_\_ STATE LICENSE NO \_\_\_\_\_ CITY LICENSE NO \_\_\_\_\_

LOT(s) *34* BLOCK *4* SUBDIVISION *Cedar Creek Park - Unit 3* ZONE *RE(ROFR-4)*

CONSTRUCTION PLANS SUBMITTED BY OWNER/CONTRACTOR  CONSTRUCTION DESIGN BY CITY DESIGN SHEET

ENGINEER \_\_\_\_\_

App If th w k d th p mt w l b g v e ly ft f  
d b h b m d f m j b t d p b l g h t f w y

| DESCRIPTION                    | TOTAL LIN FT | TOTAL SQ FT |
|--------------------------------|--------------|-------------|
| CHAIN LINK OR WIRE MESH        |              |             |
| ORNAMENTAL IRON                |              |             |
| WOOD                           |              | <i>84</i>   |
| MASONRY                        | <i>6'</i>    | <i>14</i>   |
| <del>REINFORCING</del> MASONRY | <i>4'</i>    | <i>8</i>    |
|                                | <i>2'</i>    | <i>8</i>    |
|                                |              | <i>16</i>   |

| OTHER INSPECTIONS AND FEES |  |
|----------------------------|--|
| 1                          | l p t t d f m l b h \$3000 p h (m m m h g th h r s)                    |
| 2                          | R p t f d g m l b h \$3000 d d p f TABLE 3 A f                         |
| 3                          | l p t d g m l b h f w h f p f l y d t d \$3000                         |
| 4                          | p h (m m m h g h f h )<br>Addt l pl w q d by h g ddt t p p d pl \$3000 |

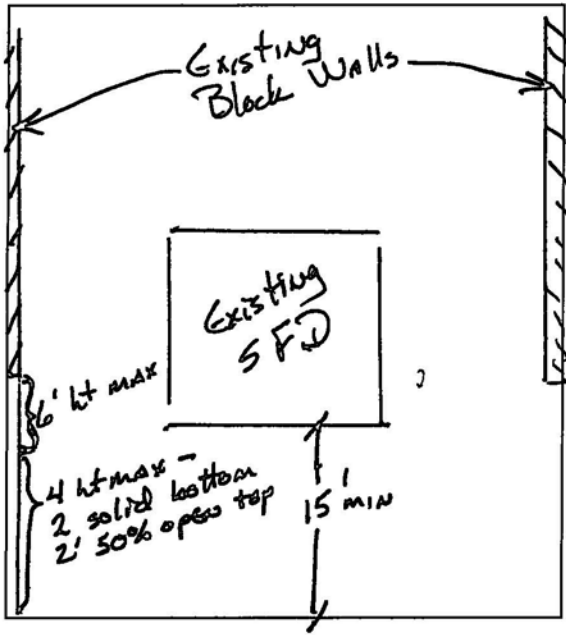

**CONDITIONS OF THE PERMIT**

- Any type of retaining wall must be engineered by a Civil or Structural Engineer
- If a home owner takes out the Building Permit and if the owner sublets the work to a Contractor then the Contractor must take out the permit and pay for it
- No fence or wall can be built on City property or rights of way but this is not intended to preclude construction within utility easements if utilities will not be damaged or made inaccessible
- The fence or wall shall not enclose any water meter light standard or fire alarm box and shall not come closer than 24' from the nearest fire hydrant outlet
- Department Inspectors must approve footings before concrete is poured and block wall reinforcing before grouting is done
- Maximum height of any wall or fence is 6' side and rear yards 4' maximum in front yard with the vertical surface above the height of 2' - 50' open
- I must not obstruct required onsite parking space (2 spaces for each dwelling unit) by the erection of this fence or wall
- By the signing of this application I herewith agree to the requirements outlined above

**FOR INSPECTIONS CALL 799 2071**

SIGNED *David Benedict* CONTRACTOR AGENT OWNER  
*Robert Paul* PLANNING DEPT DATE *7/7/89*

*as per City Design Sheet 07/07/89*

| RECEIPT          |       |
|------------------|-------|
| **0003**         |       |
| WALL             | 12 00 |
| ChE <sup>1</sup> | 12 00 |
| 8537A000         | 12 44 |

I hereby certify that I have reviewed this application and the proposed plans and have found that the proposed development meets the requirements of the City of Las Vegas Flood Hazard Reduction Ordinance for the issuance of this Development Permit

*[Signature]* 7/7/89 DATE  
LAND DEVELOPMENT AND FLOOD CONTROL ENGINEER

*[Signature]* 7/7/89 DATE  
BUILDING DEPT

PLAN REVIEW FEE \_\_\_\_\_

PERMIT FEE *1200*  
2310 2401

TOTAL FEES *1200*

MUST BE MACHINE VALIDATED

**DEPARTMENT OF BUILDING & SAFETY CITY OF LAS VEGAS**

|  |        |                                   |
|--|--------|-----------------------------------|
| JOB ADDRESS<br><i>517 Greasewood Dr</i>    |        | PERMIT NO<br><i>030777</i>        |
| LOT NO                                     | MAP NO | INSPECTOR<br><i>54</i>            |
| SUBDIVISION NAME                           |        | DATE                              |
| INSPECTOR SIGNATURE<br><i>DRS Chrusler</i> |        | INSPECTION DATE<br><i>10-7-88</i> |

*Footings not a per city  
design sheet*

| <input type="checkbox"/> PARTIAL INSPECTION DESCRIPTION                                 |                             |  |                             |                                    |                        |
|---|-----------------------------|--|-----------------------------|------------------------------------|------------------------|
| <input type="checkbox"/> APPROVED   |                             | <input type="checkbox"/> PERMIT REQUIRED   |                             | <input type="checkbox"/> STOP WORK |                        |
| <input type="checkbox"/> REJECTED CORRECTION NOTICE REINSPECTION REQUIRED CALL 799-2071 |                             |  |                             |                                    |                        |
| INSPECT   | DESCRIPTION                 | INSPECT  | DESCRIPTION                 | INSPECT                            | DESCRIPTION            |
| <input checked="" type="checkbox"/> B 1   | FOOTING LAYOUT REBAR ZONING | <input type="checkbox"/> P 1   | ON SITE SEWER               | <input type="checkbox"/> X 2       | UNDERGROUND HYDRO      |
| <input type="checkbox"/> B 2  | STEM WALL - FORMS & REBAR   | <input type="checkbox"/> P 2   | ON SITE WATER               | <input type="checkbox"/> X 3       | UNDERGROUND FINAL/FLOW |
| <input type="checkbox"/> B 3  | PRE SLAB                    | <input type="checkbox"/> P 3   | BUILDING SEWER (YARD LINES) | <input type="checkbox"/> X 4       | SPRINKLER SYSTEM HYDRO |
| <input type="checkbox"/> B 4  | ROOF SHEATHING              | <input type="checkbox"/> P 4   | UNDERSLAB PLUMBING          | <input type="checkbox"/> X 5       | FIRE ALARM             |
| <input type="checkbox"/> B 5  | FRAMING                     | <input type="checkbox"/> P 5   | TOP OUT WATER GAS WASTE     | <input type="checkbox"/> X 6       | OTHER                  |
| <input type="checkbox"/> B 6  | INSULATION                  | <input type="checkbox"/> P 6   | FINAL GAS TEST              | <input type="checkbox"/> X 7       | FINAL FIRE             |
| <input type="checkbox"/> B 7  | DRYWALL NAILING             | <input type="checkbox"/> P 7   | FINAL PLUMBING              |                                    |                        |
| <input type="checkbox"/> B 8  | EXTERIOR LATH/STUCCO        |  |                             | <input type="checkbox"/> E 1       | UNDERGROUND ELETRICAL  |
| <input type="checkbox"/> B 9  | WALL GROUT & STEEL          | <input type="checkbox"/> M 1   | ROUGH VENT                  | <input type="checkbox"/> E 2       | ROUGH ELECTRICAL       |
| <input type="checkbox"/> B 10   | PRE GUNITE                  | <input type="checkbox"/> M 2   | HOOD                        | <input type="checkbox"/> E 3       | LOW VOLTAGE ELECTRICAL |
| <input type="checkbox"/> B 11   | PRE PLASTER / FINAL         | <input type="checkbox"/> M 3   | FINAL MECHANICAL            | <input type="checkbox"/> E 4       | SIGN INSPECTION        |
| <input type="checkbox"/> B 12   | BUILDING FINAL              |  |                             | <input type="checkbox"/> E 5       | FINAL ELECTRICAL       |
| <input type="checkbox"/> B 13   | CERT OF OCC                 | <input type="checkbox"/> X 1   | KICKER / FLUSH              | <input type="checkbox"/> E 6       | TEMP POWER             |
| <input type="checkbox"/> FINAL INSPECTION   |                             | BRING HARD CARD WITH FIRE QUALITY CONTROL & PLANNING APPROVALS SIGNED OFF TO BLDG & SAFETY FOR C of O ISSUANCE (Commercial Only) |                             |                                    |                        |

**FOR ASSISTANCE -CALL 386-6251**



# DEPARTMENT OF BUILDING & SAFETY CITY OF LAS VEGAS

|   |        |                                   |
|---|--------|-----------------------------------|
| JOB ADDRESS<br><i>517 Greasewood Dr</i>     |        | PERMIT NO<br><i>030777</i>        |
| LOT NO                                      | MAP NO | INSPECTOR<br><i>54</i>            |
| SUBDIVISION NAME                            |        | PHONE                             |
| INSPECTOR SIGNATURE<br><i>D R Schmechel</i> |        | INSPECTION DATE<br><i>17-7-84</i> |

*Still not as per City  
Design sheet*

PARTIAL INSPECTION DESCRIPTION

| <input type="checkbox"/> APPROVED  | <input type="checkbox"/> PERMIT REQUIRED | <input type="checkbox"/> STOP WORK |                             |                              |                        |
|--|--|------------------------------------|-----------------------------|------------------------------|------------------------|
| <input checked="" type="checkbox"/> REJECTED CORRECTION NOTICE REINSPECTION REQUIRED CALL 799 2071 |  |                                    |                             |                              |                        |
| INSPECT  | DESCRIPTION                              | INSPECT                            | DESCRIPTION                 | INSPECT                      | DESCRIPTION            |
| <input checked="" type="checkbox"/> B 1  | FOOTING LAYOUT REBAR ZONING              | <input type="checkbox"/> P 1       | ON SITE SEWER               | <input type="checkbox"/> X 2 | UNDERGROUND HYDRO      |
| <input type="checkbox"/> B 2   | STEM WALL -- FORMS & REBAR               | <input type="checkbox"/> P 2       | ON SITE WATER               | <input type="checkbox"/> X 3 | UNDERGROUND FINAL/FLOW |
| <input type="checkbox"/> B 3   | PRE SLAB                                 | <input type="checkbox"/> P 3       | BUILDING SEWER (YARD LINES) | <input type="checkbox"/> X 4 | SPRINKLER SYSTEM HYDRO |
| <input type="checkbox"/> B 4   | ROOF SHEATHING                           | <input type="checkbox"/> P 4       | UNDERSLAB PLUMBING          | <input type="checkbox"/> X 5 | FIRE ALARM             |
| <input type="checkbox"/> B 5   | FRAMING                                  | <input type="checkbox"/> P 5       | TOP OUT WATER GAS WASTE     | <input type="checkbox"/> X 6 | OTHER                  |
| <input type="checkbox"/> B 6   | INSULATION                               | <input type="checkbox"/> P 6       | FINAL GAS TEST              | <input type="checkbox"/> X 7 | FINAL FIRE             |
| <input type="checkbox"/> B 7   | DRYWALL NAILING                          | <input type="checkbox"/> P 7       | FINAL PLUMBING              |                              |                        |
| <input type="checkbox"/> B 8   | EXTERIOR LATH/STUCCO                     |                                    |                             | <input type="checkbox"/> E 1 | UNDERGROUND ELETRICAL  |
| <input type="checkbox"/> B 9   | WALL GROUT & STEEL                       | <input type="checkbox"/> M 1       | ROUGH VENT                  | <input type="checkbox"/> E 2 | ROUGH ELECTRICAL       |
| <input type="checkbox"/> B 10  | <del>COOL</del> PRE GUNITE               | <input type="checkbox"/> M 2       | HOOD                        | <input type="checkbox"/> E 3 | LOW VOLTAGE ELECTRICAL |
| <input type="checkbox"/> B 11  | <del>COOL</del> PRE PLASTER / FINAL      | <input type="checkbox"/> M 3       | FINAL MECHANICAL            | <input type="checkbox"/> E 4 | SIGN INSPECTION        |
| <input type="checkbox"/> B 12  | BUILDING FINAL                           |                                    |                             | <input type="checkbox"/> E 5 | FINAL ELECTRICAL       |
| <input type="checkbox"/> B 13  | CERT OF OCC                              | <input type="checkbox"/> X 1       | KICKER / FLUSH              | <input type="checkbox"/> E 6 | TEMP POWER             |

FINAL INSPECTION

BRING HARD CARD WITH FIRE QUALITY CONTROL & PLANNING APPROVALS  
SIGNED OFF TO BLDG & SAFETY FOR C of O ISSUANCE (Commercial Only)

**FOR ASSISTANCE CALL 386-6251**





