

CITY OF LAS VEGAS, NEVADA

DEPARTMENT OF BUILDING AND SAFETY
PHONE 386-6251

PERMIT NO. - 099742



BUILDING PERMIT
FOR: Single Family Dwelling, Remodel
Additions, Misc. Residential Construction

LOG NO. & AREA m-1634 attached DATE 3-8-91 CONST. VAL. \$ 500.00 864

ADDRESS OF CONSTRUCTION 3312 PARAGON STREET OWNER SHARON RHOADE PHONE 33-414

LOT(s) 12 BLOCK 1 SUBDIVISION HARBOR GATE ZONE RCL

PROPOSED CONSTRUCTION PATIO COVER Edgewater #1 USE LEISURE

THIS PERMIT FOR BLDG. A/C ELEC PLBG OTHER PERMITS REQD FENCE OFF SITE SWIM POOL

FLOOR AREA BSMT _____ 1ST _____ 2ND _____ GARAGE _____ PORCH _____ TOTAL 216

CONTRACTOR WAYNECO STATE LICENSE NO. 0026647 CITY LICENSE NO. 011 02538-2
035407

ARCHITECT _____ ENGINEER _____

MASTER PLUMBER/CONTRACTOR _____ MASTER ELECTRICIAN/CONTRACTOR _____

OTHER INSPECTIONS AND FEES

- 1 Inspections outside of normal business hours = \$30.00 per hour (minimum charge three hours)
- 2 Re-inspection fee during normal business hours assessed under provisions of TABLE 3-A of the Uniform Building Code = \$30.00 per hour
- 3 Inspections during normal business hours for which no fee is specifically indicated = \$30.00 per hour (minimum charge one half hour)
- 4 Additional plan review required by changes, additions, or revisions to approved plans = \$30.00 per hour (minimum charge two hours)

CONDITIONS OF THE PERMIT:

- 1 I agree to call the City Building Department for inspections before concrete is poured, before rough wiring, electrical, plumbing, framing is covered Also for air conditioning, drywall and sheathing inspection
- 2 I agree that when the job is completed that I will call for final inspection before occupancy
- 3 I agree to perform all construction in accordance with City Ordinances and Building Codes
- 4 The Contractor's signature below denotes authority from the owner to sign in his behalf and that the owner is aware of all requirements of this application and permit Separate permits must be taken out for work outlined above this agreement
- 5 I have read and understand the contents of this application and permit, I hereby state that the information I have supplied on this application is true and correct.
- 6 Approval for the work under this permit will be given only after refuse and debris have been removed from job site and public right of way
- 7 24 HOUR MINIMUM NOTICE REQUIRED FOR INSPECTIONS

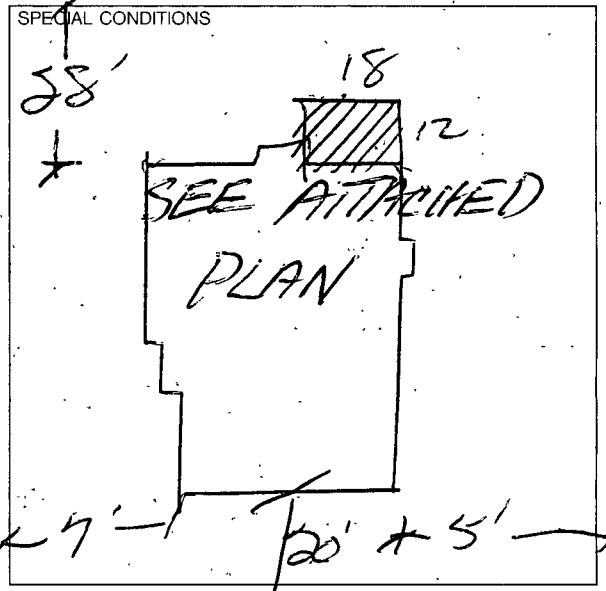

BY _____ I HEREBY DECLARE THAT I AM THE LEGAL OWNER OF THE ABOVE PROPERTY OWNER

BY Wayne A. Schmidt AGENT

I hereby certify that I have reviewed this application and the proposed plans and have found that the proposed development meets the requirements of the City of Las Vegas Flood Hazard Reduction Ordinance for the issuance of this Development Permit.

LAND DEVELOPMENT AND FLOOD CONTROL ENGINEER _____ DATE 3/8/91

PLANNING DEPT. 15 3-8-91 DATE

BUILDING DEPT _____ DATE

PLUMBING		FEE	ELECTRICAL		FEE
WATER DISTRIBUTION	6.00		RECEPTACLE _____ SWITCH _____	40	03/08/91
SEWER SYSTEM - NEW OR MODIFICATION	10.00		EACH LIGHT FIXTURE OR SOCKET _____	30	
FIXTURES - WATER SOFTENER, HW HEATER	2.00		SPECIAL OUTLET, APPLIANCE ETC	70	
GARBAGE DISPOSAL - WASHER	2.00		SERVICE/PANEL - SUB/3 00 - 200A/6 00 - 400A/12 50		
FUEL PIPING	6.00		A C UNIT OR MOTORS	3.00	
IRRIGATION SYSTEM	8.00		2310 - 2432	TOTAL	
MISC			MISC.		
2310 - 2433	TOTAL		2310 - 2431 ISSUANCE FEE		
AIR CONDITIONING		FEE	7 143 - 2973 SEWER CONNECTION		
NEW UNIT - 3 TON = 9 00 OVER = 16 50			2310 - 2431 PLAN REVIEW FEE		
FURNACE TO 100,000/9 00 OVER/11 00			2310 - 2431 BLDG. PERMIT FEE		
VAPORATIVE COOLER	6.50		TOTAL FEES		<u>20.00</u> <u>20.00</u>
VENTILATION FAN	2.35				
2310 - 2435	TOTAL				

RECEIPT
0002
SFD 20.00
CHK 20.00
0391A000 14:14

PERMIT NO. _____ MUST BE MACHINE VALIDATED

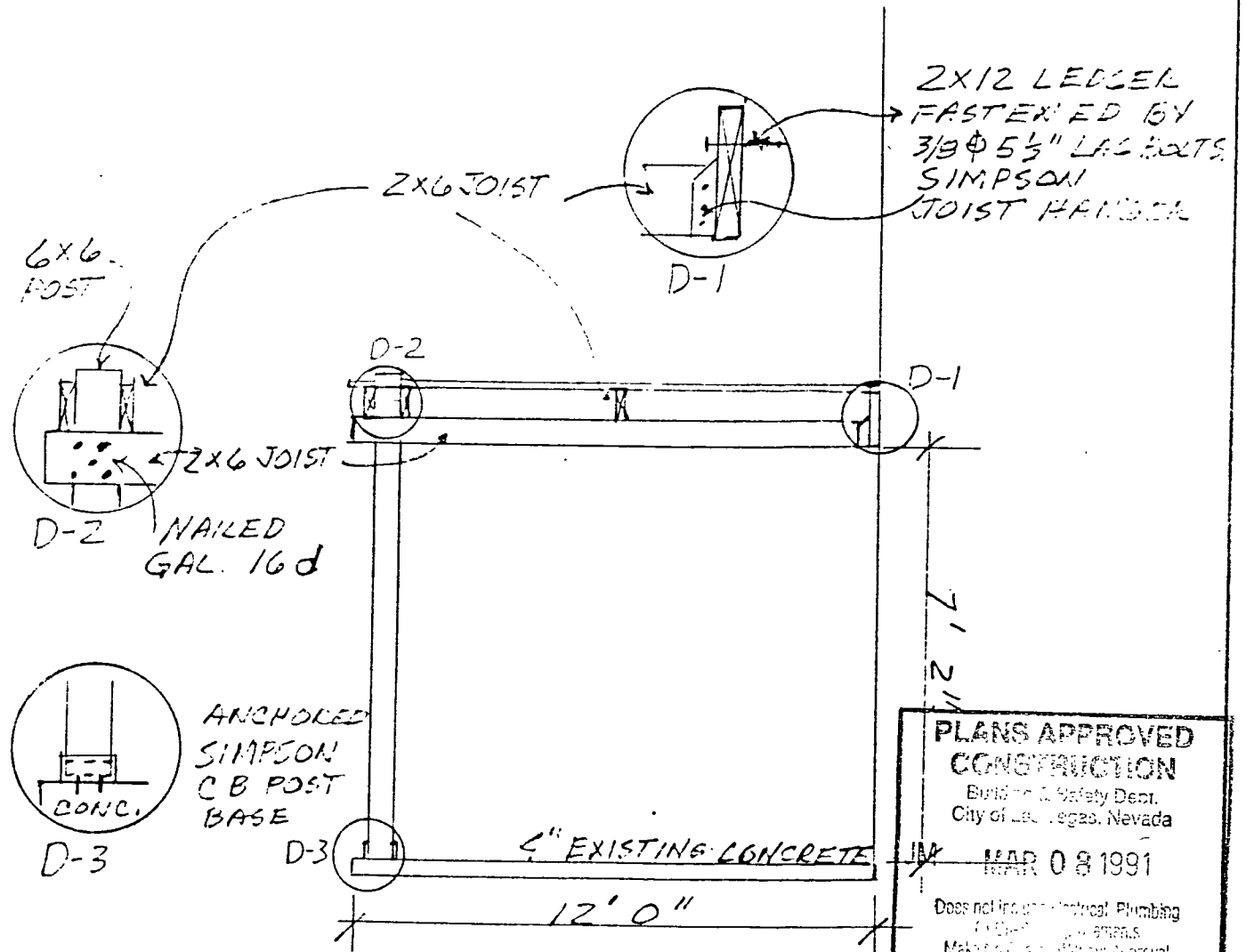
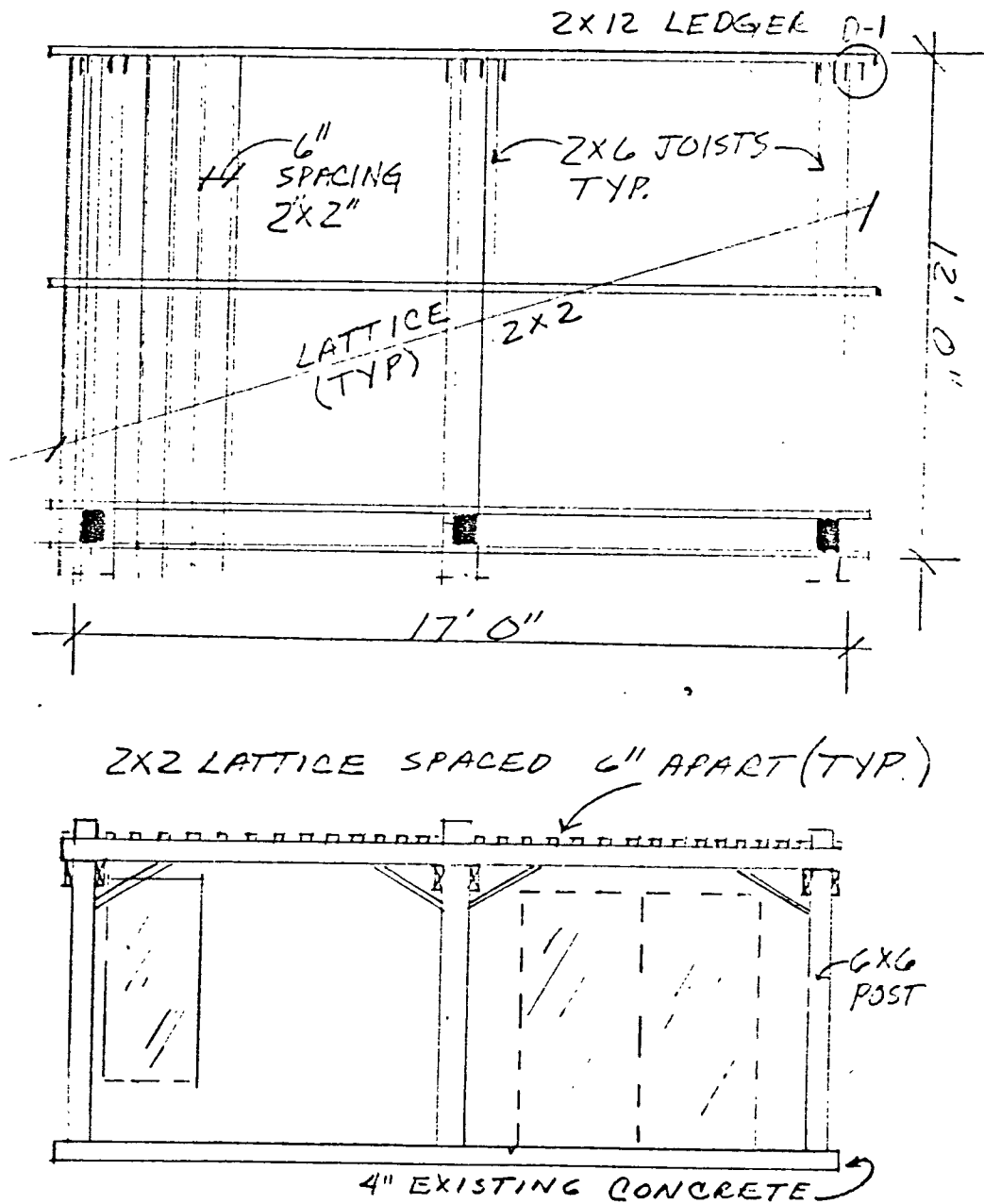

**PLANS APPROVED
CONSTRUCTION**
 Building & Safety Dept.
 City of Las Vegas, Nevada
 MAR 08 1991
 Does not include Electrical, Plumbing
 or Mechanical systems
 Make No Changes Without Approval
 Approval of Plans is Not a
 Permit To Violate Any Ordinance

WAYNECO LIC # 0026647

FOR SHARON RHOADES 3312 PARAGON ST. L.V.

DEPARTMENT OF BUILDING & SAFETY CITY OF LAS VEGAS

JOB ADDRESS 3312 Paragon			PERMIT NO 99742
LOT NO	MAP NO 12-242P	INSPECTOR 59	DATE 3-8-91
SUBDIVISION NAME		Wayne @ Wayneo	PHONE
INSPECTOR SIGNATURE [Signature]	3/11/91		INSPECTION DATE

*Pool cover please 11:00A
I can meet you at site*

PARTIAL INSPECTION - DESCRIPTION:

APPROVED **PERMIT REQUIRED** **STOP WORK**

REJECTED - CORRECTION NOTICE - REINSPECTION REQUIRED CALL 793-2071

INSPECT	DESCRIPTION	INSPECT	DESCRIPTION	INSPECT	DESCRIPTION
<input type="checkbox"/> B-1	FOOTING, LAYOUT, REBAR, ZONING	<input type="checkbox"/> P-1	ON SITE SEWER	<input type="checkbox"/> X-2	UNDERGROUND HYDRO
<input type="checkbox"/> B-2	STEM WALL - FORMS & REBAR	<input type="checkbox"/> P-2	ON SITE WATER	<input type="checkbox"/> X-3	UNDERGROUND FINAL/FLOW
<input type="checkbox"/> B-3	PRE-SLAB	<input type="checkbox"/> P-3	BUILDING SEWER (YARD LINES)	<input type="checkbox"/> X-4	SPRINKLER SYSTEM HYDRO
<input type="checkbox"/> B-4	ROOF SHEATHING	<input type="checkbox"/> P-4	UNDERSLAB PLUMBING	<input type="checkbox"/> X-5	FIRE ALARM
<input type="checkbox"/> B-5	FRAMING	<input type="checkbox"/> P-5	TOP OUT-WATER, GAS, WASTE	<input type="checkbox"/> X-6	OTHER
<input type="checkbox"/> B-6	INSULATION	<input type="checkbox"/> P-6	FINAL GAS TEST	<input type="checkbox"/> X-7	FINAL FIRE
<input type="checkbox"/> B-7	DRYWALL NAILING	<input type="checkbox"/> P-7	FINAL PLUMBING		
<input type="checkbox"/> B-8	EXTERIOR LATH/STUCCO			<input type="checkbox"/> E-1	UNDERGROUND ELETRICAL
<input type="checkbox"/> B-9	WALL GROUT & STEEL	<input type="checkbox"/> M-1	ROUGH VENT	<input type="checkbox"/> E-2	ROUGH ELECTRICAL
<input type="checkbox"/> B-10	<input type="checkbox"/> POOL PRE-GUNITE	<input type="checkbox"/> M-2	HOOD	<input type="checkbox"/> E-3	LOW VOLTAGE ELECTRICAL
<input type="checkbox"/> B-11	<input type="checkbox"/> POOL PRE-PLASTER / FINAL	<input type="checkbox"/> M-3	FINAL MECHANICAL	<input type="checkbox"/> E-4	SIGN INSPECTION
<input type="checkbox"/> B-12	BUILDING FINAL			<input type="checkbox"/> E-5	FINAL ELECTRICAL
<input type="checkbox"/> B-13	CERT OF OCC	<input type="checkbox"/> X-1	KICKER / FLUSH	<input type="checkbox"/> E-6	TEMP POWER

FINAL INSPECTION

BRING HARD CARD WITH FIRE, QUALITY CONTROL & PLANNING APPROVALS SIGNED OFF TO BLDG & SAFETY FOR C. OF O ISSUANCE (Commercial Only)

DEPARTMENT OF BUILDING & SAFETY CITY OF LAS VEGAS

JOB ADDRESS <i>3312 Paragon</i>			PERMIT NO. <i>99742</i>
LOT NO.	MAP NO. <i>12242P</i>	INSPECTOR <i>59</i>	DATE <i>3-8-91</i>
SUBDIVISION NAME <i>Wayne @ Wayneo</i>			PHONE
INSPECTOR SIGNATURE <i>B. H. S.</i>	INSPECTION DATE <i>3/11/91</i>		

*patrol cover please 11:00A
I can meet you at site*

PARTIAL INSPECTION - DESCRIPTION:

APPROVED
 PERMIT REQUIRED
 STOP WORK

REJECTED - CORRECTION NOTICE - REINSPECTION REQUIRED CALL 799-2071

INSPECT	DESCRIPTION	INSPECT	DESCRIPTION	INSPECT	DESCRIPTION
<input type="checkbox"/> B-1	FOOTING, LAYOUT, REBAR, ZONING	<input type="checkbox"/> P-1	ON SITE SEWER	<input type="checkbox"/> X-2	UNDERGROUND HYDRO
<input type="checkbox"/> B-2	STEM WALL - FORMS & REBAR	<input type="checkbox"/> P-2	ON SITE WATER	<input type="checkbox"/> X-3	UNDERGROUND FINAL/FLOW
<input type="checkbox"/> B-3	PRE-SLAB	<input type="checkbox"/> P-3	BUILDING SEWER (YARD LINES)	<input type="checkbox"/> X-4	SPRINKLER SYSTEM HYDRO
<input type="checkbox"/> B-4	ROOF SHEATHING	<input type="checkbox"/> P-4	UNDERSLAB PLUMBING	<input type="checkbox"/> X-5	FIRE ALARM
<input checked="" type="checkbox"/> B-5	FRAMING	<input type="checkbox"/> P-5	TOP OUT-WATER, GAS, WASTE	<input type="checkbox"/> X-6	OTHER.
<input type="checkbox"/> B-6	INSULATION	<input type="checkbox"/> P-6	FINAL GAS TEST	<input type="checkbox"/> X-7	FINAL FIRE
<input type="checkbox"/> B-7	DRYWALL NAILING	<input type="checkbox"/> P-7	FINAL PLUMBING		
<input type="checkbox"/> B-8	EXTERIOR LATH/STUCCO			<input type="checkbox"/> E-1	UNDERGROUND ELETRICAL
<input type="checkbox"/> B-9	WALL GROUT & STEEL	<input type="checkbox"/> M-1	ROUGH VENT	<input type="checkbox"/> E-2	ROUGH ELECTRICAL
<input type="checkbox"/> B-10	<u>POOL</u> PRE-GUNITE	<input type="checkbox"/> M-2	HOOD	<input type="checkbox"/> E-3	LOW VOLTAGE ELECTRICAL
<input type="checkbox"/> B-11	<u>POOL</u> PRE-PLASTER / FINAL	<input type="checkbox"/> M-3	FINAL MECHANICAL	<input type="checkbox"/> E-4	SIGN INSPECTION
<input checked="" type="checkbox"/> B-12	BUILDING FINAL			<input type="checkbox"/> E-5	FINAL ELECTRICAL
<input type="checkbox"/> B-13	CERT. OF OCC	<input type="checkbox"/> X-1	KICKER / FLUSH	<input type="checkbox"/> E-6	TEMP POWER

FINAL INSPECTION

BRING HARD CARD WITH FIRE, QUALITY CONTROL & PLANNING APPROVALS SIGNED OFF TO BLDG & SAFETY FOR C. of O. ISSUANCE (Commercial Only)

DEPARTMENT OF BUILDING & SAFETY CITY OF LAS VEGAS

JOB ADDRESS <i>3312 Paragon Dr</i>			PERMIT NO <i>44930-10</i>
LOT NO	MAP NO	INSPECTOR <i>65</i>	DATE
SUBDIVISION NAME <i>Harborage</i>			PHONE
INSPECTOR SIGNATURE ▶ <i>LB65</i>	INSPECTION DATE <i>7-25-89</i>		

"VISUAL" FINAL

PARTIAL INSPECTION - DESCRIPTION.

APPROVED **PERMIT REQUIRED** **STOP WORK**

REJECTED - CORRECTION NOTICE - REINSPECTION REQUIRED CALL 799-2071

INSPECT	DESCRIPTION	INSPECT	DESCRIPTION	INSPECT	DESCRIPTION
<input type="checkbox"/> B-1	FOOTING, LAYOUT, REBAR, ZONING	<input type="checkbox"/> P-1	ON SITE SEWER	<input type="checkbox"/> X-2	UNDERGROUND HYDRO
<input type="checkbox"/> B-2	STEM WALL - FORMS & REBAR	<input type="checkbox"/> P-2	ON SITE WATER	<input type="checkbox"/> X-3	UNDERGROUND FINAL/FLOW
<input type="checkbox"/> B-3	PRE-SLAB	<input type="checkbox"/> P-3	BUILDING SEWER (YARD LINES)	<input type="checkbox"/> X-4	SPRINKLER SYSTEM HYDRO
<input type="checkbox"/> B-4	ROOF SHEATHING	<input type="checkbox"/> P-4	UNDERSLAB PLUMBING	<input type="checkbox"/> X-5	FIRE ALARM
<input type="checkbox"/> B-5	FRAMING	<input type="checkbox"/> P-5	TOP OUT-WATER, GAS, WASTE	<input type="checkbox"/> X-6	OTHER
<input type="checkbox"/> B-6	INSULATION	<input type="checkbox"/> P-6	FINAL GAS TEST	<input type="checkbox"/> X-7	FINAL FIRE
<input type="checkbox"/> B-7	DRYWALL NAILING	<input type="checkbox"/> P-7	FINAL PLUMBING		
<input type="checkbox"/> B-8	EXTERIOR LATH/STUCCO			<input type="checkbox"/> E-1	UNDERGROUND ELETTRICAL
<input type="checkbox"/> B-9	WALL GROUT & STEEL	<input type="checkbox"/> M-1	ROUGH VENT	<input type="checkbox"/> E-2	ROUGH ELECTRICAL
<input type="checkbox"/> B-10	<u>POOL</u> PRE-GUNITE	<input type="checkbox"/> M-2	HOOD	<input type="checkbox"/> E-3	LOW VOLTAGE ELECTRICAL
<input type="checkbox"/> B-11	<u>POOL</u> PRE-PLASTER / FINAL	<input type="checkbox"/> M-3	FINAL MECHANICAL	<input type="checkbox"/> E-4	SIGN INSPECTION
<input checked="" type="checkbox"/> B-12	<u>BUILDING</u> FINAL			<input type="checkbox"/> E-5	FINAL ELECTRICAL
<input checked="" type="checkbox"/> B-13	CERT OF OCC	<input type="checkbox"/> X-1	KICKER / FLUSH	<input type="checkbox"/> E-6	TEMP POWER

FINAL INSPECTION

BRING HARD CARD WITH FIRE, QUALITY CONTROL & PLANNING APPROVALS SIGNED OFF TO BLDG & SAFETY FOR C. of O ISSUANCE (Commercial Only)

FOR ASSISTANCE -CALL: 386-6251