

CITY OF LAS VEGAS, NEVADA

DEPARTMENT OF BUILDING AND SAFETY
PHONE 386-6251

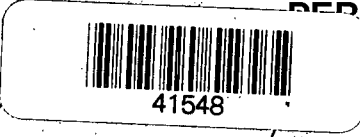

PERMIT NO. 91-108544

BUILDING PERMIT
FOR: Single Family Dwelling, Remodel
Additions, Misc. Residential Construction

LOG NO. & AREA P-178 - 91 DATE 5/15/91 CONST. VAL. \$ 46,800.00

ADDRESS OF CONSTRUCTION 1213 Goldenglow Road OWNER Lewis Homes of Nevada PHONE 736-8960

LOT(s) 1100 BLOCK R SUBDIVISION Rainbow Vista 13-B-3 & 13-C-1 "Festival" ZONE R-CL

PROPOSED CONSTRUCTION Single Family Residence USE Dwelling

THIS PERMIT FOR BLDG A/C ELEC PLBG OTHER PERMITS REQD: FENCE OFF SITE SWIM POOL

FLOOR AREA BSMT — 1ST 782 2ND 814 GARAGE 406 PORCH 21 TOTAL 2023

CONTRACTOR Lewis Homes of Nevada STATE LICENSE NO. 14761 CITY LICENSE NO. 8707

ARCHITECT Lewis Homes of Nevada ENGINEER G.C. WALLACE

MASTER PLUMBER/CONTRACTOR _____ MASTER ELECTRICIAN/CONTRACTOR _____

OTHER INSPECTIONS AND FEES

- Inspections outside of normal business hours = \$30.00 per hour (minimum charge three hours).
- Re-inspection fee during normal business hours assessed under provisions of TABLE 3-A of the Uniform Building Code = \$30.00 per hour.
- Inspections during normal business hours for which no fee is specifically indicated = \$30.00 per hour (minimum charge one half hour).
- Additional plan review required by changes, additions, or revisions to approved plans = \$30.00 per hour (minimum charge two hours).

CONDITIONS OF THE PERMIT:

- I agree to call the City Building Department for inspections before concrete is poured, before rough wiring, electrical, plumbing, framing is covered. Also for air conditioning, drywall and sheathing inspection.
- I agree that when the job is completed that I will call for final inspection before occupancy.
- I agree to perform all construction in accordance with City Ordinances and Building Codes.
- The Contractor's signature below denotes authority from the owner to sign in his behalf and that the owner is aware of all requirements of this application and permit. Separate permits must be taken out for work outlined above this agreement.
- I have read and understand the contents of this application and permit; I hereby state that the information I have supplied on this application is true and correct.
- Approval for the work under this permit will be given only after refuse and debris have been removed from job site and public right of way.
- 24 HOUR MINIMUM NOTICE REQUIRED FOR INSPECTIONS.

SPECIAL CONDITIONS:

Plan #: 6-229-m1
See plot plan

BY: _____ I HEREBY DECLARE THAT I AM THE LEGAL OWNER OF THE ABOVE PROPERTY. OWNER

BY: Sandy Norskog AGENT
Sandy Norskog - Project Coordinator

I hereby certify that I have reviewed this application and the proposed plans and have found that the proposed development meets the requirements of the City of Las Vegas Flood Hazard Reduction Ordinance for the issuance of this Development Permit.

LAND DEVELOPMENT AND FLOOD CONTROL ENGINEER [Signature] DATE 5/17/91

PLANNING DEPT. [Signature] DATE 5/29/91

BUILDING DEPT. [Signature] DATE 5/29/91

PLUMBING	FEE	ELECTRICAL	FEE
WATER DISTRIBUTION	6.00	RECEPTACLE _____ SWITCH _____	.40
SEWER SYSTEM - NEW OR MODIFICATION	10.00	EACH LIGHT FIXTURE OR SOCKET _____	.30
FIXTURES - WATER SOFTENER, H.W. HEATER	2.00	SPECIAL OUTLET, APPLIANCE ETC.	.70
GARBAGE DISPOSAL - WASHER	2.00	SERVICE/PANEL - SUB/3.00 - 200A/6.00 - 400A/12.50	
FUEL PIPING	6.00	A.C. UNIT OR MOTORS	3.00
IRRIGATION SYSTEM	8.00	2310 - 2432	TOTAL
MISC.		MISC.	
2310 - 2433	TOTAL	2310 - 2431 ISSUANCE FEE	625.00
AIR CONDITIONING	FEE	7143 - 2973 SEWER CONNECTION	10.00
NEW UNIT - 3 TON = 9.00 OVER = 16.50		2310 - 2431 PLAN REVIEW FEE	313.00
FURNACE TO 100,000/9.00 OVER/11.00		2310 - 2431 BLDG. PERMIT FEE	948.00
VAPORATIVE COOLER	6.50	TOTAL FEES	
VENTILATION FAN	2.35		
2310 - 2435	TOTAL		

RECEIPT

PERMIT NO. _____
MUST BE MACHINE VALIDATED

91-108544
41548

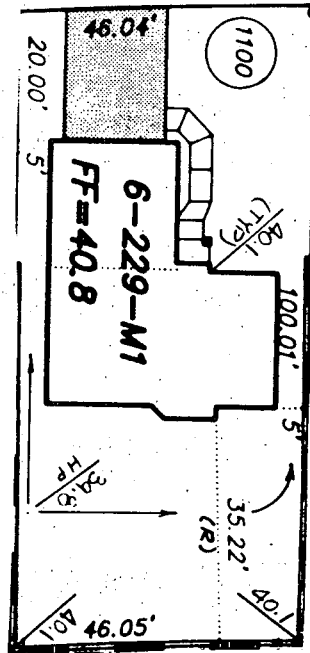

APPROVED

By: *[Signature]* 5/24/91
COMMUNITY PLANNING & DEVELOPMENT
City of Las Vegas

PLOT PLAN

LEWIS HOMES OF NEVADA

SUBDIVISION Rainbow Vista **PHASE:** 13-B-3 & 13-C-1

Lot: 1100 **Address:** 1213 Golden Glow Road
Refer to plot plan for model number.

INSTALLATION CARD

91-108544
41548

JOB ADDRESS:

Lewis Homes
QU 13-B-3 1/2 C-1
1213 Golden glow Rd

**MAGNAWALL 1-KOTE
REINFORCED STUCCO SYSTEM**

1-KOTE STUCCO PRODUCTS

ICBO Evaluation Service, Inc. Report No. 4776

Date of Job Completion: _____

PLASTERING CONTRACTOR:

Name: D.L. Peterson & Sons, Inc.

Address: 5151 Tee Pee, Las Vegas, NV
89129

Approved Contractor Number as Issued by
the Plastering Manufacturing # 30

Phone: (702) 645-4622

This is to certify that the plastering system on the building exterior at the above address has been installed in accordance with the evaluation report specified above and the manufacturer's instructions.

[Signature]
Signature of authorized representative of plastering contractor

8-2-91
Date

91-108544
41548

Lewis Homes Management Corp.

3325 Ali Baba Lane / Suite 603 / P.O. Box 19297 / Las Vegas, Nevada 89132 / (702) 736-8960

CITY OF LAS VEGAS
BUILDING DEPARTMENT
RECORDS DIVISION
400 East Stewart
Las Vegas, NV 89101

RE: Rainbow Vista
No. 13-B-3/C-1
"Festival"

GAS LOG DELAY LETTER
PERMIT #: 91-108544
LOT: 1100 BLOCK: R
ADDRESS: 1213 Goldenglow Road
DATE: 10-25-91

This is to certify that Lewis Homes of Nevada will install a gas log unit in each fireplace just prior to OR within 10 days of the new homeowner move-in.

Very truly yours,

LEWIS HOMES OF NEVADA

Leah S.W. Bryant
Regional Manager

91-108544
41548

SN

ready

TRACT SEQUENCE & PRODUCTION RELEASE SCHEDULE

10-25-91

67

LOTS - 14

LEWIS HOMES - RAINBOW VISTA NO. 13-B, PHASE 3, and

LEWIS HOMES - RAINBOW VISTA NO. 13-C, PHASE 1 "Festival"

Start Date: 6/24/91

Super: Bob Barbour

<u>Lot/Block</u>	<u>Plan No.</u>	<u>Street Address</u>	
1110/R	6-095-M2	1349 Goldenglow Road	91-108554
1109/R	6-224-M2R	1341 Goldenglow Road	91-108553
1108/R	6-933-M2	1333 Goldenglow Road	91-108552
1107/R	6-225-M2R	1325 Goldenglow Road	91-108551
1106/R	6-095-M1	1317 Goldenglow Road	91-108550
1105/R	6-933-M1R	1309 Goldenglow Road	91-108549
** build with stall shower in master bath			
1104/R	6-225-M1	1301 Goldenglow Road	91-108548
1103/R	6-229-M1R	1225 Goldenglow Road	91-108547
1102/R	6-224-M1	1221 Goldenglow Road	91-108546
1101/R	6-095-M2R	1217 Goldenglow Road	91-108545
1100/R	6-229-M1	1213 Goldenglow Road	91-108544
1099/R	6-225-M2R	1209 Goldenglow Road	91-108543
1098/R	6-933-M2	1205 Goldenglow Road	91-108542
1097/R*	6-224-M2R	1201 Goldenglow Road	91-108541

Gras Log
Delay Letters

* - Corner Lots

RV13B-3:smw:5/16/91;5/20/91:changed start date

OK. Rec'd
T.G.B.
10-28-91

CITY OF LAS VEGAS, NEVADA

PERMIT NO.

91-112052

DEPARTMENT OF BUILDING AND SAFETY
PHONE 386-6251

FOR INSPECTIONS CALL 799-2071

PLUMBING PERMIT

LOG NO. & AREA **P 178-91**



CONST. VAL. \$

ADDRESS OF CONSTRUCTION **1213 GOLDENGLOW RD. DR**

OWNER **LEWIS HOMES OF NEV.**

PHONE **873-2116**

CONTRACTOR **CARDINAL PLBG. INC.**

STATE LICENSE NO. **010848A**

CITY LICENSE NO. **05775**

LOT(s) **1100** BLOCK **R** SUBDIVISION **RAINBOW VISTA 13 B. 3 13 C 1** ZONE

PROPOSED CONSTRUCTION **R TRACT HOUSE**

USE

PLUMBING PERMIT NO.

Approval for the work under this permit will be given only after refuse and debris have been removed from job site and public right of way.

UNITS	DESCRIPTION	FEE	TOTAL
PERMIT ISSUANCE			
1	For Issuing Each Permit	10.00	10.00
	For Issuing Each Supplemental Permit	4.50	
FIXTURE CHARGE			
9	Bathtub, Shower, Lavatory, Toilet, Urinal	EA. 2.00	18.00
2	Floor Drain, Floor Sink, Wash Tray, Sink	EA. 2.00	4.00
1	Garbage Disposal, Clothes Washer, Dishwasher (residential)	EA. 2.00	2.00
	Garbage Disposal (commercial)	EA. 8.00	
	Clothes Washer, Dishwasher (commercial)	EA. 2.00	
	Clothes Dryer (gas) (venting)	2.00	
	Dental Unit	8.00	
	Drinking Fountain	2.00	
	Refrigerator - Ice Maker, Water Dispenser	2.00	
	Any other water using equipment, Attached Coffee Makers, Ice Makers	2.00	
1	Hot Water Heater (Gas or Electric)	EA. 2.00	2.00
SEWER SYSTEM			
1	New, Replacement, Modification, or Any Drainage Work	10.00	10.00
	Grease or Sand Trap or Interceptor	2.00	
	Trailer Trap (rental parks)	5.00	
WATER SOFTENERS			
	Non Permanent Type (rental)	2.00	
	Permanent Type (connected to drain)	2.00	
WATER DISTRIBUTION SYSTEM			
1	Single Family Dwelling	6.00	6.00
	Multi-Family Dwelling	6.00	
	Plus Each Dwelling Unit	3.00	
	Commercial Building per floor	3.00	
	Plus Each Unit (leased space or office)	2.00	
	Hotel or Motel	8.00	
	Plus Each Unit	3.00	
	Trailer Park	30.00	
	Plus Each Space	2.00	
	Irrigation Single Family Dwelling	8.00	
	Irrigation Commercial Fee Based on Building Code Valuation Chart Construction Valuation		

UNITS	DESCRIPTION	FEE	TOTAL
FUEL PIPING SYSTEM			
1	Single Family Dwelling	6.00	6.00
	Multi-Family Dwelling	10.00	
	Plus Each Unit	2.00	
	Commercial Building (per floor)	6.00	
	Plus Each Unit (leased space or office)	6.00	
	Medium Pressure System (Plan Check)	12.00	
4	Each Gas Appliance (Any Type)	2.00	8.00
	Steam Boilers	5.00	
SOLAR ENERGY SYSTEMS			
	Collectors (including piping) (per collector)	5.00	
	Storage Tanks (each)	5.00	
PIPELINE CONTRACT			
	For Onsite Sewer, Gas or Water Contract Value Fee based on Building Code Permit Valuation Chart		
OTHER INSPECTIONS AND FEES:			
	Inspections outside of normal business hours (minimum charge—three hours)	25.00 per hour	
	Under provisions of Table 3-A of the Uniform Building Code, work which has been inspected once and not approved may be subject to a Reinspection Fee not less than \$30.00 per each inspection during business hours.	30.00 each	
	Additional plan review required by changes. Additions to or revisions to approved plans (minimum charge: two hours).	30.00 per hour	
	Plumbing permit fees may be computed the same as building permit fees by using the cost of installation for valuation amount when such work is not included in the above schedule.		
	Construction Valuation		

I hereby certify that I have carefully examined and read the above application; that the same is true and correct; and that the work herein described is to be done in accordance with all the provisions of the applicable Ordinances of the City of Las Vegas, Nevada and the State Laws, whether herein specified or not.

SIGNED CONTRACTOR MASTER CARD NO.

BY _____ Registered Master Plumber, Spec. Cont'r, or Owner

BUILDING DEPT. DATE **6/20/91**

FOR INSPECTIONS CALL 799-2071

SEWER # 7114-3654 CONNECTION

FIXTURES X

FEE **66.00**

2310-2403 PERMIT FEE

TOTAL FEES **66.00**

RECEIPT

PERMIT NO. _____

MUST BE MACHINE VALIDATED

CITY OF LAS VEGAS, NEVADA

PERMIT NO. 1-115508

DEPARTMENT OF BUILDING AND SAFETY
PHONE 386-6251



071

ELECTRICAL PERMIT

91-115508

LOG NO. & AREA P 178-91

DATE 10/11/01

CONST. VAL. \$ _____

ADDRESS OF CONSTRUCTION 1213 Goldenglow Rd. #200 OWNER Lewis Homes

CONTRACTOR JOHNSON ELECTRIC STATE LICENSE NO. 21520 CITY LICENSE NO. 26363

Michael Johnson (PRINT NAME OF MASTER ELECTRICIAN) MASTER CARD NO. 69 PHONE 739-7781

PROPOSED CONSTRUCTION: New SFR Plan 229 R/V 13B-3 USE: _____

ELECTRIC PERMIT NO. _____

Approval for the work under this permit will be given only after refuse and debris have been removed from job site and public right of way.

UNITS	DESCRIPTION	FEE	TOTAL
PERMIT ISSUANCE			
1	For Issuing Each Permit	10.00	10.00
	Supplemental Fee	4.50	
APPLIANCE CHARGE			
Residential or General Commercial			
45	Receptacle <u>32</u> Switch <u>13</u>	.40	18.00
10	Each Light Fixture, Socket, or Exit Light, Smoke Detector or Exhaust Fan	.30	3.00
6	EACH OUTLET FOR SPECIAL PURPOSE: Dishwasher, Garbage Grinder, Trash Compactor, G.F.I., Clothes Washer, Dryer, Electric Range, Ovens, Water Heater, Space Heater, Blast Coil Heater, (PER K.W.), Mercury Lamp, Quartz Lamp, Sodium Lamp, 20AMP Sign Circuit.	.70	4.20
	X-Ray Unit	10.00	
	Area Lighting (First 3,000 Watts)	8.00	
	Each Additional 1,000 Watts	3.00	
MOTORS (1 H.P. AND OVER) TRANSFORMERS, ELEVATORS, WELDERS, GENERATORS, CHILLERS, SIGNS AND A/C UNITS (OVER 5 TONS)			
	First H.P. or Ton For each Unit	3.00	
	First KVA For Each Unit	3.00	
	Each Additional H.P., Ton or KVA up to 50	.50	
	Each Additional H.P., Ton or KVA over 50	.35	
	Temporary power or Pole	6.00	
ELECTRIC SERVICE OR MAIN DISCONNECT			
1	Up to 200 AMP	6.00	6.00
	400 AMP And 600 AMP	12.50	
	Over 600 AMP To 1200 AMP	25.00	
	Over 1200 AMP	50.00	
	Each Additional Meter Socket	.50	
	Sub Panel, Motor Control Center Disconnect Switch, Transfer Switch (Each)	3.00	
	Swimming Pool (Residential)	20.00	
	Swimming Pool (Semi-Public)	30.00	
	Spas	8.00	
	Recreational Vehicle Spaces (Each)	3.00	

UNITS	DESCRIPTION	FEE	TOTAL
	Busways-Trolley or Plug-in (Ea. 100 Ft.)	3.00	
	Gas Pumps, Dispensers (Each)	3.00	
1	Permanent A/C Unit (5 Tons or Less)	3.00	3.00
	Each Air Handler	1.00	
RESIDENTIAL LOW VOLTAGE INSTALLATIONS			
	Speaker Outlets (Each)	.30	
	Signal or Alarm Outlets (Each)	.30	
	Amplifiers	2.00	
	Control Panel	.50	
1	TV Master System	.30	.30
2	Telephone or Computer Outlet	.30	.60
OTHER INSPECTIONS AND FEES: INCLUDES ISSUANCE FEES WHEN APPLICABLE			
	Inspections outside of normal business hours (minimum charge - three hours)	30.00 per hour	
	Reinspection fee, assessed under provisions of TABLE 3-A of the Uniform Building Code = \$30.00 EACH.	30.00 each	
	Inspections for which no fee is specifically indicated (minimum charge - one-half hour).	30.00 per hour	
	Additional plan review, required by changes, additions or revisions to approved plans (minimum charge - one-half hour). After work-hours - \$30.00 per hour - minimum 1 hour.	30.00 per hour	
	Starter Permit	50.00	
CONTRACT PRICE OR COST OF INSTALLATION			
	Commercial - Burglar Alarms		
	- Music Systems		
	- Data Processing		
	- Communication		
	Conduit Only-Contract Price		
	All Misc. Electric		

I hereby certify that I have carefully examined and read the above application, that the same is true and correct, and that the work herein described is to be done in accordance with all the provisions of the applicable Ordinances of the City of Las Vegas, Nevada and the State Laws, whether herein specified or not.

Carlene Burke
SIGNED HOMEOWNER, CONTRACTOR

Gene Hooley 8/12/91
BUILDING DEPT. DATE

Permit Expires 180 Days After Abandonment of Work

Electrical permit fees may be computed the same as building permit fees by using the cost of installation for valuation amount when such work is not included in the above schedule.

2310-2432

PERMIT FEE 70% \$45.10 48.26
LESS STARTER PERMIT _____
TOTAL FEES 48.26

RECEIPT
PERMIT NO. _____
MUST BE MACHINE VALIDATED

CITY OF LAS VEGAS, NEVADA

PERMIT NO: 1-119552

DEPARTMENT OF BUILDING AND SAFETY
PHONE 386-6251



71

AIR CONDITIONING PERMIT

LOG NO. & AREA

P-178-91

57259

CONST. VAL. \$:

ADDRESS OF CONSTRUCTION

1213 Goldenglow Rd

OWNER

Lewis Homes

PHONE

312-1135

CONTRACTOR

D & H A/C

STATE LICENSE NO.

19606

CITY LICENSE NO.

23425

LOT(S)

1100

BLOCK

R

SUBDIVISION

RAINBOW VISTA B3 B

ZONE:

PROPOSED CONSTRUCTION

USE:

Approval for the work under this permit will be given only after refuse and debris have been removed from job site and public right of way.

UNITS	DESCRIPTION	FEE	TOTAL
PERMIT ISSUANCE			
1	For the issuance of each permit.	15.00	15.00
	For issuing each supplemental permit.	4.50	
UNIT FEE SCHEDULE			
	For the installation or relocation of each forced-air or gravity-type furnace or burner, including ducts and vents attached to such appliance, up to and including 100,000 Btu/h.	9.00	
	For the installation or relocation of each forced-air or gravity-type furnace or burner, including ducts and vents attached to such appliance over 100,000 Btu/h.	11.00	
	For the installation or relocation of each floor furnace, including vent.	9.00	
	For the installation or relocation of each suspended heater, recessed wall heater or floor-mounted unit heater.	9.00	
	For the installation, relocation or replacement of each appliance vent installed and not included in an appliance permit.	4.50	
	For the repair of, alteration of, or addition to each heating appliance, refrigeration unit, cooling unit, absorption unit, or each heating, cooling absorption, or evaporative cooling system, including installation of controls regulated by this code.	9.00	
1	For the installation or relocation of each boiler or compressor to and including three tons, or each absorption system to and including 100,000 Btu/h.	9.00	9.00
	For the installation or relocation of each boiler or compressor over three tons to and including 15 tons, or each absorption system over 100,000 Btu/h and including 500,000 Btu/h.	16.50	
	For the installation or relocation of each boiler or compressor over 15 tons to and including 30 tons, or each absorption system over 500,000 Btu/h to and including 1,000,000 Btu/h.	22.50	
	For the installation or relocation of each boiler or compressor over 30 tons to and including 50 tons, or for each absorption system over 1,000,000 Btu/h to and including 1,750,000 Btu/h.	33.50	
	For the installation or relocation of each boiler or refrigeration compressor over 50 tons, or each absorption system over 1,750,000 Btu/h.	56.00	

UNITS	DESCRIPTION	FEE	TOTAL
	For each air-handling unit to and including 10,000 cubic feet per minute, including ducts attached thereto. Note: This fee shall not apply to an air-handling unit which is a portion of a factory-assembled appliance, cooling unit, evaporative cooler or absorption unit for which a permit is required elsewhere in this code.	6.50	
	For each air-handling unit over 10,000 cfm.	11.00	
	For each evaporative cooler other than portable type.	6.50	
2	For each ventilation fan. COMMERCIAL RESIDENTIAL	4.50 2.35	4.70
	For each ventilation system which is not a portion of any heating or air-conditioning system authorized by a permit.	6.50	
	For the installation of each hood which is served by mechanical exhaust, including the ducts for such hood.	6.50	
	For each fire damper installed in an existing system.	4.50	
OTHER INSPECTIONS AND FEES:			
	Inspections outside of normal business hours (minimum charge - three hours.)	25.00 per hour	
	Reinspection fee assessed under provisions of TABLE 3-A of the Uniform Building Code = \$15.00 EACH.	15.00 each	
	Inspections for which no fee is specifically indicated (minimum charge - one-half hour).	30.00 per hour	
	Additional plan review required by changes, additions or revisions to approved plans (minimum charge - two hours).	30.00 per hour	
	Mechanical permit fees may be computed the same as building permit fees by using the cost of installation for valuation amount when such work is not included in the above schedule.		
	Gas piping which is directly related and necessary to the repair or replacement of heating, air conditioning, or refrigeration systems not exceeding 500,000 B.T.U.H.	6.00	

2310-2435

RECEIPT

I hereby certify that I have carefully examined and read the above application; that the same is true and correct; and that the work herein described is to be done in accordance with all the provisions of the applicable Ordinances of the City of Las Vegas, Nevada and the State Laws, whether herein specified or not.

SIGNED _____ CONTRACTOR MASTER CARD NO.

PERMIT FEE

2870

BY _____ Spec. Contr. or Owner

TOTAL FEES

3000

BUILDING DEPT.

DATE

8/26/91

MUST BE MACHINE VALIDATED