

CITY OF LAS VEGAS, NEVADA

DEPARTMENT OF BUILDING AND SAFETY
PHONE 386-6251



RMIT NO. 2071

BUILDING PERMIT
FOR: Single Family Dwelling; Remodel
Additions, Misc. Residential Construction.

90-077041
90-077041

LOG NO. & AREA 190 - 90 DATE 7-9-90 CONST. VAL \$ 55,400.00

ADDRESS OF CONSTRUCTION 6649 Golden Creek Way OWNER Metropolitan Development Co. PHONE 795-2295

LOT(s) 70 BLOCK 1 SUBDIVISION Capriana aka Sontera ZONE R-PD10

PROPOSED CONSTRUCTION SFD USE Residence

THIS PERMIT FOR: BLDG. A/C ELEC. PLBG. OTHER PERMITS REQD. FENCE OFF SITE SWIM POOL

FLOOR AREA BSMT _____ 1ST 1020 2ND 906 GARAGE 420 PORCH _____ TOTAL 2346

CONTRACTOR Metropolitan Development Company STATE LICENSE NO. 0024260 CITY LICENSE NO. C11G64216382

ARCHITECT _____ ENGINEER _____

MASTER PLUMBER/CONTRACTOR _____ MASTER ELECTRICIAN/CONTRACTOR _____

OTHER INSPECTIONS AND FEES

- Inspections outside of normal business hours = \$30.00 per hour (minimum charge three hours).
- Re-inspection fee during normal business hours assessed under provisions of TABLE 3-A of the Uniform Building Code = \$30.00 per hour.
- Inspections during normal business hours for which no fee is specifically indicated = \$30.00 per hour (minimum charge one half hour).
- Additional plan review required by changes, additions, or revisions to approved plans = \$30.00 per hour (minimum charge two hours).

CONDITIONS OF THE PERMIT:

- I agree to call the City Building Department for inspections before concrete is poured, before rough wiring, electrical, plumbing, framing is covered. Also for air conditioning, drywall and sheathing inspection.
- I agree that when the job is completed that I will call for final inspection before occupancy.
- I agree to perform all construction in accordance with City Ordinances and Building Codes.
- The Contractor's signature below denotes authority from the owner to sign in his behalf and that the owner is aware of all requirements of this application and permit. Separate permits must be taken out for work outlined above this agreement.
- I have read and understand the contents of this application and permit; I hereby state that the information I have supplied on this application is true and correct.
- Approval for the work under this permit will be given only after refuse and debris have been removed from job site and public right of way.
- 24 HOUR MINIMUM NOTICE REQUIRED FOR INSPECTIONS.

SPECIAL CONDITIONS:

Plan CR

BY: Metropolitan Development Company

I HEREBY DECLARE THAT I AM THE LEGAL OWNER OF THE ABOVE PROPERTY OWNER _____

BY: Tracy Shady AGENT _____

I hereby certify that I have reviewed this application and the proposed plans and have found that the proposed development meets the requirements of the City of Las Vegas Flood Hazard Reduction Ordinance for the issuance of this Development Permit.

Kent Nash LAND DEVELOPMENT AND FLOOD CONTROL ENGINEER DATE 7-30-90

[Signature] PLANNING DEPT. DATE 7/30/90

[Signature] BUILDING DEPT. DATE 7/14/90

PLUMBING	FEE	ELECTRICAL	FEE
WATER DISTRIBUTION	6.00	RECEPTACLE _____ SWITCH _____	.40
SEWER SYSTEM - NEW OR MODIFICATION	10.00	EACH LIGHT FIXTURE OR SOCKET _____	.30
FIXTURES - WATER SOFTENER, H.W. HEATER	2.00	SPECIAL OUTLET, APPLIANCE ETC.	.70
GARBAGE DISPOSAL - WASHER	2.00	SERVICE/PANEL - SUB/3.00 - 200A/6.00 - 400A/12.50	
FUEL PIPING	6.00	A.C. UNIT OR MOTORS	3.00
IRRIGATION SYSTEM	8.00	2310 - 2432	TOTAL
MISC.		MISC.	
2310 - 2433	TOTAL	2310 - 2431 ISSUANCE FEE	
AIR CONDITIONING	FEE	7143 - 2973 SEWER CONNECTION	625
NEW UNIT - 3 TON = 9.00 - OVER = 16.50		2310 - 2431 PLAN REVIEW FEE	
FURNACE TO 100,000/9.00 - OVER/11.00		2310 - 2431 BLDG. PERMIT FEE	358
VAPORATIVE COOLER	6.50	TOTAL FEES	983
VENTILATION FAN	2.35		
2310 - 2435	TOTAL		

RECEIPT

PERMIT NO. _____
MUST BE MACHINE VALIDATED

Permit Expires 180 Days After Abandonment of Work

**Builders
Insulation Statement**



Plan C

99-077041

Lot 70 Blk 1 Address 6649 Golden Creek Wy 19184



Insul-Safe III[®] has been installed with the manufacturer's recommendations to provide a value of R 30 using 18 bags of insulation to cover 900 square feet of area at a minimum thickness of 11 inches.

Gary Bryson
Insulation Contractor (Sign)
Skyline Insulation
Company Name
12/20/90
Date

Builder (Sign)
Company Name
Date

Batts and Blanket

R* Value	Insulation Thickness
R-38	12"
R-30	10"
R-22	6½"
R-19	6¼"
R-13	3½"
R-11	3½"

Meets Federal Specification HH-I-521F and ASTM C-665

Fiber glass batts or rolls have been installed in accordance with the manufacturer's recommendation to provide an R-value of 30 in the ceiling, 11 in the exterior walls, 19 in the floor or crawl space perimeter.

Gary Bryson
Insulation Contractor (Sign)
Skyline Insulation
Company Name
12/20/90
Date
Builder (Sign)
Company Name
Date

Thermal Performance—Attic Blowing Application

- In accordance with the chart below, you must install the specific number of bags per 1,000 sq. ft. of net area for each R-Value listed.
- The maximum net coverage per sq. ft. must not exceed that specified for each R-Value.
- The installed insulation must be at or above the specified minimum thickness for each R-Value
- Failure to install the required minimum weight per sq. ft. of insulation at or above the minimum thickness will result in reduced R-Value.
- This product should not be mixed with other blown insulations or the thermal claims will become invalid.

"R" means resistance to heat flow. The higher the R-Value, the greater the insulation power. To get the marked R-Value, it is essential that this insulation be installed properly. If you do-it-yourself, get instructions and follow them carefully. Instructions do not come with this package.

CAUTION: RECESSED LIGHT FIXTURES—TO PREVENT OVERHEATING, DO NOT INSULATE ON TOP OR WITHIN 3" OF SUCH DEVICES. DOES NOT APPLY TO TYPE IC LIGHT FIXTURES.

R-VALUE*	BAGS PER 1000 SQ. FT.	MAXIMUM NET COVERAGE	MINIMUM WEIGHT/SQ. FT.	MINIMUM THICKNESS	INSTALLED THICKNESS
To obtain a thermal resistance (R) of:	Bags per 1000 sq. ft. of net area:	contents of bag should not cover more than: (sq. ft.)	Weight per sq. ft. of installed insulation should not be less than: (lbs.)	Should not be less than: (inches)	Should typically be within this thickness range: (inches)
R-49	34.5	29 S.F.	.857 LBS.	18"	18" - 20¾"
R-44	31.3	32 S.F.	.773 LBS.	16¼"	16¼" - 18¾"
R-38	26.3	38 S.F.	.666 LBS.	14"	14" - 16½"
R-30	20.8	48 S.F.	.523 LBS.	11"	11" - 13"
R-26	18.2	55 S.F.	.452 LBS.	9½"	9¼" - 11¼"
R-22	15.2	66 S.F.	.381 LBS.	8"	8" - 9½"
R-19	13.3	75 S.F.	.333 LBS.	7"	7" - 8½"
R-13	9.0	111 S.F.	.226 LBS.	4¾"	4¾" - 5¾"
R-11	7.6	132 S.F.	.190 LBS.	4"	4" - 4¾"

*R-Values are determined in accordance with ASTM C-687 and C-518. Conforms to Federal Specification HH-I-1030B and ASTM C-764.

Framing Adjustment

To compensate for framing members the number of bags per 1000 sq. ft. of insulatable area should be as shown below:

R-VALUE	JOISTS DIMENSIONS	BAGS/1,000 SQ. FT. 16" O.C. SPACING	BAGS/1,000 SQ. FT. 24" O.C. SPACING
R-49	2 x 4	33.8	34.0
	2 x 6	33.4	33.8
	2 x 8	33.1	33.6
R-44	2 x 4	30.6	30.8
	2 x 6	30.2	30.5
	2 x 8	29.9	30.3
R-38	2 x 4	25.7	25.8
	2 x 6	25.3	25.6
	2 x 8	25.0	25.4
R-30	2 x 4	20.2	20.4
	2 x 6	19.8	20.1
	2 x 8	19.5	19.9
R-26	2 x 4	17.5	17.7
	2 x 6	17.2	17.5
	2 x 8	16.8	17.3
R-22	2 x 4	14.5	14.7
	2 x 6	14.1	14.5
	2 x 8	13.8	14.2
R-19	2 x 4	12.7	12.9
	2 x 6	12.3	12.6
	2 x 8	12.0	12.4
R-13	2 x 4	8.3	8.5
	2 x 6	8.0	8.3
	2 x 8	7.7	8.1
R-11	2 x 4	6.9	7.1
	2 x 6	6.5	6.9
	2 x 8	6.2	6.7

CertainTeed Corporation
P.O. Box 860, Valley Forge, PA 19482

HIGHLAND



**PRODUCTS
INC.**

3650 North 40th Avenue
Phoenix, Arizona 85019
(602) 272-1575 • (602) 269-2561

THE INFORMATION BELOW TO BE SUPPLIED BY APPLICATOR
LOCATION 6649 GOLDEN CREEK DATE _____
APPLICATOR WILLMAN PLAS. INSPECTED _____
NAME E. S. R. PHONE # _____
BUILDER METRO DEV.
APPLICATOR'S # 02 LOT # _____

I hereby state that the stucco installation on this project is per manufacturer's specification and conforms to the local building requirements.

CONTRACTOR WILLMAN PLASTERING INC

One copy to builder and one copy to building department in authority.
Any misuse of this card shall invalidate any warranty, implied or otherwise. Verification of this card must be obtained by calling Highland Products, Inc., 269-2561.

The following is a COPY ONLY, not to be misconstrued as an actual warranty by Highland Products, Inc.

Highland Products, Inc. warrants the Wire-Tex Stucco System for twenty (20) years from the date of the initial application to be free from any defects which seriously affect the weather resistance of the system. Should any defects occur, Highland Products, Inc. shall make a pro-rate allowance for replacement, or pay the owner the amount of the allowance. Highland Products, Inc. shall not be liable for damages or defects resulting from misuse, natural catastrophies, casualty or other cause beyond the control of Highland Products, Inc.

This warranty does not relieve the builder of his responsibilities under the Builder's Warranty required by the National Housing Act or under any provisions applicable to special housing programs such as Low Rent Public Housing.

The above warranty applies to HUB bulleting #1074.

INSTALLATION CARD

90-077041
19184

JOB ADDRESS:

FIBREWALL™ POLYMER-FORTIFIED FIBERGLASS
REINFORCED STUCCO SYSTEM

METRO DEU.

EXPO STUCCO PRODUCTS

CAPRIANA LOT 70

ICBO Evaluation Service, Inc. Report No. 4368

6649 GOLDEN CREEK

Date of Job Completion: _____

PLASTERING CONTRACTOR:

Willmans Plastering Inc.
848 N. Lorenzi Blvd. #277
Las Vegas, NV 89107

Name: *Willmans Plastering Inc.*

Address: _____

Approved Contractor Number as Issued by
the Plastering Manufacturing 5011

Phone: () 597-9227

This is to certify that the plastering system on the building exterior at the above address has been installed in accordance with the evaluation report specified above and the manufacturer's instructions.

RW
Signature of authorized representative of plastering contractor

10-17-90
Date



EXPO 11/26/88

CITY OF LAS VEGAS, NEVADA

DEPARTMENT OF BUILDING AND SAFETY
PHONE 386-6251



MIT NO. 071

90-005875
ELECTRICAL PERMIT

LOG NO. & AREA P 190-90 DATE 10-4-90 CONST. VAL. \$ _____

ADDRESS OF CONSTRUCTION 6649 GOLDEN CR. OWNER METRO DEVEL.

CONTRACTOR SIGNORELLI ELECTRIC STATE LICENSE NO. 29340 CITY LICENSE NO. C1103569

(PRINT NAME OF MASTER ELECTRICIAN) RALPH SIGNORELLI MASTER CARD NO. M 427 PHONE 795-9540

PROPOSED CONSTRUCTION: _____ USE: _____

ELECTRIC PERMIT NO. _____

Approval for the work under this permit will be given only after refuse and debris have been removed from job site and public right of way.

UNITS	DESCRIPTION	FEE	TOTAL
PERMIT ISSUANCE			
1	For Issuing Each Permit	10.00	10.00
	Supplemental Fee	4.50	
APPLIANCE CHARGE			
Residential or General Commercial			
47	Receptacle <u>35</u> Switch <u>12</u>	40	18.00
	Each Light Fixture, Socket, or Exit Light, Smoke Detector or Exhaust Fan	.30	
6	EACH OUTLET FOR SPECIAL PURPOSE: Dishwasher, Garbage Grinder, Trash Compactor, G.F.I., Clothes Washer, Dryer, Electric Range, Ovens, Water Heater, Space Heater, Blast Coil Heater, (PER K.W.), Mercury Lamp, Quartz Lamp, Sodium Lamp, 20AMP Sign Circuit	.70	4.20
	X-Ray Unit	10.00	
	Area Lighting (First 3,000 Watts)	8.00	
	Each Additional 1,000 Watts	3.00	
MOTORS (1 H.P. AND OVER) TRANSFORMERS, ELEVATORS, WELDERS, GENERATORS, CHILLERS, SIGNS AND A/C UNITS (OVER 5 TONS)			
2	First H.P. or Ton For each Unit	3.00	6.00
	First KVA For Each Unit	3.00	
	Each Additional H.P., Ton or KVA up to 50	.50	
	Each Additional H.P., Ton or KVA over 50	.35	
	Temporary power or Pole	6.00	
ELECTRIC SERVICE OR MAIN DISCONNECT			
1	Up to 200 AMP	6.00	6.00
	400 AMP And 600 AMP	12.50	
	Over 600 AMP To 1200 AMP	25.00	
	Over 1200 AMP	50.00	
	Each Additional Meter Socket	.50	
	Sub Panel, Motor Control Center Disconnect Switch, Transfer Switch (Each)	3.00	
	Swimming Pool (Residential)	20.00	
	Swimming Pool (Semi-Public)	30.00	
	Spas	8.00	
	Recreational Vehicle Spaces (Each)	3.00	

UNITS	DESCRIPTION	FEE	TOTAL
	Busways-Trolley or Plug-in (Ea. 100 Ft.)	3.00	
	Gas Pumps, Dispensers (Each)	3.00	
	Permanent A/C Unit (5 Tons or Less)	3.00	
	Each Air Handler	1.00	
RESIDENTIAL LOW VOLTAGE INSTALLATIONS			
	Speaker Outlets (Each)	.30	
	Signal or Alarm Outlets (Each)	.30	
	Amplifiers	2.00	
	Control Panel	.50	
3	TV Master System	.30	.90
3	Telephone or Computer Outlet	.30	.90
OTHER INSPECTIONS AND FEES: INCLUDES ISSUANCE FEES WHEN APPLICABLE			
	Inspections outside of normal business hours (minimum charge - three hours)	30.00	per hour
	Reinspection fee assessed under provisions of TABLE 3-A of the Uniform Building Code = \$30.00 EACH.	30.00	each
	Inspections for which no fee is specifically indicated (minimum charge - one-half hour).	30.00	per hour
	Additional plan review required by changes, additions or revisions to approved plans (minimum charge - one-half hour). After work hours - \$30.00 per hour - minimum 1 hour.	30.00	per hour
	Starter Permit	50.00	
CONTRACT PRICE OR COST OF INSTALLATION			
	Commercial - Burglar Alarms		
	- Music Systems		
	- Data Processing		
	- Communication		
	Conduit Only - Contract Price		
	All Misc. Electric		

Electrical permit fees may be computed the same as building permit fees by using the cost of installation for valuation amount when such work is not included in the above schedule.

2310-2432 10/08/90

RECEIPT
0005
ELEC 335.70
CHEK 335.70
2883A000 09:53

I hereby certify that I have carefully examined and read the above application; that the same is true and correct; and that the work herein described is to be done in accordance with all the provisions of the applicable Ordinances of the City of Las Vegas, Nevada and the State Laws, whether herein specified or not.

SIGNED HOMEOWNER, CONTRACTOR Derek Signorelli

BUILDING DEPT. B DATE 10-5-90

Permit Expires 180 Days After Abandonment of Work

PERMIT FEE 46.80
LESS STARTER PERMIT _____
TOTAL FEES _____

PERMIT NO. _____
MUST BE MACHINE VALIDATED

LOG NO. & AREA

P 190-90

CITY



NEVADA

90-077149

CONST. VAL. \$

90-077149

DEPARTMENT OF BUILDING AND SAFETY
PHONE 386-6251

PLUMBING PERMIT

ADDRESS OF CONSTRUCTION 6649 Golden Creek Way OWNER Metropolitan Development Co. PHONE 876-6967

CONTRACTOR Imperial Plumbing, Inc. STATE LICENSE NO. 17916 CITY LICENSE NO. C11 357 2 12057

LOT(s) 70 BLOCK 1 SUBDIVISION Capriana/Sontera ZONE

PROPOSED CONSTRUCTION: New
PLUMBING PERMIT NO.

USE:

Approval for the work under this permit will be given only after refuse and debris have been removed from job site and public right of way.

UNITS	DESCRIPTION	FEE	TOTAL
PERMIT ISSUANCE			
1	For Issuing Each Permit	10.00	1000
	For Issuing Each Supplemental Permit	4.50	
FIXTURE CHARGE			
11	Bathtub, Shower, Lavatory, Toilet, Urinal EA.	2.00	2200
1	Floor Drain, Floor Sink, Wash Tray, Sink EA.	2.00	200
	Garbage Disposal, Clothes Washer, Dishwasher (residential) EA.	2.00	
	Garbage Disposal (commercial) EA.	8.00	
	Clothes Washer, Dishwasher (commercial) EA.	2.00	
	Clothes Dryer (gas) (venting)	2.00	
	Dental Unit	8.00	
	Drinking Fountain	2.00	
	Refrigerator - Ice Maker, Water Dispenser	2.00	
	Any other water using equipment, Attached Coffee Makers, Ice Makers	2.00	
1	Hot Water Heater (Gas or Electric) EA.	2.00	200
SEWER SYSTEM			
1	New, Replacement, Modification, or Any Drainage Work	10.00	1000
	Grease or Sand Trap or Interceptor	2.00	
	Trailer Trap (rental parks)	5.00	
WATER SOFTENERS			
	Non Permanent Type (rental)	2.00	
	Permanent Type (connected to drain)	2.00	
WATER DISTRIBUTION SYSTEM			
1	Single Family Dwelling	6.00	600
	Multi-Family Dwelling	6.00	
	Plus Each Dwelling Unit	3.00	
	Commercial Building per floor	3.00	
	Plus Each Unit (leased space or office)	2.00	
	Hotel or Motel	8.00	
	Plus Each Unit	3.00	
	Trailer Park	30.00	
	Plus Each Space	2.00	
	Irrigation Single Family Dwelling	8.00	
	Irrigation Commercial Fee Based on Building Code Valuation Chart		
	Construction Valuation		

UNITS	DESCRIPTION	FEE	TOTAL
FUEL PIPING SYSTEM			
1	Single Family Dwelling	6.00	600
	Multi-Family Dwelling	10.00	
	Plus Each Unit	2.00	
	Commercial Building (per floor)	6.00	
	Plus Each Unit (leased space or office)	6.00	
	Medium Pressure System (Plan Check)	12.00	
3	Each Gas Appliance (Any Type)	2.00	600
	Steam Boilers	5.00	
SOLAR ENERGY SYSTEMS			
	Collectors (including piping) (per collector)	5.00	
	Storage Tanks (each)	5.00	
PIPELINE CONTRACT			
	For Onsite Sewer, Gas or Water Contract Value. Fee based on Building Code Permit Valuation Chart.		
OTHER INSPECTIONS AND FEES:			
	Inspections outside of normal business hours (minimum charge—three hours)	25.00 per hour	
	Under provisions of Table 3-A of the Uniform Building Code, work which has been inspected once and not approved may be subject to a Reinspection Fee not less than \$30.00 per each inspection during business hours.	30.00 each	
	Additional plan review required by changes. Additions to or revisions to approved plans (minimum charge two hours).	30.00 per hour	
	Plumbing permit fees may be computed the same as building permit fees by using the cost of installation for valuation amount when such work is not included in the above schedule.		
	Construction Valuation		

FOR INSPECTIONS
CALL 799-2071

SEWER # 7114-3654
CONNECTION

RECEIPT

FIXTURES X

FEE

2310-2403
PERMIT
FEE

TOTAL
FEES

64⁰⁰

PERMIT NO.

MUST BE MACHINE VALIDATED

I hereby certify that I have carefully examined and read the above application; that the same is true and correct; and that the work herein described is to be done in accordance with all the provisions of the applicable Ordinances of the City of Las Vegas, Nevada and the State Laws, whether herein specified or not.

SIGNED CONTRACTOR MASTER CARD NO.

BY Registered Master Plumber, Spec. Contr. or Owner

BUILDING DEPT. DATE

CITY OF LAS VEGAS, NEVADA

DEPARTMENT OF BUILDING AND SAFETY
PHONE 386-6251

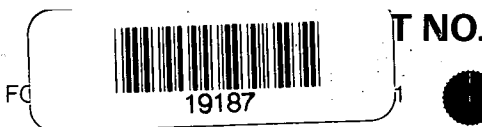

90-085495
AIR CONDITIONING PERMIT

LOG NO. & AREA P190-90 DATE 10-8-90 CONST. VAL. \$ _____
 ADDRESS OF CONSTRUCTION 6649 Golden Cr. WY OWNER Metropolitan A Ltd PHONE 293-4436
 CONTRACTOR Boulder City A/C Inc STATE LICENSE NO. 017286 CITY LICENSE NO. 023624
 LOT(S) 70 BLOCK 1 SUBDIVISION CAPRIANA PNT ZONE: _____
 PROPOSED CONSTRUCTION Residence USE: _____

Approval for the work under this permit will be given only after refuse and debris have been removed from job site and public right of way.

UNITS	DESCRIPTION	FEE	TOTAL
PERMIT ISSUANCE			
1	For the issuance of each permit.	15.00	15.00
	For issuing each supplemental permit.	4.50	
UNIT FEE SCHEDULE			
	For the installation or relocation of each forced-air or gravity-type furnace or burner, including ducts and vents, attached to such appliance, up to and including 100,000 Btu/h.	9.00	
	For the installation or relocation of each forced-air or gravity-type furnace or burner, including ducts and vents attached to such appliance over 100,000 Btu/h.	11.00	
	For the installation or relocation of each floor furnace, including vent.	9.00	
	For the installation or relocation of each suspended heater, recessed wall heater or floor-mounted unit heater.	9.00	
	For the installation, relocation or replacement of each appliance vent installed and not included in an appliance permit.	4.50	
	For the repair of, alteration of, or addition to each heating appliance, refrigeration unit, cooling unit, absorption unit, or each heating, cooling absorption, or evaporative cooling system, including installation of controls regulated by this code.	9.00	
2	For the installation or relocation of each boiler or compressor to and including three tons, or each absorption system to and including 100,000 Btu/h.	9.00	18.00
	For the installation or relocation of each boiler or compressor over three tons to and including 15 tons, or each absorption system over 100,000 Btu/h and including 500,000 Btu/h.	16.50	
	For the installation or relocation of each boiler or compressor over 15 tons to and including 30 tons, or each absorption system, over 500,000 Btu/h to and including 1,000,000 Btu/h.	22.50	
	For the installation or relocation of each boiler or compressor over 30 tons to and including 50 tons, or for each absorption system over 1,000,000 Btu/h to and including 1,750,000 Btu/h.	33.50	
	For the installation or relocation of each boiler or refrigeration compressor over 50 tons, or each absorption system over 1,750,000 Btu/h.	56.00	

UNITS	DESCRIPTION	FEE	TOTAL
	For each air-handling unit to and including 10,000 cubic feet per minute, including ducts attached thereto. Note: This fee shall not apply to an air-handling unit which is a portion of a factory-assembled appliance, cooling unit, evaporative cooler or absorption unit for which a permit is required elsewhere in this code.	6.50	
	For each air-handling unit over 10,000 cfm.	11.00	
	For each evaporative cooler other than portable type.	6.50	
2	For each ventilation fan. COMMERCIAL RESIDENTIAL	4.50 2.35	4.70
	For each ventilation system which is not a portion of any heating or air-conditioning system authorized by a permit.	6.50	
	For the installation of each hood which is served by mechanical exhaust, including the ducts for such hood.	6.50	
	For each fire damper installed in an existing system.	4.50	

OTHER INSPECTIONS AND FEES:			
	Inspections outside of normal business hours (minimum charge - three hours.)	25.00	per hour
	Reinspection fee assessed under provisions of TABLE 3-A of the Uniform Building Code = \$15.00 EACH.	15.00	each
	Inspections for which no fee is specifically indicated (minimum charge - one-half hour).	30.00	per hour
	Additional plan review required by changes, additions or revisions to approved plans (minimum charge - two hours).	30.00	per hour
	Mechanical permit fees may be computed the same as building permit fees by using the cost of installation for valuation amount when such work is not included in the above schedule.		
	Gas piping which is directly related and necessary to the repair or replacement of heating, air conditioning, or refrigeration systems not exceeding 500,000 B.T.U.H.	6.00	

2310-2405

RECEIPT

PERMIT FEE _____

TOTAL FEES 37.70

MUST BE MACHINE VALIDATED

I hereby certify that I have carefully examined and read the above application; that the same is true and correct; and that the work herein described is to be done in accordance with all the provisions of the applicable Ordinances of the City of Las Vegas, Nevada and the State Laws, whether herein specified or not.

SIGNED Boulder City A/C Inc CONTRACTOR MASTER CARD NO. _____
 BY David J. [Signature] Spec. Cont'r. or Owner
Don Hoelsy BUILDING DEPT. DATE 10/10/90

CITY OF LAS VEGAS, NEVADA

DEPARTMENT OF BUILDING AND SAFETY
PHONE 386-6251

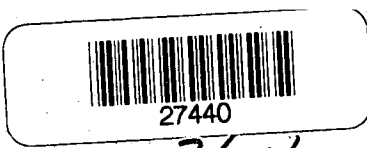

PERMIT NO. 91-098359

PLUMBING PERMIT

LOG NO. & AREA

P190-90

DATE

2/13/91

CONST. VAL. \$

ADDRESS OF CONSTRUCTION

6649 Golden Creek Way, OWNER: Metropolitan Dev.

PHONE 252-7017

CONTRACTOR

Gothic Landscaping

STATE LICENSE NO.

6028435

CITY LICENSE NO.

C1102023 2030274

LOT(S)

70

BLOCK

1

SUBDIVISION

Capriana

ZONE:

PROPOSED CONSTRUCTION:

Irrigation

USE:

PLUMBING PERMIT NO.

Approval for the work under this permit will be given only after refuse and debris have been removed from job site and public right of way.

UNITS	DESCRIPTION	FEE	TOTAL
PERMIT ISSUANCE			
1	For Issuing Each Permit	10.00	10.00
	For Issuing Each Supplemental Permit	4.50	
FIXTURE CHARGE			
	Bathtub, Shower, Lavatory, Toilet, Urinal	EA. 2.00	
	Floor Drain, Floor Sink, Wash Tray, Sink	EA. 2.00	
	Garbage Disposal, Clothes Washer, Dishwasher (residential)	EA. 2.00	
	Garbage Disposal (commercial)	EA. 8.00	
	Clothes Washer, Dishwasher (commercial)	EA. 2.00	
	Clothes Dryer (gas) (venting)	2.00	
	Dental Unit	8.00	
	Drinking Fountain	2.00	
	Refrigerator - Ice Maker, Water Dispenser	2.00	
	Any other water using equipment; Attached Coffee Makers, Ice Makers	2.00	
	Hot Water Heater (Gas or Electric)	EA. 2.00	
SEWER SYSTEM			
	New, Replacement, Modification, or Any Drainage Work	10.00	
	Grease or Sand Trap or Interceptor	2.00	
	Trailer Trap (rental parks)	5.00	
WATER SOFTENERS			
	Non Permanent Type (rental)	2.00	
	Permanent Type (connected to drain)	2.00	
WATER DISTRIBUTION SYSTEM			
	Single Family Dwelling	6.00	
	Multi-Family Dwelling	6.00	
	Plus Each Dwelling Unit	3.00	
	Commercial Building per floor	3.00	
	Plus Each Unit (leased space or office)	2.00	
	Hotel or Motel	8.00	
	Plus Each Unit	3.00	
	Trailer Park	30.00	
	Plus Each Space	2.00	
	Irrigation Single Family Dwelling	8.00	8.00
	Irrigation Commercial Fee Based on Building Code Valuation Chart Construction Valuation		18.00

UNITS	DESCRIPTION	FEE	TOTAL
FUEL PIPING SYSTEM			
	Single Family Dwelling	6.00	
	Multi-Family Dwelling	10.00	
	Plus Each Unit	2.00	
	Commercial Building (per floor)	6.00	
	Plus Each Unit (leased space or office)	6.00	
	Medium Pressure System (Plan Check)	12.00	
	Each Gas Appliance (Any Type)	2.00	
	Steam Boilers	5.00	
SOLAR ENERGY SYSTEMS			
	Collectors (including piping) (per collector)	5.00	
	Storage Tanks (each)	5.00	
PIPELINE CONTRACT			
	For Onsite Sewer, Gas or Water Contract Value. Fee based on Building Code Permit Valuation Chart.		
OTHER INSPECTIONS AND FEES:			
	Inspections outside of normal business hours (minimum charge—three hours).	25.00 per hour	
	Under provisions of Table 3-A of the Uniform Building Code, work which has been inspected once and not approved may be subject to a Reinspection Fee not less than \$30.00 per each inspection during business hours.	30.00 each	
	Additional plan review required by changes. Additions to or revisions to approved plans (minimum charge two hours).	30.00 per hour	
	Plumbing permit fees may be computed the same as building permit fees by using the cost of installation for valuation amount when such work is not included in the above schedule.		
	Construction Valuation		

**FOR INSPECTIONS
CALL 799-2071**

SEWER # 7.114-3654
CONNECTION

RECEIPT

I hereby certify that I have carefully examined and read the above application; that the same is true and correct; and that the work herein described is to be done in accordance with all the provisions of the applicable Ordinances of the City of Las Vegas, Nevada and the State Laws, whether herein specified or not.

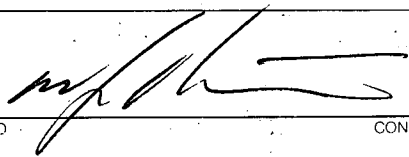
SIGNED  CONTRACTOR MASTER CARD NO

BY _____ Registered Master Plumber, Spec. Contr. or Owner

BUILDING DEPT.  DATE 2/13/91

FIXTURES X

FEE

2310-2403
PERMIT FEE

TOTAL FEES

18.00

PERMIT NO.

CITY OF LAS VEGAS, NEVADA

PERMIT NO. 91-110228

DEPARTMENT OF BUILDING AND SAFETY
PHONE 386-6251

FOR INSPECTIONS, CALL 799-2071

BUILDING PERMIT
FOR: Single Family Dwelling, Remodel
Additions, Misc. Residential Construction

LOG NO. & AREA M-4594-91

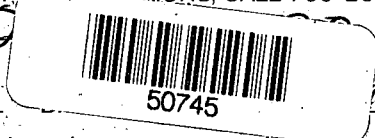

CONST. VAL \$ 726.00

ADDRESS OF CONSTRUCTION 6649 GoldenCreek Wy

OWNER Maie W Hall

PHONE 656 0196

LOT(s) 70 BLOCK 1 SUBDIVISION Mid Southern

ZONE _____

PROPOSED CONSTRUCTION PATIO

USE _____

THIS PERMIT FOR BLDG. A/C ELEC. PLBG.

OTHER PERMITS REQD: FENCE OFF SITE SWIM POOL

FLOOR AREA BSMT _____ 1ST _____ 2ND _____ GARAGE _____ PORCH _____ TOTAL 121

CONTRACTOR owner

STATE LICENSE NO. _____ CITY LICENSE NO. _____

ARCHITECT _____ ENGINEER _____

MASTER PLUMBER/CONTRACTOR _____ MASTER ELECTRICIAN/CONTRACTOR TDK

OTHER INSPECTIONS AND FEES

- Inspections outside of normal business hours = \$30.00 per hour (minimum charge three hours).
- Re-inspection fee during normal business hours assessed under provisions of TABLE 3-A of the Uniform Building Code = \$30.00 per hour.
- Inspections during normal business hours for which no fee is specifically indicated = \$30.00 per hour (minimum charge one half hour).
- Additional plan review required by changes, additions, or revisions to approved plans = \$30.00 per hour (minimum charge two hours).

CONDITIONS OF THE PERMIT:

- I agree to call the City Building Department for inspections before concrete is poured, before rough wiring, electrical, plumbing, framing is covered. Also for air conditioning, drywall and sheathing inspection.
- I agree that when the job is completed that I will call for final inspection before occupancy.
- I agree to perform all construction in accordance with City Ordinances and Building Codes.
- The Contractor's signature below denotes authority from the owner to sign in his behalf and that the owner is aware of all requirements of this application and permit. Separate permits must be taken out for work outlined above this agreement.
- I have read and understand the contents of this application and permit; I hereby state that the information I have supplied on this application is true and correct.
- Approval for the work under this permit will be given only after refuse and debris have been removed from job site and public right of way.
- 24 HOUR MINIMUM NOTICE REQUIRED FOR INSPECTIONS.

BY: Maie Hall
I HEREBY DECLARE THAT I AM THE LEGAL OWNER OF THE ABOVE PROPERTY OWNER

BY: _____ AGENT

I hereby certify that I have reviewed this application and the proposed plans and have found that the proposed development meets the requirements of the City of Las Vegas Flood Hazard Reduction Ordinance for the issuance of this Development Permit.

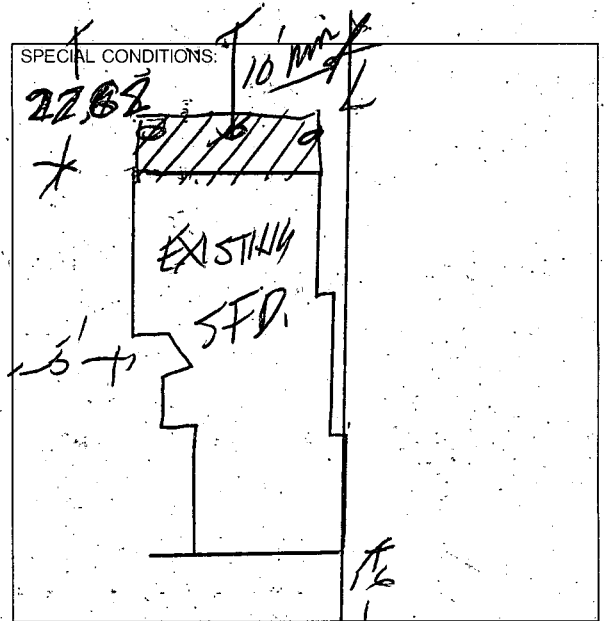

LAND DEVELOPMENT AND FLOOD CONTROL ENGINEER _____ DATE 6/17/91

PLANNING DEPT. _____ DATE _____
Ivana Hosh 6/17/91

BUILDING DEPT. _____ DATE _____

PLUMBING		FEE	ELECTRICAL		FEE
WATER DISTRIBUTION	6.00		RECEPTACLE _____ SWITCH _____	.40	
SEWER SYSTEM - NEW OR MODIFICATION	10.00		EACH LIGHT FIXTURE OR SOCKET _____	.30	
FIXTURES - WATER SOFTENER, H.W. HEATER	2.00		SPECIAL OUTLET, APPLIANCE ETC.	.70	
GARBAGE DISPOSAL - WASHER	2.00		SERVICE/PANEL - SUB / 3.00 - 200A / 6.00 - 400A / 12.50		
FUEL PIPING	6.00		A.C. UNIT OR MOTORS	3.00	
IRRIGATION SYSTEM	8.00		2310 - 2432	TOTAL	
MISC.			MISC.		
2310 - 2433	TOTAL		2310 - 2431 ISSUANCE FEE		
AIR CONDITIONING	FEE		7143 - 2973 SEWER CONNECTION		
NEW UNIT - 3 TON = 9.00 OVER = 16.50			2310 - 2431 PLAN REVIEW FEE		
FURNACE TO 100,000/9.00 OVER/11.00			2310 - 2431 BLDG. PERMIT FEE	<u>18.00</u>	
VAPORATIVE COOLER	6.50		TOTAL FEES		
VENTILATION FAN	2.35				
2310 - 2435	TOTAL				

RECEIPT
SFD 18.00
CASH 18.00
6414A000 14:06

PERMIT NO. _____ MUST BE MACHINE VALIDATED

Permit Expires 180 Days After Abandonment of Work