

CITY OF LAS VEGAS, NEVADA

DEPARTMENT OF BUILDING AND SAFETY
PHONE 386-6251

PERMIT NO. **91-093484**



071

BUILDING PERMIT
FOR: Single Family Dwelling, Remodel
Additions, Misc. Residential Construction

LOG NO. & AREA T-115 DATE 12/20/90 CONST. VAL \$ 42,400.00

ADDRESS OF CONSTRUCTION 9605 Gold Bank Drive OWNER Del Webb Corporation PHONE 363-2111

LOT(s) 74 BLOCK 2 SUBDIVISION Sun City Summerlin #22 ZONE P.C.

PROPOSED CONSTRUCTION S.F.D. W/FP. USE Residential

THIS PERMIT FOR BLDG. A/C ELEC. PLBG OTHER PERMITS REQD: FENCE OFF SITE SWIM POOL

FLOOR AREA BSMT N/A 1ST 1356 2ND N/A GARAGE 516 PORCH 126 TOTAL 1998

CONTRACTOR Del Webb Corporation STATE LICENSE NO. 0026603 CITY LICENSE NO. C11-02622-2036077

ARCHITECT Walter J. Richardson ENGINEER G.C. Wallace

MASTER PLUMBER/CONTRACTOR Imperial Plumbing MASTER ELECTRICIAN/CONTRACTOR Roberts Electric

OTHER INSPECTIONS AND FEES

1. Inspections outside of normal business hours = \$30.00 per hour (minimum charge three hours).
2. Re-inspection fee during normal business hours assessed under provisions of TABLE 3-A of the Uniform Building Code = \$30.00 per hour.
3. Inspections during normal business hours for which no fee is specifically indicated = \$30.00 per hour (minimum charge one-half hour).
4. Additional plan review required by changes, additions, or revisions to approved plans = \$30.00 per hour (minimum charge two hours).

CONDITIONS OF THE PERMIT:

1. I agree to call the City Building Department for inspections before concrete is poured, before rough wiring, electrical, plumbing, framing is covered. Also for air conditioning, drywall and sheathing inspection.
2. I agree that when the job is completed that I will call for final inspection before occupancy.
3. I agree to perform all construction in accordance with City Ordinances and Building Codes.
4. The Contractor's signature below denotes authority from the owner to sign in his behalf and that the owner is aware of all requirements of this application and permit. Separate permits must be taken out for work outlined above this agreement.
5. I have read and understand the contents of this application and permit; I hereby state that the information I have supplied on this application is true and correct.
6. Approval for the work under this permit will be given only after refuse and debris have been removed from job site and public right of way.
7. 24 HOUR MINIMUM NOTICE REQUIRED FOR INSPECTIONS.

SPECIAL CONDITIONS:

H4103C

BY: [Signature] I HEREBY DECLARE THAT I AM THE LEGAL OWNER OF THE ABOVE PROPERTY OWNER

BY: [Signature] AGENT

I hereby certify that I have reviewed this application and the proposed plans and have found that the proposed development meets the requirements of the City of Las Vegas Flood Hazard Reduction Ordinance for the issuance of this Development Permit.

LAND DEVELOPMENT AND FLOOD CONTROL ENGINEER [Signature] DATE 12/28/90

PLANNING DEPT. [Signature] DATE 12/21/90

BUILDING DEPT. [Signature] DATE 12/21/90

RECEIPT

PERMIT NO. _____
MUST BE MACHINE VALIDATED

PLUMBING		FEE	ELECTRICAL		FEE
WATER DISTRIBUTION	6.00		RECEPTACLE	SWITCH	.40
SEWER SYSTEM - NEW OR MODIFICATION	10.00		EACH LIGHT FIXTURE OR SOCKET		.30
FIXTURES - WATER SOFTENER, H.W. HEATER	2.00		SPECIAL OUTLET, APPLIANCE ETC.		.70
GARBAGE DISPOSAL - WASHER	2.00		SERVICE/PANEL - SUB/3.00-200A/6.00-400A/12.50		
FUEL PIPING	6.00		A.C. UNIT OR MOTORS		3.00
IRRIGATION SYSTEM	8.00		2310-2432	TOTAL	
MISC.			MISC.		
2310-2433	TOTAL		2310-2431 ISSUANCE FEE		625.00
AIR CONDITIONING		FEE	7.143-2973 SEWER CONNECTION		
NEW UNIT - 3 TON = 9.00 OVER = 16.50			2310-2431 PLAN REVIEW FEE		302.00
FURNACE TO 100,000/9.00 OVER/11.00			2310-2431 BLDG. PERMIT FEE		
VAPORATIVE COOLER	6.50		TOTAL FEES		927.00
VENTILATION FAN	2.35				
2310-2435	TOTAL				

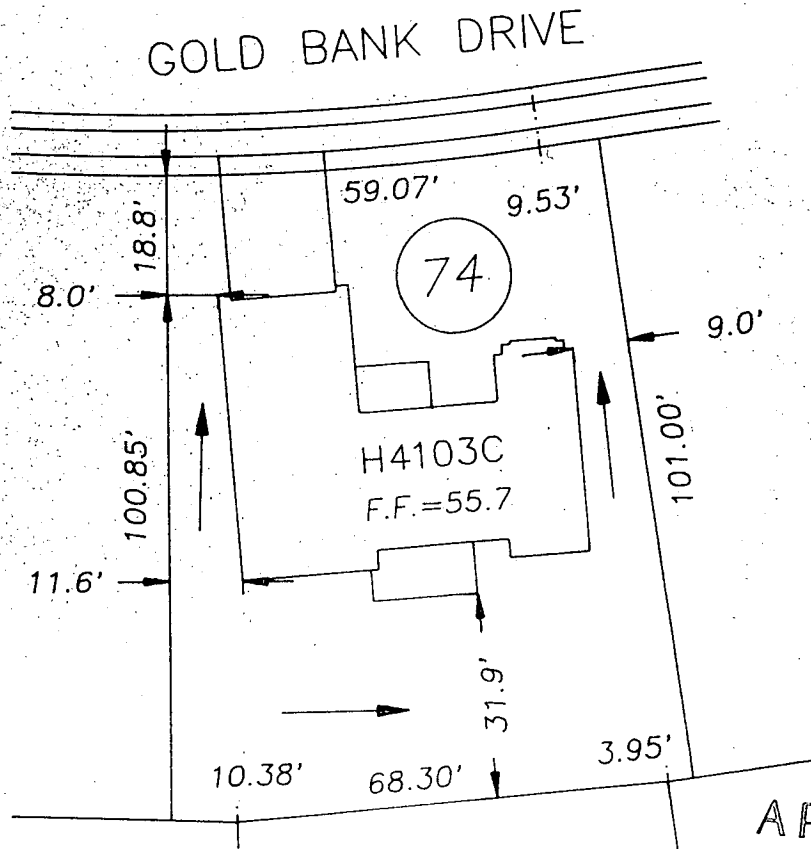

APPROVED

[Signature]
 COMMUNITY PLANNING & DEVELOPMENT
 City of Las Vegas

12/25/91
 ACCORDANCE WITH
 CONSTRUCTION
 SEQUENCE SCHEDULE
 DATED 1/4/91

PLOT PLAN

SCALE: 1" = 30'

THIS PLOT PLAN IS TENTATIVE,
 AND SUBJECT TO CHANGE
 PENDING FINAL GOVERNMENTAL
 APPROVAL.

CONSULT THE RECORDED
 SUBDIVISION PLAT FOR
 ACCURATE LOT SIZE AND
 BOUNDARY INFORMATION.

SUN CITY LAS VEGAS, NEVADA UNIT #22
 LOT 74 PLAN H4103C ADDRESS 9605 Gold Bank Drive
 DEL E. WEBB COMMUNITIES

CITY OF LAS VEGAS, NEVADA

DEPARTMENT OF BUILDING AND SAFETY
PHONE 386-6251

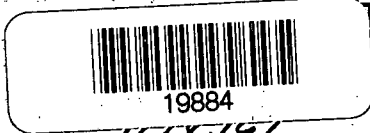

T-NO 91-094973

PLUMBING PERMIT

LOG NO. & AREA T115 DATE 11/8/91 CONST. VAL. \$ _____

ADDRESS OF CONSTRUCTION 9605 Gold Bank Drive OWNER DeJ Webb PHONE 876-5952

CONTRACTOR Cox & Sons Plumbing & Heating STATE LICENSE NO. 7596A CITY LICENSE NO. 10100

LOT(s) 74 BLOCK _____ SUBDIVISION Sun City Summerlin ZONE _____

PROPOSED CONSTRUCTION: SFD USE: RES
PLUMBING PERMIT NO. _____

Approval for the work under this permit will be given only after refuse and debris have been removed from job site and public right of way.

UNITS	DESCRIPTION	FEE	TOTAL
PERMIT ISSUANCE			
1	For Issuing Each Permit	10.00	10.00
	For Issuing Each Supplemental Permit	4.50	
FIXTURE CHARGE			
6	Bathub, Shower, Lavatory, Toilet, Urinal	EA. 2.00	12.00
1	Floor Drain, Floor Sink, Wash Tray, Sink	EA. 2.00	2.00
3	Garbage Disposal, Clothes Washer, Dishwasher (residential)	EA. 2.00	6.00
	Garbage Disposal (commercial)	EA. 8.00	
	Clothes Washer, Dishwasher (commercial)	EA. 2.00	
	Clothes Dryer (gas) (venting)	2.00	
	Dental Unit	8.00	
	Drinking Fountain	2.00	
1	Refrigerator - Ice Maker, Water Dispenser	2.00	2.00
	Any other water using equipment, Attached Coffee Makers, Ice Makers	2.00	
1	Hot Water Heater (Gas or Electric)	EA. 2.00	2.00
SEWER SYSTEM			
1	New, Replacement, Modification, or Any Drainage Work	10.00	10.00
	Grease or Sand Trap or Interceptor	2.00	
	Trailer Trap (rental parks)	5.00	
WATER SOFTENERS			
	Non Permanent Type (rental)	2.00	
	Permanent Type (connected to drain)	2.00	
WATER DISTRIBUTION SYSTEM			
1	Single Family Dwelling	6.00	6.00
	Multi-Family Dwelling	6.00	
	Plus Each Dwelling Unit	3.00	
	Commercial Building per floor	3.00	
	Plus Each Unit (leased space or office)	2.00	
	Hotel or Motel	8.00	
	Plus Each Unit	3.00	
	Trailer Park	30.00	
	Plus Each Space	2.00	
	Irrigation Single Family Dwelling	8.00	
	Irrigation Commercial Fee Based on Building Code Valuation Chart Construction Valuation _____		

UNITS	DESCRIPTION	FEE	TOTAL
FUEL PIPING SYSTEM			
1	Single Family Dwelling	6.00	6.00
	Multi-Family Dwelling	10.00	
	Plus Each Unit	2.00	
	Commercial Building (per floor)	6.00	
	Plus Each Unit (leased space or office)	6.00	
	Medium Pressure System (Plan Check)	12.00	
	Each Gas Appliance (Any Type)	2.00	
	Steam Boilers	5.00	
SOLAR ENERGY SYSTEMS			
	Collectors (including piping) (per collector)	5.00	
	Storage Tanks (each)	5.00	
PIPELINE CONTRACT			
	For Onsite Sewer, Gas or Water Contract Value. Fee based on Building Code Permit Valuation Chart.		
OTHER INSPECTIONS AND FEES:			
	Inspections outside of normal business hours (minimum charge—three hours)	25.00 per hour	
	Under provisions of Table 3-A of the Uniform Building Code, work which has been inspected once and not approved may be subject to a Reinspection Fee not less than \$30.00 per each inspection during business hours.	30.00 each	
	Additional plan review required by changes. Additions to or revisions to approved plans (minimum charge two hours).	30.00 per hour	
	Plumbing permit fees may be computed the same as building permit fees by using the cost of installation for valuation amount when such work is not included in the above schedule.		
	Construction Valuation _____		

I hereby certify that I have carefully examined and read the above application; that the same is true and correct, and that the work herein described is to be done in accordance with all the provisions of the applicable Ordinances of the City of Las Vegas, Nevada and the State Laws, whether herein specified or not.

SIGNED Kenneth Cox CONTRACTOR MASTER CARD NO. 197

BY Kenneth Cox Registered Master Plumber, Spec. Contr. or Owner

BUILDING DEPT. [Signature] DATE 11/8/91

FOR INSPECTIONS CALL 799-2071
SEWER # 7114-3654 CONNECTION

FIXTURES X
FEE \$56.00

2310-2403 PERMIT FEE

TOTAL FEES \$56.00

RECEIPT
Inspected 5-17-91
PERMIT NO. _____

DEPARTMENT OF BUILDING AND SAFETY
PHONE 386-6251



ELECTRICAL PERMIT

LOG NO. & AREA P115 DATE 11/11/11 CONST. VAL. \$ _____

ADDRESS OF CONSTRUCTION 9605 Gold Bank Dr OWNER Del Webb

CONTRACTOR Secura Electric STATE LICENSE NO. 0024610 CITY LICENSE NO. 031296

(PRINT NAME OF MASTER ELECTRICIAN) John Sylvia MASTER CARD NO. 0063 PHONE 798-8651

PROPOSED CONSTRUCTION: _____ USE: _____

ELECTRIC PERMIT NO. _____

Approval for the work under this permit will be given only after refuse and debris have been removed from job site and public right of way.

UNITS	DESCRIPTION	FEE	TOTAL
PERMIT ISSUANCE			
1	For Issuing Each Permit	10.00	10.00
	Supplemental Fee	4.50	
APPLIANCE CHARGE			
Residential or General Commercial			
54	Receptacle <u>29</u> Switch <u>25</u>	.40	21.60
17	Each Light Fixture, Socket, or Exit Light, Smoke Detector or Exhaust Fan	.30	5.10
6	EACH OUTLET FOR SPECIAL PURPOSE: Dishwasher, Garbage Grinder, Trash Compactor, G.F.I., Clothes Washer, Dryer, Electric Range, Ovens, Water Heater, Space Heater, Blast Coil Heater, (PER K.W.), Mercury Lamp, Quartz Lamp, Sodium Lamp; 20AMP Sign Circuit	.70	4.20
	X-Ray Unit	10.00	
	Area Lighting (First 3,000 Watts)	8.00	
	Each Additional 1,000 Watts	3.00	
MOTORS (1 H.P. AND OVER) TRANSFORMERS, ELEVATORS, WELDERS, GENERATORS, CHILLERS, SIGNS AND A/C UNITS (OVER 5 TONS)			
	First H.P. or Ton For each Unit	3.00	
	First KVA For Each Unit	3.00	
	Each Additional H.P., Ton or KVA up to 50	.50	
	Each Additional H.P., Ton or KVA over 50	.35	
	Temporary power or Pole	6.00	
ELECTRIC SERVICE OR MAIN DISCONNECT			
1	Up to 200 AMP	6.00	6.00
	400 AMP And 600 AMP	12.50	
	Over 600 AMP To 1200 AMP	25.00	
	Over 1200 AMP	50.00	
	Each Additional Meter Socket	.50	
	Sub Panel, Motor Control Center Disconnect Switch, Transfer Switch (Each)	3.00	
	Swimming Pool (Residential)	20.00	
	Swimming Pool (Semi-Public)	30.00	
	Spas	8.00	
	Recreational Vehicle Spaces (Each)	3.00	

UNITS	DESCRIPTION	FEE	TOTAL
	Busways-Trolley or Plug-in (Ea. 100 Ft.)	3.00	
	Gas Pumps, Dispensers (Each)	3.00	
1	Permanent A/C Unit (5 Tons or Less)	3.00	3.00
1	Each Air Handler	1.00	1.00
RESIDENTIAL LOW VOLTAGE INSTALLATIONS			
	Speaker Outlets (Each)	.30	
	Signal or Alarm Outlets (Each)	.30	
	Amplifiers	2.00	
	Control Panel	.50	
3	TV-Master System	.30	.90
3	Telephone or Computer Outlet	.30	.90

OTHER INSPECTIONS AND FEES: INCLUDES ISSUANCE FEES WHEN APPLICABLE		
Inspections outside of normal business hours (minimum charge - three hours)	30.00 per hour	
Reinspection fee assessed under provisions of TABLE 3-A of the Uniform Building Code = \$30.00 EACH.	30.00 each	
Inspections for which no fee is specifically indicated (minimum charge - one-half hour)	30.00 per hour	
Additional plan review required by changes, additions or revisions to approved plans (minimum charge - one-half hour). After work hours - \$30.00 per hour - minimum 1 hour.	30.00 per hour	
Starter Permit	50.00	

CONTRACT PRICE OR COST OF INSTALLATION		
Commercial - Burglar Alarms		
- Music Systems		
- Data Processing		
- Communication		
Conduit Only - Contract Price		
All Misc. Electric		

I hereby certify that I have carefully examined and read the above application; that the same is true and correct; and that the work herein described is to be done in accordance with all the provisions of the applicable Ordinances of the City of Las Vegas, Nevada and the State Laws, whether herein specified or not.

SIGNED HOMEOWNER, CONTRACTOR [Signature]
BUILDING DEPT. [Signature] DATE 11/17/11

Electrical permit fees may be computed the same as building permit fees by using the cost of installation for valuation amount when such work is not included in the above schedule.

2310-2432

RECEIPT

PERMIT FEE 52.70

LESS STARTER PERMIT _____

TOTAL FEES 52.70

PERMIT NO. _____

MUST BE MACHINE VALIDATED

Permit Expires 180 Days After Abandonment of Work

CITY OF LAS VEGAS, NEVADA

DEPARTMENT OF BUILDING AND SAFETY
PHONE 386-6251



PERMIT NO. 91-096137
91-096159
AIR CONDITIONING PERMIT

LOG NO. & AREA P-115 DATE _____ CONST. VAL. \$ _____

ADDRESS OF CONSTRUCTION 9605 Gold Bank Drive OWNER Del Webb PHONE 732-2545

CONTRACTOR Quality Mechanical, Inc. STATE LICENSE NO. 10867A CITY LICENSE NO. C11766-200577

LOT(s) 161 BLOCK _____ SUBDIVISION Sun City Prod. 136-162 ZONE: _____

PROPOSED CONSTRUCTION 1-3.5 ton, 2 bath fans, 1 kitchen hood USE: _____

Approval for the work under this permit will be given only after refuse and debris have been removed from job site and public right of way.

UNITS	DESCRIPTION	FEE	TOTAL
PERMIT ISSUANCE			
1	For the issuance of each permit.	15.00	15.00
	For issuing each supplemental permit.	4.50	
UNIT FEE SCHEDULE			
	For the installation or relocation of each forced-air or gravity-type furnace or burner, including ducts and vents attached to such appliance, up to and including 100,000 Btu/h.	9.00	
	For the installation or relocation of each forced-air or gravity-type furnace or burner, including ducts and vents attached to such appliance over 100,000 Btu/h.	11.00	
	For the installation or relocation of each floor furnace, including vent.	9.00	
	For the installation or relocation of each suspended heater, recessed wall heater or floor-mounted unit heater.	9.00	
	For the installation, relocation or replacement of each appliance vent installed and not included in an appliance permit.	4.50	
	For the repair of, alteration of, or addition to each heating appliance, refrigeration unit, cooling unit, absorption unit, or each heating, cooling absorption, or evaporative cooling system, including installation of controls regulated by this code.	9.00	
	For the installation or relocation of each boiler or compressor to and including three tons, or each absorption system to and including 100,000 Btu/h.	9.00	
1	For the installation or relocation of each boiler or compressor over three tons to and including 15 tons, or each absorption system over 100,000 Btu/h and including 500,000 Btu/h.	16.50	16.50
	For the installation or relocation of each boiler or compressor over 15 tons to and including 30 tons, or each absorption system over 500,000 Btu/h to and including 1,000,000 Btu/h.	22.50	
	For the installation or relocation of each boiler or compressor over 30 tons to and including 50 tons, or for each absorption system over 1,000,000 Btu/h to and including 1,750,000 Btu/h.	33.50	
	For the installation or relocation of each boiler or refrigeration compressor over 50 tons, or each absorption system over 1,750,000 Btu/h.	56.00	

UNITS	DESCRIPTION	FEE	TOTAL
	For each air-handling unit to and including 10,000 cubic feet per minute, including ducts attached thereto. Note: This fee shall not apply to an air-handling unit which is a portion of a factory-assembled appliance, cooling unit, evaporative cooler or absorption unit for which a permit is required elsewhere in this code.	6.50	
	For each air-handling unit over 10,000 cfm.	11.00	
	For each evaporative cooler other than portable type.	6.50	
3	For each ventilation fan. <u>COMMERCIAL</u> <u>RESIDENTIAL</u>	4.50 2.35	7.05
	For each ventilation system which is not a portion of any heating or air-conditioning system authorized by a permit.	6.50	
	For the installation of each hood which is served by mechanical exhaust, including the ducts for such hood.	6.50	
	For each fire damper installed in an existing system.	4.50	
OTHER INSPECTIONS AND FEES:			
	Inspections outside of normal business hours (minimum charge — three hours.)	25.00 per hour	
	Reinspection fee assessed under provisions of TABLE 3-A of the Uniform Building Code = \$15.00 EACH.	15.00 each	
	Inspections for which no fee is specifically indicated (minimum charge — one-half hour).	30.00 per hour	
	Additional plan review required by changes, additions or revisions to approved plans (minimum charge — two hours).	30.00 per hour	
	Mechanical permit fees may be computed the same as building permit fees by using the cost of installation for valuation amount when such work is not included in the above schedule.		
	Gas piping which is directly related and necessary to the repair or replacement of heating, air conditioning, or refrigeration systems not exceeding 500,000 B.T.U.H.	6.00	

2310-2435

RECEIPT

I hereby certify that I have carefully examined and read the above application; that the same is true and correct; and that the work herein described is to be done in accordance with all the provisions of the applicable Ordinances of the City of Las Vegas, Nevada and the State Laws, whether herein specified or not.

SIGNED [Signature] CONTRACTOR MASTER CARD NO. _____
Quality Mechanical, Inc.

BY [Signature] Spec. Contr. or Owner DATE 1-30-91

PERMIT FEE 3855
TOTAL FEES _____

MUST BE MACHINE VALIDATED

This home has been professionally insulated with

Owens-Corning Fiberglas Insulation

Seq 161
Job 6026



9605 Gold Bank

To meet the stated thermal resistances (R-Values), the manufacturer provides the following specifications:

Blanket Insulation

Blanket and batt insulation when installed according to the manufacturer's recommendations will provide the stated R-Value.

R-Value	Minimum Thickness
To Obtain an insulation resistance R of:	Installed insulation should not be less than:
R-38	12" Thick
R-30	9½" Thick
R-22	6¾" Thick
R-19	6¼" Thick†
R-13	3⅝" Thick††
R-11	3½" Thick

†R-18 in a 5½" cavity
††R-12.7 in a 3½" cavity

ThermaGlas™ Loose Fill Insulation 03M04250

Stated R-Value is provided by installing the required number of bags per 1,000 sq. ft. at a thickness not less than the label minimum thickness. Installation of the required number of bags may yield more than the specified minimum thickness and minimum sq. ft. weight. Failure by the installer to provide both the required bags and at least the minimum thickness will result in lower insulation R-Value.

Specification For Open Blow Attics
Nominal net weight of insulation per bag is 35 lbs.

R-VALUE	BAGS PER 1000 SQ. FT.	MAXIMUM NET COVERAGE	MINIMUM WEIGHT SQ. FT.	MINIMUM THICKNESS
To obtain an insulation resistance R of:	No. of bags per 1000 sq. ft. of net area shall not be less than:	Contents of this bag should not cover more than:	Weight per sq. ft. of installed insulation should not be less than:	Installed insulation should not be less than:
R-49	33.3	30 Sq. Ft.	1.173	19½ In.
R-44	30.3	33 Sq. Ft.	1.053	17½ In.
R-38	26.3	38 Sq. Ft.	0.910	15¼ In.
R-30	20.4	49 Sq. Ft.	0.718	12 In.
R-26	17.9	56 Sq. Ft.	0.622	10¼ In.
R-22	15.2	66 Sq. Ft.	0.527	8¾ In.
R-19	13.0	77 Sq. Ft.	0.455	7½ In.
R-11	7.5	133 Sq. Ft.	0.263	4½ In.

R means resistance to heat flow. The higher the R-value, the greater the insulating power.

The following products have been installed as specified above:

	Type (check appropriate box)					R-value	thickness	no pkgs.	coverage area
	kraft	unfaced	foil	FS-25	loose fill				
Ceilings	<input type="checkbox"/>	<input type="checkbox"/>	<input type="checkbox"/>	<input type="checkbox"/>	<input checked="" type="checkbox"/>	30	12	37	1832
Floors	<input type="checkbox"/>	<input type="checkbox"/>	<input type="checkbox"/>	<input type="checkbox"/>	<input type="checkbox"/>				
Walls	<input type="checkbox"/>	<input type="checkbox"/>	<input type="checkbox"/>	<input type="checkbox"/>	<input type="checkbox"/>				

Installed by: Commercial

Builder:

mendoza 3-28-91
signature date

signature date

HIGHLAND



**PRODUCTS
INC.**

3650 North 40th Avenue
Phoenix, Arizona 85019
(602) 272-1575 • (602) 269-2561

THE INFORMATION BELOW TO BE SUPPLIED BY APPLICATOR

LOCATION 9605 GOLD BANK DATE 3-8-91

APPLICATOR Nevada State Masticing INSPECTED _____

NAME Del Webb PHONE # 649-8522

BUILDER _____

APPLICATOR'S # 196 LOT # 161

I hereby state that the stucco installation on this project is per manufacturer's specification and conforms to the local building requirements.

CONTRACTOR John Salvi

One copy to builder and one copy to building department in authority. Any misuse of this card shall invalidate any warranty, implied or otherwise. Verification of this card must be obtained by calling Highland Products, Inc., 269-2561.

The following is a COPY ONLY, not to be misconstrued as an actual warranty by Highland Products, Inc.

Highland Products, Inc. warrants the Wire-Tex Stucco System for twenty (20) years from the date of the initial application to be free from any defects which seriously affect the weather resistance of the system. Should any defects occur, Highland Products, Inc. shall make a pro-rate allowance for replacement, or pay the owner the amount of the allowance. Highland Products, Inc. shall not be liable for damages or defects resulting from misuse, natural catastrophies, casualty or other cause beyond the control of Highland Products, Inc.

This warranty does not relieve the builder of his responsibilities under the Builder's Warranty required by the National Housing Act or under any provisions applicable to special housing programs such as Low Rent Public Housing.

The above warranty applies to HUB bulleting #1074.

DEPARTMENT OF BUILDING & SAFETY CITY OF LAS VEGAS

<input type="checkbox"/>	PERMIT NUMBER	93484	INSPECTION NUMBER	440	6026
--------------------------	----------------------	-------	--------------------------	-----	------

JOB ADDRESS: 9605 Gold Bank

LOT NO.:	BLOCK NO.:	SUBDIVISION NAME:	
74	161	Sun City	

FIRE DEPT. MAP NO.	JOB PHONE	CALL-IN DATE	CALL-IN TIME	SCHEDULE DATE
				5-16-91

INSPECTOR NO.:	INSPECTOR NAME:
23	<i>[Signature]</i>

INSPECTION REQUESTED → *final plumbing*

[Large empty area for notes or details]

<input type="checkbox"/> PARTIAL INSPECTION	<input type="checkbox"/> PARTIAL APPROVAL (P)	PARTIAL DESCRIPTION		
<input checked="" type="checkbox"/> APPROVED (A)	<input type="checkbox"/> STOP WORK (S)	<input type="checkbox"/> COMMENTS (C)	<input type="checkbox"/> TEMPORARY APPROVAL (T) - UNTIL	<input type="checkbox"/> HOLD (H)
<input type="checkbox"/> REJECTED (R)	REINSPECTION REQUIRED - CALL 799-2071		<input type="checkbox"/> PERMIT REQUIRED	
<input type="checkbox"/> REFEE (F)	REINSPECTION FEE REQUIRED - PAY AT CITY HALL 3RD FLOOR - 400 E. STEWART STREET.			

INSPECTOR SIGNATURE	<i>[Signature]</i>	INSPECTION DATE	5/17/91
----------------------------	--------------------	------------------------	---------

<input type="checkbox"/> PROJECT COMPLETE	BRING HARD CARD WITH FIRE, QUALITY CONTROL & PLANNING APPROVALS SIGNED OFF TO BLDG & SAFETY FOR C. OF O. ISSUANCE (Commercial Only)
--	---

IF YOU HAVE ANY QUESTIONS ON THIS INSPECTION, YOU MAY CALL THE INSPECTOR FROM 7:00 A.M. - 7:15 A.M. OR 2:45 P.M. - 3:00 P.M. AT

FOR ADDITIONAL ASSISTANCE CALL 386-6251
SEE REVERSE SIDE FOR INSPECTION TYPES

DEPARTMENT OF BUILDING & SAFETY CITY OF LAS VEGAS

6026

JOB ADDRESS 9605 Gold Bank			PERMIT NO. 93484
LOT NO. 74	MAP NO. 161	INSPECTOR	DATE 1-22-91
SUBDIVISION NAME Sun City 4103			PHONE
INSPECTOR SIGNATURE 			INSPECTION DATE 1/22/91

PARTIAL INSPECTION - DESCRIPTION:

APPROVED **PERMIT REQUIRED** **STOP WORK**

REJECTED - CORRECTION NOTICE - REINSPECTION REQUIRED CALL 799-2071

INSPECT	DESCRIPTION	INSPECT	DESCRIPTION	INSPECT	DESCRIPTION
<input checked="" type="checkbox"/> B-1	FOOTING, LAYOUT, REBAR, ZONING	<input type="checkbox"/> P-1	ON SITE SEWER	<input type="checkbox"/> X-2	UNDERGROUND HYDRO
<input type="checkbox"/> B-2	STEM WALL - FORMS & REBAR	<input type="checkbox"/> P-2	ON SITE WATER	<input type="checkbox"/> X-3	UNDERGROUND FINAL/FLOW
<input type="checkbox"/> B-3	PRE-SLAB	<input type="checkbox"/> P-3	BUILDING SEWER (YARD LINES)	<input type="checkbox"/> X-4	SPRINKLER SYSTEM HYDRO
<input type="checkbox"/> B-4	ROOF SHEATHING	<input type="checkbox"/> P-4	UNDERSLAB PLUMBING	<input type="checkbox"/> X-5	FIRE ALARM
<input type="checkbox"/> B-5	FRAMING	<input type="checkbox"/> P-5	TOP OUT-WATER, GAS, WASTE	<input type="checkbox"/> X-6	OTHER:
<input type="checkbox"/> B-6	INSULATION	<input type="checkbox"/> P-6	FINAL GAS TEST	<input type="checkbox"/> X-7	FINAL FIRE
<input type="checkbox"/> B-7	DRYWALL NAILING	<input type="checkbox"/> P-7	FINAL PLUMBING		
<input type="checkbox"/> B-8	EXTERIOR LATH/STUCCO			<input type="checkbox"/> E-1	UNDERGROUND ELECTRICAL
<input type="checkbox"/> B-9	WALL GROUT & STEEL	<input type="checkbox"/> M-1	ROUGH VENT	<input type="checkbox"/> E-2	ROUGH ELECTRICAL
<input type="checkbox"/> B-10	POOL - PRE-GUNITE	<input type="checkbox"/> M-2	HOOD	<input type="checkbox"/> E-3	LOW VOLTAGE ELECTRICAL
<input type="checkbox"/> B-11	POOL - PRE-PLASTER / FINAL	<input type="checkbox"/> M-3	FINAL MECHANICAL	<input type="checkbox"/> E-4	SIGN INSPECTION
<input type="checkbox"/> B-12	BUILDING FINAL			<input type="checkbox"/> E-5	FINAL ELECTRICAL
<input type="checkbox"/> B-13	CERT. OF OCC.	<input type="checkbox"/> X-1	KICKER / FLUSH	<input type="checkbox"/> E-6	TEMP POWER

FINAL INSPECTION

BRING HARD CARD WITH FIRE, QUALITY CONTROL & PLANNING APPROVALS SIGNED OFF TO BLDG & SAFETY FOR C. of O. ISSUANCE (Commercial Only)

DEPARTMENT OF BUILDING & SAFETY CITY OF LAS VEGAS

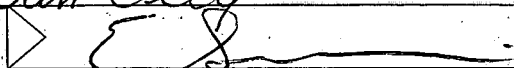
JOB ADDRESS 9605 GOLD BANK			PERMIT NO. 93484
LOT NO. 74	MAP NO. 1161	INSPECTOR	DATE 2-1-91
SUBDIVISION NAME Sun City			PHONE
INSPECTOR SIGNATURE 			INSPECTION DATE 2-1-91

PARTIAL INSPECTION - DESCRIPTION:

APPROVED **PERMIT REQUIRED** **STOP WORK**

REJECTED - CORRECTION NOTICE - REINSPECTION REQUIRED CALL 799-2071

INSPECT	DESCRIPTION	INSPECT	DESCRIPTION	INSPECT	DESCRIPTION
<input type="checkbox"/> B-1	FOOTING, LAYOUT, REBAR, ZONING	<input type="checkbox"/> P-1	ON SITE SEWER	<input type="checkbox"/> X-2	UNDERGROUND HYDRO
<input type="checkbox"/> B-2	STEM WALL - FORMS & REBAR	<input type="checkbox"/> P-2	ON SITE WATER	<input type="checkbox"/> X-3	UNDERGROUND FINAL/FLOW
<input checked="" type="checkbox"/> B-3	PRE-SLAB	<input type="checkbox"/> P-3	BUILDING SEWER (YARD LINES)	<input type="checkbox"/> X-4	SPRINKLER SYSTEM HYDRO
<input type="checkbox"/> B-4	ROOF SHEATHING	<input type="checkbox"/> P-4	UNDERSLAB PLUMBING	<input type="checkbox"/> X-5	FIRE ALARM
<input type="checkbox"/> B-5	FRAMING	<input type="checkbox"/> P-5	TOP OUT-WATER, GAS, WASTE	<input type="checkbox"/> X-6	OTHER:
<input type="checkbox"/> B-6	INSULATION	<input type="checkbox"/> P-6	FINAL GAS TEST	<input type="checkbox"/> X-7	FINAL FIRE
<input type="checkbox"/> B-7	DRYWALL NAILING	<input type="checkbox"/> P-7	FINAL PLUMBING		
<input type="checkbox"/> B-8	EXTERIOR LATH/STUCCO			<input type="checkbox"/> E-1	UNDERGROUND ELECTRICAL
<input type="checkbox"/> B-9	WALL GROUT & STEEL	<input type="checkbox"/> M-1	ROUGH VENT	<input type="checkbox"/> E-2	ROUGH ELECTRICAL
<input type="checkbox"/> B-10	<u>POOL</u> PRE-GUNITE	<input type="checkbox"/> M-2	HOOD	<input type="checkbox"/> E-3	LOW VOLTAGE ELECTRICAL
<input type="checkbox"/> B-11	<u>POOL</u> PRE-PLASTER / FINAL	<input type="checkbox"/> M-3	FINAL MECHANICAL	<input type="checkbox"/> E-4	SIGN INSPECTION
<input type="checkbox"/> B-12	BUILDING FINAL			<input type="checkbox"/> E-5	FINAL ELECTRICAL
<input type="checkbox"/> B-13	CERT. OF OCC.	<input type="checkbox"/> X-1	KICKER / FLUSH	<input type="checkbox"/> E-6	TEMP POWER

FINAL INSPECTION

BRING HARD CARD WITH FIRE, QUALITY CONTROL & PLANNING APPROVALS SIGNED OFF TO BLDG & SAFETY FOR C. of O. ISSUANCE (Commercial Only)

DEPARTMENT OF BUILDING & SAFETY CITY OF LAS VEGAS

10026

JOB ADDRESS 9605 Gold Bank			PERMIT NO. 93484
LOT NO. 74	MAP NO. 161	INSPECTOR 85	DATE 3-5-91
SUBDIVISION NAME Sun City 4103			PHONE
INSPECTOR SIGNATURE [Signature]			INSPECTION DATE 3-5-91

ADD STRAPS TO DRAG STREETS

NAIL RIDGE ON ALL ROOF LINES SINK ALL NAILS STICKING UP ON WHOLE ROOF

OK AT FRAME

PARTIAL INSPECTION - DESCRIPTION:

APPROVED PERMIT REQUIRED STOP WORK

REJECTED - CORRECTION NOTICE - REINSPECTION REQUIRED CALL 799-2071

INSPECT	DESCRIPTION	INSPECT	DESCRIPTION	INSPECT	DESCRIPTION
<input type="checkbox"/> B-1	FOOTING, LAYOUT, REBAR, ZONING	<input type="checkbox"/> P-1	ON SITE SEWER	<input type="checkbox"/> X-2	UNDERGROUND HYDRO
<input type="checkbox"/> B-2	STEM WALL - FORMS & REBAR	<input type="checkbox"/> P-2	ON SITE WATER	<input type="checkbox"/> X-3	UNDERGROUND FINAL/FLOW
<input type="checkbox"/> B-3	PRE-SLAB	<input type="checkbox"/> P-3	BUILDING SEWER (YARD LINES)	<input type="checkbox"/> X-4	SPRINKLER SYSTEM HYDRO
<input checked="" type="checkbox"/> B-4	ROOF SHEATHING	<input type="checkbox"/> P-4	UNDERSLAB PLUMBING	<input type="checkbox"/> X-5	FIRE ALARM
<input type="checkbox"/> B-5	FRAMING	<input type="checkbox"/> P-5	TOP OUT-WATER, GAS, WASTE	<input type="checkbox"/> X-6	OTHER:
<input type="checkbox"/> B-6	INSULATION	<input type="checkbox"/> P-6	FINAL GAS TEST	<input type="checkbox"/> X-7	FINAL FIRE
<input type="checkbox"/> B-7	DRY WALL NAILING	<input type="checkbox"/> P-7	FINAL PLUMBING		
<input type="checkbox"/> B-8	EXTERIOR LATH/STUCCO			<input type="checkbox"/> E-1	UNDERGROUND ELECTRICAL
<input type="checkbox"/> B-9	WALL GROUT & STEEL	<input type="checkbox"/> M-1	ROUGH VENT	<input type="checkbox"/> E-2	ROUGH ELECTRICAL
<input type="checkbox"/> B-10	<input type="checkbox"/> POOL PRE-GUNITE	<input type="checkbox"/> M-2	HOOD	<input type="checkbox"/> E-3	LOW VOLTAGE ELECTRICAL
<input type="checkbox"/> B-11	<input type="checkbox"/> POOL PRE-PLASTER / FINAL	<input type="checkbox"/> M-3	FINAL MECHANICAL	<input type="checkbox"/> E-4	SIGN INSPECTION
<input type="checkbox"/> B-12	BUILDING FINAL			<input type="checkbox"/> E-5	FINAL ELECTRICAL
<input type="checkbox"/> B-13	CERT. OF OCC.	<input type="checkbox"/> X-1	KICKER / FLUSH	<input type="checkbox"/> E-6	TEMP POWER

FINAL INSPECTION BRING HARD CARD WITH FIRE, QUALITY CONTROL & PLANNING APPROVALS SIGNED OFF TO BLDG & SAFETY FOR C. of O. ISSUANCE (Commercial Only)

DEPARTMENT OF BUILDING & SAFETY CITY OF LAS VEGAS

6026

JOB ADDRESS 9605 Gold Bank			PERMIT NO. 93484
LOT NO. 74	MAP NO. 161	INSPECTOR 85	DATE 3-13-91
SUBDIVISION NAME Sun City 4103			PHONE
INSPECTOR SIGNATURE [Signature]			INSPECTION DATE 3-13-91

Fix Fire Stopping IN FIREPLACE

CKAT (WSU)

PARTIAL INSPECTION - DESCRIPTION:

APPROVED PERMIT REQUIRED STOP WORK

REJECTED - CORRECTION NOTICE - REINSPECTION REQUIRED CALL 799-2071

INSPECT	DESCRIPTION	INSPECT	DESCRIPTION	INSPECT	DESCRIPTION
<input type="checkbox"/> B-1	FOOTING, LAYOUT, REBAR, ZONING	<input type="checkbox"/> P-1	ON SITE SEWER	<input type="checkbox"/> X-2	UNDERGROUND HYDRO
<input type="checkbox"/> B-2	STEM WALL - FORMS & REBAR	<input type="checkbox"/> P-2	ON SITE WATER	<input type="checkbox"/> X-3	UNDERGROUND FINAL/FLOW
<input type="checkbox"/> B-3	PRE-SLAB	<input type="checkbox"/> P-3	BUILDING SEWER (YARD LINES)	<input type="checkbox"/> X-4	SPRINKLER SYSTEM HYDRO
<input type="checkbox"/> B-4	ROOF SHEATHING	<input type="checkbox"/> P-4	UNDERSLAB PLUMBING	<input type="checkbox"/> X-5	FIRE ALARM
<input checked="" type="checkbox"/> B-5	FRAMING	<input type="checkbox"/> P-5	TOP OUT-WATER, GAS, WASTE	<input type="checkbox"/> X-6	OTHER:
<input type="checkbox"/> B-6	INSULATION	<input type="checkbox"/> P-6	FINAL GAS TEST	<input type="checkbox"/> X-7	FINAL FIRE
<input type="checkbox"/> B-7	DRY WALL NAILING	<input type="checkbox"/> P-7	FINAL PLUMBING		
<input type="checkbox"/> B-8	EXTERIOR LATH/STUCCO			<input type="checkbox"/> E-1	UNDERGROUND ELECTRICAL
<input type="checkbox"/> B-9	WALL GROUT & STEEL	<input type="checkbox"/> M-1	ROUGH VENT	<input type="checkbox"/> E-2	ROUGH ELECTRICAL
<input type="checkbox"/> B-10	POOL PRE-GUNITE	<input type="checkbox"/> M-2	HOOD	<input type="checkbox"/> E-3	LOW VOLTAGE ELECTRICAL
<input type="checkbox"/> B-11	POOL PRE-PLASTER / FINAL	<input type="checkbox"/> M-3	FINAL MECHANICAL	<input type="checkbox"/> E-4	SIGN INSPECTION
<input type="checkbox"/> B-12	BUILDING FINAL			<input type="checkbox"/> E-5	FINAL ELECTRICAL
<input type="checkbox"/> B-13	CERT. OF OCC.	<input type="checkbox"/> X-1	KICKER / FLUSH	<input type="checkbox"/> E-6	TEMP POWER

FINAL INSPECTION BRING HARD CARD WITH FIRE, QUALITY CONTROL & PLANNING APPROVALS SIGNED OFF TO BLDG & SAFETY FOR C. of O. ISSUANCE (Commercial Only)

DEPARTMENT OF BUILDING & SAFETY CITY OF LAS VEGAS

6026

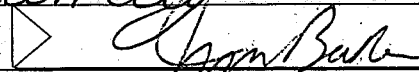
JOB ADDRESS 9605 Gold Bank			PERMIT NO. 93484
LOT NO. 74	MAP NO. 1161	INSPECTOR L.R.	DATE 3-15-91
SUBDIVISION NAME Sun City 4103			PHONE
INSPECTOR SIGNATURE 			INSPECTION DATE 3-15-91

PARTIAL INSPECTION - DESCRIPTION:

APPROVED PERMIT REQUIRED STOP WORK

REJECTED - CORRECTION NOTICE - REINSPECTION REQUIRED CALL 799-2071

INSPECT	DESCRIPTION	INSPECT	DESCRIPTION	INSPECT	DESCRIPTION
<input type="checkbox"/> B-1	FOOTING, LAYOUT, REBAR, ZONING	<input type="checkbox"/> P-1	ON SITE SEWER	<input type="checkbox"/> X-2	UNDERGROUND HYDRO
<input type="checkbox"/> B-2	STEM WALL - FORMS & REBAR	<input type="checkbox"/> P-2	ON SITE WATER	<input type="checkbox"/> X-3	UNDERGROUND FINAL/FLOW
<input type="checkbox"/> B-3	PRE-SLAB	<input type="checkbox"/> P-3	BUILDING SEWER (YARD LINES)	<input type="checkbox"/> X-4	SPRINKLER SYSTEM HYDRO
<input type="checkbox"/> B-4	ROOF SHEATHING	<input type="checkbox"/> P-4	UNDERSLAB PLUMBING	<input type="checkbox"/> X-5	FIRE ALARM
<input type="checkbox"/> B-5	FRAMING	<input type="checkbox"/> P-5	TOP OUT-WATER, GAS, WASTE	<input type="checkbox"/> X-6	OTHER:
<input type="checkbox"/> B-6	INSULATION	<input type="checkbox"/> P-6	FINAL GAS TEST	<input type="checkbox"/> X-7	FINAL FIRE
<input type="checkbox"/> B-7	DRYWALL NAILING	<input type="checkbox"/> P-7	FINAL PLUMBING		
<input type="checkbox"/> B-8	EXTERIOR LATH/STUCCO			<input type="checkbox"/> E-1	UNDERGROUND ELETRICAL
<input type="checkbox"/> B-9	WALL GROUT & STEEL	<input type="checkbox"/> M-1	ROUGH VENT	<input type="checkbox"/> E-2	ROUGH ELECTRICAL
<input type="checkbox"/> B-10	<u>POOL</u> PRE-GUNITE	<input type="checkbox"/> M-2	HOOD	<input type="checkbox"/> E-3	LOW VOLTAGE ELECTRICAL
<input type="checkbox"/> B-11	<u>POOL</u> PRE-PLASTER / FINAL	<input type="checkbox"/> M-3	FINAL MECHANICAL	<input type="checkbox"/> E-4	SIGN INSPECTION
<input type="checkbox"/> B-12	BUILDING FINAL			<input type="checkbox"/> E-5	FINAL ELECTRICAL
<input type="checkbox"/> B-13	CERT. OF OCC.	<input type="checkbox"/> X-1	KICKER / FLUSH	<input type="checkbox"/> E-6	TEMP POWER

FINAL INSPECTION

BRING HARD CARD WITH FIRE, QUALITY CONTROL & PLANNING APPROVALS SIGNED OFF TO BLDG & SAFETY FOR C. of O. ISSUANCE (Commercial Only)

FOR ASSISTANCE - CALL: 386-6251

DEPARTMENT OF BUILDING & SAFETY CITY OF LAS VEGAS

6026

JOB ADDRESS 9605 Gold Bank			PERMIT NO. 93484
LOT NO. 74	MAP NO. 161	INSPECTOR 8564	DATE 3-22-91
SUBDIVISION NAME Sun City 4103			PHONE
INSPECTOR SIGNATURE <i>[Signature]</i>			INSPECTION DATE 3-22-91

PARTIAL INSPECTION - DESCRIPTION:

APPROVED
 PERMIT REQUIRED
 STOP WORK

REJECTED - CORRECTION NOTICE - REINSPECTION REQUIRED CALL 799-2071

INSPECT	DESCRIPTION	INSPECT	DESCRIPTION	INSPECT	DESCRIPTION
<input type="checkbox"/> B-1	FOOTING, LAYOUT, REBAR, ZONING	<input type="checkbox"/> P-1	ON SITE SEWER	<input type="checkbox"/> X-2	UNDERGROUND HYDRO
<input type="checkbox"/> B-2	STEM WALL -- FORMS & REBAR	<input type="checkbox"/> P-2	ON SITE WATER	<input type="checkbox"/> X-3	UNDERGROUND FINAL/FLOW
<input type="checkbox"/> B-3	PRE-SLAB	<input type="checkbox"/> P-3	BUILDING SEWER, (YARD LINES)	<input type="checkbox"/> X-4	SPRINKLER SYSTEM HYDRO
<input type="checkbox"/> B-4	ROOF SHEATHING	<input type="checkbox"/> P-4	UNDERSLAB PLUMBING	<input type="checkbox"/> X-5	FIRE ALARM
<input type="checkbox"/> B-5	FRAMING	<input type="checkbox"/> P-5	TOP OUT-WATER, GAS, WASTE	<input type="checkbox"/> X-6	OTHER:
<input type="checkbox"/> B-6	INSULATION	<input type="checkbox"/> P-6	FINAL GAS TEST	<input type="checkbox"/> X-7	FINAL FIRE
<input checked="" type="checkbox"/> B-7	DRYWALL NAILING	<input type="checkbox"/> P-7	FINAL PLUMBING		
<input type="checkbox"/> B-8	EXTERIOR LATH/STUCCO			<input type="checkbox"/> E-1	UNDERGROUND ELETRICAL
<input type="checkbox"/> B-9	WALL GROUT & STEEL	<input type="checkbox"/> M-1	ROUGH VENT	<input type="checkbox"/> E-2	ROUGH ELECTRICAL
<input type="checkbox"/> B-10	<u>POOL</u> PRE-GUNITE	<input type="checkbox"/> M-2	HOOD	<input type="checkbox"/> E-3	LOW VOLTAGE ELECTRICAL
<input type="checkbox"/> B-11	<u>POOL</u> PRE-PLASTER / FINAL	<input type="checkbox"/> M-3	FINAL MECHANICAL	<input type="checkbox"/> E-4	SIGN INSPECTION
<input type="checkbox"/> B-12	BUILDING FINAL			<input type="checkbox"/> E-5	FINAL ELECTRICAL
<input type="checkbox"/> B-13	CERT. OF OCC.	<input type="checkbox"/> X-1	KICKER / FLUSH	<input type="checkbox"/> E-6	TEMP. POWER

FINAL INSPECTION

BRING HARD CARD WITH FIRE, QUALITY CONTROL & PLANNING APPROVALS SIGNED OFF TO BLDG & SAFETY FOR C. OF O. ISSUANCE (Commercial Only)

<input type="checkbox"/>	PERMIT NUMBER → 93484	INSPECTION NUMBER → 140 ⁶⁰²⁶
--------------------------	------------------------------	--

JOB ADDRESS: 9605 Gold Bank

LOT NO. 74	BLOCK NO. 161	SUBDIVISION NAME Sun City
------------	---------------	---------------------------

FIRE DEPT. MAP NO.	JOB PHONE	CALL-IN DATE	CALL-IN TIME	SCHEDULE DATE 5-16-91
--------------------	-----------	--------------	--------------	-----------------------

INSPECTOR NO. 23	INSPECTOR NAME <i>Sh</i>
------------------	--------------------------

INSPECTION REQUESTED → *final Bldg*

30 Day Temp.

STACK BLOCK WALL NOT FINALED

<input type="checkbox"/> PARTIAL INSPECTION	<input type="checkbox"/> PARTIAL APPROVAL (P)	PARTIAL DESCRIPTION		
<input type="checkbox"/> APPROVED (A)	<input type="checkbox"/> STOP WORK (S)	<input type="checkbox"/> COMMENTS (C)	<input checked="" type="checkbox"/> TEMPORARY APPROVAL (T) -- UNTIL	<input type="checkbox"/> HOLD (H)
<input type="checkbox"/> REJECTED (R)	REINSPECTION REQUIRED - CALL 799-2071			<input type="checkbox"/> PERMIT REQUIRED
<input type="checkbox"/> REFEE (F)	REINSPECTION FEE REQUIRED - PAY AT CITY HALL 3RD FLOOR - 400 E. STEWART STREET.			

INSPECTOR SIGNATURE <i>[Signature]</i>	INSPECTION DATE 5/17/91
---	--------------------------------

<input type="checkbox"/> PROJECT COMPLETE	BRING HARD CARD WITH FIRE, QUALITY CONTROL & PLANNING APPROVALS SIGNED OFF TO BLDG & SAFETY FOR C. OF O. ISSUANCE (Commercial Only)
--	---

IF YOU HAVE ANY QUESTIONS ON THIS INSPECTION, YOU MAY CALL THE INSPECTOR FROM 7:00 A.M. - 7:15 A.M. OR 2:45 P.M. - 3:00 P.M. AT

DEPARTMENT OF BUILDING & SAFETY CITY OF LAS VEGAS

<input type="checkbox"/> PERMIT NUMBER 93484		<input type="checkbox"/> INSPECTION NUMBER 140 6026	
JOB ADDRESS 9605 Gold Bank			
LOT NO. 74	BLOCK NO. 161	SUBDIVISION NAME Sun City	
FIRE DEPT. MAP NO.	JOB PHONE	CALL-IN DATE	CALL-IN TIME 4103
INSPECTOR NO. 85			SCHEDULE DATE 6-18-91
INSPECTOR NAME FZ			

INSPECTION REQUESTED *final Bldg*

(Empty section for notes or details)

<input type="checkbox"/> PARTIAL INSPECTION	<input type="checkbox"/> PARTIAL APPROVAL (P)	PARTIAL DESCRIPTION	
<input checked="" type="checkbox"/> APPROVED (A)	<input type="checkbox"/> STOP WORK (S)	<input type="checkbox"/> COMMENTS (C)	<input type="checkbox"/> TEMPORARY APPROVAL (T) - UNTIL
<input type="checkbox"/> REJECTED (R)	REINSPECTION REQUIRED - CALL *799-2071		<input type="checkbox"/> HOLD (H)
<input type="checkbox"/> REFEE (F)	REINSPECTION FEE REQUIRED - PAY AT CITY HALL 3RD FLOOR - 400 E. STEWART STREET.		<input type="checkbox"/> PERMIT REQUIRED

INSPECTOR SIGNATURE FZ	INSPECTION DATE 6-20-91
<input type="checkbox"/> PROJECT COMPLETE	BRING HARD CARD WITH FIRE, QUALITY CONTROL & PLANNING APPROVALS SIGNED OFF TO BLDG & SAFETY FOR C. OF O. ISSUANCE (Commercial Only)

IF YOU HAVE ANY QUESTIONS ON THIS INSPECTION, YOU MAY CALL THE INSPECTOR FROM 7:00 A.M. - 7:15 A.M. OR 2:45 P.M. - 3:00 P.M. AT

DEPARTMENT OF BUILDING & SAFETY CITY OF LAS VEGAS

6026

JOB ADDRESS 9605 Gold Bank			PERMIT NO. 93484
LOT NO. 74	MAP NO. 161	INSPECTOR 85	DATE 3-13-91
SUBDIVISION NAME Sun City 4103			PHONE
INSPECTOR SIGNATURE <i>[Signature]</i>			INSPECTION DATE 3-13-91

PARTIAL INSPECTION - DESCRIPTION:

APPROVED
 PERMIT REQUIRED
 STOP WORK
 REJECTED - CORRECTION NOTICE - REINSPECTION REQUIRED CALL 799-2071

INSPECT	DESCRIPTION	INSPECT	DESCRIPTION	INSPECT	DESCRIPTION
<input type="checkbox"/> B-1	FOOTING, LAYOUT, REBAR, ZONING	<input type="checkbox"/> P-1	ON SITE SEWER	<input type="checkbox"/> X-2	UNDERGROUND HYDRO
<input type="checkbox"/> B-2	STEM WALL - FORMS & REBAR	<input type="checkbox"/> P-2	ON SITE WATER	<input type="checkbox"/> X-3	UNDERGROUND FINAL/FLOW
<input type="checkbox"/> B-3	PRE-SLAB	<input type="checkbox"/> P-3	BUILDING SEWER (YARD LINES)	<input type="checkbox"/> X-4	SPRINKLER SYSTEM HYDRO
<input type="checkbox"/> B-4	ROOF SHEATHING	<input type="checkbox"/> P-4	UNDERSLAB PLUMBING	<input type="checkbox"/> X-5	FIRE ALARM
<input type="checkbox"/> B-5	FRAMING	<input type="checkbox"/> P-5	TOP OUT-WATER, GAS, WASTE	<input type="checkbox"/> X-6	OTHER:
<input type="checkbox"/> B-6	INSULATION	<input type="checkbox"/> P-6	FINAL GAS TEST	<input type="checkbox"/> X-7	FINAL FIRE
<input type="checkbox"/> B-7	DRYWALL NAILING	<input type="checkbox"/> P-7	FINAL PLUMBING		
<input type="checkbox"/> B-8	EXTERIOR LATH/STUCCO			<input type="checkbox"/> E-1	UNDERGROUND ELECTRICAL
<input type="checkbox"/> B-9	WALL GROUT & STEEL	<input type="checkbox"/> M-1	ROUGH VENT	<input checked="" type="checkbox"/> E-2	ROUGH ELECTRICAL
<input type="checkbox"/> B-10	POOL PRE-GUNITE	<input type="checkbox"/> M-2	HOOD	<input type="checkbox"/> E-3	LOW VOLTAGE ELECTRICAL
<input type="checkbox"/> B-11	POOL PRE-PLASTER / FINAL	<input type="checkbox"/> M-3	FINAL MECHANICAL	<input type="checkbox"/> E-4	SIGN INSPECTION
<input type="checkbox"/> B-12	BUILDING FINAL			<input type="checkbox"/> E-5	FINAL ELECTRICAL
<input type="checkbox"/> B-13	CERT. OF OCC.	<input type="checkbox"/> X-1	KICKER / FLUSH	<input type="checkbox"/> E-6	TEMP POWER

FINAL INSPECTION

BRING HARD CARD WITH FIRE, QUALITY CONTROL & PLANNING APPROVALS. SIGNED OFF TO BLDG & SAFETY FOR C. of O. ISSUANCE (Commercial Only)

FOR ASSISTANCE - CALL: 388-6251

DEPARTMENT OF BUILDING & SAFETY CITY OF LAS VEGAS

<input type="checkbox"/> PERMIT NUMBER	93484	<input type="checkbox"/> INSPECTION NUMBER	240
--	-------	--	-----

6026

JOB ADDRESS: 9605 Gold Bank

LOT NO. 74	BLOCK NO. 161	SUBDIVISION NAME Sun City
---------------	------------------	------------------------------

4103

FIRE DEPT. MAP NO.	JOB PHONE	CALL-IN DATE	CALL-IN TIME	SCHEDULE DATE 5-1-91
--------------------	-----------	--------------	--------------	-------------------------

INSPECTOR NO. 7384	INSPECTOR NAME <i>[Signature]</i>
-----------------------	--------------------------------------

INSPECTION REQUESTED → final electric

[Large empty area for notes or details]

<input type="checkbox"/> PARTIAL INSPECTION	<input type="checkbox"/> PARTIAL APPROVAL (P)	PARTIAL DESCRIPTION
---	---	---------------------

<input checked="" type="checkbox"/> APPROVED (A)	<input type="checkbox"/> STOP WORK (S)	<input type="checkbox"/> COMMENTS (C)	<input type="checkbox"/> TEMPORARY APPROVAL (T) — UNTIL	<input type="checkbox"/> HOLD (H)
--	--	---------------------------------------	---	-----------------------------------

<input type="checkbox"/> REJECTED (R)	REINSPECTION REQUIRED - CALL 799-2071	<input type="checkbox"/> PERMIT REQUIRED
<input type="checkbox"/> REFEE (F)	REINSPECTION FEE REQUIRED - PAY AT CITY HALL 3RD FLOOR - 400 E. STEWART STREET.	

INSPECTOR SIGNATURE <i>[Signature]</i>	INSPECTION DATE 5/1/91
---	---------------------------

<input type="checkbox"/> PROJECT COMPLETE	BRING HARD CARD WITH FIRE, QUALITY CONTROL & PLANNING APPROVALS SIGNED OFF TO BLDG & SAFETY FOR C. OF O. ISSUANCE (Commercial Only)
---	---

IF YOU HAVE ANY QUESTIONS ON THIS INSPECTION, YOU MAY CALL THE INSPECTOR FROM 7:00 A.M. - 7:15 A.M. OR 2:45 P.M. - 3:00 P.M. AT

FOR ADDITIONAL ASSISTANCE CALL 386-6251
SEE REVERSE SIDE FOR INSPECTION TYPES

DEPARTMENT OF BUILDING & SAFETY CITY OF LAS VEGAS

6026

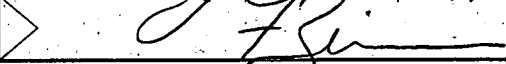
JOB ADDRESS 9605 Gold Bank			PERMIT NO. 93484
LOT NO. 74	MAP NO. 161	INSPECTOR 85	DATE 3-13-91
SUBDIVISION NAME Sun City 4103			PHONE
INSPECTOR SIGNATURE 			INSPECTION DATE 3-13-91

PARTIAL INSPECTION - DESCRIPTION:

APPROVED **PERMIT REQUIRED** **STOP WORK**

REJECTED - CORRECTION NOTICE - REINSPECTION REQUIRED CALL 799-2071

INSPECT	DESCRIPTION	INSPECT	DESCRIPTION	INSPECT	DESCRIPTION
<input type="checkbox"/> B-1	FOOTING, LAYOUT, REBAR, ZONING	<input type="checkbox"/> P-1	ON SITE SEWER	<input type="checkbox"/> X-2	UNDERGROUND HYDRO
<input type="checkbox"/> B-2	STEM WALL -- FORMS & REBAR	<input type="checkbox"/> P-2	ON SITE WATER	<input type="checkbox"/> X-3	UNDERGROUND FINAL/FLOW
<input type="checkbox"/> B-3	PRE-SLAB	<input type="checkbox"/> P-3	BUILDING SEWER (YARD LINES)	<input type="checkbox"/> X-4	SPRINKLER SYSTEM HYDRO
<input type="checkbox"/> B-4	ROOF SHEATHING	<input type="checkbox"/> P-4	UNDERSLAB PLUMBING	<input type="checkbox"/> X-5	FIRE ALARM
<input type="checkbox"/> B-5	FRAMING	<input checked="" type="checkbox"/> P-5	TOP OUT-WATER, GAS, WASTE	<input type="checkbox"/> X-6	OTHER:
<input type="checkbox"/> B-6	INSULATION	<input type="checkbox"/> P-6	FINAL GAS TEST	<input type="checkbox"/> X-7	FINAL FIRE
<input type="checkbox"/> B-7	DRYWALL NAILING	<input type="checkbox"/> P-7	FINAL PLUMBING		
<input type="checkbox"/> B-8	EXTERIOR LATH/STUCCO			<input type="checkbox"/> E-1	UNDERGROUND ELECTRICAL
<input type="checkbox"/> B-9	WALL GROUT & STEEL	<input type="checkbox"/> M-1	ROUGH VENT	<input type="checkbox"/> E-2	ROUGH ELECTRICAL
<input type="checkbox"/> B-10	POOL PRE-GUINITE	<input type="checkbox"/> M-2	HOOD	<input type="checkbox"/> E-3	LOW VOLTAGE ELECTRICAL
<input type="checkbox"/> B-11	POOL PRE-PLASTER / FINAL	<input type="checkbox"/> M-3	FINAL MECHANICAL	<input type="checkbox"/> E-4	SIGN INSPECTION
<input type="checkbox"/> B-12	BUILDING FINAL			<input type="checkbox"/> E-5	FINAL ELECTRICAL
<input type="checkbox"/> B-13	CERT. OF OCC.	<input type="checkbox"/> X-1	KICKER / FLUSH	<input type="checkbox"/> E-6	TEMP POWER

FINAL INSPECTION

BRING HARD CARD WITH FIRE, QUALITY CONTROL & PLANNING APPROVALS SIGNED OFF TO BLDG & SAFETY FOR C. of O. ISSUANCE (Commercial Only)

<input type="checkbox"/>	PERMIT NUMBER 93484	INSPECTION NUMBER 423	6026
--------------------------	----------------------------	------------------------------	------

JOB ADDRESS 9605 Gold Bank 4103 CS

LOT NO. 74	BLOCK NO. 1161	SUBDIVISION NAME Sun City
------------	----------------	---------------------------

FIRE DEPT. MAP NO.	JOB PHONE	CALL-IN DATE	CALL-IN TIME	SCHEDULE DATE 5-3-91
--------------------	-----------	--------------	--------------	----------------------

INSPECTOR NO. 85	INSPECTOR NAME [Signature]
------------------	----------------------------

INSPECTION REQUESTED general gas

[Large empty area for notes or inspection details]

<input type="checkbox"/> PARTIAL INSPECTION	<input type="checkbox"/> PARTIAL APPROVAL (P)	PARTIAL DESCRIPTION
---	---	---------------------

<input checked="" type="checkbox"/> APPROVED (A)	<input type="checkbox"/> STOP WORK (S)	<input type="checkbox"/> COMMENTS (C)	<input type="checkbox"/> TEMPORARY APPROVAL (T) - UNTIL	<input type="checkbox"/> HOLD (H)
--	--	---------------------------------------	---	-----------------------------------

<input type="checkbox"/> REJECTED (R)	REINSPECTION REQUIRED - CALL 799-2071	<input type="checkbox"/> PERMIT REQUIRED
<input type="checkbox"/> REFEE (F)	REINSPECTION FEE REQUIRED - PAY AT CITY HALL 3RD FLOOR - 400 E. STEWART STREET.	

INSPECTOR SIGNATURE [Signature]	INSPECTION DATE 5-3-91
--	-------------------------------

<input type="checkbox"/> PROJECT COMPLETE	BRING HARD CARD WITH FIRE, QUALITY CONTROL & PLANNING APPROVALS SIGNED OFF TO BLDG & SAFETY FOR C. OF O. ISSUANCE (Commercial Only)
--	---

IF YOU HAVE ANY QUESTIONS ON THIS INSPECTION, YOU MAY CALL THE INSPECTOR FROM 7:00 A.M. - 7:15 A.M. OR 2:45 P.M. - 3:00 P.M. AT

DEPARTMENT OF BUILDING & SAFETY CITY OF LAS VEGAS

6026

JOB ADDRESS 9605 Gold BANK			PERMIT NO. 93484
LOT NO. 74	MAP NO. 161	INSPECTOR 85	DATE 3-13-91
SUBDIVISION NAME Sun City 4103			PHONE
INSPECTOR SIGNATURE 			INSPECTION DATE 3-13-91

PARTIAL INSPECTION - DESCRIPTION:

APPROVED

 PERMIT REQUIRED

 STOP WORK

REJECTED - CORRECTION NOTICE - REINSPECTION REQUIRED CALL 799-2071

INSPECT	DESCRIPTION	INSPECT	DESCRIPTION	INSPECT	DESCRIPTION
<input type="checkbox"/> B-1	FOOTING, LAYOUT, REBAR, ZONING	<input type="checkbox"/> P-1	ON SITE SEWER	<input type="checkbox"/> X-2	UNDERGROUND HYDRO
<input type="checkbox"/> B-2	STEM WALL - FORMS & REBAR	<input type="checkbox"/> P-2	ON SITE WATER	<input type="checkbox"/> X-3	UNDERGROUND FINAL/FLOW
<input type="checkbox"/> B-3	PRE-SLAB	<input type="checkbox"/> P-3	BUILDING SEWER (YARD LINES)	<input type="checkbox"/> X-4	SPRINKLER SYSTEM HYDRO
<input type="checkbox"/> B-4	ROOF SHEATHING	<input type="checkbox"/> P-4	UNDERSLAB PLUMBING	<input type="checkbox"/> X-5	FIRE ALARM
<input type="checkbox"/> B-5	FRAMING	<input type="checkbox"/> P-5	TOP OUT-WATER, GAS, WASTE	<input type="checkbox"/> X-6	OTHER:
<input type="checkbox"/> B-6	INSULATION	<input type="checkbox"/> P-6	FINAL GAS TEST	<input type="checkbox"/> X-7	FINAL FIRE
<input type="checkbox"/> B-7	DRYWALL NAILING	<input type="checkbox"/> P-7	FINAL PLUMBING		
<input type="checkbox"/> B-8	EXTERIOR LATH/STUCCO			<input type="checkbox"/> E-1	UNDERGROUND ELETTRICAL
<input type="checkbox"/> B-9	WALL GROUT & STEEL	<input checked="" type="checkbox"/> M-1	ROUGH VENT	<input type="checkbox"/> E-2	ROUGH ELECTRICAL
<input type="checkbox"/> B-10	<u>POOL</u> PRE-GUNITE	<input type="checkbox"/> M-2	HOOD	<input type="checkbox"/> E-3	LOW VOLTAGE ELECTRICAL
<input type="checkbox"/> B-11	<u>POOL</u> PRE-PLASTER / FINAL	<input type="checkbox"/> M-3	FINAL MECHANICAL	<input type="checkbox"/> E-4	SIGN INSPECTION
<input type="checkbox"/> B-12	BUILDING FINAL			<input type="checkbox"/> E-5	FINAL ELECTRICAL
<input type="checkbox"/> B-13	CERT. OF OCC.	<input type="checkbox"/> X-1	KICKER / FLUSH	<input type="checkbox"/> E-6	TEMP POWER

FINAL INSPECTION

 BRING HARD CARD WITH FIRE, QUALITY CONTROL & PLANNING APPROVALS SIGNED OFF TO BLDG & SAFETY FOR C. OF O. ISSUANCE (Commercial Only)

DEPARTMENT OF BUILDING & SAFETY CITY OF LAS VEGAS

PERMIT NUMBER **93484**
 INSPECTION NUMBER **340** 6026

JOB ADDRESS **9605 Gold Bank**

LOT NO. **74** BLOCK NO. **161** SUBDIVISION NAME **Sun City** 4103

FIRE DEPT. MAP NO. _____ JOB PHONE _____ CALL-IN DATE _____ CALL-IN TIME **J** SCHEDULE DATE **5-16-91**

INSPECTOR NO. **73** INSPECTOR NAME **ED**

INSPECTION REQUESTED **final mechanical**

Large empty area for notes or inspection details.

<input type="checkbox"/> PARTIAL INSPECTION	<input type="checkbox"/> PARTIAL APPROVAL (P)	PARTIAL DESCRIPTION		
<input checked="" type="checkbox"/> APPROVED (A)	<input type="checkbox"/> STOP WORK (S)	<input type="checkbox"/> COMMENTS (C)	<input type="checkbox"/> TEMPORARY APPROVAL (T) - UNTIL	<input type="checkbox"/> HOLD (H)
<input type="checkbox"/> REJECTED (R)	REINSPECTION REQUIRED - CALL 799-2071			<input type="checkbox"/> PERMIT REQUIRED
<input type="checkbox"/> REFEE (F)	REINSPECTION FEE REQUIRED - PAY AT CITY HALL 3RD FLOOR - 400 E. STEWART STREET.			

INSPECTOR SIGNATURE **[Signature]** INSPECTION DATE **5/17/91**

PROJECT COMPLETE BRING HARD CARD WITH FIRE, QUALITY CONTROL & PLANNING APPROVALS SIGNED OFF TO BLDG & SAFETY FOR C. of O. ISSUANCE (Commercial Only)

IF YOU HAVE ANY QUESTIONS ON THIS INSPECTION, YOU MAY CALL THE INSPECTOR FROM 7:00 A.M. - 7:15 A.M. OR 2:45 P.M. - 3:00 P.M. AT

FOR ADDITIONAL ASSISTANCE CALL 386-6251
SEE REVERSE SIDE FOR INSPECTION TYPES