

CITY OF LAS VEGAS, NEVADA

PERMIT NO.

91-124507

DEPARTMENT OF BUILDING AND SAFETY
PHONE 386-6251

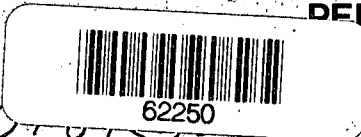

2071

BUILDING PERMIT
FOR: Single Family Dwelling, Remodel
Additions, Misc. Residential Construction

LOG NO. & AREA P-200 DATE 6/24/91 CONST. VAL. \$ 35,500.00

ADDRESS OF CONSTRUCTION 2301 Goldhill Way OWNER Rancho Classic Ltd. Partner. PHONE 795-0050

LOT(S) 40 BLOCK 2 SUBDIVISION Rancho Classic #2 ZONE RCL

PROPOSED CONSTRUCTION SFD W/FP USE Residential

THIS PERMIT FOR BLDG. A/C ELEC. PLBG. OTHER PERMITS REQD.: FENCE OFF SITE SWIM POOL

FLOOR AREA: BSMT _____ 1ST 1132 2ND _____ GARAGE 492 PORCH _____ TOTAL 1624

CONTRACTOR The Horn Co. DBA Classic Homes of Nevada STATE LICENSE NO. 31449 CITY LICENSE NO. 44275

ARCHITECT Frank Gonzales & Associates ENGINEER VTN.

MASTER PLUMBER/CONTRACTOR Executive Plumbing MASTER ELECTRICIAN/CONTRACTOR Electric Cal

OTHER INSPECTIONS AND FEES

- Inspections outside of normal business hours = \$30.00 per hour (minimum charge three hours).
- Re-inspection fee during normal business hours assessed under provisions of TABLE 3-A of the Uniform Building Code = \$30.00 per hour.
- Inspections during normal business hours for which no fee is specifically indicated = \$30.00 per hour (minimum charge one half hour).
- Additional plan review required by changes, additions, or revisions to approved plans = \$30.00 per hour (minimum charge two hours).

CONDITIONS OF THE PERMIT:

- I agree to call the City Building Department for inspections before concrete is poured; before rough wiring, electrical, plumbing, framing is covered. Also for air conditioning, drywall and sheathing inspection.
- I agree that when the job is completed that I will call for final inspection before occupancy.
- I agree to perform all construction in accordance with City Ordinances and Building Codes.
- The Contractor's signature below denotes authority from the owner to sign in his behalf and that the owner is aware of all requirements of this application and permit. Separate permits must be taken out for work outlined above this agreement.
- I have read and understand the contents of this application and permit; I hereby state that the information I have supplied on this application is true and correct.
- Approval for the work under this permit will be given only after refuse and debris have been removed from job site and public right of way.
- 24 HOUR MINIMUM NOTICE REQUIRED FOR INSPECTIONS.

SPECIAL CONDITIONS:
Stop Requested 9/18/92

BY: _____ I HEREBY DECLARE THAT I AM THE LEGAL OWNER OF THE ABOVE PROPERTY

BY: Patricia Russell OWNER

I hereby certify that I have reviewed this application and the proposed plans and have found that the proposed development meets the requirements of the City of Las Vegas Flood Hazard Reduction Ordinance for the issuance of this Development Permit.

[Signature] LAND DEVELOPMENT AND FLOOD CONTROL ENGINEER DATE 7/29/91

PLANNING DEPT. [Signature] DATE 6/30/91
BUILDING DEPT. _____ DATE _____

RECEIPT
Cancelled
PERMIT NO. _____
MUST BE MACHINE VALIDATED

PLUMBING		FEE	ELECTRICAL		FEE
WATER DISTRIBUTION	6.00		RECEPTACLE _____ SWITCH _____		.40
SEWER SYSTEM - NEW OR MODIFICATION	10.00		EACH LIGHT FIXTURE OR SOCKET _____		.30
FIXTURES - WATER SOFTENER, H.W. HEATER	2.00		SPECIAL OUTLET, APPLIANCE ETC.		.70
GARBAGE DISPOSAL - WASHER	2.00		SERVICE/PANEL - SUB/3.00-200A/6.00-400A/12.50		
FUEL PIPING	6.00		A.C. UNIT OR MOTORS	3.00	
IRRIGATION SYSTEM	8.00		2310 - 2432	TOTAL	
MISC.			MISC.		
2310 - 2433	TOTAL		2310 - 2431 ISSUANCE FEE		625.00
AIR CONDITIONING		FEE	7143 - 2973 SEWER CONNECTION		264.00
NEW UNIT - 3 TON = 9.00 OVER = 16.50			2310 - 2431 PLAN REVIEW FEE		889.00
FURNACE TO 100,000/9.00 OVER/11.00			2310 - 2431 BLDG. PERMIT FEE		
VAPORATIVE COOLER	6.50		TOTAL FEES		
VENTILATION FAN	2.35				
2310 - 2435	TOTAL				

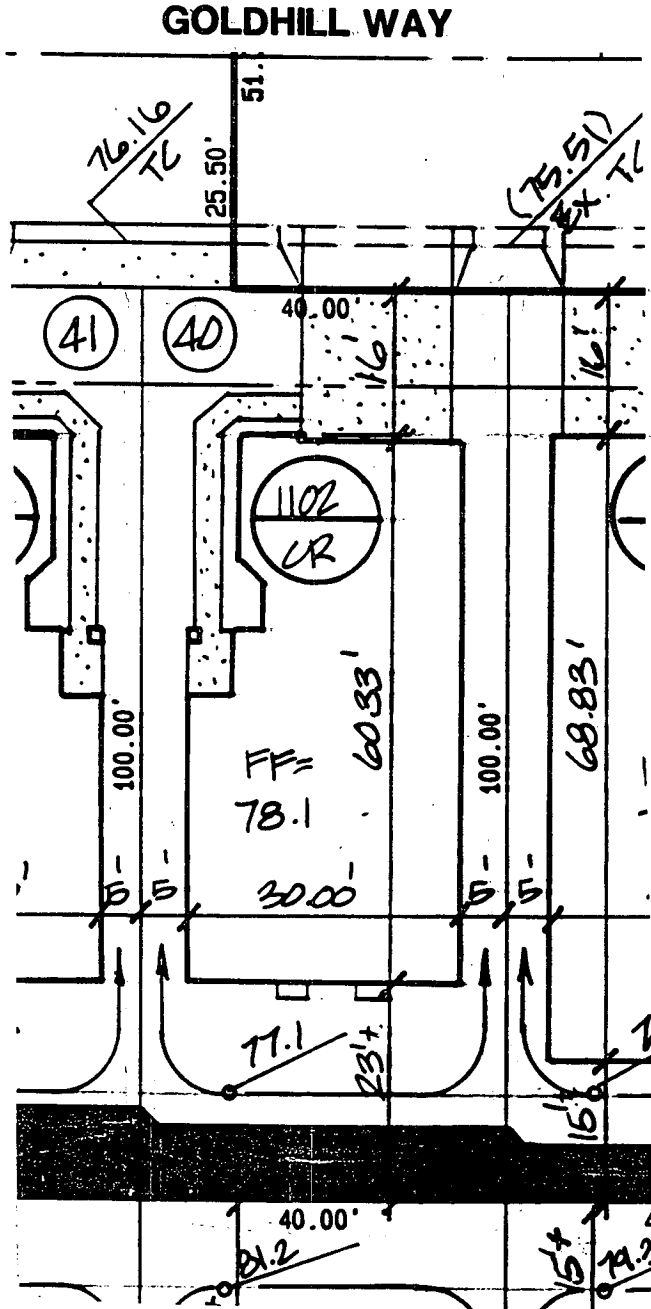

APPROVED

By: *[Signature]*
 COMMUNITY PLANNING & DEVELOPMENT
 City of Las Vegas

2301
 LOT 40 BLOCK 2

VTM nevada
 CONSULTING ENGINEERS • PLANNERS • LAND SURVEYORS
 2727 NORTH WILSON BOULEVARD
 LAS VEGAS, NEVADA 89128-1116 PHONE (702) 735-1877 FAX (702) 735-1877

TITLE
PLOT PLAN
RANCHO CLASSIC UNIT 2
PHASE 4
 PROJECT

W.O.# 3977-2
 BY MGB
 DATE 6-20-91
 SCALE 1" = 20'
 13 OF 16

CITY OF LAS VEGAS, NEVADA

PERMIT NO. 93-195388

DEPARTMENT OF BUILDING AND SAFETY
PHONE 229-6251

FOR INSPECTIONS, CALL 229-2071

BUILDING PERMIT
FOR: Single Family Dwelling, Remodel, Additions, Misc. Residential Construction

010153017

PLAN CHECK NO. **P-200 193** DATE **4/20/93** CONST. VAL. \$ **35,500.00**

ADDRESS OF CONSTRUCTION **2301 GOLDHILL WAY** OWNER **RANCHO CLASSIC LIMITED** PHONE **646-2807**

LOT(s) **40** BLOCK **2** SUBDIVISION **RANCHO CLASSIC** ZONE **RCL**

PROPOSED CONSTRUCTION **SFD** USE **RESIDENTIAL**

THIS PERMIT FOR BLDG. A/C ELEC. PLBG. OTHER PERMITS REQD.: FENCE OFF SITE SWIM POOL

FLOOR AREA BSMT. _____ 1ST **1132** 2ND _____ GARAGE **492** PORCH _____ TOTAL **1624**

CONTRACTOR **HORN CO. DBA CLASSIC HOMES OF NV** STATE LICENSE NO. **31449** CITY LICENSE NO. **44275**

ARCHITECT **FRANK GONZALES & ASSOCIATES** ENGINEER **VTN NEVADA**

MASTER PLUMBER/CONTRACTOR **A.J. PLUMBING** MASTER ELECTRICIAN/CONTRACTOR **ELECTRIC CAL**

OTHER INSPECTIONS AND FEES

- Inspections outside of normal business hours = \$40.00 per hour (minimum charge three hours).
- Re-inspection fee during normal business hours assessed under provisions of TABLE 3-A of the Uniform Building Code = \$40.00 per hour.
- Inspections during normal business hours for which no fee is specifically indicated = \$40.00 per hour (minimum charge one hour).
- Additional plan review required by changes, additions; or revisions to approved plans = \$40.00 per hour (minimum charge two hours).

CONDITIONS OF THE PERMIT:

- I agree to call the City Building Department for inspections before concrete is poured, before rough wiring, electrical, plumbing, framing is covered. Also for air conditioning, drywall and sheathing inspection.
- I agree that when the job is completed that I will call for final inspection before occupancy.
- I agree to perform all construction in accordance with City Ordinances and Building Codes.
- The Contractor's signature below denotes authority from the owner to sign in his behalf and that the owner is aware of all requirements of this application and permit. Separate permits must be taken out for work outlined above this agreement.
- I have read and understand the contents of this application and permit; I hereby state that the information I have supplied on this application is true and correct.
- Approval for the work under this permit will be given only after refuse and debris have been removed from job site and public right of way.
- 24 HOUR MINIMUM NOTICE REQUIRED FOR INSPECTIONS.

SPECIAL CONDITIONS:
Handwritten: 5/17/01

BY: _____ OWNER
BY: *Melinda Fox* AGENT

I hereby certify that I have reviewed this application and the proposed plans and have found that the proposed development meets the requirements of the City of Las Vegas Flood Hazard Reduction Ordinance for the issuance of this Development Permit.

LAND DEVELOPMENT AND FLOOD CONTROL ENGINEER *[Signature]* DATE **4/23/93**
PLANNING DEPT. *[Signature]* DATE **4/23/93**
BUILDING DEPT. *[Signature]* DATE **4/21/93**

PLUMBING		FEE
WATER DISTRIBUTION	6.70	
SEWER SYSTEM - NEW OR MODIFICATION	11.05	
FIXTURES - WATER SOFTENER, H.W. HEATER	2.25	
GARBAGE DISPOSAL - WASHER	2.25	
FUEL PIPING	6.70	
IRRIGATION SYSTEM	8.90	
MISC.		
2310 - 2433		
TOTAL		
AIR CONDITIONING		FEE
NEW UNIT - 3 TON = 10.00 OVER = 18.20		
FURNACE TO 100,000/10.00 OVER/12.20		
VAPORATIVE COOLER	7.20	
VENTILATION FAN	2.65	
2310 - 2435		
TOTAL		

ELECTRICAL		FEE
RECEPTACLE _____ SWITCH _____		.50
EACH LIGHT FIXTURE OR SOCKET _____		.40
SPECIAL OUTLET, APPLIANCE ETC.		.80
SERVICE/PANEL - SUB/3.40 - 200A/6.70 - 400A/13.85		
A.C. UNIT OR MOTORS	3.40	
MISC.		
2310 - 2432		
TOTAL		
1113 - 2437 ZONING		14.00
2310 - 2431 PLAN REVIEW		10.00
2310 - 2401 BLDG. PERMIT		285.00
7143 - 2973 SEWER CONNECTION		1100.00
6:122 - 3352 TORTOISE		
_____ - 2897 P.I.F.		
88100-1232 TRANSPORT		500.00
TOTAL FEES		1909.00

RECEIPT
MUST BE MACHINE VALIDATED

PERMIT NO. _____

CITY OF LAS VEGAS, NEVADA

PERMIT NO. **93-185388**

DEPARTMENT OF BUILDING AND SAFETY
PHONE 229-6251

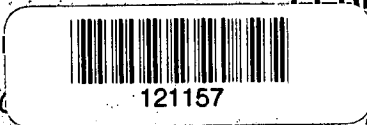

BUILDING PERMIT
FOR: Single Family Dwelling, Remodel
Additions, Misc. Residential Construction

PLAN CHECK NO. P-200 193 DATE 4/20/93 CONST. VAL. \$ 35,500.00

ADDRESS OF CONSTRUCTION 2301 GOLDHILL WAY OWNER RANCHO CLASSIC LIMITED PHONE 646-2807

LOT(s) 40 BLOCK 2 SUBDIVISION RANCHO CLASSIC ZONE RCL

PROPOSED CONSTRUCTION SFD USE RESIDENTIAL

THIS PERMIT FOR BLDG. A/C ELEC. PLBG. OTHER PERMITS REQD: FENCE OFF SITE SWIM POOL

FLOOR AREA BSMT _____ 1ST 1132 2ND _____ GARAGE 492 PORCH _____ TOTAL 1624

CONTRACTOR HORN CO. DBA CLASSIC HOMES OF NV STATE LICENSE NO. 31449 CITY LICENSE NO. 44275

ARCHITECT FRANK GONZALES & ASSOCIATES ENGINEER VTN NEVADA

MASTER PLUMBER/CONTRACTOR A.J. PLUMBING MASTER ELECTRICIAN/CONTRACTOR ELECTRIC CAL

OTHER INSPECTIONS AND FEES

- Inspections outside of normal business hours = \$40.00 per hour (minimum charge three hours).
- Re-inspection fee during normal business hours, assessed under provisions of TABLE 3-A of the Uniform Building Code = \$40.00 per hour.
- Inspections during normal business hours for which no fee is specifically indicated = \$40.00 per hour (minimum charge one hour).
- Additional plan review required by changes, additions, or revisions to approved plans = \$40.00 per hour (minimum charge two hours).

CONDITIONS OF THE PERMIT:

- I agree to call the City Building Department for inspections before concrete is poured, before rough wiring, electrical, plumbing, framing is covered. Also for air conditioning, drywall and sheathing inspection.
- I agree that when the job is completed that I will call for final inspection before occupancy.
- I agree to perform all construction in accordance with City Ordinances and Building Codes.
- The Contractor's signature below denotes authority from the owner to sign in his behalf and that the owner is aware of all requirements of this application and permit. Separate permits must be taken out for work outlined above this agreement.
- I have read and understand the contents of this application and permit; I hereby state that the information I have supplied on this application is true and correct.
- Approval for the work under this permit will be given only after refuse and debris have been removed from job site and public right of way.
- 24 HOUR MINIMUM NOTICE REQUIRED FOR INSPECTIONS.

SPECIAL CONDITIONS:

BY: _____ I HEREBY DECLARE THAT I AM THE LEGAL OWNER OF THE ABOVE PROPERTY OWNER
BY: Melinda Fox AGENT

I hereby certify that I have reviewed this application and the proposed plans and have found that the proposed development meets the requirements of the City of Las Vegas Flood Hazard Reduction Ordinance for the issuance of this Development Permit.

LAND DEVELOPMENT AND FLOOD CONTROL ENGINEER [Signature] DATE 4/23/93
PLANNING DEPT. [Signature] DATE 4/23/93
BUILDING DEPT. [Signature] DATE 4/21/93

PLUMBING	FEE
WATER DISTRIBUTION	6.70
SEWER SYSTEM - NEW OR MODIFICATION	11.05
FIXTURES - WATER SOFTENER, H.W. HEATER	2.25
GARBAGE DISPOSAL - WASHER	2.25
FUEL PIPING	6.70
IRRIGATION SYSTEM	8.90
MISC.	
2310 - 2433 TOTAL	
AIR CONDITIONING	FEE
NEW UNIT - 3 TON = 10.00 OVER = 18.20	
FURNACE TO 100,000/10,000 OVER/12.20	
VAPORATIVE COOLER	7.20
VENTILATION FAN	2.65
2310 - 2435 TOTAL	

ELECTRICAL	FEE
RECEPTACLE _____ SWITCH _____	.50
EACH LIGHT FIXTURE OR SOCKET _____	.40
SPECIAL OUTLET, APPLIANCE ETC.	.80
SERVICE/PANEL - SUB/3.40-200A/6.70-400A/13.85	
A.C. UNIT OR MOTORS	3.40
MISC.	
2310 - 2432 TOTAL	
1113 - 2437 ZONING	14.00
2310 - 2431 PLAN REVIEW	10.00
2310 - 2401 BLDG. PERMIT	285.00
7143 - 2973 SEWER CONNECTION	1100.00
6122 - 3352 TORTOISE	
_____ - 2897 P.I.F.	
88100-1232 TRANSPORT	500.00
TOTAL FEES	1909.00

RECEIPT
MUST BE MACHINE VALIDATED

PERMIT NO. _____

Permit Expires 180 Days After Abandonment of Work

CITY OF LAS VEGAS, NEVADA

PERMIT NO. 93-186776

DEPARTMENT OF BUILDING AND SAFETY
PHONE 229-6251



PLUMBING PERMIT

PLAN CHECK NO. P-200 DATE 5-6-93 CONST. VAL. \$ _____

ADDRESS OF CONSTRUCTION 2301 Gold Hill way OWNER THE HORN CO. PHONE 645-4901

CONTRACTOR A. J. PIBL CO. STATE LICENSE NO. 21071 CITY LICENSE NO. C11014902024972

LOT(s) 40 BLOCK 2 SUBDIVISION RANCHO CLASSIC ZONE: _____

PROPOSED CONSTRUCTION: PIBL For (1) House USE: _____

PLUMBING PERMIT NO. _____

Approval for the work under this permit will be given only after refuse and debris have been removed from job site and public right of way.

UNITS	DESCRIPTION	FEE	TOTAL
PERMIT ISSUANCE			
1	For Issuing Each Permit	15.50	15.50
	For Issuing Each Supplemental Permit	5.20	
FIXTURE CHARGE			
7	Bathtub, Shower, Lavatory, Toilet, Urinal	EA. 2.25	15.75
1	Floor Drain, Floor Sink, Wash Tray, Sink	EA. 2.25	2.25
3	Garbage Disposal, Clothes Washer, Dishwasher (residential)	EA. 2.25	6.75
	Garbage Disposal (commercial)	EA. 8.90	
	Clothes Washer, Dishwasher (commercial)	EA. 2.25	
	Clothes Dryer (gas) (venting)	2.25	
	Dental Unit	8.90	
	Drinking Fountain	2.25	
	Refrigerator - Ice Maker, Water Dispenser	2.25	
	Any other water using equipment, Attached Coffee Makers, Ice Makers	EA. 2.25	
1	Hot Water Heater (Gas or Electric)	2.25	2.25
SEWER SYSTEM			
1	New, Replacement, Modification, or Any Drainage Work	11.05	11.05
	Grease or Sand Trap or Interceptor	2.25	
	Trailer Trap (rental parks)	5.50	
WATER SOFTENERS			
	Non Permanent Type (rental)	2.25	
	Permanent Type (connected to drain)	2.25	
WATER DISTRIBUTION SYSTEM			
1	Single Family Dwelling	6.70	6.70
	Multi-Family Dwelling	6.70	
	Plus Each Dwelling Unit	3.40	
	Commercial Building per floor	3.40	
	Plus Each Unit (leased space or office)	2.25	
	Hotel or Motel	8.90	
	Plus Each Unit	3.40	
	Trailer Park	33.00	
	Plus Each Space	2.25	
	Irrigation Single Family Dwelling	8.90	
	Irrigation Commercial Fee Based on Building Code Valuation Chart		
	Construction Valuation _____		

UNITS	DESCRIPTION	FEE	TOTAL
FUEL PIPING SYSTEM			
1	Single Family Dwelling	6.70	6.70
	Multi-Family Dwelling	11.05	
	Plus Each Unit	2.25	
	Commercial Building (per floor)	6.70	
	Plus Each Unit (leased space or office)	6.70	
	Medium Pressure System (Plan Check)	13.30	
3	Each Gas Appliance (Any Type)	2.25	6.75
	Steam Boilers	5.80	
SOLAR ENERGY SYSTEMS			
	Collectors (including piping) (per collector)	5.80	
	Storage Tanks (each)	5.80	
PIPELINE CONTRACT			
	For Onsite Sewer, Gas or Water Contract Value. Fee based on Building Code Permit-Valuation Chart.		
OTHER INSPECTION AND FEES:			
	Inspections outside of normal business hours (minimum charge—three hours).	40.00 per hour	
	Under provisions of Table 3-A of the Uniform Building Code, work which has been inspected once and not approved may be subject to a Reinspection Fee not less than \$40.00 per each inspection during business hours.	40.00 each	
	Additional plan review required by changes. Additions to or revisions to approved plans (minimum charge two hours)	40.00 per hour	
	Plumbing permit fees may be computed the same as building permit fees by using the cost of installation for valuation amount when such work is not included in the above schedule.		
	Construction Valuation _____		

I hereby certify that I have carefully examined and read the above application; that the same is true and correct; and that the work herein described is to be done in accordance with all the provisions of the applicable Ordinances of the City of Las Vegas, Nevada and the State Laws, whether specified or not.

SIGNED [Signature] CONTRACTOR MASTER CARD NO. 243

BY [Signature] Registered Master Plumber Spec. Cont'r. or Owner
BUILDING DEPT. DATE 5/12/93

FOR INSPECTIONS CALL 229-2071

SEWER #7114-3654 CONNECTION

FIXTURES X

FEE _____
2310-2403 PERMIT FEE 73.70

TOTAL FEES _____

RECEIPT

PERMIT NO. _____

MUST BE MACHINE VALIDATED

Permit Expires 180 Days After Abandonment of Work

DEPARTMENT OF BUILDING & SAFETY CITY OF LAS VEGAS

<input checked="" type="checkbox"/>	PERMIT NUMBER	93-186776	APPLICATION NUMBER	121738
-------------------------------------	---------------	-----------	--------------------	--------

JOB ADDRESS	2301 GOLDHILL WY	INSPECTION NUMBER	17
-------------	------------------	-------------------	----

LOT/BLOCK	RECORDED SUBDIVISION NAME
40 2	RANCHO CLASSIC

FIRE DEPT. MAP NO.	JOB PHONE	CALL-IN-DATE	CALL-IN TIME	SCHEDULE DATE
2323-17	646-2807	05/26/93	14:25	05/27/93

INSPECTOR/NAME	MARKETING/BUSINESS NAME
THOMAS GUGINO - 80	

INSPECTION REQUESTED	BUILDING SEWER (YARD LINES) (405)
----------------------	-----------------------------------

405 approved

<input type="checkbox"/> PARTIAL INSPECTION	<input type="checkbox"/> PARTIAL APPROVAL (P)	PARTIAL DESCRIPTION
---	---	---------------------

<input checked="" type="checkbox"/> APPROVED (A)	<input type="checkbox"/> STOP WORK (S)	<input type="checkbox"/> COMMENTS (C)	<input type="checkbox"/> TEMPORARY APPROVAL (T) - UNTIL	<input type="checkbox"/> HOLD (H)
--	--	---------------------------------------	---	-----------------------------------

<input type="checkbox"/> REJECTED (R)	REINSPECTION REQUIRED - CALL * 229-2071	<input type="checkbox"/> PERMIT REQUIRED
<input type="checkbox"/> REFEE (F)	REINSPECTION FEE REQUIRED - PAY AT CITY HALL 3RD FLOOR - 400 E. STEWART STREET.	

INSPECTOR SIGNATURE	INSPECTION DATE
<i>Tom Guginio</i>	5-27-93

<input type="checkbox"/> PROJECT COMPLETE	BRING HARD CARD WITH FIRE, QUALITY CONTROL & PLANNING APPROVALS SIGNED OFF TO BLDG & SAFETY FOR C. of O. ISSUANCE (Commercial Only)
---	---

IF YOU HAVE ANY QUESTIONS ON THIS INSPECTION, YOU MAY CALL THE INSPECTOR FROM 7:00 A.M. - 7:15 A.M. OR 2:45 P.M. - 3:00 P.M. AT	229-6769
---	-----------------

For Additional Assistance Call * 229-6251. See Reverse Side For Inspection Types.