

CITY OF LAS VEGAS, NEVADA

PERMIT NO.

41109528
91-109520

DEPARTMENT OF BUILDING AND SAFETY
PHONE 386-6251

INSPECTIONS CALL 799-2071

DEVELOPMENT PERMIT

FOR: Fence, Wall, Retaining Wall

LOG NO. & AREA M-435491

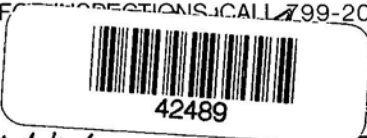

CONST. VAL. \$ 1120

ADDRESS OF CONSTRUCTION 3112 Holly Hill LVNV OWNER JEFF SCHALK PHONE 457-5333

CONTRACTOR TAYLOR MASONRY NV STATE LICENSE NO 30703 CITY LICENSE NO 045332

LOT(s) 50 BLOCK 2 SUBDIVISION Las Vegas Park 65 ZONE R1

CONSTRUCTION PLANS SUBMITTED BY OWNER/CONTRACTOR CONSTRUCTION DESIGN BY CITY DESIGN SHEET.

ENGINEER _____

Approval for the work under this permit will be given only after refuse and debris have been removed from job site and public right of way

DESCRIPTION	TOTAL LIN FT	TOTAL SQ FT
CHAIN LINK OR WIRE MESH		
ORNAMENTAL IRON		
WOOD		
X MASONRY <u>6</u>	<u>75</u>	<u>450</u>
RETAINING		

OTHER INSPECTIONS AND FEES	
1	Inspections outside of normal business hours = \$30.00 per hour (minimum charge three hours)
2	Re-inspection fee during normal business hours assessed under provisions of TABLE 3-A of the Uniform Building Code = \$30.00 each
3	Inspections during normal business hours for which no fee is specifically indicated = \$30.00 per hour (minimum charge one half hour)
4	Additional plan review required by changes, additions or revisions at approved plans = \$30.00 per hour (minimum charge two hours)

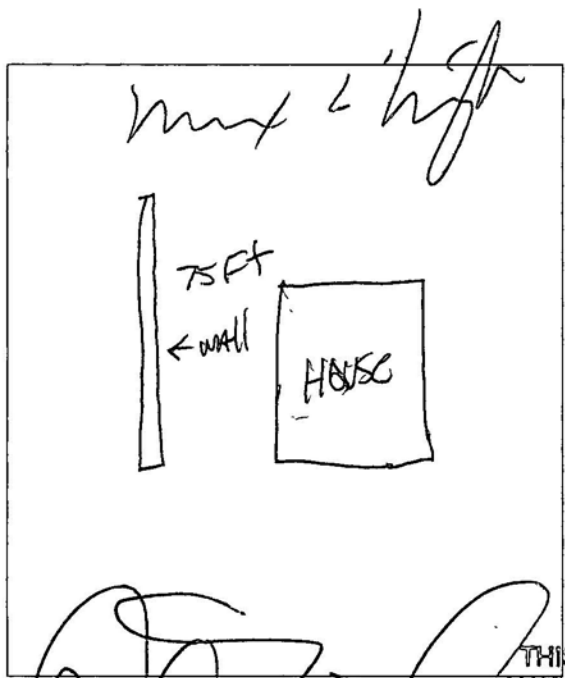

CONDITIONS OF THE PERMIT:

- Any type of retaining wall must be engineered by a Civil or Structural Engineer.
- If a home owner takes out the Building Permit and if the owner sublets the work to a Contractor, then the Contractor must take out the permit and pay for it.
- No fence or wall can be built on City property or rights-of-way, but this is not intended to preclude construction within utility easements if utilities will not be damaged or made inaccessible.
- The fence or wall shall not enclose any water meter, light standard, or fire alarm box and shall not come closer than 24" from the nearest fire hydrant outlet.
- Department Inspectors must approve footings before concrete is poured and block wall reinforcing before grouting is done.
- Maximum height of any wall or fence is 6', side and rear yards; 4' maximum in front yard with the vertical surface above the height of 2' - 50% open.
- Must not obstruct required onsite parking space (2 spaces for each dwelling unit) by the erection of this fence or wall
- By the signing of this application I herewith agree to the requirements outlined above.

FOR INSPECTIONS, CALL 799-2071

THIS FENCE OR WALL SHALL NOT BLOCK THE NATURAL FLOW OF SURFACE WATERS ACROSS THE PROPERTY NOR SHALL IT DIVERT THE FLOW OF SURFACE WATERS ONTO ANOTHER'S PROPERTY.

SIGNED [Signature] CONTRACTOR - AGENT - OWNER
DATE 6/10/91

PLANNING DEPT
I hereby certify that I have reviewed this application and the proposed plans and have found that the proposed development meets the requirements of the City of Las Vegas Flood Hazard Reduction Ordinance for the issuance of this Development Permit

[Signature] LAND DEVELOPMENT AND FLOOD CONTROL ENGINEER
DATE 6/10/91

[Signature] BUILDING DEPT
DATE 6/10/91

PLAN REVIEW FEE _____
PERMIT FEE 2310-2401
TOTAL FEES 26.00

RECEIPT
0005
WALL 26.00
CHECK 26.00
5953A000 11:09

MUST BE MACHINE VALIDATED

PERMIT EXPIRES 180 DAYS AFTER ABANDONMENT OF WORK