

# CITY OF LAS VEGAS, NEVADA

PERMIT NO. 89-045617

DEPARTMENT OF BUILDING AND SAFETY  
PHONE 386-6251

FOR



21347

89045677  
DEVELOPMENT PERMIT  
FOR: Swimming Pool or Spa

LOG NO. & AREA M-2126-89 DATE 01/25/89 CONST. VAL. \$ 51600

ADDRESS OF CONSTRUCTION 4817 HOLLY GROVE OWNER GREEN PHONE \_\_\_\_\_

CONTRACTOR TANGO POOLS STATE LICENSE NO. 11105 CITY LICENSE NO. 8515

LOT(S) 5 BLOCK 3 SUBDIVISION Johnson's Series 3 ZONE: R-1

PLUMBING CONTRACTOR TANGO POOLS ELECTRICAL CONTRACTOR Dennis Egert

CIRCLE TYPE OF POOL THAT APPLIES. PRIVATE SEMI-PUBLIC PUBLIC SPA

MATERIALS OF CONSTRUCTION: REINFORCED GUNITE REINFORCED CONCRETE OTHER \_\_\_\_\_

SQUARE FEET OF SURFACE POOL 416 SPA \_\_\_\_\_ VOLUME IN GALLONS 15,500

Approval for the work under this permit will be given only after refuse and debris have been removed from job site and public right of way.

I state that I am familiar with the effective ordinances of the City of Las Vegas, Nevada and the effective Statutes of the State of Nevada covering construction and use of the above type; I agree to perform said construction in conformity therewith. I further agree that issuance of a permit on the above application will not excuse me from conforming with the said Ordinances and Statutes despite any errors on the part of the building inspector or engineer in checking plans and application herewith.

All swimming pools must be fenced before the pool is filled with water. No electrical lines shall cross over a pool. Applicants must have separate plot plans showing location of power pole, proposed or existing fencing and location of swimming pool. I agree to repair any utility line, if damaged during excavation work. I have read and understand the contents of above application. I hereby state that the same are true and correct.

SIGNED Tango Pools CONTRACTOR  
E. Sambill  
BY \_\_\_\_\_ AGENT/OWNER  
PLANNING DEPT. \_\_\_\_\_ DATE 1/25/89

- 1 Inspections outside of normal business hours = \$30.00 per hour (minimum charge three hours).
- 2 Re-Inspection fee during normal business hours assessed under provisions of TABLE 3-A of the Uniform Building Code = \$30.00 each.
- 3 Inspections during normal business hours for which no fee is specifically indicated = \$30.00 per hour (minimum charge one half hour).
4. Additional plan review required by changes, additions or revisions to approved plans = \$30.00 per hour (minimum charge two hours).

DESCRIPTION		FEE	TOTAL
ISSUANCE FEE		10.00	10.00
SEWER CONNECTION FEE (to 30,000 GALLONS)		58.00	68.00
BUILDING PERMIT - POOL & OR SPA.			67.80
PLUMBING PERMIT	PRIVATE POOL OR SPA	PREFORMED SPA 10.00	20.00
		OTHERWISE 20.00	
	PUBLIC OR SEMI-PUBLIC POOL OR SPA	PREFORMED SPA 20.00	11708/89
		OTHERWISE 30.00	
FUEL PIPING FOR POOL HEATER		6.00	
ELECTRICAL PERMIT	SPA	8.00	
	SWIMMING POOL	RESIDENTIAL 20.00	20.00
		PUBLIC-SEMI-PUBLIC 30.00	
	ELECTRICAL SERVICE CHANGE		6.00
MISC.			
TOTAL FEES			183.80

RECEIPT	
**0002**	
POOL	77.80
SEWR	60.00
PLBG	20.00
ELEC	26.00
CHEK	183.80
4692A000	14:08

# CITY OF LAS VEGAS, NEVADA

PERMIT NO. 89-045677

DEPARTMENT OF BUILDING AND SAFETY  
PHONE 386-6251

FOR



21347

DEVELOPMENT PERMIT

FOR: Swimming Pool or Spa

89045677

LOG NO. & AREA

M-2126-89

DATE

CONST. VAL. \$

57609

ADDRESS OF CONSTRUCTION

4817 HOLLY GROVE

OWNER

GREEN

PHONE

CONTRACTOR

TANGO POOLS

STATE LICENSE NO.

11105

CITY LICENSE NO.

8515

LOT(S)

5

BLOCK

3

SUBDIVISION

Johnsview Series 3

ZONE

R-1

PLUMBING CONTRACTOR

TANGO POOLS

ELECTRICAL CONTRACTOR

Dennis Egbert

CIRCLE TYPE OF POOL THAT APPLIES:

PRIVATE

SEMI-PUBLIC

PUBLIC

SPA

MATERIALS OF CONSTRUCTION:

REINFORCED GUNIT

REINFORCED CONCRETE

OTHER

SQUARE FEET OF SURFACE POOL

416

SPA

VOLUME IN GALLONS

15,500

Approval for the work under this permit will be given only after refuse and debris have been removed from job site and public right of way.

I state that I am familiar with the effective ordinances of the City of Las Vegas, Nevada and the effective Statutes of the State of Nevada covering construction and use of the above type; I agree to perform said construction in conformity therewith. I further agree that issuance of a permit on the above application will not excuse me from conforming with the said Ordinances and Statutes despite any errors on the part of the building inspector or engineer in checking plans and application herewith.

All swimming pools must be fenced before the pool is filled with water. No electrical lines shall cross over a pool. Applicants must have separate plot plans showing location of power pole, proposed or existing fencing and location of swimming pool. I agree to repair any utility line, if damaged during excavation work. I have read and understand the contents of above application. I hereby state that the same are true and correct.

SIGNED

Tango Pools

CONTRACTOR

BY

Egbert

AGENT/OWNER

PLANNING DEPT.

[Signature]

11/18/89  
11/18/89

BUILDING DEPT.

- 1 Inspections outside of normal business hours = \$30.00 per hour (minimum charge three hours)
- 2 Re-Inspection fee during normal business hours assessed under provisions of TABLE 3-A of the Uniform Building Code = \$30.00 each.
- 3 Inspections during normal business hours for which no fee is specifically indicated = \$30.00 per hour (minimum charge one half hour).
- 4 Additional plan review required by changes, additions or revisions to approved plans = \$30.00 per hour (minimum charge two hours).

DESCRIPTION		FEE	TOTAL
ISSUANCE FEE		10.00	10.00
SEWER CONNECTION FEE (to 30,000 GALLONS)		58.00	68.00
BUILDING PERMIT - POOL & OR SPA			67.80
PLUMBING PERMIT	PRIVATE POOL OR SPA	PREFORMED SPA 10.00	20.00
		OTHERWISE 20.00	
	PUBLIC OR SEMI-PUBLIC POOL OR SPA	PREFORMED SPA 20.00	11/08/89
		OTHERWISE 30.00	
FUEL PIPING FOR POOL HEATER		6.00	
ELECTRICAL PERMIT	SPA	8.00	
	SWIMMING POOL	RESIDENTIAL 20.00	20.00
		PUBLIC-SEMI-PUBLIC 30.00	
	ELECTRICAL SERVICE CHANGE		6.00
MISC.			
TOTAL FEES			183.80

RECEIPT

\*\*0002\*\*  
 POOL 77.80  
 SEWR 60.00  
 PLBG 20.00  
 ELEC 26.00  
 CHEK 183.80  
 4692A000 14:08

MUST BE MACHINE VALIDATED

Permit Expires 180 Days After Abandonment of Work

89-215199  
 89046499  
 CONST. VAL. \$ 615

LOG NO. & AREA M-89



DEPARTMENT OF BUILDING AND SAFETY  
 PHONE 386-6251

018-295-005

PERMIT AND BUILDING PERMIT  
 FOR: Fence, Wall, Retaining Wall

ADDRESS OF CONSTRUCTION 4817 Hollyhock DR. #3 OWNER Mn Green PHONE \_\_\_\_\_

CONTRACTOR Owner STATE LICENSE NO. \_\_\_\_\_ CITY LICENSE NO. \_\_\_\_\_  
WHISPERING PINES UNIT 3

LOT(s) 5 BLOCK 6 SUBDIVISION Hollyhock ZONE R-1

CONSTRUCTION PLANS SUBMITTED BY OWNER/CONTRACTOR  CONSTRUCTION DESIGN BY CITY DESIGN SHEET

BUILDING PERMIT NO. \_\_\_\_\_ ENGINEER \_\_\_\_\_

Approval for the work under this permit will be given only after refuse and debris have been removed from job site and public right of way

DESCRIPTION	TOTAL LIN FT	TOTAL SQ FT
CHAIN LINK OR WIRE MESH		
ORNAMENTAL IRON		
WOOD		
MASONRY <u>6x4x4</u>	<u>412</u>	<u>246</u>
RETAINING		

OTHER INSPECTIONS AND FEES	
1	Inspections outside of normal business hours = \$30.00 per hour (minimum charge three hours)
2	Re-inspection fee during normal business hours assessed under provisions of TABLE 3-A of the Uniform Building Code = \$30.00 each
3	Inspections during normal business hours for which no fee is specifically indicated = \$30.00 per hour (minimum charge one half hour)
4	Additional plan review required by changes, additions or revisions at approved plans = \$30.00 per hour (minimum charge two hours)

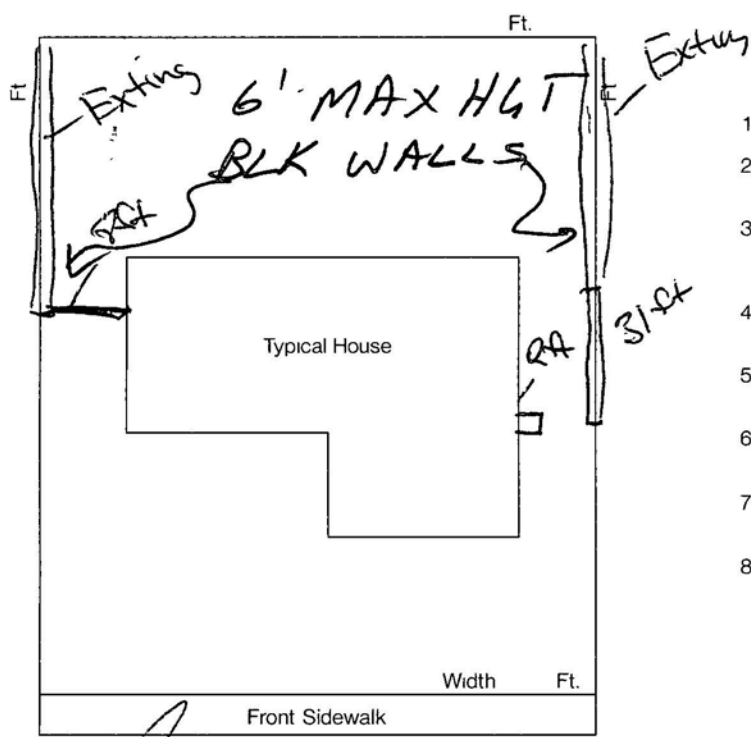

**CONDITIONS OF THE PERMIT:**

- Any type of retaining wall must be engineered by a Civil or Structural Engineer.
- If a home owner takes out the Building Permit and if the owner sublets the work to a Contractor, then the Contractor must take out the permit and pay for it
- No fence or wall can be built on City property or rights-of-way, but this is not intended to preclude construction within utility easements if utilities will not be damaged or made inaccessible.
- The fence or wall shall not enclose any water meter, light standard, or fire alarm box and shall not come closer than 24" from the nearest fire hydrant outlet.
- Department Inspectors must approve footings before concrete is poured and block wall reinforcing before grouting is done.
- Maximum height of any wall or fence is 6', side and rear yards; 4' maximum in front yard with the vertical surface above the height of 2' - 50% open.
- I must not obstruct required onsite parking space (2 spaces for each dwelling unit) by the erection of this fence or wall
- By the signing of this application I herewith agree to the requirements outlined above

**FOR INSPECTIONS, CALL 799-2071**

SIGNED [Signature] CONTRACTOR - AGENT / OWNER  
 PLANNING DEPT [Signature] DATE 11/14/89

11/15/89

I hereby certify that I have reviewed this application and the proposed plans and have found that the proposed development meets the requirements of the City of Las Vegas Flood Hazard Reduction Ordinance for the issuance of this Development Permit.

LAND DEVELOPMENT AND FLOOD CONTROL ENGINEER [Signature] DATE 11/14/89  
 BUILDING DEPT [Signature] DATE 11-15-89

RECEIPT	
**0003**	
WALL	72.50
CHEK	72.50
5005A000	10:01

PLAN REVIEW FEE \_\_\_\_\_  
 PERMIT FEE 15.00  
 2310-2401  
 TOTAL FEES 15.00

PI SH 5C ES  
**CITY OF LAS VEGAS, NEVADA**



93184519

**DEVELOPMENT PERMIT**  
 FOR: Fence, Wall, Retaining Wall

DEPARTMENT OF BUILDING AND SAFETY: PHONE 229-2271  
 FOR INSPECTIONS: CALL 229-2071

**PERMIT NO. 93-184519**

PLAN CHECK NO. M-2061 DATE April 26, 1993 CONST. VAL. \$ 229.00

ADDRESS OF CONSTRUCTION 4817 Holly Grove Dr OWNER Kenneth Green CONTRACTOR PHONE 658548

CONTRACTOR owner STATE LICENSE NO. \_\_\_\_\_ CITY LICENSE NO. \_\_\_\_\_

LOT(s) 5 BLOCK 3 SUBDIVISION Whispering Pines #3 ZONE: R-1

CONSTRUCTION PLANS SUBMITTED BY OWNER/CONTRACTOR  CONSTRUCTION DESIGN BY CITY DESIGN SHEET

ENGINEER Mendenhall Smith

Approval for the work under this permit will be given only after refuse and debris have been removed from job site and public right of way

DESCRIPTION	TOTAL LIN FT	TOTAL SQ. FT.
CHAIN LINK OR WIRE MESH		
ORNAMENTAL IRON		
WOOD		
MASONRY <u>15</u>	<u>65</u>	<u>92</u>
RETAINING		

**OTHER INSPECTIONS AND FEES**

- inspections outside of normal business hours = \$30.00 per hour (minimum charge three hours)
- Re-inspection fee during normal business hours assessed under provisions of TABLE 3-A of the Uniform Building Code = \$30.00 each
- inspections during normal business hours for which no fee is specifically indicated = \$30.00 per hour (minimum charge one half hour)
- Additional plan review required by changes, additions or revisions at approved plans = \$30.00 per hour (minimum charge two hours)

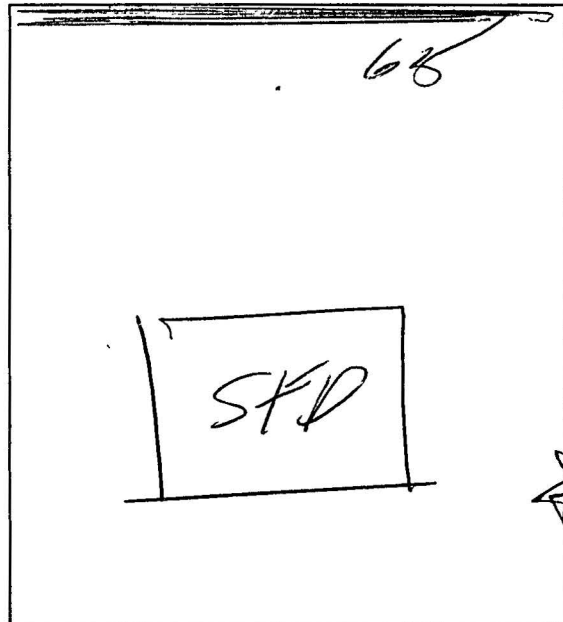

**CONDITIONS OF THE PERMIT:**

- Any type of retaining wall must be engineered by a Civil or Structural Engineer
- If a home owner takes out the Building Permit and if the owner sublets the work to a Contractor, then the Contractor must take out the permit and pay for it.
- No fence or wall can be built on City property or rights-of-way, but this is not intended to preclude construction within utility easements if utilities will not be damaged or made inaccessible.
- The fence or wall shall not enclose any water meter, light standard, or fire alarm box and shall not come closer than 24" from the nearest fire hydrant outlet.
- Department inspectors must approve footings before concrete is poured and block wall reinforcing before grouting is done.
- Maximum height of any wall or fence is 6', side and rear yards; 4' maximum in front yard with the vertical surface above the height of 2' — 50% open.
- I must not obstruct required onsite parking space (2 spaces for each dwelling unit) by the erection of this fence or wall.
- This fence or wall shall not block the natural flow of surface water across the property nor shall it divert the flow of surface waters onto another's property
- By the signing of this application I herewith agree to the requirements outlined above.

**FOR INSPECTIONS, CALL 229-2071**

SIGNED Kenneth Green TD-OK  
 CONTRACTOR - AGENT - OWNER  
 PLANNING DEPT 4/26/93 DATE

I hereby certify that I have reviewed this application and the proposed plans and have found that the proposed development meets the requirements of the City of Las Vegas Flood Hazard Reduction Ordinance for the issuance of this Development Permit

Mendenhall Smith 4/26/93  
 LAND DEVELOPMENT AND FLOOD CONTROL ENGINEER DATE

Jim Clave Hardy 4/26/93  
 BUILDING DEPT DATE

PERMIT FEE 13.00  
 2310-2401  
 PLAN REVIEW FEE 9.00 04/26/93  
 ZONING 1.00  
 TOTAL FEES 23.00

RECEIPT

\*\*0006\*\*

WALL	13.00
PLCK	9.00
ZONE	1.00
CASH	23.00
7044A000	14:00

**Permit Expires 180 Days After Abandonment of Work**

21348

I, Mr. Green am giving Rick King the consent to pull a permit for a block wall located at 4817 Hollygrove, Las Vegas, Nevada.



Mr. Green

Subscribed and sworn to before me this 13<sup>th</sup> day of Nov 1989.

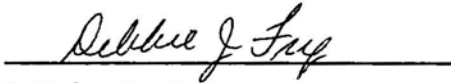

Debbie J. Fry

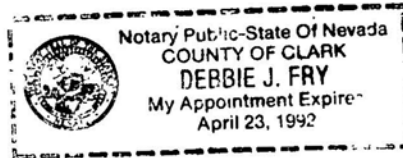

Notary Public for the State of Nevada, County of Clark.