

CITY OF LAS VEGAS NEVADA

90  
90060658  
CONST. VAL. \$ 460  
4-19-90

LOG NO. & AREA M-90



DEPARTMENT OF BUILDING AND SAFETY  
PHONE 386-6251

PERMIT AND BUILDING PERMIT

FOR: Fence, Wall, Retaining Wall

ADDRESS OF CONSTRUCTION 4909 HOLLY GROVE DR OWNER FRANK DENNARD GUEZ PHONE 645-4403

CONTRACTOR OWNER STATE LICENSE NO. \_\_\_\_\_ CITY LICENSE NO. \_\_\_\_\_

LOT(s) 9 BLOCK 3 SUBDIVISION Whispering Pines #2 ZONE R-1

CONSTRUCTION PLANS SUBMITTED BY OWNER/CONTRACTOR  CONSTRUCTION DESIGN BY CITY DESIGN SHEET.

BUILDING PERMIT NO. \_\_\_\_\_ ENGINEER \_\_\_\_\_

Approval for the work under this permit will be given only after refuse and debris have been removed from job site and public right of way

DESCRIPTION	TOTAL LIN. FT	TOTAL SQ. FT
CHAIN LINK OR WIRE MESH		
<input checked="" type="checkbox"/> ORNAMENTAL IRON <u>GATE 6' HIGH</u>	<u>9.5</u>	<u>57</u>
WOOD		
<input checked="" type="checkbox"/> MASONRY <u>6' HIGH</u>	<u>25</u>	<u>150</u>
RETAINING		

**OTHER INSPECTIONS AND FEES**

- Inspections outside of normal business hours = \$30.00 per hour (minimum charge three hours)
- Re-inspection fee during normal business hours assessed under provisions of TABLE 3-A of the Uniform Building Code = \$30.00 each
- Inspections during normal business hours for which no fee is specifically indicated = \$30.00 per hour (minimum charge one half hour)
- Additional plan review required by changes, additions or revisions at approved plans = \$30.00 per hour (minimum charge two hours)

FD-OK

**CONDITIONS OF THE PERMIT:**

- Any type of retaining wall must be engineered by a Civil or Structural Engineer.
- If a home owner takes out the Building Permit and if the owner sublets the work to a Contractor, then the Contractor must take out the permit and pay for it.
- No fence or wall can be built on City property or rights-of-way, but this is not intended to preclude construction within utility easements if utilities will not be damaged or made inaccessible
- The fence or wall shall not enclose any water meter, light standard, or fire alarm box and shall not come closer than 24" from the nearest fire hydrant outlet
- Department Inspectors must approve footings before concrete is poured and block wall reinforcing before grouting is done
- Maximum height of any wall or fence is 6', side and rear yards, 4' maximum in front yard with the vertical surface above the height of 2' - 50% open
- It must not obstruct required onsite parking space (2 spaces for each dwelling unit) by the erection of this fence or wall.
- By the signing of this application I herewith agree to the requirements outlined above

FOR INSPECTIONS, CALL 799-2071

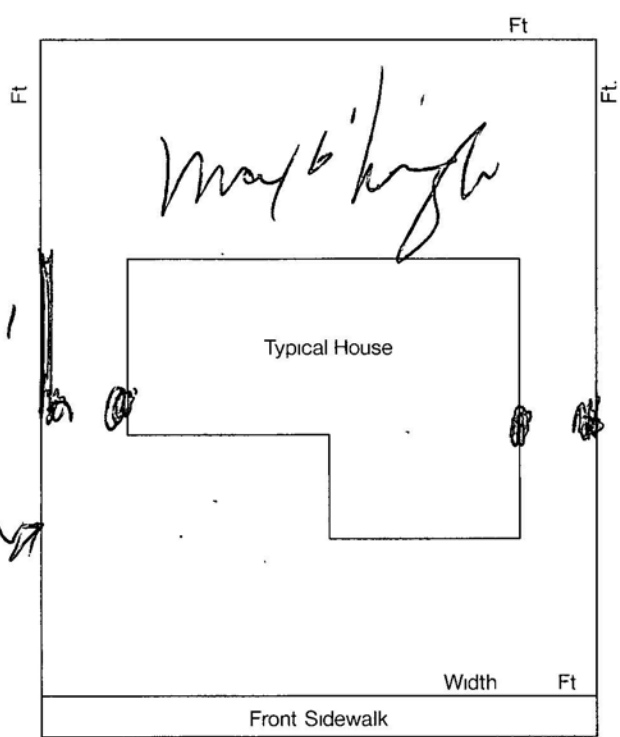

SIGNED Frank A. Guez CONTRACTOR - AGENT - OWNER  
DATE 3/16/90

PLANNING DEPT \_\_\_\_\_ DATE \_\_\_\_\_

I hereby certify that I have reviewed this application and the proposed plans and have found that the proposed development meets the requirements of the City of Las Vegas Flood Hazard Reduction Ordinance for the issuance of this Development Permit.

LAND DEVELOPMENT AND FLOOD CONTROL ENGINEER [Signature] DATE 3/16/90

BUILDING DEPT \_\_\_\_\_ DATE \_\_\_\_\_

03/16/90

RECEIPT

\*\*0006\*\*

WALL 12.00

CASH 12.00

1090A000 16:25

---

PLAN REVIEW FEE \_\_\_\_\_

PERMIT FEE 12

2310-2401

TOTAL FEES 12

MUST BE MACHINE VALIDATED

# CITY OF LAS VEGAS, NEVADA

DEPARTMENT OF BUILDING AND SAFETY  
PHONE 386-6251

FOR INFO



No. 503177 90090177

**DEVELOPMENT PERMIT**  
FOR: Fence, Wall, Retaining Wall

LOG NO. & AREA M-6117-90 DATE 01/26/90 CONST. VAL. \$ 315.00

ADDRESS OF CONSTRUCTION 4909 Holly Grove OWNER Frank Guzzi PHONE \_\_\_\_\_

CONTRACTOR owner STATE LICENSE NO \_\_\_\_\_ CITY LICENSE NO \_\_\_\_\_

LOT(s) 9 BLOCK 3 SUBDIVISION Whispering Pines 2 ZONE R-1

CONSTRUCTION PLANS SUBMITTED BY OWNER/CONTRACTOR  CONSTRUCTION DESIGN BY CITY DESIGN SHEET

ENGINEER \_\_\_\_\_

Approval for the work under this permit will be given only after refuse and debris have been removed from job site and public right of way

DESCRIPTION	TOTAL LIN. FT.	TOTAL SQ. FT.
CHAIN LINK OR WIRE MESH		
ORNAMENTAL IRON		
WOOD		
<input checked="" type="checkbox"/> MASONRY <u>2'</u>	<u>14</u>	<u>28</u>
<input checked="" type="checkbox"/> RETAINING <u>2'</u>	<u>35</u>	<u>70</u>

OTHER INSPECTIONS AND FEES	
1	Inspections outside of normal business hours = \$30.00 per hour (minimum charge three hours)
2	Re-inspection fee during normal business hours assessed under provisions of TABLE 3-A of the Uniform Building Code = \$30.00 each
3	Inspections during normal business hours for which no fee is specifically indicated = \$30.00 per hour (minimum charge one half hour)
4	Additional plan review required by changes, additions or revisions at approved plans = \$30.00 per hour (minimum charge two hours)

*D/OIC*

**CONDITIONS OF THE PERMIT:**

- Any type of retaining wall must be engineered by a Civil or Structural Engineer.
- If a home owner takes out the Building Permit and if the owner sublets the work to a Contractor, then the Contractor must take out the permit and pay for it
- No fence or wall can be built on City property or rights-of-way, but this is not intended to preclude construction within utility easements if utilities will not be damaged or made inaccessible.
- The fence or wall shall not enclose any water meter, light standard, or fire alarm box and shall not come closer than 24" from the nearest fire hydrant outlet
- Department Inspectors must approve footings before concrete is poured and block wall reinforcing before grouting is done.
- Maximum height of any wall or fence is 6'; side and rear yards; 4' maximum in front yard with the vertical surface above the height of 2' - 50% open.
- I must not obstruct required onsite parking space (2 spaces for each dwelling unit) by the erection of this fence or wall.
- By the signing of this application I herewith agree to the requirements outlined above

**FOR INSPECTIONS, CALL 799-2071**

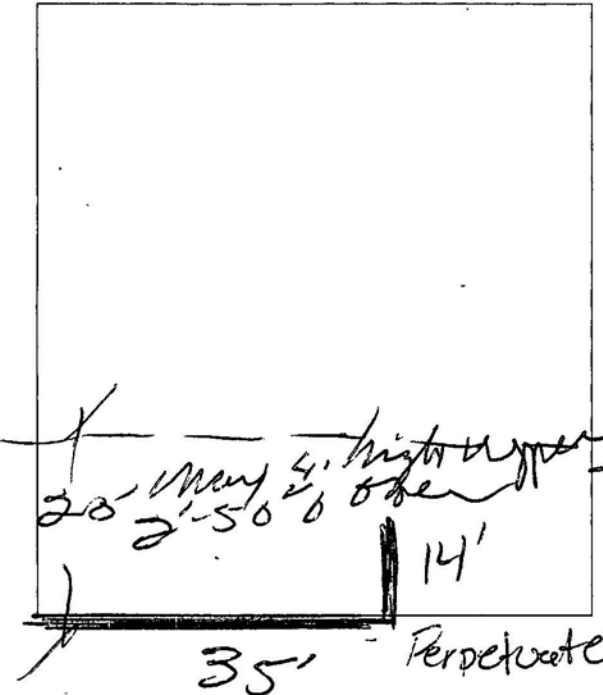

SIGNED \_\_\_\_\_ CONTRACTOR - AGENT - OWNER  
DATE 11/26/90

PLANNING DEPT \_\_\_\_\_  
I hereby certify that I have reviewed this application and the proposed plans and have found that the proposed development meets the requirements of the City of Las Vegas Flood Hazard Reduction Ordinance for the issuance of this Development Permit.

LAND DEVELOPMENT AND FLOOD CONTROL ENGINEER \_\_\_\_\_ DATE 11/26/90

BUILDING DEPT \_\_\_\_\_ DATE 11/26/90

*copy* 11/26/90  
*City*  
*Wesley Street*  
PLAN REVIEW FEE \_\_\_\_\_

PERMIT FEE 2310-2401

TOTAL FEES 200

RECEIPT

MUST BE MACHINE VALIDATED