

CITY OF LAS VEGAS, NEVADA

PERMIT NO. 89-035891

DEPARTMENT OF BUILDING AND SAFETY
PHONE 386-6251

FOR INSPECTIONS, CALL 799-2071

BUILDING PERMIT

FOR: Single Family Dwelling, Remodel, Additions, Misc. Residential Construction

LOG NO. & AREA _____ DATE 280-702-0598/ CONST. VAL \$ 3,200

ADDRESS OF CONSTRUCTION 6905 WELSH CIRCLE OWNER WILLIAM A. MAXWELL JR PHONE 645-2273

LOT(s) 123 BLOCK 3 SUBDIVISION ROSEWOOD ESTATES UNIT #3 ZONE R-PD6

PROPOSED CONSTRUCTION GARAGE ENCLOSURE USE _____

THIS PERMIT FOR _____ BLDG. A/C ELEC. PLBG. OTHER PERMITS REQD.: FENCE OFF SITE SWIM POOL

FLOOR AREA BSMT _____ 1ST _____ 2ND _____ GARAGE _____ PORCH _____ TOTAL 400

CONTRACTOR OWNER STATE LICENSE NO. _____ CITY LICENSE NO. _____

ARCHITECT _____ ENGINEER _____

MASTER PLUMBER/CONTRACTOR _____ MASTER ELECTRICIAN/CONTRACTOR _____

OTHER INSPECTIONS AND FEES

1. Inspections outside of normal business hours = \$30.00 per hour (minimum charge three hours).
2. Re-inspection fee during normal business hours assessed under provisions of TABLE 3-A of the Uniform Building Code = \$30.00 per hour.
3. Inspections during normal business hours for which no fee is specifically indicated = \$30.00 per hour (minimum charge one half hour).
4. Additional plan review required by changes, additions or revisions to approved plans = \$30.00 per hour (minimum charge two hours).

CONDITIONS OF THE PERMIT:

1. I agree to call the City Building Department for inspections before concrete is poured, before rough wiring, electrical, plumbing, framing is covered. Also for air conditioning, drywall and sheathing inspection.
2. I agree that when the job is completed that I will call for final inspection before occupancy.
3. I agree to perform all construction in accordance with City Ordinances and Building Codes.
4. The Contractor's signature below denotes authority from the owner to sign in his behalf and that the owner is aware of all requirements of this application and permit. Separate permits must be taken out for work outlined above this agreement.
5. I have read and understand the contents of this application and permit; I hereby state that the information I have supplied on this application is true and correct.
6. Approval for the work under this permit will be given only after refuse and debris have been removed from job site and public right of way.
7. 24 HOUR MINIMUM NOTICE REQUIRED FOR INSPECTIONS.

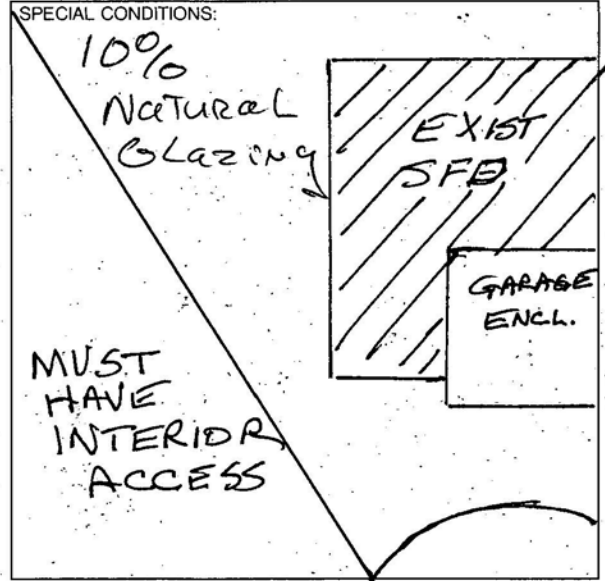

BY: W.A. Maxwell Jr OWNER

BY: _____ AGENT

I hereby certify that I have reviewed this application and the proposed plans and have found that the proposed development meets the requirements of the City of Las Vegas Flood Hazard Reduction Ordinance for the issuance of this Development Permit.

LAND DEVELOPMENT AND FLOOD CONTROL ENGINEER _____ DATE _____

Lee Cornau 8/16/89

BUILDING DEPT. _____ DATE _____

PLUMBING		FEE	ELECTRICAL		FEE
WATER DISTRIBUTION	6.00		RECEPTACLE <u>6</u> SWITCH <u>2</u>	.40	<u>3.20</u>
SEWER SYSTEM - NEW OR MODIFICATION	10.00		EACH LIGHT FIXTURE OR SOCKET	.30	
FIXTURES - WATER SOFTENER, H.W. HEATER	2.00		SPECIAL OUTLET, APPLIANCE ETC.	.70	
GARBAGE DISPOSAL - WASHER	2.00		SERVICE/PANEL - SUB/3.00 - 200A/6.00 - 400A/12.50		
FUEL PIPING	6.00		A.C. UNIT OR MOTORS	3.00	
IRRIGATION SYSTEM	8.00		2310 - 2402	TOTAL	
MISC.			MISC.		
2310 - 2403	TOTAL		2310 - 2401 ISSUANCE FEE		
AIR CONDITIONING		FEE	7114 - 3654 SEWER CONNECTION		
NEW UNIT - 3 TON = 9.00 OVER = 16.50			2310 - 2401 PLAN REVIEW FEE		
FURNACE TO 100,000/9.00 OVER/11.00			2310 - 2401 BLDG. PERMIT FEE	<u>53.00</u>	
VAPORATIVE COOLER	6.50		TOTAL FEES		
VENTILATION FAN	2.35				
2310 - 2405	TOTAL				

RECEIPT 02**
SFD 53.00
CASH 53.00
0575A000 11:54

PERMIT NO. _____ MUST BE MACHINE VALIDATED

Permit Expires 180 Days After Abandonment of Work

DEPARTMENT OF BUILDING & SAFETY CITY OF LAS VEGAS

JOB ADDRESS 6905 WELSH @ R			PERMIT NO. 89035891
LOT NO.	MAP NO.	INSPECTOR 61	DATE 10-2-89
SUBDIVISION NAME			PHONE
INSPECTOR SIGNATURE U. HOFFMAN			INSPECTION DATE 10-2-89

Insp. 140

PARTIAL INSPECTION - DESCRIPTION:

APPROVED **PERMIT REQUIRED** **STOP WORK**

REJECTED - CORRECTION NOTICE - REINSPECTION REQUIRED CALL 799-2071

INSPECT	DESCRIPTION	INSPECT	DESCRIPTION	INSPECT	DESCRIPTION
<input type="checkbox"/> B-1	FOOTING, LAYOUT, REBAR, ZONING	<input type="checkbox"/> P-1	ON SITE SEWER	<input type="checkbox"/> X-2	UNDERGROUND HYDRO
<input type="checkbox"/> B-2	STEM WALL - FORMS & REBAR	<input type="checkbox"/> P-2	ON SITE WATER	<input type="checkbox"/> X-3	UNDERGROUND FINAL/FLOW
<input type="checkbox"/> B-3	PRE-SLAB	<input type="checkbox"/> P-3	BUILDING SEWER (YARD LINES)	<input type="checkbox"/> X-4	SPRINKLER SYSTEM HYDRO
<input type="checkbox"/> B-4	ROOF SHEATHING	<input type="checkbox"/> P-4	UNDERSLAB PLUMBING	<input type="checkbox"/> X-5	FIRE ALARM
<input type="checkbox"/> B-5	FRAMING	<input type="checkbox"/> P-5	TOP OUT-WATER, GAS, WASTE	<input type="checkbox"/> X-6	OTHER:
<input type="checkbox"/> B-6	INSULATION	<input type="checkbox"/> P-6	FINAL GAS TEST	<input type="checkbox"/> X-7	FINAL FIRE
<input type="checkbox"/> B-7	DRYWALL NAILING	<input type="checkbox"/> P-7	FINAL PLUMBING		
<input type="checkbox"/> B-8	EXTERIOR LATH/STUCCO			<input type="checkbox"/> E-1	UNDERGROUND ELECTRICAL
<input type="checkbox"/> B-9	WALL GROUT & STEEL	<input type="checkbox"/> M-1	ROUGH VENT	<input type="checkbox"/> E-2	ROUGH ELECTRICAL
<input type="checkbox"/> B-10	<u>POOL</u> PRE-GUNITE	<input type="checkbox"/> M-2	HOOD	<input type="checkbox"/> E-3	LOW VOLTAGE ELECTRICAL
<input type="checkbox"/> B-11	<u>POOL</u> PRE-PLASTER / FINAL	<input type="checkbox"/> M-3	FINAL MECHANICAL	<input type="checkbox"/> E-4	SIGN INSPECTION
<input checked="" type="checkbox"/> B-12	BUILDING FINAL			<input type="checkbox"/> E-5	FINAL ELECTRICAL
<input checked="" type="checkbox"/> B-13	CERT. OF OCC.	<input type="checkbox"/> X-1	KICKER / FLUSH	<input type="checkbox"/> E-6	TEMP POWER

FINAL INSPECTION BRING HARD CARD WITH FIRE, QUALITY CONTROL & PLANNING APPROVALS SIGNED OFF TO BLDG & SAFETY FOR C. of O. ISSUANCE (Commercial Only)

FOR ASSISTANCE -CALL: 386-6251

DEPARTMENT OF BUILDING & SAFETY CITY OF LAS VEGAS

JOB ADDRESS 6905 WALKER		PERMIT NO. 89035891	
LOT NO.	MAP NO.	INSPECTOR	DATE
SUBDIVISION NAME			PHONE
INSPECTOR SIGNATURE 			INSPECTION DATE 29 SEPT 99

1 insp 240

645-2273

PARTIAL INSPECTION - DESCRIPTION:

APPROVED

 PERMIT REQUIRED

 STOP WORK

REJECTED - CORRECTION NOTICE - REINSPECTION REQUIRED CALL 799-2071

INSPECT	DESCRIPTION	INSPECT	DESCRIPTION	INSPECT	DESCRIPTION
<input type="checkbox"/> B-1	FOOTING, LAYOUT, REBAR, ZONING	<input type="checkbox"/> P-1	ON SITE SEWER	<input type="checkbox"/> X-2	UNDERGROUND HYDRO
<input type="checkbox"/> B-2	STEM WALL - FORMS & REBAR	<input type="checkbox"/> P-2	ON SITE WATER	<input type="checkbox"/> X-3	UNDERGROUND FINAL/FLOW
<input type="checkbox"/> B-3	PRE-SLAB	<input type="checkbox"/> P-3	BUILDING SEWER (YARD LINES)	<input type="checkbox"/> X-4	SPRINKLER SYSTEM HYDRO
<input type="checkbox"/> B-4	ROOF SHEATHING	<input type="checkbox"/> P-4	UNDERSLAB PLUMBING	<input type="checkbox"/> X-5	FIRE ALARM
<input type="checkbox"/> B-5	FRAMING	<input type="checkbox"/> P-5	TOP OUT-WATER, GAS, WASTE	<input type="checkbox"/> X-6	OTHER:
<input type="checkbox"/> B-6	INSULATION	<input type="checkbox"/> P-6	FINAL GAS TEST	<input type="checkbox"/> X-7	FINAL FIRE
<input type="checkbox"/> B-7	DRYWALL NAILING	<input type="checkbox"/> P-7	FINAL PLUMBING		
<input type="checkbox"/> B-8	EXTERIOR LATH/STUCCO			<input type="checkbox"/> E-1	UNDERGROUND ELETTRICAL
<input type="checkbox"/> B-9	WALL GROUT & STEEL	<input type="checkbox"/> M-1	ROUGH VENT	<input type="checkbox"/> E-2	ROUGH ELECTRICAL
<input type="checkbox"/> B-10	<u>POOL</u> PRE-GUNITE	<input type="checkbox"/> M-2	HOOD	<input type="checkbox"/> E-3	LOW VOLTAGE ELECTRICAL
<input type="checkbox"/> B-11	<u>POOL</u> PRE-PLASTER / FINAL	<input type="checkbox"/> M-3	FINAL MECHANICAL	<input type="checkbox"/> E-4	SIGN INSPECTION
<input type="checkbox"/> B-12	BUILDING FINAL			<input checked="" type="checkbox"/> E-5	FINAL ELECTRICAL
<input type="checkbox"/> B-13	CERT. OF OCC.	<input type="checkbox"/> X-1	KICKER / FLUSH	<input type="checkbox"/> E-6	TEMP POWER

FINAL INSPECTION

 BRING HARD CARD WITH FIRE, QUALITY CONTROL & PLANNING APPROVALS SIGNED OFF TO BLDG & SAFETY FOR C. of O. ISSUANCE (Commercial Only)