

CITY OF LAS VEGAS, NEVADA

PERMIT NO. 91-130271

DEPARTMENT OF BUILDING AND SAFETY
PHONE 386-6251

FOR INSPECTIONS CALL 700-9971

BUILDING PERMIT
FOR: Single Family Dwelling, Remodel
Additions, Misc. Residential Construction



71856

LOG NO. & AREA P-196

CONST. VAL. \$ 53,300.00

ADDRESS OF CONSTRUCTION 7713 Wedlock Lane

OWNER Hillside Residential of NV PHONE 658-4472

LOT(s) 42 BLOCK 3 SUBDIVISION Mountain Shadows Estates ZONE R-1

PROPOSED CONSTRUCTION SFD USE DAVE BROWN WEST #3

THIS PERMIT FOR BLDG: A/C ELEC. PLBG. OTHER PERMITS REQD.: FENCE OFF SITE SWIM POOL

FLOOR AREA BSMT _____ 1ST 1829 2ND _____ GARAGE 462 PORCH _____ TOTAL 2291

CONTRACTOR Turn-Key Development, Inc. STATE LICENSE NO. 0032689 CITY LICENSE NO. C11-2-47628

ARCHITECT _____ ENGINEER _____

MASTER PLUMBER/CONTRACTOR _____ MASTER ELECTRICIAN/CONTRACTOR _____

OTHER INSPECTIONS AND FEES

1. Inspections outside of normal business hours = \$30.00 per hour (minimum charge three hours).
2. Re-inspection fee during normal business hours assessed under provisions of TABLE 3-A of the Uniform Building Code = \$30.00 per hour.
3. Inspections during normal business hours for which no fee is specifically indicated = \$30.00 per hour (minimum charge one half hour).
4. Additional plan review required by changes, additions, or revisions to approved plans = \$30.00 per-hour (minimum charge two hours).

CONDITIONS OF THE PERMIT:

1. I agree to call the City Building Department for inspections before concrete is poured, before rough wiring, electrical, plumbing, framing is covered. Also for air conditioning, drywall and sheathing inspection.
2. I agree that when the job is completed that I will call for final inspection before occupancy.
3. I agree to perform all construction in accordance with City Ordinances and Building Codes.
4. The Contractor's signature below denotes authority from the owner to sign in his behalf and that the owner is aware of all requirements of this application and permit. Separate permits must be taken out for work outlined above this agreement.
5. I have read and understand the contents of this application and permit; I hereby state that the information I have supplied of this application is true and correct.
6. Approval for the work under this permit will be given only after refuse and debris have been removed from job site and public right of way.
7. 24 HOUR MINIMUM NOTICE REQUIRED FOR INSPECTIONS.

SPECIAL CONDITIONS:

Plan 800
Post 7/1/91
Requested 6/15/92

BY: _____ I HEREBY DECLARE THAT I AM THE LEGAL OWNER OF THE ABOVE PROPERTY OWNER

BY: [Signature] AGENT

I hereby certify that I have reviewed this application and the proposed plans and have found that the proposed development meets the requirements of the City of Las Vegas Flood Hazard Reduction Ordinance for the issuance of this Development Permit.

[Signature] LAND DEVELOPMENT AND FLOOD CONTROL ENGINEER DATE 12/19/91

[Signature] PLANNING DEPT. DATE 12/20/91

[Signature] BUILDING DEPT. DATE 12/18/91

PLUMBING		FEE	ELECTRICAL		FEE
WATER DISTRIBUTION	6.00		RECEPTACLE _____ SWITCH _____		.40
SEWER SYSTEM - NEW OR MODIFICATION	10.00		EACH LIGHT FIXTURE OR SOCKET _____		.30
FIXTURES - WATER SOFTENER, H.W. HEATER	2.00		SPECIAL OUTLET, APPLIANCE ETC.		.70
GARBAGE DISPOSAL - WASHER	2.00		SERVICE/PANEL - SUB/3.00 - 200A/6.00 - 400A/12.50		3.00
FUEL PIPING	6.00		A.C. UNIT OR MOTORS		2310 - 2432. TOTAL
IRRIGATION SYSTEM	8.00		MISC.		
MISC.			2310 - 2431 ISSUANCE FEE		
2310 - 2433 TOTAL			7143 - 2973 SEWER CONNECTION		
AIR CONDITIONING		FEE	2310 - 2431 PLAN REVIEW FEE		
NEW UNIT - 3 TON = 9.00 OVER = 16.50			2310 - 2431 BLDG. PERMIT FEE		
FURNACE TO 100,000/9.00 OVER/11.00			TOTAL FEES		
VAPORATIVE COOLER	6.50				
VENTILATION FAN	2.35				
2310 - 2435 TOTAL					

TRANS
500.00
500.00
10.00
368.00
1018.00
1978.00

RECEIPT

not bldg. at this time

PERMIT NO. _____

MUST BE MACHINE VALIDATED

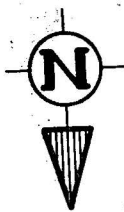
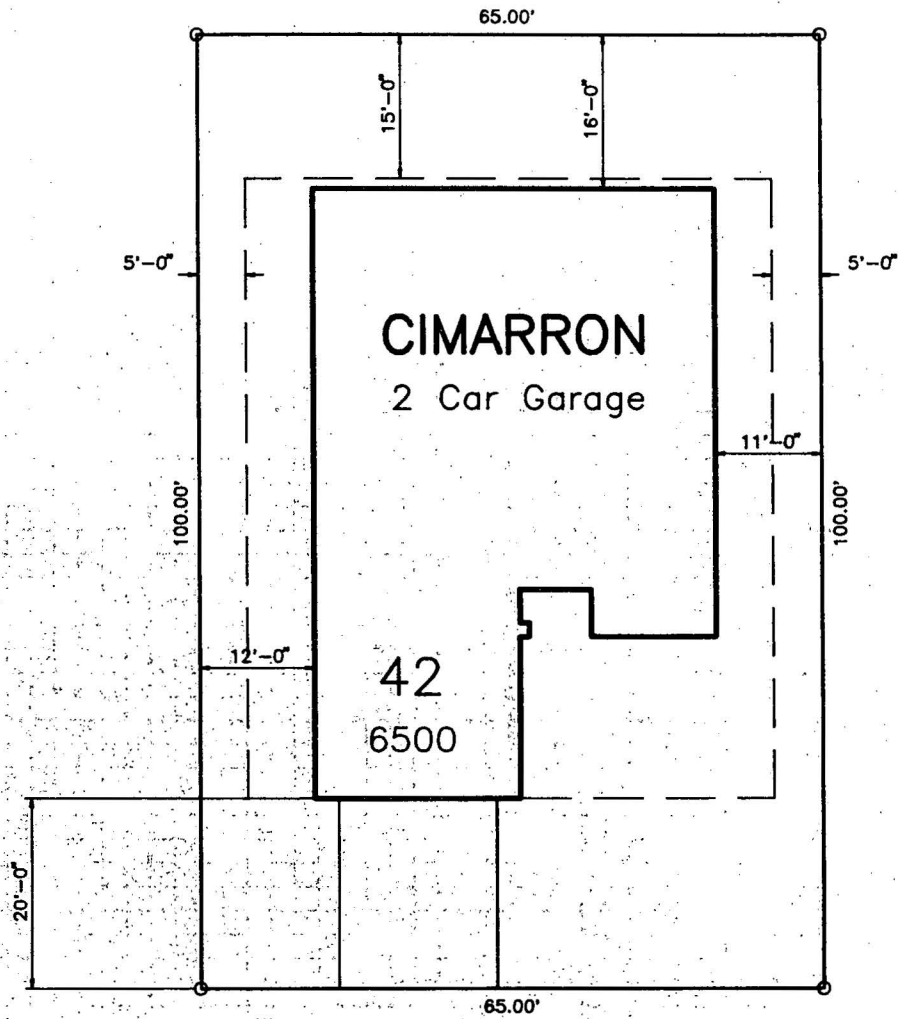

MOUNTAIN SHADOWS PHASE 3

PLOT PLAN 1" = 20.0'

ORIENTATION : Right Hand HOUSE SQ FT : 1829
 ROOF TYPE : Hip & Valley GARAGE SQ FT : 473
 STORIES : One
 STREET : Wedlock Lane - 7713

PLOT PLAN APPROVED
 By: *[Signature]* 12/30/91
 COMMUNITY PLANNING & DEVELOPMENT
 City of Las Vegas



SIDCO - WESTERN, INC.
 LOS ANGELES • CALIFORNIA
 LAS VEGAS • NEVADA
 702/ 658-4190

LAS VEGAS * CLARK COUNTY * NEVADA

LOT 42
 DEC 5 1991