

CITY OF LAS VEGAS, NEVADA

DEPARTMENT OF BUILDING AND SAFETY
PHONE 386-6251

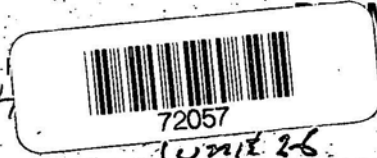

MIT NO: 91-130268

BUILDING PERMIT
FOR: Single Family Dwelling; Remodel
Additions, Misc. Residential Construction

LOG NO. & AREA: P-196 DATE: December 8, 1991 CONST. VAL. \$ 53,300.00

ADDRESS OF CONSTRUCTION: 7708 Wedlock Lane OWNER: Hillside Residential of NV PHONE: 658-4472

LOT(s): 25 BLOCK: 2 SUBDIVISION: Mountain Shadows Estates ZONE: R-1

PROPOSED CONSTRUCTION: SFD USE: _____

THIS PERMIT FOR: BLDG. A/C ELEC. PLBG. OTHER PERMITS REQD.: FENCE OFF SITE SWIM POOL

FLOOR AREA: BSMT _____ 1ST: 1829 2ND _____ GARAGE: 462 PORCH _____ TOTAL: 2291

CONTRACTOR: Turn-Key Development, Inc. STATE LICENSE NO.: 0032689 CITY LICENSE NO.: C11-2-47628

ARCHITECT _____ ENGINEER _____
MASTER PLUMBER/CONTRACTOR _____ MASTER ELECTRICIAN/CONTRACTOR _____

OTHER INSPECTIONS AND FEES

- Inspections outside of normal business hours = \$30.00 per hour (minimum charge three hours).
- Re-inspection fee during normal business hours assessed under provisions of TABLE 3-A of the Uniform Building Code = \$30.00 per hour.
- Inspections during normal business hours for which no fee is specifically indicated = \$30.00 per hour (minimum charge one half hour).
- Additional plan review required by changes, additions, or revisions to approved plans = \$30.00 per-hour (minimum charge two hours).

CONDITIONS OF THE PERMIT:

- I agree to call the City Building Department for inspections before concrete is poured, before rough wiring, electrical, plumbing, framing is covered. Also for air conditioning, dry wall and sheathing inspection.
- I agree that when the job is completed that I will call for final inspection before occupancy.
- I agree to perform all construction in accordance with City Ordinances and Building Codes.
- The Contractor's signature below denotes authority from the owner to sign in his behalf and that the owner is aware of all requirements of this application and permit. Separate permits must be taken out for work outlined above this agreement.
- I have read and understand the contents of this application and permit; I hereby state that the information I have supplied on this application is true and correct.
- Approval for the work under this permit will be given only after refuse and debris have been removed from job site and public right of way.
- 24 HOUR MINIMUM NOTICE REQUIRED FOR INSPECTIONS.

SPECIAL CONDITIONS:
Plan 800
Post 7/1/91
Requested Refunded 6/15/92

BY: _____ I HEREBY DECLARE THAT I AM THE LEGAL OWNER OF THE ABOVE PROPERTY OWNER

BY: [Signature] AGENT

I hereby certify that I have reviewed this application and the proposed plans and have found that the proposed development meets the requirements of the City of Las Vegas Flood Hazard Reduction Ordinance for the issuance of this Development Permit.

[Signature] 12-19-91
LAND DEVELOPMENT AND FLOOD CONTROL ENGINEER DATE

[Signature] 12/20/91
PLANNING DEPT. DATE

[Signature] 12/18/91
BUILDING DEPT. DATE

PLUMBING		FEE	ELECTRICAL		FEE
WATER DISTRIBUTION	6.00		RECEPTACLE _____ SWITCH _____		.40
SEWER SYSTEM - NEW OR MODIFICATION	10.00		EACH LIGHT FIXTURE OR SOCKET _____		.30
FIXTURES - WATER SOFTENER, H.W. HEATER	2.00		SPECIAL OUTLET, APPLIANCE ETC.		.70
GARBAGE DISPOSAL - WASHER	2.00		SERVICE/PANEL - SUB/3.00 - 200A/6.00 - 400A/12.50		3.00
FUEL PIPING	6.00		A.C. UNIT OR MOTORS		3.00
IRRIGATION SYSTEM	8.00		2310 - 2432	TOTAL	
MISC.			MISC.		
2310 - 2433			<u>TRANS</u>		
TOTAL			2310 - 2431 ISSUANCE FEE		500.00
AIR CONDITIONING		FEE	7143 - 2973 SEWER CONNECTION		1100.00
NEW UNIT - 3 TON = 9.00 OVER = 16.50			2310 - 2431 PLAN REVIEW FEE		10.00
FURNACE TO 100,000/9.00 OVER/11.00			2310 - 2431 BLDG. PERMIT FEE		368.00
VAPORATIVE COOLER	6.50		TOTAL FEES		1978.00
VENTILATION FAN	2.35				
2310 - 2435					
TOTAL					

RECEIPT
not bldg.
at this time
PERMIT NO. _____
MUST BE MACHINE VALIDATED

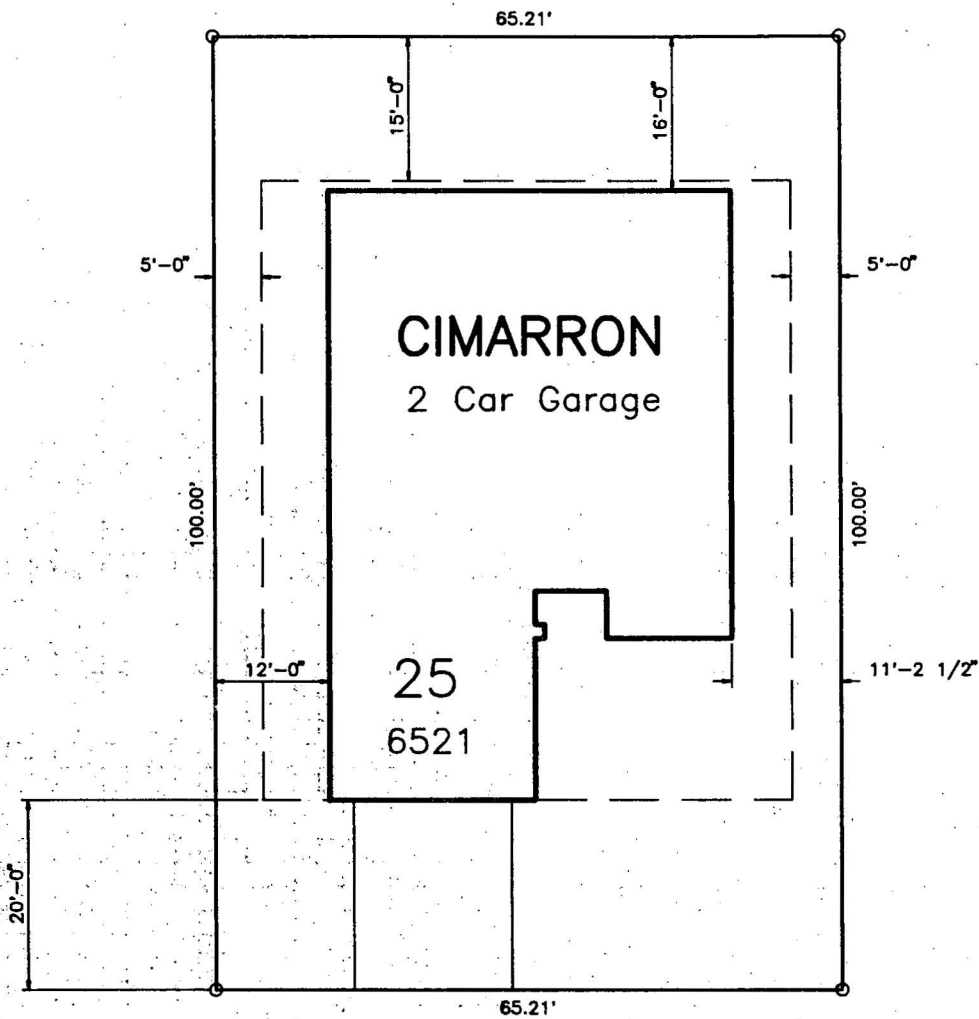

MOUNTAIN SHADOWS PHASE 3

PLOT PLAN 1" = 20.0'

ORIENTATION : Right Hand
 ROOF TYPE : Hip & Valley
 STORIES : One
 STREET : Wedlock Lane - 7708

HOUSE SQ FT : 1829
 GARAGE SQ FT : 473

PLOT PLAN APPROVED
 By *[Signature]* 12/5/91
 COMMUNITY PLANNING & DEVELOPMENT
 City of Las Vegas



SIDCO - WESTERN, INC.
 LOS ANGELES • CALIFORNIA
 LAS VEGAS • NEVADA
 702/ 658-4190

LAS VEGAS * CLARK COUNTY * NEVADA

LOT 25
DEC 5 1991