

CITY OF LAS VEGAS, NEVADA

00-057232

LOG NO. & AREA _____ DATE _____ CONST. VAL. \$ 2,370

DEPARTMENT OF BUILDING AND SAFETY
PHONE 386-6251

DEVELOPMENT PERMIT AND BUILDING PERMIT

FOR: Fence, Wall, Retaining Wall 90060232

ADDRESS OF CONSTRUCTION 8512 WAYCROSS OWNER [Signature] PHONE _____

CONTRACTOR "B" TEAM CONST. STATE LICENSE NO. 28663 CITY LICENSE NO. 040113

LOT(s) 12 BLOCK 98 SUBDIVISION SUN CITY SUMMERLIN #15 ZONE: P.C

CONSTRUCTION PLANS SUBMITTED BY OWNER/CONTRACTOR CONSTRUCTION DESIGN BY CITY DESIGN SHEET.

BUILDING PERMIT NO. _____ ENGINEER _____

Approval for the work under this permit will be given only after refuse and debris have been removed from job site and public right of way.

DESCRIPTION	TOTAL LIN. FT.	TOTAL SQ. FT.
CHAIN LINK OR WIRE MESH		
ORNAMENTAL IRON		
WOOD		
<input checked="" type="checkbox"/> MASONRY	<u>158</u>	<u>948</u>
RETAINING		

OTHER INSPECTIONS AND FEES	
1.	Inspections outside of normal business hours = \$30.00 per hour (minimum charge three hours).
2.	Re-inspection fee during normal business hours assessed under provisions of TABLE 3-A of the Uniform Building Code = \$30.00 each.
3.	Inspections during normal business hours for which no fee is specifically indicated = \$30.00 per hour (minimum charge one half hour).
4.	Additional plan review required by changes, additions or revisions at approved plans = \$30.00 per hour (minimum charge two hours).

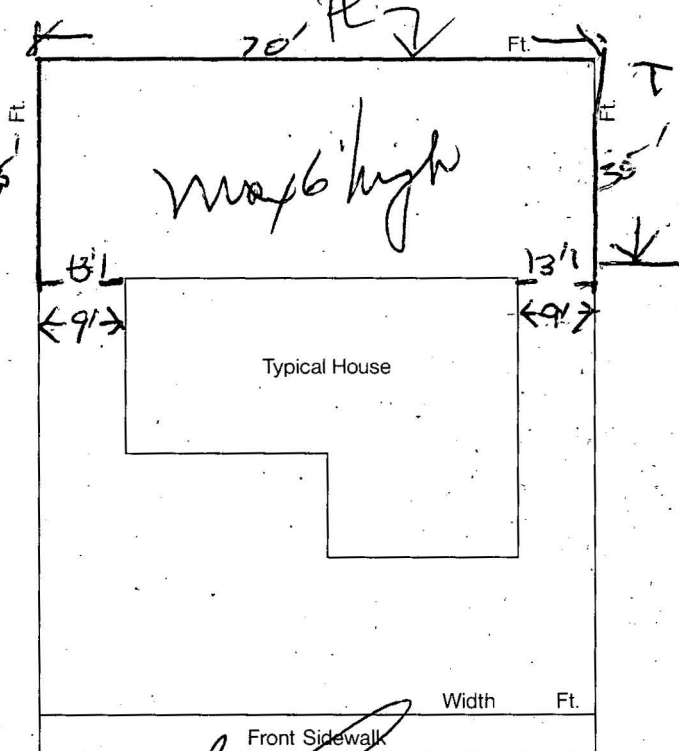

CONDITIONS OF THE PERMIT:

1. Any type of retaining wall must be engineered by a Civil or Structural Engineer.
2. If a home owner takes out the Building Permit and if the owner sublets the work to a Contractor, then the Contractor must take out the permit and pay for it.
3. No fence or wall can be built on City property or rights-of-way, but this is not intended to preclude construction within utility easements if utilities will not be damaged or made inaccessible.
4. The fence or wall shall not enclose any water meter, light standard, or fire alarm box and shall not come closer than 24" from the nearest fire hydrant outlet.
5. Department Inspectors must approve footings before concrete is poured and block wall reinforcing before grouting is done.
6. Maximum height of any wall or fence is 6', side and rear yards; 4' maximum in front yard with the vertical surface above the height of 2' - 50% open.
7. I must not obstruct required onsite parking space (2 spaces for each dwelling unit) by the erection of this fence or wall.
8. By the signing of this application I herewith agree to the requirements outlined above.

FOR INSPECTIONS, CALL 799-2071

SIGNED [Signature] CONTRACTOR - AGENT - OWNER
DATE 3/14/90

PLANNING DEPT. _____
I hereby certify that I have reviewed this application and the proposed plans and have found that the proposed development meets the requirements of the City of Las Vegas Flood Hazard Reduction Ordinance for the issuance of this Development Permit.

LAND DEVELOPMENT AND FLOOD CONTROL ENGINEER [Signature] DATE 3/14/90

BUILDING DEPT. [Signature] DATE 3-14-90

RECEIPT	
0002	
WALL	46.00
CASH	46.00
0885A000	13:33

03/14/90

PLAN REVIEW FEE _____

PERMIT FEE 46.00
2310-2401

TOTAL FEES _____

MUST BE MACHINE VALIDATED

