

LOG NO. & AREA

DATE

CONST. VAL. \$

DEPARTMENT OF BUILDING AND SAFETY

PHONE 386-6251

DEVELOPMENT PERMIT AND BUILDING PERMIT

FOR: Fence, Wall, Retaining Wall

ADDRESS OF CONSTRUCTION

6713 Waterville Cr

OWNER Chung Sun Louie

PHONE 870-0376

CONTRACTOR

Owner

STATE LICENSE NO.

CITY LICENSE NO.

LOT(s)

23

BLOCK

1

SUBDIVISION

Monte Alta Meadows #1

ZONE:

R-CL

CONSTRUCTION PLANS SUBMITTED BY OWNER/CONTRACTOR

CONSTRUCTION DESIGN BY CITY DESIGN SHEET

BUILDING PERMIT NO.

ENGINEER

Approval for the work under this permit will be given only after refuse and debris have been removed from job site and public right of way.

DESCRIPTION	TOTAL LIN. FT.	TOTAL SQ. FT.
CHAIN LINK OR WIRE MESH	134	536
ORNAIMENTAL IRON 1' HIGH	134	134
WOOD		536
MASONRY 1' HIGH	134	134
RETAINING		

OTHER INSPECTIONS AND FEES

- Inspections outside of normal business hours = \$30.00 per hour (minimum charge three hours).
- Re-inspection fee during normal business hours assessed under provisions of TABLE 3-A of the Uniform Building Code = \$30.00 each.
- Inspections during normal business hours for which no fee is specifically indicated = \$30.00 per hour (minimum charge one half hour). Additional plan review required by changes, additions or revisions at approved plans = \$30.00 per hour (minimum charge two hours).

CONDITIONS OF THE PERMIT:

- Any type of retaining wall must be engineered by a Civil or Structural Engineer.
- If a home owner takes out the Building Permit and if the owner sublets the work to a Contractor, then the Contractor must take out the permit and pay for it.
- No fence or wall can be built on City property or rights-of-way, but this is not intended to preclude construction within utility easements if utilities will not be damaged or made inaccessible.
- The fence or wall shall not enclose any water meter, light standard, or fire alarm box and shall not come closer than 24" from the nearest fire hydrant outlet.
- Department Inspectors must approve footings before concrete is poured and block wall reinforcing before grouting is done.
- Maximum height of any wall or fence is 6', side and rear yards; 4' maximum in front yard with the vertical surface above the height of 2' - 50% open.
- I must not obstruct required onsite parking space (2 spaces for each dwelling unit) by the erection of this fence or wall.
- By the signing of this application I herewith agree to the requirements outlined above.

FOR INSPECTIONS, CALL 799-2071

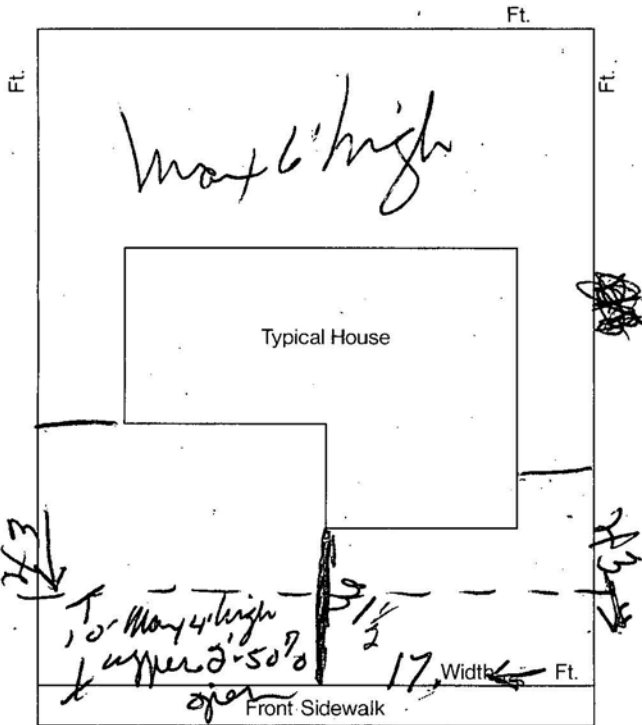

SIGNED Cathie Louie CONTRACTOR - AGENT - OWNER

[Signature] DATE 12/26/89

PLANNING DEPT. I hereby certify that I have reviewed this application and the proposed plans and have found that the proposed development meets the requirements of the City of Las Vegas Flood Hazard Reduction Ordinance for the issuance of this Development Permit.

LAND DEVELOPMENT AND FLOOD CONTROL ENGINEER [Signature] DATE 12/26/89

BUILDING DEPT. [Signature] DATE 12/26/89

RECEIPT

##0002**

WALL 46.20

CASH 46.20

6926A000 11:01

12/27/89

PLAN REVIEW FEE 46.20

PERMIT FEE 2310-2401 46.20

TOTAL FEES 46.20

MUST BE MACHINE VALIDATED