

CITY OF LAS VEGAS, NEVADA

PERMIT NO. 90-079742

DEPARTMENT OF BUILDING AND SAFETY
PHONE 386-6251



BUILDING PERMIT
FOR: Single Family Dwelling, Remodel
Additions, Misc. Residential Construction

LOG NO. & AREA M-3737-90 DATE 07/22/90 CONST. VAL \$ 2324.00

ADDRESS OF CONSTRUCTION 2813 WATERVIEW DR OWNER FRANK CARBOLE PHONE 3635362

LOT(s) 4 BLOCK 2 SUBDIVISION Bluffs 6A ZONE RPP

PROPOSED CONSTRUCTION PATIO COVER USE _____

THIS PERMIT FOR: BLDG. A/C ELEC. PLBG. OTHER PERMITS REQD: FENCE OFF SITE SWIM POOL

FLOOR AREA BSMT _____ 1ST _____ 2ND _____ GARAGE _____ PORCH _____ TOTAL 332

CONTRACTOR SILVER STAR CONST STATE LICENSE NO. 26421 CITY LICENSE NO. 036408

ARCHITECT _____ ENGINEER _____
MASTER PLUMBER/CONTRACTOR _____ MASTER ELECTRICIAN/CONTRACTOR _____

OTHER INSPECTIONS AND FEES

- Inspections outside of normal business hours = \$30.00 per hour (minimum charge three hours).
- Re-inspection fee during normal business hours assessed under provisions of TABLE 3-A of the Uniform Building Code = \$30.00 per hour.
- Inspections during normal business hours for which no fee is specifically indicated = \$30.00 per hour (minimum charge one half hour).
- Additional plan review required by changes, additions, or revisions to approved plans = \$30.00 per hour (minimum charge two hours).

CONDITIONS OF THE PERMIT:

- I agree to call the City Building Department for inspections before concrete is poured, before rough wiring, electrical, plumbing, framing is covered. Also for air conditioning, drywall and sheathing inspection.
- I agree that when the job is completed that I will call for final inspection before occupancy.
- I agree to perform all construction in accordance with City Ordinances and Building Codes.
- The Contractor's signature below denotes authority from the owner to sign in his behalf and that the owner is aware of all requirements of this application and permit. Separate permits must be taken out for work outlined above, this agreement.
- I have read and understand the contents of this application and permit; I hereby state that the information I have supplied on this application is true and correct.
- Approval for the work under this permit will be given only after refuse and debris have been removed from job site and public right of way.
- 24 HOUR MINIMUM NOTICE REQUIRED FOR INSPECTIONS.

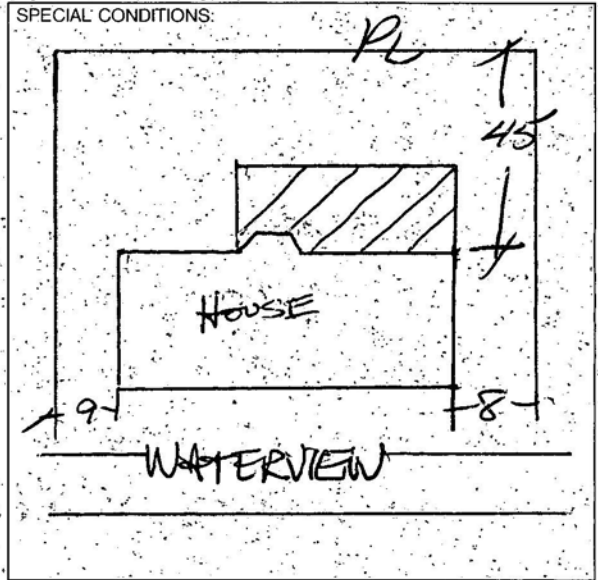

BY: _____ OWNER
I HEREBY DECLARE THAT I AM THE LEGAL OWNER OF THE ABOVE PROPERTY.
BY: [Signature] AGENT

I hereby certify that I have reviewed this application and the proposed plans and have found that the proposed development meets the requirements of the City of Las Vegas Flood Hazard Reduction Ordinance for the issuance of this Development Permit.

LAND DEVELOPMENT AND FLOOD CONTROL ENGINEER _____ DATE 8/22/90
PLANNING DEPT. _____ DATE _____
BUILDING DEPT. [Signature] DATE 8/22/90

As per City files copy sheet not convertible

PLUMBING	FEE	ELECTRICAL	FEE
WATER DISTRIBUTION	6.00	RECEPTACLE _____ SWITCH _____	.40
SEWER SYSTEM - NEW OR MODIFICATION	10.00	EACH LIGHT FIXTURE OR SOCKET _____	.30
FIXTURES - WATER SOFTENER, H.W. HEATER	2.00	SPECIAL OUTLET, APPLIANCE ETC.	.70
GARBAGE DISPOSAL - WASHER	2.00	SERVICE/PANEL - SUB/3.00-200A/6.00-400A/12.50	
FUEL PIPING	6.00	A.C. UNIT OR MOTORS	3.00
IRRIGATION SYSTEM	8.00	2310 - 2432	TOTAL
MISC.		MISC.	
2310 - 2433	TOTAL	2310 - 2431 ISSUANCE FEE	
AIR CONDITIONING	FEE	7143 - 2973 SEWER CONNECTION	
NEW UNIT - 3 TON = 9.00 OVER = 16.50		2310 - 2431 PLAN REVIEW FEE	
FURNACE TO 100,000/9.00 OVER/11.00		2310 - 2431 BLDG. PERMIT FEE	<u>46.00</u>
VAPORATIVE COOLER	6.50	TOTAL FEES	
VENTILATION FAN	2.35		
2310 - 2435	TOTAL		

RECEIPT 05**
SFD 46.00
CHEK 46.00
0292A000 08:10

Permit Expires 180 Days After Abandonment of Work.

PERMIT NO. _____ MUST BE MACHINE VALIDATED

CITY OF LAS VEGAS, NEVADA

PERMIT NO. 90-078210

90078210
DEVELOPMENT PERMIT
FOR: Swimming Pool or Spa

DEPARTMENT OF BUILDING AND SAFETY
PHONE 386-6251



LOG NO. & AREA M/3423-90 DATE 8/9/90 CONST. VAL. \$ 5,630.00

ADDRESS OF CONSTRUCTION 2813 Waterview Dr. OWNER CARBONE, Frank, Jr. PHONE 363-5362

CONTRACTOR Tropicana Sylvan Pools STATE LICENSE NO. 23414 CITY LICENSE NO. C11-00171-2-007454

LOT(s) 4 BLOCK 2 SUBDIVISION The Bluffs 6A ZONE: R-CU

PLUMBING CONTRACTOR Tropicana Sylvan Pools ELECTRICAL CONTRACTOR Phillip Cortney High Energy

CIRCLE TYPE OF POOL THAT APPLIES: PRIVATE SEMI-PUBLIC PUBLIC SPA

MATERIALS OF CONSTRUCTION: REINFORCED GUNITE REINFORCED CONCRETE OTHER

SQUARE FEET OF SURFACE POOL 435 SPA 28 VOLUME IN GALLONS 15769

Approval for the work under this permit will be given only after refuse and debris have been removed from job site and public right of way.

All swimming pools must be fenced before the pool is filled with water. No electrical lines shall cross over a pool. Applicants must have separate plot plans showing location of power pole, proposed or existing fencing and location of swimming pool. I agree to repair any utility line, if damaged during excavation work. I have read and understand the contents of above application. I hereby state that the same are true and correct.

I state that I am familiar with the effective ordinances of the City of Las Vegas, Nevada and the effective Statutes of the State of Nevada covering construction and use of the above type; I agree to perform said construction in conformity therewith. I further agree that issuance of a permit on the above application will not excuse me from conforming with the said Ordinances and Statutes despite any errors on the part of the building inspector or engineer in checking plans and application herewith.

SIGNED [Signature] CONTRACTOR
BY [Signature] AGENT/OWNER
PLANNING DEPT. [Signature] DATE 8/9/90
BUILDING DEPT. [Signature] DATE 8/9/90

1. Inspections outside of normal business hours = \$30.00 per hour (minimum charge three hours).
2. Re-Inspection fee during normal business hours assessed under provisions of TABLE 3-A of the Uniform Building Code = \$30.00 each.
3. Inspections during normal business hours for which no fee is specifically indicated = \$30.00 per hour (minimum charge one half hour).
4. Additional plan review required by changes, additions or revisions to approved plans = \$30.00 per hour (minimum charge two hours).

DESCRIPTION		FEE	TOTAL
ISSUANCE FEE		10.00	10.00
SEWER CONNECTION FEE (to 30,000 GALLONS)		58.00	68.00
BUILDING PERMIT - POOL & OR SPA:			68.00
PLUMBING PERMIT	PRIVATE POOL OR SPA	PREFORMED SPA 10.00 OTHERWISE 20.00	20.00
	PUBLIC OR SEMI-PUBLIC POOL OR SPA	PREFORMED SPA 20.00 OTHERWISE 30.00	08/09/90
		FUEL PIPING FOR POOL HEATER	6.00
	ELECTRICAL PERMIT	SPA	8.00
SWIMMING POOL		RESIDENTIAL 20.00 PUBLIC-SEMI-PUBLIC 30.00	20.00
		ELECTRICAL SERVICE CHANGE	6.00
MISC.			
TOTAL FEES			195.00

RECEIPT

0006

POOL	78.00
SEWR	63.00
PLBG	26.00
ELEC	28.00
CHEK	195.00
9542A000	08:41

MUST BE MACHINE VALIDATED

PERMIT EXPIRES 180 DAYS AFTER ABANDONMENT OF WORK

DEPARTMENT OF BUILDING & SAFETY CITY OF LAS VEGAS

JOB ADDRESS <i>2813 Waterview Dr</i>		PERMIT NO. <i>90079742</i>	
LOT NO.	MAP NO. <i>13</i>	INSPECTOR <i>59</i>	DATE <i>10-2-90</i>
SUBDIVISION NAME <i>The Bluffs</i>		PHONE	
INSPECTOR SIGNATURE <i>B. Bates</i>		INSPECTION DATE <i>10/4/90</i>	

patio cover

A# 60912
P# 90079742

PARTIAL INSPECTION - DESCRIPTION:

APPROVED
 PERMIT REQUIRED
 STOP WORK

REJECTED - CORRECTION NOTICE - REINSPECTION REQUIRED CALL 799-2071.

INSPECT	DESCRIPTION	INSPECT	DESCRIPTION	INSPECT	DESCRIPTION
<input type="checkbox"/> B-1	FOOTING, LAYOUT, REBAR, ZONING	<input type="checkbox"/> P-1	ON SITE SEWER	<input type="checkbox"/> X-2	UNDERGROUND HYDRO
<input type="checkbox"/> B-2	STEM WALL - FORMS & REBAR	<input type="checkbox"/> P-2	ON SITE WATER	<input type="checkbox"/> X-3	UNDERGROUND FINAL/FLOW
<input type="checkbox"/> B-3	PRE-SLAB	<input type="checkbox"/> P-3	BUILDING SEWER (YARD LINES)	<input type="checkbox"/> X-4	SPRINKLER SYSTEM HYDRO
<input type="checkbox"/> B-4	ROOF SHEATHING	<input type="checkbox"/> P-4	UNDERSLAB PLUMBING	<input type="checkbox"/> X-5	FIRE ALARM
<input type="checkbox"/> B-5	FRAMING	<input type="checkbox"/> P-5	TOP OUT-WATER, GAS, WASTE	<input type="checkbox"/> X-6	OTHER:
<input type="checkbox"/> B-6	INSULATION	<input type="checkbox"/> P-6	FINAL GAS TEST	<input type="checkbox"/> X-7	FINAL FIRE
<input type="checkbox"/> B-7	DRYWALL NAILING	<input type="checkbox"/> P-7	FINAL PLUMBING		
<input type="checkbox"/> B-8	EXTERIOR LATH/STUCCO			<input type="checkbox"/> E-1	UNDERGROUND ELECTRICAL
<input type="checkbox"/> B-9	WALL GROUT & STEEL	<input type="checkbox"/> M-1	ROUGH VENT	<input type="checkbox"/> E-2	ROUGH ELECTRICAL
<input type="checkbox"/> B-10	POOL PRE-GUNITE	<input type="checkbox"/> M-2	HOOD	<input type="checkbox"/> E-3	LOW VOLTAGE ELECTRICAL
<input type="checkbox"/> B-11	POOL PRE-PLASTER / FINAL	<input type="checkbox"/> M-3	FINAL MECHANICAL	<input type="checkbox"/> E-4	SIGN INSPECTION
<input type="checkbox"/> B-12	BUILDING FINAL			<input type="checkbox"/> E-5	FINAL ELECTRICAL
<input type="checkbox"/> B-13	CERT. OF OCC.	<input type="checkbox"/> X-1	KICKER / FLUSH	<input type="checkbox"/> E-6	TEMP POWER

FINAL INSPECTION

BRING HARD CARD WITH FIRE, QUALITY CONTROL & PLANNING APPROVALS
SIGNED OFF TO BLDG & SAFETY FOR C. OF ISSUANCE (Commercial Only)

FOR ASSISTANCE -CALL: 386-6251

DEPARTMENT OF BUILDING & SAFETY CITY OF LAS VEGAS

JOB ADDRESS: 28.13 Waterview Dr		PERMIT NO.: 78210
LOT NO.	MAP NO.: 1-159P	INSPECTOR: 59
SUBDIVISION NAME		DATE: 10-1-90
		PHONE
INSPECTOR SIGNATURE: [Signature]		INSPECTION DATE

10/2/0
 permission to enter
 A# 60911
 P# 90078210

PARTIAL INSPECTION - DESCRIPTION:

GT # 8500

APPROVED
 PERMIT REQUIRED
 STOP WORK

REJECTED - CORRECTION NOTICE - REINSPECTION REQUIRED CALL 799-2071

INSPECT	DESCRIPTION	INSPECT	DESCRIPTION	INSPECT	DESCRIPTION
<input type="checkbox"/> B-1	FOOTING, LAYOUT, REBAR, ZONING	<input type="checkbox"/> P-1	ON SITE SEWER	<input type="checkbox"/> X-2	UNDERGROUND HYDRO
<input type="checkbox"/> B-2	STEM WALL - FORMS & REBAR	<input type="checkbox"/> P-2	ON SITE WATER	<input type="checkbox"/> X-3	UNDERGROUND FINAL/FLOW
<input type="checkbox"/> B-3	PRE-SLAB	<input type="checkbox"/> P-3	BUILDING SEWER (YARD LINES)	<input type="checkbox"/> X-4	SPRINKLER SYSTEM HYDRO
<input type="checkbox"/> B-4	ROOF SHEATHING	<input type="checkbox"/> P-4	UNDERSLAB PLUMBING	<input type="checkbox"/> X-5	FIRE ALARM
<input type="checkbox"/> B-5	FRAMING	<input type="checkbox"/> P-5	TOP OUT-WATER, GAS, WASTE	<input type="checkbox"/> X-6	OTHER:
<input type="checkbox"/> B-6	INSULATION	<input type="checkbox"/> P-6	FINAL GAS TEST	<input type="checkbox"/> X-7	FINAL FIRE
<input type="checkbox"/> B-7	DRYWALL NAILING	<input checked="" type="checkbox"/> P-7	FINAL PLUMBING		
<input type="checkbox"/> B-8	EXTERIOR LATH/STUCCO			<input type="checkbox"/> E-1	UNDERGROUND ELETTRICAL
<input type="checkbox"/> B-9	WALL GROUT & STEEL	<input type="checkbox"/> M-1	ROUGH VENT	<input type="checkbox"/> E-2	ROUGH ELECTRICAL
<input type="checkbox"/> B-10	POOL PRE-GUNITE	<input type="checkbox"/> M-2	HOOD	<input type="checkbox"/> E-3	LOW VOLTAGE ELECTRICAL
<input checked="" type="checkbox"/> B-11	POOL PRE-PLASTER / FINAL	<input type="checkbox"/> M-3	FINAL MECHANICAL	<input type="checkbox"/> E-4	SIGN INSPECTION
<input type="checkbox"/> B-12	BUILDING FINAL			<input checked="" type="checkbox"/> E-5	FINAL ELECTRICAL
<input type="checkbox"/> B-13	CERT. OF OCC.	<input type="checkbox"/> X-1	KICKER / FLUSH	<input type="checkbox"/> E-6	TEMP POWER

FINAL INSPECTION

BRING HARD CARD WITH FIRE, QUALITY CONTROL & PLANNING APPROVALS
 SIGNED OFF TO BLDG & SAFETY FOR C. of O. ISSUANCE (Commercial Only)

FOR ASSISTANCE -CALL: 386-6251