

CITY OF LAS VEGAS, NEVADA

PERMIT 91-095704

DEPARTMENT OF BUILDING AND SAFETY
PHONE 386-6251



071

BUILDING PERMIT
FOR: Single Family Dwelling, Remodel
Additions, Misc. Residential Construction

LOG NO. & AREA M-632-91 DATE 1-29-91 CONST. VAL \$ 5,568⁰⁰

ADDRESS OF CONSTRUCTION 3701 WATERHOLE ST OWNER MAURICE GOODSIDE PHONE _____

LOT(s) 28 BLOCK 1 SUBDIVISION HOMER OWNERS #2 ZONE R-E

PROPOSED CONSTRUCTION Patio COVER CONVERTIBLE USE _____

THIS PERMIT FOR BLDG. A/C ELEC. PLBG. OTHER PERMITS REQD.: FENCE OFF SITE SWIM POOL

FLOOR AREA BSMT _____ 1ST _____ 2ND _____ GARAGE _____ PORCH _____ TOTAL 928

CONTRACTOR HOMER OWNER BUILDER STATE LICENSE NO. _____ CITY LICENSE NO. _____

ARCHITECT _____ ENGINEER _____

MASTER PLUMBER/CONTRACTOR _____ MASTER ELECTRICIAN/CONTRACTOR _____

OTHER INSPECTIONS AND FEES

- Inspections outside of normal business hours = \$30.00 per hour (minimum charge three hours).
- Re-inspection fee during normal business hours assessed under provisions of TABLE 3-A. of the Uniform Building Code = \$30.00 per hour.
- Inspections during normal business hours for which no fee is specifically indicated = \$30.00 per hour (minimum charge one half hour).
- Additional plan review required by changes, additions, or revisions to approved plans = \$30.00 per hour (minimum charge two hours).

CONDITIONS OF THE PERMIT:

- I agree to call the City Building Department for inspections before concrete is poured, before rough wiring, electrical, plumbing, framing is covered. Also for air conditioning, drywall and sheathing inspection.
- I agree that when the job is completed that I will call for final inspection before occupancy.
- I agree to perform all construction in accordance with City Ordinances and Building Codes.
- The Contractor's signature below denotes authority from the owner to sign in his behalf and that the owner is aware of all requirements of this application and permit. Separate permits must be taken out for work outlined above this agreement.
- I have read and understand the contents of this application and permit; I hereby state that the information I have supplied on this application is true and correct.
- Approval for the work under this permit will be given only after refuse and debris have been removed from job site and public right of way.
- 24 HOUR MINIMUM NOTICE REQUIRED FOR INSPECTIONS.

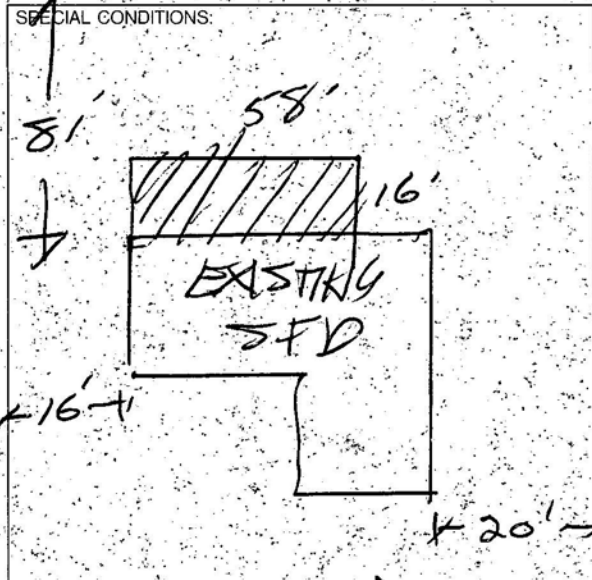

AS PER city design convertible

BY: [Signature] OWNER

BY: _____ AGENT

I hereby certify that I have reviewed this application and the proposed plans and have found that the proposed development meets the requirements of the City of Las Vegas Flood Hazard Reduction Ordinance for the issuance of this Development Permit.

LAND DEVELOPMENT AND FLOOD CONTROL ENGINEER _____ DATE _____

PLANNING DEPT. [Signature] DATE 1/29/91

BUILDING DEPT. _____ DATE _____

PLUMBING	FEE	ELECTRICAL	FEE
WATER DISTRIBUTION	6.00	RECEPTACLE SWITCH	.40
SEWER SYSTEM - NEW OR MODIFICATION	10.00	EACH LIGHT FIXTURE OR SOCKET	.30
FIXTURES - WATER SOFTENER, H.W. HEATER	2.00	SPECIAL OUTLET, APPLIANCE ETC.	.70
GARBAGE DISPOSAL - WASHER	2.00	SERVICE/PANEL - SUB/3.00-200A/6.00-400A/12.50	
FUEL PIPING	6.00	A.C. UNIT OR MOTORS	3.00
IRRIGATION SYSTEM	8.00	2310 - 2432	TOTAL
MISC.		MISC.	
2310 - 2433	TOTAL	2310 - 2431 ISSUANCE FEE	
AIR CONDITIONING	FEE	7143 - 2973 SEWER CONNECTION	
NEW UNIT - 3 TON = 9.00 OVER = 16.50		2310 - 2431 PLAN REVIEW FEE	
FURNACE TO 100,000/9.00 OVER/11.00		2310 - 2431 BLDG. PERMIT FEE	
VAPORATIVE COOLER	6.50		
VENTILATION FAN	2.35		
2310 - 2435	TOTAL	TOTAL FEES	

70⁰⁰
70⁰⁰

RECEIPT
0002
SFD 70.00
CHEK 70.00
B163A000 12:57

PERMIT NO. _____ MUST BE MACHINE VALIDATED

M-0632-91

A# 22235
P# 91095704

from the desk of

Maurice Goodside

Casino
Representative

1/28/91

I, MAURICE W. Goodside give William R. Shawn Ferrier
Permission to sign my name.

Thanks.

Maurice W. Goodside

Maurice W. Goodside

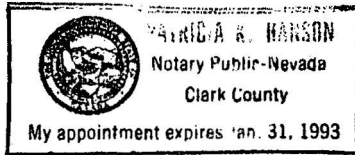

Patricia K. Hanson
1/28/91

DEPARTMENT OF BUILDING & SAFETY CITY OF LAS VEGAS

JOB ADDRESS 3701 Waterhole 91095704		PERMIT NO. 91095704
LOT NO.	MAP NO. 1-1020a	INSPECTOR GA
SUBDIVISION NAME		DATE 2-8-91
INSPECTOR SIGNATURE ▶ [Signature]		PHONE
		INSPECTION DATE 2-11

A# 22235
P# 91095704
Insp# 140

PARTIAL INSPECTION - DESCRIPTION:

APPROVED PERMIT REQUIRED STOP WORK

REJECTED - CORRECTION NOTICE - REINSPECTION REQUIRED CALL 799-2071

INSPECT	DESCRIPTION	INSPECT	DESCRIPTION	INSPECT	DESCRIPTION
<input type="checkbox"/> B-1	FOOTING, LAYOUT, REBAR, ZONING	<input type="checkbox"/> P-1	ON SITE SEWER	<input type="checkbox"/> X-2	UNDERGROUND HYDRO
<input type="checkbox"/> B-2	STEM WALL - FORMS & REBAR	<input type="checkbox"/> P-2	ON SITE WATER	<input type="checkbox"/> X-3	UNDERGROUND FINAL/FLOW
<input type="checkbox"/> B-3	PRE-SLAB	<input type="checkbox"/> P-3	BUILDING SEWER (YARD LINES)	<input type="checkbox"/> X-4	SPRINKLER SYSTEM HYDRO
<input type="checkbox"/> B-4	ROOF SHEATHING	<input type="checkbox"/> P-4	UNDERSLAB PLUMBING	<input type="checkbox"/> X-5	FIRE ALARM
<input type="checkbox"/> B-5	FRAMING	<input type="checkbox"/> P-5	TOP OUT-WATER, GAS, WASTE	<input type="checkbox"/> X-6	OTHER:
<input type="checkbox"/> B-6	INSULATION	<input type="checkbox"/> P-6	FINAL GAS TEST	<input type="checkbox"/> X-7	FINAL FIRE
<input type="checkbox"/> B-7	DRYWALL NAILING	<input type="checkbox"/> P-7	FINAL PLUMBING		
<input type="checkbox"/> B-8	EXTERIOR LATH/STUCCO			<input type="checkbox"/> E-1	UNDERGROUND ELECTRICAL
<input type="checkbox"/> B-9	WALL GROUT & STEEL	<input type="checkbox"/> M-1	ROUGH VENT	<input type="checkbox"/> E-2	ROUGH ELECTRICAL
<input type="checkbox"/> B-10	<u>POOL</u> PRE-GUNITE	<input type="checkbox"/> M-2	HOOD	<input type="checkbox"/> E-3	LOW VOLTAGE ELECTRICAL
<input type="checkbox"/> B-11	<u>POOL</u> PRE-PLASTER / FINAL	<input type="checkbox"/> M-3	FINAL MECHANICAL	<input type="checkbox"/> E-4	SIGN INSPECTION
<input checked="" type="checkbox"/> B-12	BUILDING FINAL			<input type="checkbox"/> E-5	FINAL ELECTRICAL
<input type="checkbox"/> B-13	CERT. OF OCC.	<input type="checkbox"/> X-1	KICKER / FLUSH	<input type="checkbox"/> E-6	TEMP POWER

FINAL INSPECTION

BRING HARD CARD WITH FIRE, QUALITY CONTROL & PLANNING APPROVALS SIGNED OFF TO BLDG & SAFETY FOR C. of O. ISSUANCE (Commercial Only)