

600 Cody Pass

604 Cody Pass

FILE B. 3-3-86

CITY OF LAS VEGAS, NEVADA

LOG NO. & AREA T-10 DATE _____ CONST. VAL. \$ 57921

DEPARTMENT OF BUILDING AND SAFETY 310-440-1006 BUILDING PERMIT - FOR: Single Family Dwelling, Remodel, Additions, Misc. Residential Construction
 PHONE 386-6251
 ADDRESS OF CONSTRUCTION 600 Cody Pass OWNER Plaster Development Co. PHONE NO. 385-5031

LOT(s) 6 BLOCK 1 SUBDIVISION Tenaya II - Phase I ZONE R-1

PROPOSED CONSTRUCTION SFR w/f place USE residence
 THIS PERMIT FOR BLDG. AC ELEC. PLBG. OTHER PERMITS REQ. FENCE OFF SITE SWIM POOL

FLOOR AREA BSMT _____ 1ST _____ 2ND _____ GARAGE _____ PORCH _____ TOTAL _____

CONTRACTOR Plaster Development Co., Inc. STATE LICENSE NO. 017957 CITY LICENSE NO. C11-D48-2-14322
 ARCHITECT _____ ENGINEER VTS
 MASTER PLUMBER _____ MASTER ELECTRICIAN _____

OTHER INSPECTIONS AND FEES

1. Inspections outside of normal business hours = \$30.00 per hour (minimum charge three hours)
2. Re-inspection fee during normal business hours assessed under provisions of TABLE 3-2 of the Uniform Building Code = \$30.00 per hour
3. Inspections during normal business hours for which no fee is specifically indicated = \$30.00 per hour (minimum charge one half hour)
4. Additional plan review required by changes, additions or revisions to approved plans = \$30.00 per hour (minimum charge two hours)

CONDITIONS OF THE PERMIT:

1. I agree to call the City Building Department for inspections before concrete is poured, before rough wiring, electrical, plumbing, framing is covered. Also for air conditioning, drywall and sheathing inspection.
2. I agree that when the job is completed that I will call for final inspection before occupancy.
3. I agree to perform all construction in accordance with City Ordinances and Building Codes.
4. The Contractor's signature below denotes authority from the owner to sign in his behalf and that the owner is aware of all requirements of this application and permit. Separate permits must be taken but for work outlined above this agreement.
5. I have read and understand the contents of this application and permit. I hereby state that the information I have supplied on this application is true and correct.
6. Approval for the work under this permit will be given only after refuse and debris have been removed from job site and public right of way.
7. 24 HOUR MINIMUM NOTICE REQUIRED FOR INSPECTIONS.

BY: PLASTER DEVELOPMENT CO., INC. OWNER
 I HEREBY DECLARE THAT I AM THE LEGAL OWNER OF THE ABOVE PROPERTY.
 BY: C. W. Brubaker AGENT

I hereby certify that I have reviewed this application and the proposed plans and have found that the proposed development meets the requirements of the City of Las Vegas Flood Hazard Reduction Ordinance for the issuance of this Development Permit.

Kent Nash LAND DEVELOPMENT AND FLOOD CONTROL ENGINEER DATE 3-25-86

PLANNING DEPT. Craig Mook DATE 3/25/86

BUILDING DEPT. _____ DATE _____

ACCENT
 PLANS ON FILE # 32
 Per plot Plan
 F.F. ELEV. = 2413.7
 Width _____ Ft.

PLUMBING		FEE	ELECTRICAL		FEE
WATER DISTRIBUTION	6.00		RECEPTACLE	SWITCH	.40
SEWER SYSTEM - NEW OR MODIFICATION	10.00		EACH LIGHT FIXTURE OR SOCKET		.30
FIXTURES - WATER SOFTENER, H.W. HEATER	2.00		SPECIAL OUTLET APPLIANCE ETC.		.70
GARBAGE DISPOSAL - WASHER	2.00		SERVICE/PANEL - SUB/3.00 - 200A/6.00 - 400A/12.50		
FUEL PIPING	6.00		A.C. UNIT OR MOTORS		3.00
IRRIGATION SYSTEM	8.00		2310 - 2402	TOTAL	
			MISC.		
2310 - 2403	TOTAL		2310 - 2401 ISSUANCE FEE		
AIR CONDITIONING	FEE		7114 - 3854 SEWER CONNECTION		500.00
NEW UNIT - 3 TON = 9.00 OVER = 16.50			2310 - 2401 PLAN REVIEW FEE		1
FURNACE TO 100,000/9.00 OVER/11.00			2310 - 2401 BLDG. PERMIT FEE		307
VAPORATIVE COOLER	6.50		TOTAL FEES		807
VENTILATION FAN	2.35				
2310 - 2405	TOTAL				

RECEIPT
 PERMIT NO. _____
 MUST BE MACHINE VALIDATED

PERMIT EXPIRES 180 DAYS AFTER ABANDONMENT OF WORK

JACKIE B 3-25-86

CITY OF LAS VEGAS, NEVADA
 DEPARTMENT OF BUILDING AND SAFETY - ELECTRICAL APPLICATION & PERMIT

ADDRESS OF CONSTRUCTION: L-6 B-1 600 Cody Pass PHONE NO. _____
 OWNER'S NAME: Plaster Development Tenaya II
 CIRCLE: Addition; Remodel; New Bldg. TYPE OF BLDG.: SFD APT. COMM. PUBLIC
 CONTRACTOR'S NAME: Best Electric STATE LICENSE # 19488 CITY LICENSE # L-84-2-21758

UNITS	DESCRIPTION	FEE	TOTAL
PERMIT ISSUANCE			
1	For Issuing Each Permit	10.00	10.00
	Supplemental Fee	4.50	
APPLIANCE CHARGE			
62	Receptacle <u>40</u> Switch <u>22</u>	.40	24.80
14	Each Light Fixture or Socket	.30	4.20
	EACH OUTLET FOR: Dishwasher, Garbage Grinder, Trash Compactor, G.F.L., Clothes Washer, Dryer, Electric Range, Ovens, Smoke Detector, Special Purpose, Water Heater, Space Heater, Blast Coil Heater (PER K.W.), Mercury Lamp, Quartz Lamp, Sodium Lamp	.70	4.20
	X-Ray Unit	10.00	
	Area Lighting (First 3,000 Watts)	8.00	
	Each Additional 1,000 Watts	3.00	
	Motors (1/2 H.P. And Over) Transformers Welders, Generators		
	First H.P. For each Unit	3.00	
	First KVA For Each Unit	.50	
	Each Additional H.P. or KVA	.50	
1	Temporary Power or Pole	6.00	6.00
1	Electric Service (Incl'd First Meter)	6.00	6.00
	Up to 200 AMP		
	400 AMP And 600 AMP	12.50	
	Over 600 AMP To 1200 AMP	25.00	
	Over 1200 AMP	0.00	
	Each Additional Meter Socket	.50	

UNITS	DESCRIPTION	FEE	TOTAL
	Sub Panel (Each)	3.00	
	Swimming Pool (Residential)	20.00	
	Swimming Pool (Semi-Public)	30.00	
	Spas	8.00	
	Recreational Vehicle Spaces (Each)	3.00	
	Busways-Trolley or Plug-in (Ea. 100 Ft.)	3.00	
	All Misc. Electric		
1	Permanent A/C Unit (Pkg. Units)	3.00	3.00
	Each Air Handler	.50	
LOW VOLTAGE INSTALLATIONS			
	Speaker Outlets (Each)	.30	
	Signal or Alarm Outlets (Each)	.30	
	Amplifiers	2.00	
	Control Panel	.50	
2	TV Master System	.30	.60
2	Telephone or Computer Outlet	.30	.60
	Starter Permit		
	Contract Price or Cost of Installation		
	Misc.		
CONDUIT ONLY			
TOTAL PERMIT FEE \$			

Electrical permit fees may be computed the same as building permit fees by using the cost of installation for valuation amount when such work is not included in the above schedule.

FOR BUILDING DEPARTMENT USE ONLY

Plans submitted: yes no Occupancy type: _____ Type of Construction _____ Square Footage _____
 Received by PAC: _____ Date: _____ Valuation (declared) \$ _____
 Review by Plans Check: _____ Date: _____ Fee calculated \$ _____
 Issued by _____ Date: _____ Other Fees (226) \$ _____
 Check Cash Total Fees \$ _____

- Other inspections and fees
- Inspections outside of normal business hours = \$25.00 per hour (minimum charge two hours)
- Re-inspection fee during normal business hours assessed under provisions of TABLE 3-A of the Uniform Building Code = \$15.00 per hour
- Inspections during normal business hours for which no fee is specifically indicated = \$15.00 per hour (minimum charge one half hour)
- Additional plan review required by changes, additions or revisions to approved plans = \$15.00 per hour (minimum charge one half hour)
- Expires 180 days after abandonment of work.

Approval for work under this permit will be given only after refuse and debris have been removed from job site and public right of way.

I hereby certify that I have carefully examined and read the above application; that the same is true and correct; and that the work herein described is to be done in accordance with all the provisions of the applicable Ordinances of the City of Las Vegas, Nevada and the State Laws, whether herein specified or not. City Master Card No. _____

SIGNED Raymond D. S. Date 3/20/86
 Master (Electrician) (Technician) (Owner)
 BUILDING DIVISION D.S. Date 3/20/86
 PERMIT NO. 5674 -7 PERMIT FEE \$ 579.70

RECEIPT

JACKIE B. 3-27-86

CITY OF LAS VEGAS, NEVADA

LOG NO. & AREA _____ DATE Mar 7, 1986 CONST. VAL. \$ _____

DEPARTMENT OF BUILDING AND SAFETY
PHONE 386-6251

PLUMBING PERMIT

ADDRESS OF CONSTRUCTION 601 Cody Pass OWNER Flaster Development Co. Inc.

CONTRACTOR Hynds Plumbing & Heating Co. STATE LICENSE NO. 1021 CITY LICENSE NO. 01660

LOT(S) 16 BLOCK 1 SUBDIVISION ***** Tenaya II, Style 64 ZONE _____

PROPOSED CONSTRUCTION: Plumbing
PLUMBING PERMIT NO. 5707

USE _____

Approval for the work under this permit will be given only after refuse and debris have been removed from job site and public right of way.

UNITS	DESCRIPTION	FEE	TOTAL
PERMIT ISSUANCE			
1	For Issuing Each Permit	10.00	10.00
	For Issuing Each Supplemental Permit	4.50	
FIXTURE CHARGE			
8	Bathub, Shower, Lavatory, Toilet, Urinal	EA. 2.00	16.00
19	Floor Drain, Floor Sink, Wash Tray, Sink	EA. 2.00	38.00
2	Garbage Disposal, Clothes Washer, Dishwasher (residential)	EA. 2.00	4.00
	Garbage Disposal (commercial)	EA. 8.00	
	Clothes Washer, Dishwasher (commercial)	EA. 2.00	
	Clothes Dryer (gas) (venting)	2.00	
	Dental Unit	8.00	
	Drinking Fountain	2.00	
	Refrigerator - Ice Maker, Water Dispenser	2.00	
	Any other water using equipment, Attached Coffee Makers, Ice Makers	2.00	
1	Hot Water Heater (Gas or Electric)	EA. 2.00	2.00
SEWER SYSTEM			
1	New, Replacement, Modification, or Any Drainage Work	10.00	10.00
	Grease or Sand Trap or Interceptor	2.00	
	Trailer Trap (rental parks)	5.00	
WATER SOFTENERS			
	Non Permanent Type (rental)	2.00	
	Permanent Type (connected to drain)	2.00	
WATER DISTRIBUTION SYSTEM			
1	Single Family Dwelling	6.00	6.00
	Multi-Family Dwelling	6.00	
	Plus Each Dwelling Unit	3.00	
	Commercial Building per floor	3.00	
	Plus Each Unit (leased space or office)	2.00	
	Hotel or Motel	8.00	
	Plus Each Unit	3.00	
	Trailer Park	30.00	
	Plus Each Space	2.00	
	Irrigation Single Family Dwelling	8.00	
	Irrigation Commercial Fee Based on Building Code Valuation Chart Construction Valuation		

UNITS	DESCRIPTION	FEE	TOTAL
FUEL PIPING SYSTEM			
1	Single Family Dwelling	6.00	6.00
	Multi-Family Dwelling	10.00	
	Plus Each Unit	2.00	10.00
	Commercial Building (per floor)	6.00	
	Plus Each Unit (leased space or office)	6.00	
	Medium Pressure System (Plan Check)	12.00	
	Each Gas Appliance (Any Type)	2.00	
	Steam Boilers	5.00	
SOLAR ENERGY SYSTEMS			
	Collectors (including piping) (per collector)	5.00	
	Storage Tanks (each)	6.00	
PIPELINE CONTRACT			
	For Onsite Sewer, Gas or Water Contract Value. Fee based on Building Code Permit Valuation Chart		
OTHER INSPECTIONS AND FEES:			
	Inspections outside of normal business hours (minimum charge—three hours)	25.00 per hour	
	Reinspection fees assessed under provisions of TABLE 3-A of the Uniform Building Code = \$15.00 EACH	15.00 each	
	Inspections for which no fee is specifically indicated (minimum charge—one-half hour)	15.00 per hour	
	Additional plan review required by changes, Additions to or revisions to approved plans (minimum charge, two hours)	15.00 per hour	
	Plumbing permit fees may be computed the same as building permit fees by using the costs of installation for valuation amount when such work is not included in the above schedule		
	Construction Valuation		

I hereby certify that I have carefully examined and read the above application; that the same is true and correct; and that the work herein described is to be done in accordance with all the provisions of the applicable Ordinances of the City of Las Vegas, Nevada and the State Laws, whether herein specified or not.

Hynds Plumbing & Heating Co.
Robert Ruppert CONTRACTOR
BY: Robert Ruppert Registered Master Plumber, Spec. Contr. or Owner
DATE: 13-28-86

SEWER # 7114-3854 CONNECTION
FIXTURES X 03/23/86
FEE
2310-2403 PERMIT FEE
TOTAL FEES 66.00

RECEIPT
0004
PLBG 1500.00
CHEK 1500.00
5707A001 10:08
PERMIT NO. _____
MUST BE MACHINE VALIDATED

3/83 Permit Expires 180 Days After Abandonment of Work

Stacie B 5/19/76

CITY OF LAS VEGAS, NEVADA

LOG-NO. & AREA _____ DATE _____ CONST. VAL \$ _____

DEPARTMENT OF BUILDING AND SAFETY
PHONE 386-6251

AIR CONDITIONING PERMIT

ADDRESS OF CONSTRUCTION 600 Cody Pass OWNER Plaster Dev. PHONE 385-5031

CONTRACTOR Carl's, a/c and s/m STATE LICENSE NO. 8370 CITY LICENSE NO. 230-2-18793

LOT(S) 6 BLOCK 1 SUBDIVISION Tenaya II. Accent 64 ZONE _____

PROPOSED CONSTRUCTION: complete installation of a/c and x m duct work

AIR COND. PERMIT NO. 7173 -11

Approval for the work under this permit will be given only after refuse and debris have been removed from job site and public right of way.

UNITS	DESCRIPTION	FEE	TOTAL
PERMIT ISSUANCE			
1	For the issuance of each permit.	15.00	15.00
	For issuing each supplemental permit.	4.50	
UNIT FEE SCHEDULE			
	For the installation or relocation of each forced-air or gravity-type furnace or burner, including ducts and vents attached to such appliance, up to and including 100,000 Btu/h.	9.00	
	For the installation or relocation of each forced-air or gravity-type furnace or burner, including ducts and vents attached to such appliance over 100,000 Btu/h.	11.00	
	For the installation or relocation of each floor furnace, including vent.	9.00	
	For the installation or relocation of each suspended heater, recessed wall heater or floor-mounted unit heater.	9.00	
	For the installation, relocation or replacement of each appliance vent installed and not included in an appliance permit.	4.50	
	For the repair of, alteration of, or addition to each heating appliance, refrigeration unit, cooling unit, absorption unit, or each heating, cooling absorption, or evaporative cooling system, including installation of controls regulated by this code.	9.00	
	For the installation or relocation of each boiler or compressor to and including three horsepower, or each absorption system to and including 100,000 Btu/h.	9.00	
1	For the installation or relocation of each boiler or compressor over three horsepower to and including 15 horsepower, or each absorption system over 100,000 Btu/h and including 500,000 Btu/h.	16.50	16.50
	For the installation or relocation of each boiler or compressor over 15 horsepower to and including 30 horsepower, or each absorption system over 500,000 Btu/h to and including 1,000,000 Btu/h.	22.50	
	For the installation or relocation of each boiler or compressor over 30 horsepower to and including 50 horsepower, or for each absorption system over 1,000,000 Btu/h to and including 1,750,000 Btu/h.	33.50	
	For the installation or relocation of each boiler or refrigeration compressor over 50 horsepower, or each absorption system over 1,750,000 Btu/h.	56.00	

UNITS	DESCRIPTION	FEE	TOTAL
	For each air-handling unit to and including 10,000 cubic feet per minute, including ducts attached thereto. <i>Note: This fee shall not apply to an air-handling unit which is a portion of a factory-assembled appliance, cooling unit, evaporative cooler or absorption unit for which a permit is required elsewhere in this code.</i>	6.50	
	For each air-handling unit over 10,000 cfm.	11.00	
	For each evaporative cooler other than portable type.	6.50	
	For each ventilation fan	4.50	
3		RESIDENTIAL 2.35	7.05
	For each ventilation system which is not a portion of any heating or air-conditioning system authorized by a permit.	6.50	
	For the installation of each hood which is served by mechanical exhaust, including the ducts for such hood.	6.50	
	For each appliance or piece of equipment regulated by this code but not classed in other appliance categories, or for which no other fee is listed in this code.	6.50	
OTHER INSPECTIONS AND FEES:			
	Inspections outside of normal business hours (minimum charge — three hours.)	25.00 per hour	
	Reinspection fee assessed under provisions of TABLE 3-A of the Uniform Building Code = \$15.00 EACH	15.00 each	
	Inspections for which no fee is specifically indicated (minimum charge — one-half hour).	30.00 per hour	
	Additional plan review required by changes, additions or revisions to approved plans (minimum charge — two hours).	30.00 per hour	
	Mechanical permit fees may be computed the same as building permit fees by using the cost of installation for valuation amount when such work is not included in the above schedule.		

I hereby certify that I have carefully examined and read the above application; that the same is true and correct; and that the work herein described is to be done in accordance with all the provisions of the applicable Ordinances of the City of Las Vegas, Nevada and the State Laws, whether herein specified or not.

SIGNED Sheree Nutter CONTRACTOR REGISTER CARD NO. _____
 BY P. Alfano Spec. Contr. or Owner
 BUILDING DEPT. DATE _____

PERMIT FEE 15.00
 TOTAL FEES \$38.55

2310-2405 RECEIPT
 MUST BE MACHINE VALIDATED

Permit Expires 180 Days After Abandonment of Work

TABLE R 5/27/86

CITY OF LAS VEGAS, NEVADA

LOG NO. & AREA _____ DATE _____ CONST. VAL. \$ _____

DEPARTMENT OF BUILDING AND SAFETY

ELECTRICAL PERMIT

PHONE 386-6251
 ADDRESS OF CONSTRUCTION 600 Cody Pass OWNER Plaster Development

CONTRACTOR Summit Electric Co STATE LICENSE NO. 0017358 CITY LICENSE NO. 52088

LOT(s) 6 BLOCK 1 SUBDIVISION _____ ZONE: _____

PROPOSED CONSTRUCTION: Single family dwelling 370-5 USE: _____

ELECTRIC PERMIT NO. 7636-2

Approvals for the work under this permit will be given only after refuse and debris have been removed from job site and public right of way.

UNITS	DESCRIPTION	FEE	TOTAL
PERMIT ISSUANCE			
1	For Issuing Each Permit	10.00	10.00
	Supplemental Fee	4.50	
APPLIANCE CHARGE			
	Receptacle <u>38</u> Switch <u>25</u>	40	25.20
7	Each Light Fixture or Socket	30	5.10
	EACH OUTLET FOR: Dishwasher, Garbage Grinder, Trash Compactor, G.F.L., Clothes Washer, Dryer, Electric Range, Oven, Smoke Detector, Special Purpose, Water Heater, Space Heater, Blast Coil Heater (PER K.W.), Mercury Lamp, Quartz Lamp, Sodium Lamp	30	3.00
	X-Ray Unit	10.00	
	Area Lighting (First 3,000 Watts)	3.00	
	Each Additional 1,000 Watts	3.00	
	Motors (1/2 H.P. And Over) Transformers Welders, Generators	3.00	
	First H.P. For each Unit	3.00	
	First KVA For Each Unit	3.00	
	Each Additional H.P. or KVA	30	
	Temporary power or Pole	6.00	
	Electric Service (Incl'd First Meter)	6.00	
1	Up to 200 AMP		6.00
	400 AMP And 600 AMP	12.50	
	Over 600 AMP To 1200 AMP	25.00	
	Over 1200 AMP	50.00	
	Each Additional Meter Socket	50	
	Sub Panel (Each)	3.00	
	Swimming Pool (Residential)	20.00	
	Swimming Pool (Semi-Public)	30.00	
	Spas	8.00	
	Recreational Vehicle Spaces (Each)	3.00	
	Busways-Trolley or Plug-in (Ea. 100 Ft.)	3.00	

UNITS	DESCRIPTION	FEE	TOTAL
	Gasoline Dispenser	2.00	
	All Misc. Electric		
1	Permanent A/C Unit (Pkg. Units)	3.00	3.00
	Each Air Handler	1.00	
LOW VOLTAGE INSTALLATIONS			
	Speaker Outlets (Each)	30	
	Signal or Alarm Outlets (Each)	30	
	Amplifiers	2.00	
	Control Panel	90	
	TV Master System	30	
	Telephone or Computer Outlet	30	
OTHER INSPECTIONS AND FEES:			
	Inspections outside of normal business hours (minimum charge - three hours)	25.00	per hour
	Reinspection fee assessed under provisions of TABLE 3-A of the Uniform Building Code - \$25.00 each	25.00	each
	Inspections for which no fee is specifically indicated (minimum charge - one-half hour)	15.00	per hour
	Additional plan review required by changes, additions or revisions to approved plans (minimum charge - one-half hour). After work hours - \$25.00 per hour - minimum 2 hours.	15.00	per hour
	Starter Permit		
	Contract Price or Cost of Installation		
	Misc.		
CONDUIT ONLY			

Electrical permit fees may be computed the same as building permit fees by using the cost of installation for valuation amount when such work is not included in the above schedule.

RECEIPT

2310-2402

I hereby certify that I have carefully examined and read the above application; that the same is true and correct; and that the work herein described is to be done in accordance with all the provisions of the applicable Ordinances of the City of Las Vegas, Nevada and the State Laws, whether herein specified or not.

SIGNED Jeff Jones CONTRACTOR Summit Electric Co PERMIT FEE 52.80
 BY R. Wagner Spec. Contr. or Owner TOTAL FEES 52.80
 _____ DATE _____

MUST BE MACHINE VALIDATED

Expires 180 Days After Abandonment of Work

Debbie Inghram 11-3-86

CITY OF LAS VEGAS, NEVADA

LOG NO. & AREA _____ DATE _____ CONST. VAL. \$ 215.00

DEPARTMENT OF BUILDING AND SAFETY
PHONE 386-6251

DEVELOPMENT PERMIT AND BUILDING PERMIT
FOR: Fence, Wall, Retaining Wall

ADDRESS OF CONSTRUCTION 600 Cody Pass L-27-6 OWNER Richard Parker

CONTRACTOR owner STATE LICENSE NO. _____ CITY LICENSE NO. _____

LOT(s) 16 BLOCK 1 SUBDIVISION Temaya 2-1 ZONE R-1

CONSTRUCTION PLANS SUBMITTED BY OWNER/CONTRACTOR CONSTRUCTION DESIGN BY CITY DESIGN SHEET.

BUILDING PERMIT NO. 2272 ENGINEER _____

Approval for the work under this permit will be given only after refuse and debris have been removed from job site and public right of way.

DESCRIPTION	TOTAL LIN. FT.	TOTAL SQ. FT.
CHAIN LINK OR WIRE MESH		
ORNAMENTAL IRON		
WOOD		
<input checked="" type="checkbox"/> MASONRY	<u>43'</u>	<u>86'</u>
RETAINING		

OTHER INSPECTIONS AND FEES

- Inspections outside of normal business hours - \$30.00 per hour (minimum charge three hours)
- Re-inspection fee during normal business hours assessed under provisions of TABLE 3-A of the Uniform Building Code - \$30.00
- Inspections during normal business hours for which no fee is specifically indicated - \$30.00 per hour (minimum charge one half hour)

Additional plan review required by changes, additions or revisions at approved plans - \$30.00 per hour (minimum charge two hours)

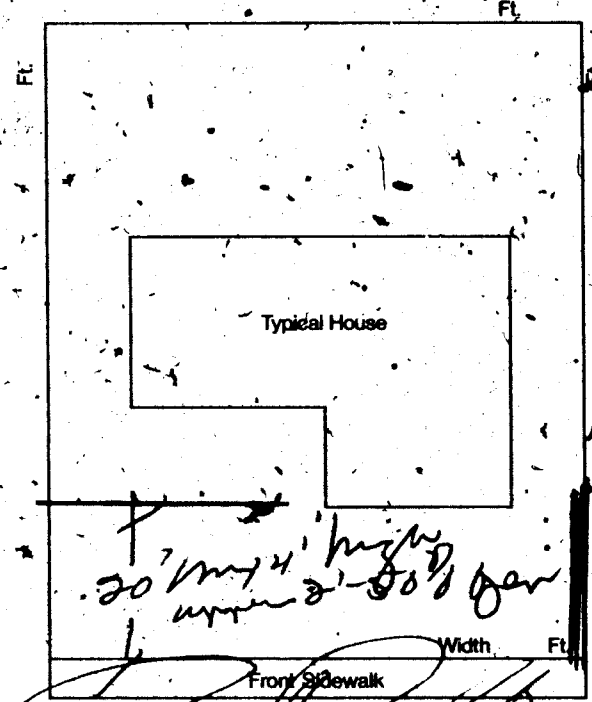

ED - OK

CONDITIONS OF THE PERMIT:

- Any type of retaining wall must be engineered by a Civil or Structural Engineer.
- If a home owner takes out the Building Permit and if the owner sublets the work to a Contractor, then the Contractor must take out the permit and pay for it.
- No fence or wall can be built on City property or rights-of-way, but this is not intended to preclude construction within utility easements if utilities will not be damaged or made inaccessible.
- The fence or wall shall not enclose any water meter, light standard, or fire alarm box and shall not come closer than 24" from the nearest fire hydrant outlet.
- Department inspectors must approve footings before concrete is poured and block wall reinforcing before grouting is done.
- Maximum height of any wall or fence is 6', side and rear yards; 4' maximum in front yard with the vertical surface above the height of 2' - 50% open.
- I must not obstruct required onsite parking space (2 spaces for each dwelling unit) by the erection of this fence or wall.
- By the signing of this application I herewith agree to the requirements outlined above.

SIGNED _____ CONTRACTOR - AGENT - OWNER
DATE 10/29/86

PLANNING DEPT. _____
I hereby certify that I have reviewed this application and the proposed plans and have found that the proposed development meets the requirements of the City of Las Vegas Flood Hazard Reduction Ordinance for the issuance of this Development Permit.

Kent Nash 10-27-86
LAND DEVELOPMENT AND FLOOD CONTROL ENGINEER DATE

Boy 10/29/86
BUILDING DEPT. DATE

PLAN REVIEW FEE _____

PERMIT FEE 12.00
2310-2401

TOTAL FEES _____

RECEIPT
0004
WALL 12.00
CHEK 12.00
2272A000 13:51

10/29/86

3/83

PERMIT EXPIRES 180 DAYS AFTER ABANDONMENT OF WORK

MUST BE MACHINE VALIDATED

TRAIL B. 3-3-86

CITY OF LAS VEGAS, NEVADA

LOG NO. & AREA T-10 DATE 2/21/86 GONST. VAL. \$ 57,921

DEPARTMENT OF BUILDING AND SAFETY 310-42-005 **BUILDING PERMIT - FOR:** Single Family Dwelling, Remodel, Additions, Misc. Residential Construction

ADDRESS OF CONSTRUCTION 604 Cody Pass OWNER Plaster Development Co., Inc. PHONE 385-5031

LOT(s) 5 BLOCK 1 SUBDIVISION Tenaya II - Phase I ZONE RCL R-1

PROPOSED CONSTRUCTION SFR w/f place USE residence

THIS PERMIT FOR BLDG. AC. ELEC. PLBG. OTHER PERMITS REQD.: FENCE OFF SITE SWIM POOL

FLOOR AREA BSMT _____ 1ST _____ 2ND _____ GARAGE _____ PORCH _____ TOTAL _____

CONTRACTOR Plaster Development Co., Inc. STATE LICENSE NO. 017957 CITY LICENSE NO. CD43-2-14322

ARCHITECT _____ ENGINEER VTN

MASTER PLUMBER _____ MASTER ELECTRICIAN _____

OTHER INSPECTIONS AND FEES

- Inspections outside of normal business hours = \$30.00 per hour (minimum charge three hours).
- Re-inspection fee during normal business hours assessed under provisions of TABLE 3-A of the Uniform Building Code = \$30.00 per hour.
- Inspections during normal business hours for which no fee is specifically indicated = \$30.00 per hour (minimum charge one half hour).
- Additional plan review required by changes, additions or revisions to approved plans = \$30.00 per hour (minimum charge two hours).

CONDITIONS OF THE PERMIT:

- I agree to call the City Building Department for inspections before concrete is poured, before rough wiring, electrical, plumbing, framing is covered. Also for air-conditioning, drywell and sheathing inspection.
- I agree that when the job is completed that I will call for final inspection before occupancy.
- I agree to perform all construction in accordance with City Ordinances and Building Codes.
- The Contractor's signature below denotes authority from the owner to sign in his behalf and that the owner is aware of all requirements of this application and permit. Separate permits must be taken out for work outlined above this agreement.
- I have read and understand the contents of this application and permit; I hereby state that the information I have supplied on this application is true and correct.
- Approval for the work under this permit will be given only after refuse and debris have been removed from job site and public right of way.
- 24 HOUR MINIMUM NOTICE REQUIRED FOR INSPECTIONS.

ACCENT
ACCENT
PLANS ON FILE # 32 Rev.
PER PLOT PLAN

F.F. ELEV. = 2413.7
Width Ft.

BY: PLASTER DEVELOPMENT CO., INC. OWNER
I HEREBY DECLARE THAT I AM THE LEGAL OWNER OF THE ABOVE PROPERTY
BY: C.W. Brubaker AGENT

I hereby certify that I have reviewed this application and the proposed plans and have found that the proposed development meets the requirements of the City of Las Vegas Flood Hazard Reduction Ordinance for the issuance of this Development Permit.

LAND DEVELOPMENT AND FLOOD CONTROL ENGINEER Kent Nash DATE 2-25-86

PLANNING DEPT. [Signature] DATE 2/25/86

BUILDING DEPT. [Signature] DATE _____

PLUMBING		FEE	ELECTRICAL		FEE
WATER DISTRIBUTION	6.00		RECEPTACLE	SWITCH	.40
SEWER SYSTEM - NEW OR MODIFICATION	10.00		EACH LIGHT FIXTURE OR SOCKET		.30
FIXTURES - WATER SOFTENER, H.W. HEATER	2.00		SPECIAL OUTLET, APPLIANCE ETC.		.70
GARBAGE DISPOSAL - WASHER	2.00		SERVICE/PANEL, SUB/3.00 - 200A/6.00 - 400A/12.50		
FUEL PIPING	6.00		A.C. UNIT OR MOTORS		3.00
IRRIGATION SYSTEM	8.00		2310 - 2402	TOTAL	
			MISC.		
2310 - 2403	TOTAL		2310 - 2401 ISSUANCE FEE		
AIR CONDITIONING	FEE		7114 - 3654 SEWER CONNECTION		500.00
NEW UNIT - 3 TON = 9.00 OVER = 16.50			2310 - 2401 PLAN REVIEW FEE		
FURNACE TO 100,000/9.00 OVER/11.00			2310 - 2401 BLDG. PERMIT FEE		307
VAPORATIVE COOLER	6.50		TOTAL FEES		807
VENTILATION FAN	2.35				
2310 - 2405	TOTAL				

PERMIT EXPIRES 180 DAYS AFTER ABANDONMENT OF WORK

RECEIPT
PERMIT NO. _____
MUST BE MACHINE VALIDATED

JACKIE B

3-25-86

CITY OF LAS VEGAS, NEVADA

DEPARTMENT OF BUILDING AND SAFETY - ELECTRICAL APPLICATION & PERMIT

ADDRESS OF CONSTRUCTION: L-5 B-1 604 Cody Pass PHONE NO. _____
 OWNER'S NAME: Plaster Development Tenaya II

CIRCLE: Addition; Remodel; New Bldg. TYPE OF BLDG.: SFD APT. COMM. PUBLIC
 CONTRACTOR'S NAME: Best Electric STATE LICENSE # .19488 CITY LICENSE # L-84-2-21758

UNITS	DESCRIPTION	FEE	TOTAL
PERMIT ISSUANCE			
1	For Issuing Each Permit	10.00	10.00
	Supplemental Fee	4.50	
APPLIANCE CHARGE			
62	Receptacle <u>40</u> Switch <u>22</u>	.40	24.80
14	Each Light Fixture or Socket	.30	4.20
6	EACH OUTLET FOR: Dishwasher, Garbage Grinder, Trash Compactor, G.F.L., Clothes Washer, Dryer, Electric Range, Ovens, Smoke Detector, Special Purpose, Water Heater, Space Heater, Blast Coil Heater (PER K.W.), Mercury Lamp, Quartz Lamp, Sodium Lamp	.70	4.20
	X-Ray Unit	10.00	
	Area Lighting (First 3,000 Watts)	8.00	
	Each Additional 1,000 Watts	3.00	
	Motors (1/2 H.P. And Over) Transformers Welders, Generators	3.00	
	First H.P. For each Unit	3.00	
	First KVA For Each Unit	3.00	
	Each Additional H.P. or KVA	3.00	
	Temporary Power or Pole	3.00	
1	Electric Service (Incl'd First Meter)	6.00	6.00
	Up to 200 AMP		
	400 AMP And 600 AMP	12.50	
	Over 600 AMP To 1200 AMP	25.00	
	Over 1200 AMP	50.00	
	Each Additional Meter Socket	.50	

UNITS	DESCRIPTION	FEE	TOTAL
	Sub Panel (Each)	3.00	
	Swimming Pool (Residential)	20.00	
	Swimming Pool (Semi-Public)	30.00	
	Spas	8.00	
	Recreational Vehicle Spaces (Each)	3.00	
	Business Trolley or Plug-in (Ea. 100 Ft.)	3.00	
	All Misc. Electric		
	Permanent A/C Unit (Pkg. Units)	3.00	3.00
	Each Air Handler	1.00	
LOW VOLTAGE INSTALLATIONS			
	Speaker Outlets (Each)	.30	
	Signal or Alarm Outlets (Each)	.30	
	Amplifiers	2.00	
	Control Panel	.50	
2	TV Master System	.30	1.60
2	Telephone or Computer Outlet	.30	1.60
	Starter Permit		
	Contract Price or Cost of Installation		
	Misc.		
CONDUIT ONLY			
	TOTAL PERMIT FEE \$		

Electrical permit fees may be computed the same as building permit fees by using the cost of installation for valuation amount when such work is not included in the above schedule.

FOR BUILDING DEPARTMENT USE ONLY

Plans submitted: yes no
 Received by PAC: _____ Date: _____
 Review by Plans Check: _____ Date: _____
 Issued by: _____ Date: _____
 Check Cash

Occupancy type: _____ Type of Construction: _____ Square Footage: _____
 Valuation (declared) \$ _____
 Fee calculated \$ _____
 Other Fees (226) \$ _____
 Total Fees \$ _____

- Other inspections and fees:
 1. Inspections outside of normal business hours = \$25.00 per hour (minimum charge two hours).
 2. Re-inspection fee during normal business hours assessed under provisions of TABLE 3-A of the Uniform Building Code = \$15.00 per hour.
 3. Inspections during normal business hours for which no fee is specifically indicated = \$15.00 per hour (minimum charge one half hour).
 4. Additional plan review required by changes, additions or revisions to approved plans = \$15.00 per hour (minimum charge one half hour).
 5. Expires 180 days after abandonment of work.

Approval for the work under this permit will be given only after refuse and debris have been removed from job site and public right of way.

I hereby certify that I have carefully examined and read the above application; that the same is true and correct; and that the work herein described is to be done in accordance with all the provisions of the applicable Ordinances of the City of Las Vegas, Nevada and the State Laws, whether herein specified or not. City Master Card No. _____

SIGNED David Durr Date _____
 Master (Electrician) (Technician) (Owner)
 BUILDING DIVISION D.S. Date 3/20/86
 PERMIT NO. 5614 PERMIT FEE \$ 53.40

2360-2402 (3/82)

RECEIPT

JACKIE B. 13-27-86

CITY OF LAS VEGAS, NEVADA

LOG NO. & AREA _____ DATE March 7, 1986 CONST. VAL. \$ _____

DEPARTMENT OF BUILDING AND SAFETY
PHONE 386-6251

PLUMBING PERMIT

ADDRESS OF CONSTRUCTION 604 Cody Pass OWNER Plaster Development Co. Inc.

CONTRACTOR Hynds Plumbing & Heating Co. STATE LICENSE NO. 1021 CITY LICENSE NO. 01660

LOT(s) 5 BLOCK 1 SUBDIVISION Plaster Tenaya II Style 64 ZONE _____

PROPOSED CONSTRUCTION: Plumbing USE _____
PLUMBING PERMIT NO. 5707 - 1

Approval for the work under this permit will be given only after refuse and debris have been removed from job site and public right of way.

UNITS	DESCRIPTION	FEE	TOTAL
PERMIT ISSUANCE			
1	For Issuing Each Permit	10.00	10.00
	For Issuing Each Supplemental Permit	4.50	
FIXTURE CHARGE			
8	Bathub, Shower, Lavatory, Toilet, Urinal	EA 2.00	16.00
1	Floor Drain, Floor Sink, Wash Tray, Sink	EA 2.00	2.00
2	Garbage Disposal, Clothes Washer, Dishwasher (residential)	EA 2.00	4.00
	Garbage Disposal (commercial)	EA 8.00	
	Clothes Washer, Dishwasher (commercial)	EA 2.00	
	Clothes Dryer (gas) (venting)	2.00	
	Dental Unit	8.00	
	Drinking Fountain	2.00	
	Refrigerator - Ice Maker, Water Dispenser	2.00	
	Any other water using equipment, Attached Coffee Makers, Ice Makers	2.00	
1	Hot Water Heater (Gas or Electric)	EA 2.00	2.00
SEWER SYSTEM			
1	New, Replacement, Modification, or Any Drainage Work	10.00	10.00
	Grease or Sand Trap or Interceptor	2.00	
	Trailer Trap (rental parks)	5.00	
WATER SOFTENERS			
	Non Permanent Type (rental)	2.00	
	Permanent Type (connected to drain)	2.00	
WATER DISTRIBUTION SYSTEM			
1	Single Family Dwelling	6.00	6.00
	Multi-Family Dwelling	6.00	
	Plus Each Dwelling Unit	3.00	
	Commercial Building per floor	3.00	
	Plus Each Unit (leased space or office)	2.00	
	Hotel or Motel	8.00	
	Plus Each Unit	3.00	
	Trailer Park	30.00	
	Plus Each Space	2.00	
	Irrigation Single Family Dwelling	8.00	
	Irrigation Commercial Fee Based on Building Code Valuation Chart Construction Valuation		

UNITS	DESCRIPTION	FEE	TOTAL
FUEL PIPING SYSTEM			
1	Single Family Dwelling	6.00	6.00
	Multi-Family Dwelling	10.00	
5	Plus Each Unit	2.00	10.00
	Commercial Building (per floor)	6.00	
	Plus Each Unit (leased space or office)	6.00	
	Medium Pressure System (Plan Check)	12.00	
	Each Gas Appliance (Any Type)	2.00	
	Steam Boilers	5.00	
SOLAR ENERGY SYSTEMS			
	Collectors (including piping) (per collector)	5.00	
	Storage Tanks (each)	5.00	
PIPELINE CONTRACT			
	For Onsite Sewer, Gas or Water Contract Value. Fee based on Building Code Permit Valuation Chart.		
OTHER INSPECTIONS AND FEES:			
	Inspections outside of normal business hours (minimum charge—three hours)	25.00 per hour	
	Reinspection fee assessed under provisions of TABLE 3-A of the Uniform Building Code = \$15.00 EACH	15.00 each	
	Inspections for which no fee is specifically indicated (minimum charge—one-half hour)	15.00 per hour	
	Additional plan review required by changes. Additions to or revisions to approved plans (minimum charge two hours)	15.00 per hour	
	Plumbing permit fees may be computed the same as building permit fees by using the cost of installation for valuation amount when such work is not included in the above schedule.		
	Construction Valuation		

I hereby certify that I have carefully examined and read the above application; that the same is true and correct; and that the work herein described is to be done in accordance with all the provisions of the applicable Ordinances of the City of Las Vegas, Nevada and the State Laws, whether herein specified or not.

Hynds Plumbing & Heating Co.

Robert Ruppert

SIGNED _____ CONTRACTOR _____ MASTER CARD NO. 19

BY Robert Ruppert Registered Master Plumber, Spec. Contr. or Owner

BUILDING DEPT. P. Allard DATE 3-7-86

FIXTURES X

FEE _____

2310-2403 PERMIT FEE

TOTAL FEES 11.00

RECEIPT

SEWER # 7114-3654 CONNECTION

PERMIT NO. _____

MUST BE MACHINE VALIDATED

Permit Expires 180 Days After Abandonment of Work

JACKIE B 5/19/86

CITY OF LAS VEGAS, NEVADA

LOG NO. & AREA _____ DATE _____ CONST. VAL. \$ _____

DEPARTMENT OF BUILDING AND SAFETY
PHONE 386-6251

AIR CONDITIONING PERMIT

ADDRESS OF CONSTRUCTION: 604 Cody Pass OWNER: Plaster Dev. PHONE: 385-5031

CONTRACTOR: Carl's a/c and s/m STATE LICENSE NO. 8370 CITY LICENSE NO. 230-2-10793

LOT(S) 5 BLOCK 1 SUBDIVISION Tenaya II Accent 64 ZONE _____

PROPOSED CONSTRUCTION: complete installation of a/c and dx duct work

AIR COND. PERMIT NO. 7173 -12

Approval for the work under this permit will be given only after refuse and debris have been removed from job site and public right of way.

UNITS	DESCRIPTION	FEE	TOTAL
PERMIT ISSUANCE			
1	For the issuance of each permit.	15.00	15.00
	For issuing each supplemental permit.	4.50	
UNIT FEE SCHEDULE			
	For the installation or relocation of each forced-air or gravity-type furnace or burner, including ducts and vents attached to such appliance, up to and including 100,000 Btu/h.	9.00	
	For the installation or relocation of each forced-air or gravity-type furnace or burner, including ducts and vents attached to such appliance over 100,000 Btu/h.	11.00	
	For the installation or relocation of each floor furnace, including vent.	9.00	
	For the installation or relocation of each suspended heater, recessed wall heater or floor-mounted unit heater.	9.00	
	For the installation, relocation or replacement of each appliance vent, installed and not included in an appliance permit.	4.50	
	For the repair of, alteration of, or addition to each heating appliance, refrigeration unit, cooling unit, absorption unit, or each heating, cooling, absorption, or evaporative cooling system, including installation of controls regulated by this code.	9.00	
1	For the installation or relocation of each boiler or compressor over three horsepower to and including 15 horsepower, or each absorption system over 100,000 Btu/h and including 500,000 Btu/h.	16.50	16.50
	For the installation or relocation of each boiler or compressor over 15 horsepower to and including 30 horsepower, or each absorption system over 500,000 Btu/h to and including 1,000,000 Btu/h.	22.50	
	For the installation or relocation of each boiler or compressor over 30 horsepower to and including 50 horsepower, or for each absorption system over 1,000,000 Btu/h to and including 1,750,000 Btu/h.	33.50	
	For the installation or relocation of each boiler or refrigeration compressor over 50 horsepower, or each absorption system over 1,750,000 Btu/h.	56.50	

UNITS	DESCRIPTION	FEE	TOTAL
	For each air-handling unit to and including 10,000 cubic feet per minute, including ducts attached thereto. <i>Note: This fee shall not apply to an air-handling unit which is a portion of a factory-assembled appliance, cooling unit, evaporative cooler or absorption unit for which a permit is required elsewhere in this code.</i>	6.50	
	For each air-handling unit over 10,000 cfm.	11.00	
	For each evaporative cooler other than portable type.	6.50	
	For each ventilation fan	COMMERCIAL 4.50 RESIDENTIAL 2.35	7.05
3	For each ventilation system which is not a portion of any heating or air-conditioning system authorized by a permit.	6.50	
	For the installation of each hood which is served by mechanical exhaust, including the ducts for such hood.	6.50	
	For each appliance or piece of equipment regulated by this code but not classified in other appliance categories, or for which no other fee is listed in this code.	6.50	
OTHER INSPECTIONS AND FEES:			
	Inspections outside of normal business hours (minimum charge — three hours)	25.00 per hour	
	Reinspection fee assessed under provisions of TABLE 3-A of the Uniform Building Code = \$15.00 EACH	15.00 each	
	Inspections for which no fee is specifically indicated (minimum charge — one-half hour).	30.00 per hour	
	Additional plan review required by changes, additions or revisions to approved plans (minimum charge — two hours).	30.00 per hour	
	Mechanical permit fees may be computed the same as building permit fees by using the cost of installation for valuation amount when such work is not included in the above schedule.		

I hereby certify that I have carefully examined and read the above application; that the same is true and correct; and that the work herein described is to be done in accordance with all the provisions of the applicable Ordinances of the City of Las Vegas, Nevada and the State Laws, whether herein specified or not.

SIGNED: Sheree Nutter CONTRACTOR
 BY: P. Alfano Spec. Contr. or Owner
 BUILDING DEPT. DATE: 5-19-86

PERMIT FEE: 15.00
 TOTAL FEES: 30.55

2310-2405 RECEIPT
 MUST BE MACHINE VALIDATED

Permit Expires 180 Days After Abandonment of Work

JACKIE B 5/30/86

CITY OF LAS VEGAS, NEVADA

LOG NO. & AREA _____ DATE _____ CONST. VAL \$ _____

DEPARTMENT OF BUILDING AND SAFETY

ELECTRICAL PERMIT

PHONE 386-6251
 ADDRESS OF CONSTRUCTION 604 Cody Pass OWNER Plaster Development

CONTRACTOR Summit Electric Co STATE LICENSE NO. 0017358 CITY LICENSE NO. 52088

LOT(s) 5 BLOCK 1 SUBDIVISION _____ ZONE _____

PROPOSED CONSTRUCTION: Single family dwelling 3rd fl USE: _____

ELECTRIC PERMIT NO. 9636-3

Approval for the work under this permit will be given only after refuse and debris have been removed from job site and public right of way.

UNITS	DESCRIPTION	FEE	TOTAL
PERMIT ISSUANCE			
1	For Issuing Each Permit	10.00	10.00
	Supplemental Fee	4.50	14.50
APPLIANCE CHARGE			
	Receptacle <u>38</u> Switch <u>25</u>	40	38.20
17	Each Light Fixture or Socket	30	5.10
	EACH OUTLET FOR: Dishwasher, Garbage Grinder, Trash Compactor, G.F.L., Clothes Washer, Dryer, Electric Range, Ovens, Smoke Detector, Special Purpose, Water Heater, Space Heater, Blast Coil Heater (PER K.W.), Mercury Lamp, Quartz Lamp, Sodium Lamp	70	3.50
	X-Ray Unit	10.00	
	Area Lighting (First 3,000 Watts)	8.00	
	Each Additional 1,000 Watts	3.00	
	Motors (1/2 H.P. And Over) Transformers Welders, Generators		
	First H.P. For each Unit	3.00	
	First KVA For Each Unit	3.00	
	Each Additional H.P. or KVA	30	
	Temporary power or Pole	6.00	
	Electric Service (Incl'd First Meter)	6.00	
1	Up to 200 AMP		600
	400 AMP And 600 AMP	12.50	
	Over 600 AMP To 1200 AMP	25.00	
	Over 1200 AMP	50.00	
	Each Additional Meter Socket	50	
	Sub Panel (Each)	3.00	
	Swimming Pool (Residential)	20.00	
	Swimming Pool (Semi-Public)	30.00	
	Spas	8.00	
	Recreational Vehicle Spaces (Each)	3.00	
	Busways-Trolley or Plug-in (Ea. 100 Ft.)	3.00	

UNITS	DESCRIPTION	FEE	TOTAL
	Gasoline Dispenser	2.00	
	All Misc. Electric		
1	Permanent A/C Unit (Plg. Units)	3.00	3.00
	Each Air Handler	1.00	
LOW VOLTAGE INSTALLATIONS			
	Speaker Outlets (Each)	30	
	Signal or Alarm Outlets (Each)	30	
	Amplifiers	2.00	
	Control Panel	50	
	TV Master System	30	
	Telephone or Computer Outlet	30	
OTHER INSPECTIONS AND FEES:			
	Inspections outside of normal business hours (minimum charge - three hours)	25.00	per hour
	Reinspection fee assessed under provisions of TABLE 3-A of the Uniform Building Code = \$25.00 EACH	25.00	each
	Inspections for which no fee is specifically indicated (minimum charge - one-half hour)	15.00	per hour
	Additional plan review required by changes, addi- tions or revisions to approved plans (minimum charge - one-half hour). After work hours - \$25.00 per hour - minimum 2 hours.	15.00	per hour
	Starter Permit		
	Contract Price or Cost of Installation		
	Misc.		
CONDUIT ONLY			

Electrical permit fees may be computed the same as building permit fees by using the cost of installation for valuation amount when such work is not included in the above schedule.

RECEIPT

2310-2492

I hereby certify that I have carefully examined and read the above application; that the same is true and correct; and that the work herein described is to be done in accordance with all the provisions of the applicable Ordinances of the City of Las Vegas, Nevada and the State Laws, whether herein specified or not.

SIGNED [Signature] CONTRACTOR
 BY [Signature] Spec. Contr. or Owner
 BUILDING DEPT. _____ DATE _____

PERMIT FEE 12.80
 TOTAL FEES 12.80

Permit Expires 180 Days After Abandonment of Work

MUST BE MACHINE VALIDATED

Debra Ingram 7-14-87

7

OWNER	Plaster Dev.	ADDRESS	604 Cody Pass
DATE	2-28-86	GEN. CONT.	OWNER
BUILD. TYPE	sfd w/tp	PERMIT No.	5062-8
LEGAL	LOT 5	LOG No.	T-10
BUILDING		MECHANICAL	
Pt. Loc. & Ft. <input type="checkbox"/>		Plumbing Cont.	<i>Humbly Kly</i>
Location & Footing <input type="checkbox"/>	<i>BM2-7-86</i>	Permit No.	<i>5704-7 Date 3-16-86</i>
Shower/Ell <input type="checkbox"/>	<i>5-13-86</i>	A/C Cont.	<i>Carl A. C</i>
Concrete Slab Floor <input type="checkbox"/>	<i>BM3-31-86</i>	Permit No.	<i>1173-12 Date 1-3-86</i>
Chimney Steel <input type="checkbox"/>		Sewer Fee	OWNER
Fireplace Footing <input type="checkbox"/>		Irrig. Cont.	
Vert. Steel Reinf. <input type="checkbox"/>		Permit No.	
Horiz. Steel Reinf. <input type="checkbox"/>		Date	
Rough Sheeting <input type="checkbox"/>	<i>BM5-5-86</i>	Hood Cont.	
Insulation <input type="checkbox"/>	<i>BM6-17-86</i>	Permit No.	
Framing <input type="checkbox"/>	<i>BM6-5-86</i>	Date	
Ext. Lath <input type="checkbox"/>	<i>BM6-5-86</i>	Rough Soil <input type="checkbox"/>	
Ext. Scratch		Rough Water <input type="checkbox"/>	<i>Feb 4-2-86</i>
Ext. Brown <input type="checkbox"/>	<i>BM4-16-86</i>	Top-Out	
Drywall <input type="checkbox"/>	<i>BM7-7-86</i>	Rough Gas	<i>1-26-9-86</i>
Final Building <input type="checkbox"/>	<i>BM8-25-86</i>	A/C Rough Duct	
Appr. for Occu. Final Building <input type="checkbox"/>	<i>BM8-25-86</i>	Final Plumbing	
		Final Gas	<i>1-25-86 4-6-86</i>
		Final Air Cond.	
		Final Sewer	
		Rough Hood <input type="checkbox"/>	
		Final Hood <input type="checkbox"/>	
		Final Irrig.	
ELECTRICAL		ELECTRICAL	
Electrical Cont.	<i>BEST Elec</i>	Temp. Pole Cont.	
Permit No.	<i>7636-3 5-14-86 Date 2-28-86</i>	Permit No.	
PT Rough	<i>KB6-5-86</i>	Date	
Ground Electrode		Inspection	
Temporary Power		Date	
Meter Tag	<i>15723</i>		
Final Electrical	<i>KB8-15-86</i>		