

216 CERVANTES

LOT 9 & 10 BLK 5 NOBLITT ADDITION ZONE R-1

1969
CITY OF LAS VEGAS, NEVADA

106⁰⁰
3180
548

LOG NO. & AREA _____

CONST. VAL \$ _____

DEPARTMENT OF BUILDING & SAFETY

APPLICATION & BUILDING PERMIT — for:
Fence, Wall, Retaining Wall.

ADDRESS OF CONSTRUCTION: 216 CERVANTES OWNER: W. H. GOBEL

LOT(s) 2410 BLOCK 5 SUBDIVISION NOBLITT ADDITION ZONE: R-1

Materials of Construction: Block Concrete Wire Wood Other PLANS:

ARCHITECT: _____ ENGINEER: _____ CALCS:

CONTRACTOR: American Fence STATE LICENSE # 8581 CITY LICENSE # 7594

TOTAL SQUARE FEET: 318 TOTAL LINEAL FEET: 53

Remarks:

CONDITIONS OF THE PERMIT:

1. Any type of retaining wall must be engineered by a Civil or Structural Engineer.
2. If a home owner takes out the Building Permit and if the owner lets the work to a Contractor, then the Contractor must take out the permit and pay for it.
3. No fence or wall can be built on City property or rights-of-way, but this is not intended to preclude construction within utility easements if utilities will not be damaged or made inaccessible.
4. The fence or wall shall not enclose any water meter, light standard, or fire alarm box and shall not come closer than 24" from the nearest fire hydrant outlet.
5. Department Inspectors must approve footings before concrete is poured and block wall reinforcing before grouting is done.
6. Maximum height of any wall or fence is 6', side and rear yards; 4' maximum in front yard with the vertical surface above the height of 2' - 50% open and further that fencing within 25' of the intersection of curb faces on corner and through-lots is limited to a maximum height of 30".
7. I must not obstruct required onsite parking space (1 space for each dwelling unit) by the erection of this fence or wall.
8. By the signing of this application I herewith agree to the requirements outlined above.

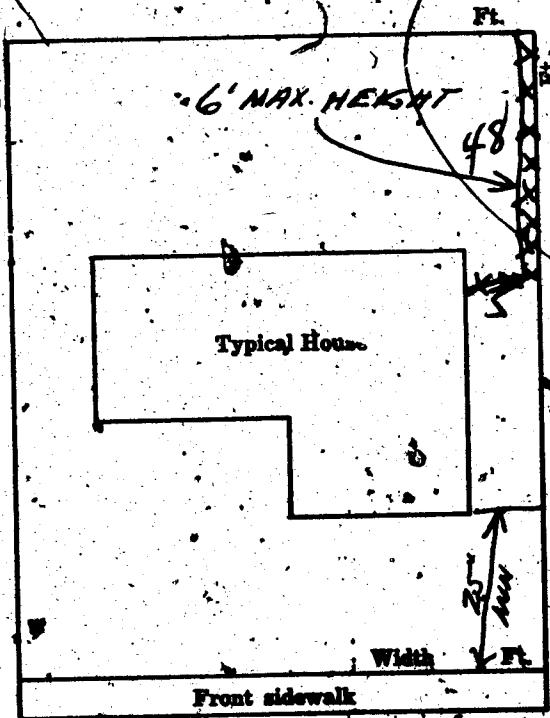

SIGNED: J. Heuber DATE: 2-17-69
 CONTRACTOR AGENT OWNER

PLANNING DEPT: RAA Date: 2-19-69
 ENGINEERING DEPT: _____ Date: _____
 BUILDING DEPT: P.C. Date: 2-19-69
 #1286 PERMIT NO: 46019 PERMIT FEE \$ 4.00

RECEIPT
9M 67 - \$004.00 - 8
CITY OF LAS VEGAS DEPT. OF BUILDING & SAFETY
MUST BE MACHINE VALIDATED 20 FEB 69

CITY OF LAS VEGAS, NEVADA
DEPARTMENT OF BUILDING & SAFETY - AIR CONDITIONING APPLICATION & PERMIT

ADDRESS OF CONSTRUCTION: 216 CERVANTES OWNER'S NAME: BILL GABLE
 CIRCLE: Addition; (Remodel); New Bldg; TYPE OF BLDG.: SFD APT. COMM. PUBLIC
 CONTRACTOR'S NAME: ALL REFRIGERATION STATE LICENSE 9817 CITY LICENSE 2024

UNITS	DESCRIPTION	FEE	TOTAL	UNITS	DESCRIPTION	FEE	TOTAL
	Unit heater floor, wall or suspended	4.00			EVAPORATIVE COOLERS:		
	FOR EACH FORCED-AIR OR GRAVITY-TYPE FURNACE OR BURNER INCLUDING DUCTS AND VENT ATTACHED TO SUCH APPLIANCES:				5 outlets or under	3.00	
		Up to and including 100,000 B.t.u.'s	4.00		Over 5 and up to and including 10'	5.00	
		Over 100,000 B.t.u.'s	6.00		Each additional outlet over 10'	.25	
	FOR EACH HEATING APPLICATION, REFRIGERATION UNIT, COMFORT COOLING AND HEATING UNIT, ABSORPTION UNIT, COMPRESSOR OR BOILER:				VENTILATION:		
		Up to and including 3 ton or horsepower, or absorption system up to and including 100,000 B.t.u.'s	4.00	4.00	For each fan connected to a single duct	1.00	
		Over 3 ton or 3 horsepower up to and including 10, or absorption system over 100,000 B.t.u.'s up to and including 250,000 B.t.u.'s	7.00		For each commercial or industrial ventilation system	5.00	
		Over 10 ton or 10 horsepower up to and including 50, or absorption system over 250,000 B.t.u.'s up to and including 1,000,000 B.t.u.'s	12.00		For each commercial kitchen hood	5.00	
	Over 30 ton or 30 horsepower up to and including 50, or absorption system over 1,000,000 B.t.u.'s up to and including 1,700,000 B.t.u.'s	20.00		MISCELLANEOUS:			
	Over 50 ton or 50 horsepower, or absorption system over 1,700,000 Btu's	30.00		For each water cooling tower	8.00		
	FOR EACH AIR HANDLING UNIT INCLUDING DUCTS ATTACHED THERETO:			Duct work only-each opening	.25	.25	
		Up to and including 10,000 CFM	2.00		For installation or relocation of each commercial or industrial incinerator	15.00	
	Over 10,000 CFM	4.00		Gas piping related to the air cond. work in single family dwelling only	3.00		
				For each appliance, piece of equipment, any mechanical work or alteration or replacement not included in this schedule, the permit fee shall be computed the same as building permit fees by using the cost of installation for the valuation amount.			
				FOR THE ISSUANCE OF EACH PERMIT			3.00
				TOTAL PERMIT FEE \$			7.25

I hereby certify that I have carefully examined and read the above application; that the same is true and correct; and that the work herein described is to be done in accordance with all the provisions of the applicable Ordinances of the City of Las Vegas, Nevada and the State Laws, whether herein specified or not.

SIGNED Walter L. Smith Date 9-16-69
 Air Conditioning Contractor - Owner
 BUILDING DEPARTMENT J. Wenzel Date 9-16-69
 PERMIT NO. 27914 PERMIT FEE \$ 7.25

RECEIPT
 2705 \$007.25 - 4
 CITY OF LAS VEGAS
 DEPT. OF BUILDING & SAFETY
 MUST BE MACHINE VALIDATED
 16 SEP 69

CITY OF LAS VEGAS, NEVADA
DEPARTMENT OF BUILDING & SAFETY - ELECTRICAL APPLICATION & PERMIT

ADDRESS OF CONSTRUCTION: 216 Corvairs OWNER'S NAME: Bill Gables

LOT(S) _____ BLOCK _____ SUBDIVISION _____ Type of bldg. SFD Apt. Comm.

Check Proper Construction: New Bldg. Addn. Remodel Temporary Pole Old Bldg.

CONTRACTOR'S NAME: Logan Tomic STATE LICENSE # 7761 CITY LICENSE # 8713

NUMBER	FIXTURE OR INSTALLATION	UNIT PRICE
	<u>A.C. unit</u>	
	Fixture or sockets	.15
	Light, receptacle or switch outlet	.20
	Wall or ceiling space heater:	.35
	Blast coil heater per kilowatt	.35
	Garbage grinder outlet	.35
	Dishwasher outlet	.35
	Clothes dryer outlet	.35
	Automatic clothes washer	.35
	Electric range outlet	.35
	Electric water heater outlet	.35
	Mercury arc lamp and equipment	.35
	Special purpose outlet	5.00
	X-ray unit and its appurtenances	4.00
	Watts of festoon lighting (Watts) First 3,000 watts	1.50
	for each additional thousand watts	1.75
	Horsepower - all motors first horsepower or less	.35
	for each additional horsepower	4.00
	Temporary power and lights (temporary pole)	3.00
	Electric service (including any single meter socket)	.35
	for each additional socket	1.50
	Air conditioning service	amps. 2.00
	Each KW (KVA) Generator (Transformer) (Welder) KW (KVA)	.01
	First 100 KVA - For each additional KW (KVA)	4.00
	Special inspection per hour	.15
	Speaker outlets	.15
	Signal or Alarm outlets	.50
	Amplifiers	.25
	Control panels	.15
	T. V. outlets - master system only	.15
	Radio outlets	1.00
	Main control racks	.75
	T. V. and Radio antennas - master system only	4.00
	Minimum fee for any permit	
	Total fee <u>4.00</u>	

I hereby certify that I have carefully examined and read the above application; that the same is true and correct; and that the work herein described is to be done in accordance with all the provisions of the applicable Ordinances of the City of Las Vegas, Nevada and State laws whether herein specified or not.

SIGNED: George L. Logan Date 9/25/69
MASTER ELECTRICIAN (TECHNICIAN) (OWNER)

BUILDING DEPARTMENT: [Signature] Date 9-25-69

#1286 PERMIT NO. 28909 PERMIT FEE: 4.00

RECEIPT
 2589 \$004.00 - 6

CITY OF LAS VEGAS
 DEPT. OF BUILDING & SAFETY

MUST BE MACHINE VALIDATED
 25 SEP 69

Department of Building & Safety
City of Las Vegas, Nevada

Special Kardex
Elec. only, Plbg. only, A.C. only

Owner Bill Gable Address 216 Cervantes Date: 9/16/69
Contractor _____ Permit No. _____
Lot _____ Block _____ Subdivision _____

Electric Only	Plumbing Only	Heat & Vent. A. C. Only
Contractor _____	Contractor _____	Contractor <u>All Ref</u>
Permit No. _____	Permit No. _____	Permit No. <u>27914</u>
Slab _____	Rough Soil _____	A.C. Rough Duct _____
Rough Elect _____	Rough Water _____	Ref. Ro. Piping _____
Final Rough _____	Top Out _____	Rough Gas _____
Final Fixture _____	Rough Gas _____	Final Refrig _____
Final Elec _____	Final Plbg. _____	Final Air Cond <u>WC 9-18-69</u>
Temp. Service _____	Final Gas _____	Final Gas _____
	Final Sewer _____	
	Final Septic Tank _____	

23.06 D Address 216 Cervantes Log No. Area

Department of Building & Safety
City of Las Vegas, Nevada

Special Kardex
Elec. only, Plbg. only, A.C. only

Owner Bill Gobler Address 216 Cervantes Date: 9-25-69
Contractor _____ Permit No. _____
Lot _____ Block _____ Subdivision _____

Electric Only	Plumbing Only	Heat & Vent. A. C. Only
Contractor <u>Logan & Tomsik</u>	Contractor _____	Contractor _____
Permit No. <u>28909</u>	Permit No. _____	Permit No. _____
Slab _____	Rough Soil _____	A.C. Rough Duct _____
Rough Elect _____	Rough Water _____	Ref. Ro. Piping _____
Final Rough _____	Top Out _____	Rough Gas _____
Final Fixture _____	Rough Gas _____	Final Refrig _____
Final Elec <u>092669</u>	Final Plbg. _____	Final Air Cond _____
Temp. Service _____	Final Gas _____	Final Gas _____
	Final Sewer _____	
	Final Septic Tank _____	

23.06 D Address 216 Cervantes Log No. Area

DEPARTMENT OF BUILDING & SAFETY
CITY OF LAS VEGAS, NEVADA

KARDEX CARD
FENCE & RETAINING
WALLS

OWNER WM GOBEL ADDRESS 216 Cervantes DATE 2/20/69

CONTRACTOR AMERICAN FENCE PERMIT NO. 46019

LOT 9-10 BLOCK 5 SUBDIVISION Noblitt Add.

Fence (wire, wood, etc.)		Walls (masonry, rock, etc.)	
Location _____		Location _____	
Final Inspection <u>2/23-4-69</u>		Footings _____	
		Wall Steel 1st _____ 2d _____ 3d _____	
		Final Inspection _____	
Retaining Wall, (masonry)		Retaining Wall (concrete)	
Location _____		Location _____	
Footings _____		Footings _____	
Wall Steel 1st _____ 2d _____ 3d _____		Wall Steel 1st _____ 2d _____ 3d _____	
Bond Beam 1st _____ 2d _____ 3d _____		Final Inspection _____	
Final Inspection _____			

23.14 B ADDRESS 216 Cervantes LOG NO. _____ AREA _____