

· 3524 Corona Del Mar ·

L105 B 3 Twin Lakes Village Unit 14-B Zone R-1

A. Gatewood 2-26-79

CITY OF LAS VEGAS, NEVADA

36-10

LOG NO. & AREA

T44-3

CONST. VAL. \$ 29,190

DEPARTMENT OF PUBLIC SERVICES
DIVISION OF BUILDING AND SAFETY

APPLICATION & BUILDING PERMIT - for:
Dwellings, Duplexes, Misc. Residential Const.

ADDRESS OF CONSTRUCTION: 3524 Corona Del Mar Drive

OWNER: First Western Savings Association

LOT(s): 1052 BLOCK: 3 SUBDIVISION: Twin Lakes Village Unit 14-B ZONE: R-1

Existing structure on lot: Dwelling Accessory Bldgs. Vacant Lot Other

PROPOSED CONSTRUCTION: Single Family Dwelling - New With Fireplace USE: Residential

MATERIALS OF CONSTRUCTION: Wood Frame Concrete Block Reinforced Concrete Steel Frame

SQUARE FEET OF FLOOR AREAS: 1st: 1,199 2nd: 3rd: Other: 441 TOTAL SQ. FT.: 1640

FIRE ZONE: 3 Occupancy Group: R3 + M1 CONST. TYPE: V-N

ARCHITECT: Stanton Construction ENGINEER: NO. of UNITS: 1 NO. of STORIES: 1

Plans Submitted: Yes No Calculations Submitted: Yes No Sewer Fee Req'd: Yes No

CONTRACTOR: Stanton Construction, Inc. STATE LICENSE #: 12947A CITY LICENSE #: C11 18086

ADD'L. PERMITS REQ'D: Air Cond. Elec. Plumbing Signs Paving Fence Public Walks Curb gutters
Incinerators Fire Sprinkling System

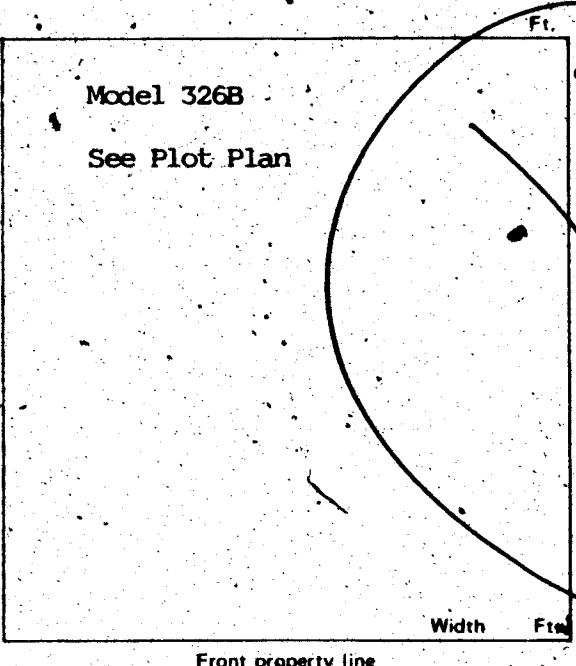

CONDITIONS OF THE PERMIT:

- I agree to call the City Building Department for inspections before concrete is poured, before rough wiring, electrical, plumbing, framing is covered. Also for Air conditioning, drywall and sheathing inspection.
- I agree that when the job is completed that I will call for final inspection before occupancy.
- I agree to perform all construction in accordance with City Ordinances and Building Codes.
- The Contractor's signature below denotes authority from the owner to sign in his behalf and that the owner is aware of all requirements of this application and permit. Separate permits must be taken out for work outlined above this agreement.
- I have read and understand the contents of this application and permit. I hereby state that the information I have supplied on this application is true and correct.

Approval for the work under this permit will be given only after refuse and debris have been removed from job site and public right of way.

SIGNED: Stanton Construction, Inc. Contractor

BY: *Donald L. Wylie* Agent or Owner
Donald L. Wylie, General Manager

PLANNING DEPT: *[Signature]* Date: 10-26-78

PUBLIC WORKS DEPT: *Turb* Date: 10/27/78

BUILDING DIVISION: *RLC* Date: 11-2-78

PERMIT NO.: 11124-73 PERMIT FEE \$ 131.00

154-01-220

RECEIPT

MUST BE MACHINE VALIDATED

G. Gatewood 2-26-79

CITY OF LAS VEGAS, NEVADA

DEPARTMENT OF PUBLIC SERVICES—APPLICATION AND PERMIT FOR PLUMBING DIVISION OF BUILDING AND SAFETY

ADDRESS OF CONSTRUCTION: 3524 Corona Del Mar Drive OWNER'S NAME: Stanton Construction, Inc.
 CIRCLE: New Bldg. Add'n.; Remodel; TYPE OF BLDG.: SFD APT. PUBLIC COMM.
 CONTRACTOR'S NAME: Mojave Plumbing, Inc. STATE LICENSE # 10312A CITY LICENSE # 12057

UNITS	DESCRIPTION	FEE	TOTAL
1	Bath tub	1.00	1.00
1	Shower	1.00	1.00
2	Lavatory	1.00	2.00
2	Toilet	1.00	2.00
	Urinal	1.00	
	Floor Drain	1.00	
	Floor Sink	1.00	
	Wash Tray	1.00	
1	Sink	1.00	1.00
1	Garbage Disposal	1.00	1.00
	Garbage Disposal (comm.)	3.00	
1	Clothes Dryer (gas)	1.00	1.00
1	Clothes Washer	1.00	1.00
	Clothes Washer (comm.)	5.00	
	Dishwasher	1.00	1.00
	Dishwasher (commercial)	5.00	
	Dental Unit	10.00	
	Drinking Fountain	1.00	
	Any Water using Equipment	1.00	
1	Water Heater (gas) (elect.)	1.00	1.00
1	Sewer System—New, Replacement, or any Drainage System	4.00	4.00
	Grease or Sand Trap	2.00	
	Trailer Trap	2.00	
	Septic Disposal System	4.00	
WATER SOFTENERS			
	Nonpermanent Type	4.00	
	Permanent Type (connected to Drainage)	5.00	
SWIMMING POOLS			
	Private or Wading Pool	10.00	
	Public or Semi-public	20.00	

UNITS	DESCRIPTION	FEE	TOTAL
WATER DISTRIBUTION SYSTEM			
1	Single Family Dwelling	4.00	4.00
	Multiple Family Dwelling plus each unit	4.00	
		2.00	
	Commercial Bldg. per floor	6.00	
	Hotel or Motel plus each bath	4.00	
		1.50	
	Trailer Park plus each space	20.00	
		1.00	
	Irrigation	4.00	
GAS PIPING SYSTEM			
1	Single Family Dwelling	3.00	3.00
	Multiple Family Dwelling plus each unit	6.00	
		1.00	
	Commercial Bldg. per floor plus each unit	3.00	
		3.00	
X 2	Gas Appliance (any type)	1.00	2.00
AUTOMATIC FIRE EXTINGUISHING SYSTEM			
	Underground Piping	10.00	
	Distribution Piping ea/ ft.	.01	
	Sprinkler Head each	.10	
	In Range Hood and Vent	5.00	
DRY STANDPIPE SYSTEM			
	Piping	50.00	
	Each Outlet	1.00	
WET STANDPIPE SYSTEM			
	Piping	5.00	
	Fire Hose Cabinet	1.00	
MINIMUM PERMIT FEE			
		4.00	
PIPELINE CONTRACTOR; SECT. 14 B.P.F. \$			
			25.00

I hereby certify that I have carefully examined and read the above application, that the same is true and correct, and that the work herein described is to be done in accordance with all the provisions of the applicable Ordinances of the City of Las Vegas, Nevada and the State Laws, whether herein specified or not.

Approval for the work under this permit will be given only after refuse and debris have been removed from job site and public right of way.

Signed Thomas J. Wallace Date: _____
 Registered Master Plumber, Spec. Cont'r. or Owner.
 Building Division: B.D. Date: 11-30-78
 Permit No. 11249-1 Permit Fee \$ 25.00

T54-01-222

RECEIPT

MUST BE MACHINE VALIDATED

A. Gatewood 2-26-79

CITY OF LAS VEGAS, NEVADA

DEPARTMENT OF PUBLIC SERVICES - AIR CONDITIONING APPLICATION & PERMIT
 DIVISION OF BUILDING AND SAFETY

ADDRESS OF CONSTRUCTION: 3524 Corona Del Mar Drive OWNER'S NAME: Stanton Construction Inc.

CIRCLE: Addition; Remodel; New Bldg; TYPE OF BLDG: SFD APT. COMM. PUBLIC

CONTRACTOR'S NAME: Central Air Conditioning STATE LICENSE # 11997 CITY LICENSE # 00057

UNITS	DESCRIPTION	FEE	TOTAL	UNITS	DESCRIPTION	FEE	TOTAL
	Unit heater - floor, wall or suspended	4.00		EVAPORATIVE COOLERS:			
FOR EACH FORCED AIR OR GRAVITY-TYPE FURNACE OR BURNER INCLUDING DUCTS AND VENT ATTACHED TO SUCH APPLIANCES:					5 outlets or under	3.00	
	Up to and including 100,000 B.t.u.'s	4.00			Over 5 and up to and including 10	5.00	
	Over 100,000 B.t.u.'s	6.00			Each additional outlet over 10	.25	
FOR EACH HEATING APPLICATION, REFRIGERATION UNIT, COMFORT COOLING, AND HEATING UNIT, ABSORPTION UNIT, COMPRESSOR OR BOILER:				VENTILATION:			
1-3	Up to and including 3 ton or horsepower, or absorption system up to and including 100,000 B.t.u.'s	4.00	4.00		For each fan connected to a single duct	1.00	
	Over 3 ton or 3 horsepower up to and including 10, or absorption system over 100,000 B.t.u.'s up to and including 250,000 B.t.u.'s	7.00			For each commercial or industrial ventilation system	5.00	
	Over 10 ton or 10 horsepower up to and including 30, or absorption system over 250,000 B.t.u.'s up to and including 1,000,000 B.t.u.'s	12.00			For each commercial kitchen hood	5.00	
	Over 30 ton or 30 horsepower up to and including 50, or absorption system over 1,000,000 B.t.u.'s up to and including 1,700,000 B.t.u.'s	20.00		MISCELLANEOUS:			
	Over 50 ton or 50 horsepower, or absorption system over 1,700,000 B.t.u.'s	30.00			For each water cooling tower	8.00	
FOR EACH AIR HANDLING UNIT INCLUDING DUCTS ATTACHED THERETO:					Duct work only - each opening	.25	
	Up to and including 10,000 CFM	2.00			For installation or relocation of each commercial or industrial incinerator	15.00	
	Over 10,000 CFM	4.00			Gas piping related to the air cond. work in single family dwelling only	3.00	
					For each appliance, piece of equipment, any mechanical work or alteration or replacement not included in this schedule, the permit fee shall be computed the same as building permit fees by using the cost of installation for the valuation amount.		
						FOR THE ISSUANCE OF EACH PERMIT:	3.00
						TOTAL PERMIT FEES	7.00

I hereby certify that I have carefully examined and read the above application; that the same is true and correct; and that the work herein described is to be done in accordance with all the provisions of the applicable Ordinances of the City of Las Vegas, Nevada and the State Laws, whether herein specified or not.

Approval for the work under this permit will be given only after refuse and debris have been removed from job site and public right of way.

SIGNED G. McDonald Date 12/12/78
 Air Conditioning Contractor - Owner

BUILDING DIVISION B.D. Date 12-12-78

PERMIT NO. 154-01-224 PERMIT FEE \$ 7.00

#12890

RECEIPT

MUST BE MACHINE VALIDATED

Sharon Nevada June 17, 1979

DEPARTMENT OF PUBLIC SERVICES—ELECTRICAL APPLICATION & PERMIT
DIVISION OF BUILDING AND SAFETY

ADDRESS OF CONSTRUCTION: 3524 Corona Blvd Mar Drive

OWNER'S NAME: Stanton Const. Inc.

CIRCLE: New Bldg. Add'n. Remodel. TYPE OF BLDG.: SFD. APT. PUBLIC COMM.

CONTRACTOR'S NAME: ABC ELECTRIC

STATE LICENSE #: 13214

CITY LICENSE #: 09893

NUMBER	FIXTURE OR INSTALLATION	UNIT PRICE	TOTAL
	Rm addition, carport or garage enclosure	4.00	
	Temporary power	4.00	
57	Light, receptacle or switch outlet	.20	11.40
	Wall or ceiling space heater	.35	
1	Garbage grinder outlet	.35	.35
1	Dishwasher outlet	.35	.35
	Clothes dryer outlet	.35	
1	Automatic clothes washer	.35	.35
	Electric range outlet	.35	
	Electric water heater outlet	.35	
	Special purpose outlet	.35	
	X-ray unit and its appurtenances	5.00	
	Watts of festoon lighting (Watts) First 3,000 watts for each additional thousand watts	4.00 4.50	
	Horsepower each motor first horsepower or less for each additional horsepower	1.75 .35	
1	Electric service (including any single meter socket) for each additional socket	3.00 .35	3.00
1	Air conditioning service	1.50	1.50
	Each KW(KVA) Generator (Transformer, Welder) First 100 KVA for each additional KW(KVA)	2.00 .01	
	Speaker, signal or alarm outlet	.15	
	Amplifiers	.50	
	Control panels	.25	
	Main control racks	1.00	
	T.V. and radio antennas-master system only	.75	
	Minimum fee for any permit	4.00	
	TOTAL FEE		16.95

Approval for the work under this permit will be given only after refuse and debris have been removed from job site and public right of way.

I hereby certify that I have carefully examined and read the above application; that the same is true and correct; and that the work herein described is to be done in accordance with all the provisions of the applicable Ordinances of the City of Las Vegas, Nevada and State laws whether herein specified or not.

SIGNED: Margaret Ford DATE: 2/8/79
MASTER ELECTRICAL TECHNICIAN (OWNER)
 BUILDING DIVISION: M.S. DATE: 2/9/79
 PERMIT NO. 0957-2 PERMIT FEE: \$ 16.95

RECEIPT:

MUST BE MACHINE VALIDATED

Y. Gatewood December 20, 1979

CITY OF LAS VEGAS, NEVADA

LOG NO. & AREA _____

CONST. VAL. \$ 1050

DEPARTMENT OF PUBLIC SERVICES
DIVISION OF BUILDING & SAFETY

APPLICATION & BUILDING PERMIT - for:
Fence, Wall, Retaining Wall.

ADDRESS OF CONSTRUCTION: 3524 Corona Del Mar Dr Ed Petri

LOT(s) 105 BLOCK _____ SUBDIVISION Green Lakes Village 14-B ZONE R-1

Materials of Construction: Block Concrete Wire Wood Other Yes No

ARCHITECT: _____ ENGINEER: _____ PLANS:

CONTRACTOR: owner STATE LICENSE # _____ CITY LICENSE # _____ CALCS:

TOTAL SQUARE FEET: 420 TOTAL LINEAL FEET: 70

Remarks:

CONDITIONS OF THE PERMIT:

1. Any type of retaining wall must be engineered by a Civil or Structural Engineer.
2. If a home owner takes out the Building Permit and the owner sublets the work to a Contractor, then the Contractor must take out the permit and pay for it.
3. No fence or wall can be built on City property or rights-of-way, but this is not intended to preclude construction within utility easements if utilities will not be damaged or made inaccessible.
4. The fence or wall shall not enclose any water meter, light standard, or fire alarm box and shall not come closer than 24" from the nearest fire hydrant outlet.
5. Department inspectors must approve footings before concrete is poured and block wall reinforcing before grouting is done.
6. Maximum height of any wall or fence is 6', side and rear yards 4' maximum in front yard with the vertical surface above the height of 2' - 50% open.
7. I must not obstruct required onsite parking space (2 spaces for each dwelling unit) by the erection of this fence or wall.
8. By the signing of this application I herewith agree to the requirements outlined above.

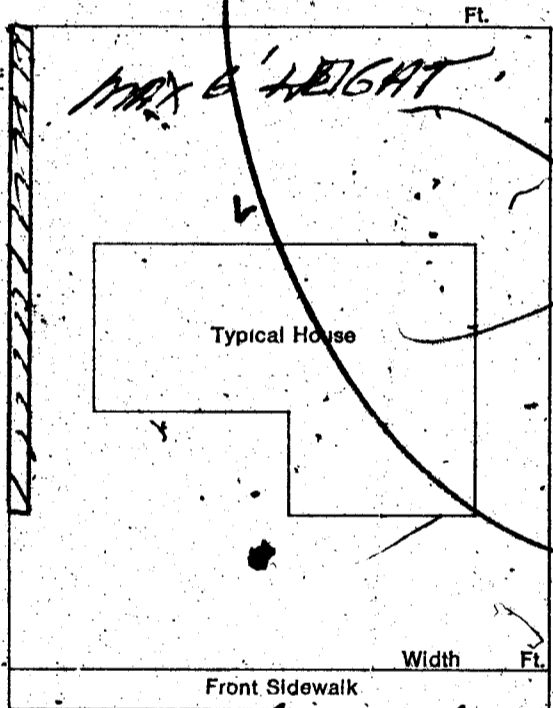

1LULA \$.00
 WALL \$ 12.00
 STL \$ 12.00
 TOTL \$ 12.00
 CASH DATE 20.00
 CHNG 8.00

3524 Corona Del Mar Dr Ed Petri

SIGNED: Ed Petri

CONTRACTOR AGENT

PLANNING DEPT: J. Robinson Date: 12/10/79

PUBLIC WORKS DEPT: [Signature] Date: 12/10/79

BUILDING DIVISION: M.S. Date: 12/10/79

#12858 PERMIT NO: 8871 PERMIT FEE \$ 12.00

A#8871 SR#001/01
 CITY - LAS VEGAS
 BLDG. & SAFETY
 12/10/79

MUST BE MACHINE VALIDATED

James L Jackson

FENCE & RETAINING WALLS		
OWNER Ed Petri	PERMIT NO. 12-10-79	FINAL INSPECTION 6-11
ADDRESS 3524 Corona Del Mar Dr.		
CONTRACTOR Owner	PERMIT NO. 8871	FINAL INSPECTION BK wall
LOT 105	BLOCK Twin Lakes Village	SUBDIVISION 14-B
LOG #	AREA	
FENCES (wire, wood, block, & retaining walls)		
Location	U/H 12-14-79	
Footing		
Wall Steel		
1st	2nd	
Bond Beam		
1st	2nd	
Final	U/H 2-2-79	
Specify Type Of Fence		

OWNER First Western Savings ADDRESS 3524 Corona Del Mar Dr.	
DATE 11-29-78	GEN. CONT. Stanton Const.
SFD NEW W/F.P. 11124-7	
TYPE OF STRUCTURE	PERMIT NO. FINAL INSPECTION
LEGAL DESCRIPTION L-105 B-3	LOG # T44-3 AREA #
Twin Lakes Village Unit T4B	
APPROVED FOR OCCUPANCY & METER	
BUILDING	MECHANICAL
Investigation	Plumbing Cont. Winters
Location & Footing JK 1-3-79	Permit No. 11249-1 Date 1-30-78
Concrete Slab Floor JK 1-3-79	Heat & Vent. A/C Cont. Perkins
Fireplace Footing EC 1-31-79	Permit No. 11596-2 Date 12-12-78
Chimney Steel EC 2-18-79	First Western Savings Sewer Cont.
Vert. Steel Reinf.	Permit No. 11123 Date 11-29-78
Horiz. Steel Reinf.	Rough Soil
Framing EC 3-15-79	Rough Water
Ext. Lath JK 3-8-79	Top Out MC 3-15-79
Ext. Brown	Rough Gas. MC 3-15-79
Drywall	A/C Rough Duct
Final Building EC 4-19-79	Final Plumbing JL 9-26-79
Appr. for Occu.	Final Gas JL 4-26-79
ELECTRICAL	
Temp. Pole Cont.	Final Air Cond. MC 3-15-79
Permit No.	Date
Inspection #	Date
Electrical Cont. ABC	
Permit No. 0957-2 Date 2-7-79	
Rough CW 2-22-79	
Final Rough	
Final Electrical CW 4-22-79	
Temporary Service	
PLEASE NOTE ADDITIONAL REMARKS ON REVERSE SIDE.	
DIV. OF BLDG. & SAFETY CITY OF LAS VEGAS REV. 10-78	
2-1-31	
E-Z WAY SYSTEMS NEWARK, OH 43055 LITHO IN U.S.A.	