

3020 TO 3040 CONTRAC

SEE APPLICAITON FOR LEGAL

Sharon Pereira: 2/23/79

1970

CITY OF LAS VEGAS, NEVADA

LOG NO. & AREA

DEPARTMENT OF BUILDING & SAFETY

CONST. VAL. \$ 1,528

APPLICATION & BUILDING PERMIT - for: Fence, Wall, Retaining Wall.

ADDRESS OF CONSTRUCTION:

3020 TO 3040 CONTRACT AVE OWNER Russel Job

LOT(S)

9/11/11 BLOCK 2 SUBDIVISION EAST PARK - INDS. SUB ZONE CH

Materials of Construction:

Block  Concrete  Wire  Wood  Other

Yes No

PLANS:

ARCHITECT:

ENGINEER:

CALCS:

CONTRACTOR:

Fortune Fence

STATE LICENSE #

5906 A

CITY LICENSE #

8489

TOTAL SQUARE FEET:

4584

TOTAL LINEAL FEET:

767

Remarks:

Empty table for remarks.

CONDITIONS OF THE PERMIT:

- 1. Any type of retaining wall must be engineered by a Civil or Structural Engineer.
2. If a home owner takes out the Building Permit and if the owner sublets the work to a Contractor, then the Contractor must take out the permit and pay for it.
3. No fence or wall can be built on City property or rights-of-way, but this is not intended to preclude construction within utility easements, if utilities will not be damaged or made inaccessible.
4. The fence or wall shall not enclose any water meter, light standard, or fire alarm box and shall not come closer than 24" from the nearest fire hydrant outlet.
5. Department Inspectors must approve footings before concrete is poured and block wall reinforcing before grouting is done.
6. Maximum height of any wall or fence is 6', side and rear yards; 4' maximum in front yard with the vertical surface above the height of 2' - 50% open.
7. I must not obstruct required onsite parking space (1 space for each dwelling unit) by the erection of this fence or wall.
8. By the signing of this application I herewith agree to the requirements outlined above.

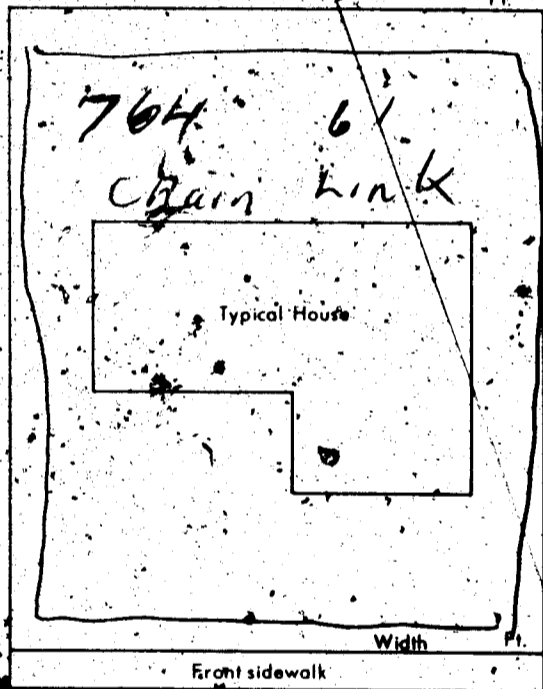

SIGNED:

R. M. Cooper

DATE Dec 3, 1970

CONTRACTOR  AGENT  OWNER

PLANNING DEPT.:

MR

Date:

12-3-70

PUBLIC WORKS DEPT.:

Date:

BUILDING DEPT.:

M. Miller

Date:

12-3-70

#12850

PERMIT NO.:

55700

PERMIT FEE \$

15.00

RECEIPT

2554 \$015.00 - 8

CITY OF LAS VEGAS DEPT. OF BUILDING & SAFETY

MUST BE MACHINE VALIDATED

- 3 DEC 70

DEPARTMENT OF BUILDING & SAFETY  
CITY OF LAS VEGAS, NEVADA

KARDEX CARD  
FENCE & RETAINING  
WALLS

OWNER Russel Job ADDRESS 3020 to 3040 Contract Ave. DATE 12-3-70

CONTRACTOR Fortune Fence PERMIT NO. 55700

LOT 9, 10, & 11 BLOCK 2 SUBDIVISION East Park Inds Sub wire fence

Fence (wire, wood, etc.)	Walls (masonry, rock, etc.)
Location _____	Location _____
Final Inspection <u>09 12-11-70</u>	Footings _____
	Wall Steel 1st _____ 2d _____ 3d _____
	Final Inspection _____
Retaining Wall (masonry)	Retaining Wall (concrete)
Location _____	Location _____
Footings _____	Footings _____
Wall Steel 1st _____ 2d _____ 3d _____	Wall Steel 1st _____ 2d _____ 3d _____
Bond Beam 1st _____ 2d _____ 3d _____	Final Inspection _____
Final Inspection _____	

23.14 B

ADDRESS 3020 To 3040 Contract Ave. LOG NO. \_\_\_\_\_ AREA \_\_\_\_\_

*Nona Vogel* 5-23013

# CITY OF LAS VEGAS, NEVADA

666-613-006

3040 CONTRACT

LOG NO. & AREA

C-62

CONST. VAL. \$ 627,500.00

DEPARTMENT OF BUILDING AND SAFETY

APPLICATION & BUILDING PERMIT - for Commercial or Public Structures.

ADDRESS OF CONSTRUCTION

3040 Contract Ave

OWNER

Small Lot

LOT(s)

11

BLOCK

SUBDIVISION

East Park Sub Unit 1

ZONE

ROI 10A

Existing structure on lot:

Dwelling

Accessory Bldg.

Vacant Lot

Commercial Bldg.

Other

PROPOSED CONSTRUCTION

Warehouse with bldg

USE

Storage

MATERIALS OF CONSTRUCTION:

Wood Frame

Concrete Block

Reinforced Concrete

Steel Frame

SQUARE FEET OF FLOOR AREAS: 1st

2nd

3rd

Other

TOTAL SQ. FT.

5,000

FIRE ZONE:

Occupancy Group

CONST. TYPE:

ARCHITECT:

ENGINEER:

NO. of UNITS

NO. of STORIES

Plans Submitted:

Yes  No

Calculations Submitted

Yes  No

Sewer Fee Req'd.

Yes  No

CONTRACTOR

Champlin Sales

STATE LICENSE #

11854

CITY LICENSE #

12567

ADD'L. PERMITS REQ'D.:

Air Cond.

Elec.

Plumbing

Signs

Paving

Fence

Public Walks

Curbs/Gutters

Incinerators

Fire Sprinkling System

2-66-64(37) Approved by City Planning Comm. 3/21/83

### CONDITIONS OF THE PERMIT:

### CONDITIONS:

1. Conformance to the plot plan and elevations awarded to eliminate the 12 back-out signs and pave all parking areas.  
*PLANS*
2. Approval of the parking and driving plans by the Traffic Engineer.  
*Ph. I*
3. Repair any damage to existing improvements resulting from this development as required by the Dept. of Public Services.
4. Provision of fire hydrants and water as required by the Department of Fire Services.  
*SEE PLANS*

1. I agree to call the City Building Department for inspections before concrete is poured, before rough wiring, electrical, plumbing, framing is covered. Also for air conditioning, drywall and sheathing inspection.
2. I agree that when the job is completed that I will call for final inspection before occupancy.
3. I agree to perform all construction in accordance with City Ordinances and Building Codes.
4. The Contractor's signature below denotes authority from the owner to sign in his behalf and that the owner is aware of all requirements of this application and permit. Separate permits must be taken out for work outlined above this agreement.
5. I have read and understand the contents of this application and permit; I hereby state that the information I have supplied on this application is true and correct.

Approval for the work under this permit will be given only after refuse and debris have been removed from lot and public right of way.

ILDUT \$ 00.00  
 SEER \$ 585.00  
 CEM \$ 125.50  
 SJL \$ 920.50  
 TPL \$ 920.50  
 CHER \$ 920.50  
 SR# 001/01

BY

*Mike X. Champlin*

CITY - LAS VEGAS BLDG. & SAFETY

Clark County Health Department 03/16/83

Las Vegas Fire Department

PLANNING DEPT. *2/28*

Date: 4/19/83

PUBLIC WORKS DEPT. *JOK*

Date:

BUILDING DIVISION: *M. O.*

Date: 5/13/83

76-10-13  
154-01-220

PERMIT NO.:

9841

PERMIT FEE \$

335.50

### RECEIPT

*CK# 2030*

MUST BE MACHINE VALIDATED

**Steel Buildings**

Representative  
**Mel Champlin**  
(702) 876-9520

• Farm • Commercial  
• Industrial • Retail  
Complete Building Services

LIC. #01512

Write or Call: **Champlin Building & Sales**  
1523 Industrial  
Las Vegas, NV 89102 (702) 388-0888



# CITY OF LAS VEGAS, NEVADA

## DEPARTMENT OF BUILDING AND SAFETY - PLUMBING APPLICATION & PERMIT

ADDRESS OF CONSTRUCTION: 3040 Contract Ave.

OWNER'S NAME: Russell Jalt

PHONE NO. \_\_\_\_\_

CIRCLE: Addition; Remodel; New Bldg. TYPE OF BLDG.: SPD APT. COMM. PUBLIC

CONTRACTOR'S NAME: Ayres Plumbing Corp.

STATE LICENSE # 012058

CITY LICENSE C11-570-2-12748

UNITS	DESCRIPTION	FEE	TOTAL
<b>PERMIT ISSUANCE</b>			
1	For Issuing Each Permit	10.00	10.00
	For Issuing Each Supplemental Permit	4.50	
<b>FIXTURE CHARGE</b>			
2	Bathtub, Shower, Lavatory, Toilet, Urinal	EA. 2.00	4.00
	Floor Drain, Floor Sink, Wash Tray, Sink	EA. 2.00	
	Garbage Disposal, Clothes Washer, Dishwasher (residential)	EA. 2.00	
	Garbage Disposal (commercial)	EA. 8.00	
	Clothes Washer, Dishwasher (commercial)	EA. 2.00	
	Clothes Dryer (gas) (venting)	2.00	
	Dental Unit	2.00	
	Drinking Fountain	8.00	
	Refrigerator - Ice Maker, Water Dispenser	2.00	
	Any other water using equipment, Attached Coffee Makers, Ice Makers	2.00	
1	Hot Water Heater (Gas or Electric)	EA. 2.00	2.00
<b>SEWER SYSTEM</b>			
1	New, Replacement, Modification, or Any Drainage Work	10.00	10.00
	Grease or Sand Trap or Interceptor	2.00	
	Trailer Trap (rental parks)	5.00	
<b>WATER SOFTENERS</b>			
	Non Permanent Type (rental)	2.00	
	Permanent Type (connected to drain)	2.00	
<b>SWIMMING POOLS</b>			
	Private or Wading Pool (including spa)	20.00	
	Public or Semi-Public	30.00	
	Spas - Preformed (private)	10.00	
	Spas - Preformed (commercial)	20.00	
<b>WATER DISTRIBUTION SYSTEM</b>			
	Single Family Dwelling	6.00	
	Multi-Family Dwelling	6.00	
	Plus Each Dwelling Unit	3.00	
1	Commercial Building per floor	3.00	3.00
	Plus Each Unit (leased space or office)	2.00	
	Hotel or Motel	8.00	
	Plus Each Unit	3.00	
	Trailer Park	30.00	
	Plus Each Space	2.00	
1	Irrigation	8.00	8.00
<b>FUEL PIPING SYSTEM</b>			
	Single Family Dwelling	6.00	
	Multi-Family Dwelling	10.00	

UNITS	DESCRIPTION	FEE	TOTAL
	Pipe Each Unit	2.00	
1	Commercial Building (per floor)	6.00	6.00
2	Plus Each Unit (leased space or office)	6.00	12.00
	Medium Pressure Gas System (plan check)	12.00	
	Each Gas Appliance (any type)	2.00	
	Standby Emergency (generating engines)	5.00	
	Steam Boilers	5.00	
	Service Station Fuel Tank and Piping System	10.00	
		10.00	
<b>AUTOMATIC FIRE EXTINGUISHING SYSTEM</b>			
	Underground Piping	20.00	
	Distribution Piping (per foot)	.05	
	Sprinkler Head (each)	.20	
	In Range Hood and Vent	10.00	
	Dry Standpipe System		
	Piping	75.00	
	Each Outlet	2.00	
	Wet Standpipe System		
	Piping	10.00	
	Fire Hose Cabinet	2.00	
<b>SOLAR ENERGY SYSTEMS</b>			
	Collectors (including piping) (per collector)	5.00	
	Storage Tanks (each)	5.00	
<b>PIPELINE CONTRACT</b>			
	For Onsite Sewer, Gas or Water Contract Value. Fee based on Building Code Permit Valuation Chart.		
	Inspections for which no fee is specifically indicated (minimum charge - one half hour)	15.00	per hour
	Additional plan review required for changes, additions or revisions to approved plans (minimum charge - one half hour)	15.00	per hour
	Misc.	11.00	\$ 11.00
		PEMB	\$ 35.00
		PL	\$ 35.00
		TOTL	\$ 35.00
		GRAND TOTAL	\$ 35.00
<b>TOTAL PERMIT FEE \$ 35.00</b>			

Plumbing permit fees may be computed the same as building permit fees by using the cost of installation for valuation amount when such work is done in accordance with the applicable Ordinance of the City of Las Vegas, Nevada.

I hereby certify that I have carefully examined and read the above application; that the same is true and correct, and that the work herein described is to be done in accordance with all the provisions of the applicable Ordinances of the City of Las Vegas, Nevada and the State Laws, whether herein specified or not.

Approval for the work under this permit will be given only after refuse and debris have been removed from job site and public right of way.

CITY MASTER CARD NO. 7

SIGNED Russell Jalt Date 5-25-83  
 Registered Master Plumber, Spec. Contr. or Owner

BUILDING DIVISION Palfano Date 5-25-83

PERMIT NO. 10-2403 0073 PERMIT FEE \$ 35.00

05/25/83

RECEIPT

# CITY OF LAS VEGAS, NEVADA

## DEPARTMENT OF BUILDING AND SAFETY—ELECTRICAL APPLICATION & PERMIT

PHONE NO. 452-1729

ADDRESS OF CONSTRUCTION: 3040 CONTRACT AVE OWNER'S NAME: \_\_\_\_\_

CIRCLE: Addition; Remodel; New Bldg TYPE OF BLDG.: SFD APT. COMM PUBLIC

CONTRACTOR'S NAME: DuFour Electric STATE LICENSE # 020112 CITY LICENSE # 011-2366

UNITS	DESCRIPTION	FEE	TOTAL
<b>PERMIT ISSUANCE</b>			
	For Issuing Each Permit	10.00	10.00
	Supplemental Fee	4.50	
<b>APPLIANCE CHARGE</b>			
50	Receptacle <u>40</u> Switch <u>10</u>	.40	20.00
40	Each Light Fixture br Socket	.30	12.00
	EACH OUTLET FOR: Dishwasher, Garbage Grinder, Trash Compactor, G.F.L., Clothes Washer, Dryer, Electric Range, Ovens, Smoke Detector, Special Purpose, Water Heater, Space Heater, Blast Coil Heater (PER K.W.), Mercury Lamp, Quartz Lamp, Sodium Lamp	.70	2.80
	X-Ray Unit	10.00	
	Area Lighting (First 3,000 Watts)	8.00	
	Each Additional 1,000 Watts	3.00	
	Motors (1/2 H.P. And Over) Transformers Welders, Generators		
	First H.P. For each Unit	3.00	
	First KVA For each Unit	.50	
	Each Additional H.P. or KVA	.30	
	Temporary Power or Pole	6.00	
1	Electric Service (Incl'd First Meter)	6.00	6.00
	Up to 200 AMP		
	400 AMP And 600 AMP	12.50	
	Over 600 AMP To 1200 AMP	25.00	
	Over 1200 AMP	50.00	
	Each Additional Meter Socket	.50	

UNITS	DESCRIPTION	FEE	TOTAL
1	Sub Panel (Each)	3.00	3.00
	Swimming Pool (Residential)	20.00	
	Swimming Pool (Semi-Public)	30.00	
	Spas	8.00	
	Recreational Vehicle Spaces (Each)	3.00	
	Busways-Trolley or Plug-in (Ea. 100 Ft.)	3.00	
	All Misc. Electric		
1	Permanent A/C Unit (Pkg. Units)	3.00	3.00
5	Each Air Handler	1.00	5.00
<b>LOW VOLTAGE INSTALLATIONS</b>			
	Speaker Outlets (Each)	.30	
	Signal or Alarm Outlets (Each)	.30	
	Amplifiers	2.00	
	Control Panel	.50	
	TV Master System	.30	
	Telephone or Computer Outlet	.30	
	Starter Permit		
	Contract Price or Cost of Installation		
	Misc.		
<b>CONDUIT ONLY</b>			
TOTAL PERMIT FEE \$		61.80	

Electrical permit fees may be computed the same as building permit fees by using the cost of installation for valuation amount when such work is not included in the above schedule.

**FOR BUILDING DEPARTMENT USE ONLY**

Plans submitted:  yes  no      Occupancy type: \_\_\_\_\_      Type of Construction \_\_\_\_\_ Footage \_\_\_\_\_

Received by PAC: \_\_\_\_\_      Date: \_\_\_\_\_      Valuation (declared) \$ \_\_\_\_\_

Review by Plans Check: \_\_\_\_\_      Date: \_\_\_\_\_      Fee calculated \$ 1.00      \$ 0.00

Issued by: \_\_\_\_\_      Date: \_\_\_\_\_      Other Fees (226) \$ ELEC \$ 61.80

Check  Cash       Total Fees \$ STL \$ 61.80

- Other inspections and fees:
- Inspections outside of normal business hours = \$25.00 per hour (minimum charge two hours).
  - Re-inspection fee during normal business hours assessed under provisions of TABLE 3-A of the Uniform Building Code = \$15.00 per hour.
  - Inspections during normal business hours for which no fee is specifically indicated = \$15.00 per hour (minimum charge one half hour).
  - Additional plan review required by changes, additions or revisions to approved plans = \$15.00 per hour (minimum charge one half hour).
  - Expires 180 days after abandonment of work.

Approval for the work under this permit will be given only if all refuse and debris have been removed from the site and public right of way.

CITY OF LAS VEGAS  
BLDG. & SAFETY  
05/31/83

I hereby certify that I have carefully examined and read the above application; that the same is true and correct; and that the work herein described is to be done in accordance with all the provisions of the applicable Ordinances of the City of Las Vegas, Nevada and the State Laws, whether herein specified or not. City Master Card No. 53

SIGNED Ronald Duff Date 04/18-83  
Master (Electrician) (Technician) (Owner)

BUILDING DIVISION RCM Date 5/31/83

PERMIT NO. 0207 PERMIT FEE \$ 61.80

Done & sealed  
10-21-83

# Certificate of Occupancy

City of Las Vegas, Nevada  
Department of Building & Safety

This Certificate issued pursuant to the requirements of the Uniform Building Code certifying that at the time of issuance this structure was in compliance with the various ordinances of the City regulating building construction or use. For the following:

Use Classification B-2 Bldg. Permit No. 9841

Building Address 3040 Contract Avenue Floor, Suite or Room \_\_\_\_\_

Owner of Building Russell Job Address 3040 Contract Avenue

Clay Hymer  
Building Official

By: Michael Marshall  
Date: September 26, 1983

POST IN CONSPICUOUS PLACE

*Don Hively*  
10-21-83



**DEPARTMENT OF BUILDING & SAFETY**

Phone 386-6251

**CITY OF LAS VEGAS, NEVADA**

APPROVED BUILDING PLANS No. \_\_\_\_\_

Approved Plans must be on Job Site During Const.

OWNER Russell Job

CONTRACTOR Champion Bldg & Sales

STREET NO. 3040 Contract Ave

TYPE OF STRUCTURE: Warehouse Model Bldg

DATE ISSUED: 5-16-83

Location & Footing \_\_\_\_\_  
 Stem Wall \_\_\_\_\_  
 Pour No Concrete Until Above is Signed  
 Conc. Slab BLDG. INSP. 62 CIV (Reinf.) 9/2/83  
 Electrical Slab \_\_\_\_\_  
 Plumbing (groundwork) MECH. INSP. 80 CLV  
 Gas Piping (groundwork) \_\_\_\_\_  
 Fireplace Footing \_\_\_\_\_  
 Chimney Steel \_\_\_\_\_  
 Fireplace Final \_\_\_\_\_  
 Conc. Block Building \_\_\_\_\_  
 Vert. Steel 1st \_\_\_\_\_ 2nd \_\_\_\_\_  
 Horiz. Steel 1st \_\_\_\_\_ 2nd \_\_\_\_\_

Drywall \_\_\_\_\_  
 Ext. Lath \_\_\_\_\_  
 Ext. Scratch \_\_\_\_\_  
 Ext. Brown \_\_\_\_\_  
 Miscellaneous \_\_\_\_\_  
 Roofing \_\_\_\_\_  
 Sewer \_\_\_\_\_

Final Electrical OK - 11-9-83  
 Final Plumbing \_\_\_\_\_  
 Final Gas \_\_\_\_\_  
 Final Heating & Vent \_\_\_\_\_  
 Final Building BLDG. INSP. 62 CIV 9/2/83  
 On-Site Paving BLDG. INSP. 62 CIV

Pour No Concrete Until Above is Signed.

OFFICES & BATHROOM MECH. INSP. NO. 71 C 8-5-83  
 Rough Electrical ELC. INSP. NO. 71 C  
 Topout \_\_\_\_\_  
 Rough Gas Piping \_\_\_\_\_  
 Rough Htg. & Vent. \_\_\_\_\_  
 Sheathing BLDG. INSP. 62 CIV  
 Framing BLDG. INSP. 62 CIV EXT. WALLS  
 Insulation BLDG. INSP. 62 CIV

NOTE: All of the following equipment shall be approved by the Las Vegas Fire Department before the Building Department will final this structure. Sprinkler systems; alarm and communications systems; standpipes; underground flammable liquid tanks; fire pumps; emergency generator; hood extinguishment systems; non-flammable medical gas systems.  
 Call Fire Prevention Bureau at 386-6361 for inspection

Fire Pump \_\_\_\_\_  
 Emerg. Generator \_\_\_\_\_  
 Alarm System \_\_\_\_\_  
 Sprinkler System \_\_\_\_\_  
 Smoke Detector \_\_\_\_\_

Building Permit No. 9841  
 Electric Permit No. \_\_\_\_\_  
 Plumbing Permit No. \_\_\_\_\_  
 Air Cond. Permit No. \_\_\_\_\_  
 Sewer Connection No. 9841-1

Occupancy Approval  
 Planning 9/26/83 SUBJECT TO CONDITIONS OF PERMITS AND PERMIT.  
 Quality Cont. SEPT. 20, 1983  
 Fire Dept. 9-21-83  
 Bldg. Dept. BLDG. INSP. 62 CIV

**POST THIS CARD ON FRONT OF BUILDING**

Temp. Occupancy Approval  
 Not To Exceed 60 Days  
 Bldg. Dept. \_\_\_\_\_