

2700 CONSTANTINE

Lot 133 BLK 3 WASHINGTON ADDITION #2 ZONE R-1

Marion Pereira 2/23/79

PERMIT FEE: \$ 3.00

CITY OF LAS VEGAS, NEVADA
DEPARTMENT OF BUILDING & SAFETY
APPLICATION & BUILDING PERMIT
for FENCE, WALL, RETAINING WALL

CONSTRUCTION
VALUATION: \$
INSPECTION
VALUATION: \$ 76.00

LOG NO. & AREA

ADDRESS OF 2700
CONSTRUCTION: Constantine OWNER'S NAME J. C. Fugate OWNER'S ADDRESS: Same

Lot (s) 133 Block 3 Subdivision Washington Blvd #2 Zone R-1

Materials of Construction: Concrete Block () Concrete () Wire () Wood () Other ()

Total Square Feet: _____ Total Lineal Feet 76

CONTRACTOR'S NAME: _____ STATE _____ CITY _____
LICENSE # _____ LICENSE # _____

Architect's Name: _____ PLANS SUBMITTED: Yes ___ No ___
Engineer's Name: _____ CALCULATIONS: Yes ___ No ___

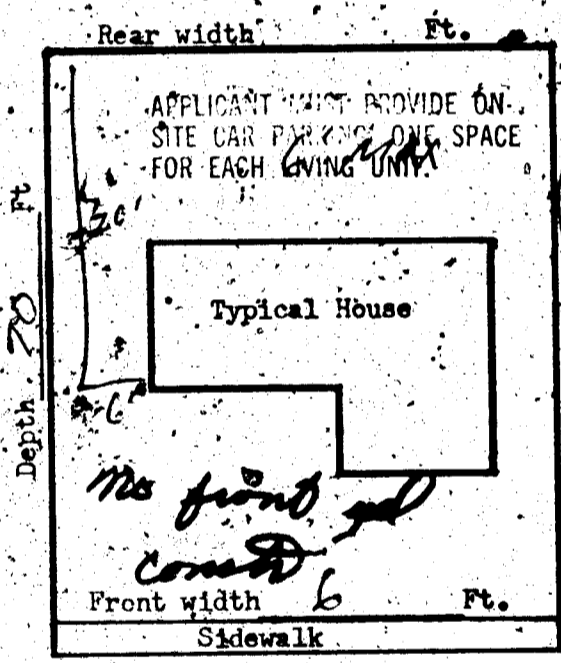

I understand that any portion of this (fence) (wall) constructed or erected on City property or right-of-way will be removed from said location at my expense upon request received from the City of Las Vegas, Nevada. I understand that the (fence) (wall) shall not enclose water meter, light standard, fire alarm box & shall not come closer than two (2) feet in any direction from any fire hydrant. I further state that I am familiar with effective Ordinances of the City of Las Vegas, Nevada & effective Statutes of the State of Nevada covering construction and use of the above type; I agree to perform said construction in conformity therewith. I further agree that issuance of a permit on above application will not excuse me from conforming with said Ordinances and Statutes, despite any error on the part of the Building Inspector or Engineer in checking plans and applications herewith submitted. I have read and understand the contents of above application & permit; I hereby state that same are true and correct.

STREET Constantine

SIGN HERE: J. C. Fugate Date: Dec 3, 1966
By: _____

APPROVED BY: [Signature] DATE 12/2/66
PLANNING DEPT. & CODE ASSISTANCE

FIRE DEPARTMENT DATE 12/2/66

ENGINEERING DEPARTMENT DATE DEC. 2, 1966

BUILDING & SAFETY DEPARTMENT DATE DEC. 2, 1966

#1285 PERMIT NO. 35577 PERMIT FEE \$ 3.00
23.14

RECEIPT
35577 \$003.00 - 8
 CITY OF LAS VEGAS
 DEPT. OF BUILDING & SAFETY
 Must be machine validated
 - 2 DEC 66

DEPT. of BLDG & SAFETY—CITY of LAS VEGAS, NEVADA
 OWNER ARDEN BLDG. CORP. ADDRESS 2700 Constantine Ave. DATE 8-6-62
 GEN. CONT. SAME TYPE OF STRUCTURE S.F. Dw.
 PERMIT NO. 11735 LEGAL DESCRIPTION Lot 133 Block 3 Wash. Add #3

BUILDING	MECHANICAL	ELECTRICAL
LOCATION	PLUMBING CONT. <u>11/24/62</u>	TEMP. POLE CONT.
FIREPLACE FTG.	PERMIT NO. <u>7405</u> DATE <u>125/62</u>	PERMIT NO. _____ DATE _____
FOOTINGS	HEAT & VENT. AC CONT. <u>12/11/62</u>	INSPECTION _____ DATE _____
FOUNDATION WALL	PERMIT NO. <u>2580</u> DATE <u>12/17/62</u>	ELECTRICAL CONT. <u>Vegas Valley</u>
STEM WALL	SEWER CONT.	PERMIT NO. <u>8237</u> DATE <u>8-1-62</u>
FLOOR FRAMING	PERMIT NO. _____ DATE _____	FIXTURES CONT.
SLAB	ROUGH SOIL <u>12/10/62</u>	PERMIT NO. _____ DATE _____
CHIMNEY STEEL (FIREPLACE)	ROUGH WATER <u>12/10/62</u>	SLAB _____
WALL STEEL	TOP-OUT <u>12/10/62</u>	ROUGH <u>plaster 12/11/62</u>
COLUMN STEEL	ROUGH GAS <u>12/10/62</u>	FINAL ROUGH _____
BEAM STEEL	AC. ROUGH DUCT <u>12/11/62</u>	FINAL FIXTURE _____
STEEL FABRICATION	REF. ROUGH PIPING _____	TEMPORARY SERVICE _____
FRAMING <u>12/14/62</u>	FINAL PLUMBING <u>12/4/63</u>	
ROOF SHEATHING <u>11-14-62</u>	FINAL GAS _____	MISCELLANEOUS
INTERIOR	FINAL AIR COND. <u>12/4/63</u>	URBAN REDEVELOPMENT APPROVAL _____
DRYWALL	FINAL REFRIG. _____	<input type="checkbox"/>
LATHING <u>11-22-63</u>	FINAL SEWER <u>12-20-63</u>	GRADING & DRAINAGE _____
BACKING (SIDING) _____	FINAL SEPTIC TANK _____	ON-SITE PARKING SPACES _____ APP. _____
PLASTER SCRATCH _____		ENG. APPROVAL OF _____
FINAL BLDG. <u>12/20/63</u>		OFF-SITE IMPROVEMENTS _____

APPROVED FOR OCCUPANCY 12/20/63 INSPECTOR _____ DATE _____
 APPROVED FOR METER 12/18/63
 PLEASE NOTE REMARKS ON REVERSE SIDE LOG # _____ AREA # _____ 23.04
 2700 Constantine Ave. T-38 .2

DEPARTMENT OF BUILDING & SAFETY
 CITY OF LAS VEGAS, NEVADA
 OWNER R. C. FUGON ADDRESS 2700 Constantine DATE 12/2/66
 CONTRACTOR _____ OWNER _____ PERMIT NO. 35577
 LOT 133 BLOCK 3 SUBDIVISION Washington Add. #2
 Fence (wire, wood, etc.) Wood fence
 Walls (masonry, rock, etc.)
 Location _____
 Final Inspection 12-15-66
 Footing _____
 Wall Steel 1st _____ 2d _____ 3d _____
 Final Inspection _____
 Retaining Wall (masonry)
 Location _____
 Footing _____
 Wall Steel 1st _____ 2d _____ 3d _____
 Bond Beam 1st _____ 2d _____ 3d _____
 Final Inspection _____
 Retaining Wall (concrete)
 Location _____
 Footing _____
 Wall Steel 1st _____ 2d _____ 3d _____
 Final Inspection _____
 23.14 B ADDRESS _____ LOG NO. _____ AREA _____

KARDEX CARD
 FENCE & RETAINING WALLS
 DATE 12/2/66